

Remote Front

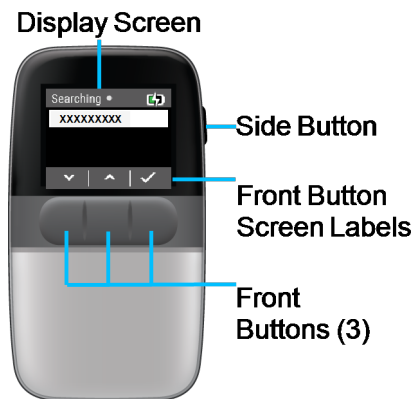

The **Front Button Screen Labels** displayed on the screen are executed by pressing the coinciding **Front Button** below the label.









To unlock the remote press the **Front Buttons** in order from left to right.



Once unlocked, the remote screen will stay active for the programmed *Screen Timeout* minutes before going into sleep mode. See ["Screen Timeout" on page 129](#).

Front Button Screen Labels

	Repeat a Function
	Cancel or Exit a Function
	Access Help Information
	Silence Alarm
	Edit a Value
	Acknowledge or Accept

	Scroll Up / Increase a Value
	Scroll Down / Decrease a Value
	Next Screen
	Previous Screen
	Pump Settings
	Unlock Screen

Remote Back

The remote includes a bay on the back to store and charge a spare pump battery. This battery does not power the remote.



Contact your local authorities to determine the proper method for disposing of the durable components when they are no longer needed. These components have electronics that contain lead and Lithium Polymer batteries.

The *Pump Battery Status Light* on the bottom of the remote indicates the pump battery's charging status when in the bay.

Pump Battery Bay
(clear plastic cover not shown)



Pump Battery
Status Light

Charging Port



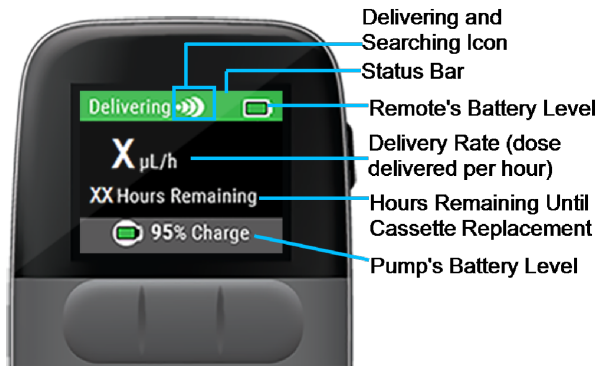

Color	Status
Green	Battery charging is complete
Amber	Battery is charging
Blinking Red	Charging Fault

Home Screen

The *Home Screen* displays details about your pump's medication delivery and any conditions you need to address, such as *Alarms or Attention Alarms*. See "*Alarms and Attention Alarms*" on page 147.



The color of the *Status Bar* indicates the remote's connection to the pump and the current delivery:

	Connected and Delivering
	Connected and NOT Delivering
	NOT Connected
	Alarm
	Attention Alarm

Pump Overview

The *Pump* connects to a *Cassette* and pumps medication under your skin at the delivery rate you set using the remote. The pump will continue to deliver medication even when it is not communicating with the remote.

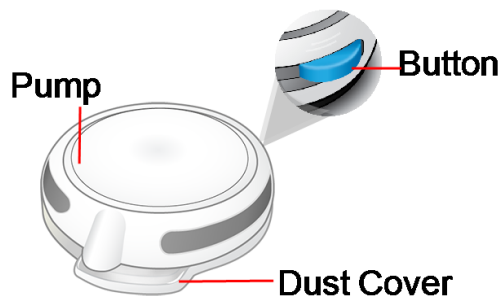

The pump's blue button can be pressed to start medication delivery, exit airplane mode, and place the pump in pairing mode.

The pump is powered by a rechargeable pump battery that is inserted into the battery bay located on the bottom of the pump. Every three days you must replace the pump battery with a fully charged pump battery.

If the pump has been subjected to the extremes of specified storage temperatures, before using the pump allow it to cool off/warm up for one hour.

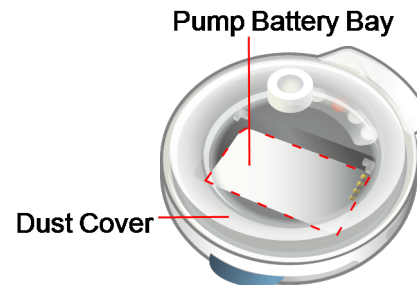

Pump with Cassette Attached

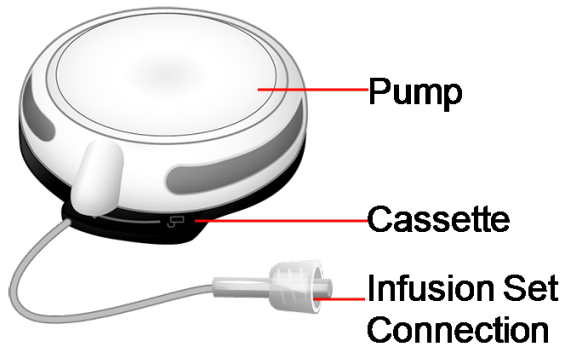

Remove the Clear Dust Cover

The pump is shipped with a *Clear Dust Cover* attached to protect the pump.

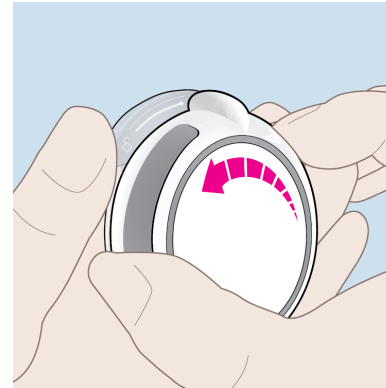

1. Remove the clear dust cover by holding the dust cover in one hand and rotating the pump counterclockwise with the other hand.
2. Separate the pump from the dust cover.

Attach the Clear Dust Cover

Whenever the pump is not being used, store the pump with the clear dust cover in place.

1. Align the *pump-bump* with the unlock symbol on the clear dust cover.
2. Holding the clear dust cover in one hand and the pump in the other, push and rotate to the lock symbol on the clear dust cover.

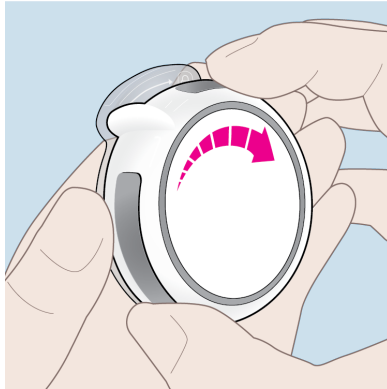

How to Wear Your Pump

Your *Pump* can be worn a few different ways:

- Attached to a belt with the included *Belt Clip* accessory
- Placed *in a pocket*

Make sure to secure the infusion set tubing to prevent it from catching on other objects.



Belt Clip



1. The pump slides into the *Belt Clip* with the blue button facing inward.

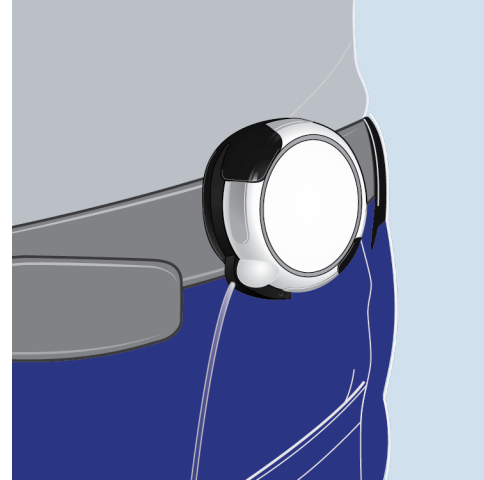

2. Slide the belt clip onto your belt or other location on your body that will firmly support the pump.

In Your Pocket

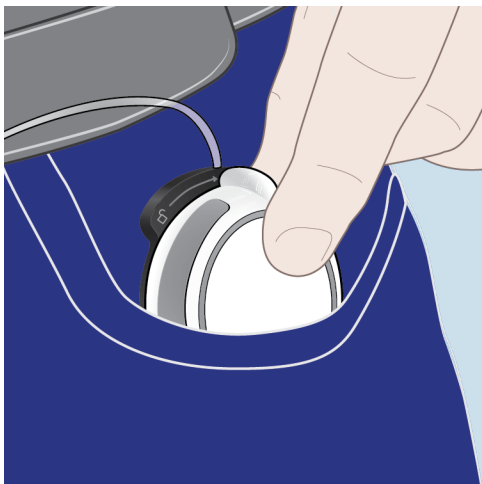

Insert the pump into your pocket making sure the infusion set tubing is not pinched.

Introduction

This page intentionally left blank.

Set Up

Contact your specialty pharmacy for assistance with any of the set up instructions.

Charge the Pump Batteries	46
Charge the Remote and One Pump Battery	48
Pair Remote and Pump for the First Time	52
Enter Delivery Rate	57

Charge the Pump Batteries

You must charge the *Pump Batteries* before you can use the pump. A fully charged pump battery can power the pump for 3 days (72 hours).

Each time you replace a cassette, you should also replace the pump battery with a fully charged battery.

You can charge up to two pump batteries using the battery charger, and one pump battery using the remote. See "[Charge the Remote and One Pump Battery](#)" on page 48.

The pump battery charger may be connected to any USB port for battery charging.

Charging the pump batteries using the dual USB AC Adapter will take about 6 hours. Charging the pump batteries using only the USB Cable (e.g., through a personal computer) may take more time.

If the pump batteries have been subjected to the extremes of the specified storage temperatures, before charging or using the batteries allow them to cool off / warm up for 20 minutes.

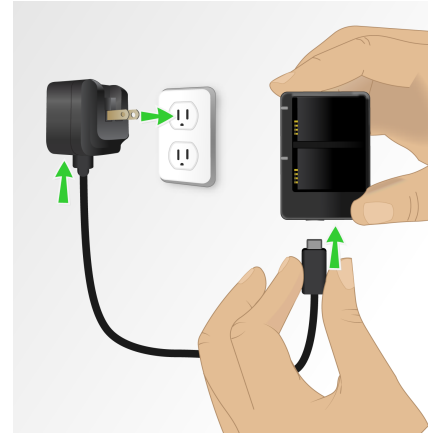

1. Plug in one of the USB cables into the battery charger and the other end of the USB cable into the dual USB wall adapter.
2. Then plug the dual USB wall adapter into an AC power outlet.



Avoid touching the electrical contacts on the battery charger when it is connected to a power source.

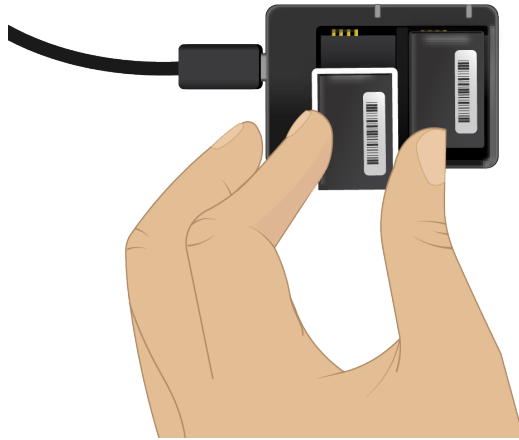

3. Insert two rechargeable batteries into the battery charger by aligning the contacts.

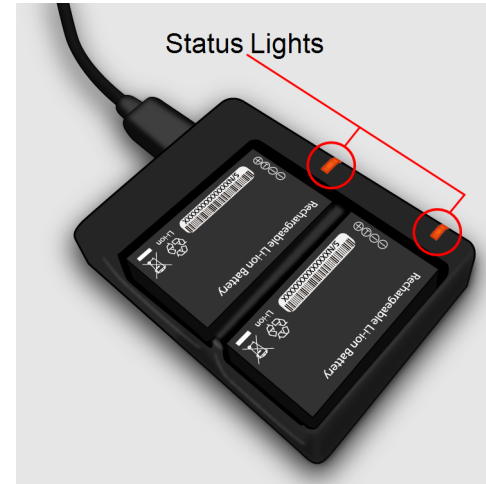

4. Amber battery charger status light(s) indicate the batteries are charging.

Color	Status
Green	Battery charging is complete
Amber	Battery is charging
Blinking Red	Charging Fault

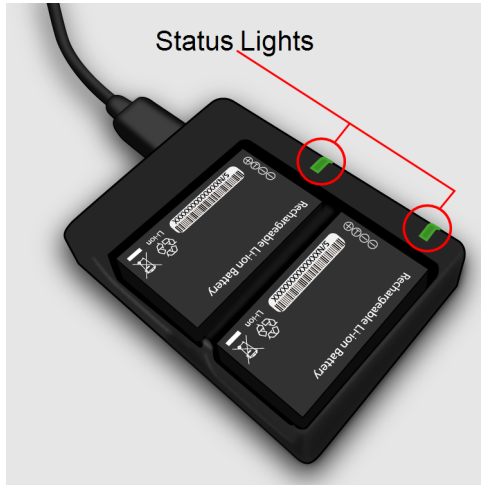

5. Wait until the pump batteries are fully charged before use.

A pump battery is fully charged when the battery charger status light(s) are green.

Charge the Remote and One Pump Battery

You should charge the remote before use. The remote and pump battery in the remote will typically fully charge in 6 hours or less when connected to the supplied dual USB AC adapter.

The charging time for the remote may be longer if connected to power sources other than the supplied dual USB wall adapter.

The remote will work for up to 1 day (24 hours) on a full charge. It is recommended to charge the remote daily. It is a good habit to charge the remote every evening.

The remote is charged by connecting it to the supplied dual USB AC adapter or any USB port. The remote can also be used to charge a pump battery as you are charging the remote.

You can use the remote while it is charging.



When the system is used in a loud environment the remote should be kept in a pant or shirt pocket so that the vibratory aspect of an alarm notification can be felt.

If the remote has been subjected to the extremes of the specified storage temperatures, before charging or using the remote, allow the device to cool off/warm up for one hour.

1. Plug the second USB cable into the bottom of the remote and the other end of the USB cable into the dual USB wall adapter.

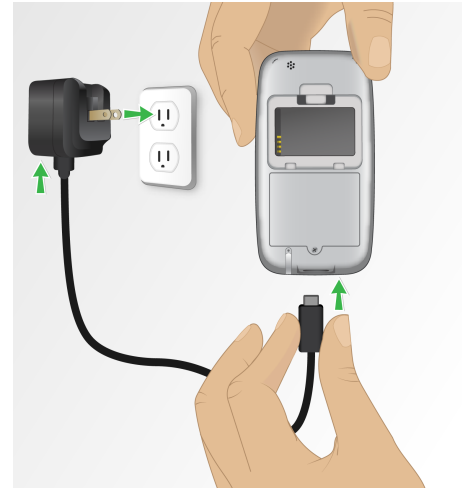

Avoid touching the electrical contacts on the battery charger when it is connected to a power source.

2. Remove the clear cover on the back of the remote by pushing down on the tab and pulling forward.

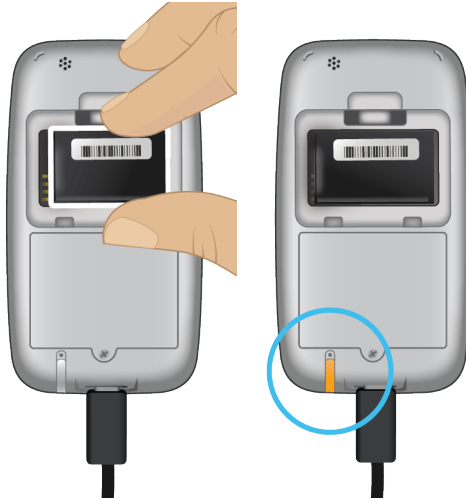

3. Insert a rechargeable pump battery into the back of the remote making sure to align the contacts.

While the remote is charging you are also charging the pump battery (indicated by the amber light on the back of the remote).

Color	Status
Green	Battery charging is complete
Amber	Battery is charging
Blinking Red	Charging Fault

4. Insert the clear cover into the back of the remote.



5. To check the remote's battery charge, press and hold the wake up button on the side of the remote.
6. Check the top right of the display screen for the charging symbol on top of the battery symbol, which indicates that the remote is charging.



7. When the battery symbol is full green on the remote screen, the remote is fully charged.

Pair Remote and Pump for the First Time

Pairing the remote with the pump enables the remote to control the pump settings, including the medication delivery rate.



Cell phones, Bluetooth devices, RFID readers, and Wi-Fi equipment may affect the communication between the Pump and Remote or interrupt operation of the Pump. Keep the Pump and Remote at least 0.8 m [3 ft] away from these items. [See Table 28 on page 223](#) and [See Table 30 on page 226](#) for more information.



1. **Press the side button** to wake up the remote.

The remote will search for a pump when you power on.



Press: **1** **2** **3**

2. Unlock the screen by pressing each front button from left to right to unlock the remote screen.



Once unlocked, the screen will stay active for 2 minutes before going into sleep mode.

The pump is shipped with a *Clear Dust Cover* attached to protect the pump.

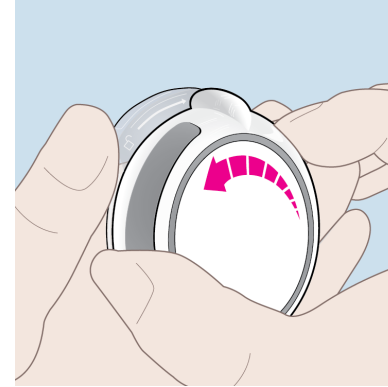

3. Remove the clear dust cover by holding the dust cover in one hand and rotating the pump counterclockwise with the other hand.
4. Lift the dust cover off and store it with your other Remunity supplies.

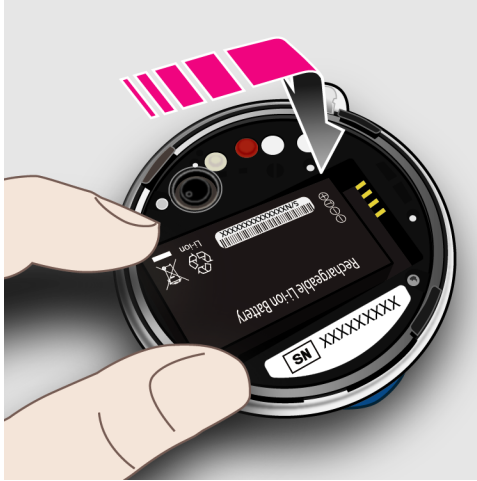

5. Insert a fully charged pump battery into the pump's battery bay.

The pump will be in pairing mode and sound a ready tone (one beep). If you hear a different tone, [See "Troubleshooting Pump" on page 189.](#)

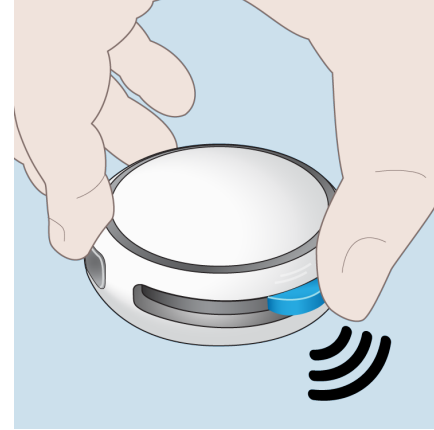

6. Locate your pump's serial number on the bottom of the pump.

7. Place the pump and remote within 2 in (50 mm) of each other during the pairing process.



8. If your pump's serial number does not show up on screen after a minute, **press and hold** the pump's **blue button** for **10 seconds** to activate pairing mode. Then, check the screen again for your pump serial number.



9. On the remote, use   to highlight the pump's serial number and press .





10. After selecting your pump serial number you will be prompted to confirm the selected pump. Press  to confirm.



A *Pairing To...* message displays.

If pairing fails, see "[Pairing Failed Attention Alarm](#)" on page 166



11. Upon successful pairing the *Paired Pump* message displays. Press .
12. If the remote is paired to an incorrect pump, press  and repeat the pairing instructions from [Step 6](#).

Enter Delivery Rate





Cell phones, Bluetooth devices, RFID readers, and Wi-Fi equipment may affect the communication between the Pump and Remote or interrupt operation of the Pump. Keep the Pump and Remote at least 0.8 m [3 ft] away from these items. [See Table 28 on page 223](#) and [See Table 30 on page 226](#) for more information.



Programming the incorrect delivery rate of medication can lead to errors in the dose rate of medication that can lead to harm. Programming should be performed with the direction from your healthcare provider.

1. The remote will prompt you to set a delivery rate (the amount of medication the pump will deliver per hour of use).



2. Use   to set your prescribed rate, then press .

- The remote displays a *Fill new cassette with X.X mL, prime, and install* message. However you will not need to follow the steps to fill the cassette with the amount displayed on the Remote for the Pharmacy-Filled cassettes.
- Wash your hands, gather cassette change supplies, and follow the cassette change steps starting from "*Prepare Priming Aid*" on [page 70](#).



Here are some important reminders to ensure continuous therapy after your first set up:

At least the following items should be kept on hand to facilitate a cassette or pump battery change:

- Non-expired cassette, in its unopened packaging.
- Fully charged pump battery.

When traveling at least the following spares should be kept on hand:

- Remote
- Pump
- Extra fully charged pump battery
- Extra non-expired cassettes, in their unopened packaging

Cassette Change

Cassette Change with Remote	60
Supplies Needed for Cassette Change with Remote	61
Stop Delivery with Remote	63
Disconnect Infusion Site	65
Disconnect Cassette from Pump and Dispose ..	66
Replace Pump Battery	68
Prepare Priming Aid	70
Connect and Prime Infusion Set	73
Stop Priming and Remove Priming Aid	75
Connect Cassette to Pump	78
Connect to Catheter	80
Start Delivery	81
Cassette Change Without Remote	82
Supplies Needed for Cassette Change without Remote	83
Stop Delivery Without the Remote	85

Disconnect Cassette from Pump and Dispose without Remote	85
Replace Pump Battery	87
Prepare Priming Aid	89
Connect and Prime Infusion Set	92
Stop Priming and Remove Priming Aid	94
Connect Cassette to Pump without Remote	97
Connect to Catheter	99
Start Delivery without Remote	99

Cassette Change with Remote

The *Cassette Change* is a step-by-step process for replacing the pump battery, the infusion set, and an empty cassette with a filled cassette.

Follow the step-by-step procedure in the order listed to ensure a safe and efficient replacement of the battery, infusion set, and cassette when the pump and remote are in communication.

Given the drug volume required to prime the pump, the pump's calculation of the time remaining prior to cassette change may be less than expected. Be sure to check the time that you will need to replace the cassette on the Remote so that you can prepare and have your supplies available when the change is needed.



1. Before you start, wash your hands with soap and water.



Supplies Needed for Cassette Change with Remote



The following supplies are needed to complete a *Cassette Change*.

Table 4: Components for Cassette Change

Remote with One Fully Charged Battery	Pump attached to the Used Cassette
	

Cassette Change

Table 5: Disposables for Cassette Change

Disposable Kit	Infusion Sets
	<p>Use only one of the following Infusion Sets</p> <ul style="list-style-type: none"> • Medtronic Quick-set Infusion Set (MMT-392, MMT-393) • Medtronic Silhouette Infusion Set (MMT-373) • Smiths Medical Cleo 90 Infusion Set (21-7230-24, 21-7220-24)  <div data-bbox="620 602 1597 720" style="border: 1px solid gray; padding: 10px; display: flex; align-items: center;">  <p>Always refer to your specific infusion set instructions.</p> </div>

Stop Delivery with Remote





Cell phones, Bluetooth devices, RFID readers, and Wi-Fi equipment may affect the communication between the Pump and Remote or interrupt operation of the Pump. Keep the Pump and Remote at least 0.8 m [3 ft] away from these items. [See Table 28 on page 223](#) and [See Table 30 on page 226](#) for more information.

1. **Press the side button** to wake up the remote.

Your delivery rate and the hours remaining on the cassette displays.



Press 1 2 3

2. Unlock   the screen by pressing each front button from left to right.

The *Main Menu* displays.



3. Press  to select **Change Cassette**.



- A Delivery must be stopped before changing the cassette message displays.*
4. Press  to stop medication delivery.
A Sending request to the pump message displays.