





5. Press  to silence the attention alarm.
6. Press  to acknowledge the *Pump delivery has stopped* Attention Alarm.

Disconnect Infusion Site

1. Disconnect the infusion set tubing from the catheter.

Refer to the instructions provided by your infusion set's manufacturer for guidance.

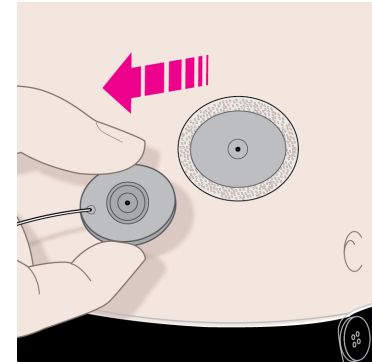

You should consult with your specialty pharmacy about how often to change the catheter.





Do not remove the pump from the used cassette until after you have disconnected the infusion set tubing from your body. Disconnecting the pump before you disconnect the infusion set tubing from your body could lead to unintended medication delivery.

Disconnect Cassette from Pump and Dispose

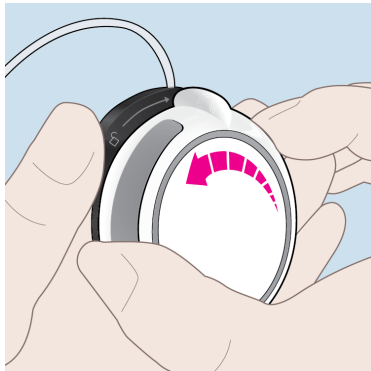

To avoid unintended medication delivery, disconnect from catheter before detaching the cassette from the pump.



1. Holding the cassette still, rotate the pump counterclockwise until the *pump-bump* is aligned with the *Unlock*  symbol.



2. You should hear a one beep tone coming from the pump.

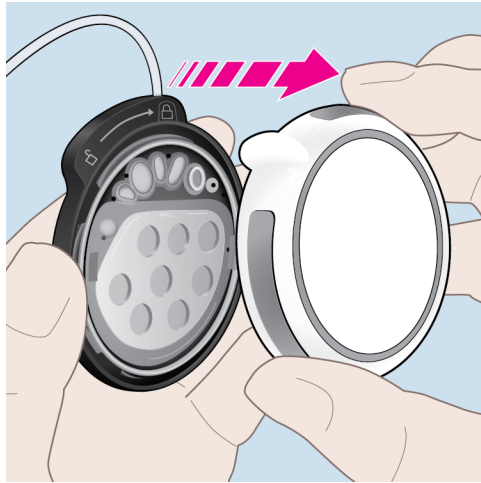

3. Separate the pump from the cassette.



Avoid unnecessary contact with all parts on the interior of the pump exposed during the cassette changing process.



Keep dirt, lubricants and liquids away from all parts on the interior of the pump exposed during the cassette changing process.

4. Dispose of the used cassette and infusion set tubing and catheter (if removed) in the trash.

Follow your infusion set's instructions:

- If you also plan to change your catheter and/or infusion site.
- For proper disposal of infusion set tubing and/or catheter.



Replace Pump Battery



Avoid unnecessary contact with all parts on the interior of the pump exposed during the battery changing process.



1. Turn the pump over and use the end of your finger to remove the battery from the pump.



2. Before removing the remote from the charging outlet, check that the charging light on the back of the remote is green. This indicates the battery in the bay is fully charged.

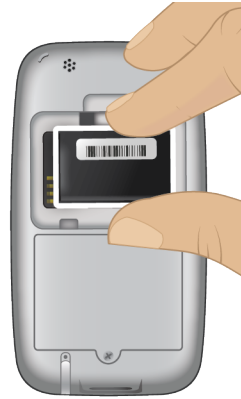

3. Open the clear cover and remove the fully charged battery from the battery bay.
Alternatively, you can obtain a fully charged battery from the battery charger.

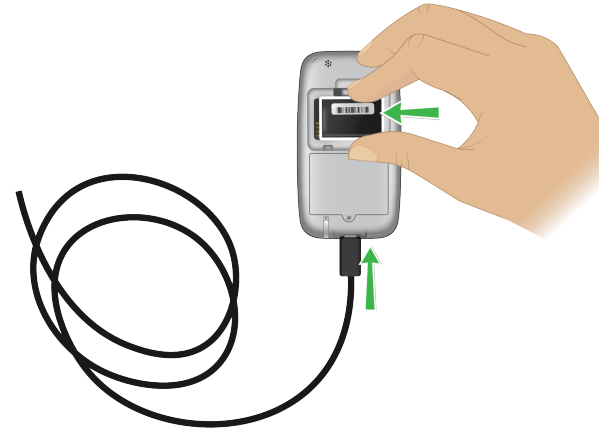

4. Insert the depleted pump battery into the back of the remote's battery bay.
At the end of the day, remember to charge the remote with the inserted battery.
Alternatively, you can insert the depleted pump battery into the battery charger to fully charge.

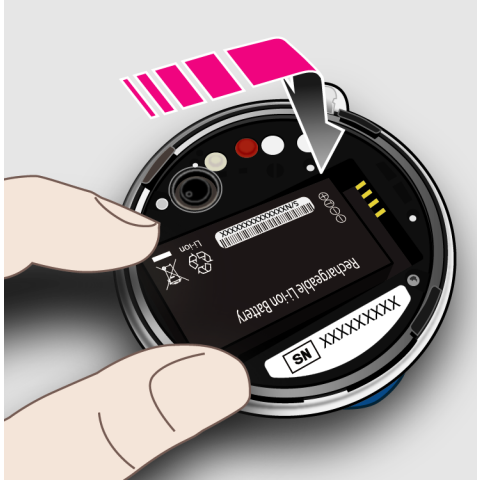

5. Insert the battery into the pump making sure the contacts are aligned.
6. The pump will sound a ready tone (one beep).

Keep dirt, lubricants and liquids away from all parts on the interior of the pump exposed during the battery changing process.

Prepare and Fill Cassette

You can use each cassette for up to three days. Replace the cassette when medication runs out or after three days.



Do not use previously opened, expired or damaged disposable components. Doing so may lead to infection.



Do not connect to infusion set catheter in the body until after a newly prepared cassette is attached to the pump. Connecting the cassette to the body before attaching the pump may lead to unintended delivery.

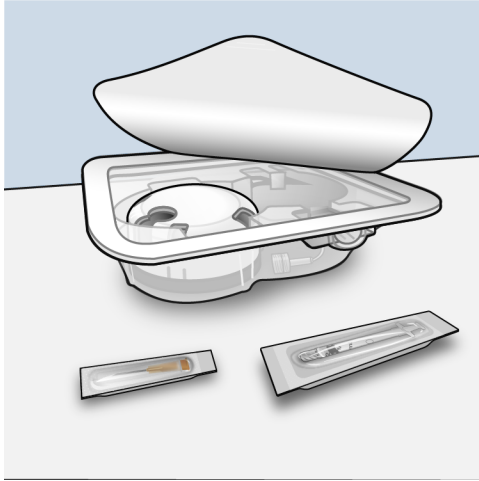

1. Open the disposable kit and remove the priming aid and empty cassette from the package and place the black side down on a flat surface.

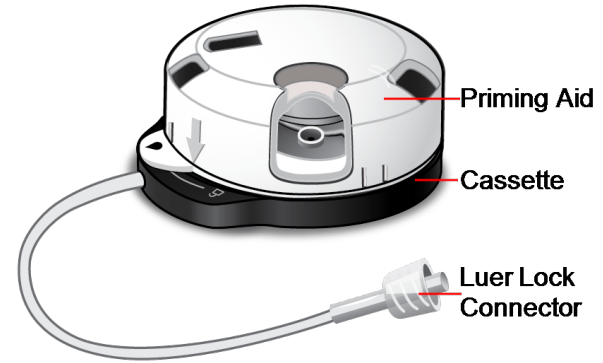

Note the important areas of the priming aid assembly.

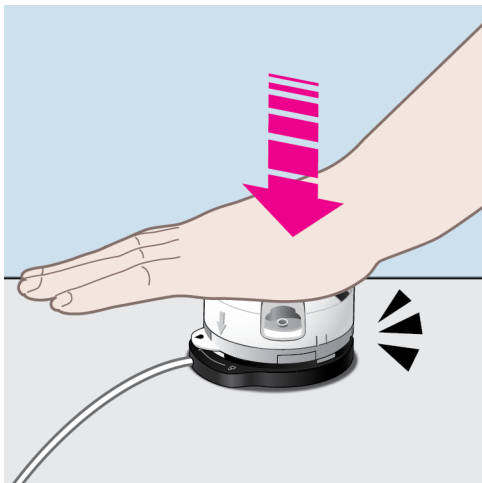

2. Firmly push down on the top of the priming aid with the palm of your hand until you hear a *click*.
3. Prepare your injection by removing the syringe and the needle from its packaging.

Only use the sterile, single-use, 3 mL syringe and needle to fill the cassette.

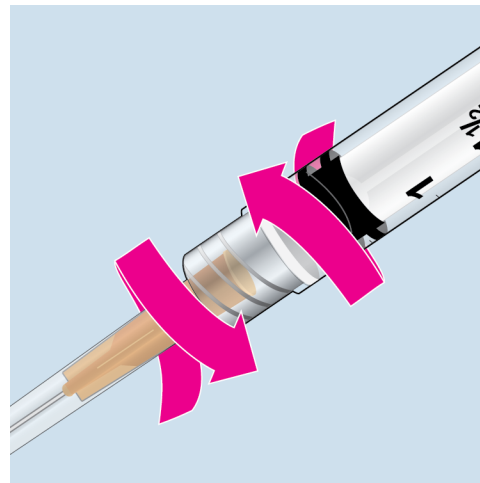

4. Insert the needle into the syringe *Luer Lock* and twist until finger tight.
5. Wipe the top of the Remodulin vial with an alcohol wipe.
6. Remove the cap from the needle.
7. Pull the syringe plunger out.
8. Insert the needle into the vial.

9. Push down on the syringe plunger to pressurize the vial.

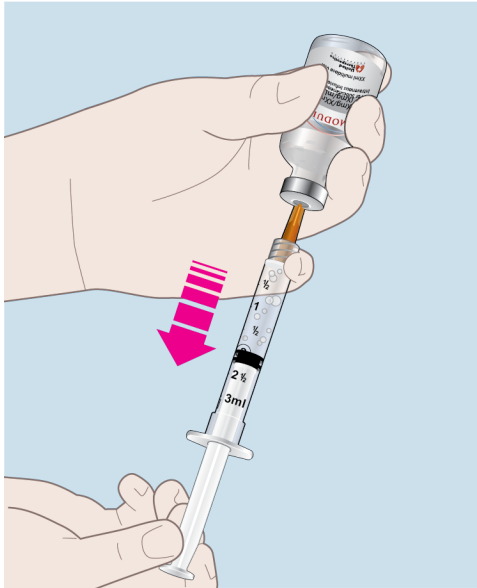

10. While still holding the syringe, flip the vial over so the vial is on top, slowly pull down on the plunger to fill the syringe.



11. Fill the syringe with the amount of Remodulin (mL) that is displayed on the remote.
12. With the needle facing up and held vertically, tap on the syringe to remove any air bubbles.
13. Remove the syringe from the vial.



Follow the Remodulin manufacturer's instructions for use and handling.

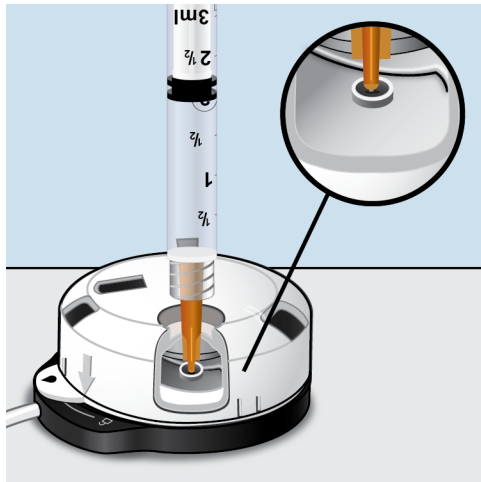

14. Insert the syringe into the hole in the priming aid and push down until you feel the needle insert into the cassette's rubber membrane.

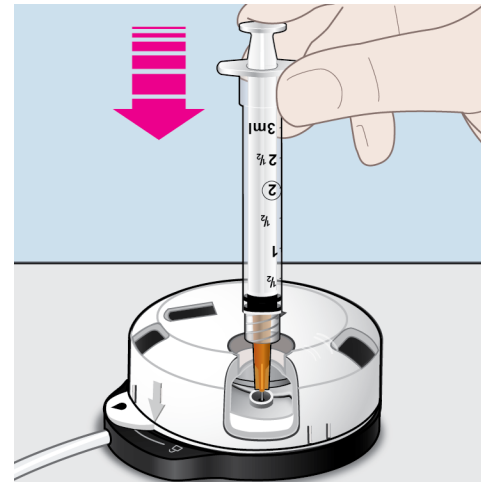

15. Push down on the syringe plunger to fill the cassette with Remodulin.
16. When the syringe is empty, continue to push down on the plunger while removing it from the priming aid.
17. Dispose of the used syringe and needle in a *Sharps* container.

Contact your local authorities to determine the proper method of disposing the syringe and needle. Improper disposal of these items may result in injury to the operator and others from exposure to sharp or contaminated components.



18. Wipe up any Remodulin medication residue with an absorbent towel or cloth and wash any areas that came in contact with Remodulin with soap and water.

Connect and Prime Infusion Set

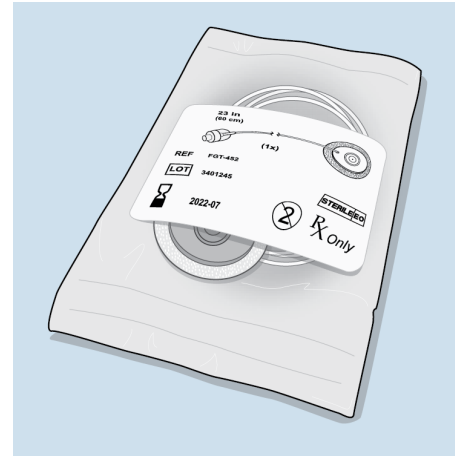

1. The infusion set tubing should be changed whenever you are performing a *Cassette Change*. Obtain a new infusion set package.

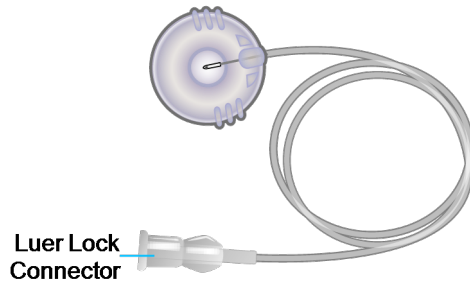

2. Open the infusion set package and remove the infusion set tubing.

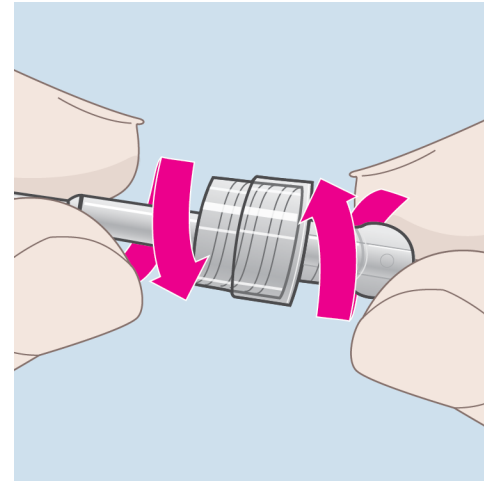

3. Connect the infusion set to the cassette by twisting the *Luer Lock* connectors together.



Do not insert the new infusion set catheter into your body until after you have prepared the new cassette and connected it to the pump. Inserting the infusion set catheter before connecting the cassette to the pump may lead to unintended delivery.



4. Holding the cassette still, rotate the priming aid clockwise until you hear a click and the arrow is aligned with the drop  symbol on the priming aid tab.

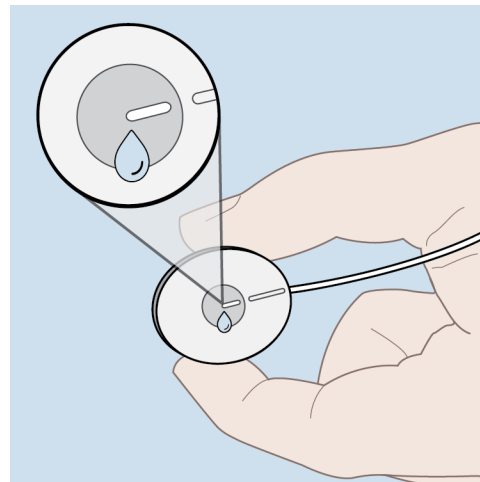

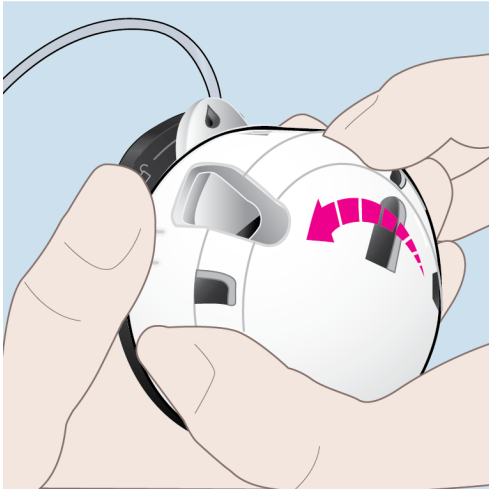

5. Watch for medication drops to appear at the end of the infusion set.
Seeing the medication drops indicates the infusion set and cassette are primed.

Stop Priming and Remove Priming Aid

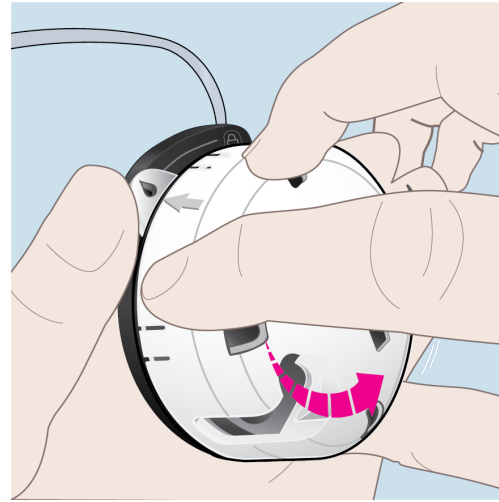

1. **As soon as you see the first drops** from the infusion set tubing, rotate the priming aid counterclockwise to end the priming.



2. Rotate counterclockwise until the tab on the priming aid becomes aligned with the *Unlock*  symbol on the cassette.



3. Detach the priming aid from the cassette.
4. Place the cassette down on your workspace.
5. Wipe up medication residue that may have settled on top of the cassette during the filling process with an absorbent towel or cloth.

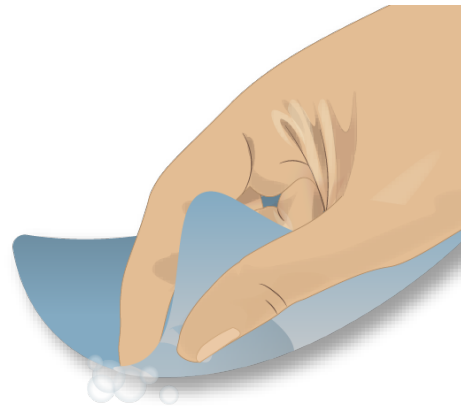

6. Wipe up any Remodulin medication residue with an absorbent towel or cloth and wash any areas that came in contact with Remodulin with soap and water.



7. Dispose of the priming aid in the trash.
DO NOT dispose of the newly filled cassette.

Connect Cassette to Pump



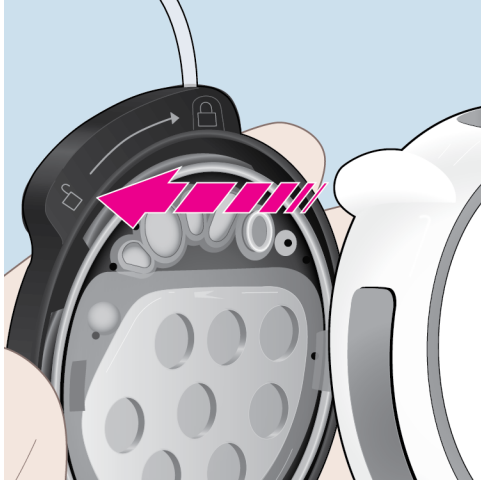

Do not connect the infusion set tubing to your catheter.

1. Before connecting the pump to the filled cassette, inspect the cassette and infusion set tubing for leaks.
If you see any leaks replace the cassette and infusion set tubing.
2. Wipe up any medication residue with an absorbent towel or cloth and wash contacted areas with soap and water.
3. Also check to ensure the interfaces of the pump and cassette are free of dust, lint and debris.

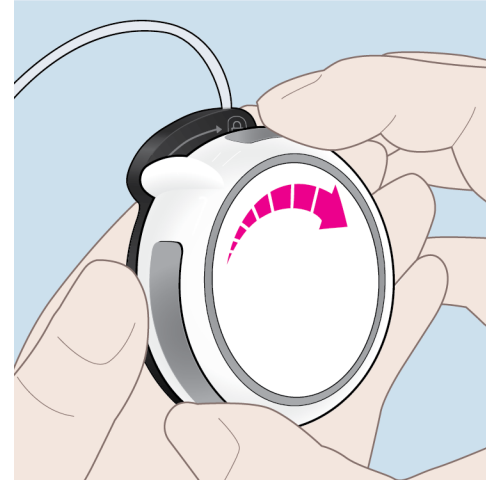

4. Connect the filled cassette to the pump by aligning the *pump-bump* with the *Unlock*  symbol on the cassette.



5. Push down and rotate the pump clockwise to the *Lock*  symbol.

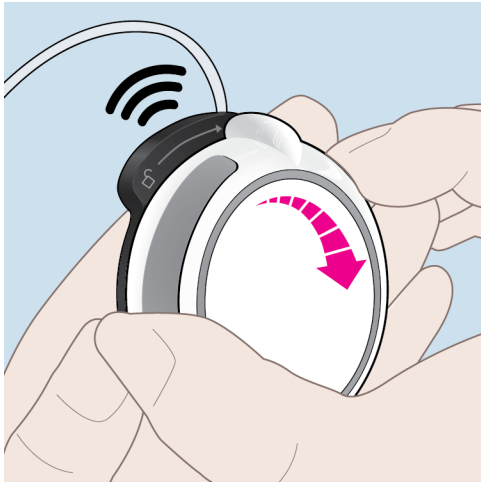

6. *Pump-bump* should align with the infusion set tubing.
7. You should hear a series of beeps coming from the pump followed by a final confirmation beep.



On the remote a *Self Test* displays.

8. Allow the *Self Test* on the remote to complete.



Do not connect the infusion set tubing to an inserted catheter before the pump completes the self tests. Doing so may cause an over delivery of medication resulting in harm.

Connect to Catheter

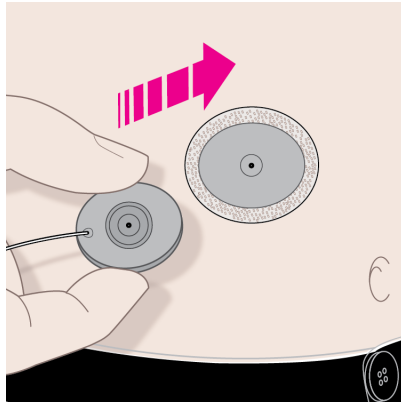

1. Connect the infusion set tubing from the pump to the catheter.
2. Consult with your specialty pharmacy about how often you should change the catheter. Refer to your infusion set's instructions for steps on how to insert the infusion set's catheter into your body.

Start Delivery



1. To start medication delivery, **press and hold the blue pump button**, or on your remote, press to start delivery.
2. The pump will make a *four-tone* sound and delivery will start.

Appendix B



3. Confirm that the remote displays a green header indicating that the pump is delivering.
4. Check to make sure the displayed rate matches your prescribed rate.

GLOSSARY

B

Battery Charger

A hardware device used to charge the rechargeable batteries.

C

Cassette

A hardware component of the Remunity™ system that holds the medication and attaches to the Pump.

Cassette Change

The process of changing the pump battery with a fully charged battery, the infusion set tubing

(sometimes the catheter), and an unfilled cassette with a filled cassette.

Catheter

A tubular medical device for insertion into canals, vessels, passageways, or body cavities for diagnostic or therapeutic purposes (as to permit injection or withdrawal of fluids or to keep a passage open)

D

Disposable Kit

The Disposable Kit consists of the Pharmacy-Filled Cassette attached to a Priming Aid.

E

Event

A historical entry saved within the remote. Examples of events are rate changes, cassette changes, alerts, alarms, and delivery start and stops.

I

Infusion Set

The device used to connect the Remunity™ pump to your body. A needle is housed inside a catheter, a tiny plastic tube that is placed under the skin in the subcutaneous fat.

L

Luer Lock

A screw connection on a syringe or infusion set tubing that creates a leak-free seal.

P

Prime

The process of filling the infusion set tubing with medication.

Priming Aid

A disposable hardware device used to aid in the filling and priming of the Cassette with medication.

Pump

The main hardware component that pumps the medication into your body and wirelessly connects to the remote.

Pump Battery

The battery for the Pump that can be recharged using the provided battery charger or the charging bay on the back of the remote and AC power.

Pump Bump

A protrusion on the perimeter of the pump.

Pump Dust Cover

A clear plastic cover that attaches to the bottom of the Pump to protect its internal components from dust, dirt and contamination when the cassette is not attached.

R

Remodulin

For the purposes of this User Guide, an infused medication used to treat pulmonary arterial hypertension.

Remote

The remote interface or GUI device used to wirelessly program the pump.

S

Subcutaneous

Situated or applied under the skin

T

Tubing

Specifically the cassette or infusion set tubing.

GLOSSARY

This page intentionally left blank.

INDEX

A

About 7

alarms 148

attention alarms 148

Accept 36

Access Help 36

Accessories 208

Acknowledge 36

Alarm 147

battery depleted 149

cassette depleted 150

cassette problem 153

cassette removed 151

occlusion 154

pump error 158

pump failure 159

Appendix 211, 237

Attention Alarm 147

adjust pump 160

basal not started 160

delivery stopped 161

depletes soon 162

excessive noise 162

low remote battery 170-171

message timeout 163

no communication 164

pairing failed 166

pairing lost 167

pump battery low 169

pump idle [168](#)

software version error [172](#)

tech [173](#)

walkaway [174](#)

B

Battery

charger [69, 88, 247](#)

Battery Bay [39](#)

Battery Charger

status lights [47](#)

C

Cancel [36](#)

Cassette [32](#)

connect to pump [78, 97, 258](#)

prepare and fill [248](#)

prepare priming aid [70, 89](#)

Cassette Change [59](#)

disconnect cassette from pump [66, 85, 244](#)

patient-filled [238](#)

supplies [61, 83, 239](#)

with remote [60](#)

without remote [82](#)

Cautions [26](#)

Change Rate [103](#)

Clear Dust Cover [40, 53](#)

Contraindications [11](#)

Conventions [11](#)

D

Delivery

start [81](#), [109](#), [261](#)

start without remote [99](#)

stop [63](#), [85](#), [107](#), [241](#)

Delivery Rate

enter [57](#)

Disposables [33](#)

Drop Icon [74](#), [93](#), [255](#)

E

Edit [36](#)

Emergency Contact Information [275](#)

Essential Performance [10](#)

F

FAQ [199](#)

Frequently Asked Questions [199](#)

G

GLOSSARY [263](#)

H

History [111](#)

event viewer [115](#)

previous 24 hours [114](#)

pump cassette info [113](#)
remote battery charging [112](#)
remote battery level [112](#)

Home Screen [38](#)

delivery rate [38](#)
hours remaining [38](#)
pump battery level [38](#)
remote battery level [38](#)
status bar [38](#)

I

Indications for Use [11](#)

Infusion Set

connect [73](#), [80](#), [92](#), [99](#), [253](#), [261](#)
disconnect [65](#), [243](#)

prime [73](#), [92](#), [253](#)

Infusion Sets [33](#)

Introduction [29](#)

L

Luer Lock [74](#), [93](#), [250](#), [254](#)

M

Main Menu [102](#)

Maintenance [175](#)

pump [176](#)

remote [177](#)

Menu

functions [101](#)

N

Next Screen [36](#)

P

Parts [208](#)

Power OFF [34](#)

Power ON [34](#)

Previous Screen [36](#)

Priming Aid [32](#)

 dispose [75, 94, 256](#)

 remove [75, 94, 256](#)

Pump [39](#)

 belt clip [42](#)

 blue button [39](#)

 clothing clip [43](#)

 dust cover attach [41](#)

 dust cover removal [40](#)

 how to wear [41](#)

 with cassette [40](#)

Pump Battery

 charging [46](#)

 replace [68, 87, 246](#)

 status light [37](#)

Pump Settings [36](#)

Pump Sounds [197](#)

R

Remote

back [37](#)

battery charging status lights [50](#)

charging [48](#)

front [35](#)

front button screen labels [36](#)

overview [34](#)

pairing [52](#)

pump battery charging [48](#)

Repeat [36](#)

Return [145](#)

Return to Previous Menu [102](#)

S

Scroll Down [36](#)

Scroll Up [36](#)

Service [207](#)

Set Up [45](#), [117](#)

airplane mode [137](#)

exit airplane mode [139](#)

factory reset [140](#)

pair to spare pump [118](#)

paired pump [117](#)

passcode [133](#)

remote audio [130](#)

screen timeout [129](#)

system information [144](#)

walkaway alert [127](#)
Silence Alarm [36](#)
Starter Kit [31](#)
Status Bar
 color indications [38](#)
Support [207](#)
Symbols [13](#)
Syringe
 disposal [252](#)
 fill [251](#)
System Overview [30](#)

T

Technical Specifications [212](#)
Technical Support [208](#)

Troubleshooting [175](#)
 battery charger [178](#)
 pump [189](#)
 remote [182](#)

U

Unlock [36](#)
USB AC Adapter [46](#)
USB cable [46](#)

W

Warnings [21](#)
 cassette change [25](#)
 component [21](#)

location of use [23](#)
medication delivery [26](#)
Wash Hands [60, 82, 238](#)

Emergency Contact Information

Remunity™ Pump for Remodulin® (treprostinil) Injection

Remunity System is for prescription use only.

Clinician:

Nurse Educator:

Specialty Pharmacy:



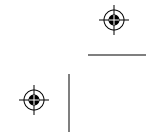
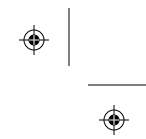

Distributed by:

United Therapeutics Corp.

RTP, NC 27709

1-877-864-8437