





5. Press  to silence the attention alarm.
6. Press  to acknowledge the *Pump delivery has stopped* Attention Alarm.

## Disconnect Infusion Site

1. Disconnect the infusion set tubing from the catheter.

Refer to the instructions provided by your infusion set's manufacturer for guidance.

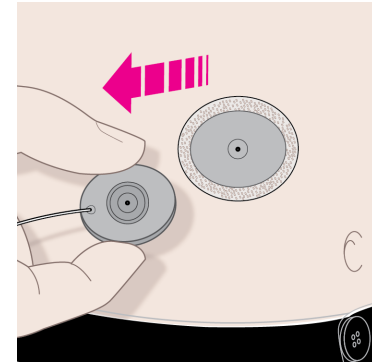

You should consult with your specialty pharmacy about how often to change the catheter.





Do not remove the pump from the used cassette until after you have disconnected the infusion set tubing from your body. Disconnecting the pump before you disconnect the infusion set tubing from your body could lead to unintended medication delivery.

## Disconnect Cassette from Pump and Dispose

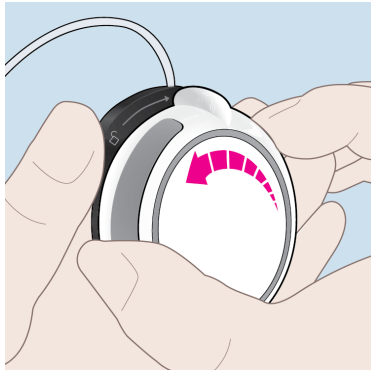

To avoid unintended medication delivery, disconnect from catheter before detaching the cassette from the pump.



1. Holding the cassette still, rotate the pump counterclockwise until the *pump-bump* is aligned with the *Unlock*  symbol.



2. You should hear a one beep tone coming from the pump.

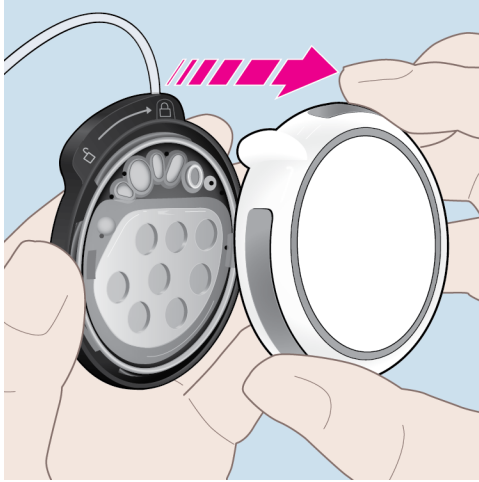

### 3. Separate the pump from the cassette.



Avoid unnecessary contact with all parts on the interior of the pump exposed during the cassette changing process.



Keep dirt, lubricants and liquids away from all parts on the interior of the pump exposed during the cassette changing process.

4. Dispose of the used cassette and infusion set tubing and catheter (if removed) in the trash.

Follow your infusion set's instructions:

- If you also plan to change your catheter and/or infusion site.
- For proper disposal of infusion set tubing and/or catheter.



## Replace Pump Battery



Avoid unnecessary contact with all parts on the interior of the pump exposed during the battery changing process.



1. Turn the pump over and use the end of your finger to remove the battery from the pump.



2. Before removing the remote from the charging outlet, check that the charging light on the back of the remote is green. This indicates the battery in the bay is fully charged.

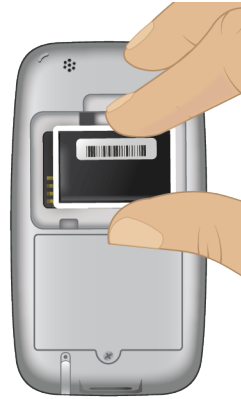

3. Open the clear cover and remove the fully charged battery from the battery bay.  
Alternatively, you can obtain a fully charged battery from the battery charger.

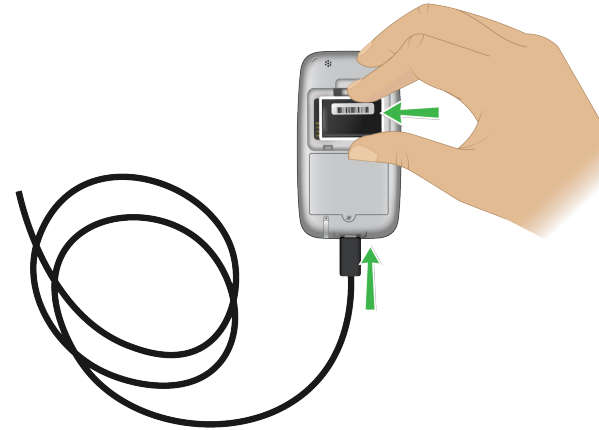

4. Insert the depleted pump battery into the back of the remote's battery bay.  
At the end of the day, remember to charge the remote with the inserted battery.  
Alternatively, you can insert the depleted pump battery into the battery charger to fully charge.



5. Insert the battery into the pump making sure the contacts are aligned.
6. The pump will sound a ready tone (one beep).

Keep dirt, lubricants and liquids away from all parts on the interior of the pump exposed during the battery changing process.

## Prepare Priming Aid

You can use each pharmacy-filled cassette for up to three days. Replace the cassette when medication runs out or after three days.



Do not use previously opened, expired or damaged disposable components. Doing so may lead to infection.



Do not connect to infusion set catheter in the body until after a newly prepared cassette is attached to the pump. Connecting the cassette to the body before attaching the pump may lead to unintended delivery.



1. You will not need to follow the steps to fill the cassette with the amount displayed on the Remote for the Pharmacy-Filled cassettes.
2. Open the pharmacy-filled cassette package and remove the plastic clamshell.
3. Open the plastic packaging, remove the priming aid with pharmacy-filled cassette, and place the black side down on a flat surface.

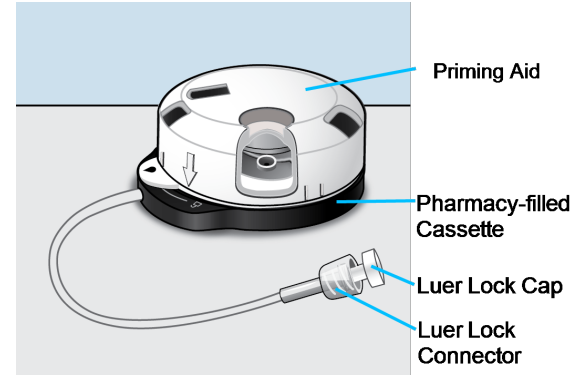

Note the important areas of the priming aid and pharmacy-filled cassette assembly.

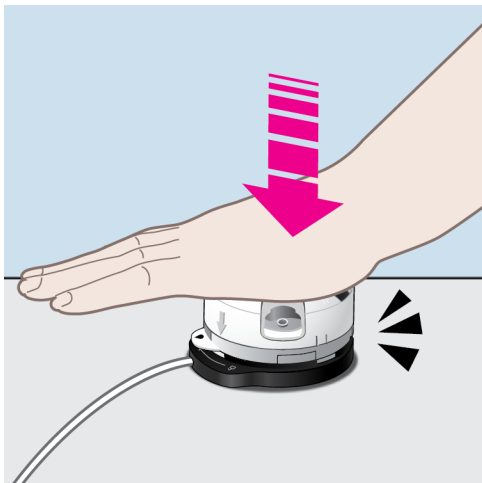

4. Press down on the top of the priming aid until you hear a *click*.

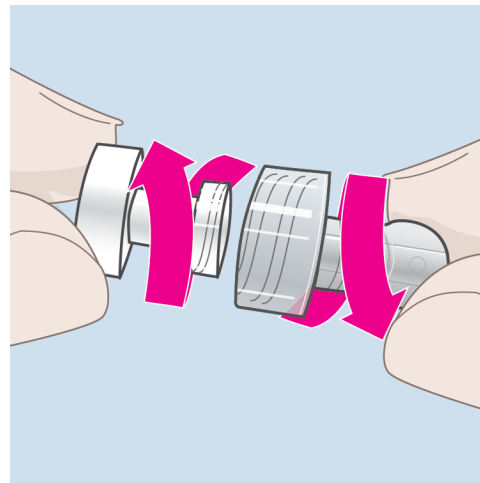

5. Remove the cap from the Luer Lock connector.



## Connect and Prime Infusion Set



1. The infusion set tubing should be changed whenever you are performing a *Cassette Change*. Obtain a new infusion set package.

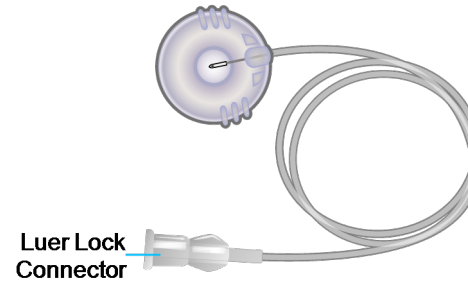

2. Open the infusion set package and remove the infusion set tubing.

Cassette Change

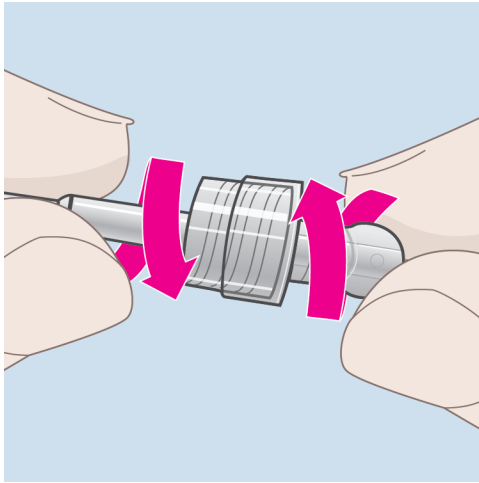

3. Connect the infusion set to the cassette by twisting the *Luer Lock* connectors together.



Do not insert the new infusion set catheter into your body until after you have prepared the new cassette and connected it to the pump. Inserting the infusion set catheter before connecting the cassette to the pump may lead to unintended delivery.



4. Holding the cassette still, rotate the priming aid clockwise until you hear a click and the arrow is aligned with the drop  symbol on the priming aid tab.

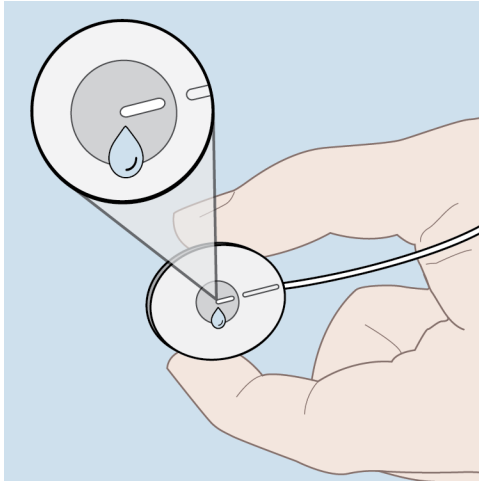

5. Watch for medication drops to appear at the end of the infusion set.

Seeing the medication drops indicates the infusion set and cassette are primed.

## Stop Priming and Remove Priming Aid

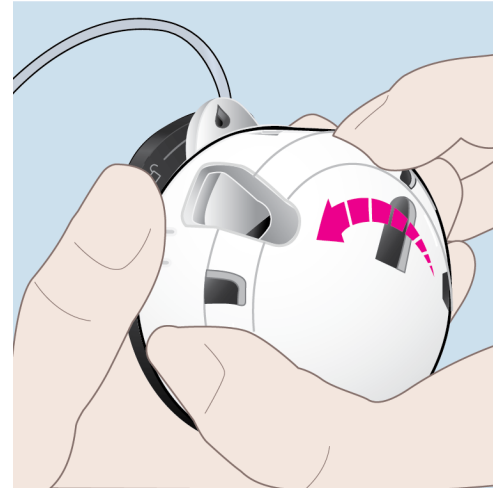

1. **As soon as you see the first drops** from the infusion set tubing, rotate the priming aid counterclockwise to end the priming.

## Cassette Change

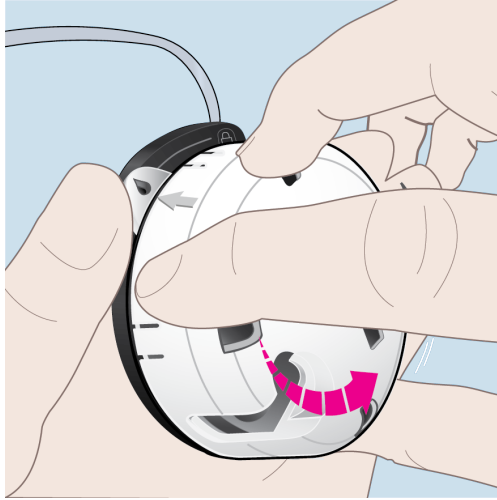

2. Rotate counterclockwise until the tab on the priming aid becomes aligned with the *Unlock*  symbol on the cassette.

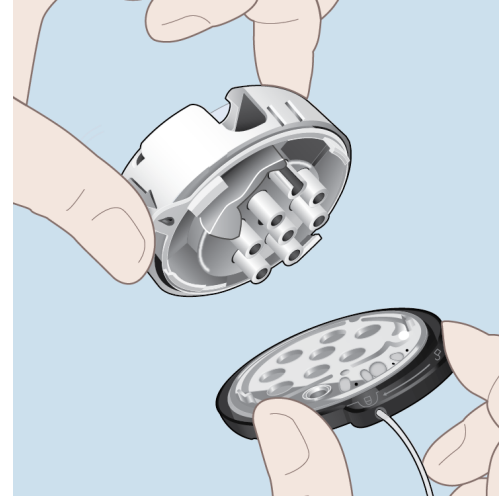

3. Detach the priming aid from the cassette.
4. Place the cassette down on your workspace.
5. Wipe up medication residue that may have settled on top of the cassette during the filling process with an absorbent towel or cloth.



6. Wipe up any Remodulin medication residue with an absorbent towel or cloth and wash any areas that came in contact with Remodulin with soap and water.



7. Dispose of the priming aid in the trash.  
**DO NOT** dispose of the newly filled cassette.

## Connect Cassette to Pump



Do not connect the infusion set tubing to your catheter.

1. Before connecting the pump to the filled cassette, inspect the cassette and infusion set tubing for leaks.

If you see any leaks replace the cassette and infusion set tubing.

2. Wipe up any medication residue with an absorbent towel or cloth and wash contacted areas with soap and water.
3. Also check to ensure the interfaces of the pump and cassette are free of dust, lint and debris.



4. Connect the filled cassette to the pump by aligning the *pump-bump* with the *Unlock*  symbol on the cassette.

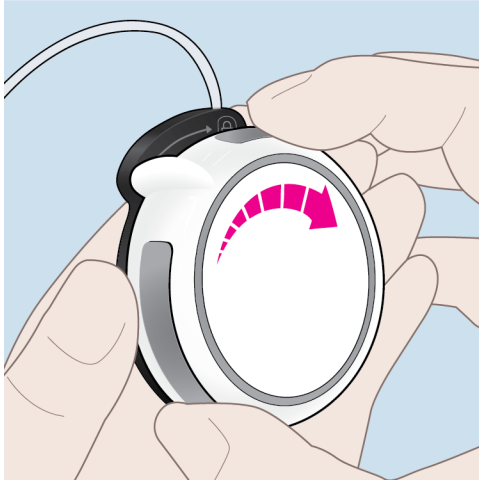

5. Push down and rotate the pump clockwise to the *Lock*  symbol.

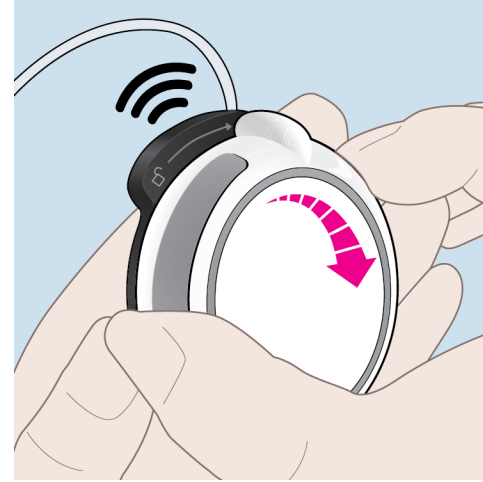

6. *Pump-bump* should align with the infusion set tubing.
7. You should hear a series of beeps coming from the pump followed by a final confirmation beep.



On the remote a *Self Test* displays.

8. Allow the *Self Test* on the remote to complete.



Do not connect the infusion set tubing to an inserted catheter before the pump completes the self tests. Doing so may cause an over delivery of medication resulting in harm.

## Connect to Catheter

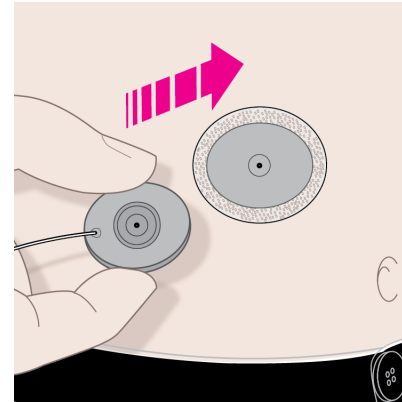

1. Connect the infusion set tubing from the pump to the catheter.
2. Consult with your specialty pharmacy about how often you should change the catheter. Refer to your infusion set's instructions for steps on how to insert the infusion set's catheter into your body.



## Start Delivery



1. To start medication delivery, **press and hold the blue pump button**, or on your remote, press  to start delivery.
2. The pump will make a *four-tone* sound and delivery will start.



3. Confirm that the remote displays a green header indicating that the pump is delivering.
4. Check to make sure the displayed rate matches your prescribed rate.

Cassette Change

## Cassette Change Without Remote

The *Cassette Change* is a step-by-step process for replacing the pump battery, the infusion set, and an empty cassette with a filled cassette.

Follow the step-by-step procedure in the order listed to ensure a safe and efficient replacement of the battery, infusion set, and cassette when the pump and remote are not in communication or the remote is *OFF*.

Given the drug volume required to prime the pump, the pump's calculation of the time remaining prior to cassette change may be less than expected. Be sure to check the time that you will need to replace the cassette on the Remote so that you can prepare and have your supplies available when the change is needed.



1. Before you start, wash your hands with soap and water.



# Supplies Needed for Cassette Change without Remote



The following supplies are needed to complete a *Cassette Change* without your remote.

Table 6: Components for Cassette Change

Battery Charger and One Fully Charged Battery	Pump attached to the Used Cassette
	

Cassette Change

Table 7: Disposables for Cassette Change

Disposable Kit	Infusion Sets
	<p>Use only one of the following Infusion Sets</p> <ul style="list-style-type: none"> <li>• Medtronic Quick-set Infusion Set (MMT-392, MMT-393)</li> <li>• Medtronic Silhouette Infusion Set (MMT-373)</li> <li>• Smiths Medical Cleo 90 Infusion Set (21-7230-24, 21-7220-24)</li> </ul>  <div data-bbox="618 598 782 762">  </div> <p data-bbox="791 598 1592 762">Always refer to your specific infusion set instructions.</p>

## Stop Delivery Without the Remote

1. Disconnect the infusion set tubing from the catheter.

Refer to the instructions provided by your infusion set's manufacturer for guidance.

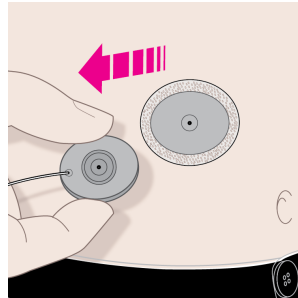

You should consult with your specialty pharmacy about how often to change the catheter.



Do not remove the pump from the used cassette until after you have disconnected the infusion set tubing from your body. Disconnecting the pump before you disconnect the infusion set tubing from your body could lead to unintended medication delivery.

## Disconnect Cassette from Pump and Dispose without Remote



To avoid unintended medication delivery, disconnect from catheter before detaching the cassette from the pump.

1. Holding the cassette still, rotate the pump counterclockwise until the *pump-bump* is aligned with the *Unlock*  symbol.

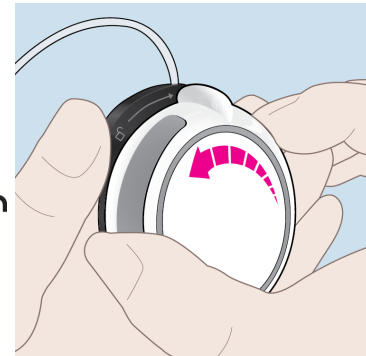

## Cassette Change

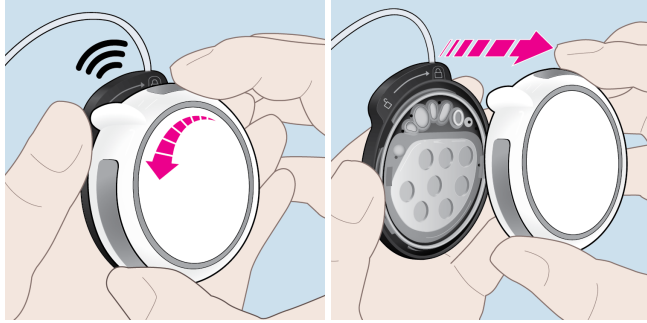

2. You should hear the alarm tone coming from the pump.
3. Separate the pump from the cassette.



Avoid unnecessary contact with all parts on the interior of the pump exposed during the cassette changing process.



Keep dirt, lubricants and liquids away from all parts on the interior of the pump exposed during the cassette changing process.



4. Dispose of the used cassette and infusion set tubing and catheter (if removed) in the trash.

Follow your infusion set's instructions:

- If you also plan to change your catheter and/or infusion site.
- For proper disposal of infusion set tubing and/or catheter.

## Replace Pump Battery



Avoid unnecessary contact with all parts on the interior of the pump exposed during the battery changing process.



1. Turn the pump over and use the end of your finger to remove the battery from the pump.



2. Before removing the remote from the charging outlet, check that the charging light on the back of the remote is green. This indicates the battery in the bay is fully charged.

## Cassette Change

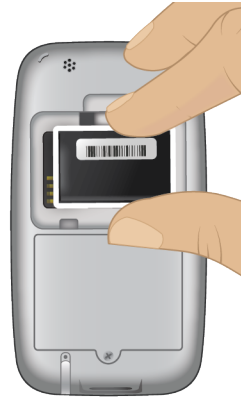

3. Open the clear cover and remove the fully charged battery from the battery bay.

Alternatively, you can obtain a fully charged battery from the battery charger.

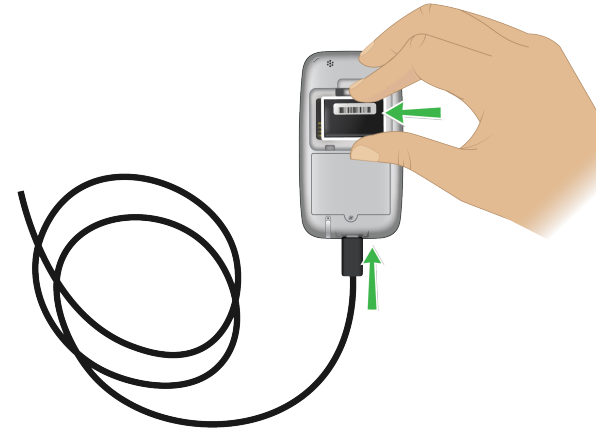

4. Insert the depleted pump battery into the back of the remote's battery bay.

At the end of the day, remember to charge the remote with the inserted battery.

Alternatively, you can insert the depleted pump battery into the battery charger to fully charge.



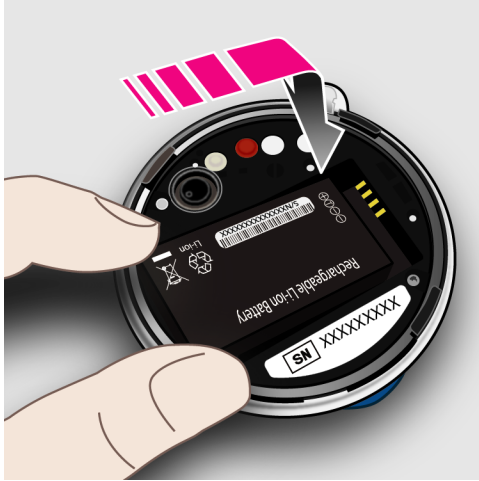

5. Insert the battery into the pump making sure the contacts are aligned.
6. The pump will sound a ready tone (one beep).

Keep dirt, lubricants and liquids away from all parts on the interior of the pump exposed during the battery changing process.

## Prepare Priming Aid

You can use each pharmacy-filled cassette for up to three days. Replace the cassette when medication runs out or after three days.



Do not use previously opened, expired or damaged disposable components. Doing so may lead to infection.



Do not connect to infusion set catheter in the body until after a newly prepared cassette is attached to the pump. Connecting the cassette to the body before attaching the pump may lead to unintended delivery.



1. You will not need to follow the steps to fill the cassette with the amount displayed on the Remote for the Pharmacy-Filled cassettes.
2. Open the pharmacy-filled cassette package and remove the plastic clamshell.
3. Open the plastic packaging, remove the priming aid with pharmacy-filled cassette, and place the black side down on a flat surface.

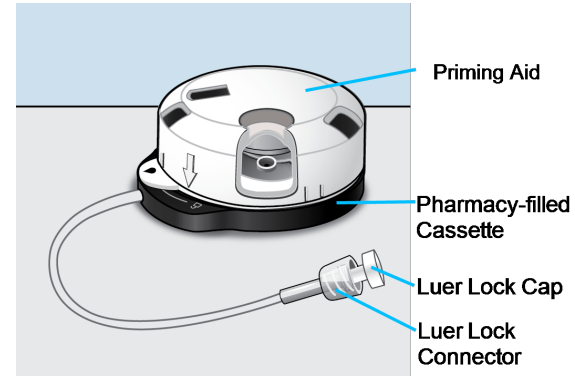

Note the important areas of the priming aid and pharmacy-filled cassette assembly.

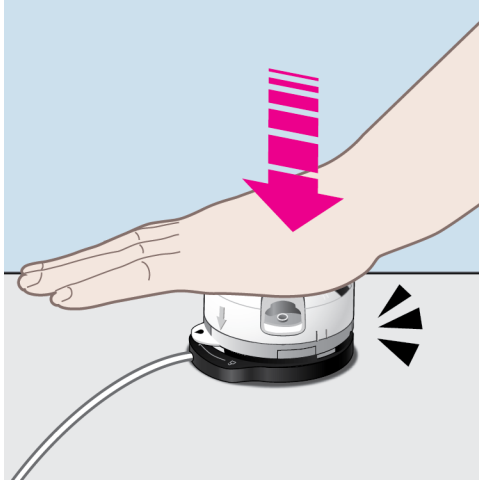

4. Press down on the top of the priming aid until you hear a *click*.

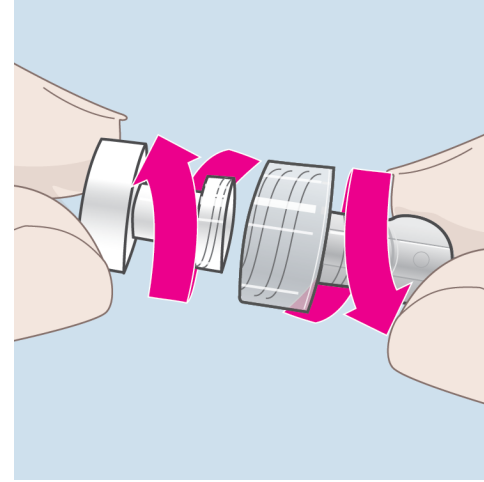

5. Remove the cap from the Luer Lock connector.

## Connect and Prime Infusion Set



1. The infusion set tubing should be changed whenever you are performing a *Cassette Change*. Obtain a new infusion set package.

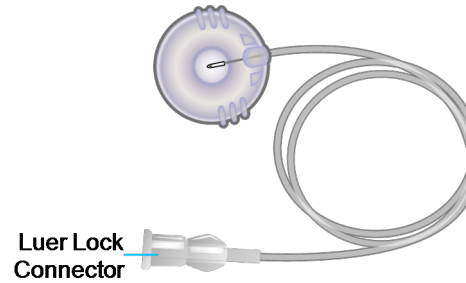

2. Open the infusion set package and remove the infusion set tubing.

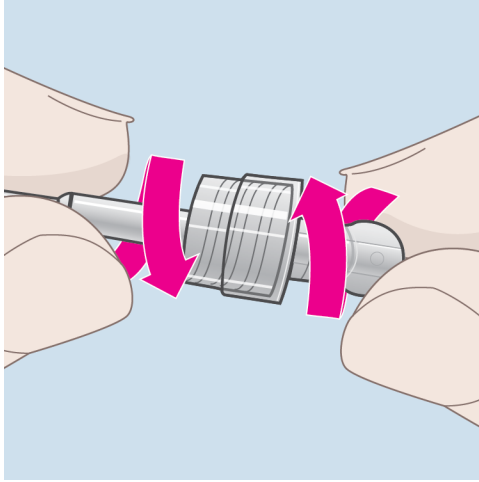

3. Connect the infusion set to the cassette by twisting the *Luer Lock* connectors together.



Do not insert the new infusion set catheter into your body until after you have prepared the new cassette and connected it to the pump. Inserting the infusion set catheter before connecting the cassette to the pump may lead to unintended delivery.

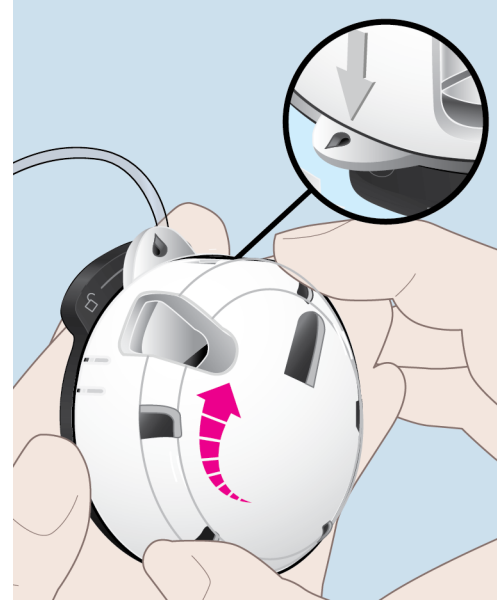

4. Holding the cassette still, rotate the priming aid clockwise until you hear a click and the arrow is aligned with the drop  symbol on the priming aid tab.

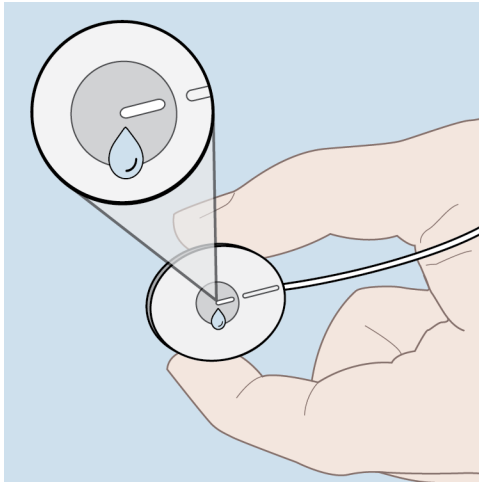

5. Watch for medication drops to appear at the end of the infusion set.

Seeing the medication drops indicates the infusion set and cassette are primed.

## Stop Priming and Remove Priming Aid

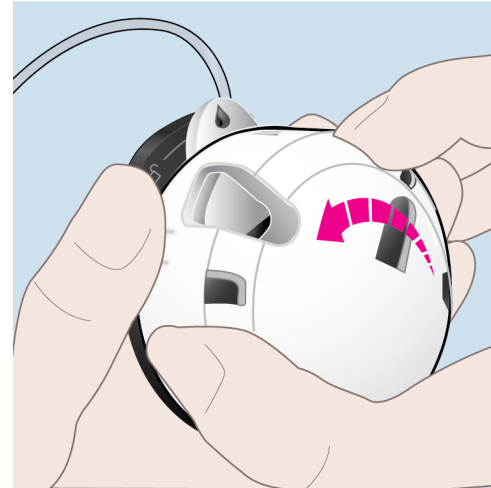

1. **As soon as you see the first drops** from the infusion set tubing, rotate the priming aid counterclockwise to end the priming.

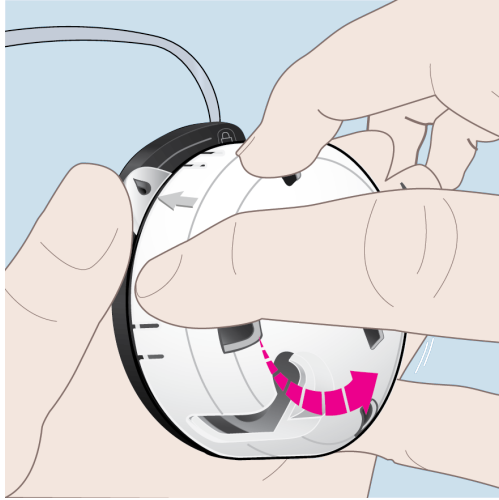

2. Rotate counterclockwise until the tab on the priming aid becomes aligned with the *Unlock*  symbol on the cassette.

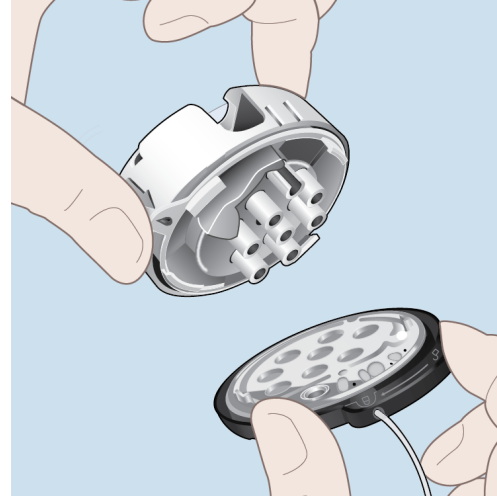

3. Detach the priming aid from the cassette.
4. Place the cassette down on your workspace.
5. Wipe up medication residue that may have settled on top of the cassette during the filling process with an absorbent towel or cloth.

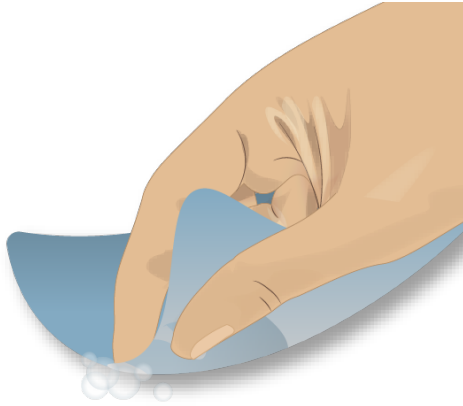

6. Wipe up any Remodulin medication residue with an absorbent towel or cloth and wash any areas that came in contact with Remodulin with soap and water.



7. Dispose of the priming aid in the trash.  
DO NOT dispose of the newly filled cassette.



## Connect Cassette to Pump without Remote





Do not connect the infusion set tubing to your catheter.

1. Before connecting the pump to the filled cassette, inspect the cassette and infusion set tubing for leaks.

If you see any leaks replace the cassette and infusion set tubing.

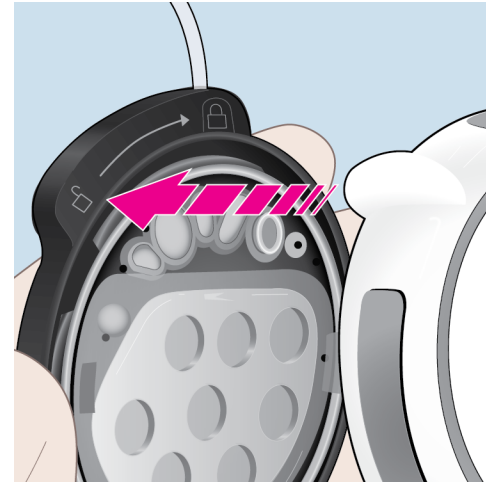
2. Wipe up any medication residue with an absorbent towel or cloth and wash contacted areas with soap and water.
3. Also check to ensure the interfaces of the pump and cassette are free of dust, lint and debris.



4. Connect the filled cassette to the pump by aligning the *pump-bump* with the *Unlock*  symbol on the cassette.

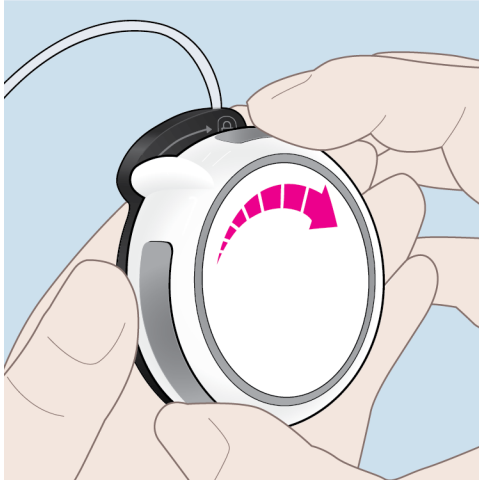

5. Push down and rotate the pump clockwise to the *Lock*  symbol.

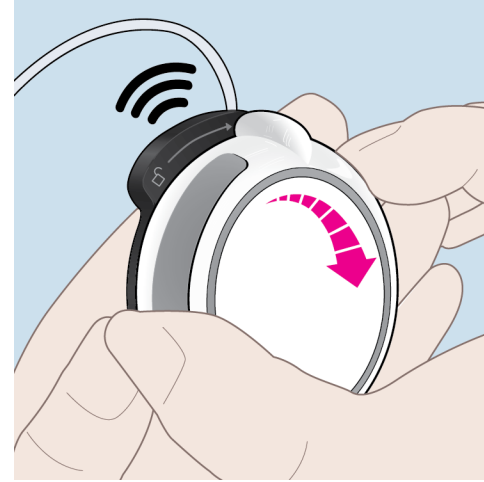

6. *Pump-bump* should align with the infusion set tubing.
7. You should hear a series of beeps coming from the pump followed by a final confirmation beep. When the beeps stop, the pump and cassette are ready.

## Connect to Catheter

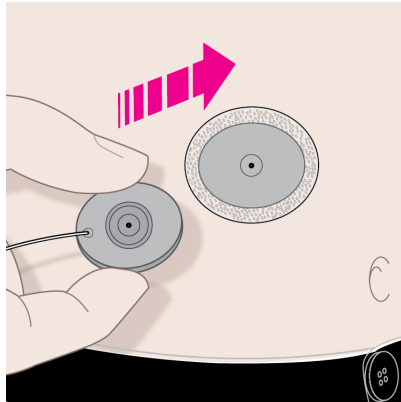

1. Connect the infusion set tubing from the pump to the catheter.
2. Consult with your specialty pharmacy about how often you should change the catheter. Refer to your infusion set's instructions for steps on how to insert the infusion set's catheter into your body.

## Start Delivery without Remote

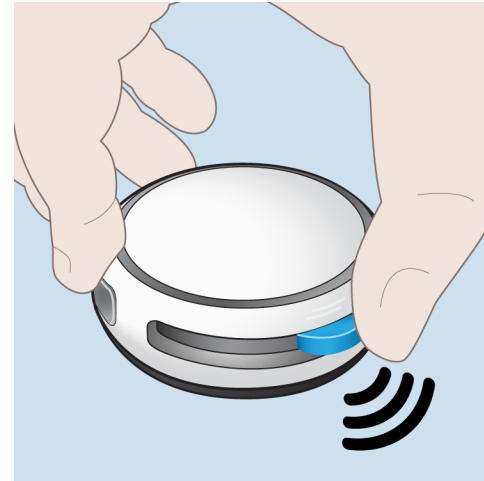

1. To start medication delivery, **press and hold the blue pump button.**
2. The pump will make a *four-tone* sound and delivery will start.

**Cassette Change**

This page intentionally left blank.

# Menu Functions

Contact your specialty pharmacy for assistance with any of the menu function instructions.

---



<b>Main Menu</b> .....	<b>102</b>
Return to Previous Menu .....	102
<b>Change Rate</b> .....	<b>103</b>
<b>Stop Delivery</b> .....	<b>107</b>
<b>Start Delivery</b> .....	<b>109</b>
<b>History Menu</b> .....	<b>111</b>
Remote Battery .....	112
Pump Cassette Info .....	113
Previous 24 Hours .....	114
Event Viewer .....	115
<b>Setup</b> .....	<b>117</b>
Paired Pump .....	117
Pair to a Spare Pump .....	118
Pair to a Spare Remote .....	123
Walkaway Attention Alarm .....	127

---

Screen Timeout .....	129
Remote Audio .....	130
Change Rate Passcode .....	133
Airplane Mode .....	137
Factory Reset .....	140
Remote Factory Reset .....	140
Pump Factory Reset .....	141
System Information .....	144
Return .....	145

## Main Menu

The *Main Menu* provides access to the following features:

- Change Cassette
  - Change Rate
  - Stop/Start Delivery
  - History
  - Setup
1. **Press the side button** to display the remote's *Main Menu*.
  2. Use the up and down arrows   to scroll through the list.
  3. Press  to select the highlighted function.



## Return to Previous Menu

During any navigation through the menu functions you can press the **Side Button** to return back to the previous menu screen.

Within any of the menus you can scroll down to **Return** and press .

## Change Rate



Cell phones, Bluetooth devices, RFID readers, and Wi-Fi equipment may affect the communication between the Pump and Remote or interrupt operation of the Pump. Keep the Pump and Remote at least 0.8 m [3 ft] away from these items. [See Table 28 on page 223](#) and [See Table 30 on page 226](#) for more information.

Use the remote to set or adjust the pump's delivery rate to match your prescribed dosage.

The pump can deliver medication at rates from 16  $\mu\text{L}$  (0.016 mL) to 225  $\mu\text{L}$  (0.225 mL) per hour, in 1  $\mu\text{L}$  (0.001 mL) increments.



1. **Press the Side Button** to wake up the remote.

Your delivery rate and the hours remaining on the cassette display.



Press 1 2 3

2. Unlock  >> the screen by pressing each front button from left to right.

The *Main Menu* displays.



3. Use the down arrow  to highlight **Change Rate**, then press .



The delivery rate is the amount of medication the pump will deliver per hour of use.







Programming the incorrect delivery rate of medication can lead to errors in the dose rate of medication that can lead to harm. Programming should be performed with the direction from your Healthcare Provider.



4. Use the up and down arrows   to change your prescribed rate.
5. Press  to continue.



6. If the delivery rate is incorrect, press  to edit it or press  to cancel the rate change.
7. Press  to confirm the new rate.



After confirming the new delivery rate, the remote will display a *Sending request to the Pump...* message and you will hear a four-tone delivering sound coming from the pump.



The remote's home screen will appear displaying the new delivery rate.

## Stop Delivery



Cell phones, Bluetooth devices, RFID readers, and Wi-Fi equipment may affect the communication between the Pump and Remote or interrupt operation of the Pump. Keep the Pump and Remote at least 0.8 m [3 ft] away from these items. [See Table 28 on page 223](#) and [See Table 30 on page 226](#) for more information.



1. **Press the Side Button** to wake up the remote.