

AGE 14+

Boley

FT009 HIGH SPEED RACING BOAT

ATTENTION:
Please read all warnings and instructions carefully before using this product.

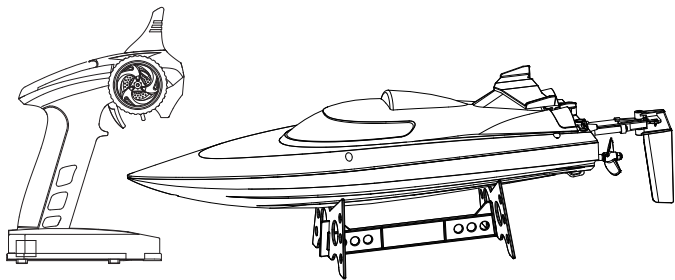

Operating Instructions for 2.4G Wireless Remote Control Boat

1. Driving system is equipped with 540 high-power main motor, high-precision servo control steering system, and water cooling system motor.
2. Includes a high power rechargeable Lithium-ion battery.
3. The boat has a max speed of 30 kilometers per hour.
4. Boat Dimensions:
Length of boat body: 463mm
Width of boat body: 124mm
Height of boat body: 118mm

Main Structures of Remote Control Boat

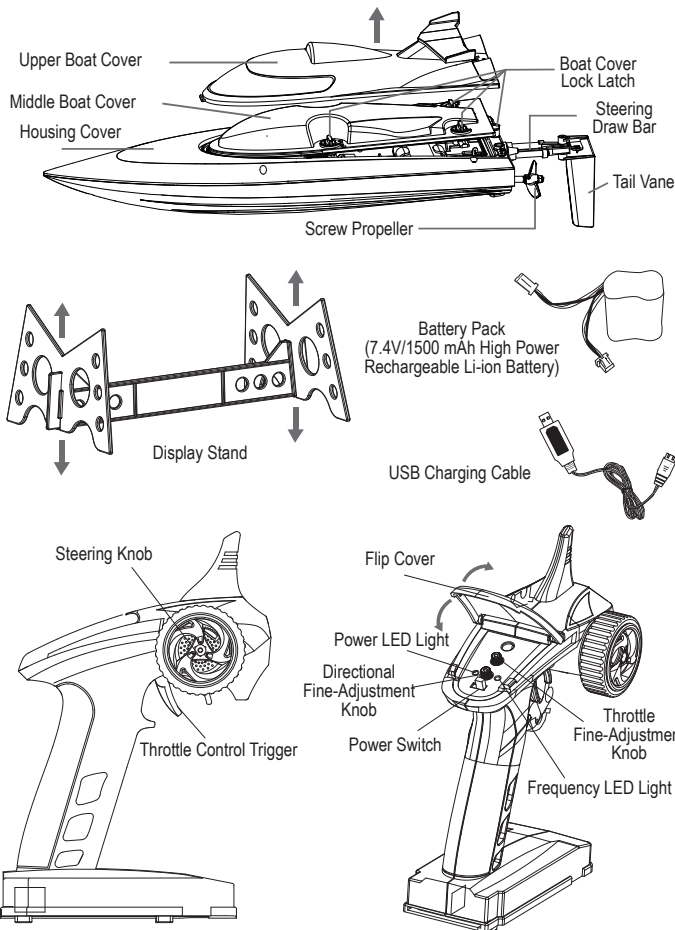

-1-

Remote Controller Battery Installation

Batteries: Open the battery cover of the remote controller. Put 1.5V AA x 6 batteries in the remote according to positive and negative electrodes. Close the battery cover and tighten the screws (See Figure1).

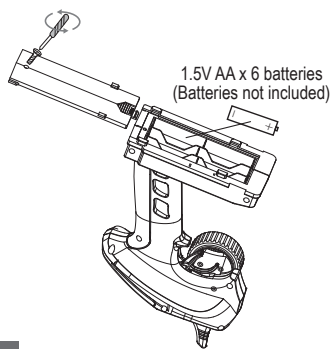

Rechargeable battery

Properly connect the 7.1V lithium battery pack to the end of the USB charging cable connector until you hear a click. Plug the USB charging cable into any USB power socket. Allow 5 hours for the lithium battery pack to be fully charged. Once charged, disconnect the USB charging cable and the lithium battery pack. Always store the battery pack in a cool place away from excessive heat.

Caution about Batteries, USB Charger

1. 1.5V AA battery X 6 for remote control.
2. 7.4V/1500mAh lithium rechargeable battery pack for high speed racing boat.
3. Do not charge non-rechargeable batteries.
4. Remove batteries from the boat before charging.
5. Do not mix batteries of different types or use old and new batteries together.
6. Batteries should be installed in right polarity.
7. Exhausted batteries must be removed from toy.
8. No short circuit of power-line connection is permitted.
9. Please only use the provided USB charging cable.
10. Please cut off power of USB charging cable before using any liquid to clean the boat.
11. Regularly check for damages to wires and batteries to ensure consistent safety when the toy is being operated.

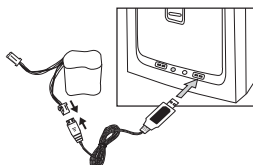

Attention!
Before charging the lithium battery pack, make sure the battery is fully dried and has had 30 minutes to cool down after use.

-2-

Racing Boat Battery Installation

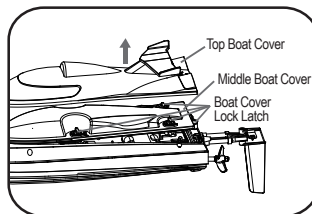

1. Twist the lock latch to remove the top and middle boat cover.

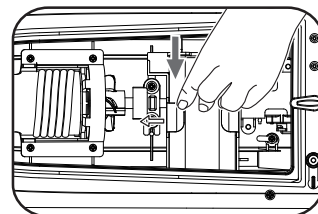

2. Place Li-ion battery pack in the battery holder of the boat body.

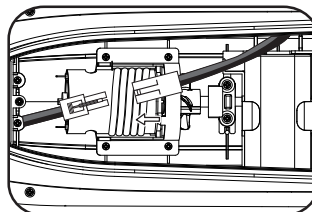

3. Connect the the Li-ion battery pack to the circuit board in the body of the boat.

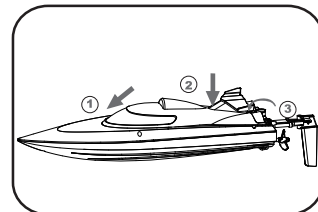

4. Place the top and middle cover back onto the boat and twist the lock latch until all pieces are locked in place.

Frequency pairing for remote controller and boat model

Install the battery, place the boat on the water and turn on the remote controller. When the red light is solid and the green light is flashing, it means that the boat is pairing with the remote. When the green light turns solid, the boat and the remote have successfully paired. The pairing process should take no more than 5 seconds.

Note: If over 5 seconds, the pairing was unsuccessful.

-3-

Safety Warning

Please read all safety warnings below before operating the FT016 High Speed Racing Boat

- 1.The high speed racing boat is for kids 14 and older. Always ensure there is adult supervision when operating the boat
- 2.Ensure there are no people swimming in the body of water the boat is being operated in to avoid injury.
- 3.Make sure there are no foreign objects in the water to ensure smooth operation.
- 4.Please do not exceed the distance of 150 meters. The boat will become un-operational past 150 meters.
- 5.When the boat is not in use, be sure to switch the power off.
- 6.Once the remote begins beeping indicating that the batteries are depleting. Promptly return the boat to shore.
- 7.Please be aware of your own safety. Do not enter the water to retrieve any stranded boats. Always ask a trained professional for assistance.
- 8.Please maintain a safe distance from the propeller which is operating at high rotational speeds, to avoid trauma and cutting.
- 9.Do not touch the electric motor or batteries to avoid thermal burns.
- 10.The boat is only meant to be used on the water. It is not meant for land use.

Installation of anti-collision part

Anti-collision part can prevent bow cusp causing injury.
Refer to illustration:

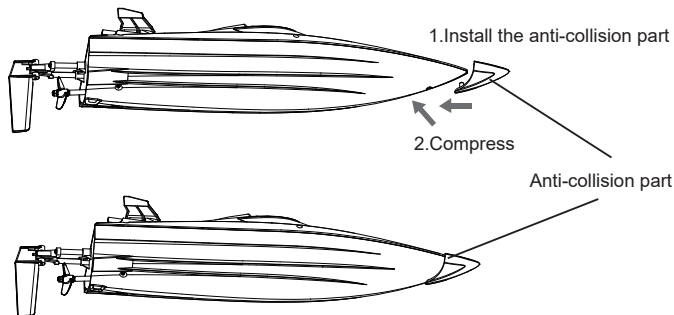

-4-

Operating Methods

Forward

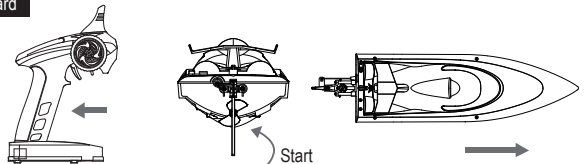

Pull the trigger of the remote controller back to advance the boat.

Backward

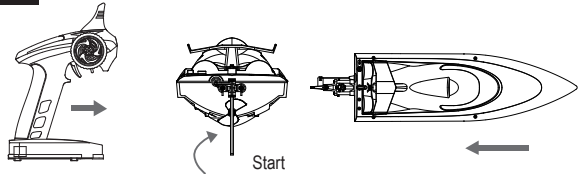

Push the trigger of the remote controller forward to reverse the boat.

Turn left

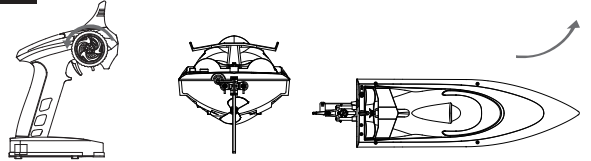

Pull the trigger of the remote controller back and rotate the direction knob counter-clockwise to turn left.

Turn right

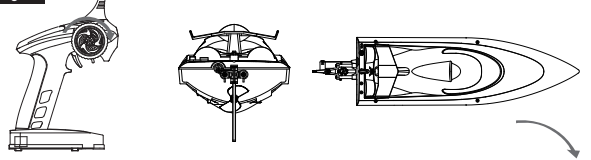

Pull the trigger of the remote controller back and rotate the direction knob of the clockwise to turn right.

-5-

Turnover of boat

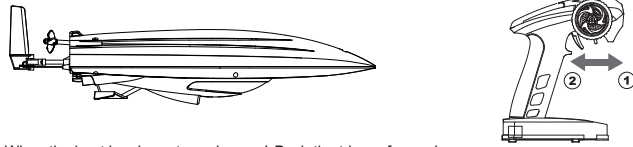

When the boat has been turned over, 1.Push the trigger forward, 2.Then pull the trigger back immediately. The boat model will turn back over.

Fine adjustment towards left

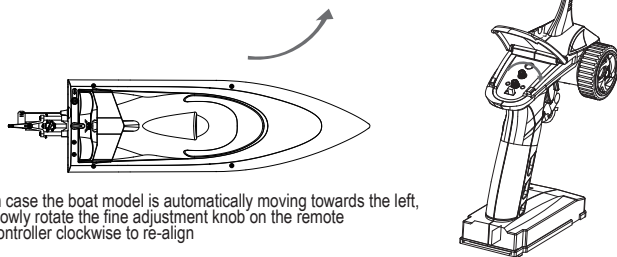

In case the boat model is automatically moving towards the left, slowly rotate the fine adjustment knob on the remote controller clockwise to re-align

Fine adjustment towards right

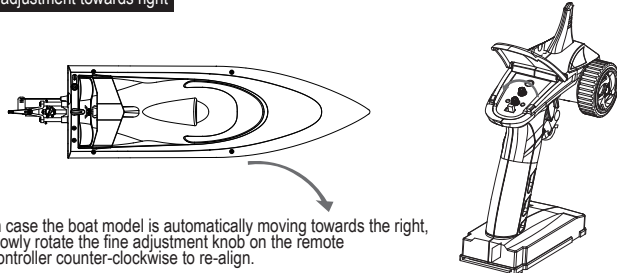

In case the boat model is automatically moving towards the right, slowly rotate the fine adjustment knob on the remote controller counter-clockwise to re-align.

Maintenance and Inspection

- 1.Always power off the boat when not in use.
- 2.Do not place the boat under the sun for extended hours to avoid sun damage.
- 3.After use, dry the boat with a soft cloth and drain any excess water.
- 4.When the toy is not in use, always take the batteries out both the boat and remote controller to prevent any battery leak.

-6-

Spare Parts

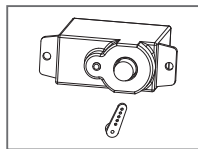

Electronic steering engine unit

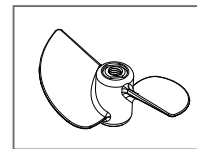

Tail screw propeller unit

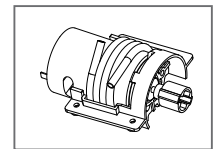

Water cooling motor subassembly

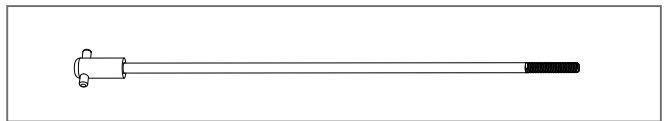

Screw unit

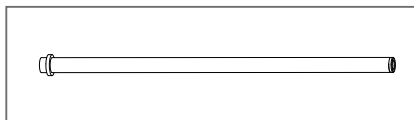

Steel tube unit



Anti-collision part

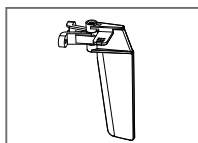

Steering engine unit

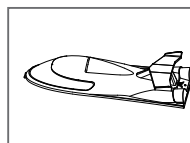

Boat cover unit

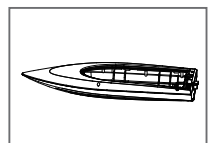

Boat bottom unit

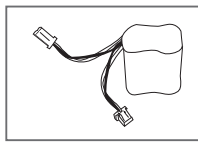

Lithium battery(7.4V/1500mAh)

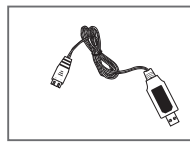

USB Charging Line

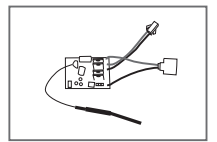

Circuit board of FT009 for receiving signal

-7-

FCC Warning Statement Changes or modifications not expressly approved by the party responsible for compliance could void the user's authority to operate the equipment. This equipment has been tested and found to comply with the limits for a Class B digital device, pursuant to Part 15 of the FCC Rules. These limits are designed to provide reasonable protection against harmful interference in a residential installation. This equipment generates uses and can radiate radio frequency energy and, if not installed and used in accordance with the instructions, may cause harmful interference to radio communications. However, there is no guarantee that interference will not occur in a particular installation. If this equipment does cause harmful interference to radio or television reception, which can be determined by turning the equipment off and on, the user is encouraged to try to correct the interference by one or more of the following measures:

- - Reorient or relocate the receiving antenna.
- - Increase the separation between the equipment and receiver.
- - Connect the equipment into an outlet on a circuit different from that to which the receiver is connected.
- - Consult the dealer or an experienced radio/TV technician for help.

This device complies with part 15 of the FCC Rules. Operation is subject to the following two conditions: (1) This device may not cause harmful interference, and (2) this device must accept any interference received, including interference that may cause undesired operation.