

145*130MM

OSQ



410
USER MANUAL

Content

FCC WARNING STATEMENT	01
PACKING LIST	02
NOTICE	02
FUNCTION OVERVIEW	03
QUICK START	04
PROJECTION DISTANCE & SIZE	05
PROJECTION MODE	05
INPUT SOURCE	06
MEDIA PLAYER SETTING	07
PICTURE AND SOUND SETTINGS	09
WIFI CONNECTION & SCREEN MIRRORING	10
BLUETOOTH SETTING	14
PROJECTION SETTING	16
OTHER SETTING	19
SPECIFICATION	20
TROUBLE SHOOTING	21
WARRANTY	23

PACKING LIST



Projector



Remote control



2 AA Batteries

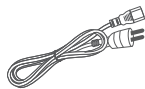

Power Cable

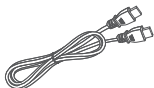

HDMI Cable



User Manual

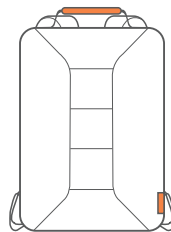

Carrying Bag

NOTICE

Recommended

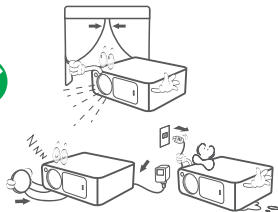

NOT Recommended

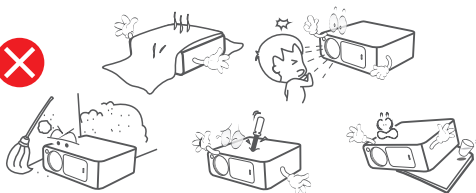

FUNCTION OVERVIEW

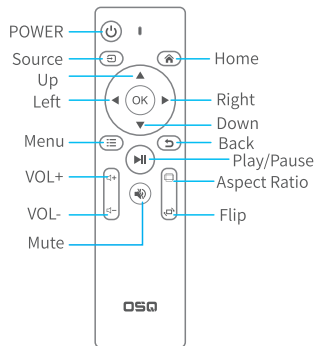
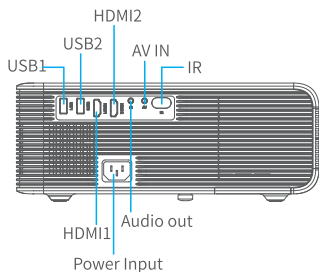
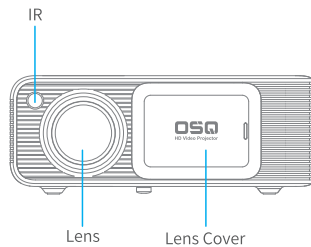
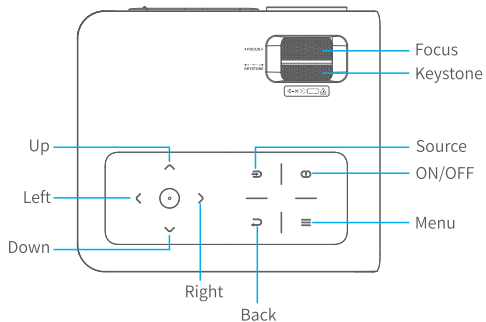

QUICK START

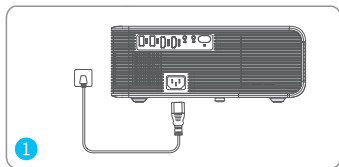

Plug the power cord into an outlet.

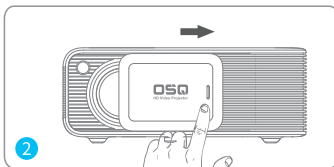

Push the lens cover to the right and secure it

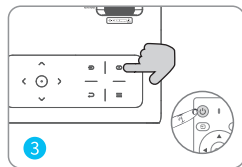

Press the **Power Button** to turn on the projector.

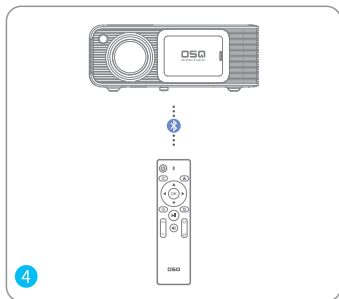

Connect your remote control to the projector via Bluetooth.

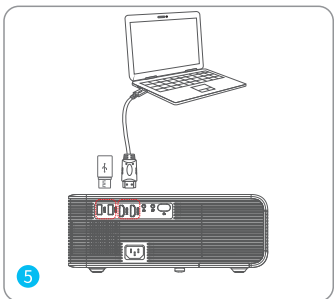

Connect your device to the projector correctly.

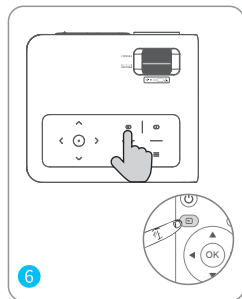

Press **Source button** and select the correct input source.

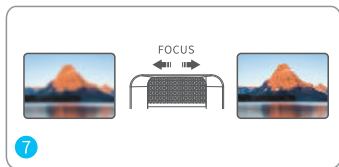

Adjust the focus ring to get the best image performance.

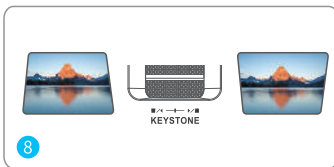

Adjust the keystone to get the suitable size

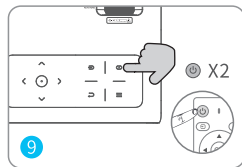

Press the **Power Button** twice to turn off the projector

PROJECTION DISTANCE & SIZE

The recommended projection screen is around 80 inches with a distance of around 9.84ft.
Dark environment & a good project screen will improve the clarity of the projected images.

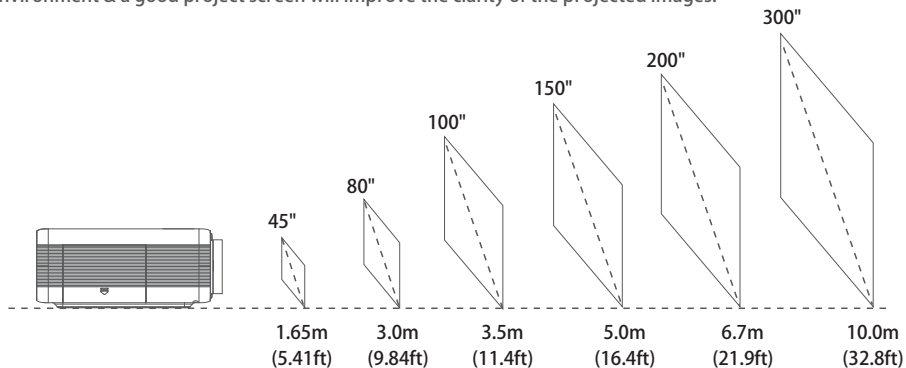

PROJECTION MODE

If you want to hang the projector to the ceiling, a projector mount will be needed.

If you want to project in different way, please select corresponding mode in the setting page.



FRONT TABLE

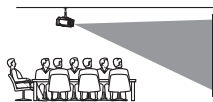

FRONT CEILING



REAR TABLE



REAR CEILING

INPUT SOURCE

Press (**Source** ) on the projector or remote to enter the interface of the **Input Source**.

A. HDMI Connection

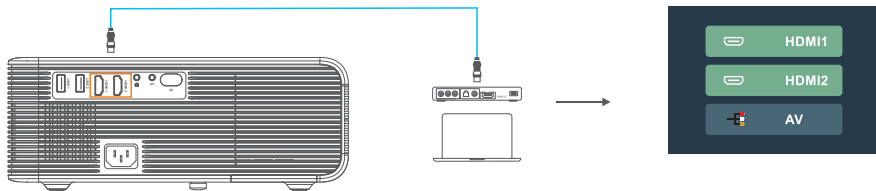

B. AV Connection

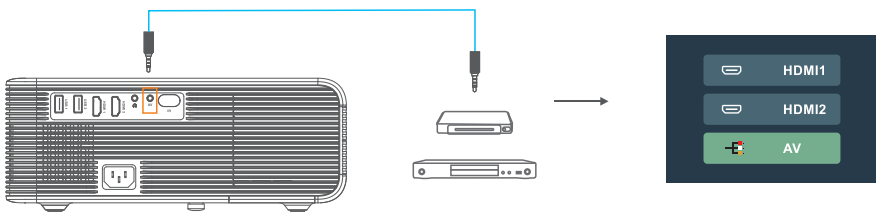

C. USB Connection

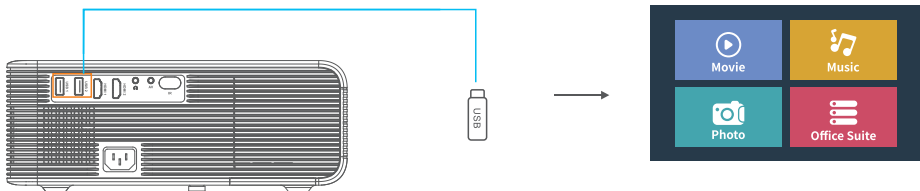

MEDIA PLAYER SETTING

When you are using media player, please choose correct entrance in home page first. If you enter from Movie, it will ONLY detect files of video format in the USB stick. (The other three interface and so on.)

A. Movie Player Setting



Press **Menu** ≡ button

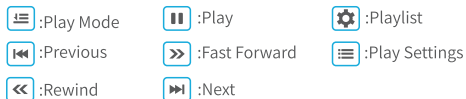
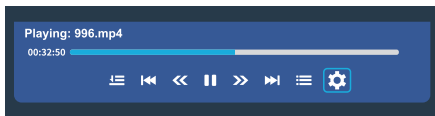

B. Music Player Setting



Press **Menu** ≡ button

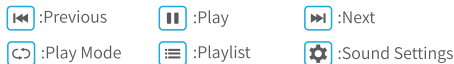
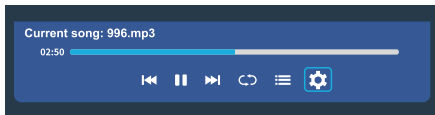

C. Photo Player Setting



Press **Menu** ≡ button

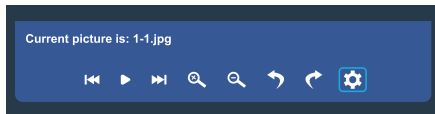

:Previous



:Play



:Next



:Zoom Out



:Zoom In



:Rotate Left



:Rotate Right



:Image Settings

D. Office Suit Setting



Press **Menu** ≡ button



:Account login



:Sharing



:File Settings

Note:

1. In the Office Suite, this projector supports to connect a keyboard or mouse via the USB interface for more detailed operations on the opened documents.
2. Recommended projection size is within 100" if using office suit playback to get the best effect.
3. The file is bigger, the opening time will be longer, please wait with patience.

PICTURE AND SOUND SETTINGS

In HDMI or AV mode, press **Menu button**  to enter picture and sound settings.

A. Picture Settings:

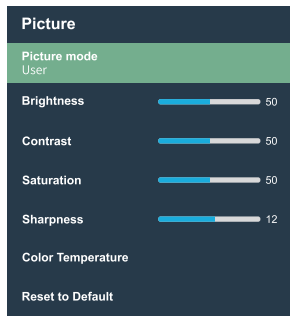

Picture Mode	User / Standard / Dynamic / Moderate	
Brightness	0~100	
Contrast	0~100	
Saturation	0~100	
Sharpness	0~100	
Color Temperature	User/ Cool/ Standard/ Warm	Red Gain: -100~100
		Green Gain: -100~100
		Blue Gain: -100~100
Reset to Default	Press to restore original picture setting.	

B. Sound Settings:

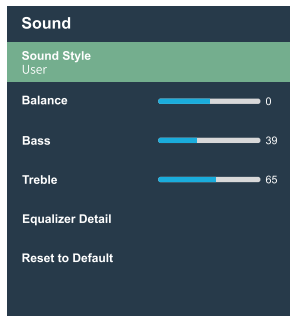

Sound Style	User/ Standard/ Film/ Music/ Sports	
Balance	-50~50	
Bass	0~100	
Treble	0~100	
Equalizer Detail	120Hz	-50~50
	500Hz	-50~50
	1.5KHz	-50~50
	5KHz	-50~50
	10KHz	-50~50
Reset to Default	Press to restore original sound setting.	

WIFI CONNECTION & SCREEN MIRRORING

WIFI CONNECTION

1. Go to **Home Page** > **Setup** > **WIFI Setting**
2. Turn the WIFI **ON** and search out the WIFI list by "Add WIFI"
3. Choose your WIFI, then enter password to connect

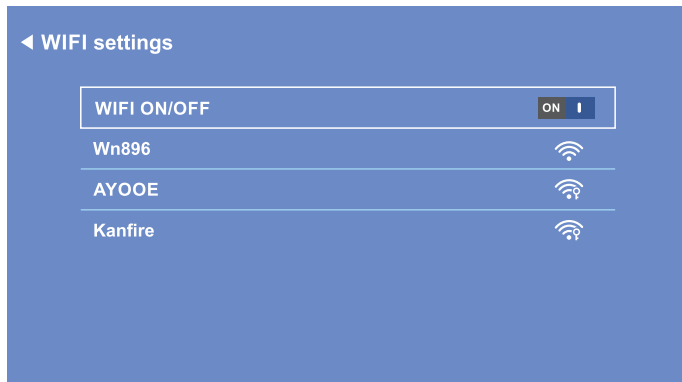

NOTE:
If you need screen mirroring, the speed of your home network is directly related to the smoothness of video play. Please make sure that the network is good to have a smoother playback.

SCREEN MIRRORING

IOS CAST (For IOS System)



1. Go to **Home Page** > **IOS CAST** to show the following page
2. On your iOS device open control center and tap Screen Mirroring
3. Looking for device that can be mirrored on
4. Select BirdCast-XXXX from the list to connect

IOS CAST

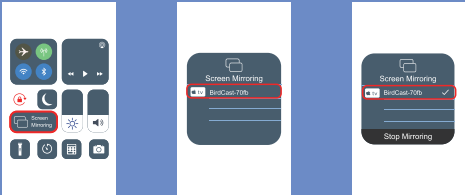
Make sure that your IOS device is connected to the same network as your projector



1. On your IOS device, open Control Center and tap Screen Mirroring.
2. Looking for devices that can be mirrored on.
3. Select BirdCast-70fb from the list.

 Network error  BirdCast-70fb

NOTE:

Please make sure the projector and your iOS device has connected to the same Wifi.
If there is no WIFI, please open a hotspot on your IOS device and connect the projector to it.

MIRACAST (For Android System)

1. Go to **Home Page > MIRACAST** to show the following page
2. On your Android device launch the Multi-screen/Wireless Display/Screen Mirroring/Smart View Function.
3. Looking for device that can be mirrored on
4. Select BirdCast-XXXX from the list to connect

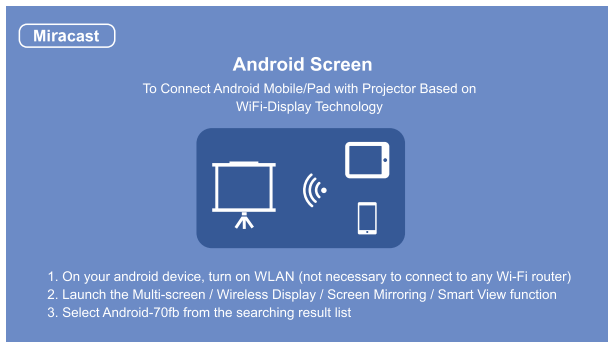

Miracast

Android Screen

To Connect Android Mobile/Pad with Projector Based on WiFi-Display Technology

1. On your android device, turn on WLAN (not necessary to connect to any Wi-Fi router)
2. Launch the Multi-screen / Wireless Display / Screen Mirroring / Smart View function
3. Select Android-70fb from the searching result list

NOTE:

1. Please remember to open the WIFI function on your Android device, but not necessary to connect to any WIFI router.
2. When you disconnect Miracast, please manually reconnect the wifi in the settings, or wait 1-2 minutes to let it automatically restore the connection.

DLNA (For Android and iOS Device)

1. Make sure that your device is connected to the same network as your projector.
2. Open your video player software
3. Click the  icon and select the projector name BirdCast-XXXX to connect



NOTE:

1. The DLNA connection can be operated in any page of the projector.
2. After connected via DLNA, the phone can continue to use as normally, the projected video will keep playing while the mobile phone interface will not be displayed.

PROJECTION SETTING

A. Manual Keystone

1. Enter **Image Setting**
2. Choose **Keystone Advanced**, press **Right button** ► or **Left button** ◀ to turn it into **Front Mode**
3. Choose **Manual Keystone**
4. Press **Left button** ◀ and **Right button** ► to adjust the vertical keystone angle($\pm 50^\circ$).

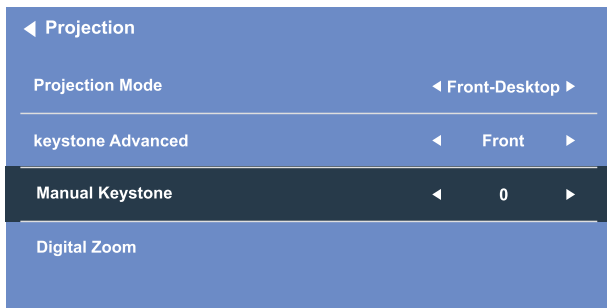

B. 4 Point Keystone

1. Enter **Image Setting**
2. Choose **Keystone Advanced**, press **Right ▶** or **Left ◀** button to turn it into **Slide Mode**
3. Choose **4 Point Keystone**
4. Press **Direction Buttons**  to adjust the angle, press **OK button** to jump to the next corner adjustment

When the center circle for roundness image best proportion



“OK” Select “” Select “” Back “” Reset

NOTE: If you want to return to the original settings, press the **Menu**  to reset.

C. Digital Zoom

1. Enter **Image Setting**
2. Choose **Digital Zoom**
3. Press **Down button ▼** to Zoom out (100%-50%) and **Up button ▲** to Zoom in(50%-100%).

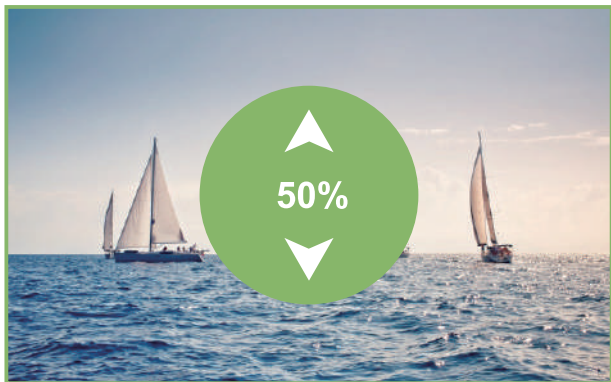

“” Adjust “” Back “” Reset

NOTE: If you want to return to the original settings, press the **Menu**  to reset.

OTHER SETTING

A. Boot Source Option: OFF/ HDMI 1/ HDMI 2/ AV

(The default setting is OFF, which can be modified as needed)

B. Power On Option: Standby/ Direct

(The default setting is Standby. If you change it to Direct, please note that if the projector suddenly loses power while working, it need to wait for a while (10-20 seconds) and then connect the power. The projector will automatically restart without press "Power" button.)

C. Language Settings

(The system provides 24 language options, you can choose it according to your requirement.)

D. Scheduled Shutdown: 10 min/ 20 min/ 30 min/ 60 min/ 120min

(Set the automatic shutdown time according to your needs)



TROUBLE SHOOTING

Q

Remote control not work?

- Make sure the batteries are effective and installed in the correct way.
- Make sure the remote control has connected Bluetooth.

A

Q

Blurry Image?

- Adjust focus ring/keystone to get the best image.
- The quality of the projection screen will also affect the image quality. Recommended to use it on a white wall or a better quality screen. Not suggest to use it on a thin white gauze screen, which will reduce the image quality.

A

Q

No Sound?

- Turn Dolby audio off in your device.
- The mute button on the remote was be pressed accidentally.

A

Q

Automatic shut-down?

- Overheating protection. Please use in a ventilated environment.
- It is recommended to unplug the power supply after use to prolong the service life.

A

Q

Upside down image?

--Press "Flip" button on the remote control.
--enter "Projection Settings" to change the Projection Mode.

A**Q**

The content from HULU, Netflix, and similar services can not be mirrored or cast?

--Due to the copyright restriction from Hulu, Netflix, and similar services, the contents can't be mirrored or cast.
--If needed to play these videos, please prepare a TV stick, Roku or Chromecast (not included).

A**Q**

Missing accessories?

--If the device is damaged or any accessories missing, please contact our after-sales department for help.

A

WARRANTY

OSQ provides the following service for each customer:

- 30-days full refund or free replacement
- 1-year technology support
- Lifetime professional consult

If you need any help or want to extend the warranty time for your order, please email us:

✉ us-projector-410@eitack.com





O-410 USER MANUAL

FCC Caution:

This device complies with part 15 of the FCC Rules. Operation is subject to the following two conditions: (1) this device may not cause harmful interference, and (2) this device must accept any interference received, including interference that may cause undesired operation.

Any changes or modifications not expressly approved by the party responsible for compliance could void the user's authority to operate the equipment.

NOTE: This equipment has been tested and found to comply with the limits for a Class B digital device, pursuant to Part 15 of the FCC Rules. These limits are designed to provide reasonable protection against harmful interference in a residential installation. This equipment generates, uses and can radiate radio frequency energy and, if not installed and used in accordance with the instructions, may cause harmful interference to radio communications. However, there is no guarantee that interference will not occur in a particular installation.

If this equipment does cause harmful interference to radio or television reception, which can be determined by turning the equipment off and on, the user is encouraged to try to correct the interference by one or more of the following measures:

- Reorient or relocate the receiving antenna.
- Increase the separation between the equipment and receiver.
- Connect the equipment into an outlet on a circuit different from that to which the receiver is connected.
- Consult the dealer or an experienced radio/TV technician for help.

To maintain compliance with FCC's RF Exposure guidelines, This equipment should be installed and operated with minimum distance between 20cm the radiator your body: Use only the supplied antenna.

FCC ID: 2ATFT-410