

215KZ数码相框说明书

尺寸：110*150mm

材质：封面200g铜版纸彩色印刷

封二封三留白

内页80g书纸黑白印刷

Digital Picture Frame

User Manual

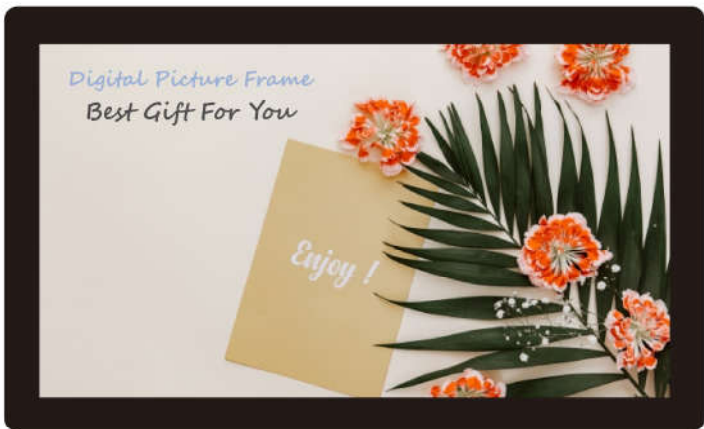

215KZ

Please read this manual before operating your Wi-Fi Cloud Photo Frame, and keep it for further reference.

Table of Contents

FCC Warning Statement	01
Contents of box	02
Frame Features	03
Getting Started	04
Share photos	09
Photo management	16
Manage account	17
Functional Overview	18
FQA	21
Contact Us	23

FCC Warning Statement

FCC Statement

This equipment has been tested and found to comply with the limits for a Class B digital device, pursuant to part 15 of the FCC Rules. These limits are designed to provide reasonable protection against harmful interference in a residential installation. This equipment generates, uses and can radiate radio frequency energy and, if not installed and used in accordance with the instructions, may cause harmful interference to radio communications. However, there is no guarantee that interference will not occur in a particular installation. If this equipment does cause harmful interference to radio or television reception, which can be determined by turning the equipment off and on, the user is encouraged to try to correct the interference by one or more of the following measures:

- Reorient or relocate the receiving antenna.
- Increase the separation between the equipment and receiver.
- Connect the equipment into an outlet on a circuit different from that to which the receiver is connected.
- Consult the dealer or an experienced radio/TV technician for help.

Caution: Any changes or modifications to this device not explicitly approved by manufacturer could void your authority to operate this equipment.

This device complies with part 15 of the FCC Rules. Operation is subject to the following two conditions: (1) This device may not cause harmful interference, and (2) this device must accept any interference received, including interference that may cause undesired operation.

RF Exposure Information

This equipment complies with FCC radiation exposure limits set forth for an uncontrolled environment. This equipment should be installed and operated with minimum distance 20cm between the radiator and your body.

FCC ID: 2ATFT-215K

Contents of box

Please make sure the following items are included in package.

If any item is damaged or missing, contact us anytime to get a new one for free .

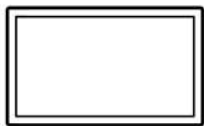

Wi-Fi Cloud Photo Frame

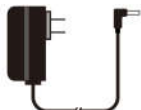

Power Adapter
with Power Cable



User Manual

Table stand need



Wall stand need



Screws for wall mounting



Screws for frame mounting

Remote Control need

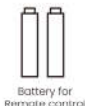
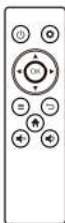

Battery for
Remote control

Frame Features

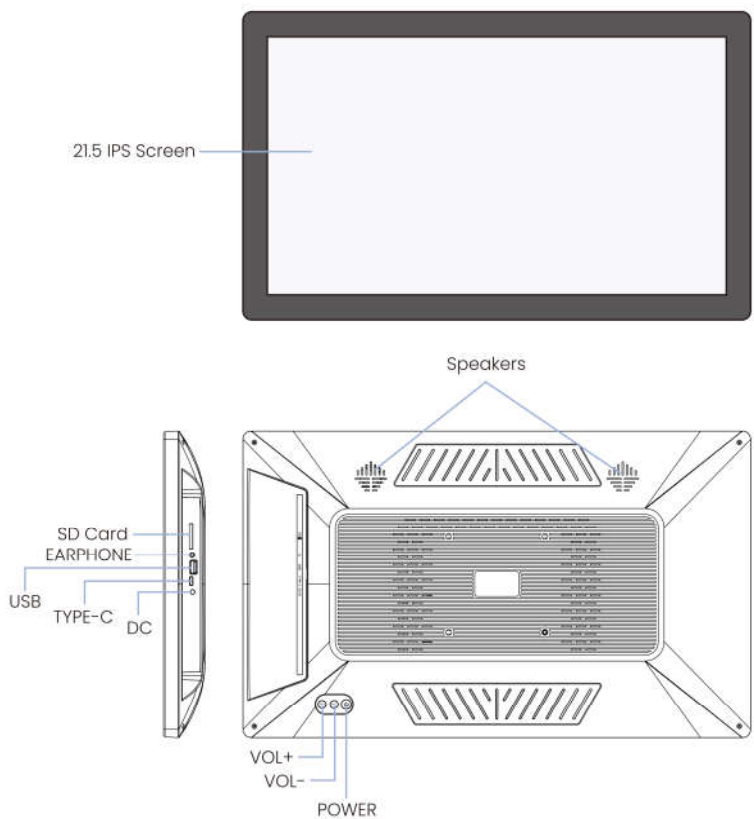

Getting Started

● Install the wall mounting stand

- ① Attach the bracket to the rear of the photo frame using screws, ensuring the narrower side is facing downwards.
- ② Secure another bracket onto a suitable location on the wall, ensuring the narrower side faces downwards.
- ③ Slide the bracket on the back of the photo frame into the wall-mounted bracket.

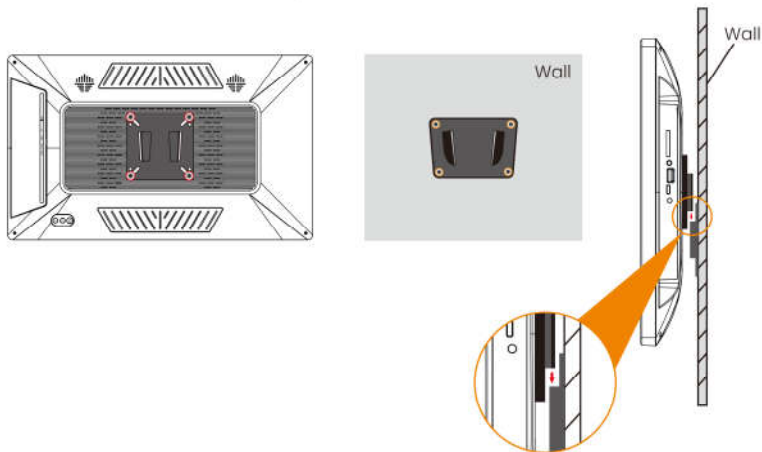

● Install the tablet stand

Fit into the frame bracket on the back. You can choose different height holes to control the frame angle.

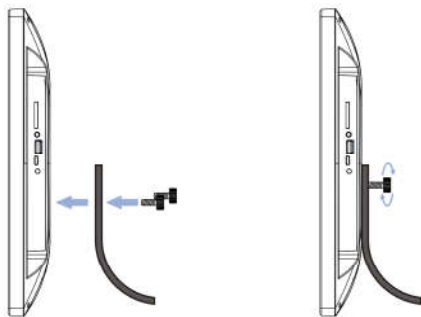

● Power on

Connect the Power Cable to your frame and plug the Power Adapter into the wall socket, the frame will enter the system in seconds.

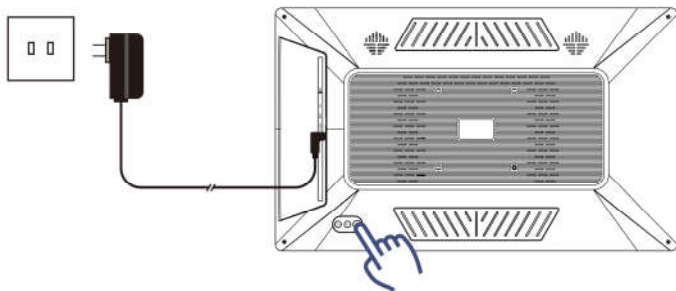

● Initial settings

There are several initial settings (Wi-Fi, Device info, Sleep Mode, etc.) when you enter the system for the first time.

● Connect to Wi-Fi

Select the Wi-Fi network you would like to connect and enter the password if required.

If your Wi-Fi network is not on the list, move your frame closer to your router, wait for seconds and check it again.

● Download the Uhale App

To send photos to your frame, by using the Uhale App for iOS or Android.

▶ Download App

Search for "Uhale" on App Store / Google Play

Scan the QR code to download and install it on the mobile device.



● Remote control

Turn off screen/Turn on screen

① Short press to turn off the screen or turn on the screen.

② Long press to power off or restart

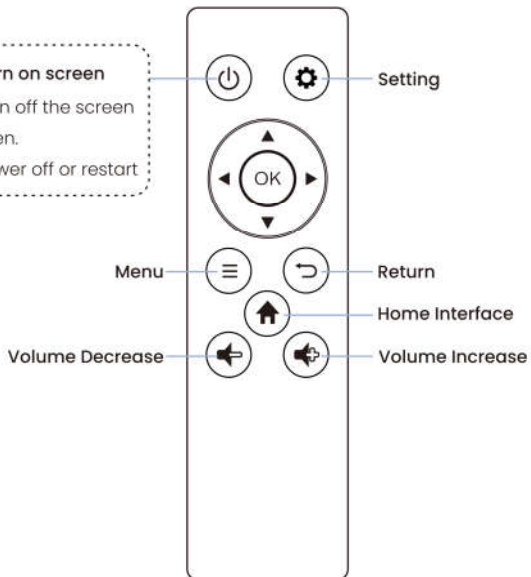

● Quick Setup

When starting your frame for the first time, you will need to setup the frame.

1. Uhale Frame may request to upgrade to the latest version. If so, it is recommended to upgrade the photo frame before proceeding.
2. Choose a language you preferred as default.
3. Connect the photo frame to the Internet via Wi-Fi.
4. Set the date, time and set the time zone if needed.
5. Name the photo frame (E.g. Jack's Frame); Set the location of the photo frame (E.g. Living Room, Kitchen, Office).
6. Check the quick guide on the Uhale frame.

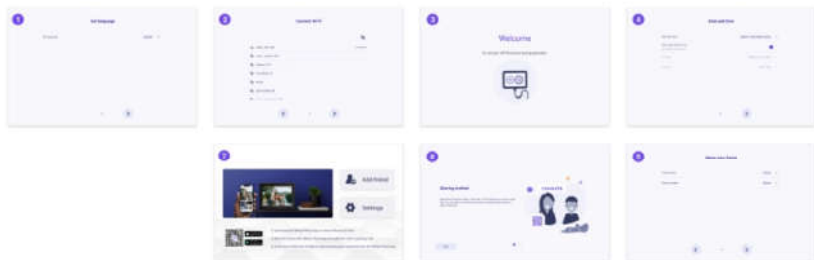

● Bind your frame

1. Make sure that your friend has downloaded and installed the Uhale App.
2. Choose the "Add friend" icon on your frame. A dialog will appear showing both QR code and SN code (valid for 12 hours).
3. Now share either the QR code or the SN code through your preferred way E.g. SMS, IM, phone call, to your friend.
4. Once the frame is connected to your friend's Uhale App, you will be able to find them on the sharing list on the frame.



• Navigating your frame

Use the Remote Control left and right to browse photos, photos can be automatically rotated. To access the menu bar, tap the  on the Remote Control, this will show the menu. In the menu, you will find quick access to the add friends and the settings.

From the menu, it is also possible to make relevant settings for the currently displayed photos, such as hide, adjust, Repeat all, and Slideshow.

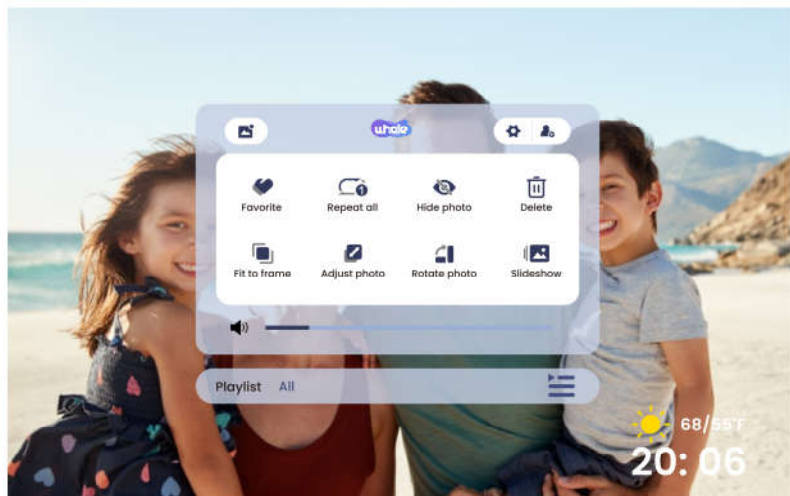

Share photos

You can share photos/videos in four ways.

1. Uhaul APP

Quick Setup

APP is equivalent to a transfer tool, you can log in with a visitor account or with an email account.

Visitor accounts: The data will not be saved in the cloud, the accounts created are temporary. As long as you uninstall or reset APP, the temporary account and the information generated by the account will all be deleted.

Email account: The cloud will keep your usage data (such as avatar, nickname, photo frame binding relationship), and the data will exist when you uninstall/reset the app or change your phone to login.

Photo Share

Sharing photos is divided into picture share and video share.

Photo share: select pictures (up to 50 pictures) - select photo frames -edit pictures (adjust focus areas and name photos) - send.

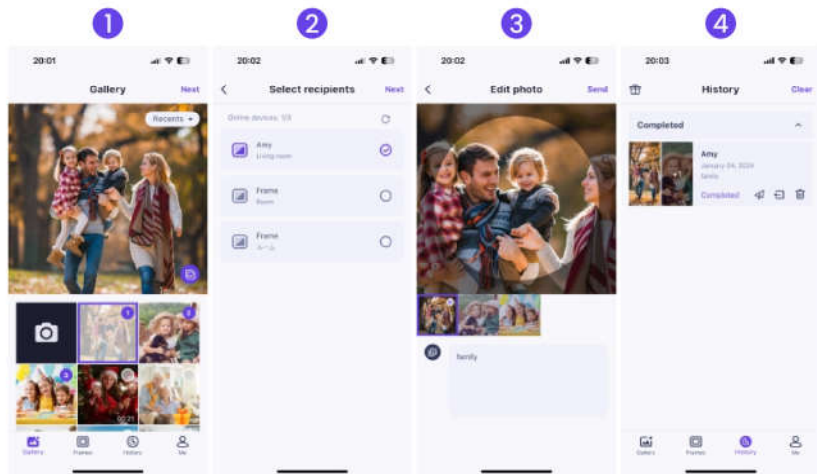

Video share: select video (only one video can be selected, video up to 30 seconds long)
- select photo frame - edit video (video length and video naming) - send.

NOTE: You can also import videos to the digital photo frame by inserting an SD card/USB flash drive and there is no time limit for videos. However, the UHale APP can only upload videos up to 30 seconds.

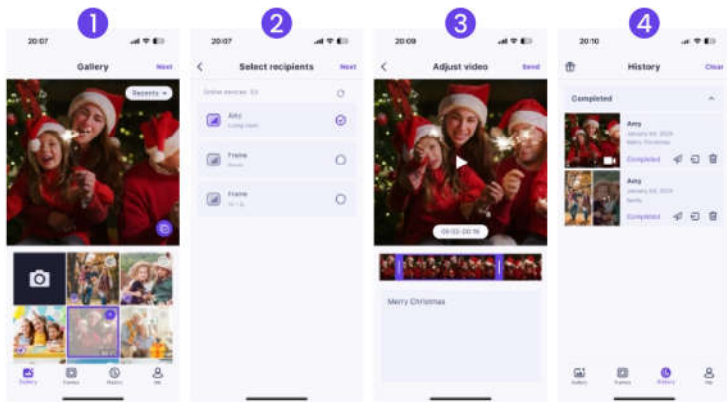

History

You can check the status of photo sending tasks and perform some quick actions on the sending history side.

Delete: Deletes local history data (does not delete framed photos).

Clear: clears the history data (does not delete the task in the sent state).

Resend: you can resend this photo to other frames.

Withdraw: Deletes local history data and frame photos, as long as the history record on the app exists and the frame is online, you can withdraw the photos.

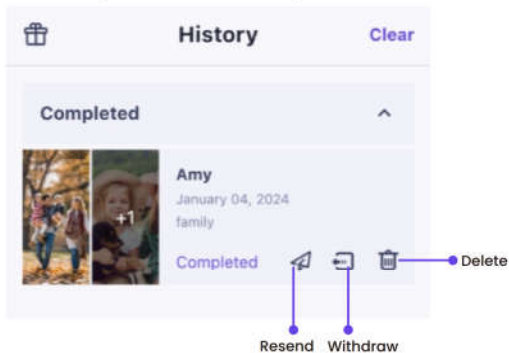

2. Uhale Web

Uhale Web is a pc online transferring tool for Uhale Frames. Through the Uhale Web , you can share up to 500 photos to the photo frame at once.

Log in and log out

Scan code login

Visit the website to get access to Uhale Web: <https://uhale.zeasn.tv>

Download, install, and open the Uhale APP on your mobile device, find the QR code [scan] below to log in, or use visitor /Account Login.

Note: After successfully logging in, the webpage will automatically synchronize the information in the APP/Account (such as avatar, nickname, and connected device).

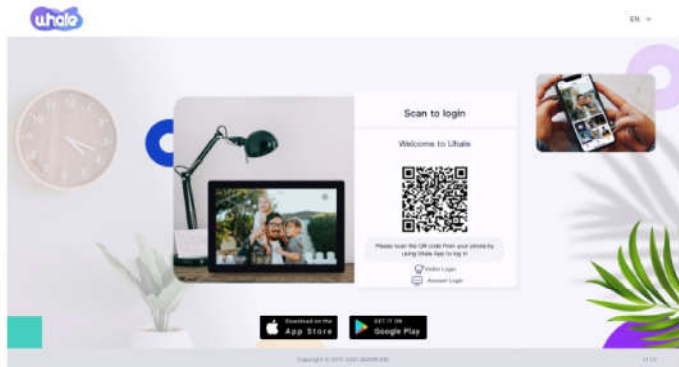

Log out

To switch accounts for sharing, Log out the current account in the upper right corner, and scan the code to log in another account.

Photo sharing

Photo selection

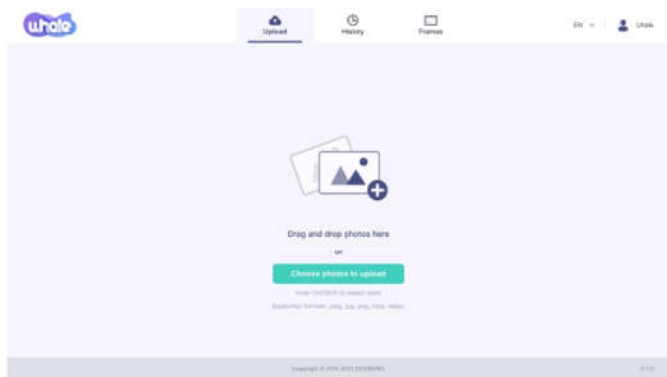

After logging in, select photos to share in two ways.

- 1) Click the button to open the local folder and select photos;
- 2) Drag photos or a folder directly to the area, then click **[Next]** to upload;

NOTE:

- 1) Hold down Ctrl to select batches or drag photo(s) to the area.
- 2) Currently supported photo formats: JPG, JPEG, PNG, BMP.

Photo editing

When the photos are on the list to be transferred, you can edit the photo information, such as adding photos onto the existing list, renaming and removing photos, and more.

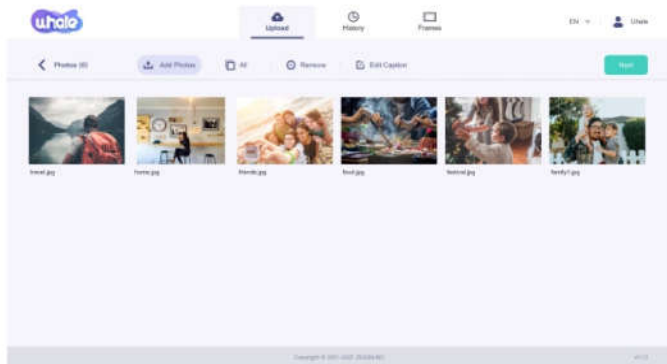

Renaming a photo: Supports name re-editing for a selected photo

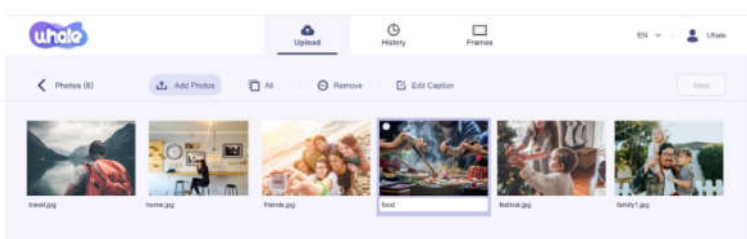

NOTE:

Exit the editing mode, select a photo frame to complete photo sharing. Photo(s) cannot be shared under editing mode.

Frame selection

When finishing editing all photos, click **[Next]** to select a photo frame. If there is a binding device, the online photo frame information will be displayed; and if there is no binding device, you will be prompted to go to the APP to bind one.

Offline display:

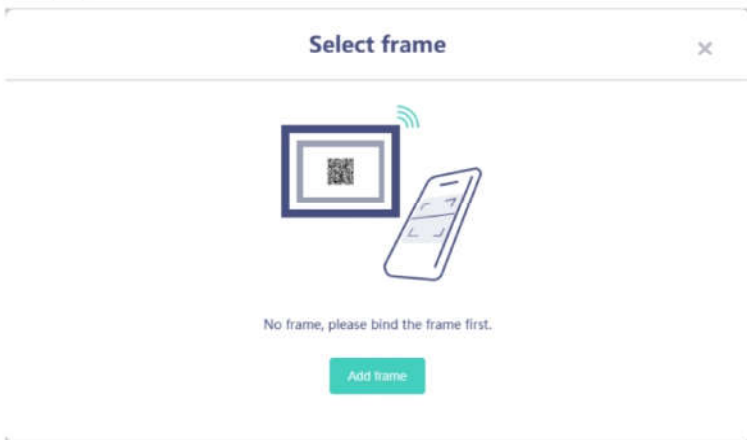

Online display:

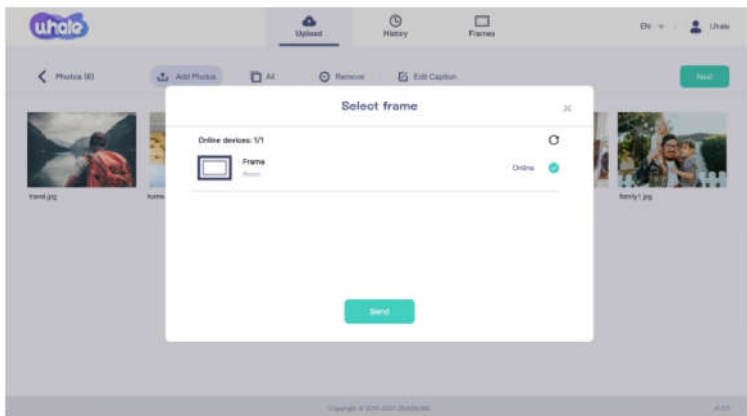

Send

Select the photo frame and click **[send]**. Then, a task will be created in the taskbar. Check the photo sending progress on the page or click **[History]** to view it.

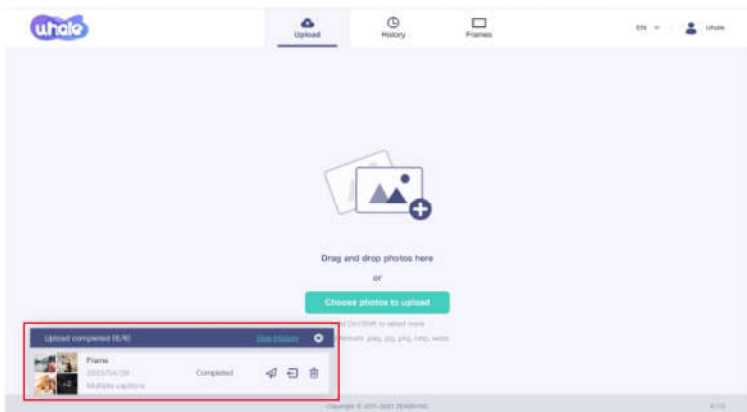

Profile

Basic information is displayed under the profile section.

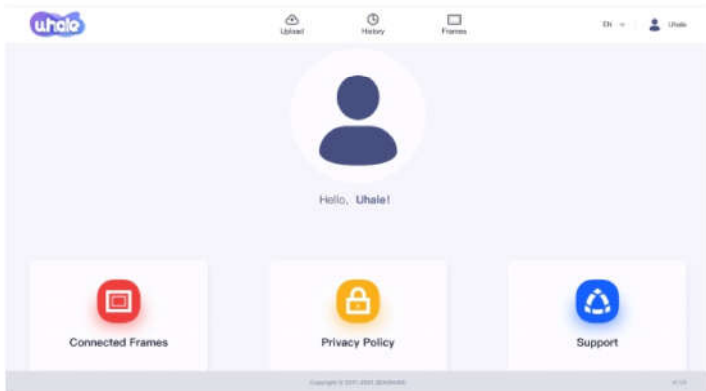

- 1) Connected frames : Display information of connected frames, name, location and status.
- 2) Privacy Policy: Displays Privacy Policy and Terms of Use.
- 3) Support: displays contact information of the support team.

Photo sharing

The Taskbar displays the photo transfer tasks for users to check sending progress.

The Taskbar supports quick operations, including re-send, withdraw, delete and more.

- 1) View history: Click [View History] to jump to the history record. The functions of the history record are the same as Taskbar; but in here, you can view the transmission details of a single task.
- 2) Maximize/Restore down the Taskbar: When the taskbar is maximized, scroll up and down to view each transmission task; restore down to display in a smaller window.
- 3) Resend: Re-select the photo frame to send the photo(s) again.
- 4) Withdraw: Withdraw photo(s) from the photo frame.
- 5) Delete: Delete current task.

History

History obtains the same functions as Taskbar but in here, you can view the details of a task to check the transferring status of photo(s) (successful, transferring, failed).

3. SD Card

You can copy photos and videos to SD card, then insert the SD card into the frame, and import photos to the frame through [Frame] - [Settings] - [Manage Photos] - [Import Photos].

Direct playback of photos from SD card without importing.

4. USB

You can copy photos and videos to the USB flash drive, then insert the USB flash drive into the photo frame, then Import photos to the photo frame through [Frame] - [Settings] - [Manage Photos] - [Import Photos].

Direct playback of photos from USB flash drive without importing.

Photo management

● Memory usage

The Manage Photo section shows you the number of photos stored in the frame and the storage space occupied/remaining.

● Show/Hide photos

Select the photo you want to hide by Remote Control. Hidden photos will not be deleted from the frame and can be re-displayed at any time. Use to select or deselect all photos.

● Favorite photos

Select the photo you want to remove from the favorite photos by Remote Control.

● Delete photos

Select the photo you want to permanently delete from the frame by Remote Control.[Settings]-[Manage photos]-[Delete photos] Use to select or deselect all and to delete the selected photos. You can also withdraw photos/videos which are already sent to frame from UHale mobile app.

Note: withdraw only works when history is retained and frame stays online). To withdraw: In UHale "history" - select the icon of the ones you would like to withdraw.

● Import photos

Allows you to import photos from a SD card/USB flash drive.

—How to import photos to your frame?

1. Insert a SD card/USB flash drive into your digital frame.
2. Select the photos you want to import into the photo frame.
3. Tap on the import button by remote control to start the import process.

Once the import process is complete, your selected photos will be available for display on your digital picture frame.

● Export photos

Allows you to export photos from the digital frame to a SD card/USB flash drive.

—How to export photos from your frame to a SD card/USB flash drive?

1. Select the photo you want to export from the photo frame.
2. Tap the export button by remote control to start the export process.

Once the export process is complete, the selected photo will be saved onto the SD card/USB flash drive, allowing you to transfer it to other devices or store it as a backup.

● Best wishes

Here you can view the history of blessings received, including time, title, sender, etc.

Manage account

This contains all connected accounts that are authorized to send photos to your frame .

● Add a new account

To add a new authorized account, choose the device share button, and then share the displayed SN or QR code you preferred with your friend

● Account Settings

1. Remove an account: Once an account is removed from your frame, it will no longer be able to share photos with your photo frame.
2. Delete shared photos: You can delete all photos that were shared by a specific account.
3. Delete the account (without deleting the shared photos): This option allows you to remove an account from the list without deleting any of the photos that were shared by that account.

Functional Overview

Settings

My frame	Frame name	Set/Change the name of the frame. The frame name is also displayed in connected mobile devices, under the list of connected photo frames in the App.
	Frame location	Set/Change the location of the photo frame. This location is displayed in the list of connected photo frames of your friends and family, helping to identify multiple frames.
	Time zone	Set time zone for a photo frame.
	Language	Set language used for a photo frame.
	Automatic date&time	Use network-provided time.
	Set date/time	The date and time can be manually adjusted after the automatic date&time is turned off.
	Enable/Disable 24-hour clock	Enable and disable the 24-hour clock.
	Power	Power off / Restart / Sleep

Display settings:	Brightness level	Adjust photo frame brightness.
	Show caption	There are 3 display modes to choose from.
	Show favorite	The "favorite" button can select turn off or on.
	Text size	There are 4 Font sizes for selection.
	Ambient clock	Once enabled, a clock will be displayed when the photo frame is in sleeping mode.

Display settings:	Sleep mode	when the sleep mode is on, the screen is turned off during a specific time to reduce energy consumption. The default setting is to turn off the screen at 20:00 and turn it back on at 08:00. This can be changed by setting your preferred sleep mode start time. Photos can still be received when the sleep mode is on.
	Weather & Time	Enable and disable the weather and time. When enabled, the weather and time are displayed on the home page, and when disabled, they are not displayed.
	Set weather	View weather specific information and search to switch to other cities.
	Temperature unit	Supports Celsius and Fahrenheit switching.

Photo settings	Timer	Set the photo display time interval.
	Fill frame	This function is to change the scaling of all current photos on the frame or not.
	Slideshow	There are four slides to choose from here, Default, Shuffle, Scale In Out, Accordion
	Photo display order	Set the order of photo rotation. --By date: Photos are displayed in chronological order --According to user: display by friend --Shuffle: The photos are displayed randomly
	Video related settings	Video Autoplay: when turned on, video will be automatically played; when turned off, video will be paused. Playback Audio: when turned off, the video will be muted; when turned on, the video will be played with a preset volume. Video volume setting: Adjust the video volume of the photo frame.
	Playback Mode	Repeat all/Single repeat

Notifications	Notification volume	Adjust the notification volume of the photo frame.
	Show Notifications	Enable for notification, disable to stop(Wi-Fi connection, New friends, Storage space, New photos)

Backup and restore	Backup	Backup frame to external storage (e.g. SD card/USB flash drive) Tap to make a backup of your photos by remote control. The time of the last successful backup is also displayed here. Any existing backup on the external storage will be overridden!
	Restore from backup	Before you attempt to restore your frame, start by confirming that your backup is up-to-date. This is done by confirming the date under "Backup" frame to external storage (e.g. SD card/USB flash drive). if e.g. the last backup is too old or if no backup is made, then press the "Backup" frame external storage (e.g. SD card/USB flash drive)"button" to make a new backup. NB: If you wish to restore a backup on a frame that has already been set up, please make sure that both frames are updated to the latest version beforehand.
	Reset Frame	This is done by pressing the "Reset Frame" button. This operation will delete all the data on the frame and reset the frame to its factory preset values. After a successful reset, select the "Restore from backup" button to restore the data.

WiFi	Set the Wi-Fi connection, Wi-Fi details, Add a hidden Wi-Fi, Refresh Wi-Fi list
------	---

Help	Give feedback, FAQ, Guide, Privacy policy, App download, Support
------	--

About	Software version update, Build Number, System version, MAC, Terminal ID
-------	---

More meaningful functions

● Favorite

Choose the  on the screen to favorite the current photo or video.

● Best wishes

Show the wishes sent by your family or friends.

You can manage the blessings in **【Settings】** - **【 Manage photos】** - **【Best wishes】** .

How to send out wishes?

1) Open the Uhale APP on your phone. Tap the **【Gift】** icon.

Note: Please upgrade the APP to version 3.14 or above.

2) Write down your wishes in text.

3) Select a style.

4) Choose a frame(s) you would like to send wishes to.

FQA

1. Is the frame install a battery?

Answer: No, this photo frame without a battery, it can only work by supporting an adapter.

2. Why can't I power on when I plug in the adapter and press the power button?

Answer: You need to confirm whether the adapter is plugged in, and also check whether the power supply is calling.

3. Can I share the photos to friends and family through the frame?

Answer: Yes, you can share photos and videos with friends and family through the website or Uhale APP.

4. What kind of app should I download for the photo frame?

Answer: To send photos to your frame, use the Uhale app for iOS or Android.

Find the Uhale app on: Google play by searching for "Uhale" or App Store by searching for "Uhale".

5. Can this digital frame operate with a 220V outlet?

Answer: Yes, this digital frame operate with 110-220V outlet.

6. Can I send photos to the frame by mail?

Answer: No!

Way one: transfer photos to digital frame via "Uhale" App.

Way two: import photos to digital frame via SD card.

Way three: transfer photos to the digital frame through the website.

Way four: import photos into the digital photo frame via USB flash drive.

7. Can I transfer photos from my computer to the frame?

Answer: Yes!

Way one: Transfer computer photos to photo frame via website: <https://uhale.zeasn.tv>

Way two: Transfer the photos on the computer to the SD card, and then insert the SD card into the photo frame to import the photos to the frame.

Way three: Transfer the photos on the computer to the USB flash drive, then insert the USB flash drive into the photo frame to import the photos into the photo frame.

8. Are my photo transfers safe?

Answer: Absolutely safe! Our digital frames are authorized genuinely by "Uhale" App company, so there is no need to worry about photos and videos being leaked.

9. Can I use a USB flash drive to directly upload photos or videos?

Answer: Yes, you can import the photos in the USB flash drive into the photo frame, or you can choose not to import and view the photos in the USB flash drive directly.

10. How to send best wishes?

Answer: Open the Uhale APP on your phone. Click the [Gift] icon, select a style, edit the text and send it to the photo frame which would like to send wishes to.

Contact Us

* If there is a malfunction of the machine or damage to any part of the machine, stop using it and consult a licensed electrician for repairs.

* Do not attempt to modify or repair the machine yourself. If you have any problem with the product, please don't hesitate to email us at:

215kz-uhale@eitack.com

We will reply to you within 24 hours and give you the best solution. Thank you!

Digital Picture Frame
User Manual