



Qi CERTIFIED WIRELESS CHARGER Model: 160486

Caution

This equipment generates, uses, and can radiate radio frequency energy and, if not installed and used in accordance with the instructions, may cause harmful interference to radio communications.

If this equipment does cause harmful interference to radio or television reception, which can be determined by turning the equipment off and on, the user is encouraged to try to correct the interference by one or more of the following measures:

- Reorient or relocate the receiving antenna.
- Increase the separation between the equipment and receiver.
- Connect the equipment into an outlet on a circuit different from that to which the receiver is connected.
- Consult the dealer or an experienced radio/TV technician for help.

This product may cause interference to radio equipment and should not be installed near maritime safety communications equipment or other critical navigation or communication equipment operating between 0.45-30 MHz.

The Qi symbol is a trademark of the Wireless Power Consortium.



Important Safety Precautions

Read all instructions before using your charger.

- Never expose your charger to high temperatures, extreme cold, high humidity or any liquid.
- In order to avoid the risk of electric shock, never attempt to open your charger or repair it, consult a certified professional.
- If the product overheats, has been dropped or damaged or has been dropped in a liquid, discontinue use.
- Your charger is not to be used by children without adult supervision.
- Do not use your charger at temperatures under 40° F or over 95° F.
- Do not drop your charger, throw it, or subject it to strong impacts.
- If you detect any abnormalities when using your charger immediately discontinue use and contact the manufacturer.
- Unplug your charger when it will not be in use for long periods of time or during lightning storms.
- Before charging any electronic device with the wireless charger, check the voltage of your electronic device to make sure that is compatible with your charger.
- Do not clean the charger with harmful chemicals or detergents.
- Do not touch the device with wet hands.
- Magnetic strip cards, including credit cards, security badges and passports may be damaged by magnetic fields.
- Don't place anything between your phone and the charger. Magnetic mounts, metallic items, magnetic cases or other objects might reduce performance or damage your phone.

Product Overview

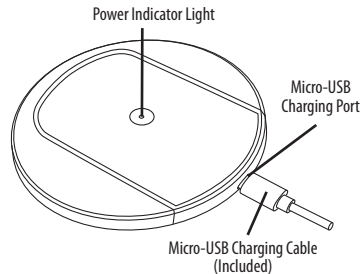

Qi Certified Wireless Charger

Warning: If a non Qi compatible device is used the charger may overheat.

Wireless charger is rigorously tested using the Qi standard to help ensure safety, interoperability and energy efficiency. Tested for its compatibility with a wide span of existing Qi certified products. This ensures that all new products are “backwards compatible”; they should work with all existing Qi products.

Compatibility

This Qi wireless charger works with fully Qi-enabled devices like iPhone X, XS, XS Max, iPhone XR, iPhone 8/8 Plus, Samsung Galaxy S10, S10+, S10E, Note 9, S9, S9 Plus, Note 8, S8, S8 Plus, S7, S7 Edge, S6, S6 Edge, Google Pixel 3/3xl, Nokia 9, Nexus 4, 5, Lumia 920 and other Qi-Enabled devices.

Charging

Note 1: The wireless charger will charge most phones with cases 5/32 inch/4mm thick or thinner. But for more efficient charging, we still recommend you to remove the case before charging. (As metal adornments or credit cards may damage your phone and may prevent charging.)

Note 2: When charging a device, the wireless charger may feel warm, this is a normal operating condition and should not be cause for concern.

Note 3: Your phone won't charge wirelessly when your phone is connected to a USB cable.

Note 4: Multiple Qi enabled devices cannot be charged at the same time.

1. Place the charger on a level surface.

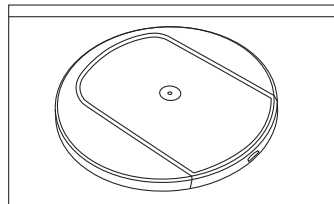

Charging (continued)

- Use the cable that came with your wireless charger and a 5V/2A power adapter (not supplied) or computer's USB port to power your wireless charger. The indicator on the wireless charger will turn red indicating the wireless charger is ready to charge.

Charge via USB Wall Charger:

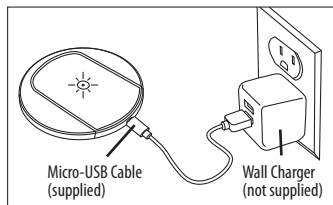

Charge via Computer's USB Port:

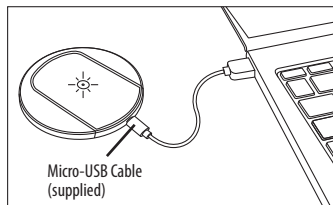

Charging (continued)

- Place your phone on the charger with the display facing up. Place the phone in the center of the wireless charger or in the location recommended by manufacturer of your phone. Your phone should start charging after you place it on your wireless charger. Confirm your phone is charging by checking the charge icon on your phone.

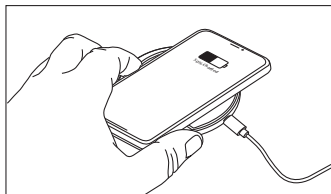

Trouble Shooting

Why is the wireless charger not charging or charging slowly?

- The power adapter is underpowered. Try using another power adapter with a least 5V/2A of power output.
- The case on your phone is too thick. Try removing the case to charge the phone.
- Your phone vibrates when getting notifications which moves your phone from the optimal charging location on the wireless charger. Deactivate the vibration feature on your phone while charging.

Specifications

Product Covering Material: ABS
Cord Type: Micro-USB
Maximum Power: 7.5W with QC charger
Input: 5V/2A
Output: 5V 1.5A Maximum
Dimensions: 11mm x 100mm x 100mm
Overcurrent Protection: Yes
Short Protection: Yes
Overheat Protection: Yes
Operational Temperature: 40°F (5° C) - 95°F (35° C)
Charging Distance: 0-0.25in (0-6mm)
Certification Type: Qi (BPP)
Specifications are subject to change without notice.

FCC Information

Caution: Changes or modifications not expressly approved by the party responsible for compliance could void the user's authority to operate the equipment.

This device complies with part 15 of the FCC Rules. Operation is subject to the following two conditions: (1) This device may not cause harmful interference, and (2) this device must accept any interference received, including interference that may cause undesired operation.

NOTE: This equipment has been tested and found to comply with the limits for a Class B digital device, pursuant to part 15 of the FCC Rules. These limits are designed to provide reasonable protection against harmful interference in a residential installation. This equipment generates, uses and can radiate radio frequency energy and, if not installed and used in accordance with the instructions, may cause harmful interference to radio communications. However, there is no guarantee that interference will not occur in a particular installation. If this equipment does cause harmful interference to radio or television reception, which can be determined by turning the equipment off and on, the user is encouraged to try to correct the interference by one or more of the following measures:

- Reorient or relocate the receiving antenna.
- Increase the separation between the equipment and receiver.
- Connect the equipment into an outlet on a circuit different from that to which the receiver is connected.
- Consult the dealer or an experienced radio/TV technician for help.