

wireless speaker

CHARGING

Connect USB end of included cable to a computer or wall charger. Connect Micro USB end of included cable to the charging port on the speaker. A red indicator light confirms the unit is charging. Once speaker is fully charged, average run time is approximately 3 hours.

CONTENTS

The following items are included in the box.
If there is any missing, please contact the seller.
Wireless Speaker: 1 set
Charging Cable: 1 PCS
Product Manual: 1 PCS

PRECAUTIONS

- Do not open, disassemble, later, or damage exterior housing.
- Keep from water or excessively hot or humid environments.
- Do not incinerate.
- Warning: listening to music at a loud volume can adversely affect hearing.

3

SKINNY DIP

wireless speaker

wireless speaker

SPECIFICATIONS

- Frequency response: 60Hz-18KHz
- Sensitivity: 80dB ± 2dB
- Signal to noise ratio: ≥90dB
- Distortion: 0.5%
- Bluetooth version: BLUETOOTH4.2
- Wireless communication range: 32 feet (specific phone model and various types of interference can adversely affect range).
- Power supply: built-in lithium battery

WIRELESS CONNECTION

1. Power up speaker. Audible cue will sound.
2. A blue flashing indicator light indicates speaker is in the pairing mode.
3. From the Bluetooth Option dialog on your mobile device, select speaker to pair with. Another audible cue will sound indicating successful pairing.
4. Once a device has been successfully paired, it will automatically connect the next time the speaker is turned on.

Note: When reactivating Bluetooth Mode on a mobile device, it may take a couple of seconds for the device to find the speaker and automatically pair with it.

1

wireless speaker

FUNCTIONS

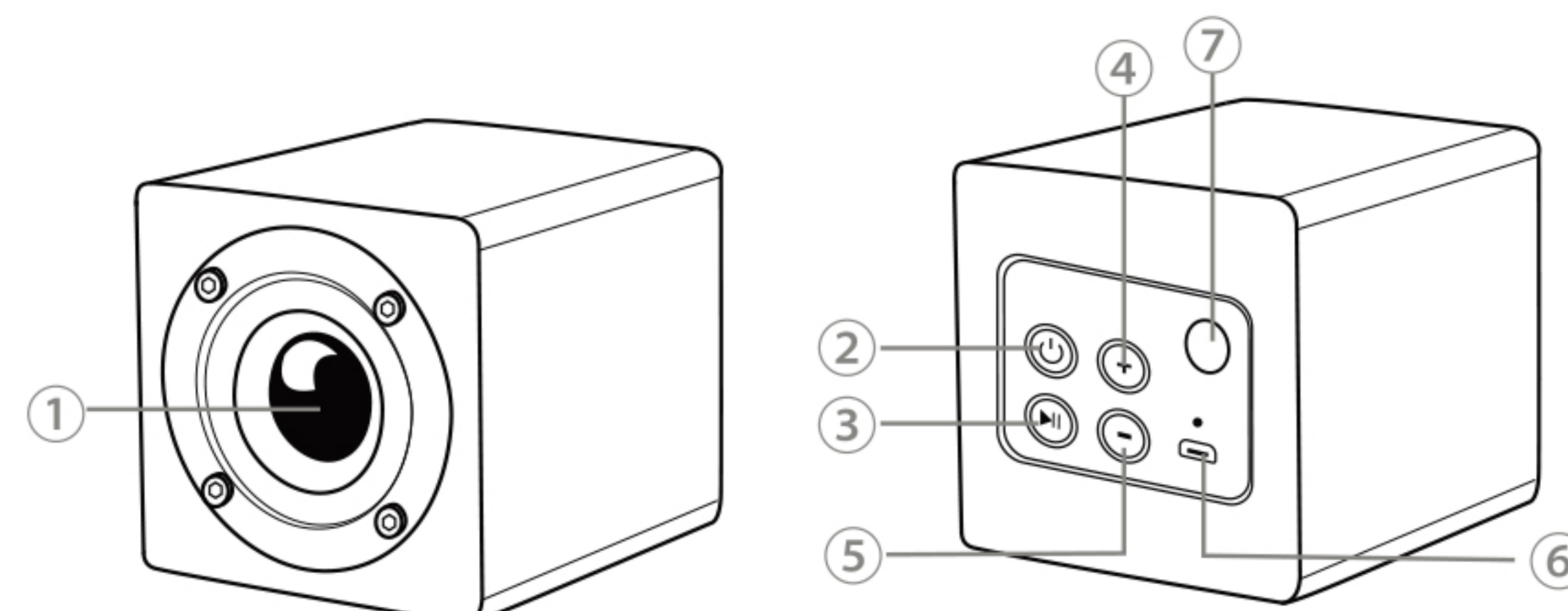

1. Speaker
2. [⏻] Power
3. [⏮] Play/Pause
4. [⏭] Press to advance to next song. Press and hold to increase volume.
5. [⏪] Press to go to previous song. Press and hold to decrease volume.
6. DC 5V charging port.

2

FCC STATEMENT :

This device complies with Part 15 of the FCC Rules. Operation is subject to the following two conditions:

- (1) This device may not cause harmful interference, and
- (2) This device must accept any interference received, including interference that may cause undesired operation.

Warning: Changes or modifications not expressly approved by the party responsible for compliance could void the user's authority to operate the equipment.

NOTE: This equipment has been tested and found to comply with the limits for a Class B digital device, pursuant to Part 15 of the FCC Rules. These limits are designed to provide reasonable protection against harmful interference in a residential installation. This equipment generates uses and can radiate radio frequency energy and, if not installed and used in accordance with the instructions, may cause harmful interference to radio communications. However, there is no guarantee that interference will not occur in a particular installation. If this equipment does cause harmful interference to radio or television reception, which can be determined by turning the equipment off and on, the user is encouraged to try to correct the interference by one or more of the following measures:

Reorient or relocate the receiving antenna.

Increase the separation between the equipment and receiver.

Connect the equipment into an outlet on a circuit different from that to which the receiver is connected.

Consult the dealer or an experienced radio/TV technician for help.

FCC Radiation Exposure Statement:

This equipment complies with FCC radiation exposure limits set forth for an uncontrolled environment. This equipment should be installed and operated with minimum distance 20cm between the radiator & your body.