

### 3. Using Your Amarey A980

#### ① Important Tips Before Using A980

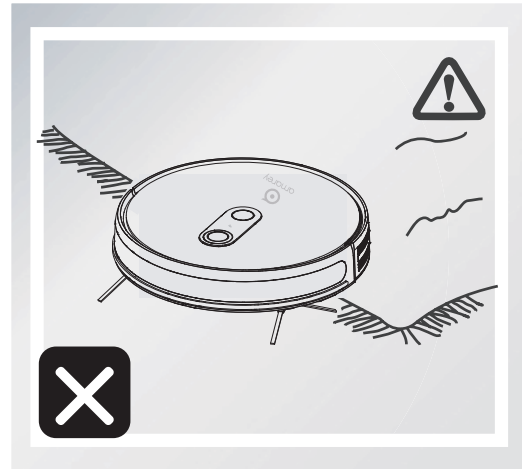

Remove power cords and small objects from the floor that may entangle A980.



A980 is not suitable for use on long-pile carpet. Before using Robot near a short-pile rug with tasseled edges, please tuck the fringe underneath.



Keep A980 away from spaces lower than 3 inches to prevent A980 from getting stuck. If necessary, place a barricade to block off the area or elevate your appliance.



Anti-drop sensors prevent A980 from tumbling down stairs and steep drops. They may work less effectively if dirty or used on reflective/very dark-colored floors. It is recommended to apply the Boundary Strips to block off areas where A980 may fall.

## 2 Preparations

1. Position the Charging Dock on a hard level surface and against a wall.

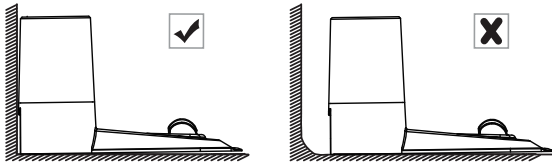

2. Ensure the place is an open & uncluttered area leaving at least:

- 6 feet in front of the Charging Dock.
- 3 feet on both sides of the Charging Dock.

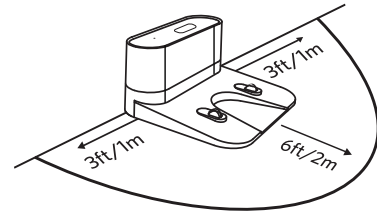

3. Connect the round connector of the adapter into the power socket on the Charging Dock and the other end into a wall outlet.

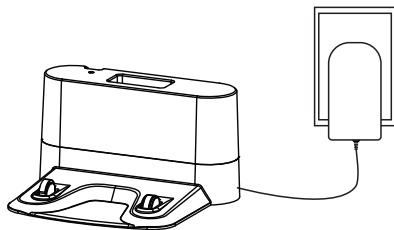

Notice: Please ensure the Charging Dock is plugged in, then Robot can automatically dock.

4. Attach Side Brushes to the bottom of Robot by pressing a brush into each slot until you hear the voice "click" .

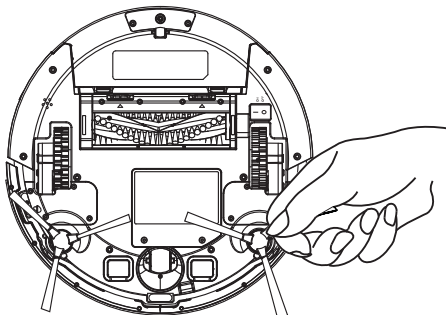

5. Turn on the Main Power Switch at the bottom of Robot. After Robot says "I am ready now" it is ready for use.

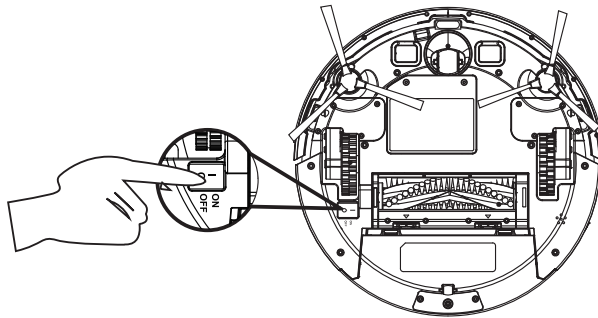

### 3 Charging Robot

Place Robot onto the Charging Dock, ensure the metal Charging Contacts Points on the Charging Dock match up with those underneath Robot. If successful you will hear a "beep". Please charge your Robot for 3.5 hours at least until the light turns blue.

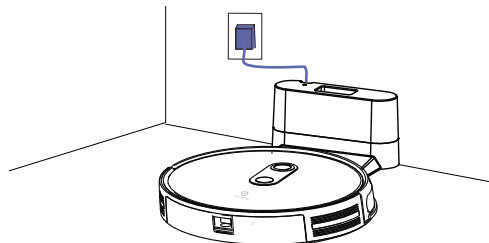

## 4 Download and Install APP

Robot contains remote operations multiple clean mode options battery remaining capacity its current state view, etc through APP. Please download the APP by searching “amarey” on the APP store or Google Play. You also can scan the corresponding QR code, download and install the APP. After the installation of the APP, please register, configure the network and experience Robot by following the APP Operation Guide.

For iOS:





For Android:



## 5 Clean Mode

### 1. Auto Cleaning

Press the  button on Robot (or press the  button on Remote Control or through APP) and Robot says “Start Auto Cleaning”. Robot intensely cleans with its automatic routing.

Before cleaning, ensure Robot's  button lit blue and it is in standby mode. If not, please wake it up firstly by press the  button on Robot or the  button on Remote Control.

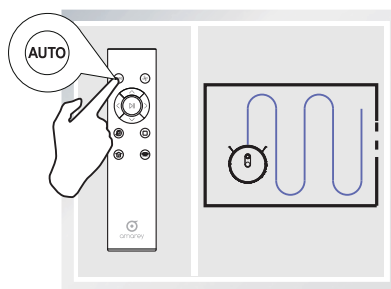
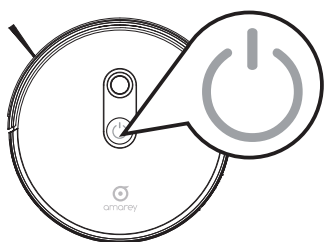

## 2. Spot Cleaning

Press the  button on Remote Control or through APP and Robot says “Start Spot Cleaning” . Robot intensely cleans a localized area. After cleaning is finished, Robot will keep in standby mode.

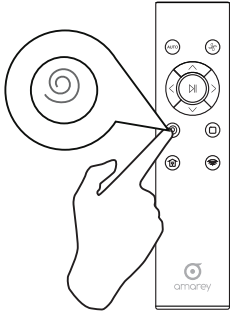

## 3. Edge Cleaning

Press the  button on Remote Control or through APP and Robot says “Start Edge Cleaning” . Robot intensely cleans along walls and around furniture legs. After cleaning is finished, Robot will keep in standby mode.

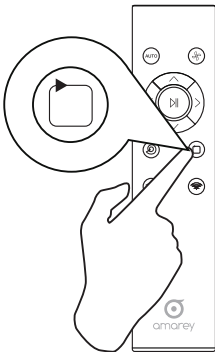

## 4. Schedule Cleaning

You can only set schedule cleaning by APP. Please set schedule cleaning by following the APP Operation Guide.

## 6 Auto Recharge

When the battery level is low, Robot will say “Battery is Low, Returning to Charging Dock” and then return to the Charging Dock to recharge.

Press the  button on Remote Control or through APP, Robot will say “Returning to Charging Dock” and then return to the Charging Dock to recharge.

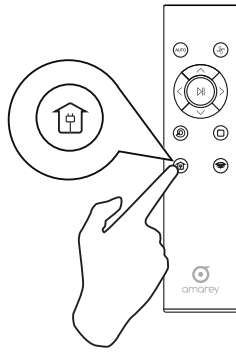

## 7 Power Off

Turn off the Main Power Switch at the bottom of Robot if you will not use Robot for a long time.

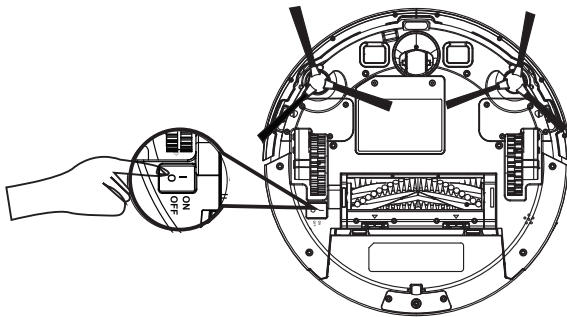

## 8 Use the Boundary Strip

You can cut the boundary strip to a proper length.

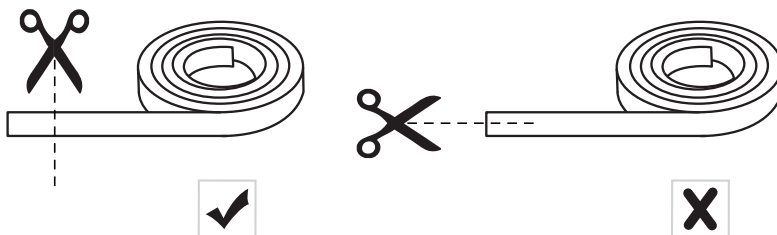

Lay the boundary strips (flat side down) on the floor to block off the space: the Robot recognizes the strips and avoids the area.

Tips: You can use the tape to keep boundary strips flat on the floor

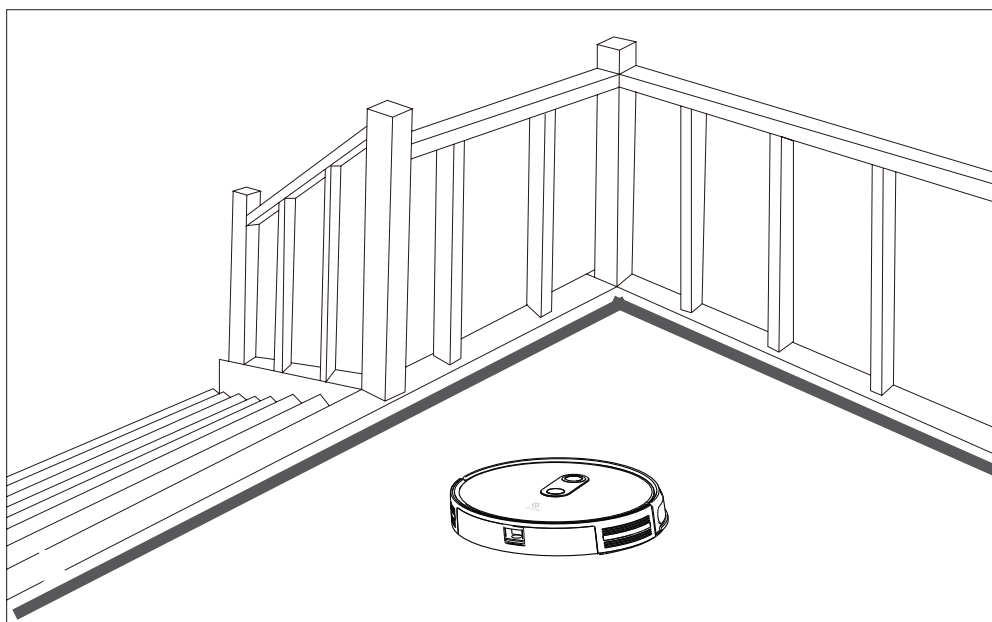

## 4. Amarey A980 Robot Maintenance

To keep Robot running at peak performance, perform the following care procedures.

### 1 Dust Bin

Press Bin Release Button to remove it. Open Dust Bin's door to empty it.

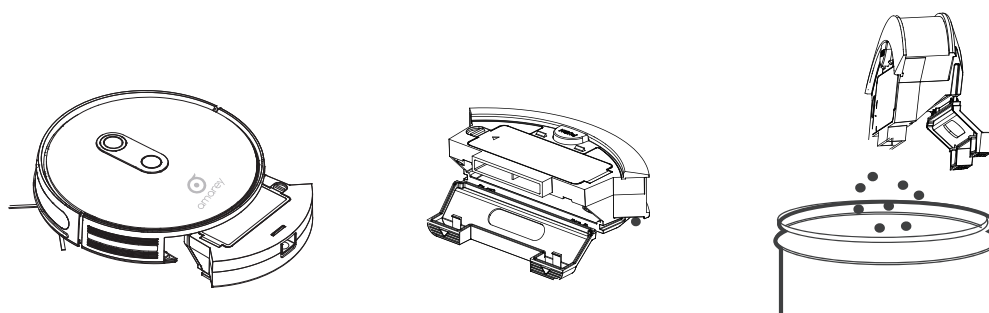

Tips: Clean the Dust Bin after each use.

## 2 Filters

1. Pull the filters out from the Dust Bin. Clean the Dust Bin and filters with provided Cleaning Tool.

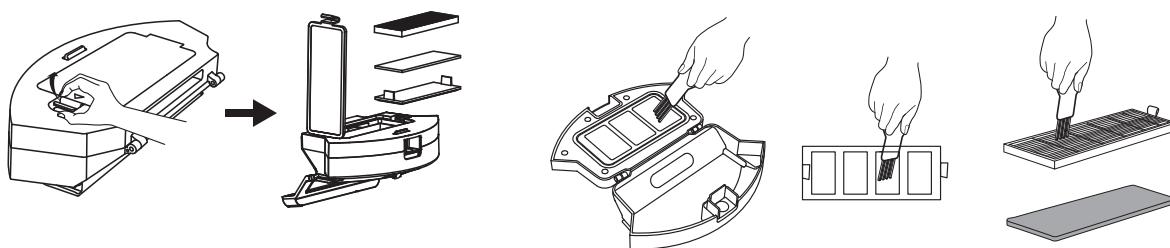

2. Put the filters back together in the Dust Bin.



Tips: Clean the filter once every week and replace it usually every 1-2 months. Pre-filter and sponge filter are washable.

## 3 Rolling Brush

1. Take out the Rolling Brush, clean the vacuuming aisle by a cloth.

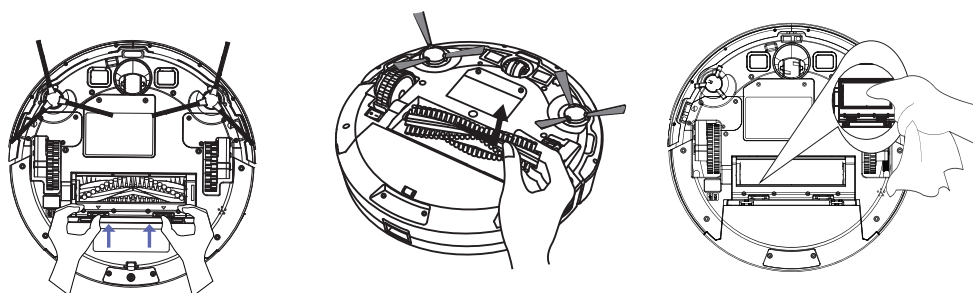

2. Clean the Rolling Brush. Cut down the hair winded in the Rolling Brush with the knife of Cleaning Tool.

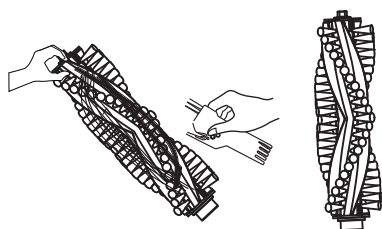



## 4 Side Brush

Cut down the hair winded in the Side Brush with the knife of Cleaning Tool and use a cloth to remove the dust from the brush.

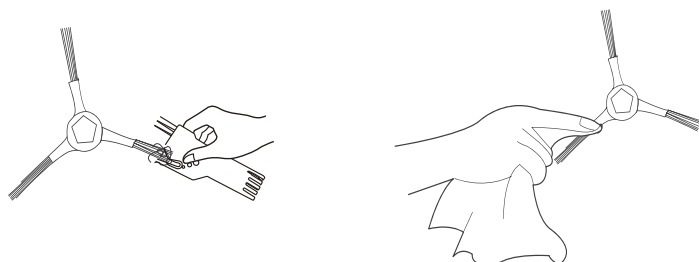

Tips: Clean the Rolling Brush and Side Brush once every week and replace the Rolling Brush usually every 6-12 months and the Side Brush every 3-6 months.

## 5 Swivel Wheel

Pull out the Swivel Wheel, then clean the Swivel Wheel with a cloth.

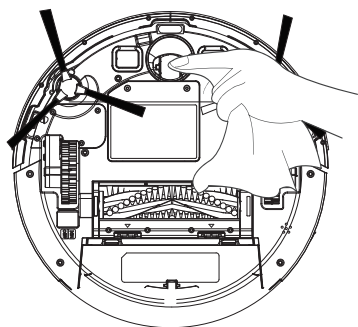

## 6 Senso

Use a cloth to clean sensors to maintain the peak performance.

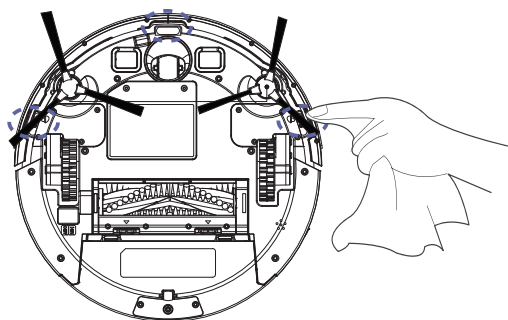

## 5. Troubleshooting

Refer to the chart as below to resolve Robot's problem. If the problem is not resolved, please contact our amarey Customer Service Center for more assistance.

NO.	Problems	Causes	Solutions
1	Robot be charged.	Charging Dock has no electricity.	Ensure the charging cord is plugged into the dock and wall outlet, and the light on the Charging Dock is white.
		The poor connection with the points.	Clean the charging connection points on both Charging Dock and bottom of the cleaner with a dry cloth.
2	Robot gets stuck.	Get stuck by objects.	Pick up objects like clothing, loose paper, pull cords, and fragile objects to avoid Robot stuck before it starts working.
		Get stuck under furniture.	Robot's slimmer body would work with most of the furniture but it still probably stuck. Notice: the lowest height is 3 inches.
		Get stuck on carpet.	Robot is not suitable for use on long-pile carpet. Before using Robot near an area rug or on a prevent on a short-pile area rug with tasseled edges, please fold area rug's edges under themselves to prevent Robot from tangling.
3	Robot can not dock.	Charging Dock has no electricity.	Ensure the charging cord is plugged into the dock and wall outlet, and the light on the Charging Dock is white.
		The location of Charging Dock is not correct.	Position the Charging Dock on a hard level surface (not on a dark-colored surface or high-pile carpet) and in an area where Robot has a clear path to return at the end of a cleaning cycle, not hidden behind a kitchen or other furniture.
4	Remote Control failure.	The batteries are dead.	Replace with new batteries in the Remote Control .
		The Main Power Switch at the bottom of Robot is off.	Turn on the Main Power Switch at the bottom of Robot.
		It is over effective range.	Ensure to aim the Remote Control directly at the Robot within 5m when pressing.
		The Infrared Emitter and the Infrared Receiver are dirty.	Use a dry cloth to wipe the Infrared Emitter on Remote Control and the Infrared Receiver on Robot.
5	Side Brush fell from Robot when working.	Installed incorrectly.	Attach Side Brush to the bottom of Robot by pressing a brush into slot until you hear the voice "click" .
6	Suction power is weak.	The suction inlet is blocked.	Take out Dust Bin and Rolling brush, clean the suction inlet.
		The Dust Bin is full.	Empty the Dust Bin.
		The filters are blocked.	Clean the filters with a cleaning brush, and air-dry the filters completely before use if the filters are wet or change a new filter.

NO.	Problems	Causes	Solutions ou can not
7	Yor can not schedule cleaning.	The Main Power Switch on the bottom of Robot is off.	Turn on the Main Power Switch on the bottom of Robot.
		Power is too low to start cleaning.	Charging Robot.
		The scheduled time have been set incorrectly.	According to APP Operation Guide to set schedule cleaning.
8	Left/right wheel is abnormal.	Left/right wheel is stuck or entangled	Cleān left/right wheel.
9	is abnormal.	Left/right Side Brush is stuck or entangled.	Clean left/right Side Brush.
10	Rolling brush is abnormal.	Rolling Brush is stuck or entangled.	Clean Rolling Brush.
11	Robot is suspended in the air.	Robot is hanging.	Put it down to the ground.
12	Camera is abnormal.	Camera is dirty.	Wipe camera with alcohol cotton ball gently.
13	Bumper is abnormal.	The bumper is not flexible.	Check the bumper.
14	Dust Bin is abnormal.	Dust Bin is installed incorrectly.	Install Dust Bin again.

## 6. Amarey Customer Care

 @amarey.robot

 support@iamarey.com

 @amareyrobot

 <http://www.iamarey.com>

 Amarey Robot

# FCC STATEMENT

1. This device complies with Part 15 of the FCC Rules. Operation is subject to the following two conditions:

(1) This device may not cause harmful interference, and

(2) This device must accept any interference received, including interference that may cause undesired operation.

2. Changes or modifications not expressly approved by the party responsible for compliance could void the user's authority to operate the equipment.

NOTE: This equipment has been tested and found to comply with the limits for a Class B digital device, pursuant to Part 15 of the FCC Rules. These limits are designed to provide reasonable protection against harmful interference in a residential installation.

This equipment generates uses and can radiate radio frequency energy and, if not installed and used in accordance with the instructions, may cause harmful interference to radio communications. However, there is no guarantee that interference will not occur in a particular installation. If this equipment does cause harmful interference to radio or television reception, which can be determined by turning the equipment off and on, the user is encouraged to try to correct the interference by one or more of the following measures:

Reorient or relocate the receiving antenna.

Increase the separation between the equipment and receiver.

Connect the equipment into an outlet on a circuit different from that to which the receiver is connected.

Consult the dealer or an experienced radio/TV technician for help.

## FCC Radiation Exposure Statement

This equipment complies with FCC radiation exposure limits set forth for an uncontrolled environment. This equipment should be installed and operated with minimum distance 20cm between the radiator & your body