



WS-RE01

True Wireless Bluetooth headset+charging capsule
Each Headset can be used separately

Congratulations, and thank you for choosing WS-RE01 Bluetooth earbuds. This manual will help you operate the earbuds, but you should first familiarize yourself with the Bluetooth functionality of your mobile phone or other devices before using the earbuds. To enjoy your time with your product.

Safety rules:

1. People follow the rules described in this manual closely to ensure your safety, we would strongly encourage you to read through this user manual before using this stereo earbuds.
2. Be more wary of any edges, uneven surfaces, metal parts accessories and its packaging so as to prevent any possible injury or damage.
3. Do not modify, repair or dismantle this Bluetooth Stereo earbuds. Doing so may result in fires, electric shocks, complete breakdown of this Bluetooth Stereo earbuds, etc. All of which, are not covered under warranty.
4. Do not use any diluents or volatile liquid to clean the Bluetooth Stereo earbuds.
5. Do not use the Bluetooth Stereo earbuds in a hazardous Location.

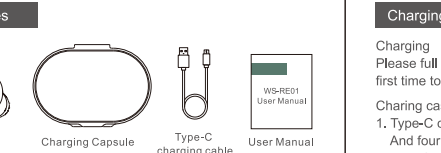

Graphical Representation

1. Charging Case
2. Type C input
3. Charging Pin
4. Tuning Hole
5. Earbuds Charging status LED indicator/Mic
6. Touch control button
7. Charging Case status LED indicator

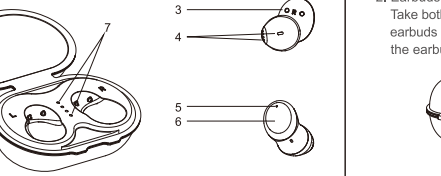

Charging

Charging
Please full charge the charging capsule and earbuds before the first time to use.

Charing case charging
1. Type-C charging port, Blue LED indicator flash while charging
And four blue LED will be solid blue when the charging capsule were fully charged.

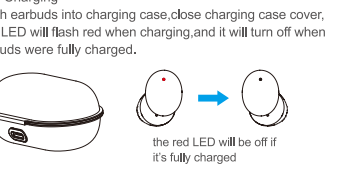
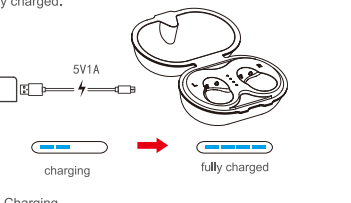

Single headset operation

1 Power on / Power off

Manual Power on:
Press the touch control button about 2 seconds, the LED light will flash blue, you will hear "power on" prompt.

Auto Power on:
Open the charging capsule, the earbud will be discharged and the LED indicator will flash blue, you will hear "power on" prompt.

Manual Power off:
Press and hold the touch control button around 6 seconds, the LED indicator will first flash red and die out later, you will hear "power off" prompt.

Auto Power off:
Cover the earbud with the charging capsule, the charging LED indicator for the earbud will turn to white, the earbud is power off and begin to be recharged, the white LED will die out when the earbud is full charged.

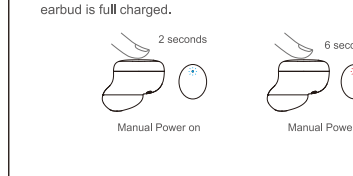
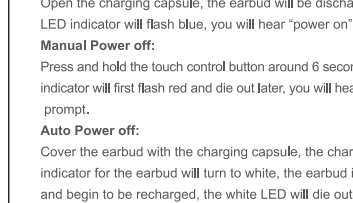

2 Mono Pairing: first time to use

Manual Pairing:
R earbud pair as single/L earbud pair as single:
Press the touch control button around 2 seconds, the earbud will power on with LED indicator flash blue, then double click the touch control button, the LED indicator will turn to flash red and blue alternately and ready for connecting. Turn on the Bluetooth of the device and find the pairing ID "WS-RE01", click it to connect, the LED indicator of the earbud will flash once/twice every 5 seconds, the earbud is connected with the Bluetooth device successfully.

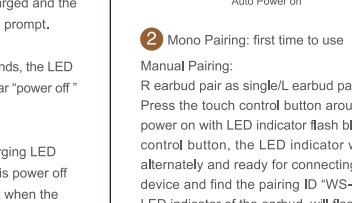

Auto Pairing:
R earbud pair as single/L earbud pair as single:
Put the earbud into the charging capsule, cover the cap and open it later, both earbuds will power on automatically, waiting for seconds and the LED indicators of both earbuds will flash red and blue alternately, put them together and the two earbuds will pairing automatically, when they are paired successfully, one of the earbud will change to flash blue slowly and the other one will flash red and blue alternately, now both earbuds are paired together successfully and they are ready for connecting with the Bluetooth devices. Turn on the Bluetooth of the device and find the pairing ID "WS-RE01", click it to connect, the LED indicator of both earbuds will turn to flash blue slowly, the earbuds is connected with the Bluetooth device successfully.

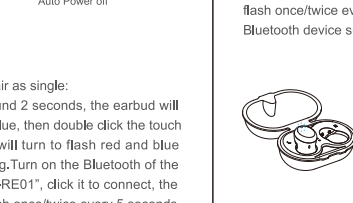

Second time or later use: Press the touch control button around 2 seconds to power on the earbud, it will auto connect with the Bluetooth device which has previous connect record. In pairing mode, single earbud will power off automatically if it can't connect with Bluetooth device in 5 minutes.

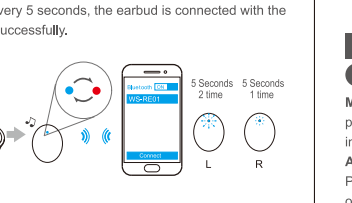

Stereo headset operation

1 Power on

Manual power on:
press the touch control button for about 2 seconds, the LED indicator will flash blue and you will hear "power on" prompt.

Auto power on:
Put the earbuds into the charging capsule and cover the cap, then open the charging capsule, both earbuds will power on automatically and both LED indicators of the earbuds will flash blue.

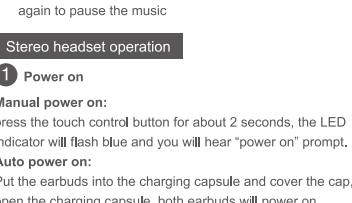

2 Power off:

Manual power off
Press and hold the touch control button around 6 seconds, the LED indicator will first flash red and die out later, you will hear a "power off" prompt and the earbud was turned off. Power off one earbud while both earbuds are working, the other one will connect the Bluetooth device and go on playing, so you should power off both earbuds one by one to power them off.

Auto power off
Put both earbuds into the charging capsule and cover the cap, the earbuds will power off and begin to be recharged

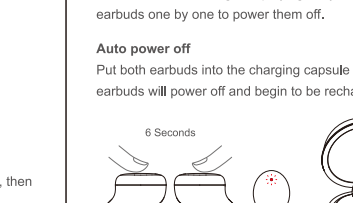

3 Pairing: first time to use

Manual Pairing:
Long press the touch control buttons of both earbuds around 8 seconds until the LED indicator of the earbuds flash blue and red alternately, release the buttons and put the earbuds together to pairing each other, one of the earbud will change to flash blue slowly and the other one will flash red and blue alternately, now both earbuds are paired together successfully and they are ready for connecting with the Bluetooth devices. Turn on the Bluetooth of the device and find the pairing ID "WS-RE01", click it to connect, the LED indicator of both earbuds will turn to flash blue slowly, the earbuds is connected with the Bluetooth device successfully.

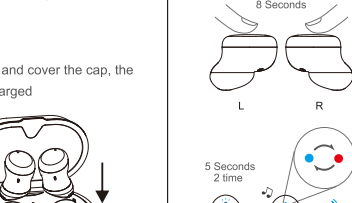

3 Answer a call/End a call:

Tap the touch control button once to answer the incoming call. Tap the touch control button again to end a call.

4 Reject a call:

Double-tap the touch control button to reject the incoming call.

5 Music:

When the earbud is connected with the Bluetooth device, single click the touch control button to play music, single click it again to pause the music

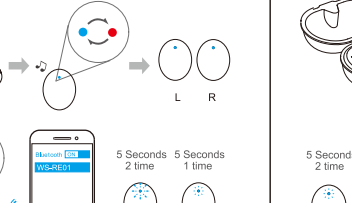

4 Calling

Both earbuds can hear the voice when calling and both button can works. Tap the touch control button once to answer the incoming call. Tap the touch control button again to end a call.

Reject a call: Double-tap the touch control button to reject the incoming call.

Call switching: When there is a second incoming call rings while you are answering a call, just long press the touch button around 2 seconds to keep the first call and switch to answer the second incoming call.

Microphone switching: Triple tap the touch button to switch the using of the microphone between the Bluetooth device and earbuds when you are calling.

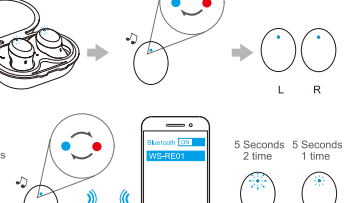

5 Play music

When the earbuds is connected with the Bluetooth device, tap the touch control button once to play music, tap it again to pause the music.

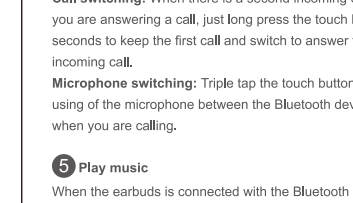

6 Volume+/Volume-

When the earbuds is playing with music, double click the touch control button of the R earbud to increase the volume and double click the touch control button of the L earbud to decrease the volume. There is a prompt to remind you if the volume is increased to the top.

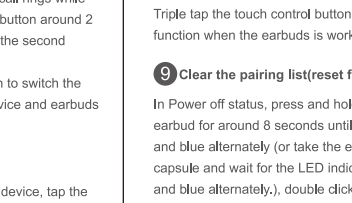

7 Previous song/Next song

When the earbuds is playing with music, press the touch control button of the R/L earbud around 2 seconds to the Previous/Next song. Please release the touch control button once you heard the "Beep" sound, or press another 4 seconds will power it off.

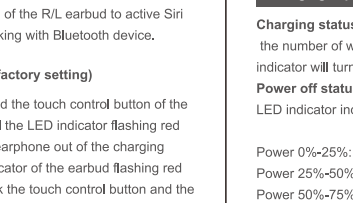

8 Active Siri

Triple tap the touch control button of the R/L earbud to active Siri function when the earbuds is working with Bluetooth device.

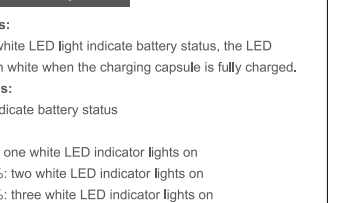

9 Clear the pairing list(reset factory setting)

In Power off status, press and hold the touch control button of the earbud for around 8 seconds until the LED indicator flashing red and blue alternately (or take the earphone out of the charging capsule and wait for the LED indicator of the earbud flashing red and blue alternately.), double click the touch control button and the LED indicator will flash red and blue twice at the same time, reset the factory setting and the earbud will power off after the operation. Remark: Please pair the earbuds again after clearing the pairing list, or it can't be used as TWS.

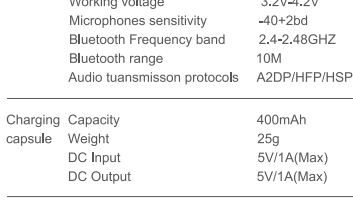

10 Low power alarm

The LED indicator of the earbud will flash red quickly and a prompt of "Low battery, please charge" will remind you to recharge the earbud in a short time, or the earbud will shutdown automatically after several minutes if you ignored the prompt.

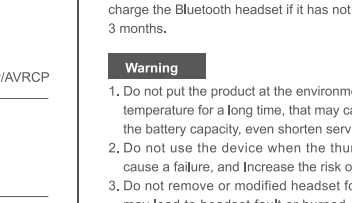

Specifications

Items	Specifications
Headset Battery	Button Cell 60mAh
Earbud Weight	4,7g
Bluetooth Version	V5,0
Working voltage	3.2V-4.2V
Microphones sensitivity	-40+2db
Bluetooth Frequency band	2.4-2.48GHZ
Bluetooth range	10M
Audio transmission protocols	A2DP/HFP/HSP/AVRCP

Charging capsule Capacity: 400mAh
Weight: 25g
DC Input: 5V/1A(Max)
DC Output: 5V/1A(Max)

Power 0%-25%: one white LED indicator lights on
Power 25%-50%: two white LED indicator lights on
Power 50%-75%: three white LED indicator lights on
Power 75%-100%: four white LED indicator lights on

Product Certificate:FCC/CE/ROHS/BQB

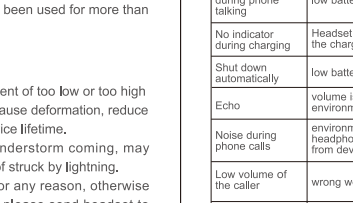

Notice

Please ensure the headset WS-RE01 is in pairing mode (LED indicator of the earbud flash red and blue alternately,) or the mobile will not find the relevant pairing ID to connect it.

Warm tips

You must select a qualified adapter to charge this product. You must charge the Bluetooth headset if it has not been used for more than 3 months.

Warning

1. Do not put the product at the environment of too low or too high temperature for a long time, that may cause deformation, reduce the battery capacity, even shorten service lifetime.
2. Do not use the device when the thunderstorm coming, may cause a failure, and increase the risk of struck by lightning.
3. Do not remove or modified headset for any reason, otherwise may lead to headset fault or burned, please send headset to authorized service center for repairs.
4. Place the device and all accessories out of the reach of children and pets, small parts may be swallowed cause suffocation and serious consequences.
5. Do not put the headset into the water.

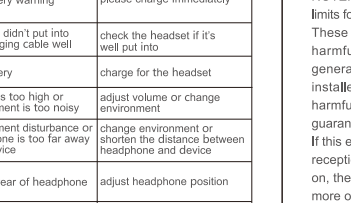

Troubleshooting

Phenomenon	Reason	Solution
Starting-up failure	low battery	charge for the headset
No sound after paired	wrong paired	re-pairing
Red light shines during phone talking	low battery warning	please charge immediately
No indicator during charging	Headset didn't put into the charging cable well	check the headset if it's well put into
Shut down automatically	low battery	charge for the headset
Echo	volume is too high or environment is too noisy	adjust volume or change environment
Noise during phone calls	environment disturbance or headphone is too far away from device	change environment or shorten the distance between headphone and device
Low volume of the caller	wrong wear of headphone	adjust headphone position
Signal is not well interrupting	environment disturbance or headphone is too far away from device	far away from the interference signal or shorten the distance between headphones and device

warranty and support

For more products and supports, please visit our company website: www.difa-tech.com

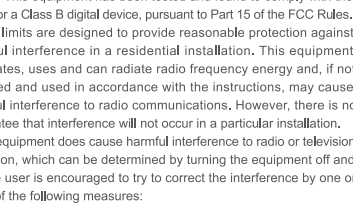

FCC: This device complies with part 15 of the FCC Rules. Operation is subject to the condition that this device does not cause harmful interference (1) this device may not cause harmful interference, and (2) this device must accept any interference received, including interference that may cause undesired operation.

Changes or modifications not expressly approved by the party responsible for compliance could void the user's authority to operate the equipment. NOTE: This equipment has been tested and found to comply with the limits for a Class B digital device, pursuant to Part 15 of the FCC Rules. These limits are designed to provide reasonable protection against harmful interference in a residential installation. This equipment generates, uses and can radiate radio frequency energy and, if not installed and used in accordance with the instructions, may cause harmful interference to radio communications. However, there is no guarantee that interference will not occur in a particular installation. If this equipment does cause harmful interference to radio or television reception, which can be determined by turning the equipment off and on, the user is encouraged to try to correct the interference by one or more of the following measures:

- Reorient or relocate the receiving antenna.
- Increase the separation between the equipment and receiver.
- Connect the equipment into an outlet on a circuit different from that to which the receiver is connected.
- Consult the dealer or an experienced radio/TV technician for help.

The device has been evaluated to meet general RF exposure requirement. The device can be used in portable exposure condition without restriction.

FCC ID: 2A7AL-WS-RE01

