



ChemProX

Handheld Chemical Detector

Quick Reference Guide

Key Elements

- 1. Utility connection
- 2. Color display
- 3. Right button (ON)
- 4. Menu button
- 5. Left button
- 6. Battery clip
- 7. Battery hatch
- 8. Air inlet with rain cap
- 9. Air inlet switch
- 10. LED
- 11. Connection for power and data

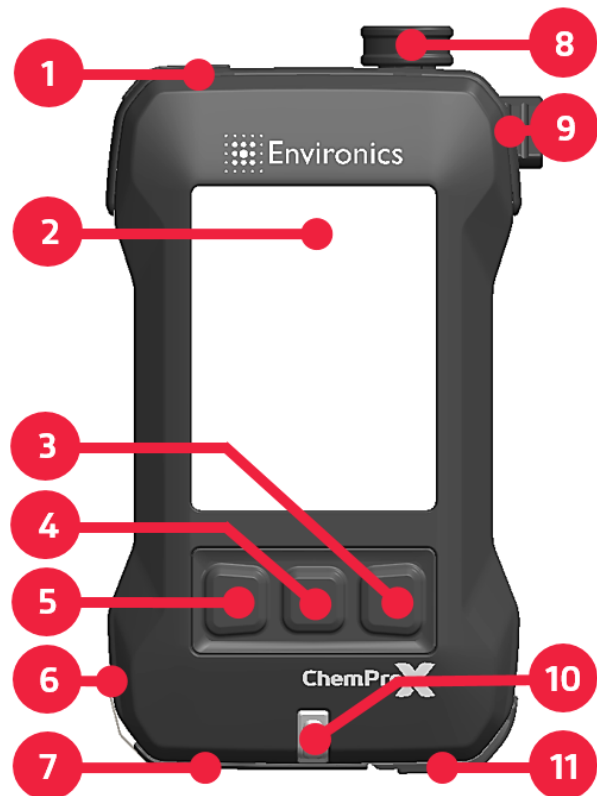

Battery Charging

1. Plug the mains power supply into 110... 240VAC and 50... 60Hz
2. Open the bottom lid
3. Connect the output of the mains power supply to the connector
4. Charge the li-ion battery for approximately 5 hours to achieve full charge

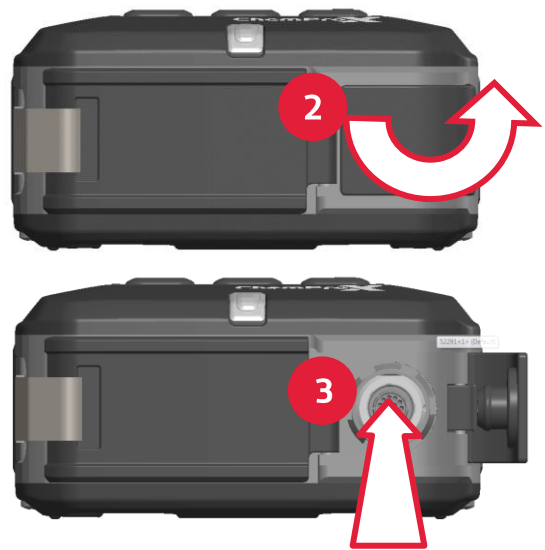

Starting ChemProX

1. Open the air intake by rotating the switch 180° counter-clockwise
2. Start the detector by holding down the right button for 3 seconds
3. Wait for the automatic starting procedures to finish
4. Main display appears

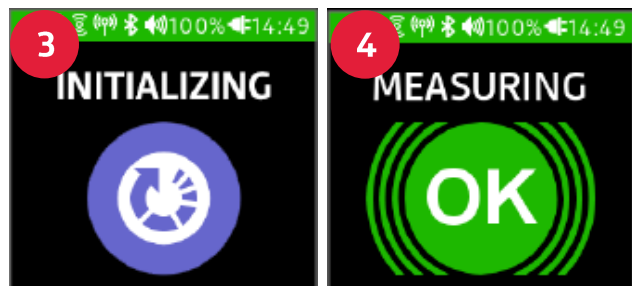

Confidence Check

1. Press middle button and select **Confidence check**
2. Follow the on-screen instructions



Shutting Down ChemProX

1. Hold the right button for 2 seconds
2. Press the middle button confirm the shutdown
3. Let the purge phase complete if asked
4. Close the air inlet by rotating the switch 180° clockwise



Replacing Dust Filter

1. Shut down the detector
2. Open the air intake by rotating the switch 180° counter-clockwise
3. Press the air inlet switch and continue rotating until it loosens up
4. Pull the dust filter out
5. Push a new dust filter in
6. Press the air inlet switch and rotate it clockwise until it tightens
7. Close the air intake by rotating the switch 180° clockwise

