

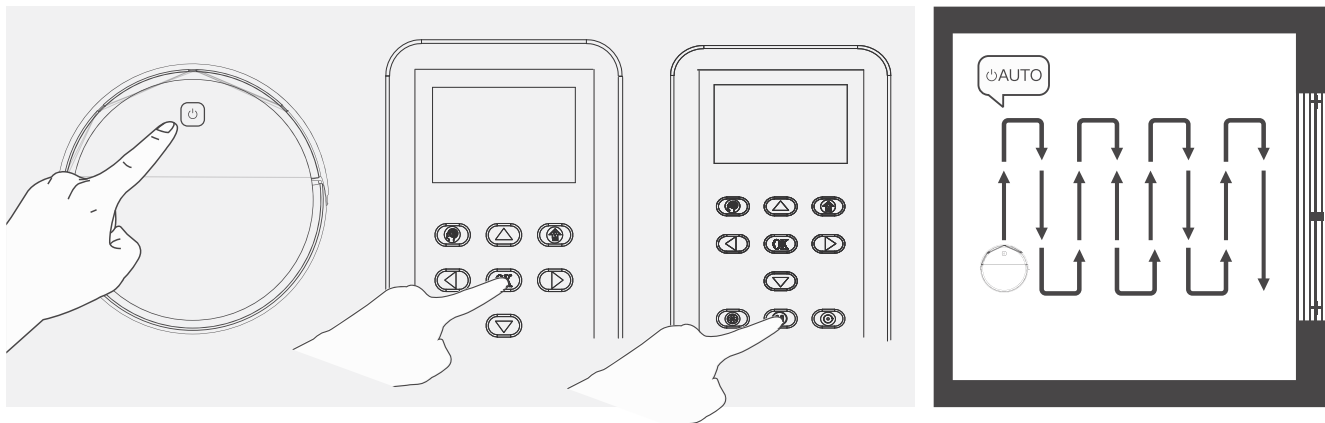



3.Product Composition

Start Cleaning

Start the Automatic Cleaning Mode with the master's  key or remote control  key



Before starting the mode, make sure that the outer ring of the  key is red/blue and the master is in the state of being awakened. If the master does not wake up, short press the master  or remote control  key to wake it up.

The master enters the sleep state after 10 minutes of standby, and the  key light is off.

If you need to select another mode, please refer to the (Mode Selection) section.

Stop Working

While the master is working, press the master  key or remote control and the master will pause.

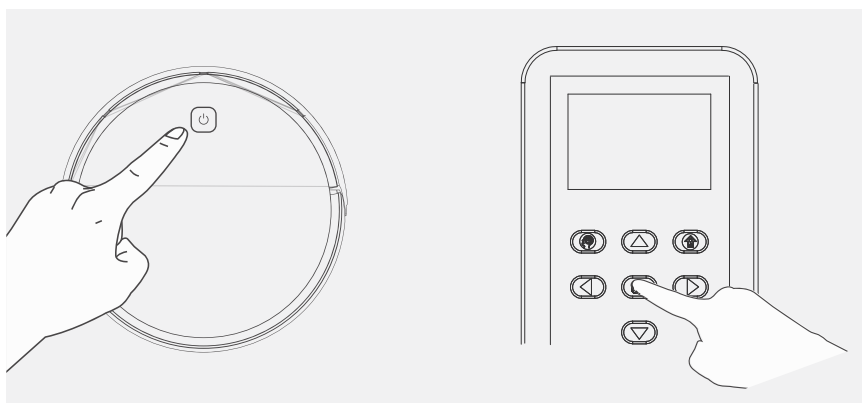



3.Product Composition

3.3Mode Selection

In order to adapt to different ground conditions and achieve deep cleaning, this product has a variety of cleaning modes, which can be selected by remote control as needed.

The remote control can switch any mode directly.

Before starting the mode, make sure that the outer ring of the  key is red/blue and the master is in the state of being awakened. If the master does not wake up, short press the master  or remote control  key to wake it up.

Fixed-Point Mode

It is suitable for the ground environment where the garbage is concentrated. The master centralized cleaning in the designated area, and master centralized cleaning with the “spiral” route. After the diameter is 1m, the machine returns to the original point. If the obstacle is encountered in the middle, the spiral is cleaned for 2 minutes

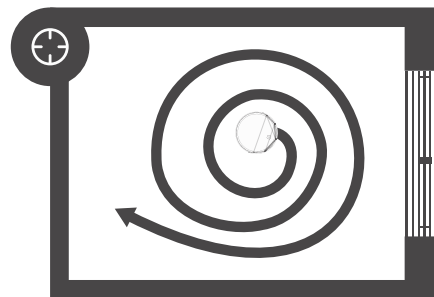
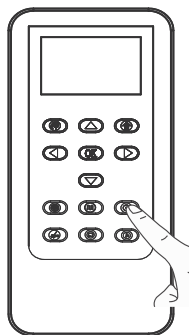

Edge Mode

It is suitable for cleaning at the corners of the room. The master is cleaned around the periphery of a fixed object (such as a wall) and cleaned back to the charging stand.

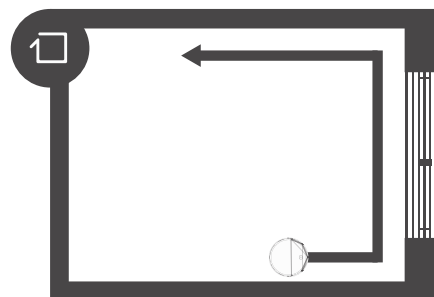
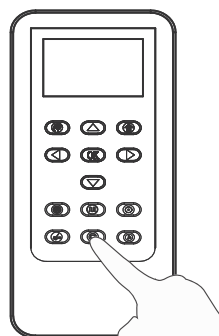

Return Charging Mode

It can also be commanded by the button on the remote control to start the “return charging” mode. During the cleaning process, the master can sense that its own power is insufficient, and automatically start the “return charging” mode, and automatically find the charging stand for charging.

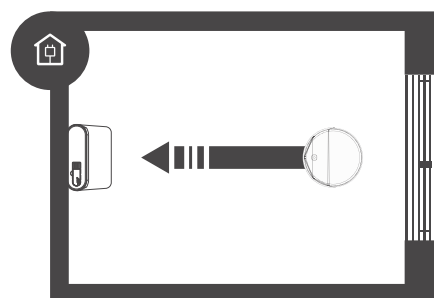
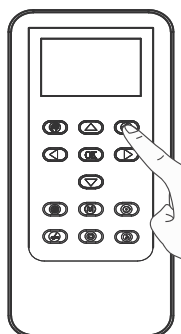

3.Product Composition

Turbo Mode

Robot will increase suction. Suitable for a very dirty floor or a thick carpet.



Turbo mode

cannot be accessed while using the mop cleaning method.

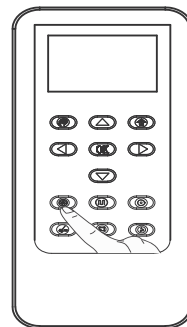

Time and Date Settings

1. Programming the Time and Date

a . Settings of current week day:

In the standby mode, press the "●" button to enter the setting of current week day; press the "◀" "▶" buttons to switch Monday/Sunday; press the "OK" to save the current week day and enter the setting of current hour/minute.

b .Settings of current hour/minute:

After the settings of current week day is done, then enter the specific settings of current hour/minute.

press the "◀" "▶" buttons to switch hour/minute.

press the "▲" buttons to increment the current time, and press the "▼" button vice versa;

press the "OK" buttons to save the current hour/minute.

2. Scheduling a Routine Cleaning

a . Settings of Schedule week day:

In the standby mode, press the "●" button on the remote controller 4 seconds to enter the settings of schedule week day; press the "◀" "▶" buttons to switch Monday/Sunday; press the "OK" to save the appointed week day and enter the setting of appointed hour/minute. After the settings of schedule week day is done, press the "▲" button on the remote controller to save, press the "▼" button on the remote controller to cancel, then press the "OK" button on the remote controller to save, enter the settings of appointed hour/minute.

b . Settings of Schedule hour/minute:

Press the "◀" and "▶" buttons to switch hours/minute;

Press the "▲" buttons to increment the appointed time, and press the "▼" button vice versa;

Press the "OK" buttons to save the setting of appointed hour/minute.

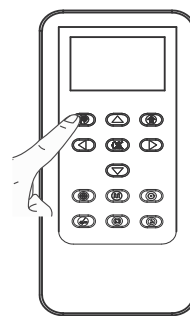

3.Product Composition

3.4Use of Water Permeable Rag

This product is equipped with a water tank assembly. After the cleaning work is completed, if there is a demand for mopping, the dust box can be replaced with a water tank assembly. For the cleaning method, please refer to the [Maintenance] section in this manual.

Do not use the water tank assembly on the carpet. When cleaning with the rag function, fold the edge of the carpet to avoid foreign matter on the rag from soiling the carpet.

In the cleaning, please pay attention, add water or clean up in time, remove the water storage box when adding water. When charging, be sure to remove the water permeable wiper assembly.

■ Add Water

Open the water inlet cover and take enough water.

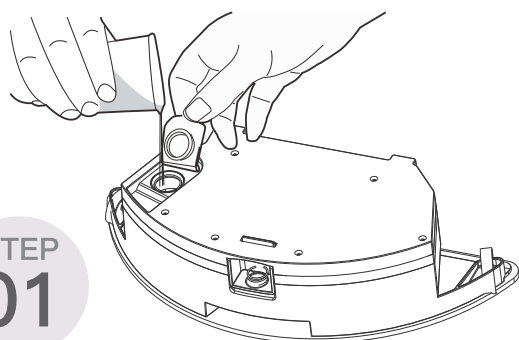

■ Sticking The Water Rag

Close the water inlet cover and stick the water rag.

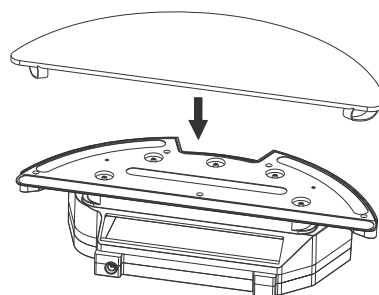

■ Install Water Tank Assembly

Press the dust box release button at the rear of the master to remove the dust box and replace the water tank assembly.

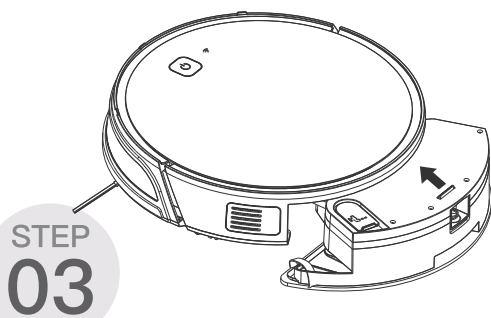

■ Mop

Start any cleaning mode as needed, and the master will perform cleaning and mopping.

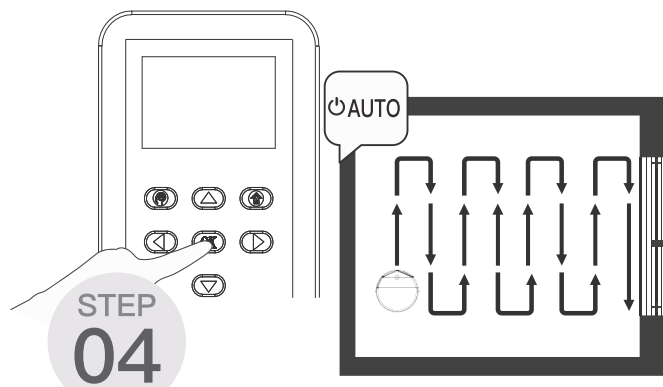

3.Product Composition

3.5Roller Brush Assembly and Sucking Assembly

Assembly Choices

Roller brush assembly:

Scratch the floor, sweep and suck dust effectively.

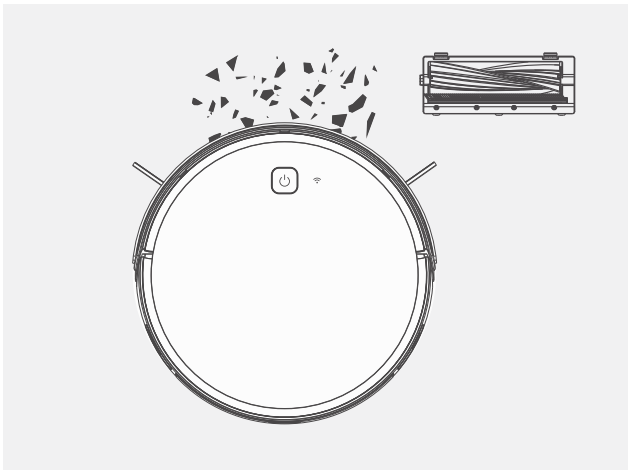

Set sucking parts: take Aout roller brush cover board and brush first, and change suction cover board and then press to lock.



Set roller brush assembly: take out sucking assembly first, set the roller brush and cover the board and then press to lock.



4.Maintenance

4.1Dust Box and Filter

When cleaning and maintaining the master and its accessories, turn off the master and unplug the charging stand.

- Remove the dust box, open the dust box cover, and clean the garbage;

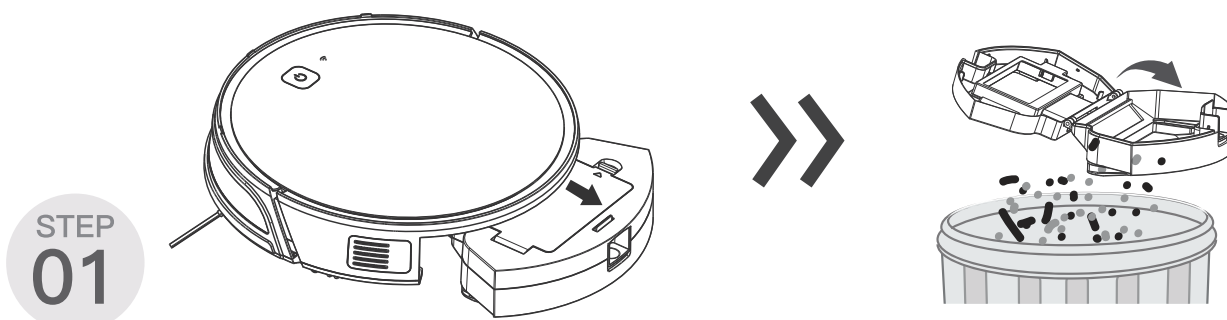

- Remove dust filter. HEPA is not recommended for washing. Please pat and remove ash.

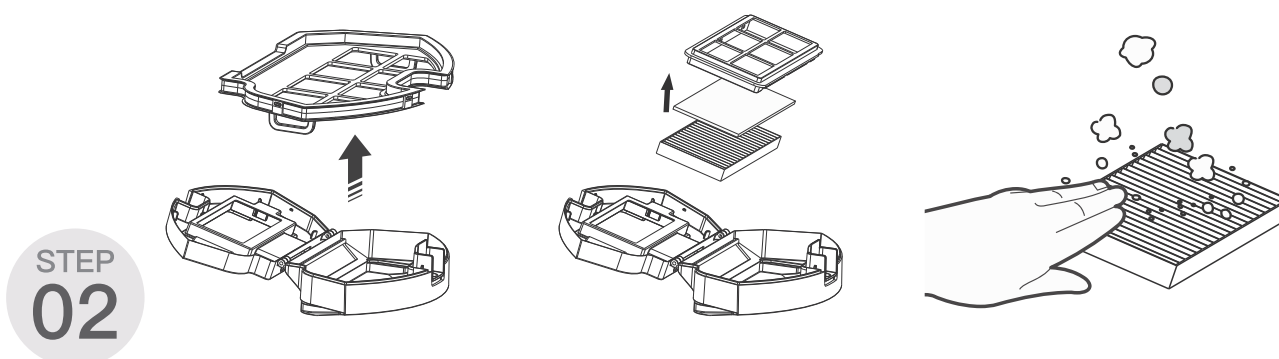

- Flush the dust box and the primary filter;

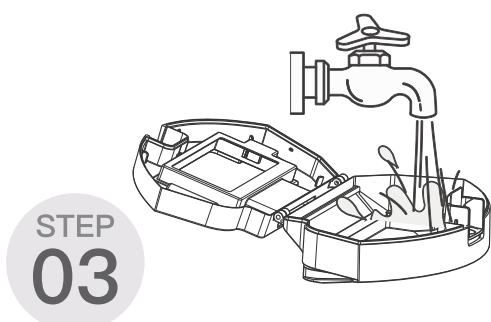

- Dry the dust box and dust filter assembly and keep it dry to ensure its service life.

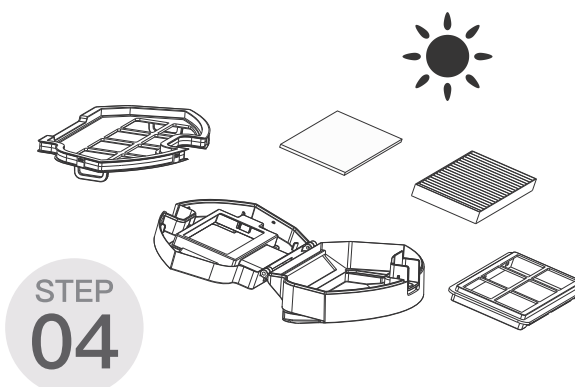

4.Maintenance

4.2Water Tank Assembly

Cleaning Of Water Rag

- **Remove:** After the mopping is completed, remove the water tank assembly and remove the water permeable rag.

STEP
01

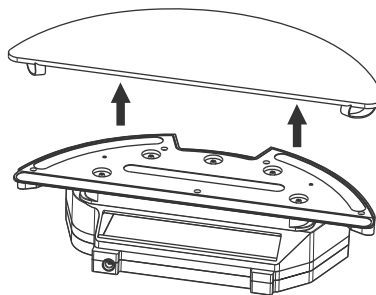
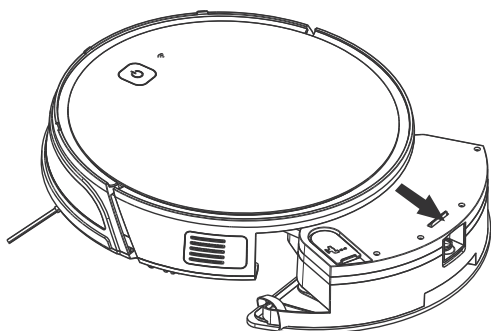

- **Maintenance:** Rinse and dry the water rag

STEP
02

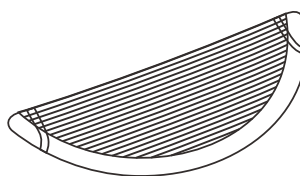

■ Cleaning The Water Reservoir

Remove: After mopping the floor, remove the water tank assembly, remove the water permeable cloth, and pour off the remaining water in the water reservoir.

Maintenance: Dry the reservoir and allow it to dry.

STEP
03

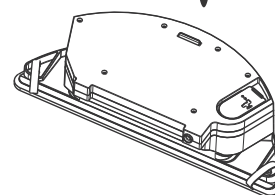
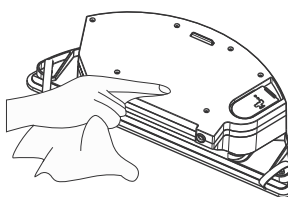
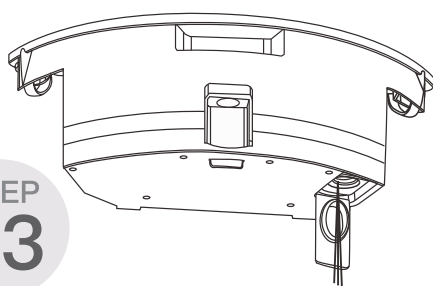

4.Maintenance

4.3Rolling Brush、 Suction Port、 Side Brushes

■ Cleaning Rolling Brush

Remove the rolling brush cover plate, remove the rolling brush, cut off the hair wound on the rolling brush, and facilitate cleaning.

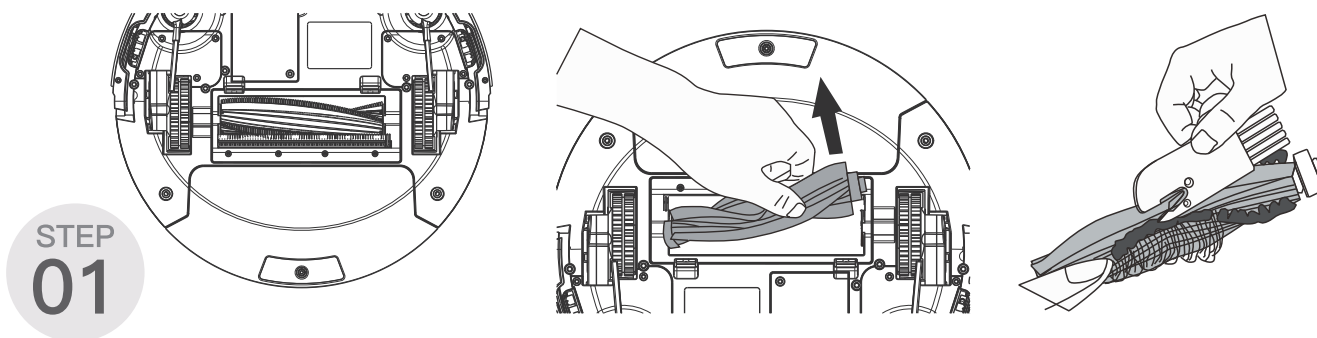

■ Cleaning Suction Port

If there is more dust on the suction port, please use a rag to clean it.

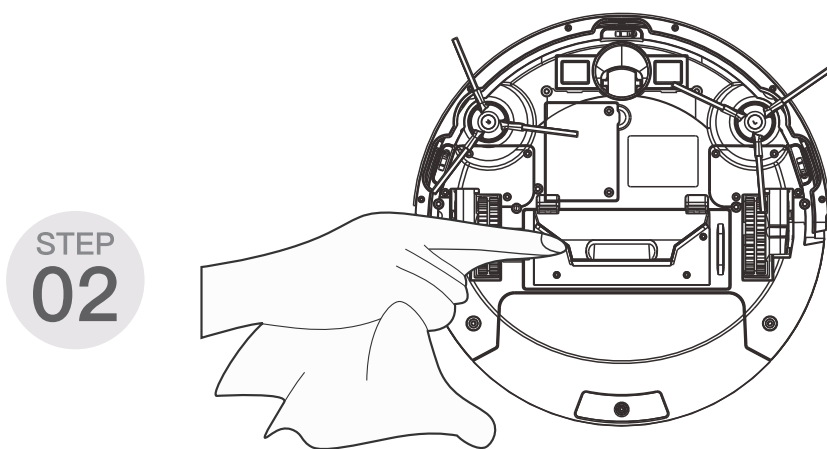

■ Cleaning Side Brushes

Pull out the side brush and wipe it with a clean rag.

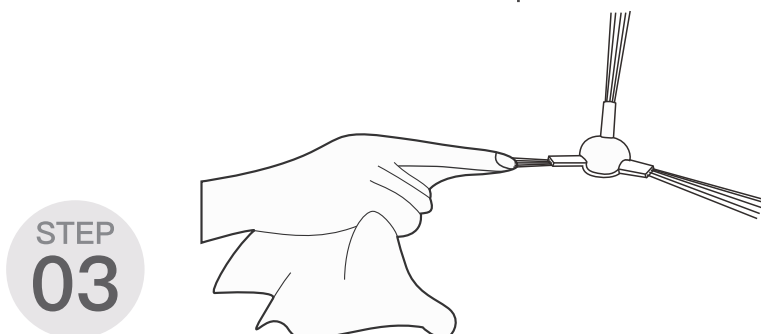

4.Maintenance

4.4Other Assembly

- Clean the universal wheel to reduce hair entanglem.

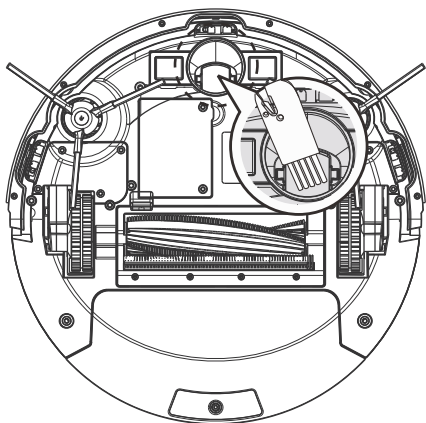

- Clear down the sensor to ensure the sensitivity of the sensor.

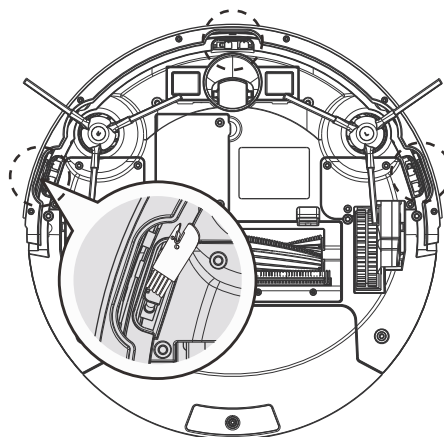

- To clean the charging pole pieces, use a dry rag to clean the charging poles on the bottom of the master or the charging stand

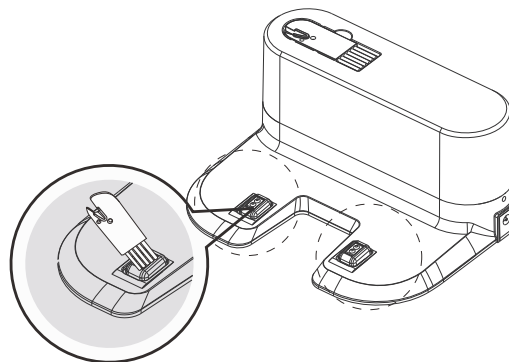
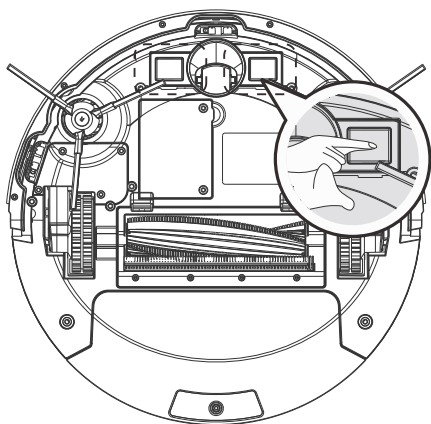

Do not use this product for a long time, please remove the battery and keep it in a safe place. If the battery leaks, remove the battery and wipe the battery compartment clean.

This product uses a high-life battery and does not require frequent replacement. If you need to replace, you can contact our company for after-sales service replacement.

5. Lighting Effects And Alarm Tips

5.1 Lighting Effects

Cleaner status	AUTO Display Status
Cleaner stop cleaning	Blue lamp light on
Start auto charge	Purple & blue lamp light on
Start to Spiral clean	Blue lamp light on
Start to wall follow cleaning	Blue lamp light on
Start recharging	Blue lamp flash
Start zigzag clean	Blue lamp light on
Switch on	Blue lamp light on (red lamp means low power)
Start to mopping mode	Blue lamp light on
Low power, Start to auto charge	Blue lamp light on
Press any direction button	"non"
Connect wifi	Blue lamp flash
Connect successfully	Blue lamp light on

5. Lighting Effects And Alarm Tips

5.2 Alarm Tips

When the host fails, the red light of the outer ring of the host key flashes, and the buzzer sounds of different lengths will be emitted. Refer to the following table to check the cause of the fault:

Cleaner status	AUTO Display Status	Solution
Side brush error	Red lamp light on two sounds three times	Please check if the side brush is entangled and clean the side brushes
Fan motor error	Red lamp light on three sounds three times	Please check the garbage and air duct outlet
Main brush error	Red lamp light on four sounds three times	Please check if the roller brush is entangled and clean the roller brush
Dustbin error	Red lamp light on five sounds three times	Please check whether dustbin put in position
Ground sensor error	Red lamp flash two sounds three times	Clean the cliff sensor ground detector or manually pick up the cleaner if wheel are not on the floor
Cleaner trapped	Red lamp flash three sounds three times	Please move to the open space
Low power, need charge manually	Red lamp flash four sounds three times	Manually move the cleaner back to the dock station recharging
Adapter failuer	Red lamp flash five sounds three times	Please use 19V 0.6A adapter for charging
Frcnt bumper error	Red lamp flash one sound three times	Push heavily the front bumper, then check whether the front bumper can bounces back

Tips

If the above method does not solve the problem, please try the following:
Re-open the power switch on the side of the master and restart the machine.

6.FAQ

If the following problems occur during the use of the product, you can solve it yourself by checking the queries.

No	Cause of Failure	Probable Reasons	Solution
01	Master cannot be charged	The master is not in full contact with the charging pole of the charging stand.	Make sure that the master is fully docked with the charging poles of the cradle.
		The charging stand power is turned off and the main power switch is turned on, resulting in power loss.	When the master does not work, it is recommended to keep it in charge so that it can carry out the next work better
02	The master is in trouble when working	The master is entangled or obstructed by scattered wires on the ground, drape curtains or carpet edges.	The master will try various ways to get rid of difficulties, if you are not able to get out of trouble, it is recommended to help manually
03	After the cleaning is completed, the host returns to charging.	When the master is working, it can sense that the battery is low and automatically returns to charging.	Charge the master
		Wooden floor, tile and other flat ground master speed and time difference	The working time of the master varies depending on the complexity of the room, the amount of garbage and the cleaning mode.
04	The master did not automatically clean up according to the appointment time	The master power switch is not turned on, and the master is in the off state to clear the reservation information on the master side.	Turn on the power switch of the master, reconnect the network and use the APP to determine the reservation information.
		The master is low on battery.	When the master is in standby, it should be kept on the charging stand to ensure that it has sufficient power to work at any time.
		The master is clogged and tangled by garbage	Turn off the power and clean the dust box with the bottom of the master facing up. Clean each part separately.
05	The remote control is out of order (the remote control has an effective control range of 5 meters)	The remote control is low on battery.	Replace the battery with a new one and install it properly.
		Master power switch is not turned on or master is not enough power.	Make sure the master power switch is turned on and has sufficient power to complete the operation
		The infrared emission of the remote control or the master receiver is dirty and cannot transmit or receive signals.	Wipe the infrared emitter of the remote control and the infrared receiver of the master with a clean cotton cloth.
		There is a device interference signal that generates infrared rays near the master.	Avoid using the remote control near other infrared devices.

FCC Instructions:

This product has been tested and found to comply with the limits for a Class B digital device, pursuant to Part 15 of the FCC Rules. These limits are designed to provide reasonable protection against harmful interference in a residential installation. This product generates, uses and can radiate radio frequency energy and, if not installed and used in accordance with the instructions, may cause harmful interference to radio communications. However, there is no guarantee that interference will not occur in a particular installation. If the product does cause harmful interference to radio or television reception, which can be determined by turning the equipment off and on, the user is encouraged to try to correct the interference by one or more of the following measures:

- Reorient or relocate the receiving antenna.
- Increase the separation between the product and receiver.
- Connect the product into an outlet on a circuit different from that to which the receiver is connected.
- Consult the dealer or an experienced radio/TV technician for help.

This device complies with Part 15 of the FCC Rules. Operation is subject to the following two conditions:

- (1) this device may not cause harmful interference, and
- (2) this device must accept any interference received, including interference that may cause undesired operation.

Warning: Changes or modifications not expressly approved by the party responsible for compliance could void the user's authority to operate the product.

FCC Radiation Exposure Statement:

The equipment complies with FCC Radiation exposure limits set forth for uncontrolled environment. This equipment should be installed and operated with minimum distance 20cm between the radiator and your body.