

Robotic Vacuum Cleaner

User Manual

Please read the instructions carefully before using this product and keep it properly.

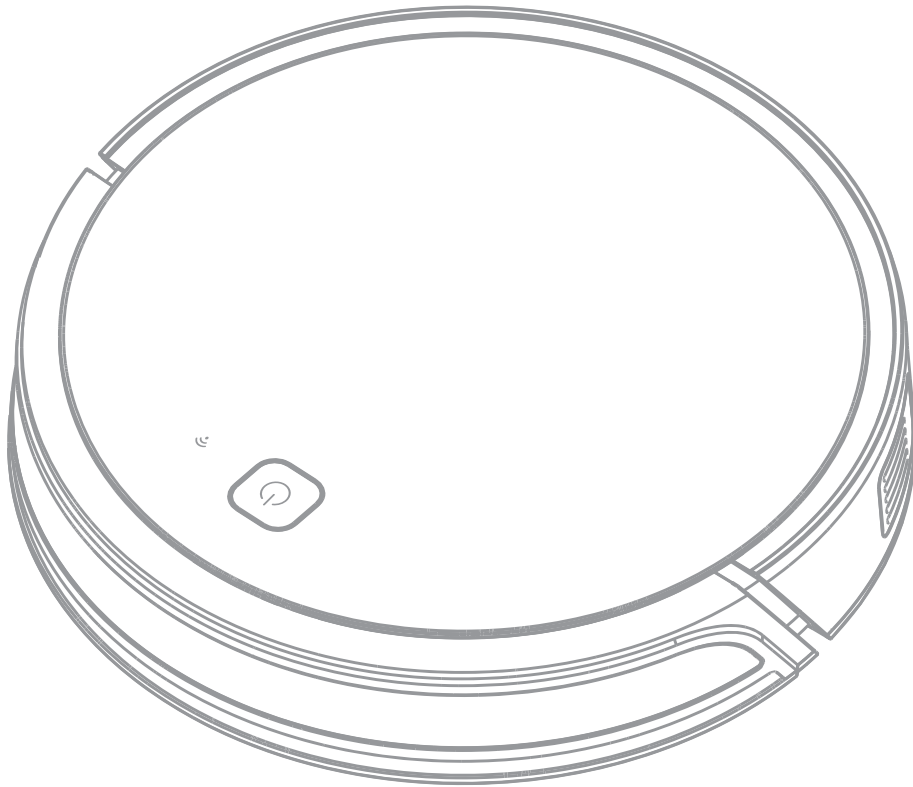

Intelligent technology for professional cleaner

CONTENT

1.Safety Regulations	3
2.Product Composition	4
2.1Component Name	4
2.2Technical Parameter	7
3.Product Instructions	8
3.1Considerations	8
3.2Rapid Operation	9
3.3Mode Selection	12
3.4Use of Water Permeable Rag	14
3.5Roller Brush Assembly and Sucking Assembly	15
4.Maintenance	16
4.1Dust Box and Filter	16
4.2Water Tank Assembly	17
4.3Rolling Brush、Suction and Side Brushes	18
4.4Other Assembly	19
5.Light Effect And Alarm Tips	20
5.1Light Effect	20
5.2Alarm Tips	21
6.FAQ	22

1.Safety Regulations

When using the product, please keep your vigilance and follow below information
Please read the manual carefully before using the product. Please keep instruction

- 1) Products cannot be used by children under 8 years of age or people with mental disabilities. If you need to use it, please do so under the supervision of the guardian. Please do not let children ride on the product or play the product as a toy.
- 2) Problems that may arise in cleaning products should be eliminated as early as possible. Clean the power cords and small items on the floor to prevent the product from being blocked during the cleaning process. Fold the edge of the carpet to the underside of the carpet, and keep the hanging curtains, tablecloths, etc. from touching the ground.
- 3) If there is a suspended environment such as a staircase, test the product first to see if it can detect the edge of the suspended area without falling. Protective barriers should be installed at the edge of the suspended area to prevent falling products. Make sure that the protective equipment does not cause personal injury.
- 4) Please follow the manual instructions to use the product. Use only accessories recommended or sold by the manufacturer.
- 5) Ensure that the power supply voltage meets the voltage indicated on the cradle
- 6) Used only in indoor home environments. Do not use in outdoor, commercial or industrial locations.
- 7) Use only original rechargeable batteries and charging docks that are unique to the manufacturer. Do not use non-rechargeable batteries. For battery specifications, please refer to "Technical Data".
- 8) Ensure that dust boxes and filter materials are installed before using products.
- 9) Use of the product in an environment with open flames or fragile items is prohibited.
- 10) Do not use the product in extreme heat (above 40 ° C) or very cold (below -5 ° C).
- 11) It is forbidden to close the body's hair, clothes, fingers and other parts close to the opening and operating parts of the product.
- 12) Do not use the product in a room where infants sleep.
- 13) Do not use the product on wet or watery ground.
- 14) It is forbidden to absorb any items such as stones, waste paper and any other products that may block the product.
- 15) Do not allow the product to absorb any flammable materials such as toner, toner or toner for printers or copies. Do not use the product in a clean area with flammable materials.
- 16) Do not take any product that is burning, such as cigarettes, matches, ash, or other items that may cause a fire.
- 17) Do not place items at the suction outlet. Do not use products when suction is blocked. Clean dust, cotton wool, hair, etc. at the suction port to ensure smooth air circulation at the suction port.
- 18) Use the power cord carefully to avoid damage. Do not use the power cord to drag or pull the product and the product charging stand. Do not use the power cord as a handle. Do not clamp the power cord into the door seam. Do not pull the power cord at sharp corners and corners. Do not operate the product on the power line, and the power cord should be kept away from heat.
- 19) If the power cord is damaged, it must be replaced by a manufacturer, a professional in its maintenance department or a similar department to avoid danger.
- 20) Do not use the damaged charging stand.
- 21) Do not use the product with a damaged power cord or power outlet. Do not use the product when it is not working properly due to dropping, damage, outdoor use or water ingress. To avoid injury, the product should be repaired by the manufacturer or its after-sales service.
- 22) Turn off the product switch before cleaning and maintaining the product.
- 23) The plug must be unplugged from the power outlet before cleaning and maintaining the product.
- 24) Before discard of the product, remove the product from the charge stand, turn off the product power switch, and remove the battery.
- 25) The product battery must be removed and discarded in accordance with local laws and regulations before disposing of the product.
- 26) Please dispose of used batteries in accordance with local laws and regulations.
- 27) Even if the product has been severely damaged, it is forbidden to incinerate the product, and the product battery may cause an explosion.
- 28) If you do not use the product for a long time, please turn off the product.
- 29) Please follow the instructions in the manual to use the product. The company is not responsible for any loss or damage caused by improper use.

2.Product Composition

2.1Assembly Name

► Master

Key (Start or Pause)

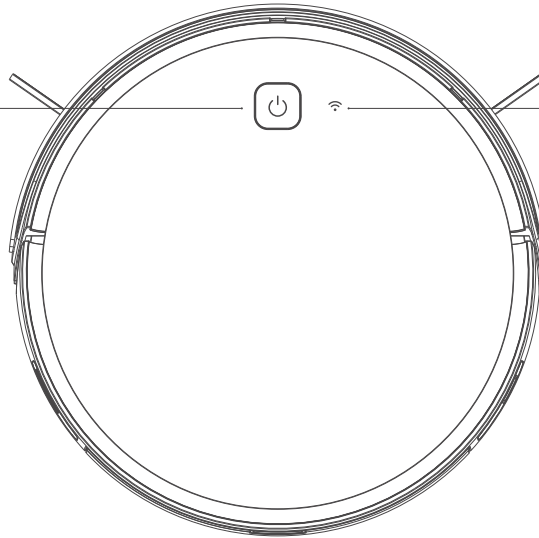

Wifi Indicator Light

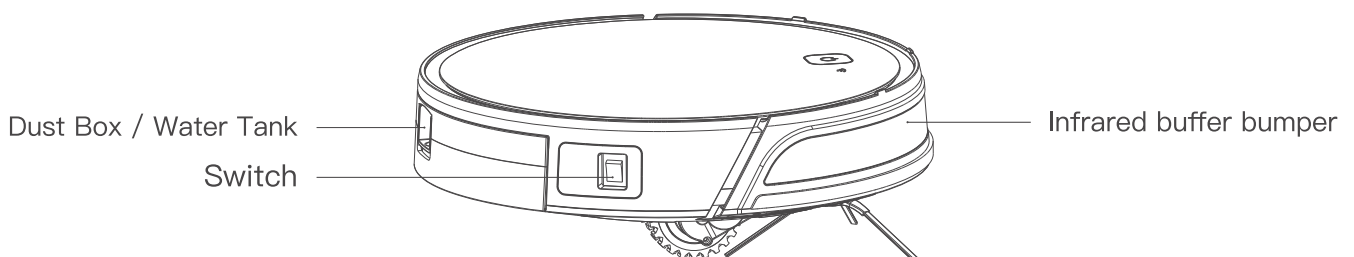
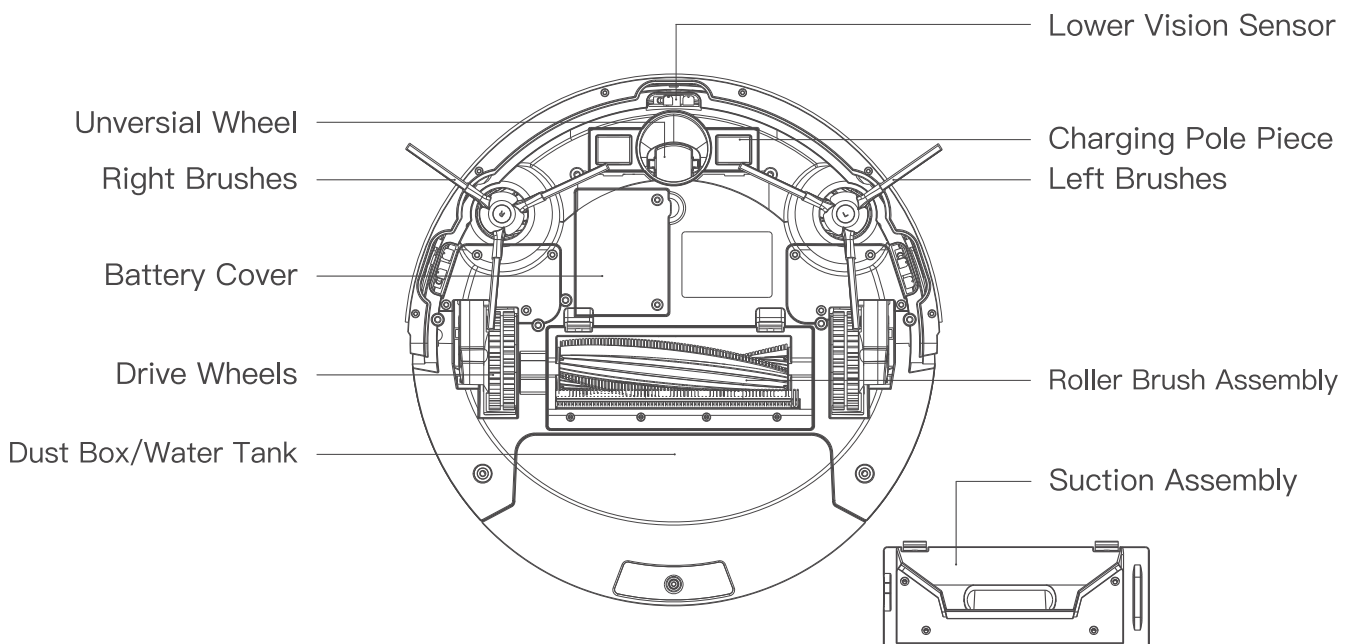

2.Product Composition

► Charging Stand Assembly

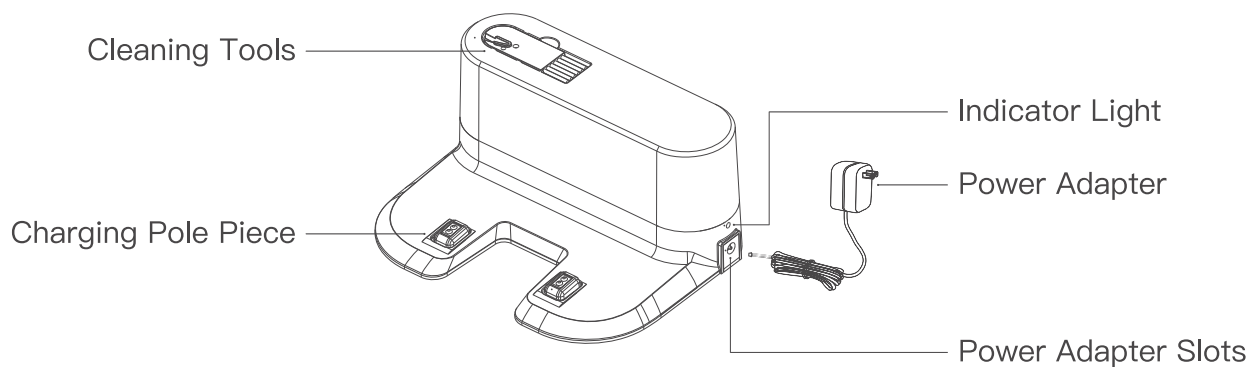

► Remote Control

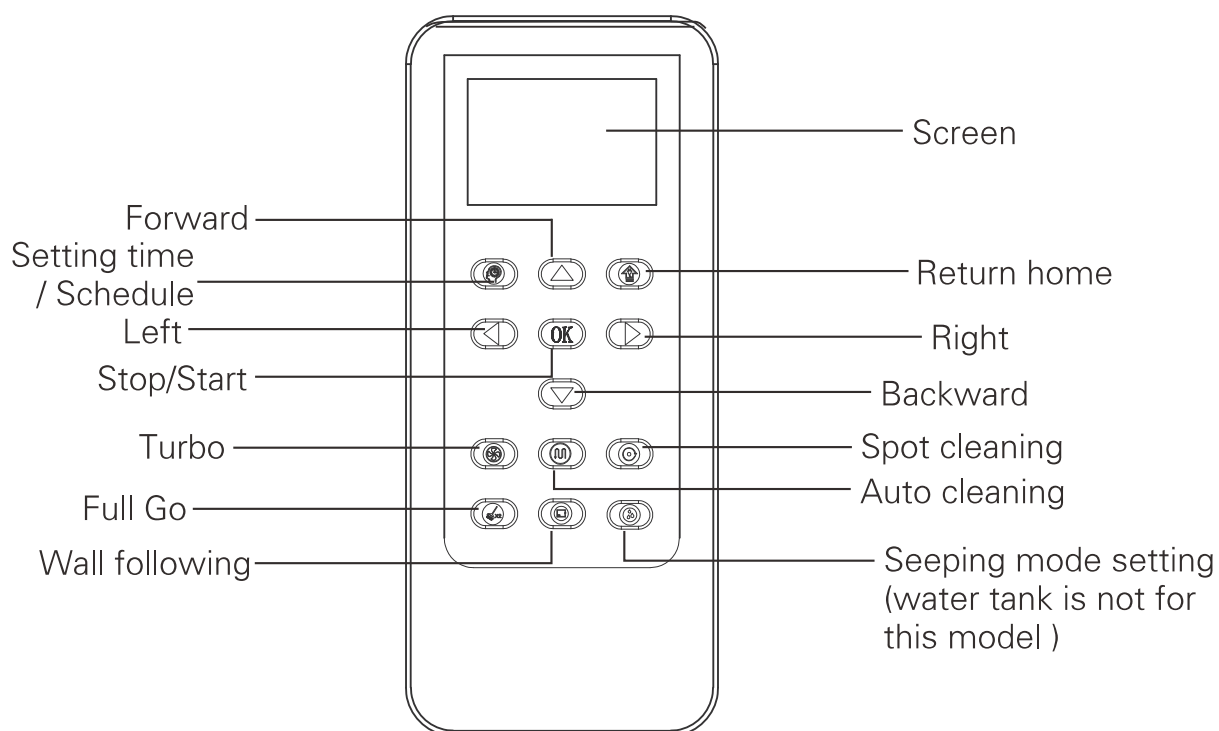

2.Product Composition

► Dust Box

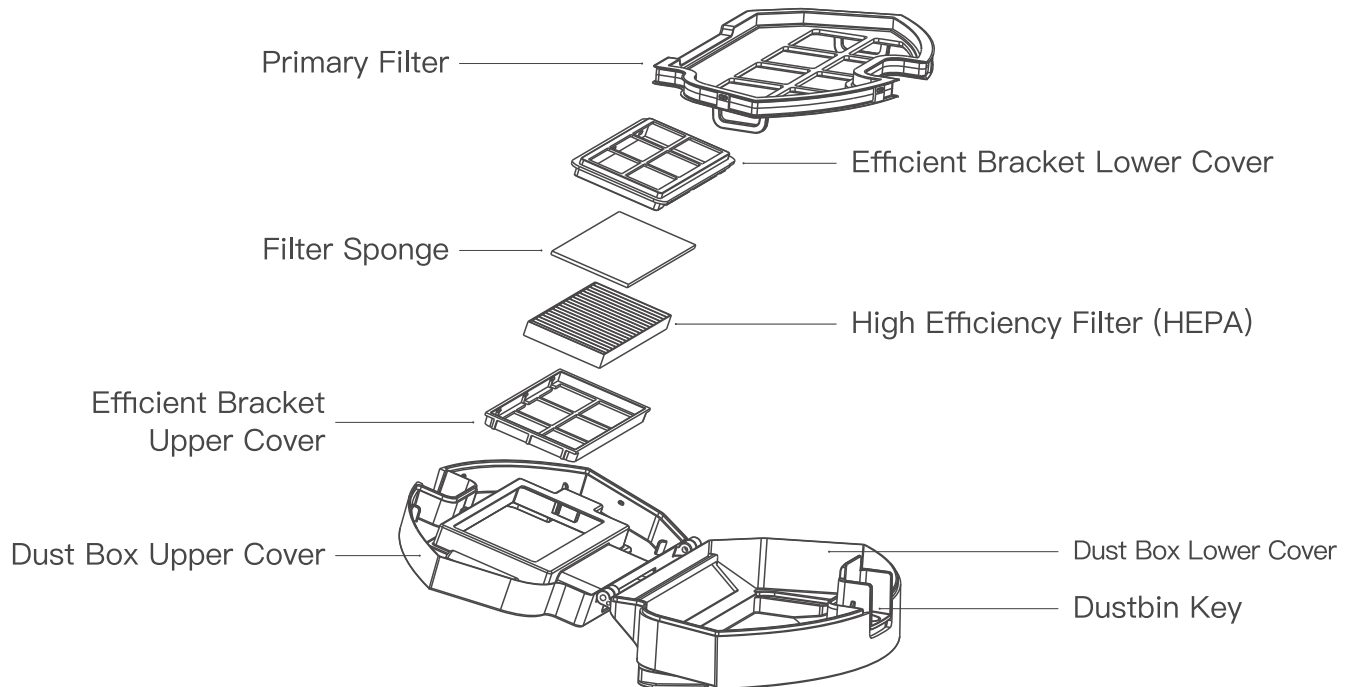

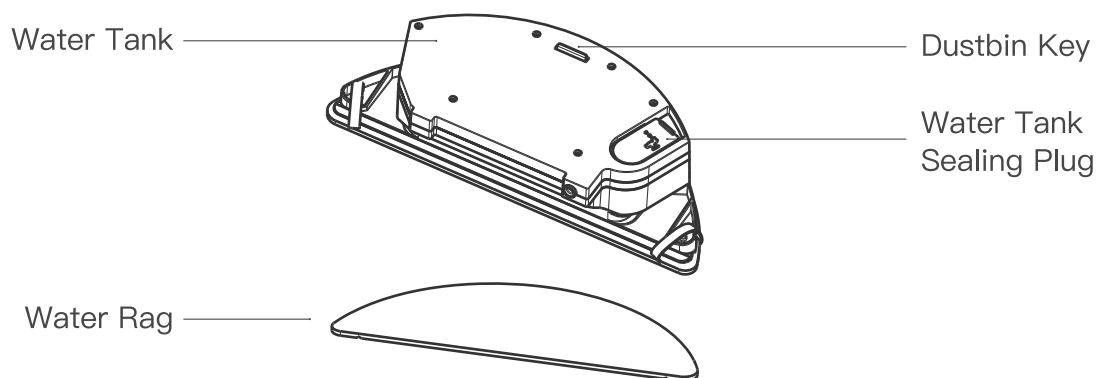

► Water Permeable Rag Assembly



2.Product Composition

2.2Technical Parameters

Master	
Working Voltage: 14.52 V 	Power Rating: 25W
Charging Stand	
Rated Input Voltage: 19 V 	Rated output current: 0.6A
Battery and Specifications	Lithium Battery 2600mAh
Adapter : Output parameter 100–240V ~50/60HZ input parameter 19VDC/0.6A	

3.Product Composition

3.1Considerations

Please refer to the following guidelines to check the cleaning area before the main engine works.



Power lines and other debris scattered on the ground may trip up.Product must be removed

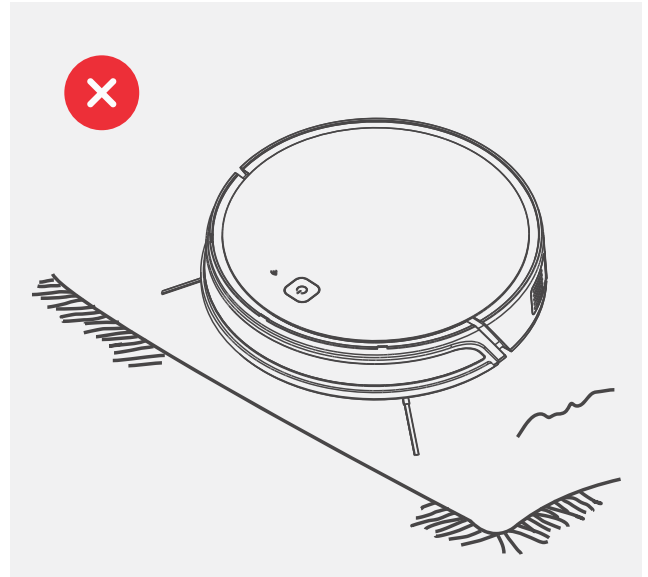

Please roll the carpet tassels or work on short-hair rugs.

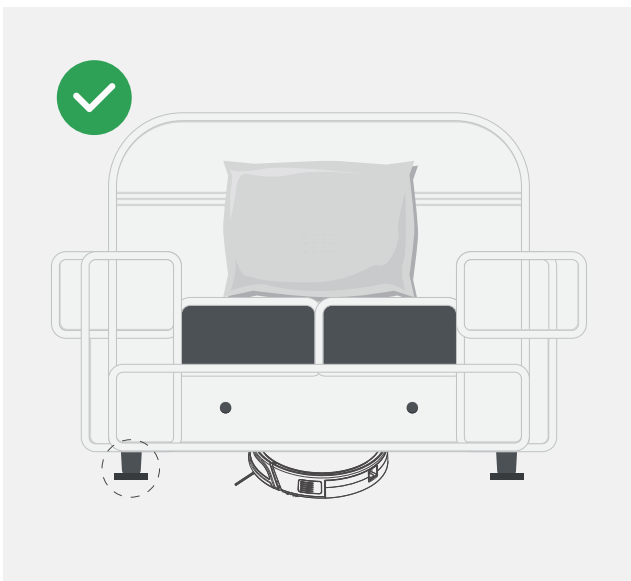

A gap of less than 8 cm on the bottom of the furniture may catch the product. If you need to clean it, please raise the furniture.

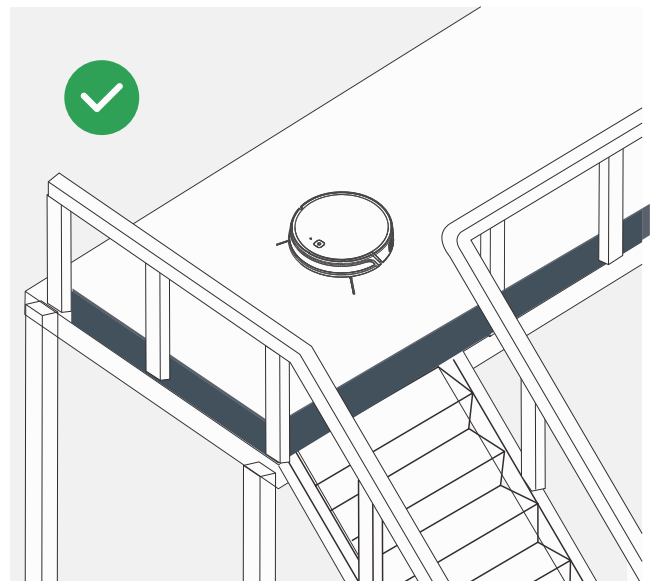

A guardrail should be placed at the edge of the duplex to ensure safe operation of the product.

3.Product Composition

3.2Rapid Operation

Charging Preparation

1 Connect the adapter to the charging stand

Place the charging stand flat against the wall. Do not place objects in the left and right 1M and the front 2M, and do not have objects with strong reflection surfaces such as mirrors.

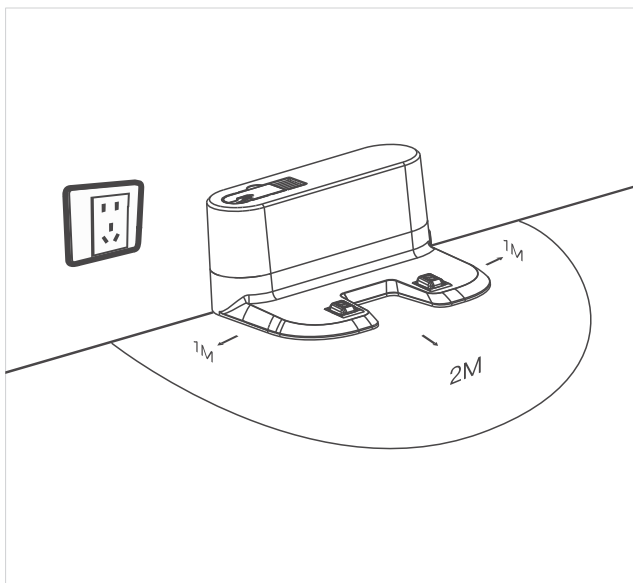

Place the charging stand

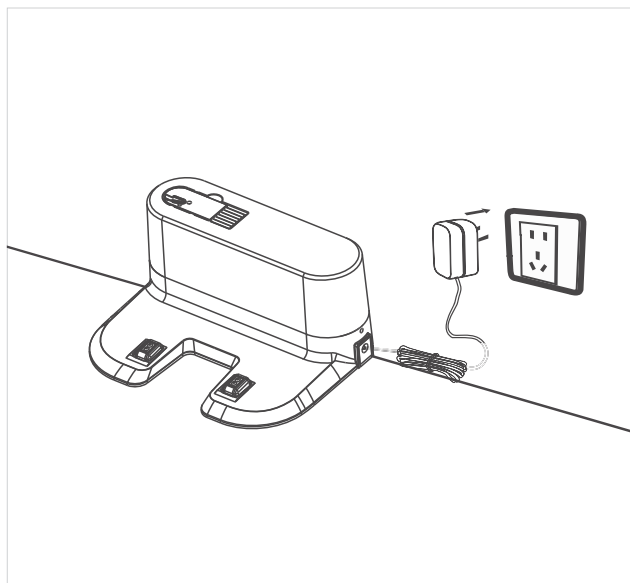

Connect the power supply

2 Install The Side Brushes

Please install the right brush into the right bottom mounting port of the machine, the left brush into the left bottom mounting port of the machine, and ensure that the two side brushes are in place

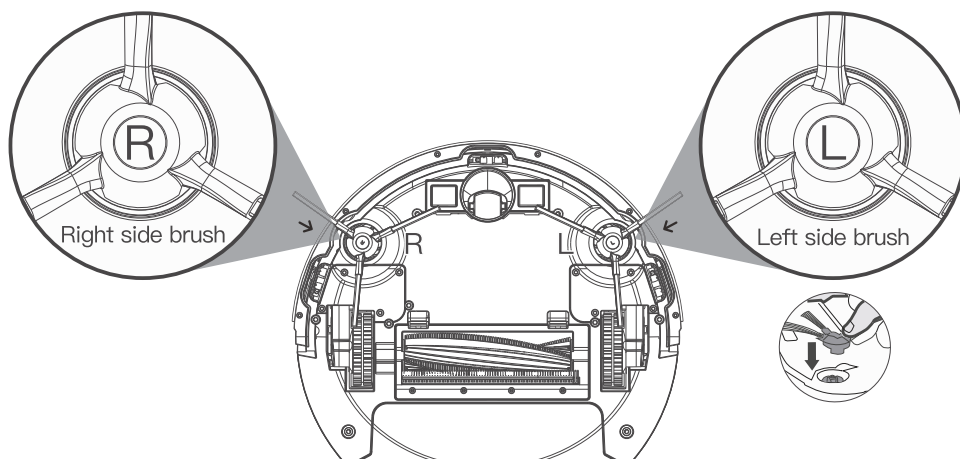

3.Product Composition

Start to charge

1 Turn On The Master

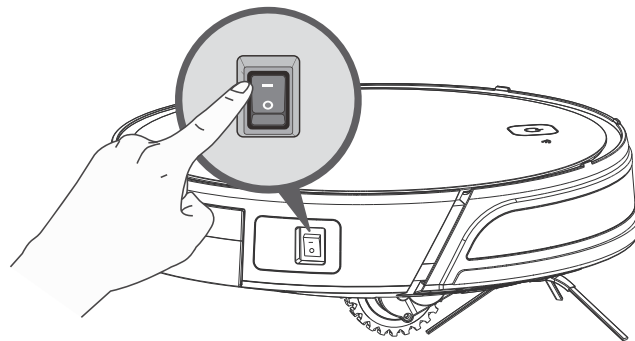

Turn on the side power switch, “I” is the turn on, “O” is the turn off.

After the master finishes working, it is recommended not to shut down; keep the master in a state of charge so that it can perform its next job better.



2 Master Charge

Place the master in the charging stand and pay attention to the charging pole piece

Turn on the power switch, the robot will enter standby mode.  Red light/pink light/Blue light breathing light flashes indicate charging.  When the blue light is off means charging is completed. For the first use, please charge continuously for more than 12 hours.

