

# MT-210

## Robot Vacuum

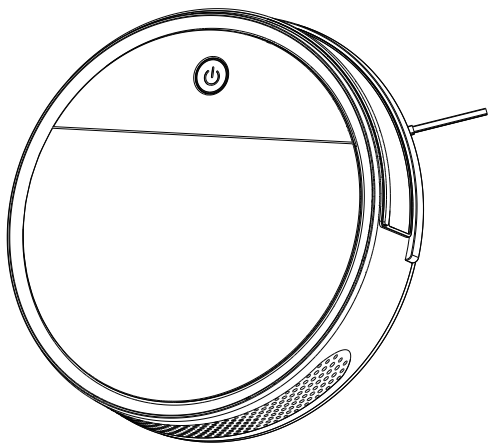

Before operation this unit, please read this instructions completely and follow them step by step



# CONTENTS

<u>1. Safety Regulations</u>	02
<u>2. Product Instruction</u>	04
<u>3. Product Operating and Programming</u>	06
<u>4. Maintenance</u>	10
<u>5. Lighting effect and alarm</u>	15
<u>6. Troubleshooting</u>	16
<u>7. Parameter</u>	17
<u>8. WIFI Manual</u>	18

## **1.Important Safety Instructions**

**When using the product, please keep your vigilance and follow below information:**

1. This Appliance can be used by children aged from 8 years and above and persons with reduced physical, sensory or mental capabilities or lack of experience and knowledge if they have been given supervision or instruction concerning use of the Appliance in a safe way and understand the hazards involved. Children shall not play with the Appliance. Cleaning and user maintenance shall not be made by children without supervision.
2. Clear the area to be cleaned. Remove power cords and small objects from the floor that could entangle the Appliance. To tuck fringe under the rug base, and lift items such as curtains and tablecloths off the floor.
3. If there is a drop off in the cleaning area due to a step or stairs, you should operate the Appliance to ensure that it can detect the step without falling over the edge. It may become necessary to place a physical barrier at the edge to keep the unit from falling. Make sure the physical barrier is not a trip hazard.
4. Only use as described in this manual. Only use attachments recommended or sold by the manufacturer.
5. Please make sure your power supply voltage matches the power voltage marked on the Charging Dock.
6. For INDOOR household use ONLY. Do not use the Appliance in outdoor, commercial or industrial environments.
7. Do not use without dust bin and/or filters in place.
8. Do not operate the Appliance in an area where there are lit candles or fragile objects.
9. Do not use in extremely hot or cold environments (below -5°C/23°F or above 40°C/104°F).
10. Keep hair, loose clothing, fingers, and all parts of body away from any openings and moving parts.
11. Do not operate the Appliance in a room where an infant or child is sleeping.
12. Do not use Appliance on wet surfaces or surfaces with standing water.
13. Do not allow the Appliance to pick up large objects like stones, large pieces of paper or any item that may clog the Appliance.
14. Do not use Appliance to pick up flammable or combustible materials such as gasoline, printer or copier toner, or use in areas where they may be present.
15. Do not use Appliance to pick up anything that is burning or smoking, such as cigarettes, matches, hot ashes, or anything that could cause a fire.
16. Do not put objects into the suction intake. Do not use if the suction intake is blocked. Keep the intake clear of dust, lint, hair, or anything that may reduce air flow.

17. Take care not to damage the power cord. Do not pull on or carry the Appliance or Charging Dock by the power cord, use the power cord as a handle, close a door on the power cord, or pull power cord around sharp edges or corners. Do not run Appliance over the power cord. Keep power cord away from hot surfaces.
18. If the power cord is damaged, it must be replaced by the manufacturer or its service agent in order to avoid a hazard.
19. Do not use the Charging Dock if it is damaged.
20. Do not use with a damaged power cord or receptacle. Do not use the Appliance or Charging Dock if it is not working properly, has been dropped, damaged, left outdoors, or come in contact with water. It must be repaired by the manufacturer or its service agent in order to avoid a hazard.
21. Turn OFF the power switch before cleaning or maintaining the Appliance.
22. The plug must be removed from the receptacle before cleaning or maintaining the Charging Dock.
23. Remove the Appliance from the Charging Dock, and turn OFF the power switch to the Appliance before removing the battery for disposal of the Appliance.
24. The battery must be removed and discarded according to local laws and regulations before disposal of the Appliance.
25. Please dispose of used batteries according to local laws and regulations.
26. Do not incinerate the Appliance even if it is severely damaged. The batteries can explode in a fire.
27. When not using the Charging Dock for a long period of time, please unplug it.
28. The Appliance must be used in accordance with the directions in this Instruction Manual. vosfeel ROBOTICS cannot be held liable or Responsible for any damages or injuries caused by improper use.
29. If the robot will not be used for a long time, fully charge the robot and power OFF for storage and unplug the Charging Dock.

## 2.Product Composition

### ► Robot

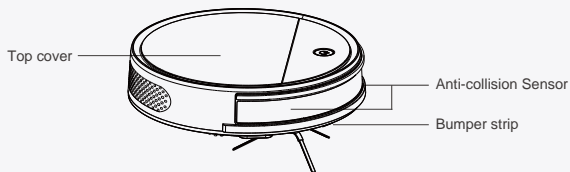
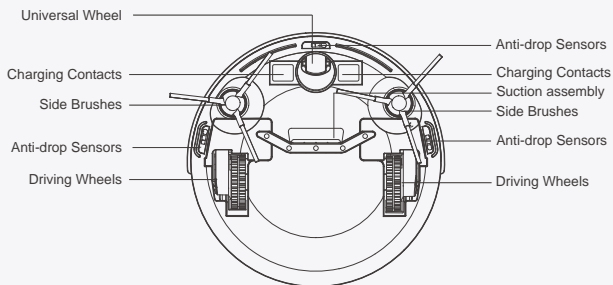
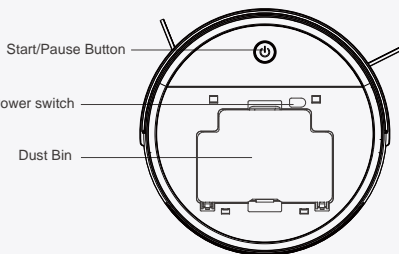

## 2. Product Composition

### ► Charging Dock

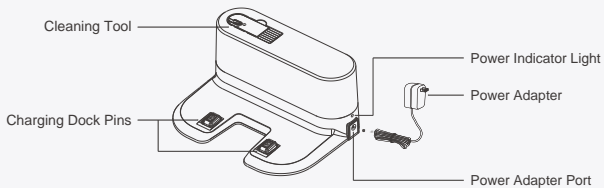

### ► Dust Bin

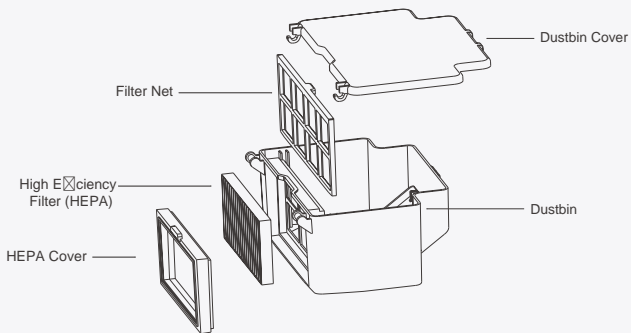

## 2.Product Composition

### ► Structure of Remote controller

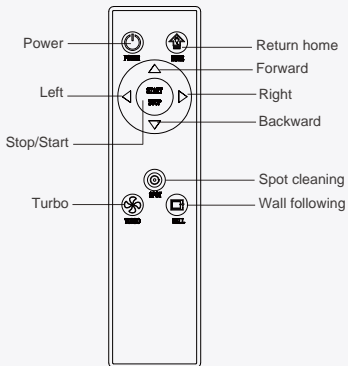

## 3.Operating and Programming

### 3.1Notes Before Cleaning

Please refer to the following guidelines to check the cleaning area before using the robot.

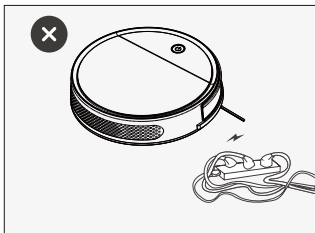

Remove power cords and small objects from the Floor that could entangle the products.

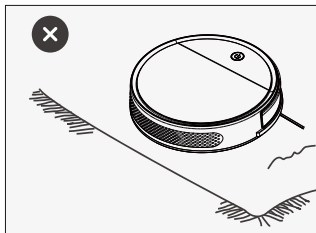

Fold tasseled edges of area rugs underneath to prevent Tangling Robot. Avoid cleaning very dark colored rugs or high-pile rug.



Please be aware that the robot needs at least an 8 cm (3") clearance to clean under furniture without complications.

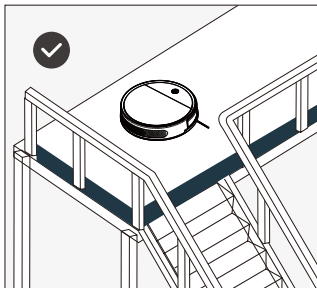

If there is a step or stairs in the cleaning area, please operate robot to ensure its Anti-Drop Sensors can detect the drop off. It may be necessary to place a physical barrier at the edge of the drop off to keep the unit from falling over the edge

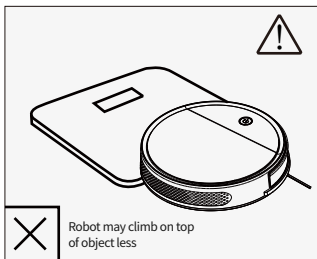

Robot may climb on top of object less



Keep Robot away from wet, flame and burning

## 3.2 Quick Start

### Charging Dock Placement

#### 1. Connect the adapter to the charging Dock

Place the Charging Dock on a level floor surface against the wall with the base perpendicular to the ground. Keep the immediate area 2m (6.6') in front of the charger and 1 m (3.3') on both sides of the charger clear of objects and reflective surfaces.

Plug the Charging Dock in. The Power Indicator Light on the Charging Dock glows.



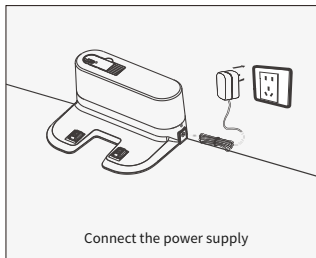
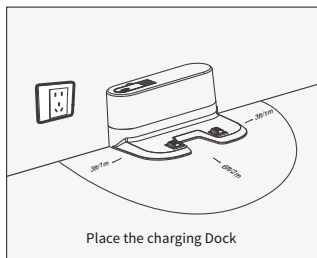

## 2.Install Side Brushes

Attach Side Brushes to the bottom of robot by pressing a brush into each slot until it clicks.

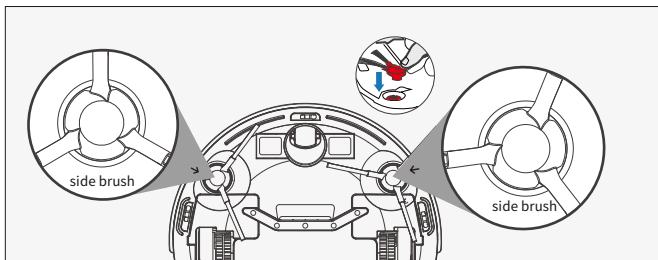

## 3.Operating and Programming

### Start to Charge

#### 1.Turn on the power

Open the unit top cover, push the switch to " I " (" I " is for turn on, " o " is for turn off). when the robot finished work, please don't turn off: keep the robot under charging, better for next time cleaning.

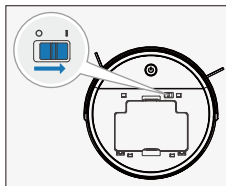

## 2. Charge Robot

Charging Contacts on robot and the Charging Dock Pins make a connection.

⏻ Button in breathing status when robot is charging. Button stops glowing after robot is fully charged. Usually take 5.5 hours from low battery mode to fully charged.

Contacts on robot and the Charging Dock Pins make a connection.

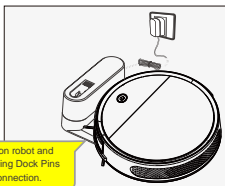

## Start/Stop Cleaning

1. Start or stop by pressing the Start button (⏻) key or the remote control's (⏻)/START STOP key.

Note: Before starting the Robot, make sure that the outer ring of the (⏻) key is white and the Robot is in the state of being awakened. If the Robot does not wake up, short press the (⏻) key to wake it up.

The appliance enters the sleep state after 10 minutes of standby, and the key light is off.

2. If you need to select another mode, please refer to the (Mode Selection) section.

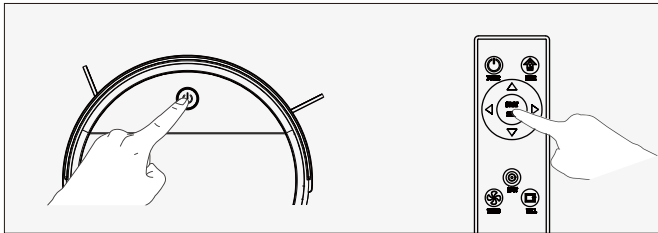

## Mode Selection

In order to adapt to different ground conditions and achieve deep cleaning, this product has a variety of cleaning modes, which can be selected by remote control as needed.

The remote control can switch any mode directly.

Before starting the mode, make sure that the outer ring of the (⏻) key is white and the appliance is in the state of being awakened. If the appliance does not wake up, short press the (⏻) key to wake it up.

## 3. Operating and Programming

### 1. Auto mode

When you start the robot, the default mode is auto mode, zigzag cleaning route. it is suitable for whole room cleaning.

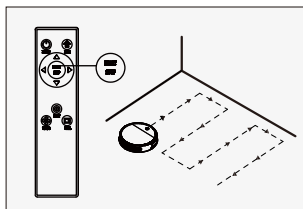

### 2. Turbo mode

The robot will increase suction, Suitable for a very dirty floor or a thick carpet.

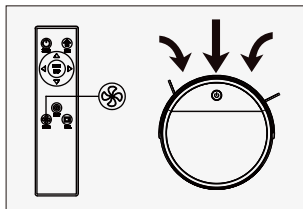

### 3. Fixed-point Mode

It is suitable for the ground environment where the garbage is concentrated. The Robot will centralize cleaning in the designated area with the "spiral" route.

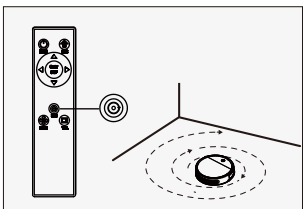

#### 4. Edge Mode

It is suitable for cleaning at the corners of the room. The Robot is cleaned around the periphery of a fixed object (such as a wall) and back to the charging dock after cleaning.

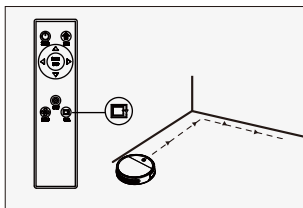

#### 5. Return Charging Mode

During the cleaning process, the appliance can sense that its power is insufficient, and automatically find the charging stand for charging. You can press the “Remote control home” button or press the “equipment home” button twice to make the appliance return to the charging stand for charging.

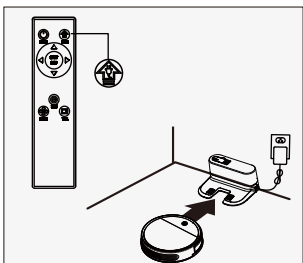

## 4. Maintenance

### 4.1 Dust Bin and Filters

Open the middle cover to take out the dust bin, open the dust bin cover and empty the garbage.

**1. Remove the dust bin, open the dustbin cover, and empty the dust bin.**

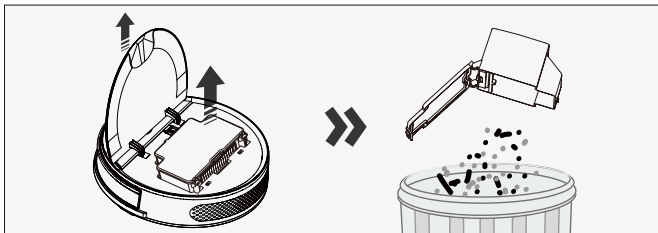

**2. Remove dust filter. HEPA is not recommended for washing. Pat the High Efficiency Filter clean.**

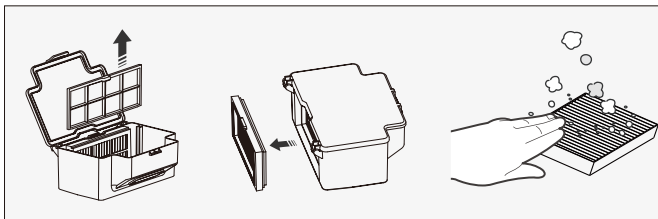

**3. Flush the Dust Bin and Clean the Filter Net.**

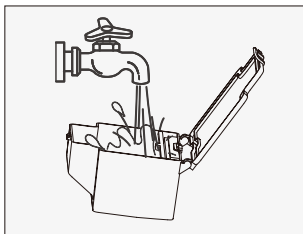

**4. Dry the Sponge filter, Dust Bin and Filter Net completely before reinstalling.**

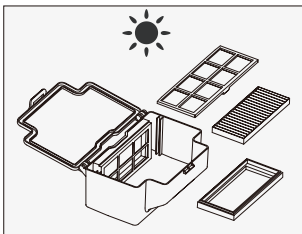

## 4. Maintenance

### 4.1 Suction assembly and side brush

- 1 Clean the suction port. If there is a lot of dust in the suction port, use a cloth to clean up.
- 2 Cleaning the Side Brushes. Remove the Side Brushes. Wipe the Side Brushes and their slots with a dry cloth.

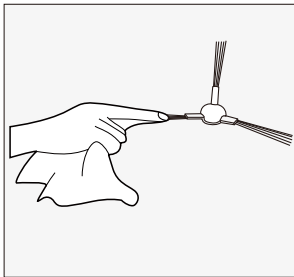
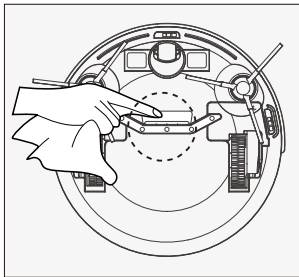

- 3 Clean the driving wheel to maintain its effectiveness.
- 4 Use the multi-function cleaning tool to cut off and remove any hair tangled around the universal wheel.

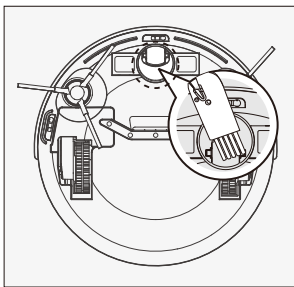
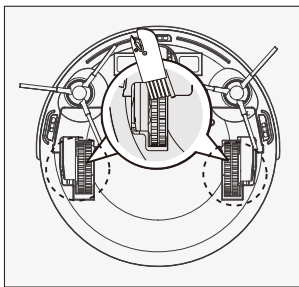

## 4.Maintenance

### 4.2 Other Components

- 1 Clean the anti-collision sensor panel.
- 2 Wipe the anti-drop sensors with the brush or the felt side of the multi-function cleaning tool to maintain their effectiveness.

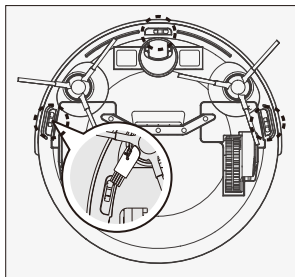
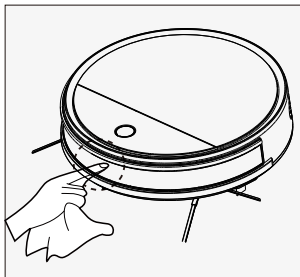

- 3 Wipe the Charging Contacts and Charging Dock Pins with the brush of the Multi-Function Cleaning Tool or a dry clean cloth to maintain their effectiveness.

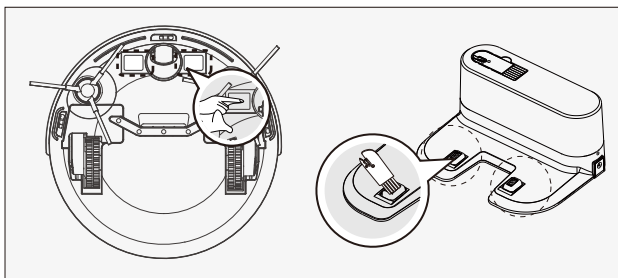

## 5. Lighting effect and alarm

### 5.1 Indicator Light

Status	AUTO Display Status
Charging	white light in breathing state
Finished Charging	white light in breathing state
Low Battery	Glows a continuous RED
Before starting network pairing	a. paired status: red light flash 3s and then switch to constant light state b. unpaired status: white light in constant light state
Network pairing process/WiFi connection lost	white light in flashing state
Connect to Wi-Fi	white light in constant light state

### 5.2 Alarm tips

When the robot fails, the robot indicator flashes red and a beeping sound of varying lengths is emitted. Refer to the following table to query the cause of the failure:

Red Light Glows a continuous RED (APP alarm prompt only applies to vosfeel MT-210)			
Nr	Cause of issue	Beeps	APP Error prompts and solutions
1	Driven wheel abnormal	1 bip 3 times	The wheel is entangled and clean the driving wheel. The driving wheel is abnormal. Please check whether the driving.
2	Side brush abnormal	2 bips 3 times	The side brush is abnormal, please check if the side brush is entangled, and clean the side brush.
3	Motor fan abnormal	3 bips 3 times	The motor fan is abnormal. Please clean the garbage and air ducting the dust box.
Red light flashes			
1	Anti-fall detection alarm	2 bips 3 times	The robot is floating, please move to the ground
2	Out of trouble alarm	3 bips 3 times	Get out of trouble failure, please move to an open area.
3	Low Battery	4 bips 3 times	Battery is too low,
4	Power Adaptor	5 bips 3 times	Charging voltage is abnormal, please replace the adapter
5	Charging abnormal	6 bips 3 times	Please make sure that the robot is turned on and charged with the 19V 0.6A adapter.

If the trouble cannot be eliminated according to the above operation, Please try the following operations Re-open the power switch on the side of the robot and restart the robot.



## 6.Troubleshooting

Please use this chart to troubleshoot common problems using robot.

NO	Malfunction	Possible Causes	Solutions
1	Can not connect to WIFI.(applicable for vosfeel-MT-210)	Incorrect WIFI name or Password.	Please make sure the WIFI name and the password are entered correctly
		Make sure the robot is less than 5 feet(0.5 meter)away from the router and your phone - the closer the better!	Ensure the robot is under WIFI signal coverage.
		Didn't connect to 2.4G Wi-Fi signal.	Make sure the robot is in the network pairing mode.
		Robot isn't in network pairing mode.	The robot is not compatible with 5G WIFI signal. Please connect to 2.4G WIFI signal.
		Download the incorrect APP	Please scan the QR code in the user manual or search on google play or app store.
2	The robot is too noisy.	Side brush, rolling brush, entangled,dustbin Filter material blocked, etc.	It is recommended to clean and maintain the brush, roller brush,dustbin and filters regularly.
		The robot is in MAX suction power mode.	Change the suction power mode to Medium or Low.
3	Robot will not Charge.	The Robot is not connecting to the Charging Dock	Be sure that robot ' s Charging Contacts have made a connection with the Charging Dock Pins.
		Charging Dock is unplugged while robot is powered ON, which causes battery. consumption.	Plug in the Charging Dock and ensure robot is powered ON. Keep robot on the Charging Dock to make sure it has a full battery to work at any time.
4	Robot gets into trouble while working and stops.	The robot is entangled or obstructed by scattered wires on the ground, drape curtains or carpet edges	Robot will try various ways to get itself out of trouble. If it is unsuccessful, manually remove the obstacles and restart.
		Side Brush is stuck or the rotation speed of the Side Brush decreases.	Remove the debris tangled around the Side Brush. If the Side Brush still rotates slowly, contact Customer Service.
		Roller Brush is stuck or the rotation speed of the Roller brush decreases	Remove the debris tangled around the roller Brush with the provided Multi-Function Cleaning Tool. If the Roller Brush still rotates slowly, contact Customer Service.
5	Robot returns to the Charging Dock before it Finishes cleaning.	When battery power gets low, robot automatically switches to Return to Charger Mode and returns to the Charging Dock to recharge itself.	This is normal. No solution necessary.
		Working time varies according to floor surface,room complexity and the selected Cleaning Mode.	This is normal. No solution necessary.
6	Remote Control failure(effective control range of Remote Control is 5m (16').	The batteries in the Remote Control need to be replaced.	Replace the battery with a new one and install it properly.
		Robot is powered OFF or robot's battery is low.	Make sure robot is powered ON and fully charged.
		The infrared signal cannot be transmitted because the Infrared Emitter on the Remote Control or robot's Infrared Receiver on robot is dirty.	Use a dry cloth or the Multi-Function Cleaning Tool to wipe the Infrared Emitter on Remote Control and the Infrared Receiver on robot.
		There is other equipment interfering with the infrared signal to robot.	Avoid using the Remote Control near other equipment using infrared signals.

The images are only for reference, please refer to the actual item as the standard. VOSFEEL reserves the right to update products without prior notice.

## 7. Technical Parameters

Robot Model:MT-220		
Working Voltage(V) : 14.8	===	Power Rating(W) : 25
Working time : 12minutes		change time : 4hours
Battery type : Li-ion 14.8V 2600mAh		Dust bin capacity : 500ml
Net weight : 2.0kgs		Unit size : 28X28X6.9cm
Charging Stand		
Rated Input Voltage(V) : 19	===	Rated output current(A):0.6

## 8.WIFI Manual



1. Scan the bar code below to download Tuya WIFI APP--"Tuya Smart".
2. Open APP "Tuya Smart", registered your account by phone number or email etc.
3. Enter "Add Device" surface.
4. Enter "Add Manually", click "Small Home Appliance", then choose " Robot Vacuum (WIFI) "
5. Open the top cover, turn on the switch to "I", long press  button for 3 seconds, you will hear a voice of "Di", then the robot will enter into network mode.

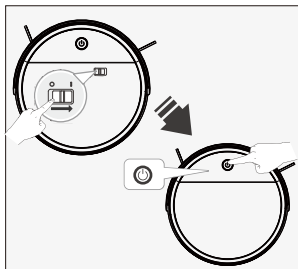
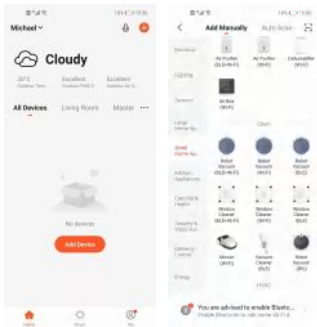

6. Select the available network, only support 2.4GHz, enter the correct WIFI password, click to confirm.
7. After confirmed, the “Connecting” progress of the robot will be displayed.
8. After the connection is successful, it will appear “Device added successfully”

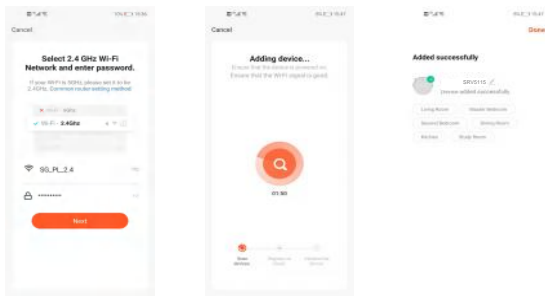

9. You can enter the operation interface to control the robot now with map.
10. The App will show the map of working cleaning path of the robot, But it may not update in real time.
11. Tap "Cleaning record", it will show the cleaning records of working time, also you can clear the data.
12. Click “Settings”, you can see”Timer”, click it to add schedule cleaning for robot. you can select schedule time on the above, choose schedule date on the " Repeat" button, then keep "Switch" button on and press "Save".

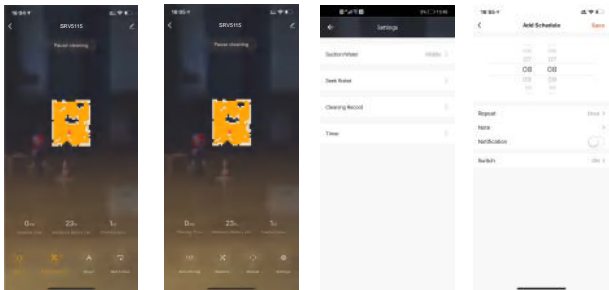

## **FCC Requirement**

Any changes or modifications not expressly approved by the party responsible for compliance could void the user's authority to operate the equipment.

This device complies with Part 15 of the FCC Rules. Operation is subject to the following two conditions:

- (1) this device may not cause harmful interference, and
- (2) this device must accept any interference received, including interference that may cause undesired operation.

Note: This equipment has been tested and found to comply with the limits for a Class B digital device, pursuant to Part 15 of the FCC Rules. These limits are designed to provide reasonable protection against harmful interference in a residential installation. This equipment generates, uses, and can radiate radio frequency energy, and if not installed and used in accordance with the instructions, may cause harmful interference to radio communications. However, there is no guarantee that interference will not occur in a particular installation. If this equipment does cause harmful interference to radio or television reception, which can be determined by turning the equipment off and on, the user is encouraged to try to correct the interference by one or more of the following measures:

- Reorient or relocate the receiving antenna.
- Increase the separation between the equipment and receiver.
- Connect the equipment into an outlet on a circuit different from that to which the receiver is connected.
- Consult the dealer or an experienced radio/TV technician for help.

This equipment complies with FCC radiation exposure limits set forth for an uncontrolled environment. This equipment should be installed and operated with a minimum distance of 20cm between the radiator & your body. This transmitter must not be co-located or operating in conjunction with any other antenna or transmitter.