

# MOGO S2 MANUAL

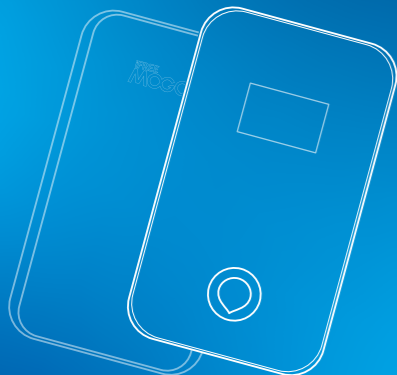

No Limits No Boundaries

## Statement of Conditions

In the interest of improving internal design, operational function, and/or reliability, iFREE GROUP reserves the right to make changes to the products described in this document without notice. iFREE GROUP does not assume any liability that may occur due to the use or application of the product(s) or circuit layout(s) described herein.

Thank you for purchasing the 4G mobile WiFi router, MOGO S2 (MOGO S2 for short). This device brings you a high speed wireless network connection. This manual will help you understand the device so you can start using it right away. Please read this document carefully before using.

\* Accessible service may be limited by contract conditions.

## Introduction

MOGO S2 lets you access your network from virtually anywhere within the operating range of your wireless network. However, the operating distance or devices of your wireless connection can vary significantly depending on the physical placement of your router.

MOGO S2 offers a wireless transmission rate of as high as 300 Mbps. With the MOGO S2, you can get online with your notebook, smart phone, tablet, or any other wireless device using a single mobile connection. Moreover, the MOGO S2 provides high-speed wireless access to everybody – whether you are with colleagues on a business trip, or travelling with friends and family.



MOGO APP QR Code

## MOGO S2 Structure Diagram

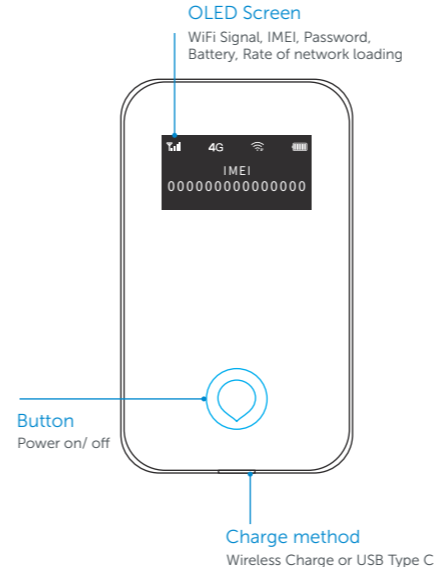

## Steps to use MOGO S2



1 Before first use, please go to MOGO APP profile to bind the device



2 Purchase a package via MOGO APP.



3 Turn on the MOGO S2 device.



4 Check the WiFi name and enter the password. Connect your smart device to the S2.



5 Wait for 2 mins to connect to the network.

iFREE GROUP®

## Specifications

|                        |                                   |  |
|------------------------|-----------------------------------|--|
| Product Name           | 4G Wireless Data Terminal         |  |
| Model                  | S2                                |  |
| Network Specifications | Radio Frequency Bands             | FDD-LTE: B1/B3/B5/B7/B8/B20 /B2/B4/B12/B13<br>TDD-LTE: B38/B40/B41<br>UMTS: B1/B5/B8/B2/B4 |
|                        | Cellular Access                   | Download: 150Mbps<br>Upload: 50Mbps  |
|                        | SIM Card                          | VSIM   |
| WiFi Information       | WiFi Access Point                 | 802.11b/g/n  |
|                        | Transmission                      | 300Mbps  |
| Charge method          | Wireless Charge/USB Type C Charge |  |
| Dimensions (L*W*H)     | 101mm * 59mm * 13mm               |  |
| Weight                 | 89.5g                             |  |
| Voltage                | 3.8V                              |  |
| Input                  | 5V ---1A                          |  |
| Battery capacity       | 2000mAh                           |  |
| Standby time           | 100 hours                         |  |
| Operating Temperature  | 0°C ~ +45°C                       |  |
| Storage Temperature    | -20°C ~ +70°C                     |  |
| Manufacturer           | iFREE GROUP (HK) LIMITED          |  |

\*In an open environment, the maximum distance for connection between MOGO S2 and your smart device is 120 meters.

## Safety Notices

- 1) Handle the device with care. Store it in a dry, clean and dust-free place when not in use.
- 2) To protect the battery from over discharging, we suggest to fully charge the battery every two months when the device is not in use.
- 3) Do not put the device near a fire or lit cigarette or in an area where a potentially explosive atmosphere might exist.
- 4) Do not drop, throw or bend the device.
- 5) Do not operate your device in any area where medical equipment, life support equipment, or near any equipment that might be susceptible to any form of radio interference.
- 6) Do not operate the device on an airplane, near an airplane, or any area where two-way radios are prohibited.
- 7) Never attempt to repair or disassemble the device by yourself. Return the device to an authorized service centre for service.
- 8) Do not use the device in any way illegal.

## Warranty

If within 7 days of purchase this product or any part thereof is proven to be defective by reason of faulty workmanship or defect in materials, we will repair or replace the said product free of charge.

Battery Warranty: 6 months  
MOGO S2 Warranty: 12 months

## Fair Usage Policy

Under the Fair Usage Policy, to avoid excessive downloads or uploads, service providers have the right to restrict the data access speed without prior notice.

iFREE reserves the right to limit returns or exchanges at any time, for whatever reason. Any questions please contact our customer service center at [www.ifree.ly/support](http://www.ifree.ly/support).

CE Warning:  
This device was tested for typical body-worn operations. To comply with RF exposure requirements, a minimum separation distance of 10mm must be maintained between the user's body and the device, including the antenna. Third-party belt-clips, holsters, and similar accessories used by this device should not contain any metallic components. Body-worn accessories that do not meet these requirements may not comply with RF exposure requirements and should be avoided. Use only the supplied or an approved antenna. This device in compliance with the essential requirements and other relevant provisions of Directive 2014/53/EU. All essential radio test suites have been carried out.

1. CAUTION : RISK OF EXPLOSION IF BATTERY IS REPLACED BY AN INCORRECT TYPE. DISPOSE OF USED BATTERIES ACCORDING TO THE INSTRUCTIONS

2. The device complies with RF specifications when the device used at 10mm from your body

FCC Warning:  
This device complies with part 15 of the FCC Rules. Operation is subject to the condition that this device does not cause harmful interference. Any changes or modifications not expressly approved by the party responsible for compliance could void the user's authority to operate the equipment.  
NOTE: This equipment has been tested and found to comply with the limits for a Class B digital device, pursuant to Part 15 of the FCC Rules. These limits are designed to provide reasonable protection against harmful interference in a residential installation. This equipment generates, uses and can radiate radio frequency energy and, if not installed and used in accordance with the instructions, may cause harmful interference to radio communications. However, there is no guarantee that interference will not occur in a particular installation.

If this equipment does cause harmful interference to radio or television reception, which can be determined by turning the equipment off and on, the user is encouraged to try to correct the interference by one or more of the following measures:

- Reorient or relocate the receiving antenna.
- Increase the separation between the equipment and receiver.
- Connect the equipment into an outlet on a circuit different from that to which the receiver is connected.
- Consult the dealer or an experienced radio/TV technician for help.

Specific Absorption Rate (SAR) information:

This device meets the government's requirements for exposure to radio waves. The guidelines are based on standards that were developed by independent scientific organizations through periodic and thorough evaluation of scientific studies. The standards include a substantial safety margin designed to assure the safety of all persons regardless of age or health. FCC RF Exposure information and Statement The SAR limit of USA (FCC) is 1.6 W/kg averaged over one gram of tissue. Device types: S2 (FCC ID: 2AT71-S2) has also been tested against this SAR limit. The highest SAR value reported under this standard during product certification for use at the body is 1.32W/kg. This device was tested for typical body-worn operations with the back of the device kept 10mm from the body. To maintain compliance with FCC RF exposure requirements, use accessories that maintain a 10mm separation distance between the user's body. The use of accessories that do not satisfy these requirements may not comply with FCC RF exposure requirements, and should be avoided.

Body-worn Operation

This device was tested for typical body-worn operations. To comply with RF exposure requirements, a minimum separation distance of 10mm must be maintained between the user's body and the device, including the antenna. Third-party belt-clips, holsters, and similar accessories used by this device should not contain any metallic components. Body-worn accessories that do not meet these requirements may not comply with RF exposure requirements and should be avoided. Use only the supplied or an approved antenna.

Designed by iFREE GROUP (HK) Limited  
Made in China

## Warranty Card

Product Name: \_\_\_\_\_

Purchase Date: \_\_\_\_\_

Descriptions: \_\_\_\_\_

Name: \_\_\_\_\_

Mobile: \_\_\_\_\_

Mail: \_\_\_\_\_

Address: \_\_\_\_\_

