

AUStream Hybrid

USER MANUAL

Hybrid Active Noise Cancelling Earbuds

Ausounds AU-Stream Hybrid earphones were designed with music enthusiast and creators in mind. The 9.2mm high performance AU-Titanium Driver and Hybrid Active Noise Cancellation provide an accurate soundstage while also reducing distracting ambient sounds. The AU-Stream Hybrid is extremely transparent and dynamic with a frequency range of 20Hz - 20KHz. 25 hours total battery life with Rapid Wireless Charging means you'll never miss a beat. Other key features such as Bluetooth 5.0 with Smart Pairing and an IPX5 waterproof rating make the AU-Stream Hybrid earphones the ideal high-quality audio solution.

PACKAGE INCLUDES

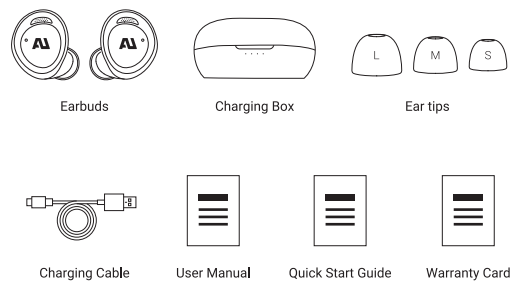

- 01 -

PRODUCT DETAILS

Charge your earbuds for at least 10 minutes before first use.

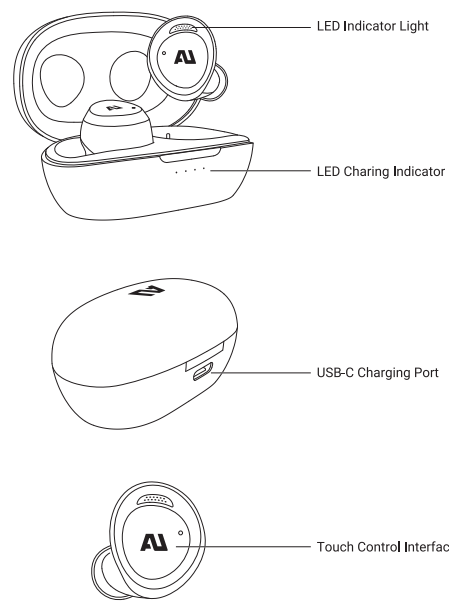

- 02 -

LISTENING COMFORT

Select the right size ear tip

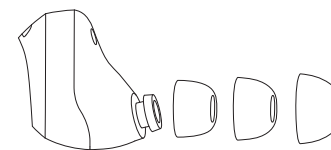

Select the ear tip that provides the most comfortable fit and audio seal. Lightly pull the default ear tip off the earbud to remove it and install the ear tip size you selected.

Positioning your earbuds

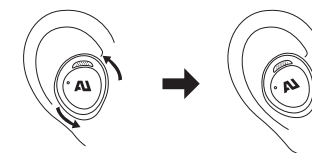

Lightly insert the earbuds into the ear and adjust it to a comfortable angle by rotating the earbuds. There is a left side and a right side earbud as indicated by the L and R markers on them.

- 03 -

BLUETOOTH FEATURES

Automatic remote connection

The AU-Stream Hybrid stores your last connected device in memory. If your earbuds are disconnected due to being out of range, they will automatically reconnect once in range. If your earbud is disconnected for more than 5 minutes, tap the Bluetooth name in your phone to connect again. If it is disconnected for more than 10 minutes, it will automatically shut down.

Automatically switch between left and right ear

Removing either the left or right earbud for charging in the case will switch the mode to single ear state and only play audio through the remaining active earbud.

Reset Pairing Memory

Remove the earbuds from the charging case, and press and hold both touch panel for 8 seconds at the same time to clear the pairing record and enter the pairing mode

- 04 -

CHARGING

Charging and battery life

Your earbuds can play audio up to 9 hours in Bluetooth mode without charge and has a total battery life of up to 25 hours utilizing the charging case to recharge your earbuds.

Charging Your Earbuds

Put the earbuds in the charging case and they will automatically shut down and enter the charging state.

Charging Your Case

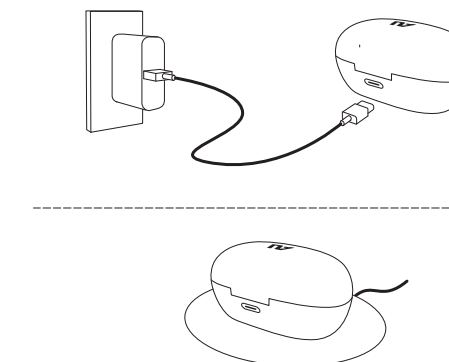

- 05 -

PLAYBACK CONTROLS

	Left ear	Right ear
Touch control		
Answer call	Tap once	Tap once
Decline incoming / end call	Tap and hold 2 sec	Tap and hold 2 sec
Play / Pause	Tap once	Tap
Previous / Next track	Tap twice	Tap twice
ANC mode toggle	Tap and hold 3 sec	Tap and hold 3 sec
Activate voice assistant	Tap three times	Tap three times
Enter pairing mode	Tap and hold 8 sec	Tap and hold 8 sec

- 06 -

SPECIFICATIONS

Bluetooth version	BT 5.0
Charging time	1.5H
Stand-alone battery life	9H (Bluetooth mode)
Earbuds impedance	32Ω
Frequency Range	20~20kHz
SPL	100 dB@1KHz
Microphone sensitivity	-38 ±1 dB V/Pa
Battery capacity	50mAh-earbud 360mAh-charging case
Bluetooth range	33 ft.
Weight	6g (Single earbuds)
Waterproof level	IPX5
Charging voltage	DC_5 V

FCC ID: 2AT6N-20HBL
FCC ID: 2AT6N-20HBR
IC: 25348-20HBL
IC: 25348-20HBR
HVIN: AU-STREAM Hybrid

Model: AU-STREAM Hybrid
Ausounds Intelligence, LLC
929 108TH AVE NE STE 1200
BELLEVUE, WA, 98004-4787, UNITED STATES



- 07 -

SAFETY INSTRUCTIONS

- Do not attempt to make any modifications to the product, including removing or modifying the earphones, as the damage is not covered by the warranty.
- Do not place earphones in extremely high or low ambient temperatures for extended periods of time. Extreme temperatures can cause equipment to deform, and reduce the charging capacity of the device.
- Thunderstorm weather may affect the normal use of the earphones and there is a risk of electric shock, so please do not use the earphones during thunderstorms.
- This product contains small parts. Do not swallow it to avoid danger. Keep the product out of the reach of children.
- Using the earphones for a long time at high volume may affect your hearing.
- Please control the volume when using the earphones.
- This product supports active noise cancellation. Please do not turn this function on when walking, driving, or cycling to avoid accidents.

BATTERY WARNING

This product contains a lithium battery. Do not disassemble, impact, squeeze or put battery into the fire. Do not place the product under high temperature, or hot sun, beware of explosion. If there is swelling, leakage, odor, or any other abnormality in the battery compartment of the product, do not continue to use it. Please dispose of used batteries properly in accordance with local regulations.

- 08 -

WARNING

Do not subject the unit to excessive shock. The touch sensor may not operate properly if you apply stickers or other adhesive items to the touch sensor control panel. Be careful not to catch your finger in the unit when folding. When you use the unit as wired headphones, use the supplied headphone cable only. Make sure that the headphone cable is firmly inserted. The Bluetooth function may not work with a mobile phone, depending on the signal conditions and the surrounding environment. Do not apply weight or pressure to the unit for long periods, including when it is stored, as it may cause deformation. If you experience discomfort while using the unit, stop using it immediately. The earpads may be damaged or deteriorate with long-term use and storage.

CLEANING THE UNIT

When the outside of the unit is dirty, clean it by wiping with a soft dry cloth. If the unit is particularly dirty, soak a cloth in a dilute solution of neutral detergent, and wring it well before wiping. Do not use solvents such as thinner, benzene, or alcohol, as they may damage the surface.

DO NOT USE THE HEADSET NEAR MEDICAL DEVICES

This product has magnets which may interfere with pacemakers, defibrillators and programmable shunt valves or other medical devices. Do not put this product close to these medical devices and the person who use any of these medical devices. Consult your doctor before using this product, if you have any concerns.

- 09 -

DO NOT PLACE CARDS WITH MAGNETS IN THE VICINITY OF THE HEADSET

This product has magnets. Placing cards with magnets in the vicinity of the product may affect the magnetism of the card and render it unusable.

READ ALL INSTRUCTIONS BEFORE USE AND SAVE THESE INSTRUCTIONS FOR FUTURE REFERENCE

This equipment has been tested and found to comply with the limits for a Class B digital device, pursuant to part 15 of the FCC Rules. These limits are designed to provide reasonable protection against harmful interference in a residential installation. This equipment generates uses and can radiate radio frequency energy and, if not installed and used in accordance with the instructions, may cause harmful interference to radio communications. However, there is no guarantee that interference will not occur in a particular installation. If this equipment does cause harmful interference to radio or television reception, which can be determined by turning the equipment off and on, the user is encouraged to try to correct the interference by one or more of the following measures:

- Reorient or relocate the receiving antenna.
- Increase the separation between the equipment and receiver.
- Connect the equipment into an outlet on a circuit different from that to which the receiver is connected.
- Consult the dealer or an experienced radio/TV technician for help.

- 10 -

This device complies with Part 15 of the FCC Rules. Operation is subject to the following two conditions: (1) this device may not cause harmful interference, and (2) this device must accept any interference received, including interference that may cause undesired operation.

FCC RF EXPOSURE STATEMENT:

This transmitter must not be co-located or operating in conjunction with any other antenna or transmitter. This device complies with FCC radiation exposure limits set forth for an uncontrolled environment.

CAUTION!

Any changes or modifications not expressly approved by the party responsible for compliance could void the user's authority to operate the equipment.

ISED C STATEMENT

This device complies with Innovation, Science, and Economic Development Canada license-exempt RSS standard(s). Operation is subject to the following two conditions: (1) this device may not cause interference, and (2) this device must accept any interference, including interference that may cause undesired operation of the device.

- 11 -

Le présent appareil est conforme aux CNR d'Innovation, Sciences et Développement économique Canada applicables aux appareils radio exempts de licence. L'exploitation est autorisée aux deux conditions suivantes : (1) l'appareil n'émet pas de brouillage, et (2) l'utilisateur de l'appareil doit accepter tout brouillage radioélectrique subi, même si le brouillage est susceptible d'en compromettre le fonctionnement.

This Class B digital apparatus complies with Canadian ICES-003. Cet appareil numérique de classe B est conforme à la norme nmb-003 du Canada.

ISED C RF EXPOSURE STATEMENT:

The device is compliance with RF exposure guidelines, users can obtain Canadian information on RF exposure and compliance.

LE PRÉSENT APPAREIL EST CONFORME

Après examen de ce matériel aux conformités ou aux limites d'intensité de champ RF, les utilisateurs peuvent sur l'exposition aux radiofréquences et la conformité and compliance d'acquérir. les informations correspondantes.

- 12 -