

Fuzhou PEPE Electronics Technology Co., Ltd.

No.9,GaowangRd.,GaishanInvestmentZone,CangshanDistrict,Fuzhou,Fujian,P.R,China

Tel: +86 (591) 8326 9076

For technical assistance: Support@eye-home.com

For detailed information: Sales@eye-home.com

FCC Notice

FCC ID: 2AT52-EC-3201

This device complies with Part 15 of the FCC Rules. Operation is subject to the following two conditions: (1) this device may not cause harmful interference, and (2) this device must accept any interference received, including interference that may cause undesired operation.

EC-E2001GB

E-bike / E-Scooter Alarm System

Installation Manual and User's Guide



ECR-006

Basic Features:

- System arming / disarming
- Waterproof remote key
- Built-in shock sensor
- Low power consumption
- Remote panic mode
- Compact design built-in 120 dB siren
- Silent arming / disarming
- Power Save mode
- Memory system
- Low voltage alarm

Components:

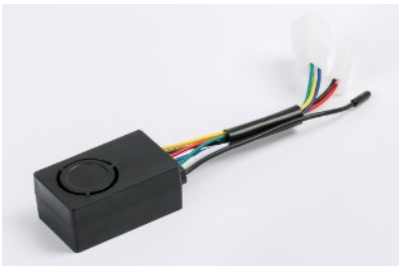

Alarm Module



Remote Key

Before Installation:

- Please check that your electric bike is fully charged and that all electrical circuits are in good working condition.
- Check the layout and construction of the electric bike to decide what space is available to place the components.
- Verify that no parts interfere with the components.

Wire Connections

The factory default connector is a 2PIN connector. The wires should be connected as follows:

2PIN Male Connector

Red wire: to battery positive

Black wire: to battery negative

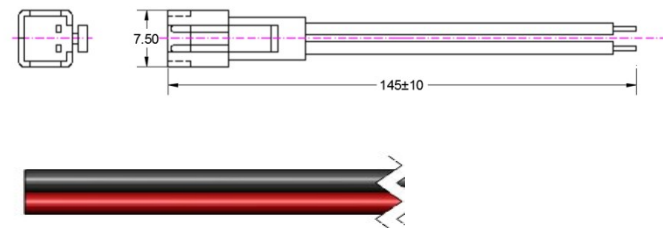

Notes: 2 copper stranded wires, 22 AWG with insulating jackets.

Dimensions:

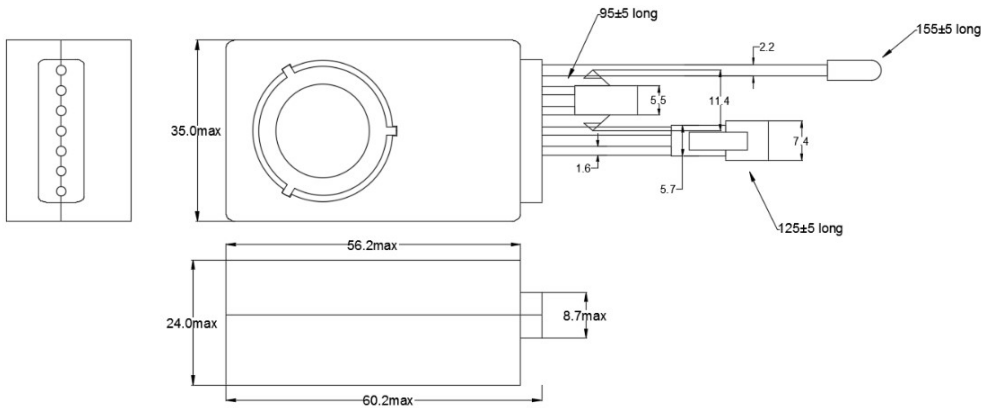

Operating Instructions

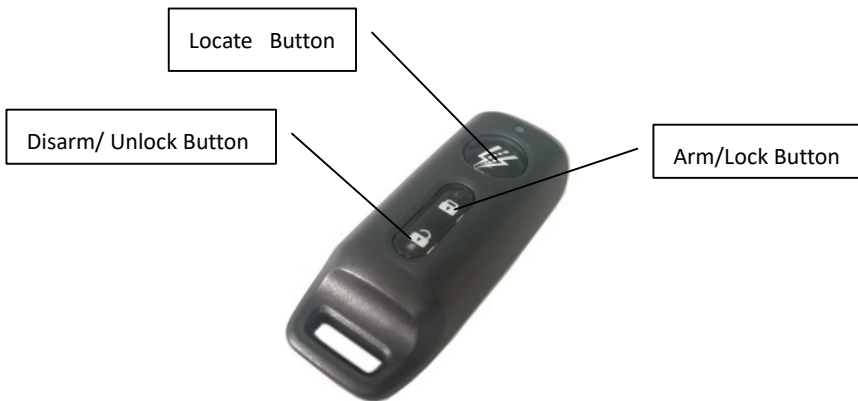

System arming

Press the Arm button once, siren one time and system is armed now. In case the system gets triggers, siren five times. Trigger again, siren sound for 15 seconds.

System disarming

Press the Disarm button once, siren one time and system is disarmed. Now user can start the bike.

Panic mode

The system is armed state, press the Locate button once, the siren will sound for 15 seconds. Press the Disarm button to stop the alarm, and the system remains an armed state.

Power save mode

The system will automatically enter the power save mode 24 hours after it's been set to the armed state. The system bypass remote control function. If someone touched the bike, the system would wake up from power save mode immediately, siren five times. Trigger again, siren sound for 15 seconds.

Low battery alarm

When the battery is low, the red LED light blinking quickly.

Adjusting shock sensor sensitivity

Although the sensor is pre set from the factory, it may be necessary to adjust the sensitivity to suit your specific needs.

Press and hold down button 3, while holding down, the siren will sound to correspond with the current sensitivity setting, the siren sound once is level 1, (Minimum level 1), the siren sound 3 times is level 3 (Maximum leave 3). Release the button followed by one siren to indicate the setting saved.

Programming the remote

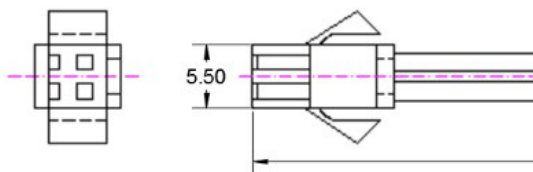

2PIN wire female connector for encoding

Step 1: Check that the bike is not turned off state.

Step 2: Within 5 seconds, caused two wires short circuit 2 seconds and release, siren one time to indicate that the programming is successful.

Caution: The user is cautioned that changes or modifications not expressly approved by the party responsible for compliance could void the user's authority to operate the equipment.

This device complies with Part 15 of the FCC Rules. Operation is subject to the following two conditions: (1) this device may not cause harmful interference, and (2) this device must accept any interference received, including interference that may cause undesired operation.

NOTE: This equipment has been tested and found to comply with the limits for a Class B digital device, pursuant to Part 15 of the FCC Rules. These limits are designed to provide reasonable protection against harmful interference in a residential installation. This equipment generates, uses and can radiate radio frequency energy and, if not installed and used in accordance with the instructions, may cause harmful interference to radio communications. However, there is no guarantee that interference will not occur in a particular installation.

If this equipment does cause harmful interference to radio or television reception, which can be determined by turning the equipment off and on, the user is encouraged to try to correct the interference by one or more of the following measures:

- Reorient or relocate the receiving antenna.
- Increase the separation between the equipment and receiver.
- Connect the equipment into an outlet on a circuit different from that to which the receiver is connected.
- Consult the dealer or an experienced radio/TV technician for help.