

# User Manual

Airdual DockLinQ

# INVERY

www.invery.com

INVERY is committed to customer services. We focus on customer experiences. We strive to make customers 100% satisfied.

BEFORE LEAVE US A NEGATIVE REVIEW, ANY PROBLEMS,PLEASE CONTACT US AT FIRST! TRUST US! WE WON'T DISAPPOINT YOU!

www.invery.com

E-mail: support@invery.com

Facebook:www.facebook.com/goinvery

GoINVERY



Phone:+1 (256) 472 5302  
Whatsapp:+86 15913117895

## 1.Overview

Wirelessly stream music from your iPhone,iPad ,or other Bluetooth-enabled device to either your 30-Pin docking station or to any home or car stereo that has a 3.5mm line-out jack. The DockLinQ offers 2 ways to bring Bluetooth to your audio equipment.

The DockLinQ also has 2 power options.It can be powered by the 30 Pin connector of a docking station or run on its built-in rechargeable battery. The battery is charged when the DockLinQ is plugged into the 30 Pin connector of a docking station or a 30 Pin charging cable.

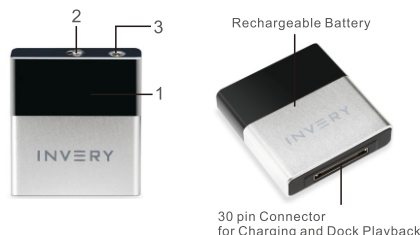

1 Diagram Top View - ON/OFF SWITCH, 3.5 MM Aux-out jack

LED light indicator	Battery switch button on	Battery switch button off
Blue blinking light	Bluetooth pairing mode	
Blue constant light	Bluetooth paired	
Red light is on	Battery charging	Red light is off
Red light is off	Battery charging completed	Red light is off

## 2 Battery ON/OFF switch

- Slide switch button to left for ON position to activate battery and the battery will be charged at left position when DockLinQ is plugged into 30 pin docking station .
- Slide switch button to right for OFF position to prevent battery from draining and the battery won't be charged at right position even if DockLinQ is plugged into 30 pin dock.

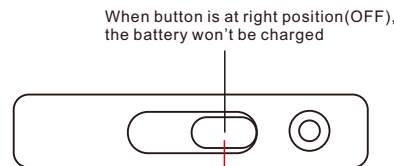

We strongly recommend slide button to right position. It will protect battery when DockLinQ is plugged into 30 pin connector. DockLinQ can be powered by 30 pin connector without battery.

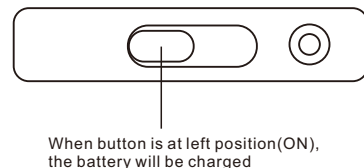

## 3 3.5 mm Aux-out jack

- Using included aux cable to plug DockLinQ Aux-out jack to home or car stereo Aux-in jack to transmit audio. Connect wired headphones/earphones.
- Connect wired headphones/earphones.

## 2.Instruction (FAST SETUP)

### 1. PLUG. Plug DockLinQ into 30 pin connector.

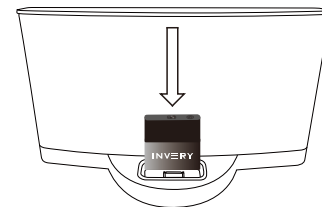

### 2. PAIR. Open your phone bluetooth setting to search DockLinQ. Tap to pair it. After paired successfully, you will see constant blue light.

### 3. PLAY. Streaming music from your phone to docking station.

### IMPORTANT NOTES:

DockLinQ is compatible with most of Bose dock. If the sound doesn't come out or the sound is not loud or not good , the problem probably is that 30 pin connector is not in good contact condition due to the dock is used for many years. Please try to adjust DockLinQ position to make it in good contact condition, the sound will come out. If it still doesn't work, please contact us support@invery.com

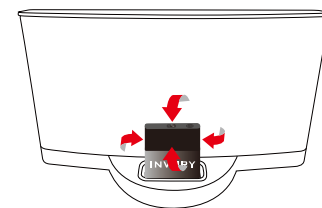

## 3. Playing Music from a Docking Station via 3.5 mm Aux-in jack.

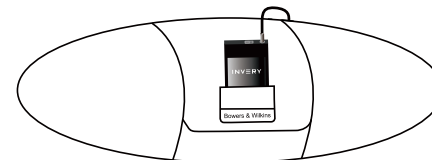

DockLinQ is not compatible with Some digital dock which adopt USB channel such as Bowers&Wilkins Zeppelin with Aux-in jack. DockLinQ provides alternative bluetooth streaming solution: Use 3.5 mm Aux cable to connect DockLinQ Aux-out jack to docking station speaker Aux-in jack to play music.

## 4. Playing Music from Home or Car Stereo with a 3.5 mm Aux-in jack

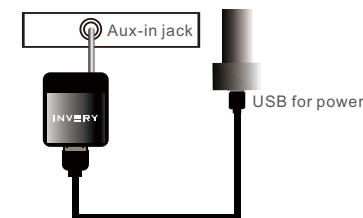

Use 3.5 mm Aux cable to input audio  
Use 30 pin-USB cable to supply power for DockLinQ

## 5. Playing Music with Wired Earphone

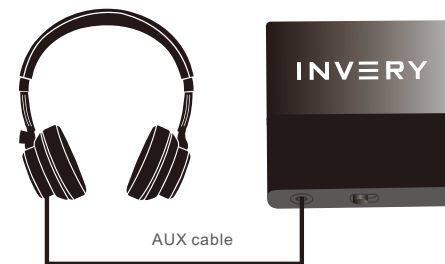

Use DockLinQ and Aux cable to turn wired earphones into bluetooth earphones.

## 6. Playing Music from 2 Mobile Devices (Multipoint Function)

- a. Pair first mobile device bluetooth. Search DockLinQ and pair it.

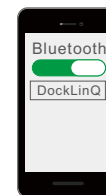

b. Turn off first mobile device bluetooth

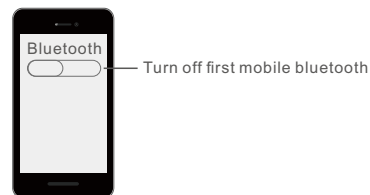

c. Pair second mobile device bluetooth when first mobile device bluetooth was turned off. Search DockLinQ and pair it.

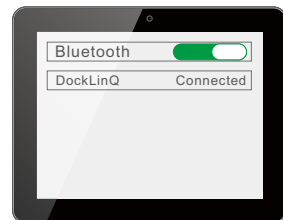

d. Open first mobile device bluetooth tap to pair it.

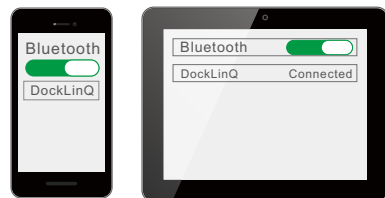

You will see both two mobile devices was paired simultaneously.

## 7. Amazon Echo Dot works with DockLinQ

The Amazon Echo Dot easily connects to the DockLinQ. Just follow these steps.

1. Turn OFF the Bluetooth function on your iPhone, iPad or any other mobile device that has Bluetooth.

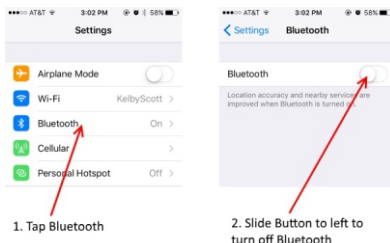

iPhone Menus to Turn Off Bluetooth

2. Take DockLinQ off the Bose SoundDock and slide the power button to the left. This will turn on battery. Place DockLinQ near Amazon Echo Dot.



Amazon Echo Dot Pairing with DockLinQ

3. Open the Alexa App on your phone, tablet or laptop. Then tap the 3 Line Menu icon in the upper left hand corner of the Home Screen.

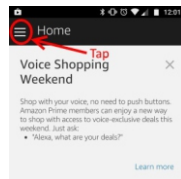

Alexa Home Screen

4. Tap Settings on the Home Menu.

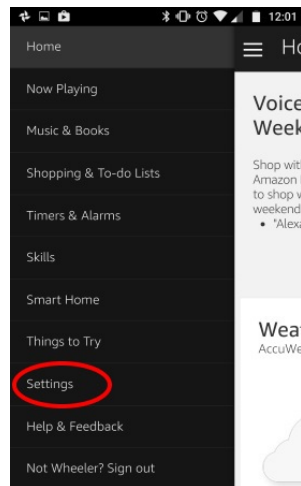

Alexa Home Menu

5. Tap Echo Dot under the Settings Menu. It will be the first choice.

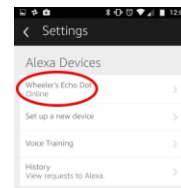

Alexa Settings Menu

6. Tap Bluetooth under Echo Dot settings.

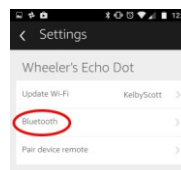

Echo Dot Settings

7. Tap the blue bar "Pair New Device" to start the search for the DockLinQ.

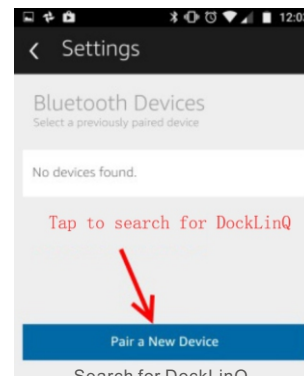

Search for DockLinQ

8. Tap DockLinQ to pair the Echo Dot with the DockLinQ.

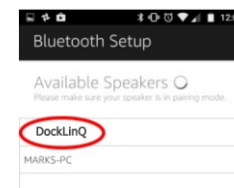

Pair DockLinQ

9. Once DockLinQ is connected to the Echo Dot you can plug the DockLinQ into your docking station.

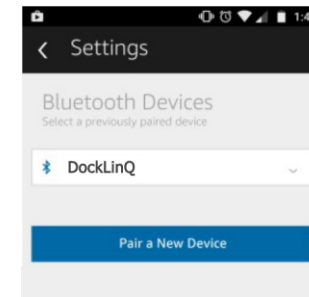

DockLinQ Paired with Echo Dot

10. Now you can tell Alexa to play music and it will come out of your Bose SoundDock.

## Specifications:

- QUALCOMM CSR Bluetooth 4.1 A2DP for Stereo sound
- Rechargeable Lithium battery supports up to 5 hours play time.
- 3.5 mm Aux jack supports connection to home, and car stereos with 3.5 mm line-in jack.
- 3.5 mm jack supports connection to wired earphones.
- Automatic detection of 5V and 12V power supply



## WARRANTY CARD

INVERy warrants this product against defect in material or workmanship for 1 year from the date of purchase.

Client name:	Contact Phone:
Address:	
Warranty reason:	

## FCC Warning

This device complies with part 15 of the FCC Rules. Operation is subject to the following two conditions:

(1) This device may not cause harmful interference, and (2) this device must accept any interference received, including interference that may cause undesired operation. Any Changes or modifications not expressly approved by the party responsible for compliance could void the user's authority to operate the equipment. This equipment has been tested and found to comply with the limits for a Class B digital device, pursuant to part 15 of the FCC Rules. These limits are designed to provide reasonable protection against harmful interference in a residential installation. This equipment generates uses and can radiate radio frequency energy and, if not installed and used in accordance with the instructions, may cause harmful interference to radio

communications. However, there is no guarantee that interference will not occur in a particular installation. If this equipment does cause harmful interference to radio or television reception, which can be determined by turning the equipment off and on, the user is encouraged to try to correct the interference by one or more of the following measures:

- Reorient or relocate the receiving antenna.
- Increase the separation between the equipment and receiver.
- Connect the equipment into an outlet on a circuit different from that to which the receiver is connected.
- Consult the dealer or an experienced radio/TV technician for help. The device has been evaluated to meet general RF exposure requirement. The device can be used in portable exposure condition without restriction.