

ISSUE	REVISION	BY	DATE
1	Adjust product render color	CN	21.06.22
2	Adjust opacity of the green & red on tracker's battery door	AH	22.06.22
3	fix graphic defects	AH	22.06.22
4	Adding IC number	AH	22.06.22
5	Adding Spot UV	AH	22.06.22

Trim / Part No	Trim / Part Name		
OT-00667	BT Tracker V2 - Black - Packaging sleeve		
Page	Title		
1 of 5	Packaging Sleeve		
Revision	Drawn By	Last Updated	
3		22/6/2022	
Scale	Strictly Confidential		orbitkey
1:1	© Orbitkey 2021		



Front

Back

Trim / Part No OT-00668	Trim / Part Name BT Tracker V2 - Stone - Packaging sleeve	
Page 4 of 5	Title Packaging Sleeve	
Revision 3	Drawn By	Last Updated 22/6/2022
Scale 1:1	Strictly Confidential © Orbitkey 2021 orbitkey	

226mm

Orbitkey x Chipolo Bluetooth Tracker V2

Locate your lost keys and belongings, in seconds.

FIND WITH **chipolo.**

- 01 Track your belongings.
- 02 Remote camera button.
- 03 Fits in any Orbitkey Key Organiser.
- 04 Replaceable CR1632 battery.

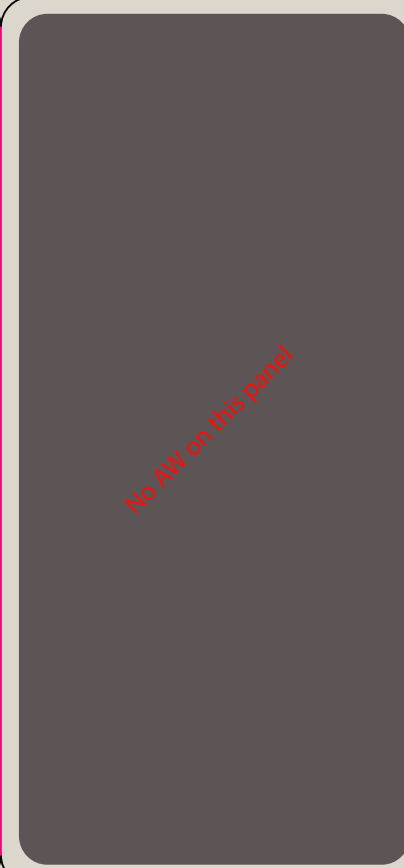

Connecting Your Tracker

- 1 Remove the plastic battery pull tab.
- 2 Download the **Chipolo app** from the iOS app store or Android play store.
- 3 Once logged in, you can add your tracker through **Partner Products** under the option +



Locating Your Tracker

- 1 In the Chipolo app, simply select the tracker you're locating and select **Ring To Find**.

Locating Your Phone

- 1 Double click the button on your tracker. If your phone is within range, it will ring.



How to Use the Remote Camera Button

- 1 In the Chipolo app, select the tracker you'd like to use as the camera trigger.
- 2 Select the Camera button within the app.
- 3 Double click the button on your tracker to snap a picture.

How to Use the Tassel

- 1 Loop the tassel through the hole of the tracker. Pull to secure.
- 2 Insert the other end of the tassel through an item you want to track.
- 3 Loop the tracker through the tassel.
- 4 Secure by pulling the tracker.

The tassel can be used to attach the tracker to anything you want to track (bags, umbrella, etc.). To learn more, visit www.orbitkey.com/tracker

117.5mm

WARNING



This product contains a coin cell battery. Do not ingest! battery, chemical burn hazard. Keep battery away from children (whether the battery is new or used). The battery can cause severe or fatal injuries in 2 hours or less if it is swallowed or placed inside any part of the body. Medical attention should be sought immediately if it is suspected the battery has been swallowed or placed inside any part of the body.

Replacing the Battery

- 1 Insert a small coin into the slot, and rotate the battery door 90° anticlockwise to unlock.

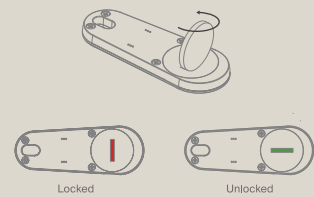

- 2 Use a small pin or paper clip to remove the old battery.

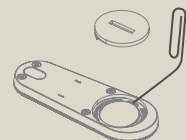

- 3 Insert a new CR1632 battery, ensuring the positive terminal faces upwards.

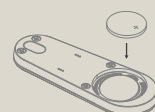

- 4 Replace the battery door.

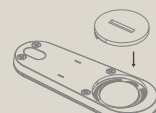

- 5 To lock, use a small coin to rotate the battery door 90° clockwise until you hear a click.

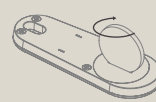

Customer Support

For additional details or assistance with product quality, contact us at: support@orbitkey.com

For assistance with software and connection, contact: support@chipolo.net
2 year warranty applies.

Requirements

The tracker is compatible with devices running iOS 12.4 and later, and Android 7 and later. The device must also be equipped with Bluetooth-4. A complete list of supported devices is available at www.chipolo.net/devices.

Specifications

Tracker range: up to 50m (160 ft)
- in open space -
90 - 95 dB
Sound output:
Temperature range: -10 c - 60 c
Voltage range: 1.8V - 3V
Frequency range: 2.4GHz ISM band
Battery type: CR1632
Battery life: up to 6 months

Product Disposal

At the end of its service life, this product should not be treated as household or general waste. It should be handed over to the applicable collection point for recycling of electrical and electronic equipment, or returned to the supplier for disposal.

Orbitkey Model No: TBT2
FCC ID: 2AT4I-TBT2
IC: 28666-TBT2



Declaration of Conformity

Warning: Changes or modifications to this unit not expressly approved by the party responsible for compliance could void the user's authority to operate the equipment.

This device complies with Part 15 of the FCC Rules. This device contains licence-exempt transmitter(s) / receiver(s) that comply with Innovation, Science and Economic Development Canada's licence-exempt RSS(s). Operation is subject to the following two conditions:
(1) This device may not cause harmful interference, and
(2) This device must accept any interference received, including interference that may cause undesired operation.

L'émetteur/récepteur exempt de licence contenu dans le présent appareil est conforme aux CNR d'Innovation, Sciences et Développement économique Canada applicables aux appareils radio exempts de licence. L'exploitation est autorisée aux deux conditions suivantes:
1. L'appareil ne doit pas produire de brouillage;
2. L'appareil doit accepter tout brouillage radioélectrique subi, même si le brouillage est susceptible d'en compromettre le fonctionnement.

NOTE: This equipment has been tested and found to comply with the limits for a Class B digital device, pursuant to Part 15 of the FCC Rules. These limits are designed to provide reasonable protection against harmful interference in a residential installation. This equipment generates, uses and can radiate radio frequency energy and, if not installed and used in accordance with the instructions, may cause harmful interference to radio communications. However, there is no guarantee that interference will not occur in a particular installation. If this equipment does cause harmful interference to radio or television reception, which can be determined by turning the equipment off and on, the user is encouraged to try to correct the interference by one or more of the following measures:
- Reorient or relocate the receiving antenna.
- Increase the separation between the equipment and receiver.
- Connect the equipment into an outlet on a circuit different from that to which the receiver is connected.
- Consult the dealer or an experienced radio/TV technician for help.

To maintain compliance with the FCC's RF exposure guidelines, place the product at least 5mm from nearby persons.

Trim / Part No OT-00670	Trim / Part Name BT Tracker V2 - Common - Instruction Manual	
Page 5 of 5	Title Instruction manual	
Revision 3	Drawn By	Last Updated 22/6/2022
Scale 1:1	Strictly Confidential © Orbitkey 2021	orbitkey