

# VR EVO

Lees altijd alle productdocumentatie VOORDAT u het product installeert.  
<https://www.warn.com/manuals/index.jsp>



## WAARSCHUWING

- Plaats **altijd** een goed zichtbare waarschuwing op de kabelgeleider.
- Gebruik **altijd** montagemiddelen van kwaliteitsklasse 8.8 metrisch (imperiaal: SAE grade 5) of hoger.
- Las **nooit** montagebouten.
- Gebruik **nooit** bouten die te lang zijn.
- Verifieer de benodigde boutlengte om ervoor te zorgen dat de schroefdraad voldoende aangrijpt.
- Voltooi **altijd** de lierinstallatie en haakbevestiging voordat u de bedrading installeert.

## MONTAGE

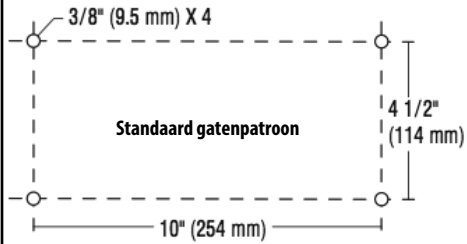

Plaatdikte	Boutlengte
7 mm (1/4")	32 mm (1 1/4")
10 mm (3/8")	40 mm (1 5/8")
13 mm (1/2")	40 mm (1 5/8")

Item	Aantal	Beschrijving
A, B, C	4	M10
D	2	M10 x 30
E	2	M12 x 35
F, G, H	2	M12

Item	Aantal	Beschrijving
A, B, C	4	M10
D	2	M10 x 30
E	2	M10 x 45

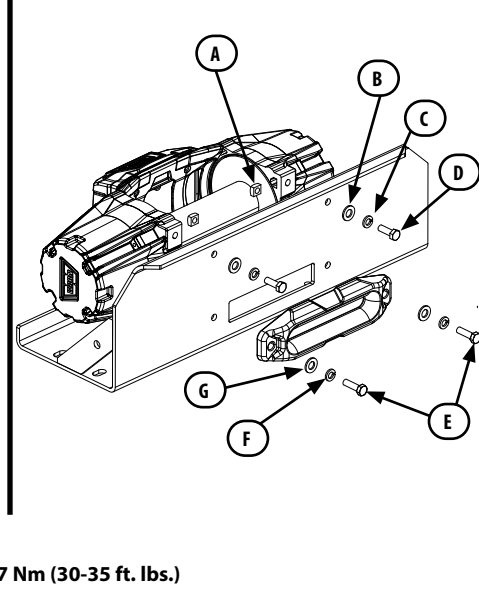
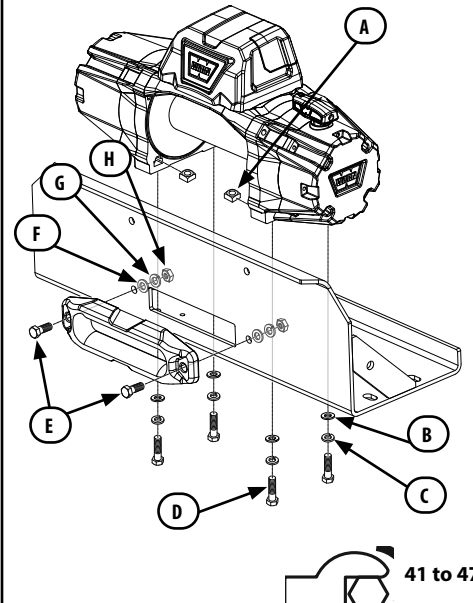

Item	Aantal	Beschrijving
A, B, C	4	M10
D	2	M10 x 30
E	2	M12 x 35
F, G, H	2	M12

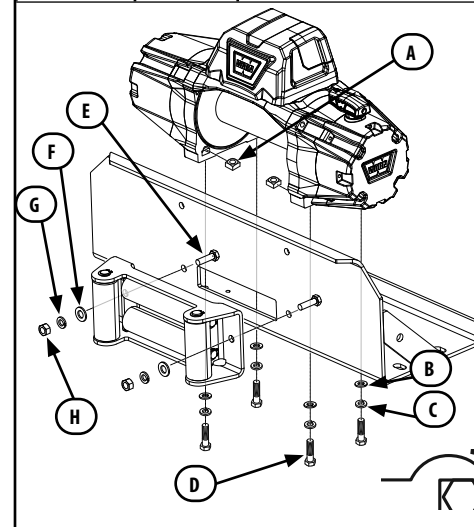

Item	Aantal	Beschrijving
A, B, C	4	M10
D	2	M10 x 30
E	2	M10 x 40

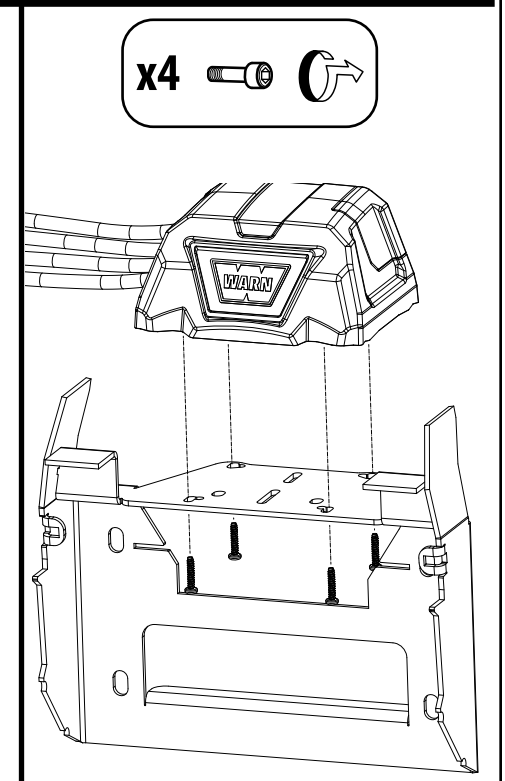
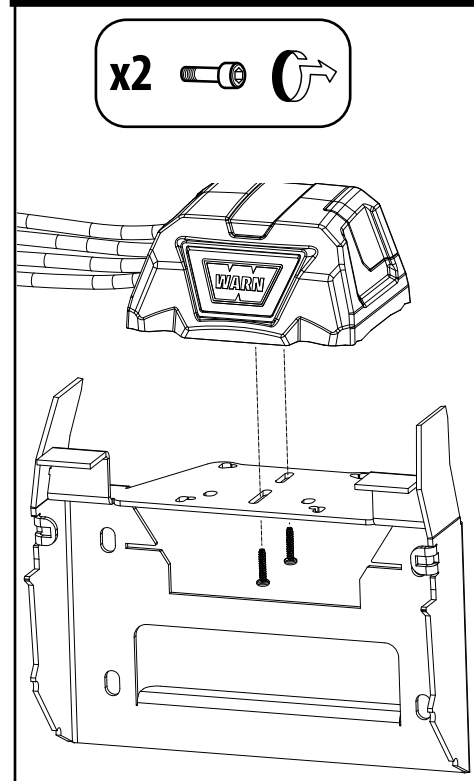
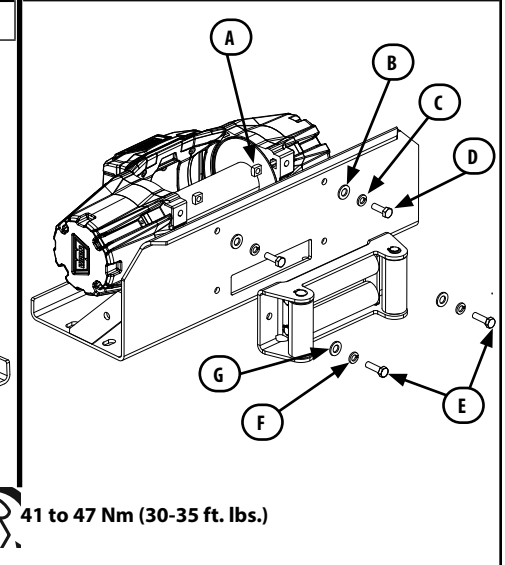

## BEDRADING ⚠ WAARSCHUWING

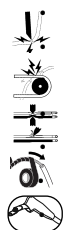

- Verwijder **altijd** alle sieraden en draag altijd een veiligheidsbril als u de accu aansluit.
- Leid elektriciteitskabels **nooit** over scherpe randen.
- Leg elektriciteitskabels **nooit** in de buurt van onderdelen die heet worden.
- Leid elektriciteitskabels **nooit** over accupolen.
- Leid elektriciteitskabels niet door of nabij bewegende onderdelen.
- Isoleer en bescherm **altijd** alle blootliggende bedrading en elektrische aansluitingen.
- Plaats **altijd** de meegeleverde klemhulzen op de draden en de aansluitingen.

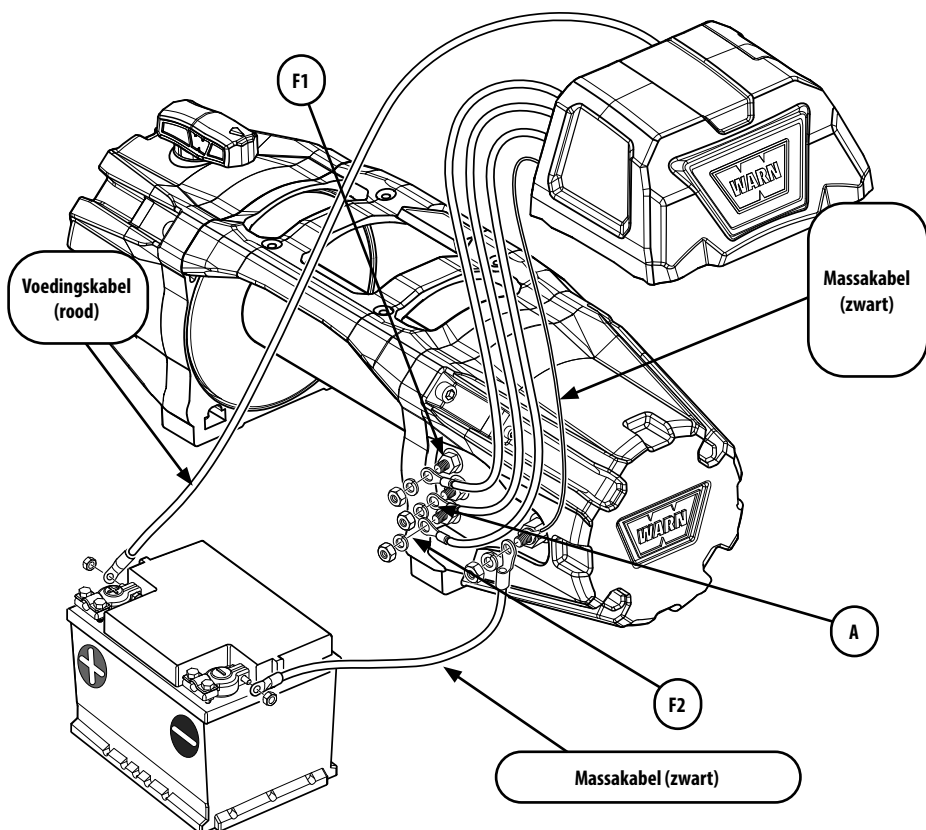

## AFSTANDSBEDIENING

### ⚠ WAARSCHUWING

- Schakel de koppeling **nooit** in of uit als de lier onder belasting staat, het lierkabel in spanning staat of de trommel in beweging is.
- Verlaat de lierafstandsbediening **nooit** waar deze kan worden geactiveerd tijdens het vrij ronddraaien, optuigen of wanneer de lier niet wordt gebruikt.
- Laat de afstandsbediening van de draadloze lier **nooit** ingeschakeld tijdens het installeren, freespooling, tuigage of onderhoud van een lier, of wanneer de lier niet wordt gebruikt.

**Knop voor draadloze activering:**  
Houd ingedrukt om de draadloze modus te activeren.

**Wired Activation Light:**  
Rood lampje aan wanneer bedrade modus is geactiveerd.

**Draadloos activeringslicht:**  
Blauw licht aan wanneer de draadloze modus is geactiveerd.

**Lier Power-Out-knop:**  
Druk op om de power-out-bediening van de lier te regelen.

**Winch Power-in-knop:**  
Indrukken om de power-in-bediening van de lier te regelen.

### Bedrade functie

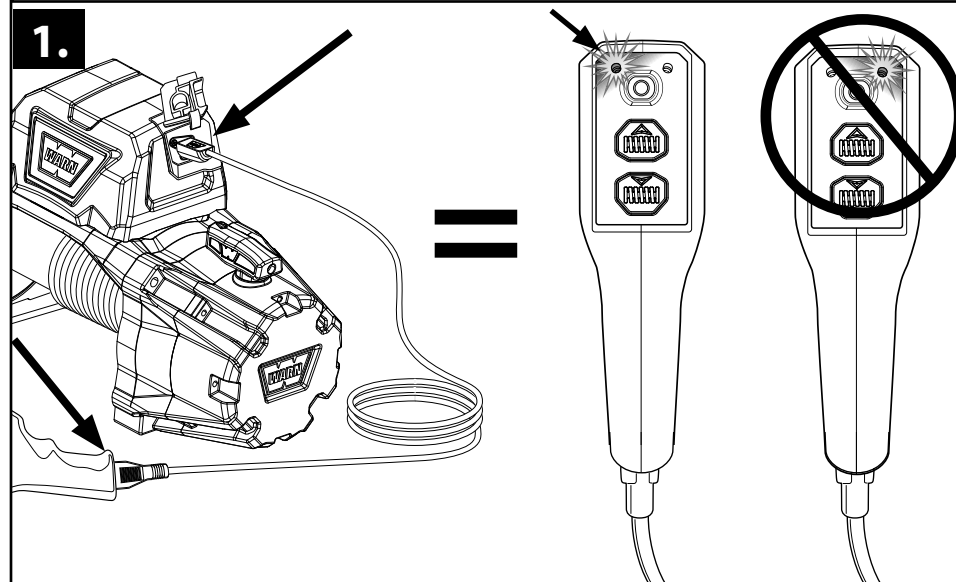

### Draadloze functie

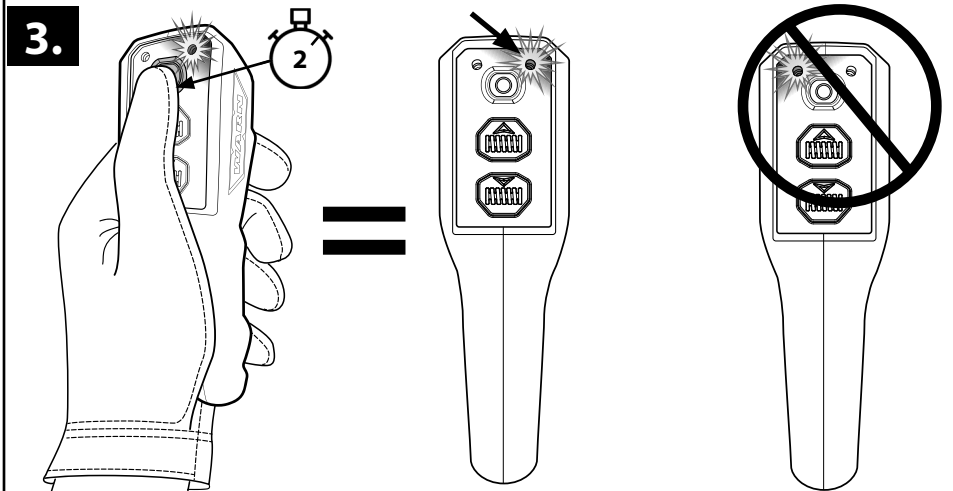
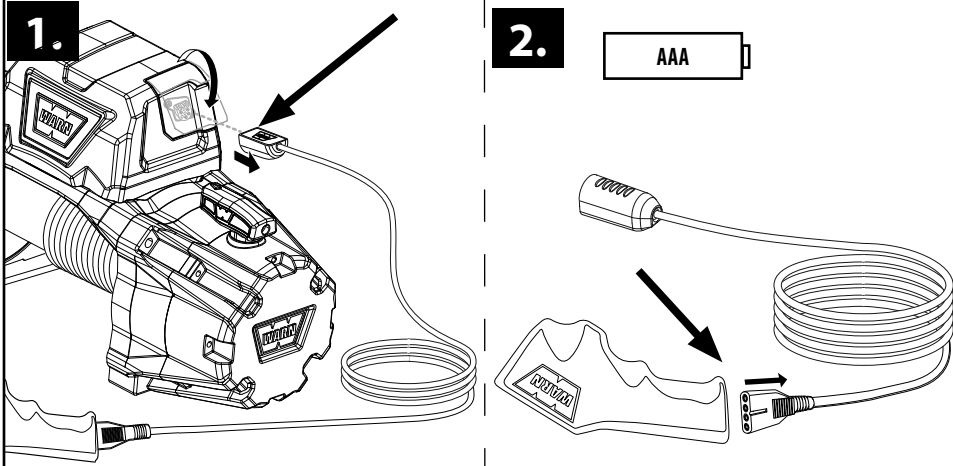

### Winching-functie

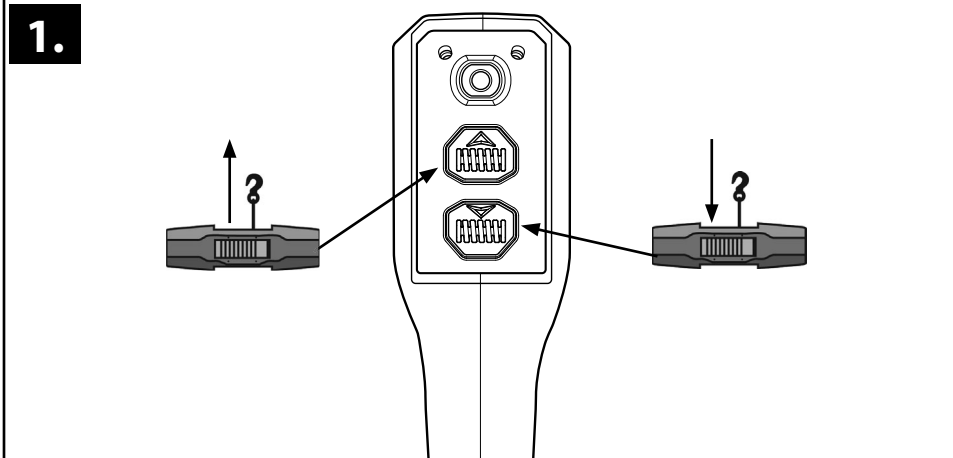

103485A4

## VR EVO

在安装产品之前, 务必阅读所有产品资料。  
<https://www.warn.com/manuals/index.jsp>



### 警告

- 始终适当定位导缆器, 确保警告在顶部可见。
- 始终使用公制8.8级(5级)或更好的五金配件。
- 切勿焊接安装螺栓。
- 切勿使用过长的螺栓。
- 始终确认所需的螺栓长度, 以确保正确的螺纹接合。
- 务必在安装布线前完成绞盘的安装和吊钩的连接。

### 安装

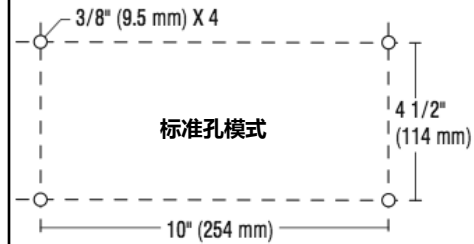

板厚度	螺栓长度
7 mm (1/4" )	32 mm (1 1/4" )
10 mm (3/8" )	40 mm (1 5/8" )
13 mm (1/2" )	40 mm (1 5/8" )

项目	数量	说明
A、B、C	4	M10
D	2	M10 x 30
E	2	M12 x 35
F、G、H	2	M12

项目	数量	说明
A、B、C	4	M10
D	2	M10 x 30
E	2	M10 x 45

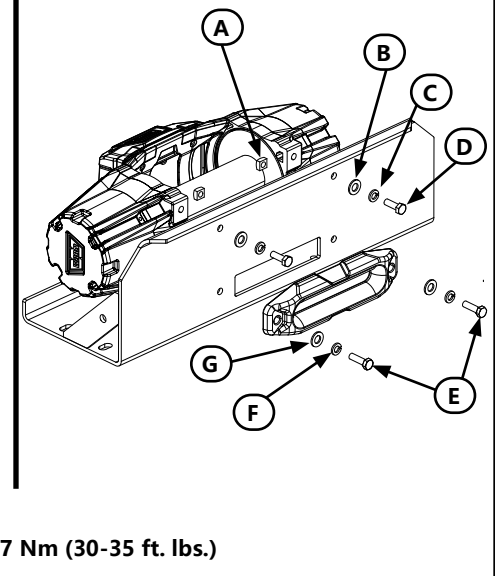
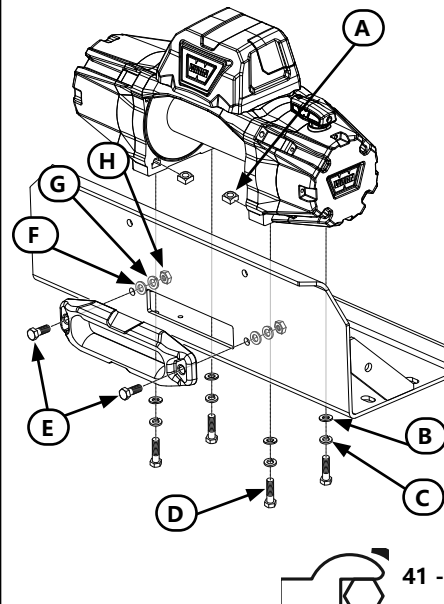

41 - 47 Nm (30-35 ft. lbs.)

103485A4

项目	数量	说明	项目	数量	说明
A、B、C	4	M10	A、B、C	4	M10
D	2	M10 x 30	D	2	M10 x 30
E	2	M12 x 35	E	2	M10 x 40
F、G、H	2	M12			

41 - 47 Nm (30-35 ft. lbs.)

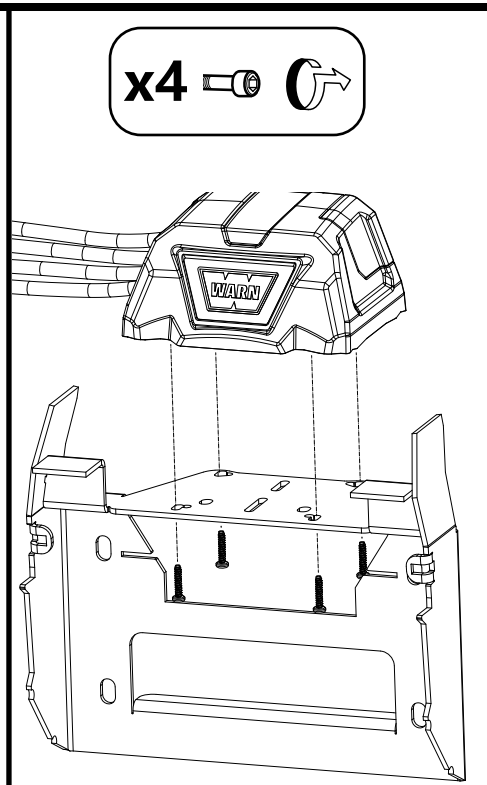
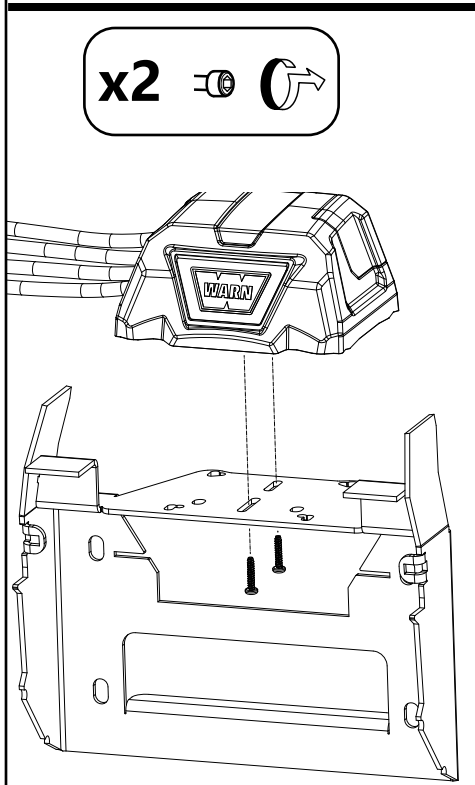

103485A4

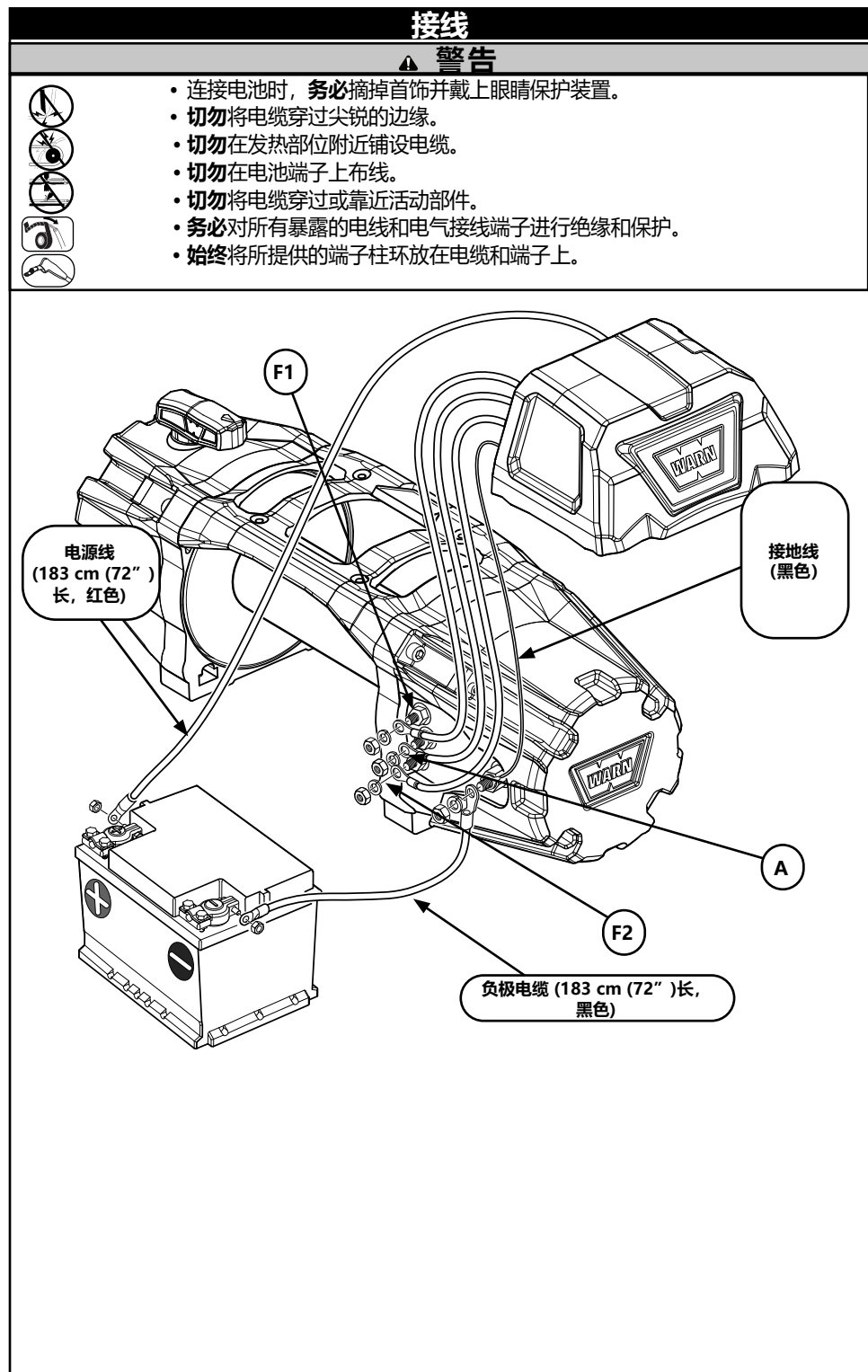

103485A4

## 遥控

### 警告

- 若绞盘处于负载状态，绞盘绳处于张力状态或滚筒处于运动状态，切勿接合或松开离合器。
- 切勿将绞盘遥控器放在它能够在自由卷线、传动或绞盘不使用时激活的地方。
- 切勿将无线绞盘遥控器放在它能够在安装、自由卷线、传动或维修绞盘或绞盘不使用时激活的地方。

无线启动按钮：  
按住可启动无线模式。

有线启动指示灯：  
当有线模式启动时，红灯点亮。

无线启动指示灯：  
当无线模式启动时，蓝灯点亮。

绞盘电源输出按钮：  
按下可控制绞盘的电源输出  
操作。

绞盘电源输入按钮：  
按下可控制绞盘的电源输入  
操作。

## 有线功能

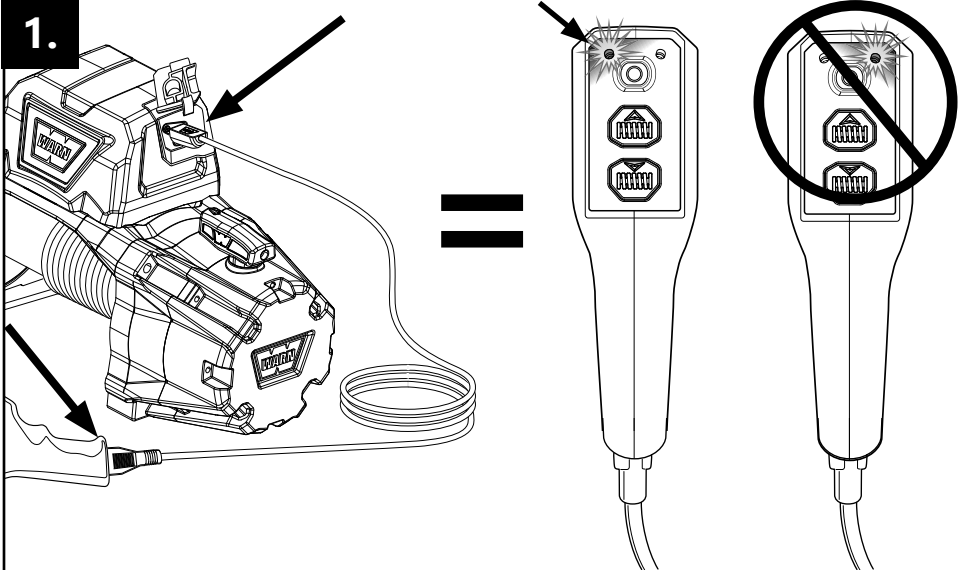

103485A4

## 无线功能

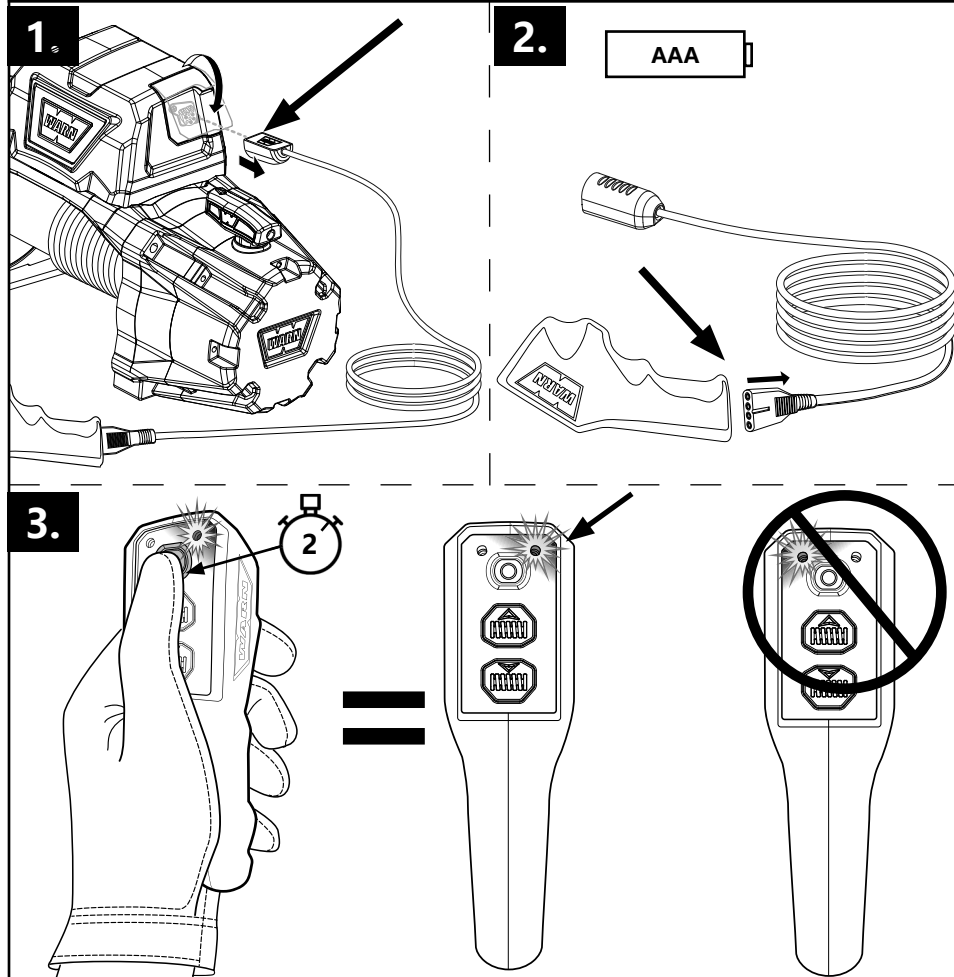

## 绞盘功能

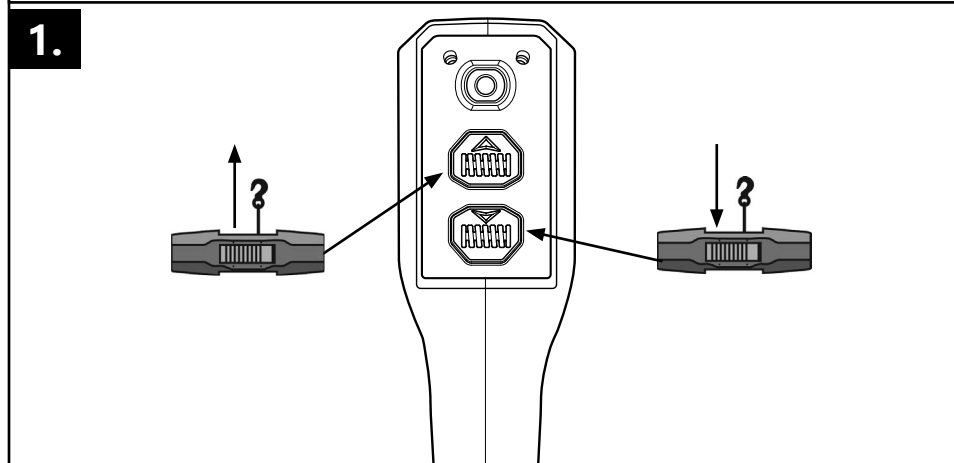

103485A4

## FCC& ISDE Statement

This device complies with Part 15 of the FCC Rules and with Industry Canada licence-exempt RSS standard(s). Operation is subject to the following two conditions:

(1) this device may not cause harmful interference, and (2) this device must accept any interference received, including interference that may cause undesired operation.

Cet appareil est conforme à la partie 15 des règles de la FCC et aux normes RSS exemptées de licence d'Industrie Canada. Le fonctionnement est soumis aux deux

conditions suivantes : (1) cet appareil ne doit pas causer d'interférences nuisibles, et (2) cet appareil doit accepter toute interférence reçue, y compris les interférences pouvant entraîner un fonctionnement indés

Changes or modifications to this unit not expressly approved by the party responsible for compliance could void the user's authority to operate the equipment.

NOTE: This equipment has been tested and found to comply with the limits for a Class B digital device, pursuant to Part 15 of the FCC Rules. These limits are designed to provide reasonable protection against harmful interference in a residential installation. This equipment generates, uses and can radiate radio frequency energy and, if not installed and used in accordance with the instructions, may cause harmful interference to radio communications. However, there is no guarantee that interference will not occur in a particular installation. If this equipment does cause harmful interference to radio or television reception, which can be determined by turning the equipment off and on, the user is encouraged to try to correct the interference by one or more of the following measures:

- Reorient or relocate the receiving antenna.
- Increase the separation between the equipment and receiver.
- Connect the equipment into an outlet on a circuit different from that to which the receiver is connected.
- Consult the dealer or an experienced radio/TV technician for help.

This device meets the exemption from the routine evaluation limits in section 2.5 of RSS 102 and compliance with RSS 102 RF exposure, users can obtain Canadian information on RF exposure and compliance.

cet appareil est conforme à l'exemption des limites d'évaluation courante dans la section 2.5 du cnr - 102 et conformité avec rss 102 de l'exposition aux rf, les utilisateurs peuvent obtenir des données canadiennes sur l'exposition aux champs rf et la conformité.

This equipment complies with Canada radiation exposure limits set forth for an uncontrolled environment.

Cet équipement est conforme aux limites d'exposition aux rayonnements du Canada établies pour un environnement non contrôlé.

## Radiation Exposure Statement for camera

This equipment should be installed and operated with minimum distance 0cm between the radiator & your body.

Cet équipement doit être installé et utilisé à une distance minimale de 0 cm entre le radiateur et votre corps.