

tineco

PURE ONE S12V SERIES Smart Vacuum Cleaner

Instruction Manual

Manual De Uso

Mode D'emploi



*Actual product may differ from illustration.

CONTENTS

Important Safety Instructions.....	2
Overview.....	5
Accessories.....	7
Assembly.....	9
Operation.....	11
Maintenance.....	21
Specifications.....	24
Troubleshooting.....	25
Warranty.....	27

Important Safety Instructions

SAVE THESE INSTRUCTIONS

Household use only.

When using an electrical appliance, basic precautions should always be followed, including the following:

READ ALL INSTRUCTIONS BEFORE USING (THIS APPLIANCE). Failure to follow the warnings and instructions may result in electric shock, fire and/or serious injury.

WARNING – To reduce the risk of fire, electric shock, or injury:

1. This appliance can be used by children aged from 8 years and above and persons with reduced physical, sensory or mental capabilities or lack of experience and knowledge if they have been given supervision or instruction concerning use of the appliance in a safe way and understand the hazards involved. Children shall not play with the appliance. Cleaning and user maintenance shall not be made by children without supervision.
2. The appliance is not to be used by persons (including children) with reduced physical, sensory or mental capabilities, or lack of experience and knowledge, unless they have been given supervision or instruction.
3. For **INDOOR** use **ONLY**. Do not use the appliance in outdoors, nor in commercial or industrial environments. Do not use the appliance on wet surfaces or surfaces with standing water.
4. Do not allow to be used as a toy. Close attention is necessary when used by or near children, pets or plants.
5. Use only as described in this manual. Use only manufacturer's recommended attachments.
6. Do not use with a damaged cord or plug. If appliance has been dropped, damaged, left outdoors, dropped into water, or is not working as it should, return it to a service center.
7. Do not handle charger, including charger plug, and charger terminals with wet hands.
8. Do not put any object into openings. Do not use with any openings blocked; keep free of dust, lint, hair, and anything that may reduce air flow.
9. Keep hair, loose clothing, fingers, and all parts of your body away from openings and moving parts.
10. Use extra care when cleaning on stairs.
11. Do not use to pick up flammable or combustible liquids, such as gasoline, or use in areas where they may be present.
12. Do not pick up anything that is burning or smoking, such as cigarettes, matches, or hot ashes.
13. Do not use without a filter.
14. Prevent unintentional activation. Ensure the switch is in the off position before connecting to the battery pack, picking up or carrying the appliance. Carrying the appliance with your finger on the switch or powering on the appliance with the switch on may cause accidents.

15. Disconnect the battery pack from the appliance before making any adjustments, changing accessories, storing the appliance. Such preventive safety measures reduce the risk of starting the appliance accidentally.
16. For the purposes of recharging the battery, only use the detachable supply unit provided with this appliance. A charger that is suitable for one type of battery pack may create a risk of fire when used with another battery pack.
17. Use appliances only with specifically designated Tineco battery packs. Use of any other battery packs may create a risk of injury and fire.
18. When battery pack is not in use, keep it away from other metal objects, like paper clips, coins, keys, nails, screws or other small metal objects, that can make a connection from one terminal to another. Shorting the battery terminals together may cause burns or a fire.
19. Under abusive conditions, liquid may be ejected from the battery; avoid contact. If contact accidentally occurs, flush with water. If liquid comes into eye contact, seek medical help. Liquid ejected from the battery may cause irritation or burns.
20. Do not use a battery pack or appliance that is damaged or modified. Damaged or modified batteries may exhibit unpredictable behavior resulting in fire, explosion or risk of injury.
21. Do not expose a battery pack or appliance to fire or excessive temperature. Exposure to fire or temperature above 266°F (130°C) may cause an explosion.
22. Follow all charging instructions and do not charge the battery pack or appliance outside of the temperature range specified in the instructions. Charging improperly or at temperatures outside of the specified range may damage the battery and increase the risk of fire.
23. Have servicing performed by a qualified repair person using only identical replacement parts. This will ensure that the safety of the product is maintained.
24. This appliance contains battery cells that are non-replaceable. Do not modify or attempt to repair the appliance or the battery pack except as indicated in the instructions for use and care.
25. Always turn off this appliance before connecting or disconnecting the motorized nozzle.
26. Do not charge or store the appliance outdoors or inside a car. Only charge, store or use the battery in a dry indoor area where the temperature is higher than 39.2°F (4°C) but lower than 104°F (40°C). The charger is for indoor use only.

Only For NA: FCC Supplier's Declaration of Conformity

Tineco Smart Vacuum Cleaner

1. **PURE ONE S12V** (VS12200AUS, VS12220AUS, VS12230AUS)

2. **PURE ONE S12V PLUS** (VS12210AUS, VS12240AUS, VS12250AUS)

This appliance complies with part 15 of the FCC Rules. Operation is subject to the following two conditions:

(1) This appliance may not cause harmful interference, and (2) this appliance must accept any interference received, including interference that may cause undesired operation.

TINECO INTELLIGENT, INC.

1700 WESTLAKE AVENUE N., SUITE 200, SEATTLE, WA, 98109, USA

Changes or modifications not expressly approved by the party responsible for compliance could void the user's authority to operate the equipment.

Note: This equipment has been tested and found to comply with the limits for a Class B digital appliance, pursuant to Part 15 of the FCC Rules. These limits are designed to provide reasonable protection against harmful interference in a residential installation. This equipment generates uses and can radiate radio frequency energy and, if not installed and used in accordance with the instructions, may cause harmful interference to radio communications. However, there is no guarantee that interference will not occur in a particular installation. If this equipment does cause harmful interference to radio or television reception, which can be determined by turning the equipment off and on, the user is encouraged to try to correct the interference by one or more of the following measures:

- (1) Reorient or relocate the receiving antenna.
- (2) Increase the separation between the equipment and receiver.
- (3) Connect the equipment into an outlet on a circuit different from that to which the receiver is connected.
- (4) Consult the dealer or an experienced radio/TV technician for help.

FCC Radiation Exposure Statement

This equipment complies with FCC radiation exposure limits set forth for an uncontrolled environment. This equipment should be installed and operated with a minimum distance of 15cm between the radiator and any part of your body.

Note

The manufacturer is not responsible for any radio or TV interference caused by unauthorized modifications to this equipment, such modifications could void the user's authority to operate this equipment.

IC Note

This appliance contains licence-exempt transmitter(s)/receiver(s) that comply with Innovation, Science and Economic Development Canada's licence-exempt RSS(s). Operation is subject to the following two conditions:

- (1) This appliance may not cause interference.
 - (2) This appliance must accept any interference, including interference that may cause undesired operation of the appliance.
- This Class B digital apparatus complies with Canadian ICES-003.
 - This equipment complies with ISED RSS-102 radiation exposure limits set forth for an uncontrolled environment. This equipment should be installed and operated with a minimum distance of 15cm between the radiator and any part of your body.

Overview

S12V

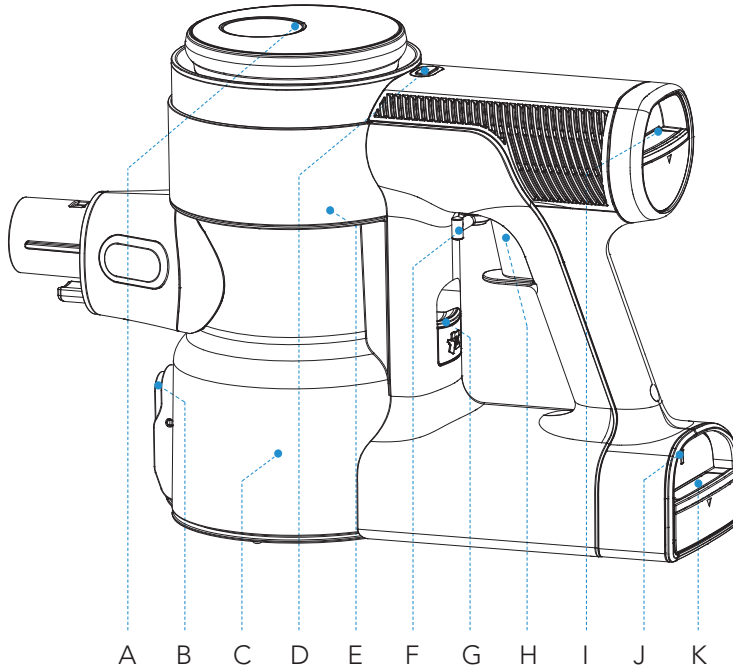

- A. Magnetic attachment zone
- B. Dust empty release button
- C. Dustbin
- D. MAX/AUTO
- E. WiFi reset button
(Remove the dustbin to access)

- F. Trigger lock
- G. Dustbin release button
- H. Trigger
- I. HEPA release button
- J. Battery indicator light
- K. Battery release button

S12V Plus

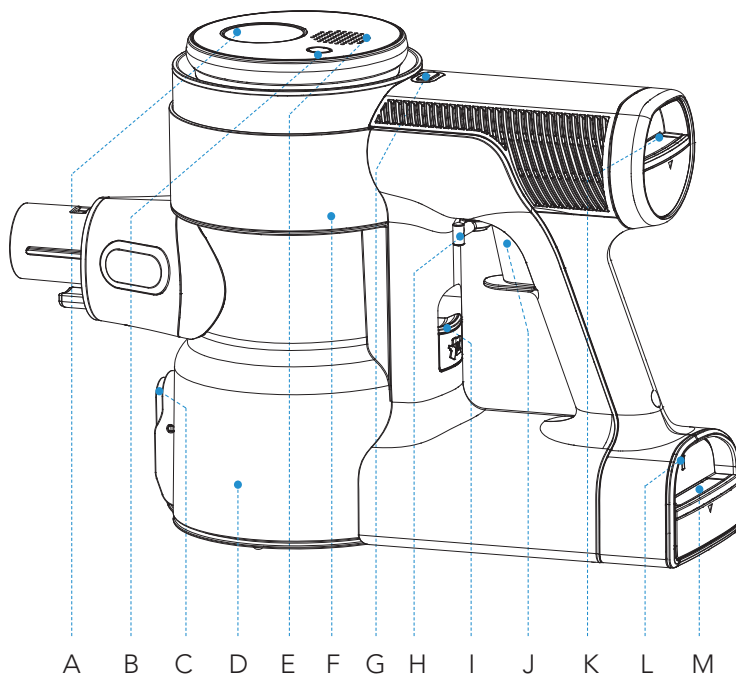

A. Magnetic attachment zone

B. Mute button

C. Dust empty release button

D. Dustbin

E. Built-in bluetooth speaker

F. WiFi reset button

(Remove the dustbin to access)

G. MAX/AUTO

H. Trigger lock

I. Dustbin release button

J. Trigger

K. HEPA release button

L. Battery indicator light

M. Battery release button

Accessories

Note:

- Test an accessory on a small, inconspicuous area before use on sensitive surfaces.
- The “Product Components” page shows which accessories are included with your purchase.
- As shown below, there are many components compatible with this model. If you require more accessories, please visit the Tineco Official Site.



www.tineco.com

Products

Parts and Accessories

Buy Now

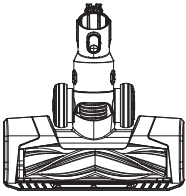

Full-size LED multi-tasker power brush

Ideal for both hard floors and carpets.

Very effective for agitating dirt embedded in the carpet.

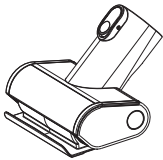

Mini power brush

For vacuuming upholstered furniture, mattresses etc.

Vacuums pet hair and removes ingrained dirt.

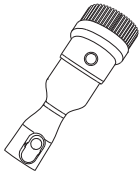

2-in-1 dusting brush

Switches between a wide and a soft brush by pressing the release button. The soft brush is most effective on hard-surface furniture while the wide brush is effective for upholstered furniture, curtains, etc.

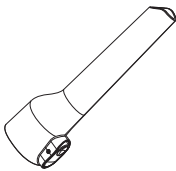

Crevice tool

For corners, nooks, and other hard-to-reach places such as around car seats, picture frames, and cupboards.



Soft dusting brush

Angled bristles on a slender, oval-shaped rim provide anti-static, cushioned contact. Suitable for dusting shelves, lighting, delicate surfaces, electronics and more.



Flexible long crevice tool

Easy to bend, easy to reach tight spots. Suitable for cleaning dust behind and beneath furniture, around refrigerators, and many other tight gaps.

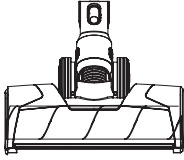

Full-size LED soft-roller power brush

Perfect for hard floors, especially sensitive wood floor. Picks up coarse and fine dirt at the same time.

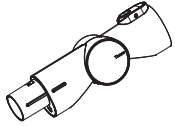

Multi-angle folding tube

An articulated joint makes it adjustable to allow for flexibility when cleaning from high to low.

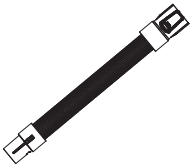

Flexible extension hose

Excellent extension and flexibility to access hard-to-reach spaces; perfect for in-care use. Compatible with all non-motorized Tineco accessories.

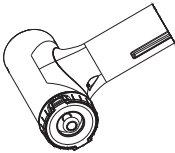

Pre-filter cleaning tool

A dirty filter is a leading cause of suction loss, and this tool is designed to make your filter last much longer. Place the dirty filter inside the pre-filter cleaning tool and close the lid. Run the appliance in MAX mode, and rotate the side cover.

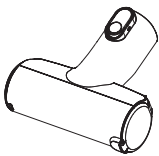

Automatic pre-filter cleaning tool

A dirty filter is a leading cause of suction loss, and this tool is designed to make your filter last much longer. Simply place the dirty filter inside the automatic pre-filter cleaning tool and close the lid. Connect the tool to the main body and pull the trigger. The appliance will automatically shut off once completed.



Hair cleaning tool

Use the end with the small blade to remove hair and debris wrapped around the roller. Use the end with the brush to clean the brush window, and the dustbin, as required.

Assembly

Tube Installation

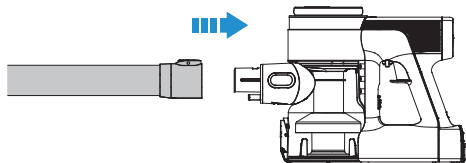

Insert tube.

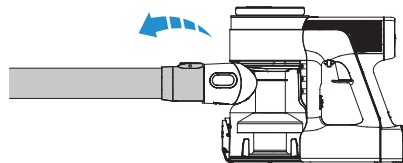

Press the release button to remove the tube.

Brush Installation

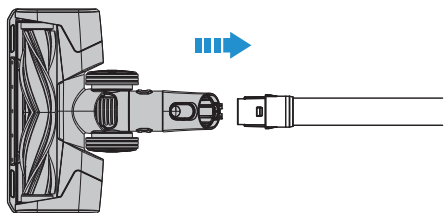

Insert the power brush.

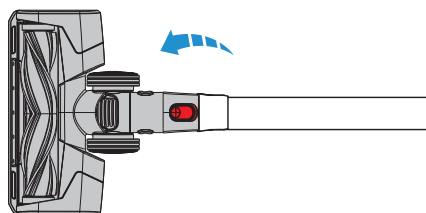

Press the release button to remove the power brush.

Dustbin Installation

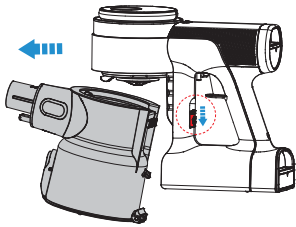

To clean the dustbin more thoroughly, press the dustbin release button to fully detach from the appliance.

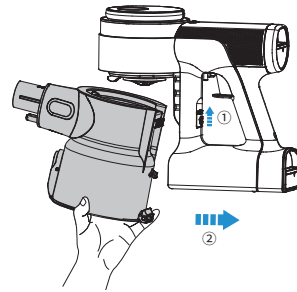

When re-attaching the dustbin, hold on an angle and slot the top of the dustbin into the hook on the main body. Push upwards until the hook is fixed into the slot on the dustbin and then it clicks into place.

Battery Installation

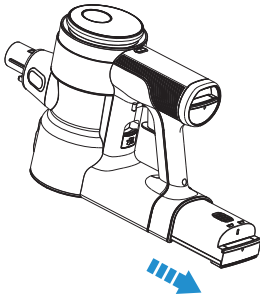

Press the battery release button, and remove the battery.

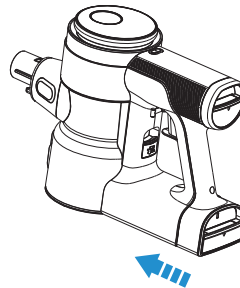

To replace, slide the battery into the slot at the base of the main body. The battery will click into position when correctly fitted.

Operation

Preparing for Use

Note:

- Before the first use, please charge the appliance (see "Charging the Battery") for 3-4 hours in an area where the ambient temperature is between 39.2°F (4°C) and 104°F (40°C).
- Select an accessory and attach it to the appliance before use (see "Accessories").

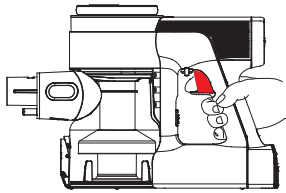

Pull the trigger to activate the suction.

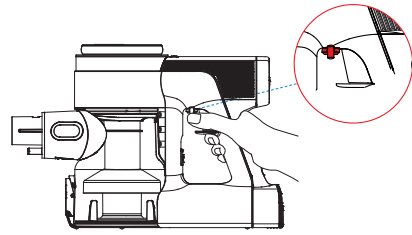

Pull the trigger lock to hold the trigger for continuous power mode.

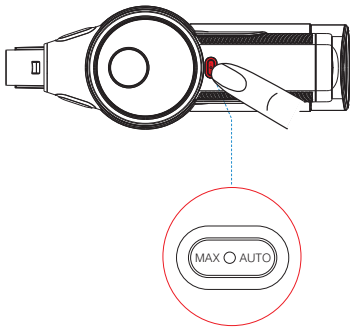

The appliance will start in AUTO mode by default. After 3 seconds, press the MAX/AUTO button to switch to Max mode.

- Determine the best wall location for mounting the dock. Choose a location close to an electrical outlet and measure the length of the power cord to be sure that it will reach.

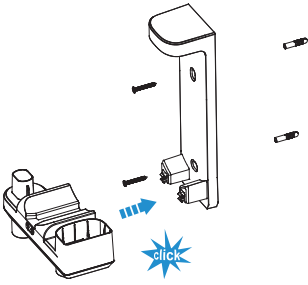

Assemble the two bracket components, with a “click” to signify correct assembly. Once this is complete, use the screws provided by Tineco to affix the dock to the wall.

Warning:

- Ensure the wall surrounding the mounting area is free of gas or water pipes and electrical cables and wires.
- To avoid the dock falling, ensure it is firmly installed.

- Place the appliance on the wall-mounted dock for convenient storage and recharging after use.

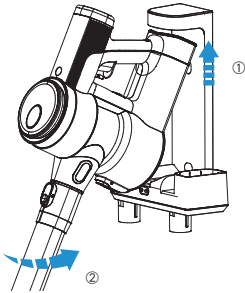

Place the main body on the dock.

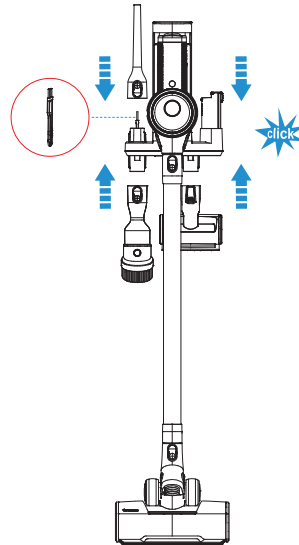

To avoid bristle damage, always place attachments on the dock after use.

Adhesive Magnet

1

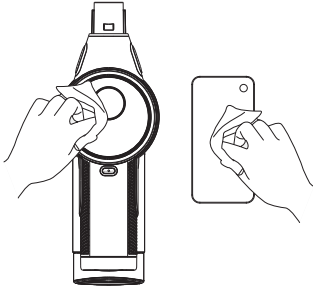

With a dustless cloth, wipe the main body and the back of your phone to remove all dust.

2

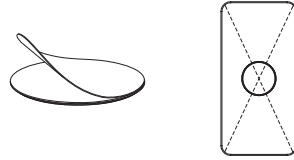

Remove the cover from the adhesive surface and place the magnet on the back of the phone. Wait 10 minutes before using.

3

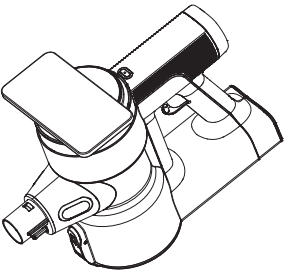

With the magnet attached, place the phone on the magnetic attachment zone in order to secure on the main body.

Note:

- The ideal ambient temperature when attaching the magnet is 59 °F (15°C) - 100.4 °F (38 °C). Do not attach if ambient temperature is below 50 °F (10 °C).
- To prevent air bubbles, start at one end and gently move to the other end.
- Do not re-use the magnet if it falls off, and contact Customer Service to purchase a new one.
- If the phone is moved, return to original position to prevent from slipping and falling.
- The adhesive magnet is suitable for use on metal and plastic surfaces. It is unsuitable for use on glass, pottery or porcelain.
- As such, we recommend using phone cases made from metal, plastic, silicone, TPU, etc.
- To prevent the phone from falling due to oversized/overweight, recommended phone size/weight: less than 7.2 inches/230g.
- Magnetic attachment zone should be kept away from other magnetic objects.

Discover More

Work with Alexa



Connect your devices to Alexa and you can give voice commands to check work status, obtain a cleaning report, etc.



Voice Prompt (for PURE ONE S12V Plus)

The appliance can report the work status in real time.

List of voice prompt	
"Auto mode"	"Please clean the pre-filter" (when WiFi connected)
"Max mode"	"Please clean the dustbin" (when WiFi connected)
"WiFi connected"	"Dust sensor malfunction"
"Bluetooth enabled"	"Brush roller tangled"
"Bluetooth connected"	"Air channel blocked, please remove blockages and clean the filters."
"Bluetooth disconnected"	"Voice prompts on"
"Low battery, please charge"	"Voice prompts off"
"Charging"	

- Press  to disable voice prompts when the indicator is illuminated. Press  again to turn the voice prompts on.

Built-in Bluetooth Speaker (for PURE ONE S12V Plus)

With successful pairing, the Bluetooth speaker can play audio from your phone.

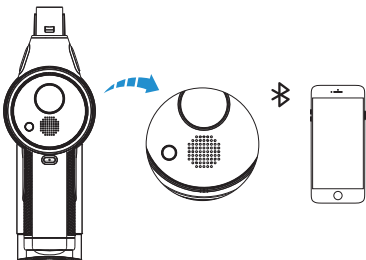

1. Pull the trigger to activate Bluetooth on the appliance.
2. Enable Bluetooth on your phone and select "Tineco_XXXX" from the device list.

Note:

- If the device is not used for 30 minutes or more, Bluetooth will automatically disconnect.

NFC Reader

- The appliance is equipped with NFC technology, enabling for simpler connection to the Tineco app.

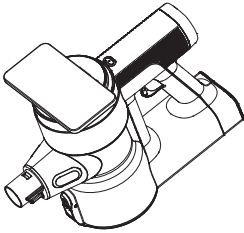

①

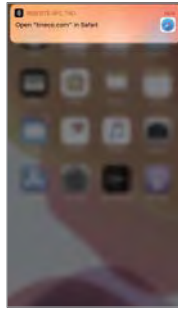

iOS ▲



② Android ▲



③

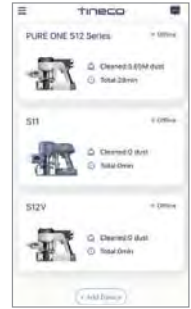

④

1. Enable NFC functionality and place the phone within the reading area.
2. Follow the prompts on your phone screen to go to the app download page; no need to search in the App Store.
3. After the app is downloaded, the login page will automatically appear.
4. After login, the Tineco device list page will open.

Note:

- Please enable the NFC function on your phone before use.
- First test the NFC sensing area of your phone during use to ensure compatibility with your phone model.
- Android: Only for NFC-enabled phones; iOS: Only for iPhone XR or above.

App

- All functions can be performed using the Tineco app. Download the Tineco app to access more features.



✓ iOS 9.0 or later

✓ Android 5.0 or later

App Function Introduction



Battery

Battery level in real time.



Cleaning report

Displays the dust amount, working hours and working status.



Suction adjustment

When in manual mode, swipe the phone screen to adjust suction power.



Filter status reminder

Records the severity of the dirty filter and provides a cleaning reminder as required.



Contact us

You can contact the Customer Service about any problems during the working hours.



Feedback

If you have any comments, please send us your feedback.

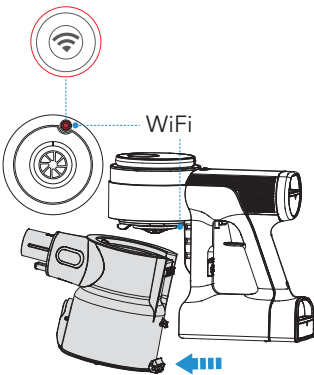

Note:

- To disable the WiFi module, pull the trigger to activate the appliance. Remove the dustbin to access the WiFi button, press and hold it for 20 seconds until **MAX AUTO** lights off.
- To enable the WiFi module, pull the trigger to activate the appliance, then press the WiFi button for 2 seconds with **MAX AUTO** blinking and the WiFi module is turned on.

Cleaning Mode Selection

AUTO mode

- In AUTO mode, the suction power will change in real time according to the amount of dust detected.

Start in two ways:

①

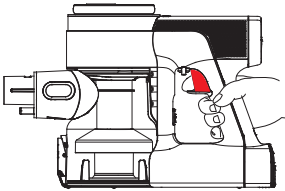

The default setting on startup is AUTO. The appliance then takes 3 seconds to initially detect blockages or dust. If no dust is detected, power is reduced to conserve energy.

②

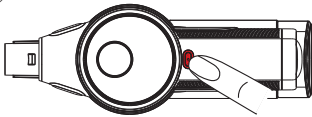

In Max mode, press MAX/AUTO button or click AUTO in the App to enter the AUTO mode.

MAX mode

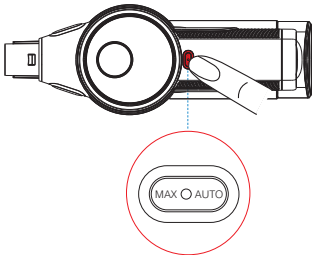

In AUTO mode, press the MAX/AUTO button to switch to MAX mode.

Remark: You can also swipe in the App to adjust suction power as needed.