

# Walkie-talkie

## User Manual

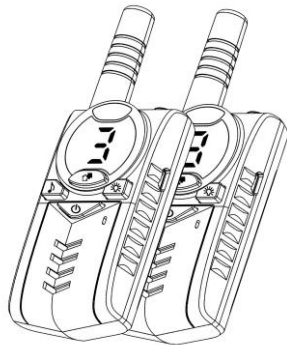

### Functions at Glance

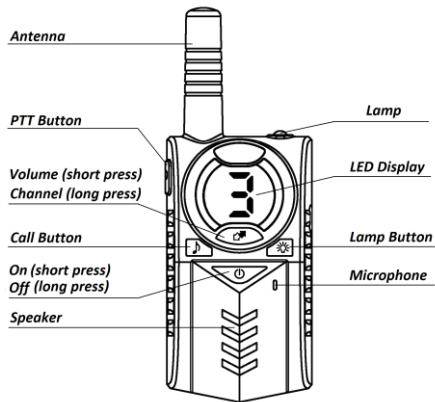

### BEFORE USE

#### Removing the belt clip

Before insert batteries into the device, first pull the belt clip latch away from the device.

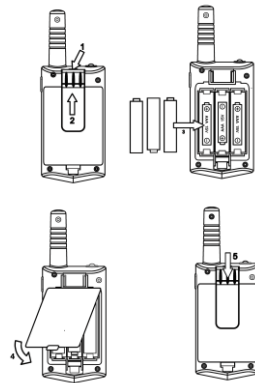



## Installing the Batteries

1. Slid down the battery compartment cover.
2. Insert 3\* AAA Alkaline Battery (Not included)
3. Position the batteries according to the polarity marking on the battery compartment.
4. After placing batteries into correct positions, put the battery cover back on.

## Using the device

### 1. Turning the device on/off

- a. Switch on the device: short Press the  button then you will hear a beep sound.
- b. Switch off the device: Long Press the  button 3 seconds then you will hear a beep sound.

### 2. Receiving/transmitting communications:

The devices are in "Reception" mode when it is turned ON and no transmitting.

When you press the PTT (push to talk) button, the device switches to "Transmission" mode.

Hold the device in a vertical position with the MIC (microphone) 3-5 cm away from your mouth. While holding the **PTT** button, speak into the microphone in a normal tone of voice.

Release the **PTT** button when you have finished transmitting.

For others to receive your transmission, they must be on the same channel with you.

### Note:

1. The talking range depends on terrain and weather conditions. It will be affected by obstructions such as hills, bush or buildings.
2. Don't try to use two devices which are less than 1.5m (5 feet) apart. Otherwise, you may experience interference.

### 3. Changing Channels

Press and hold the **channel button** for 3 seconds to change the channel.

### 4. Sending a call tone

Press the **CALL button**, the call tone will be transmitted on the setting channel.

### 5. Battery saving function

When the device has not been used for 6 seconds, the economy mode is automatically activated. This does not affect the reception of transmission and the standby mode is automatically re-activated as soon as a signal is detected.

### 6. Built-in Flashlight

Your device has a built-in flashlight that can be used in sending light signals or for our lighting needs.

### 7. Low battery switch off

When low battery level is detected, the walkie talkie will beep twice and shut down

### 8. Charging

Plug in the charger

The LED indicator will begin to flash.

Indicates that charging is in progress.

After being fully charged,

LED stops flashing

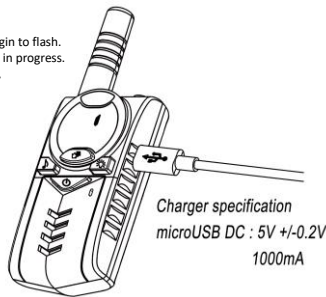

## 9. Technical specifications

Frequency	446.00625MHz~446.5625MHz 462.5625MHz~462.6625MHz
Channel	3 channels
Transmission Power	≤0.5W
Range	Up to 5 Km in open field
Battery type	3* AAA Alkaline/rechargeable batteries (DC4.5V) The battery voltage: 1.5V
Modulation type	FM-F3E
Channel spacing	12.5 kHz (Narrowband)

## 10. Transmit and Receive Procedure

Your two-way radio contains a transmitter and a receiver. To control your exposure and ensure compliance with the general population/uncontrolled environment exposure limits, always adhere to the following procedure:

•Transmit no more than 50% of the time. To receive calls, release the PTT button. To transmit (talk), press the Push to Talk (PTT) button. Transmitting 50% of the time, or less, is important because the radio Generates measurable RF energy exposure only when transmitting (in terms of measuring standards compliance).

•Always hold the radio approximately 5cm in front of your mouth with the antenna pointing away from your head.

## 11. Channel and Frequency (MHz)

### USA

Ch.	Frequency	CTCSS
1	462.5625MHz	100 Hz
2	462.6125MHz	100 Hz
3	462.6625MHz	100 Hz

### Europe

Ch.	Frequency	CTCSS
1	446.00625MHz	100 Hz
2	446.03125MHz	100 Hz
3	446.05625MHz	100 Hz

### FCC Statement

This equipment has been tested and found to comply with the limits for Part 15 of the FCC rules. These limits are designed to provide reasonable protection against harmful interference in a residential installation. This equipment generates, uses and can radiate radio frequency energy and, if not installed and used in accordance with the instructions, may cause harmful interference to radio communications. However, there is no guarantee that interference will not occur in a particular installation. If this equipment does cause harmful interference to radio or television reception, which can be determined by turning the equipment off and on, the user is encouraged to try to correct the interference by one or more of the following measures:

- Reorient or relocate the receiving antenna.
- Increase the separation between the equipment and receiver.
- Connect the equipment to an outlet on a circuit different from that to which the receiver is connected.
- Consult the dealer or an experienced radio/TV technician for help.

Any changes or modifications not expressly approved by the party responsible for compliance could void the user's authority to operate the equipment. This device complies with part 15 of the FCC Rules. Operation is subject to the condition that this device does not cause harmful interference.

### RF Exposure Warning

This equipment must be installed and operated in accordance with provided instructions and must not be co-located or operating in conjunction with any other antenna or transmitter. End-users and installers must be provide with antenna installation instructions and transmitter operating conditions for satisfying RF exposure compliance. The SAR limit adopted by US is 1.6 W/kg averaged over 1 grams of tissue. The highest SAR value for this device type when properly worn on the body is 0.19 W/kg.