USER MANUAL

Action Camera

Keychain

FCC Statement

Changes or modifications not expressly approved by the party responsible for compliance could void the user's authority to operate the equipment.

This equipment has been tested and found to comply with the limits for a Class B digital device, pursuant to Part 15 of the FCC Rules. These limits are designed to provide reasonable protection against harmful interference in a residential installation. This equipment generates uses and can radiate radio frequency energy and, if not installed and used in accordance with the instructions, may cause harmful interference to radio communications. However, there is no guarantee that interference will not occur in a particular installation. If this equipment does cause harmful interference to radio or television reception, which can be determined by turning the equipment off and on, the user is encouraged to try to correct the interference by one or more of the following measures:

- Reorient or relocate the receiving antenna.
- Increase the separation between the equipment and receiver.
- Connect the equipment into an outlet on a circuit different from that to which the receiver is connected.
- Consult the dealer or an experienced radio/TV technician for help

This device complies with part 15 of the FCC rules. Operation is subject to the following two conditions (1) this device may not cause harmful interference, and (2) this device must accept any interference received, including interference that may cause undesired operation.

IC Statement

This device complies with Industry Canada's licence-exempt RSSs. Operation is subject to the following two conditions:

- (1) This device may not cause interference; and
- (2) This device must accept any interference, including interference that may cause undesired operation of the device.

The term "IC: " before the certification/registration number only signifies that the Industry Canada technical specifications were met. This product meets the applicable Industry Canada technical specifications.

Cet appareil contient des émetteurs / récepteurs exemptés de licence conformes aux RSS (RSS) d'Innovation, Sciences et Développement économique Canada.

L'exploitation est autorisée aux deux conditions suivantes : (1) l'appareil ne doit pas produire de brouillage,

et (2) l'utilisateur de l'appareil doit accepter tout brouillage radioélectrique subi, même si le brouillage est susceptible d'en compromettre le fonctionnement.

CONTENTS

What's in the Box	1
Your Keychain Camera	2
Getting Started	3
Standalone Use	4
Download the AKASO GO App	5
Connecting to the App	5
Customizing Your Keychain Camera in the "AKASO GO" App	7
Accessories Introduction	11
Updating Your Camera's Software	12
Q&A	12
Contact Us	13

WHAT'S IN THE BOX



AKASO Keychain
Camera * 1



Pivot Stand and Pivot
Stand Base * 1



Carry-on Camera
Case * 1



Magnet Base * 1



Easy Clip * 1



Type-C Charging
Cable * 1



Quick Start Guide * 1

YOUR KEYCHAIN CAMERA

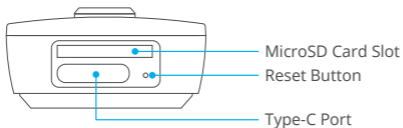
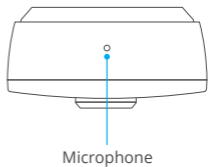
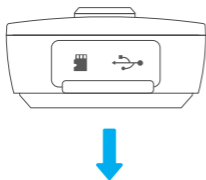
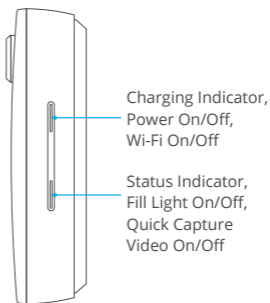
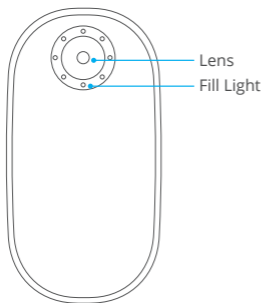

GETTING STARTED

1. CHARGING THE BATTERY

To make the most of your new camera, we recommend fully charging the battery before first use.

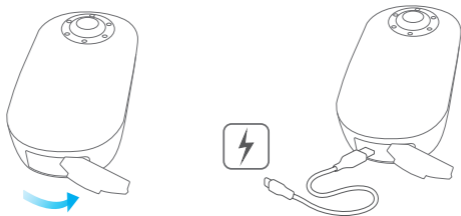

Step1: Open the door.

Step2: Charge the battery using the USB-C cable included.

Note: The battery cannot be removed from the camera.

The camera status light turns red during charging. When charging with a computer, be sure that the computer is connected to a power source. If the camera status light does not turn on, use a different USB port.

2. INSERTING/REMOVING MICROSD CARDS

- Insert the card (not included) at a downward angle with the label facing down.
- To remove the card, press it into the slot with your fingernail and it will pop out.

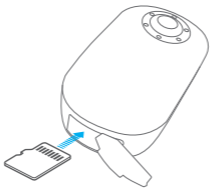

Please use brand name memory cards that meet these requirements:

- microSD, microSDHC or microSDXC
- Class 10 or UHS-I rating
- Capacity up to 64GB (FAT32)

Note: Handle memory cards with care. Avoid contact with liquids, dust, and debris.

As a precaution, power off the camera before inserting or removing the card.

Check manufacturer guidelines regarding use in acceptable temperature ranges.

STANDALONE USE

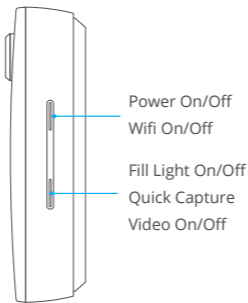

Power On/Off

Press and hold the Power on/off Button for at least 2 seconds to power on/off the Keychain camera, indicated by two short vibrations and a blue status indicator.

Tips: If you turn on auto shut down (1/3/5 Mins) and your Keychain camera stays in standby mode for over 1/3/5 Mins, it will shut down automatically.

Fill Light On/Off

Firstly make sure the camera is on, press and hold the Fill Light button for at least 2 seconds to turn on or turn off the fill light.

Quick Capture On/Off

Firstly make sure the camera is on. Press the Quick Capture button and you will see the blue indicator flash showing that your Keychain camera has started video capture. Press again to stop capturing the video.

Tips: Default setting is Normal Video. The camera will also remember the video shooting mode you selected in the app last time.

DOWNLOAD THE AKASO GO APP

The AKASO GO app is available on the App Store© and Google Play™.



CONNECTING TO THE APP

The AKASO GO app lets you control your camera remotely using a smartphone or tablet.

Features include camera control, live preview, playback, download, and settings.

- ① Turn on the camera. Press the Power button to turn on Wifi on the camera.
- ② Turn on Wifi on your phone, select the Wifi named SNKXXXX and enter the password: 1234567890 on your smartphone WLAN setting.
- ③ Open the AKASO GO app. Tap the "+" icon on the upper right corner. Add "KeyChain" and click the "Live Preview".

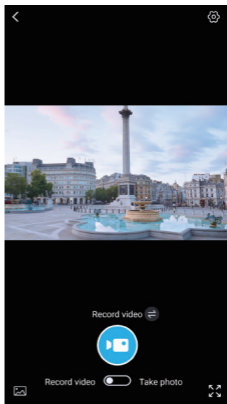
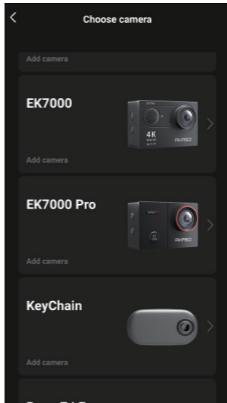
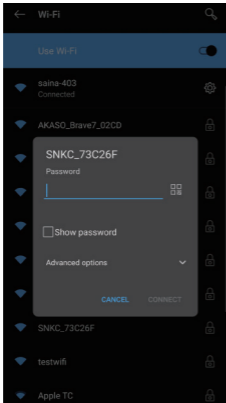

- ④ Having successfully connected to your Keychain, you can capture photos or videos via the app.

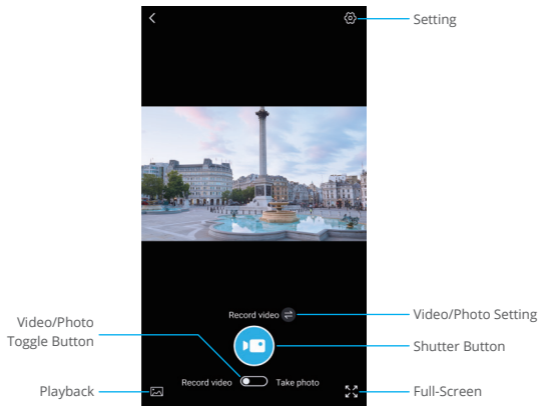

Note: The interface for default Video mode shown here is for illustrative purposes only.

CUSTOMIZING YOUR KEYCHAIN CAMERA IN THE “AKASO GO” APP

1. Video Setup

Video Setting	Video Resolution
Record Video	4k30fps, 2.7k30fps, 2.7k60fps, 1080P60fps, 1080P30fps, 720P120fps, 720P60fps
Loop Recording	4k30fps, 2.7k30fps, 2.7k60fps, 1080P60fps, 1080P30fps, 720P120fps, 720P60fps
Time-Lapse Video	4k30fps, 2.7k30fps, 2.7k60fps, 1080P60fps, 1080P30fps, 720P120fps, 720P60fps
Slow Motion Video	1080P60fps, 720P120fps, 720P60fps

• Record Video

Default setting is Record Video. Press the Shutter button and the camera will record a slow motion video.

Note: When capturing videos in high resolution or high frame rate in warm ambient temperatures, the camera may become warm and use more power.

• Loop Recording

Loop recording time: 1 Min/3 Min/5 Min

Default setting is 1 Min.

Loop recording allows your camera to overwrite old files with new files. Once the microSD card becomes full, the camera will delete the first video file to make room for the latest file. For example, if the setting for loop recording is “1 Minute”, then the camera will create video clips of 1 minute in length. A 1 minute clip will be deleted when memory is full.

• Time-Lapse Video

Time Lapse: 1 Sec/3 Sec/5 Sec/10 Sec/30 Sec/1 Min

Default setting is 1 Sec.

In Time Lapse Video mode, press the Shutter button and the camera will record a video from frames captured at specific intervals.

Note: Time Lapse Video is captured without audio.

• Slow Motion Video

In Slow Motion Video mode, press the shutter button and the camera will record a slow motion video.

• Wind Noise Reduction: Off/On

Default setting is Off.

Turn on Wind Noise Reduction to lower noise as required.

- **Image Stabilization:** Off/On

Default setting is Off.

This setting adjusts the footage to offset for motion during capture. The result is smoother footage, particularly useful when doing activities like cycling, motorcycling, and other activities in which the camera is easily destabilized.

Note: Image stabilization cannot be activated when the video resolution is 1080P120fps, 720P240fps and 720P120fps.

2. Photo Setup

Photo Setting	Photo Resolution
Take Photo	20MP, 16MP, 14MP, 10MP, 8MP, 5MP
Burst Photo	20MP, 16MP, 14MP, 10MP, 8MP, 5MP
Time-lapse Photo	20MP, 16MP, 14MP, 10MP, 8MP, 5MP

- **Take Photo**

Default setting is Take Photo.

- **Burst Photo**

Continuous shots: 3 shots/7 shots/15 shots/30 shots

Default setting is 3 shots.

In burst mode, several photographs are captured in quick succession, perfect for capturing fast-moving activities.

- **Time Lapse**

Time lapse interval: 3 Sec/5 Sec/10 Sec/30 Sec/1 Min

Default setting is 3 Sec. Time Lapse Photo captures a series of photos at specified intervals. Use this mode to capture photos of any activity, then choose the best ones later.

3. System Setting

- **Fill Light:** On/Off

Default setting is Off.

In low luminance lighting conditions, Fill Light setting will help better capture photos and videos.

- **Auto-rotate:** On/Off

Default setting is On.

This setting determines the orientation of your video or photos to help you prevent upside down footage.

- **Auto Shut Down:** Off/1 Min/3 Min/5 Min

Default setting is 1 Min.

Auto Shut Down helps to power off camera after a period of inactivity to save battery life.

- **White Balance:** Auto/Daylight/Cloudy/Tungsten/Fluorescent

Default setting is Auto.

White Balance lets you adjust the color temperature of videos and photos to optimize for cool or warm lighting conditions.

- **Distortion Calibration:** Off/On

Default setting is Off.

Turn on Distortion Calibration to correct image distortion.

- **Date Stamp:** Off, Date, Date/Time

Default setting is Date/Time.

- **Format microSD Card:** Cancel/Confirm

Default setting is Cancel.

To keep your microSD card in good condition, reformat it on a regular basis.

Note: Reformatting erases all of your content, so be sure to offload your photos and videos first.

- **Reset To Factory:** Cancel/Confirm

Default setting is Cancel.

This option resets the device to the original factory settings.

- **Remaining Battery**

You can check how much battery is left in your device.

- **Card Capacity**

You can check the card capacity and remaining space of your microSD card.

- **Version**

You can check the version number.

ACCESSORIES INTRODUCTION



Easy Clip



Magnet Board: The magnet board should be worn underneath your shirt.



Tips: It can only rotate 90° clockwise. Please do NOT rotate it too hard to prevent the pivot stand from falling off.

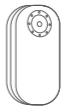

Carry-on Camera Case

Important

- Using the 1/4" mounting screw, the Pivot Stand can be connected to other compatible accessories.
- As thick clothing can weaken the magnetic force of the Board, please do not use the Keychain camera with thick clothing. Always test the Keychain camera's stability before shooting.
- People who wear cardiac pacemakers must not wear Magnet Board.
- When using the Pivot Stand and Sticky Base, please attach them to dry, clean and flat surfaces. Avoid attaching them to surfaces with strong vibration.
- If the Sticky Base or Pivot Stand has lost stickiness, clean it with water and dry for re-use. After use, re-apply their original covers to maintain stickiness. Avoid placing the Sticky Base or Pivot Stand in high- or low-temperature environments.

UPDATING YOUR CAMERA'S SOFTWARE

To get the latest features and best performance from your Keychain camera, be sure to keep updating your camera's software. When connected to the "AKASO GO" app, you are automatically notified if an update is available.

Connect your camera to your smartphone/tablet. If an update is available, the app provides instructions for installing it.

PRO TIP: To see your current software version, connect your Keychain camera to the "AKASO GO" app. Go to "Settings" to check the version number.

Q&A

Q: I want to share videos with my friends or to social media. How long does it take to download a video to my smartphone?

A: It depends on how many clips you have and how long they are. For a single 30 second clip (4K/30fps) it will finish downloading in about 35 seconds or so.

Q: Can my camera shoot 360 degree videos?

A: No, but it can shoot roughly 124 degree videos.

Q: What's the battery life of my camera? What's the longest video I can shoot before the battery needs recharging?

A: The built-in battery is 500 mAh. The longest single video recorded was more than 60 mins according to our laboratory tests.

Q: How come my camera will not turn on?

A: Charge your camera for at least 30 mins. If you still cannot power on your device, please hold the reset key for 3 seconds to reset your camera.

CONTACT US

For any inquiries with AKASO products, please feel free to contact us, we will respond within 24 hours.

E-mail: cs@akasotech.com

Tel: (888) 466-9222 (US) Mon-Fri (except holiday) 9am-5pm (EST)

Official website: www.akasotech.com

The microSD, microSDHC, microSDXC and SD marks and logos are trademarks of SD-3D, LLC.