

Quick Start Guide

innovation+you

Register your product for further support at www.philips.com/support

SCN450
Home Projector
Screeneo S4
PHILIPS



6

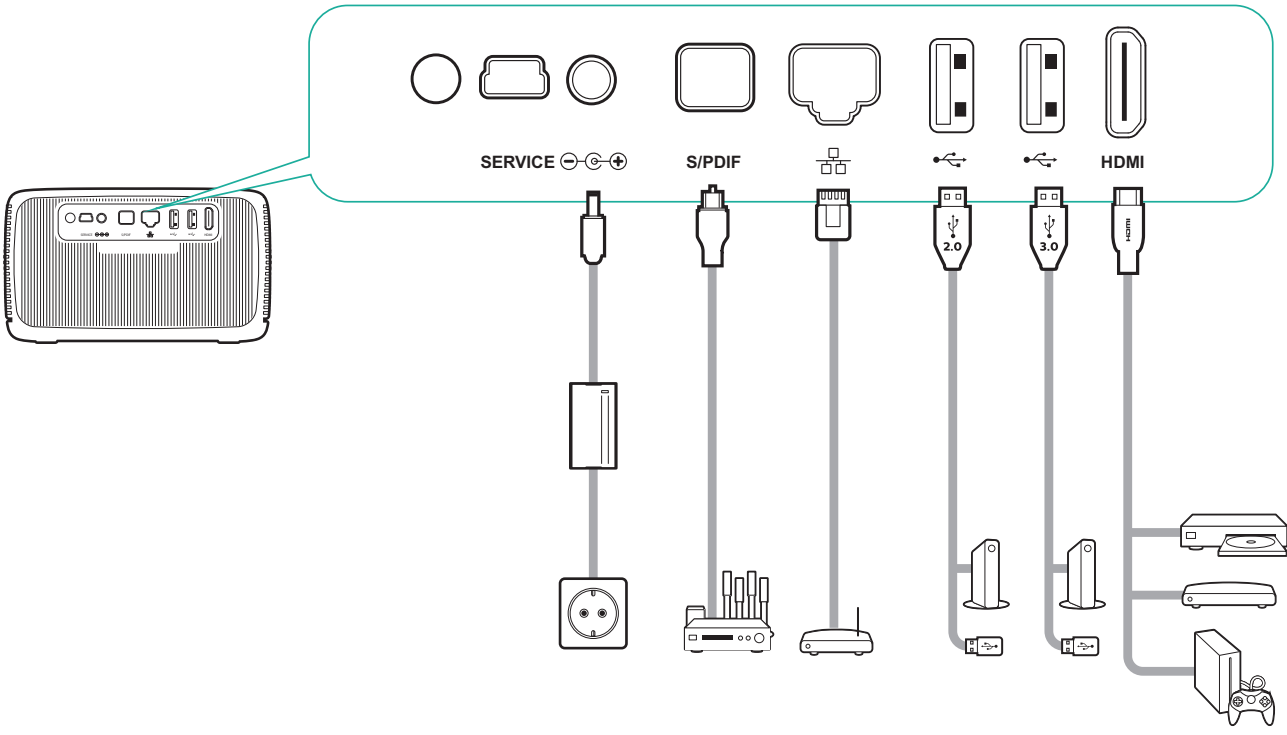

7 Home screen

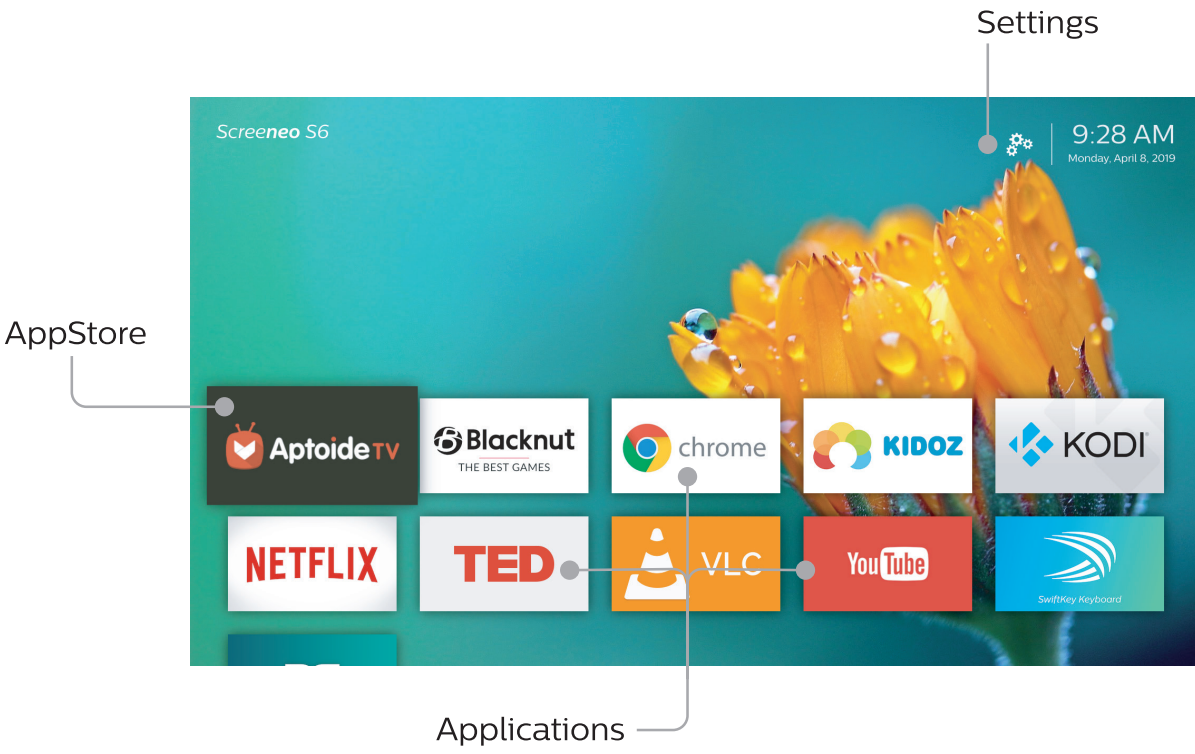

8 Cleaning

1

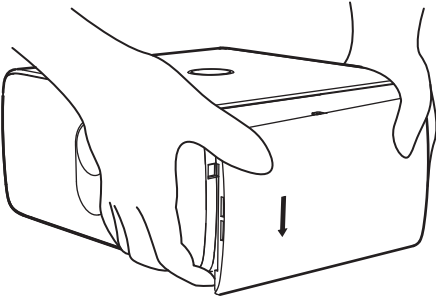

2

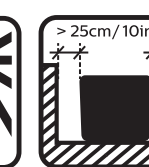
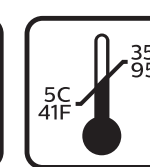
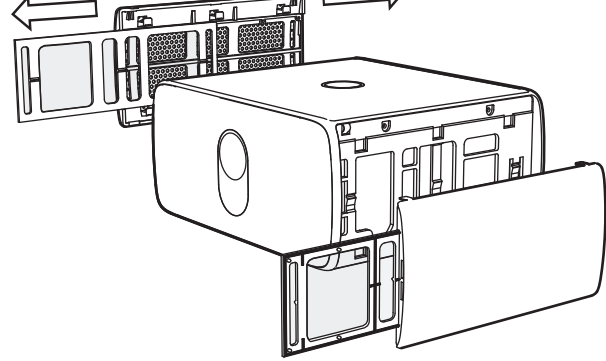

Screeneo Innovation SA
1131 - Tolochenaz - Switzerland
www.philips.com/welcome
philips.projector.eu@screeneo.com
Philips and the Philips Shield Emblem are registered trademarks of Koninklijke Philips N.V. used under license to the product with which this booklet was packaged.
2019 © Screeneo Innovation SA
All right reserved.

FCC ID: 2ASFT-SCN450
This device complies with part 15 of the FCC Rules. Operation is subject to the following two conditions: (1) This device may not cause harmful interference, and (2) this device must accept any interference received, including interference that may cause undesired operation.



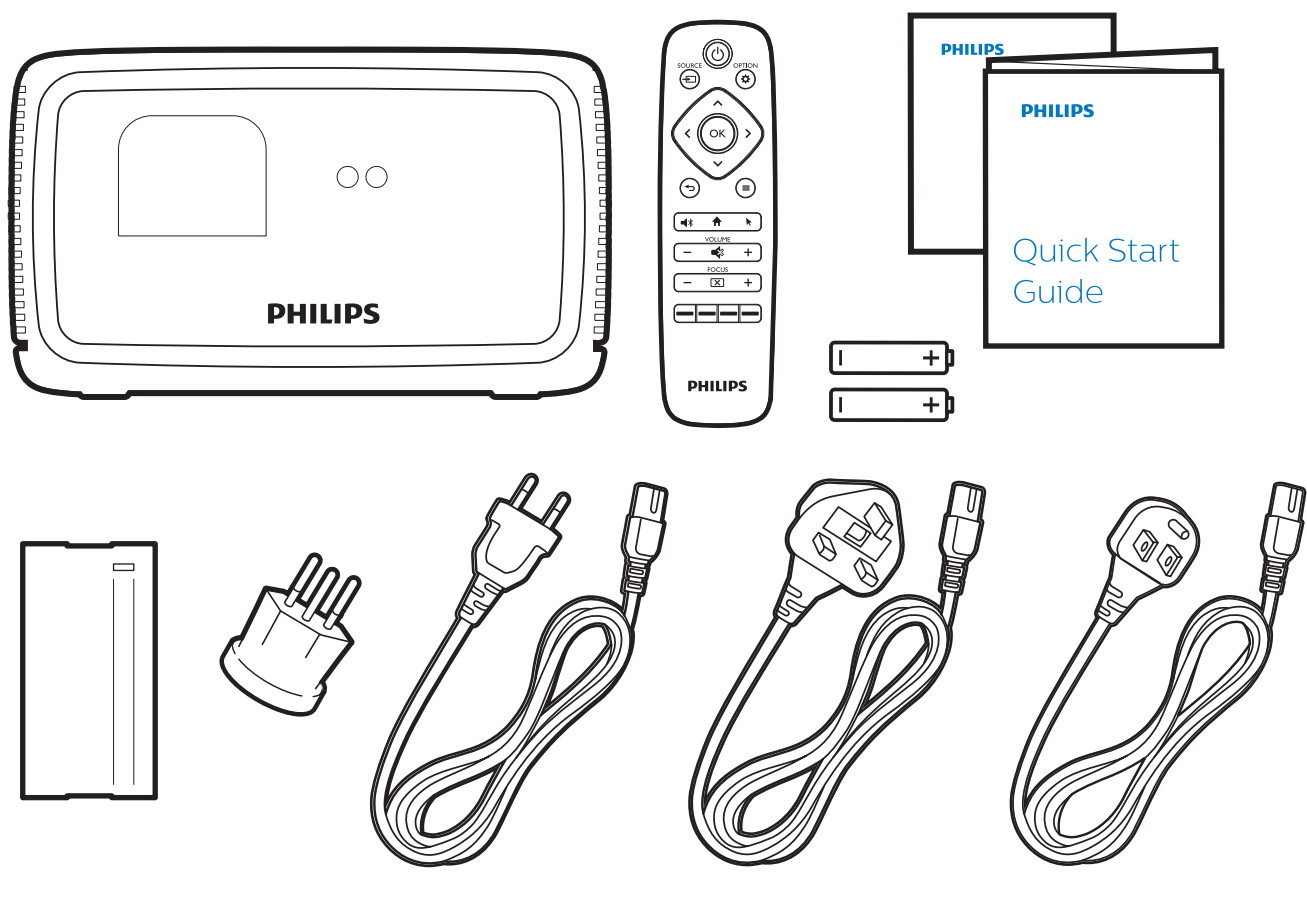

1 ▶ On/Off

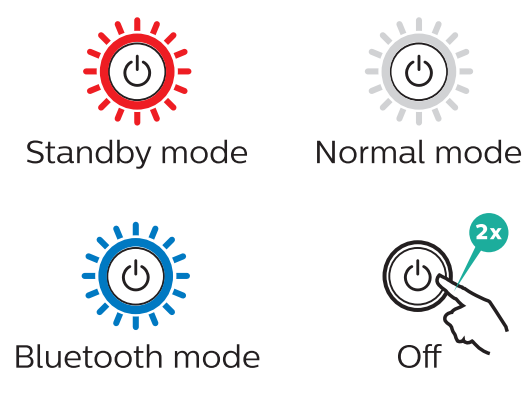
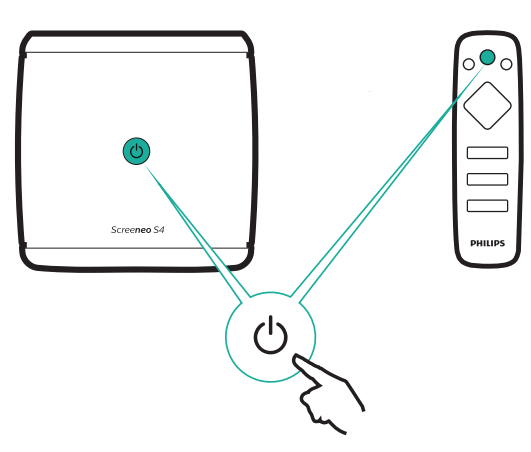
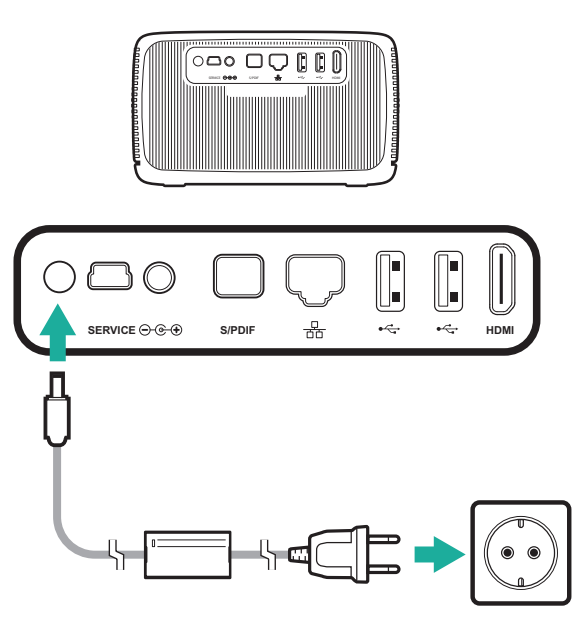

2 ▶ Keystone

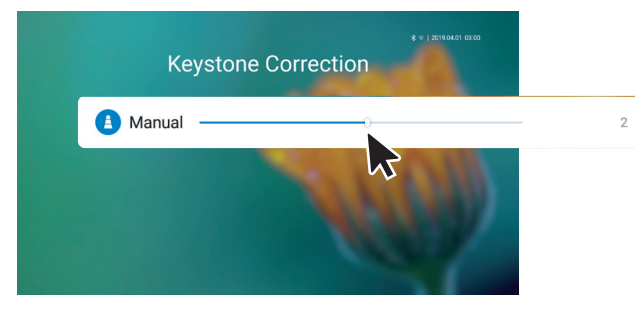
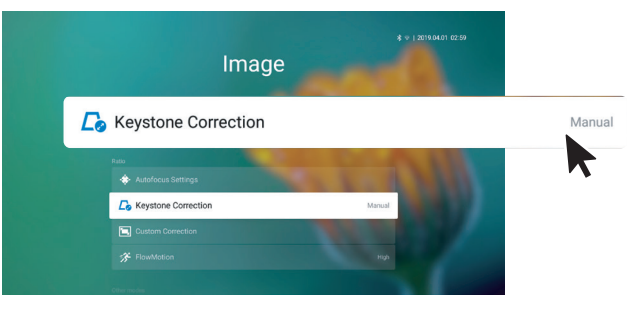
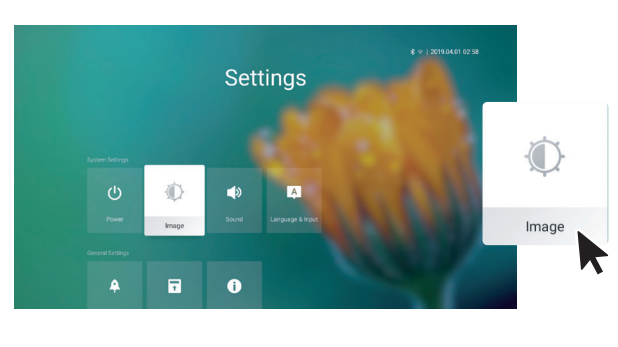
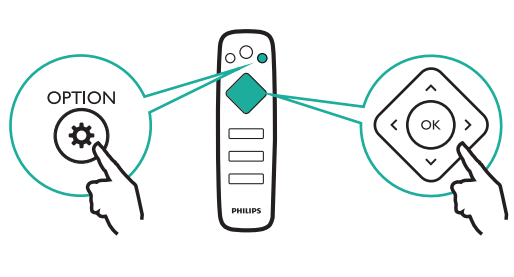

3 ▶ Focus

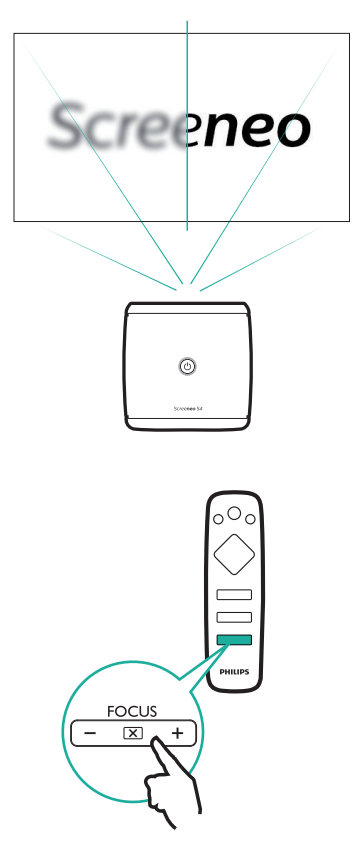

4 ▶ AirMote

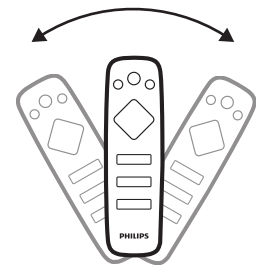
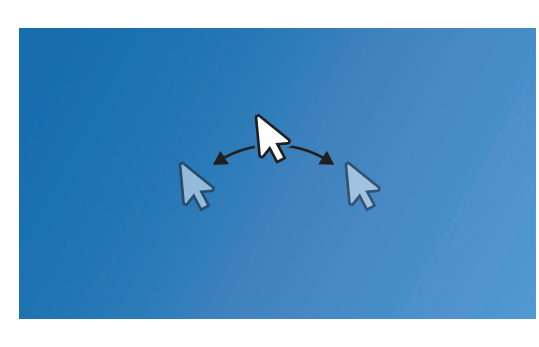
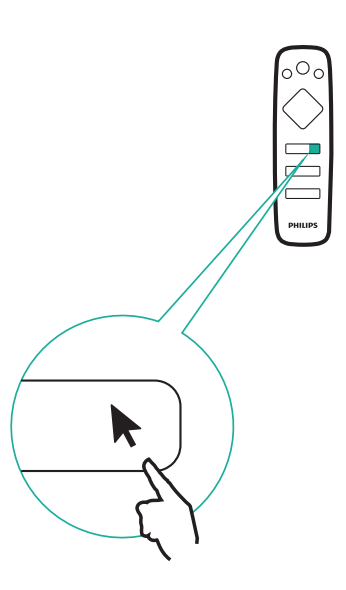

5 ▶ Bluetooth speaker

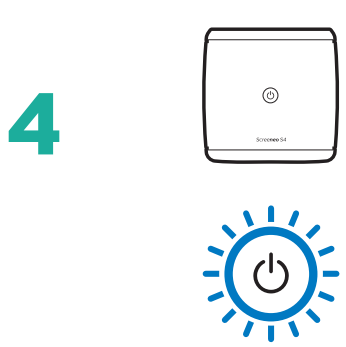
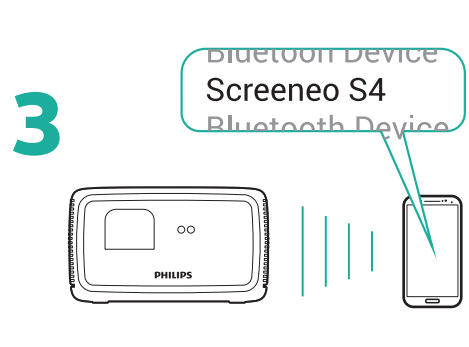
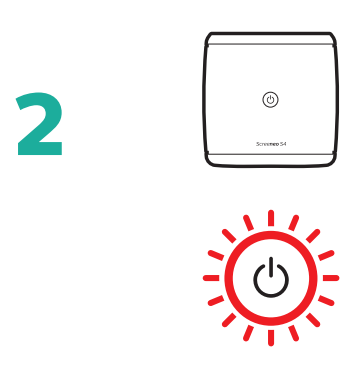
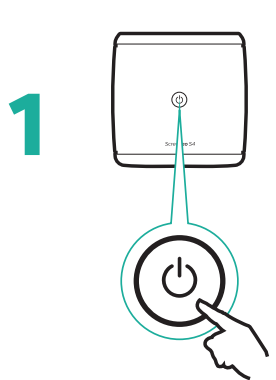

Frequency bands	Maximum output power
BT EDR(EIRP)	8.07 dBm
BT BLE(EIRP)	4.74 dBm
WIFI 2.4G(EIRP)	17.58 dBm
WIFI 5150-5250(EIRP)	17.82 dBm
WIFI 5725-5850(EIRP)	11.80 dBm

CE Statement

1. The product shall be connected to a USB interface of version USB2.0 or higher.
2. Adapter shall be installed near the equipment and shall be easily accessible.
3. The operating temperature of the EUT can't exceed 35°C and shouldn't be lower than 5°C.
4. The plug considered as disconnect device of adapter.
5. The UNII Band 5150-5250MHz indoor use only.
6. The device complies with RF specifications when the device used at 20cm from your body



Hereby, Screeneo Innovation SA declares that this product is in compliance with essential requirements and other relevant provisions of Directive 2014/53/EU.



FCC Statement

15.19 Labeling requirements.

This device complies with part 15 of the FCC Rules. Operation is subject to the following two conditions: (1) This device may not cause harmful interference, and(2) this device must accept any interference received, including interference that may cause undesired operation.

15.21 Information to user.

Any changes or modifications not expressly approved by the party responsible for compliance could void the user's authority to operate the equipment.

15.105 Information to user.

This equipment has been tested and found to comply with the limits for a Class B digital device, pursuant to Part 15 of the FCC Rules. These limits are designed to provide reasonable protection against harmful interference in a residential installation. This equipment generates uses and can radiate radio frequency energy and, if not installed and used in accordance with the instructions, may cause harmful interference to radio communications. However, there is no guarantee that interference will not occur in a particular installation. If this equipment does cause harmful interference to radio or television reception, which can be determined by turning the equipment off and on, the user is encouraged to try to correct the interference by one or more of the following measures:

- Reorient or relocate the receiving antenna.
- Increase the separation between the equipment and receiver.
- Connect the equipment into an outlet on a circuit different from that to which the receiver is connected.
- Consult the dealer or an experienced radio/TV technician for help.

During operation, the separation distance between user and the antenna shall be at least 20cm, this separation distance will ensure that there is sufficient distance from a properly installed externally-mounted antenna to satisfy the RF exposure requirements.