

24/7 Customer Service

We provide 24/7 customer support in English, Chinese (Mandarin and Cantonese), and Korean. Our customer service professionals will assist you with your service request.



We are available 24/7.

For United States and Canada, 1-877-482-5503
For Korean Customer Service, 1-800-875-8318



We are also available on WeChat.

Our customer service is also available on WeChat!
Search iTalkBB on WeChat, and chat with us!

For more information, please visit www.iTalkBB.com.

iTalkBB

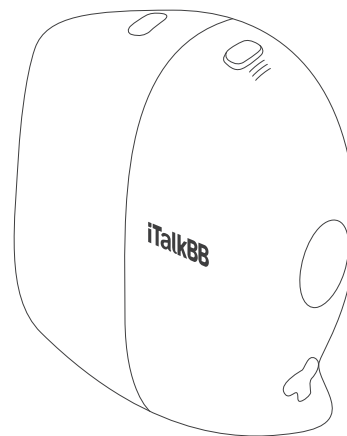

QUICK START GUIDE

What's in the box

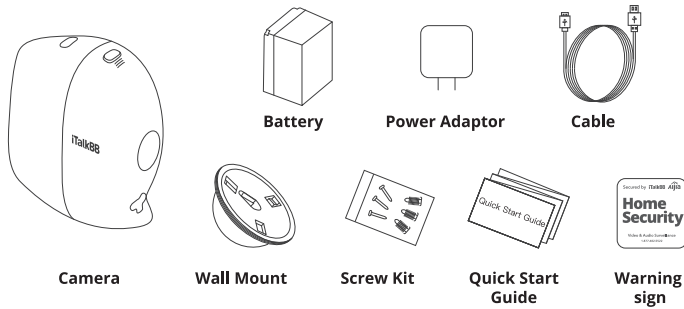

Battery

When using the camera for the first time, be sure to fully charge the battery.

How to charge battery :

1. Insert the battery into the camera.
2. Connect the camera to a power outlet using the power adaptor (5V 1A).
3. It usually takes about 5-6 hours to fully charge the battery.

➔ Note: The app will notify you when it detects a low battery level.

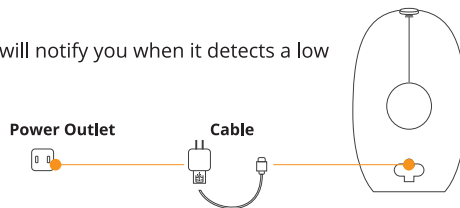

Basics of camera

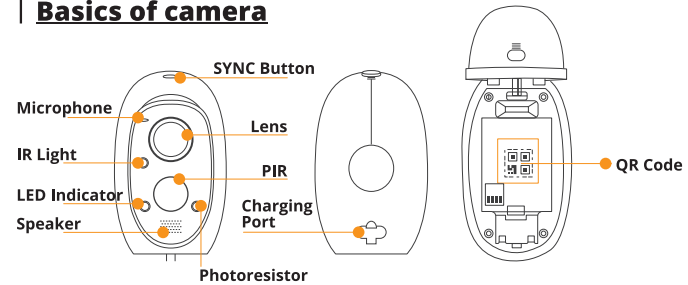

Name	Description
SYNC Button	Press and hold for 5 seconds to start Wi-Fi configuration.
PIR	With the PIR (Passive Infrared), the device can detect a human body to determine when there is a possible break-in and begins to record footage.
LED Indicator	<ul style="list-style-type: none"> • Steady Red: The camera is starting up. • Steady Blue: The video is being viewed in the app. • Slow-Blinking Blue: The camera is working. • Fast-Blinking Blue: The camera is connecting to the internet. • Slow-Blinking Red: Network error or the camera is being charged. • Fast-Blinking Red: Camera error or the battery is low.
Photo-resistor	Detects light conditions and switches the Day/Night recording mode.
IR Light	Improves the night vision.
Charging Port	For charging the battery.
QR Code	Scan the QR code either on the battery or on the package to connect the camera to the app.

Set up your camera

Step 1: Power on

1. Unlock the battery compartment by pressing and holding the latch.
2. Align the battery contacts and insert the battery.
3. Close the battery door and the camera will be turned on.

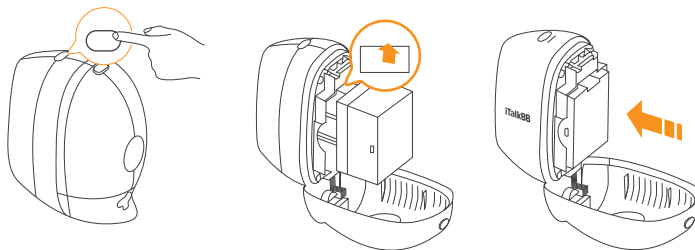

➔ Note: Please fully charge the battery before using it.

Step 2: Get the app

Download the app and create a user account:

1. Search for iTalkBB Aljia in the Apple app store or Google Play.
2. Follow the onscreen instructions and set up an Aljia account.

To add a new iTalkBB Aljia camera:

1. Press and hold the SYNC button for 5 seconds, until the LED indicator starts to blink blue.

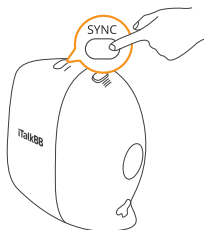

2. Log into the app, tap "+", and follow the onscreen instructions.

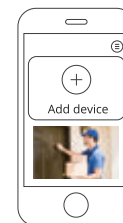

Install your camera outdoor

Step 1: Place your camera in a location with a clear, unblocked field of view.

Your camera provides a 111° viewing angle, so place the camera to cover a desired area.

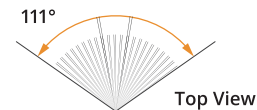

The best area for motion detection is 5 feet to 25 feet (1.5 to 7.5 meters) from the camera.

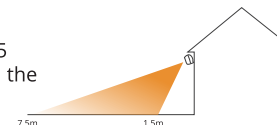

Step 2: Secure the magnetic mount with screws.

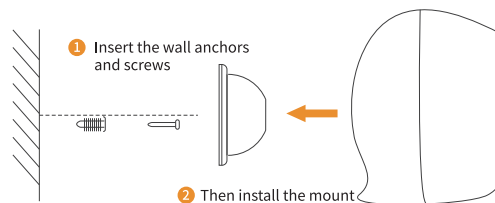

Step 3: Attach the camera to the magnetic mount.

- ➔ Note: The iTalkBB Aljia Wireless Outdoor Security Camera is designed for outdoor surveillance only.

简体

设备及配件

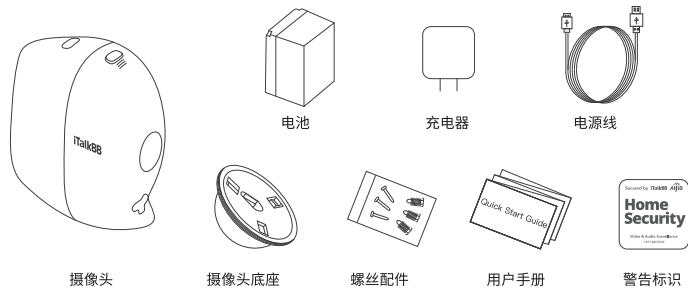

电 池

在安装摄像头之前，请确保电池已充满。

如何充电

1. 将电池装入摄像头。
2. 将电源线插入摄像头的接口，然后连接电源。
3. 充电时间大约在5-6个小时左右。具体充电时间将视电池剩余电量而决定。

→ 温馨提示

当电量即将耗尽时，手机app将会通知您及时充电。



基本配置

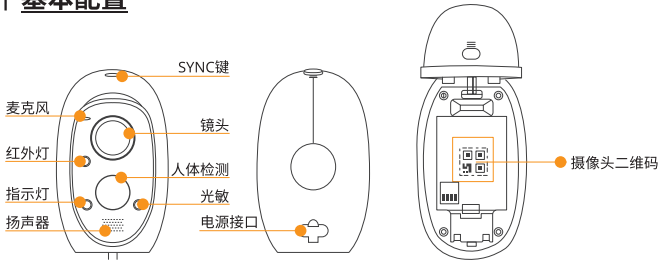

名称	描述
SYNC键	长按5秒开始摄像头与Wi-Fi网络配置
人体检测	摄像头内的红外线探测器可以探测到人体移动，并开始监测和录像
指示灯	<div><div><ul style="list-style-type: none">• 红色常亮：启动中• 蓝色慢闪：正常工作• 蓝色快闪：配网模式</div><div><ul style="list-style-type: none">• 蓝色常亮：客户端正在访问摄像头• 红色慢闪：网络断开/正在充电• 红色快闪：故障/电量低</div></div>
光敏	通过探测周遭环境的光线条件来智能开启白天/夜晚模式
红外灯	辅助夜间录像光线
电源接口	用于电池充电
摄像头二维码	用app扫描电池或包装盒上的二维码，连接摄像头与账户

摄像头设置

步骤1: 安装电池

1. 按住按钮打开电池盖。
2. 电池朝上，装进摄像头。
3. 合上后盖后，摄像头将自动启动。

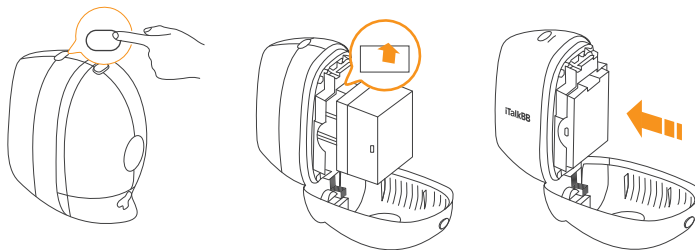

→ 温馨提示

使用摄像头前，请确保电池已充满电。

步骤2: 使用iTalkBB爱家App

下载app和注册账户：

1. 在苹果和谷歌应用商店搜索iTalkBB爱家，下载app并安装。
2. 安装后，请根据app内提示完成用户注册。

添加摄像头到iTalkBB爱家App

1. 首先，长按SYNC键5秒，等到指示灯蓝光快闪时，摄像头进入到联网状态。

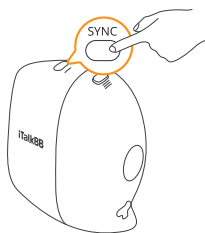

2. 然后登录app，选择添加设备，根据界面提示将摄像头添加到iTalkBB爱家app中。



摄像头户外安装

步骤1: 在房屋外选择干净、平滑的墙壁。

摄像头的监控范围可达111°；请根据监控需求，选择适当的摄像头安装位置。

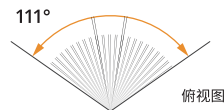

距离摄像头1.5到7.5米之间为最佳监控区域。

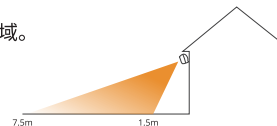

步骤2: 安装螺丝和配件。

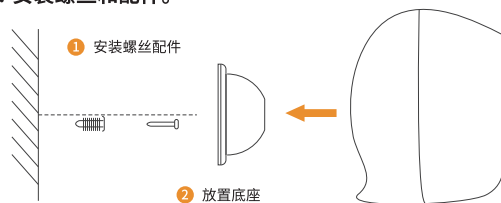

步骤3: 把摄像头放在磁铁底座上。

→ 温馨提示：iTalkBB爱家无线户外安防摄像头只适用于户外监控。

設備及配件

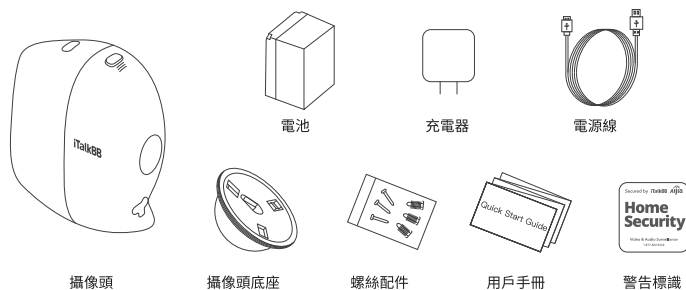

電池

在安裝攝像頭之前，請確保電池已充滿。

如何充電

1. 將電池裝入攝像頭。
2. 將電源線插入攝像頭的接口，然後連接電源。
3. 充電時間大約在5-6個小時左右。具體充電時間將視電池剩餘電量而決定。

溫馨提示

當電量即將耗盡時，手機app將會通知您及時充電。



基本配置

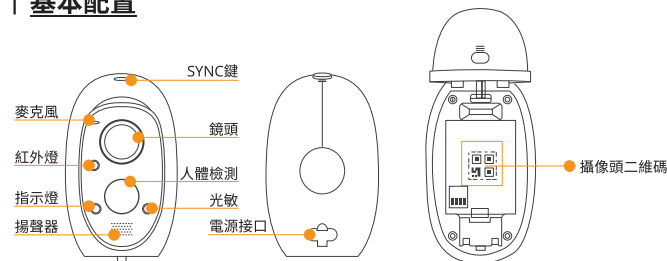

名称	描述
SYNC鍵	長按5秒開始攝像頭與Wi-Fi網絡配置
人體檢測	攝像頭內的紅外線探測器可以探測到人體移動，並開始監測和錄像
指示燈	<ul style="list-style-type: none"> 紅色常亮：啟動中 藍色常亮：客戶端正在訪問攝像頭 藍色慢閃：正常工作 紅色慢閃：網絡斷開/正在充電 藍色快閃：配網模式 紅色快閃：故障/電量低
光敏	通過探測周遭環境的光線條件來智能開啟白天/夜晚模式
紅外燈	輔助夜間錄像光線
電源接口	用於電池充電
攝像頭二維碼	用app掃描電池或包裝盒上的二維碼，連接攝像頭與賬戶

攝像頭設置

步驟1: 安裝電池

1. 按住按鈕打開電池蓋。
2. 電池朝上，裝進攝像頭。
3. 合上後蓋後，攝像頭將自動啟動。

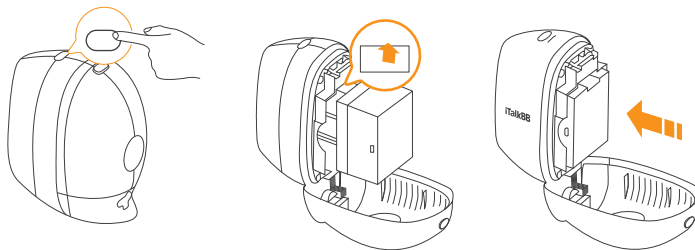

→ 溫馨提示

使用攝像頭前，請確保電池已充滿電。

步驟2: 使用 iTalkBB 愛家App

下載app和註冊賬戶：

1. 在蘋果和谷歌應用商店搜索iTalkBB愛家，下載app並安裝。
2. 安裝後，請根據app內提示完成用戶註冊。

添加攝像頭到iTalkBB愛家App

1. 首先，長按SYNC鍵5秒，等到指示燈藍光快閃時，攝像頭進入到聯網狀態。

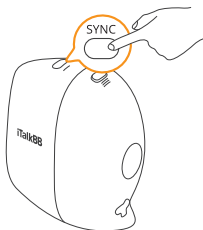

2. 然後登錄app，選擇添加設備，根據界面提示將攝像頭添加到iTalkBB愛家app中。



攝像頭戶外安裝

步驟1: 在房屋外選擇乾淨、平滑的牆壁。
攝像頭監控視角可達111°；請根據監控需求，選擇適當的攝像頭安裝位置。

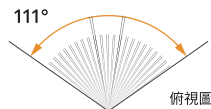

距離攝像頭1.5到7.5米之間為最佳監控區域。

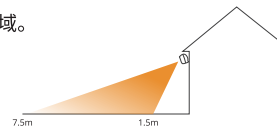

步驟2: 安裝螺絲和配件。

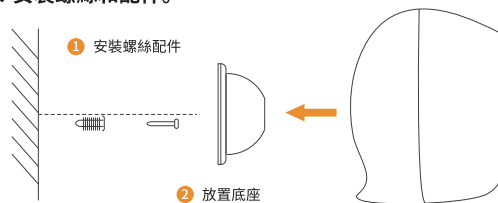

步驟3: 把攝像頭放在磁鐵底座上。

→ **溫馨提示:** iTalkBB愛家無線戶外安防攝像頭只適用於戶外監控。

전체 제품

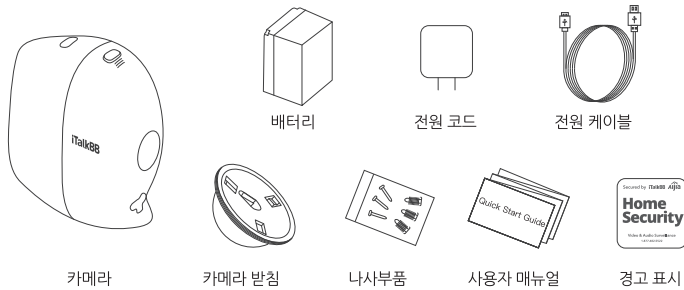

배터리

카메라를 설치하기 전에 배터리를 완충해 주십시오.

충전방법

1. 배터리를 카메라에 장착 해 주십시오.
2. 전원케이블을 카메라와 연결 후, 전원을 연결해 주십시오.
3. 충전시간은 약 5-6시간 정도 소요되며, 실제 충전 시간은 배터리의 잔여량에 따라 결정 됩니다.

주의사항

배터리가 거의 소진될 경우, 휴대폰 App을 통해 충전 알림 메시지가 전송 됩니다.



기능소개

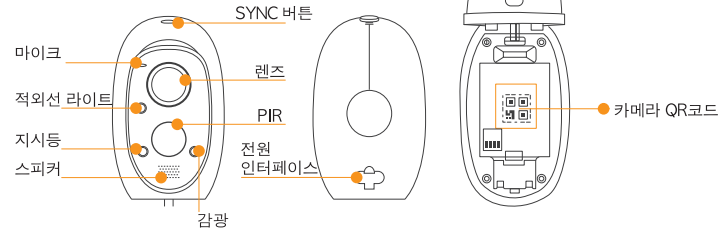

이름

SYNC 버튼

상세정보

5초동안 버튼을 눌러 카메라와 app 연결

PIR

카메라 내의 적외선 센서로 인체의 이동을 감지하여 감시 및 촬영

지시등

- 빨간 라이트 장시간 켜짐 : 가동중
- 파란 라이트 장시간 켜짐 : 휴대폰 app을 통해 카메라 확인중
- 파란 라이트 천천히 깜빡임 : 정상 작동중
- 빨간 라이트 천천히 깜빡임 : 인터넷 끊김/충전중
- 파란 라이트 빠르게 깜빡임 : 인터넷 연결중
- 빨간 라이트 빠르게 깜빡임 : 고장/배터리 부족

광민

주변환경의 빛 조건에 따라 자동으로 낮/밤 모드를 교체 가능합니다.

적외선 라이트

보조촬영라이트

전원

인터페이스

배터리충전시 연결

카메라 QR 코드

QR코드를 스캔하여카메라와 app 어카운트를 연결해 주십시오.

카메라 설정

Step 1: 배터리 장착

1. 버튼을 눌러 배터리 케이스를 오픈해 주십시오.
2. 배터리 방향을 위로 하여 카메라에 장착해 주십시오.
3. 뒷면 케이스를 닫고 전원 버튼을 눌러 주십시오.

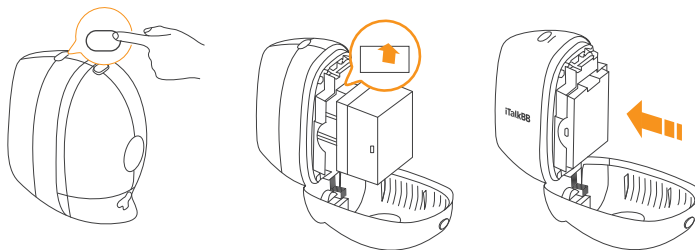

→ 주의사항

카메라를 사용하기 전, 배터리의 완충 상태 여부를 먼저 확인해 주십시오.

Step 2: iTalkBB Aljia App 사용

어카운트 가입

1. IOS 또는 Android 스토어에서 iTalkBB Aljia App을 다운로드 및 설치해 주십시오.
2. 설치완료 후, 새로운 어카운트를 등록해 주십시오.

iTalkBB Aljia App 에 카메라 추가:

1. 우선, SYNC버튼을 5초동안 누르고 지시등이 파란 라이트로 빠르게 깜빡일 때까지 기다리면 카메라에 인터넷이 연결 됩니다.

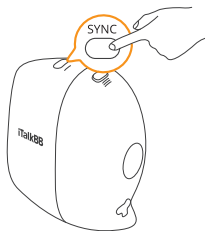

2. 다음, app에 로그인 하시어, 장비추가를 선택 하시고 절차에 따라 해당 장비를 iTalkBB Aljia app 내에 추가해 주십시오.



카메라 설치

Step 1: 실외(집밖)에서 깨끗하고 평평한 벽면을 선택해 주십시오.

카메라의 모션센서 범위는 최대 111°이며, 필요에 따라 적절한 카메라 설치 위치를 선택 하십시오.

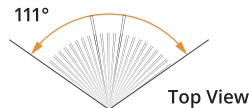

본 카메라는 좌우측으로의 움직임에 특히 민감하며, 모션센서의 최적구역은 1.5 ~ 7.5 미터입니다.

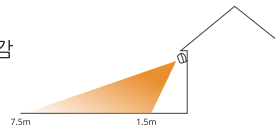

Step 2: 설치나사 및 부품

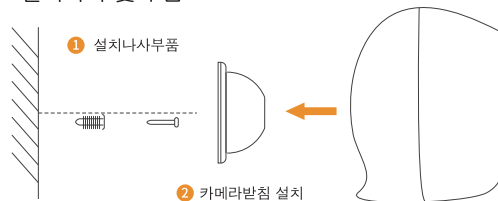

Step 3: 카메라를 자석이 달린 받침에 설치해 주십시오.

→ 주의사항: iTalkBB Aljia 보안시스템 카메라는 실외 모니터링 용도로만 사용해 주시기 바랍니다.

Get your iTalkBB Aljia app for the best experience!

Download the iTalkBB Aljia app for your smartphone by searching for iTalkBB Aljia in the Apple app store or Google Play.



➔ Note: If you already use the iTalkBB Aljia app, please make sure that you are using the latest version. To find out if an update is available, go to the app store and search for iTalkBB Aljia.

This device complies with Part 15 of the FCC Rules. Operation is subject to the following two conditions:

- (1) This device may not cause harmful interference, and
- (2) This device must accept any interference received, including interference that may cause undesired operation.

Note: This product has been tested and found to comply with the limits for a Class B digital device, pursuant to Part 15 of the FCC Rules. These limits are designed to provide reasonable protection against harmful interference in a residential installation. This product generates, uses, and can radiate radio frequency energy and, if not installed and used in accordance with the instructions, may cause harmful interference to radio communications. However, there is no guarantee that interference will not occur in a particular installation. If this product does cause harmful interference to radio or television reception, which can be determined by turning the equipment off and on, the user is encouraged to try to correct the interference by one or more of the following measures:

- Reorient or relocate the receiving antenna.
 - Increase the separation between the equipment and receiver.
 - Connect the equipment into an outlet on a circuit different from that to which the receiver is connected.
 - Consult the dealer or an experienced radio/TV technician for help.
- Please take attention that changes or modification not expressly approved by the party responsible for compliance could void the user's authority to operate the equipment. This equipment complies with FCC radiation exposure limits set forth for an uncontrolled environment. This equipment should be installed and operated with minimum distance 20cm between the radiator & your body.