

D32 Instruction

Contains three languages: English, Japanese, German

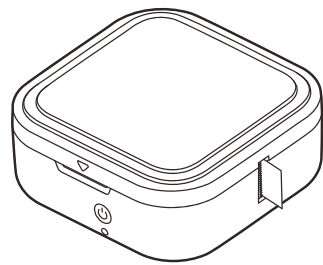

- EN Please read the instructional manual carefully before using the product.
- JP 本製品使用前は必ず本説明書をお読みください。
- DE Lesen Sie sich diese Bedienungsanleitung vor dem Gebrauch sorgfältig durch.



- EN Multilingual Comprehensive Instruction Manual
- JP 多言語詳細版説明書
- DE Detaillierte Bedienungsanleitung in verschiedenen Sprachen

English

01. Packing List



NOTE The number of paper rolls in the list is subject to the actual shipment.

02. Product Specifications

Product name	Smart Mini Label Maker
Product model	D32
Printing technology	Thermal printing
Consumable width	12-15mm
Effective printing width	12 mm
Supported consumables	Pre-cut paper, black mark paper, continuous paper
Printing density	Light, standard, dark
Printing resolution	203 dpi
Print head service life	50 KM
Communication interface	Bluetooth
Product size	82*82*32.5 mm (3.23*3.23*1.28 inch)
Power input	5V = 2A
Power supply method	Lithium Battery
Supported operating system	Android/iOS

03. Parts Description Appearance Introduction

01 Label Maker display

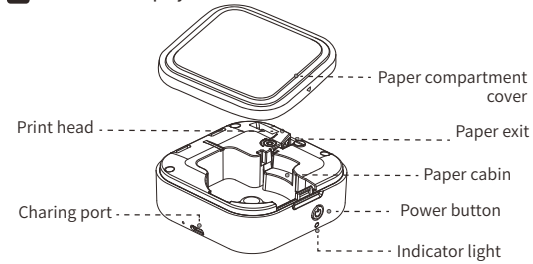

02 Label paper display

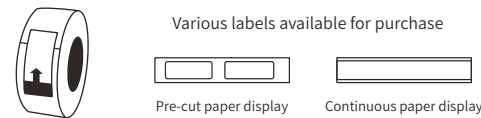

03. Parts Description Power Button and Indicator Light

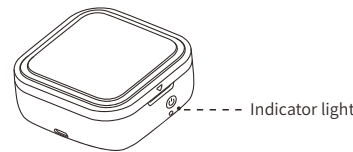

01 Button Instructions

Button Type	Operation	Function
Power Button	Long press for 3s	Power on/off
	Press once when printer is on	Calibrate label position
	Double press when printer is on	Print a self-test page

02 Indicator Light Instructions

Status	Meaning	Advised Action
● Solid Green Light	Device functioning properly and fully charged	/
● Fast Flashing Green Light	Charging when printer is off	/
● Slow Flashing Green Light	Charging when printer is on	/
● Solid Red Light	Out of paper	Properly insert label paper into Paper Outlet
	Printer overheat	Pause printing for 5 min for printer to cool down
● Slow Flashing Red Light	Low battery	Charge for 1 hour (or at least 20 min if in urgent need)
● Fast Flashing Red Light	Battery running low	Charge for 2-3 hours

04. Guidelines for Use

01 Open the paper compartment cover of the machine.

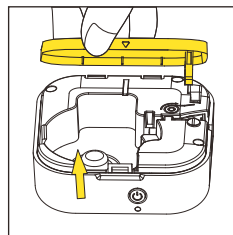

02 Take out the label paper, tear off the anti-loosening sticker.

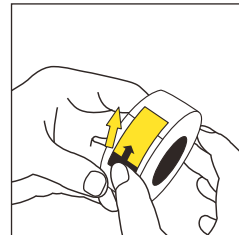

03 Depending on the direction of the marking, place the label paper into the paper compartment.

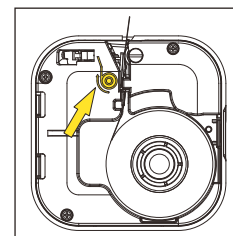

04 Pull out the label paper out of the Paper exit by 5 mm in length for normal printing.

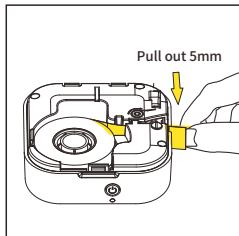

05. Boot Guide

01 After turning on the power, click the power button to identify the label position.

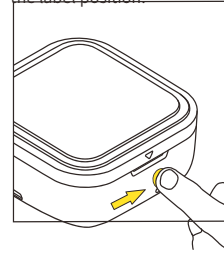

02 Come out a piece of paper, positioning completed.

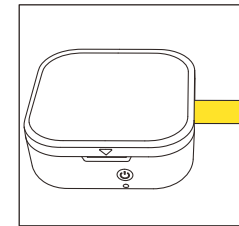

NOTE When installing or replacing the label roll for the first time, the label position identification is required. (Step 01)
If the label position identification is not carried out (Step 01), failures may occur such as first printing missing, not centered, etc.

06. Downloading the App

Method 1: Search for the "Print Master" app on App Store® or Google Play™ for download and installation.



Method 2: Scan the QR code to download the app.



① As the Safari browser on Apple devices does not support direct QR code scanning, please use your device's built-in QR code scanner instead.

07. Printer Connection

01 Turn on GPS. (Android mobile phone only.)

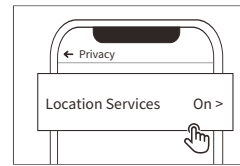

03 Click to search for the device.

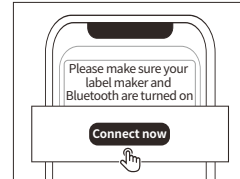

02 Open the App.

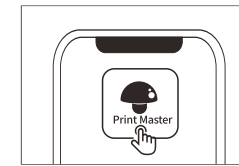

04 Connect immediately.

NOTE This product needs to be connected to the printer in the App after the Bluetooth is turned on.
According to the official requirements of Google, Android mobile phones need to open the GPS permission before they can use the Bluetooth function.
When connecting the App, please make sure that the printer is turned on and the Bluetooth of the mobile phone is turned on.

08. Confirm the Label Size

Method I: Check the label paper packaging. Please refer to the actual size used.

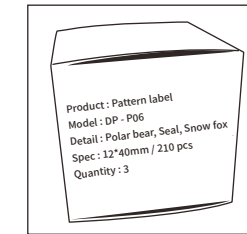

Method II: Check the label paper pads. The old and new versions of label paper are being replaced, please refer to the actual shipment.



09. Detailed Online Guide

Method 1: Visit downloadapp.qu-in.top/Ph to access the Detailed Online Guide, video tutorials, and answers to FAQs.



Method 2: Scan the QR code to access the Detailed Online Guide, video tutorials, and answers to FAQs.

① As the Safari browser on Apple devices does not support QR code scanning, please use your device's built-in QR code scanner instead.

10. FCC WARNING

FCC Statement

1. This device complies with Part 15 of the FCC Rules. Operation is subject to the following two conditions:

- (1) This device may not cause harmful interference, and
- (2) This device must accept any interference received, including interference that may cause undesired operation.

2. Any Changes or modifications not expressly approved by the party responsible for compliance could void the user's authority to operate the equipment.
NOTE: This equipment has been tested and found to comply with the limits for a Class B digital device, pursuant to Part 15 of the FCC Rules. These limits are designed to provide reasonable protection against harmful interference in a residential installation.

This equipment generates uses and can radiate radio frequency energy and, if not installed and used in accordance with the instructions, may cause harmful interference to radio communications.

However, there is no guarantee that interference will not occur in a particular installation. If this equipment does cause harmful interference to radio or television reception, which can be determined by turning the equipment off and on, the user is encouraged to try to correct the interference by one or more of the following measures:

- Reorient or relocate the receiving antenna.
- Increase the separation between the equipment and receiver.
- Connect the equipment into an outlet on a circuit different from that to which the receiver is connected.
- Consult the dealer or an experienced radio/TV technician for help.

FCC Radiation Exposure Statement

The device has been evaluated to meet general RF exposure requirement. The device can be used in portable exposure condition without restriction.

① Change or modifications not expressly approved by the manufacturer responsible for compliance could void the user's authority to operate the equipment.

11. ISED NOTICE (Canada)

IC Warning

This device contains licence-exempt transmitter(s)/receiver(s) that comply with Innovation, Science and Economic Development Canada's licence-exempt RSS(s). Operation is subject to the following two conditions:

- (1) This device may not cause interference.
- (2) This device must accept any interference, including interference that may cause undesired operation of the device.

L' émetteur/ récepteur exempt de licence contenu dans le présent appareil est conforme aux CNR d' Innovation, Sciences et Développement économique Canada applicables aux appareils radio exempts de licence. L' exploitation est autorisée aux deux conditions suivantes :

- 1) L' appareil ne doit pas produire de brouillage;
- 2) L' appareil doit accepter tout brouillage radioélectrique subi, même si le brouillage est susceptible d' en compromettre le fonctionnement.

IC RF Exposure Statement/ IC Déclaration d'exposition aux RF:

The device has been evaluated to meet general IC RF exposure requirement. The device can be used in portable exposure condition without restriction.

L'appareil a été évalué pour répondre aux exigences générales d'exposition aux RF d'IC. L'appareil peut être utilisé dans des conditions d'exposition portable sans restriction.

Maintenance Card / 保証書 / Garantiekarte

Replace/交換/Ersatz	Return/返品/Rückkehr
User Information/ お客様/ Nutzerinformation Name/お名前/Name/: _____ Gender/性別/Geschlecht: _____ Phone/電話番号/Tel: _____ Address/ご住所/Adresse: _____	
Product Information/ 製品情報/ Produktinformation Date of purchase/お買い上げ日/Kaufdatum: _____ Product order number/注文番号/Produktbestellnummer: _____ Product serial number/シリアル番号/Produkt ID: _____	
Reason for Return (Replace, Repair, Request Maintenance) / 返品、交換、また修理の請求/ Rückgabe-Grund (Ersatz, Reparatur, Anforderungsausfall) Fault description/理由/Gründe für die Rückgabe oder Ersetzung: _____	