

**HEART RATE MONITOR
CHEST STRAP**

USER MANUAL

Model: CL806

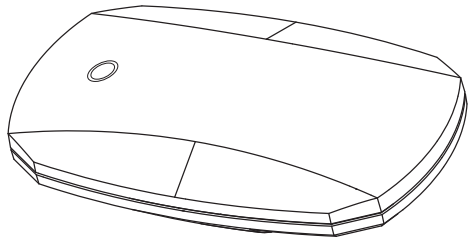

Bluetooth



ANT+

Thank you for purchasing this product as your sports fitness product of choice. The product is a sensor type heart rate monitor that will track your real-time heart rate and send heart rate data to the Smart phone.

IMPORTANT This product is for sport purposes only and it is not meant to replace any medical advice.

This manual contains important safety and care information, and provides step by step instructions for using this product. Read it thoroughly, and keep the manual in a safe place in case you need to refer to it later.

DEVICE OVERVIEW:

A. Heart rate Transmitter

a. Front View

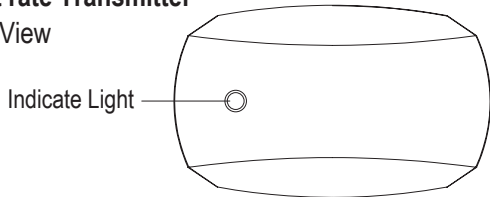

The device flashes green for 5 times when it is turned on,
The green lights turns on for 3 seconds when device turns off.

b. Back View

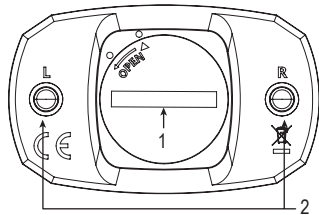

1. Battery Door

2. Left & Right wearing directions

B. Heat rate chest strap

3. Electrodes

4. Fastening buttons

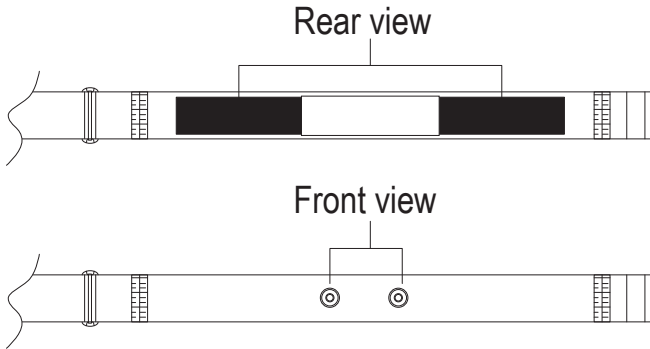

GETTING STARTED

A. Unpacking the product In this box, you will find:

- a. Heart rate transmitter
- b. Adjustable elastic strap
- c. CR2032 battery- already installed
- d. User manual

B. To wear chest strap

- a) Wet the conductive pads on the rear of the chest strap with a few drops of water, Saliva or conductive gel to ensure solid contact.
- b) Strap the heart rate chest belt across your chest. To ensure an accurate heart rate signal, adjust the strap until the belt fits snugly below your (chest) pectoral muscles.
- c) Attach the transmitter to the strap, marked 'L' towards left.

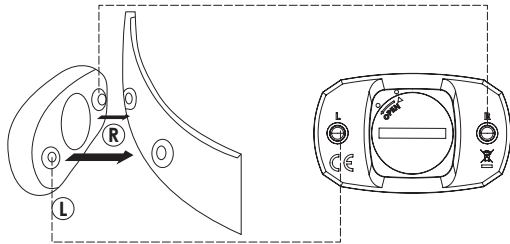
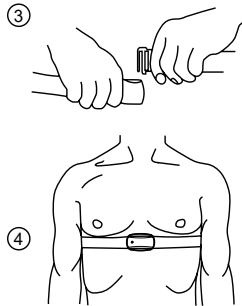
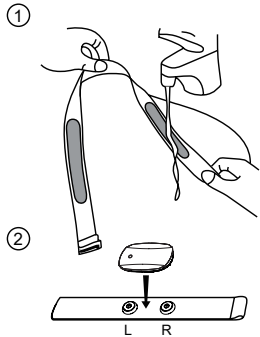

WARNING
Inaccurate heart rate data will be detected
if the device is worn in wrong directions.

C. APP PAIRING

a. Turn on BLUETHOOOTH



b. Download the APP

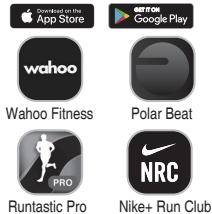

c. Activate the Sensor

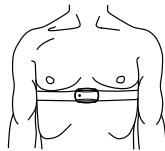

Wear the sensor properly

d. Pair Sensor

Open the APP to the sensor page

e. Start your workout

WARNING

- a. Cleaning of transmitter and strap in a washing machine or dryer is strongly prohibited.
- b. Before hand washing the device, detach the transmitter of Heart Rate Monitor where electrodes are located, This part is not washable.
- c. While washing the straps, make sure water is no higher than 30°C.
- d. Ironing, bleaching or heating is prohibited.

BATTERIES

The transmitter use CR2032 3V battery. The battery already installed. The battery typically last one year.

- A. Using a coin, twist the battery door counter clock wise until it clicks out of place.
- B. Remove the old battery and insert the new battery with the +side upwards.
- C. Replace the battery door by twisting it clockwise until it is firmly in place.

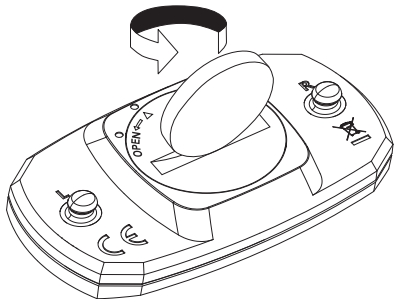

IMPORTANT

1. Non-rechargeable and rechargeable batteries must be disposed of properly. For this purpose, special containers are provided for battery disposal at communal collection centers.
2. Batteries are extremely dangerous when swallowed! Therefore, keep batteries and small articles away from children.
3. The batteries supplied must not be recharged, reactivated by any other means, dismantled, put into fire or short-circuited.

DATE TRANSMISSION

ANT+ & BLE Sports System is supported to achieve reliable data transmission by this HRM.

For ANT+ System:

A. Pairing

If the HRM is not paired with the ANT+ compatible receiver, it has to be activated and paired.

- Ensure that the HRM battery is not drained. Replace the battery if needed.
- Ensure there are no other ANT+ transmitting devices within 50 m range, other devices may affect pairing.

B. Ready to use

If your device is successfully paired, it's ready for use.

Compatible Apps:

Wahoo Fitness, Polar Beat, Zwift, Runtastic Pro, Nike+ Run Club

* All brand names and trademarks are properties of their respective owners.

Disclaimer

- The information contained in this manual just for reference. The product described above may be subject to alteration owing to the manufacturer's continuing research and development plans, without making an announcement in advance.
- We shall not bare any legal responsibility for any direct or indirect, accidental or special damages, losses and expenses arising from or in connection with this manual or the contained product.

CE and FCC statement

Hereby, We, declares that heart rate monitor, Chest, strap (CL806) is in compliance with the essential requirements and other relevant provisions of Directive RED 2014/53/EU. A copy of the signed and dated Declaration of Conformity is available.

This device complies with Part 15 of the FCC Rules. Operation is subject to the following two conditions:

(1) This device may not cause harmful interference, and (2) This device must accept any interference received, including interference that may cause undesired operation.

Version: V1.0

WARNING: Changes or modifications not expressly approved by the party responsible for compliance could void the user's authority to operate the equipment.

NOTE: This equipment has been tested and found to comply with the limits for a Class B digital device, pursuant to Part 15 of the FCC Rules. These limits are designed to provide reasonable protection against harmful interference in a residential installation.

This equipment generates, uses and can radiate radio frequency energy and, if not installed and used in accordance with the instructions, may cause harmful interference to radio communications. However, there is no guarantee that interference will not occur in a particular installation.

If this equipment does cause harmful interference to radio or television reception, which can be determined by turning the equipment off and on, the user is encouraged to try to correct the interference by one or more of the following measures:

- Reorient or relocate the receiving antenna.
- Increase the separation between the equipment and receiver.
- Connect the equipment into an outlet on a circuit different from that to which the receiver is connected.
- Consult the dealer or an experienced radio / TV technician for help.

The device has been evaluated to meet general RF exposure requirement. The device can be used in portable exposure condition without restriction.

FC **CE** **RoHS**  