

blu™ 6-Pack LCD Unit

SETUP GUIDE

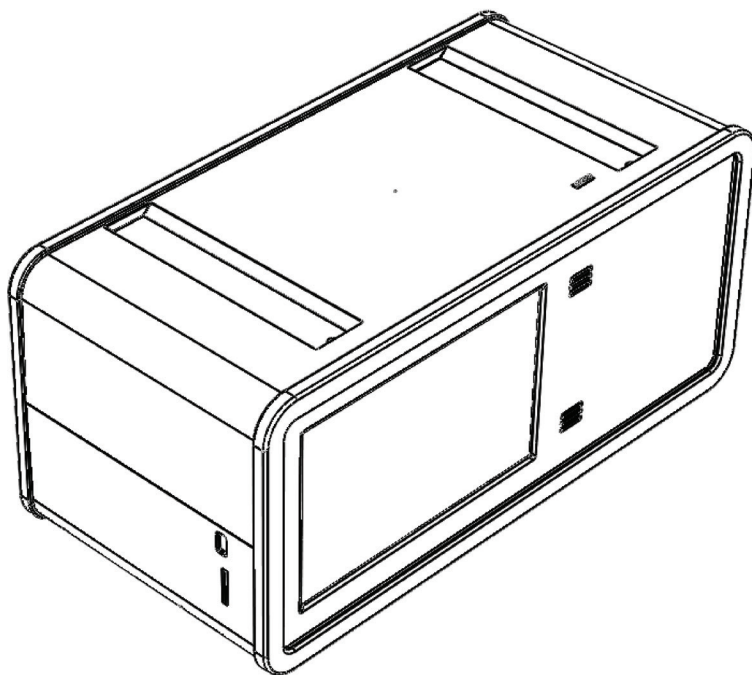

PLEASE NOTE: BEFORE PROCEEDING WITH THIS SETUP GUIDE, **WRITE DOWN THE ASSET #** OF THE UNIT AS YOU WILL NEED THIS WHEN CONFIGURING THE VAP (VIDEO ADVERTISING PLATFORM) APP.

THE ASSET # WILL BE LOCATED ON THE BOTTOM OF THE UNIT, PLEASE REFER TO THE VISUAL BELOW:

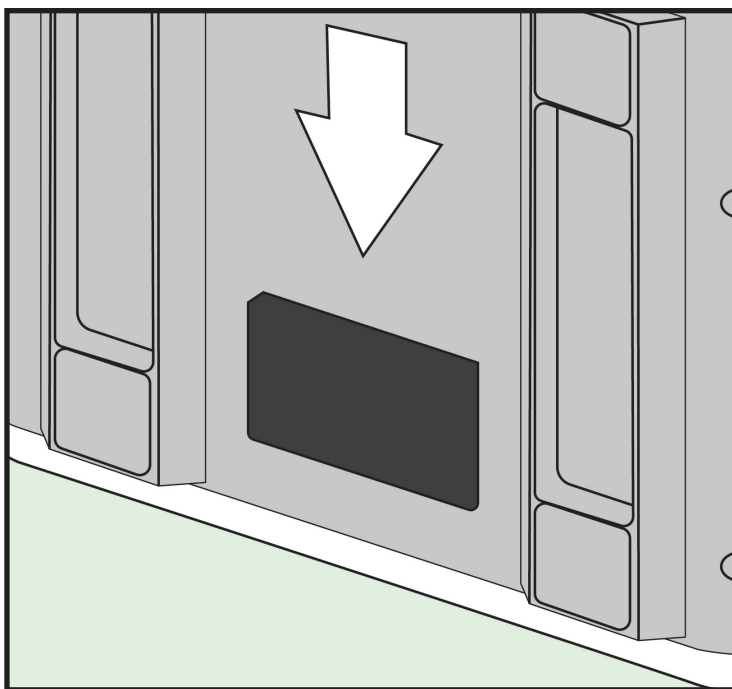

General Safety Information.....	4
Care and Maintenance.....	5
Certification.....	5
What’s Included	6
Components Overview.....	7
blu™ 3-Pack LCD Unit Setup Guide	8
Accessing the Touch Screen	8
Access Settings	9
Connecting to Wi-Fi	9
Date/Time Settings	10
Setting up the VAP (Video Advertising Platform)	11
Adjusting Brightness	12
Adjusting Volume	13
Inserting POS Advertising	14
Installing Pack Tray	15
Removing Dry Starter Kit Insert	16
Filling and Dispensing from Trays	17
Stacking Units	17
Applying Pin Covers	18
Troubleshooting.....	20
Damaged Goods	20
Screen/UI	20
If VAP app does not load	20
If Video does not load	21
Electronic Component Failure	21
blu™ Appendix	22

GENERAL SAFETY INFORMATION

FOR THE SAFE AND SUCCESSFUL OPERATION OF THIS PRODUCT, PLEASE READ AND FOLLOW THE INFORMATION CONTAINED IN THIS USER MANUAL BEFORE USE.



- Do not try to access internal components of any blu™ units as contents may cause electric shock.



- For proper operation, use only approved blu™ branded electronics and components as well as specified compatible electronic devices.

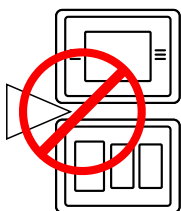

- Do not place any items between stacked units at any time. Disruption of power to the units can cause damage to the unit.

- **No metal is to come into contact with power connection points of blu™ units. These points are located on the tops of each blu™ unit, and connect to transfer power when stacked. Metallic interference will cause damage to the unit and possible harm to the individual.**

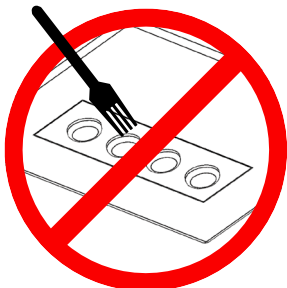

CARE AND MAINTENANCE

- Keep blu™ units and all accessories out of reach of children.
- Do not use third party power supplies or non-approved adapters with blu™ units.
- Do not attempt to open the outer casing of the product.
- Do not clean any blu™ units with harsh chemicals and keep blu™ units away from liquids.
- Do not expose blu™ units to extreme temperatures.
- Do not paint or apply coatings to blu™ units, as you might affect parts or damage internal components.
- Do not keep blu™ units in direct sunlight

CERTIFICATION

blu™ units are all FCC, SGS (NRTL) and ROHS certified for safety and reliability under the United States compliance standards.

Unauthorized changes or modifications to this device may impair the user's ability to operate this device and will void the warranty.

FCC, SGS (NRTL) and ROHS Notice to Users

Users are not permitted to make changes or modify this device or any of its companion products or components in any way. Changes or modifications are considered a safety hazard/risk and will void the warranty.

WHAT'S INCLUDED

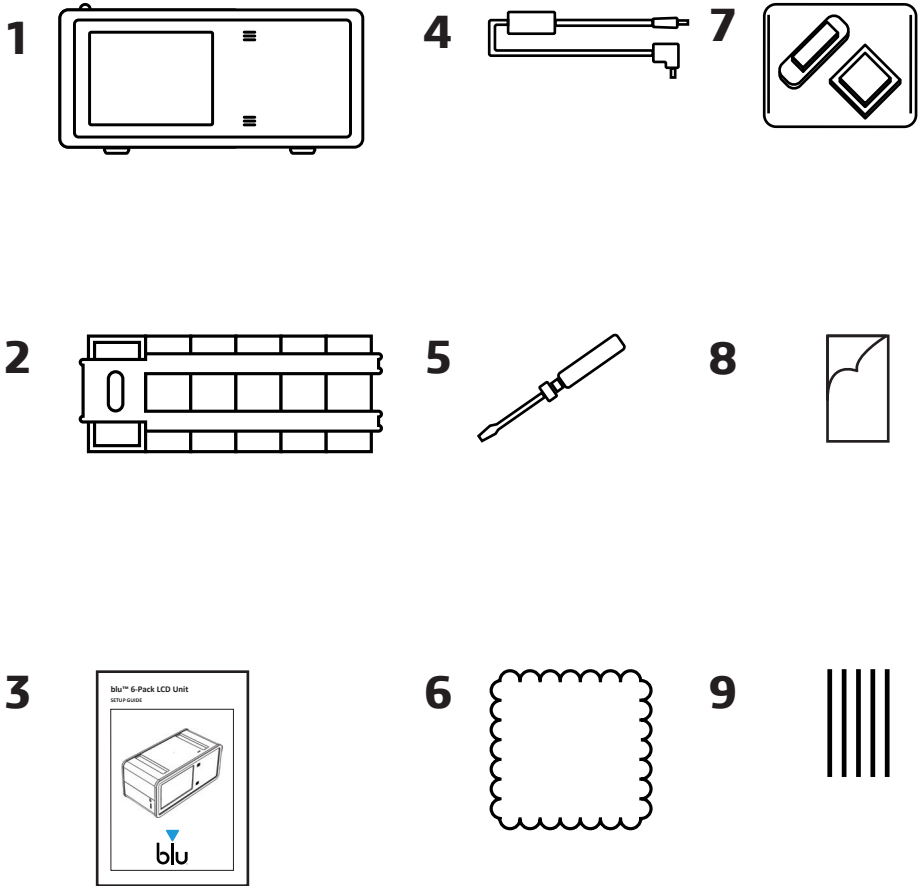

- | | | | |
|----|---|----|-----------------------------------|
| 1. | blu™ Product Unit | 6. | 1 x Microfiber Cloth |
| 2. | blu™ Product Tray (with Starter Kit insert) | 7. | Polybag of 2 x Pin Caps |
| 3. | Setup Guide | 8. | Double-Sided Tape for Transformer |
| 4. | 60 Watt Power Supply | 9. | 5 x Cable Ties |
| 5. | Screwdriver | | |

COMPONENTS OVERVIEW

FRONT VIEW

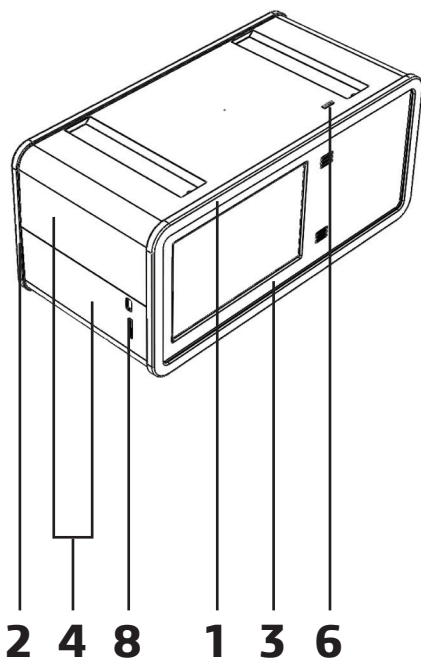

- 1. Blue Front Trim
- 2. Blue Rear Trim
- 3. LCD Display Fascia
- 4. Outer Casing

REAR VIEW

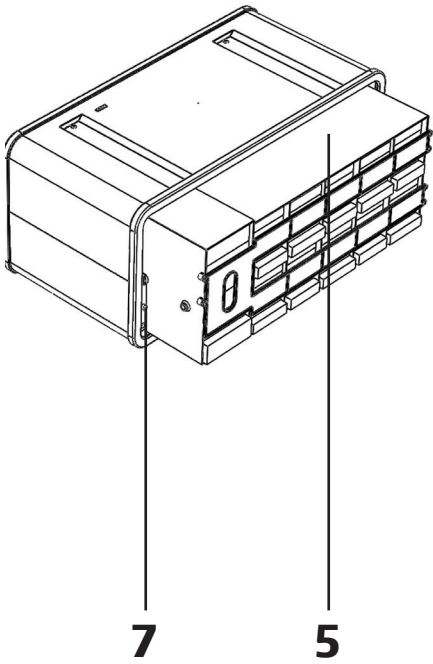

- 5. blu™ Product Tray
- 6. Power Connection Points
- 7. Power Button
- 8. SD/USB Slots

blu™ 6-Pack LCD Screen Setup Guide

Accessing the Touch Screen

- **Note:** Before proceeding with setup, please ensure the Asset # has been written down as this will be used for setting up the unit on the bluVAP app.
- Remove the front blue trim as shown in the visual opposite.
- Using the screwdriver provided, remove each screw from the front fascia by turning the screw anti-clockwise as shown in the visual opposite.
- Carefully remove clear front fascia.
- Turn unit on by plugging in or stacking on top of an already powered POS unit.

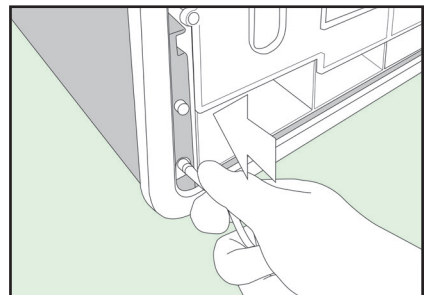
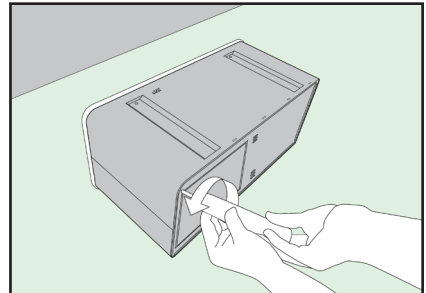
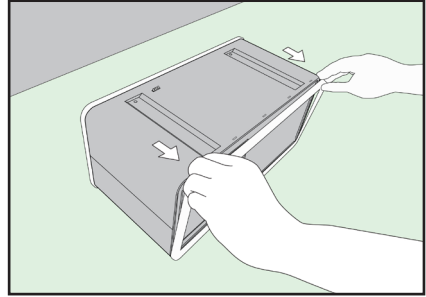

Access Settings

- When the device is plugged in, the bluVAP app will automatically load at the Home Page.
- Swipe down from the top of the screen once. This will bring up the options menu as shown in the visual opposite.
- Swipe down from the top of the screen again. This will show a small box at the top of the screen as shown in the visual opposite.
- Tap this small box to bring up a larger menu, which displays the Settings icon.
- Access Settings by tapping the icon shown in the visual below.

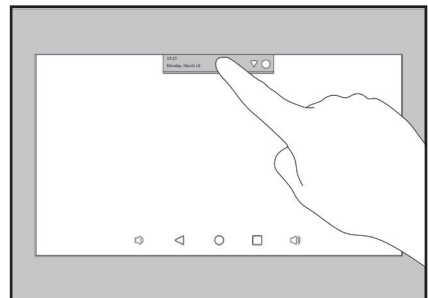
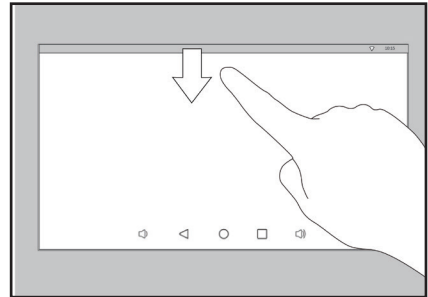

Connecting to Wi-Fi

- Under Wireless and networks, tap Wi-Fi.
- Select store network and enter Wi-Fi password to connect.
- Tap the ◀ icon on the bottom bar to return to Settings.

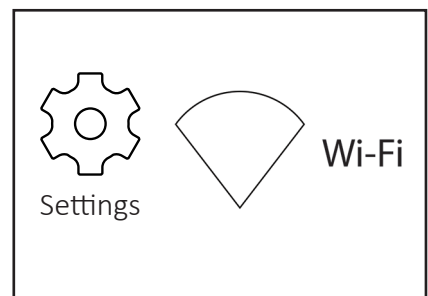

Date/Time Settings

- When in Settings, use touch screen to scroll up until you see Date and Time.
- Tap Date and Time.
- Select appropriate Time Zone.
- Ensure that 'Use 24-hour format' icon is switched ON (As shown right)
- The time should now reflect this change. (Example: 2:00pm-14:00)
- **Check to ensure that the time in the top right corner is correct and in the correct 24:00 format.**
- Tap the  icon. This will display any open v.
- Swipe the **Settings** tab away.
- **Note: If at any time the bottom bar is not visible swipe up from the bottom of the screen and it will reappear.**

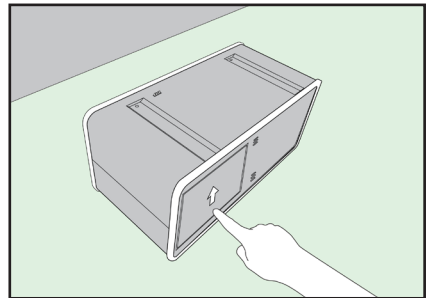
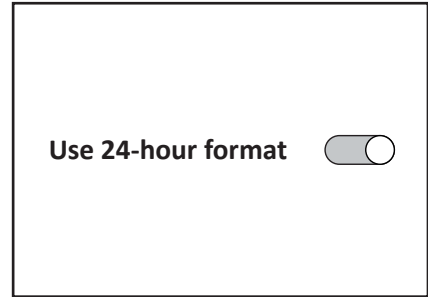

Setting up the VAP (Video Advertising Platform)

- Once at the bluVAP Home Page, press Configure.
- Enter all relevant details, ensure all details are correct.
- **Note: Please refer to the Asset # noted earlier.**
- Once completed, press 'Configure Device'
- Please wait until video begins playing.
- **Note: The video may take a short while to load and begin playing.**
- **Note: If at any stage the screen freezes, turn the unit off by pressing the black button on the rear of the unit. Wait for the unit to power down on the 10" screen. Once the 10" screen has powered down, press the on/off button again and the screen will power up.**

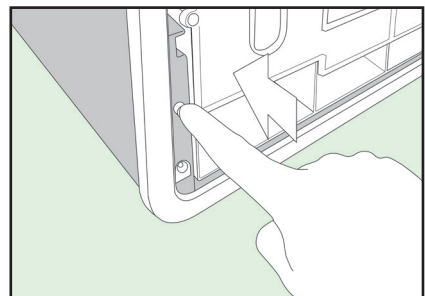
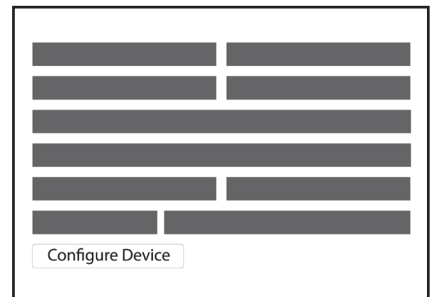

Adjusting Brightness

- Swipe down from the top of the screen to bring up the brightness slider

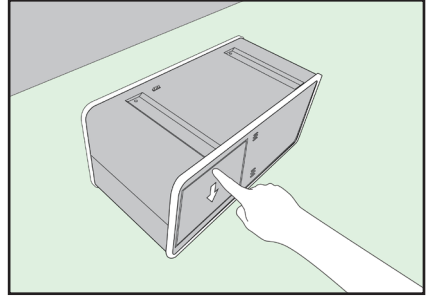

- Adjust the brightness by using the slider:

Left - Dimmer

Right- Brighter

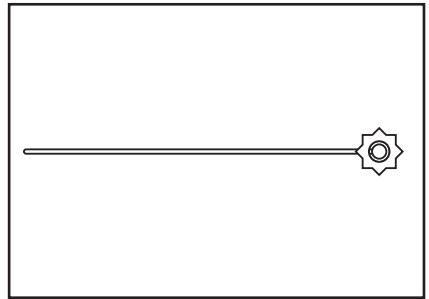

- Swipe the menu up to exit.

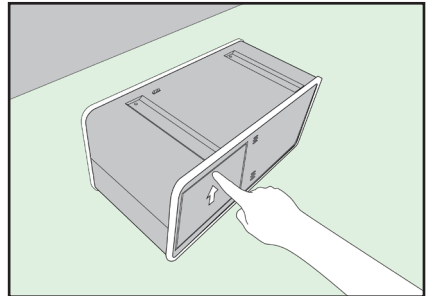

Adjusting Volume

- Swipe up from the bottom of the screen to bring up the volume settings

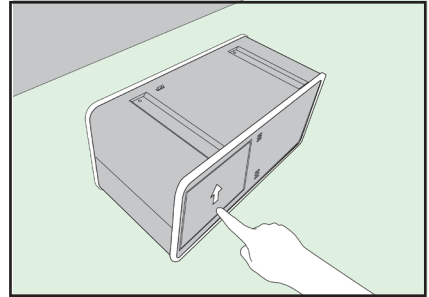

- Adjust the volume by using the speaker icons:

 **Louder**

 **Quieter**



- Swipe the menu down to exit.

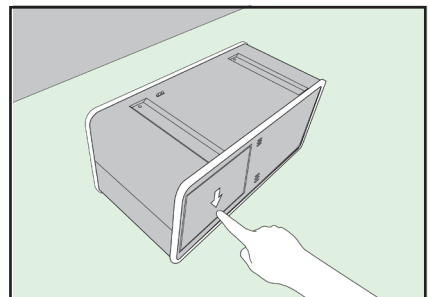

Inserting POS Advertising

- With the front blue trim and clear cover removed, lay POS advertising over the display fascia as shown in the visual opposite.

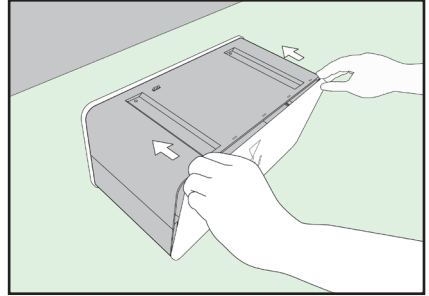

- Carefully **peel clear film** from outer face of clear panel.
- Use the provided microfiber cloth to wipe off any dust or fingerprint marks.
- Fix clear cover on unit using provided screws as shown in visual opposite.
- **Note: Do not over tighten screws. Tighten until firm but not OVER tight.**
- Replace the front blue trim as per the visual opposite.

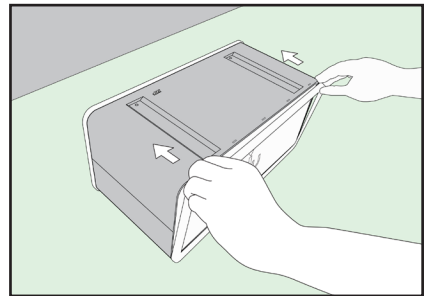
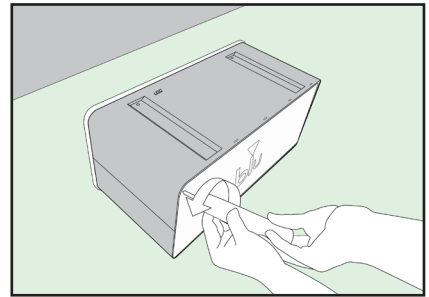

Installing Pack Tray

- Carefully remove the rear blue trim as shown in the visual opposite.

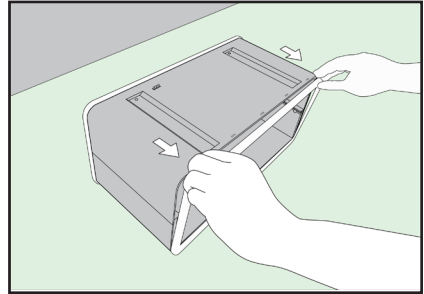

- Insert tray using the guide rails on either side of the unit as shown in the visual opposite.

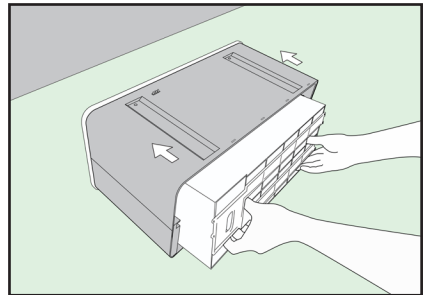

- Once the tray is in position, replace the blue trim to the outer edge as shown in the visual opposite.

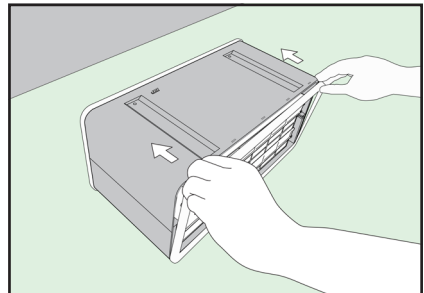

Removing Dry Starter Kit Insert

- Using the screwdriver provided, remove each screw from the clear fascia by turning the screw anti-clockwise as shown in the visual opposite.
- Carefully remove clear fascia.

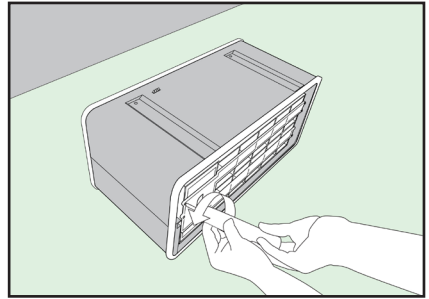

- Remove the Starter Kit insert.

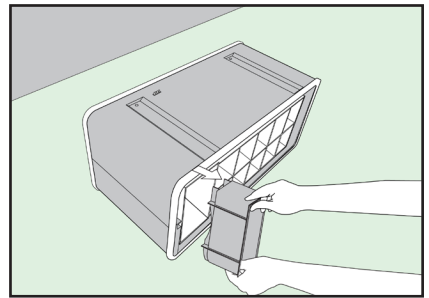

- Using the screwdriver provided, fix the fascia panel onto the tray using the screws as shown in the visual opposite.

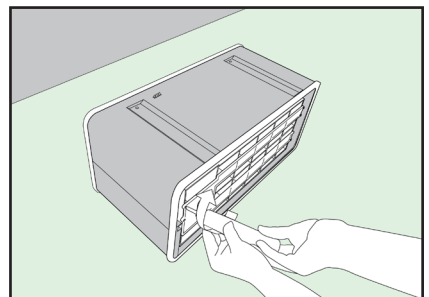

Filling and Dispensing from Trays

- Load packs by inserting into the top opening of each section as per the visual opposite.

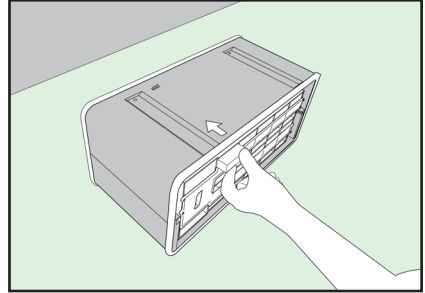

- Remove packs by pulling out from the bottom opening of each section as per the visual shown opposite.

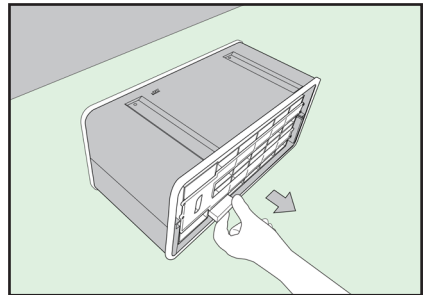

Stacking Units

- Units can be stacked on top of each other for multiple displays in a store (NOTE: Units should not be stacked more than 3 high).
- Only one unit needs to be connected to the power source.
- When stacked correctly on top of another unit, the top unit(s)

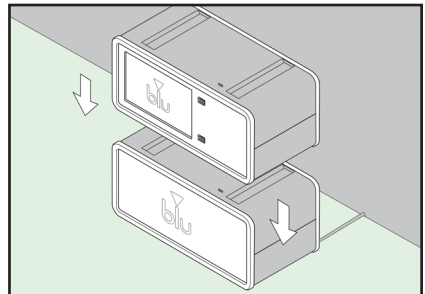

- Will connect automatically to the bottom units power.
- Stacked units should sit directly on top of the bottom unit, with the feet of the top unit 'nesting' into the top of the bottom unit as per the visual opposite.

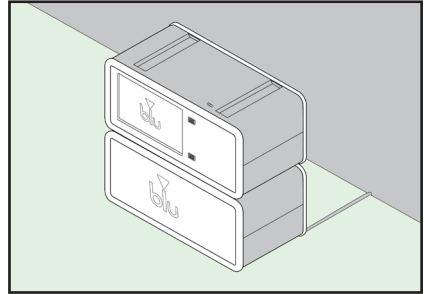

Applying Pin Covers

- Please ensure that any exposed power connection points are covered by the provided pin covers. **These pin covers are only to be used on the top exposed pins of the top unit (as shown in the visual opposite, and the bottom exposed pins of the bottom unit (as shown in the visual opposite)).**
- **Note: The visual opposite refers to the bottom unit ONLY. Do not cover the bottom pins of the top or center unit as this will disrupt power between the units.**

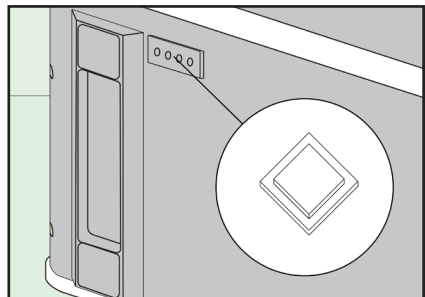
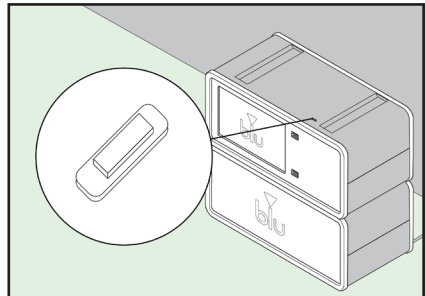

Please refer to next page

Top Unit Pin Cover Application

- Remove one side of the double sided tape and place on the inside of the pin cover
- Once the tape is firmly pressed inside the pin cover, place a pin cover over the pins on the top of the unit as shown in the visual opposite.

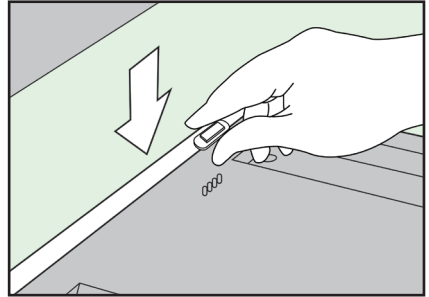

Bottom Unit Pin Cover Application

- Similarly, when tape is applied to the second pin cover, place the second pin cover over the pins on the bottom of the unit as shown in the visual opposite.

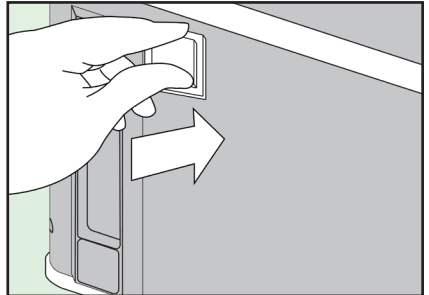

TROUBLESHOOTING

Damaged Goods

- If you receive any damaged/broken components, please contact online support and complete the **Re-Order Process** form at **repsupport@blu.com**

SCREEN/UI

If VAP app does not load

- Press and hold the power button at the rear of the unit until the screen powers down.
- Press the button again to turn the screen on. The bluVAP should automatically load at the Home Page as shown in the visual opposite.
- If the problem persists, contact online support at **repsupport@blu.com**



If Video does not load

- Check and ensure **all correct details** are listed at the configuration screen.
- Once configured, if no video plays, press and hold the power button at the rear of the unit until the screen powers down.
- Press the button again to turn the screen on.
- The bluVAP app will automatically load to the Home Page as shown in the visual opposite.
- Wait approximately 10 seconds and the correct video content should begin playing.
- **Note: The video may take a short while to load and begin playing.**
- If the problem persists, please contact online support at **repsupport@blu.com**



ELECTRONIC COMPONENT FAILURE

- If there are issues involving any electronic components, please contact online support at **repsupport@blu.com**

blu™ Appendix

FCC Regulatory Compliance

Note: This equipment has been tested and found to comply with the limits for a Class B digital device, pursuant to Part 15 of the FCC Rules. These limits are designed to provide reasonable protection against harmful interference in a residential installation. This equipment generates, uses and can radiate radio frequency energy and, if not installed and used in accordance with the instructions, may cause harmful interference to radio communications. However, there is no guarantee that interference will not occur in a particular installation. If this equipment does cause harmful interference to radio or television reception, which can be determined by turning the equipment off and on, the user is encouraged to try to correct the interference by one or more of the following measures:

- Reorient or relocate the receiving antenna.*
- Increase the separation between the equipment and receiver.*
- Connect the equipment into an outlet on a circuit different from that to which the receiver is connected.*
- Consult the dealer or an experienced radio/TV technician for help.*

Warning: changes or modifications not expressly approved by the party responsible for compliance could void the user's authority to operate the equipment.

RF Exposure Compliance

This equipment complies with FCC radiation exposure limits set forth for an uncontrolled environment. This equipment should be installed and operated with minimum distance 20cm between the radiator and your body. This transmitter must not be co-located or operating in conjunction with any other antenna or transmitter.