



Shower Power Manual



Welcome Note from the Founders

There's really no need to remind everyone how crazy life is right now. Starting or finishing the day frazzled isn't healthy. We all need a microlift...time to relax, de-stress and even have a bit of fun. Having as little as 5 minutes alone time is an easy way to get back on track. For a lot of people, the time you spend in Shower may be the only truly alone time you get all day. Why not make the most of it?

Enter... Shower Power. A powerful Bluetooth speaker that generates all its power from the water you are already using in the shower. Relaxing music, your favorite podcast, in the shower... What's not to like?

We designed Shower Power, to be effortless to use. It integrates seamlessly into your daily routine. Installation is fast and simple. It turns on and pairs automatically. And best of all, you never have to worry about charging it. With Shower Power, you will always have a powerful fully-charged Bluetooth speaker in your shower. We guarantee that your shower experience will never be the same.

Before using Shower Power, please read all the instructions and watch our installation videos. And, make sure to register your product at register.ampere.shop to lock in the one-year warranty and a \$20 gift card.

Thank you for your support! We'd love to hear what you think about Shower Power. Please email us with any questions, concerns, feedback, etc. at hello@ampere.tech.

Thanks!

Chase & Reid

Handwritten signatures of Chase and Reid in black ink.

Specs

Battery: 1800 mAh Lithium Ion

Frequency Range: 100Hz-20KHz

Speaker: 40mm x 2

Speaker Power: 3W x 2

Supports Bluetooth®: 5.1

Weight: 520 g.

Size: 158 x 95 x 91mm



360° Sound & Powerful Bass



Pair Two Together for Surround Sound



10 Hours of Battery Power



Remote or Touchpad Control



100% Powered by Water



IPX6 Waterproof



Made from Recycled Ocean Plastic



Fits 99% of Showerheads

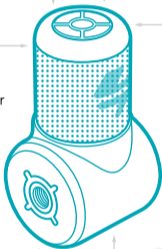

What's in the Box



Shower Dock



Droplet Pro
(aka Speaker)



Male-male
Connector



Hex Key



Sealing Tape



Gaskets
(O-rings)

Quick Start Guide

For more detailed installation instructions and how-to videos, go to install-shower-power.ampere.shop or scan the QR code below.



Before you begin, identify your shower fitting.

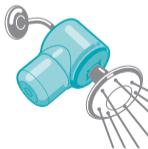

Fixed

The showerhead attaches to a fitting that comes straight from the wall at an angle. The fitting is male and the showerhead is female.



Rain

The showerhead attaches to a fitting that comes straight down from the ceiling. The fitting is **male** and the showerhead is **female**.

*Installation is basically the same for handheld and rain.



Handheld

The showerhead attaches to a hose that comes from a fitting **lower down on the wall**. The hose is **female** and the showerhead is **male**.

*Tip -

You can install Shower Power on either end depending on your preference. It can be at the base of the hose OR at the end of the hose, attached to the showerhead.

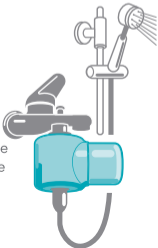

Step 1 - Unbox Shower Power and remove the speaker from the dock

Rotate the speaker 90 degrees counterclockwise to separate it from the dock. Set the speaker and dock aside.

Step 2 - Remove your showerhead from the fitting

Unscrew the showerhead. You can usually do this by hand but may need a pair of pliers if it was installed too tightly.

Step 3 - Install the male-male connector on the appropriate side

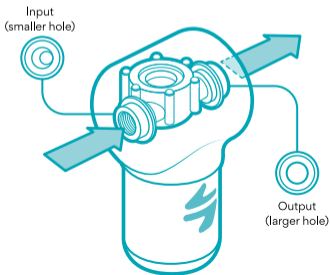

Determine which side of Shower Power is input and which side is output. There is a sticker that indicates the input side (this can be removed after the first use). For additional confirmation, in future checks, the hole on the input side is smaller. As such, the turbine will be more visible on the output side.

Rain and Fixed

For these shower types, the male-male connector will go on the output side (the side that connects to the showerhead). First, screw in the male-male connector by hand and then tighten it with the hex key.

Handheld

For these shower types, the male-male connector will go on the input side (the side that connects to the hose). First, screw in the male-male connector by hand and then tighten it with the hex key.

Step 4 - Connecting your showerhead to the shower dock

Attach your showerhead to the shower dock. Connect securely but don't overtighten. If you noticed that your showerhead/fitting already used sealing tape, you may want to use it at this stage of the installation process.

***Tip for handheld showers**

If the showerhead is not oriented in the direction you want then you can add a rubber O-ring inside the output threads on Shower Power. Use the thinner rings for smaller adjustments and the thicker rings for larger adjustments. You can use multiple if necessary.

Step 5 - Connect shower dock + showerhead to the shower fitting

Finally, connect the shower dock, with the showerhead now attached, to the shower fitting.

***Tip for rain and fixed showers**

If the showerhead is not oriented in the direction you want then you can add a rubber O-ring inside the output threads on Shower Power. Use the thinner rings for smaller adjustments and the thicker rings for larger adjustments. You can use multiple if necessary.

Step 6 - Connect the speaker (aka Droplet Pro) to the shower dock

Align the bump in the underside of the shower dock with the groove on the top of the speaker (Droplet). The Ampere logo will be facing the same direction as flow of water when and you should feel the bump go into the groove. Then, rotate the speaker 90 degrees. You will feel it “lock” into place and the Ampere logo will be perfectly centered along the side of Shower Power.

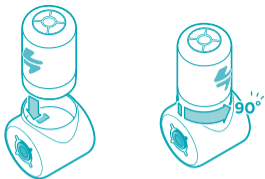

Congratulations! Now you are ready to rock n' roll.

Troubleshooting

It's leaking! What do I do?

The first thing to check is if you screwed in Shower Power tight enough. The next solution is to try adding rubber O-rings to the female ends of the connection. Another solution is to use the included thread sealing tape to make the connection tighter. Wrap the sealing tape around the threads in a counterclockwise direction for a better seal.

What do I do if Shower Power is not pointed in the direction I want?

If the showerhead is not oriented in the direction you want then you can add a rubber O-ring inside the output threads on Shower Power. Use the thinner rings for smaller adjustments and the thicker rings for larger adjustments. You can use multiple if necessary. You can also use the included thread sealing tape to prevent leakage and screw to your preferred direction.

Using Shower Power

Charging

Hydroelectric Charging:

Charging a Bluetooth speaker has never been easier—all you have to do is take a shower. Shower Power will charge whenever there is flowing water. Under “normal use conditions,” Shower Power will never need to be charged. We consider “normal use conditions” to be water pressure between 30-50 PSI, water temperature of less than 120°F (50°C), and only using Shower Power while the water is running.

If you use Shower Power without water running, then you will be using the reserve battery power. Continued use will result in needing to use the USB-C port to charge the Shower Power.

USB-C Charging:

Remove Droplet (the speaker) from the Shower Dock and make sure it is completely dry before plugging in. You can charge Droplet with almost any adapter from a reputable brand. Droplet is compatible with QC and PD adapters.

Low Power Notifications:

When the battery level reaches 20% Shower Power will beep three times. When the battery reaches 10% it will beep three times. When you hear this “low battery” sound, we recommend not using Shower Power without water running. Alternatively, you can use the USB-C port to bring it back up to 100%.

Pairing

When Shower Power is turned on, it will enter Bluetooth pairing mode automatically. The “searching sound” will play for one minute but it will remain in pairing mode for three minutes. If no device is paired within three minutes, Shower Power will automatically turn off.

To pair your device, open the Bluetooth pairing tab on your device and select “Shower Power.”

Play your favorite audio from your device. You can pause, play, skip, change volume, etc from your device, via the button pad, or the Shower Power remote control.

Button Pad



Power Button

1. Hold for two seconds to turn Shower Power on and off.
2. The power button will illuminate green when the battery is charging.
3. The power button will blink blue while in pairing mode.



Play Button

1. Single press to pause and play your audio.
2. Hold for two seconds to skip to the next song.

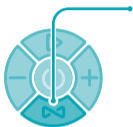

Pairing Button

1. Single press to enter TWS pairing mode.
2. Press and hold for 2 seconds to enter Bluetooth pairing mode.
3. Hold for 10 seconds to clear the Bluetooth pairing history.



+/- Buttons

1. Single press the + and - buttons to increase and decrease volume, respectively, one level at a time.
2. Hold the + and - buttons to “scroll” through the volume levels more quickly.

Shower Power Accessories

Droplet/Droplet Pro

When sold with the Shower Dock, the speaker and Shower Dock together are called Shower Power (and Shower Power Pro). When purchased separately, the speaker component is referred to as Droplet (and Droplet Pro). Regardless of whether you bought the speaker component as part of “Shower Power” or separately, it will work with any Shower Power Shower Dock.

TWS Pairing

Before pairing your device, turn on two Ampere speakers (Droplet, Droplet Pro, Shower Power, Shower Power Pro) and allow the two speakers to connect. When they connect successfully, you’ll hear a pairing sound.

Single press the pairing button to enter TWS pairing mode. After two speakers are connected, single press on one to disconnect it. After disconnecting the TWS, if you would like to re-pair, turn Droplet off and turn on again.

If you are having trouble getting the speakers to connect, make sure that there are no devices nearby that have paired to either speaker. If so, go into your Bluetooth settings and “forget” all

Shower Power-related Bluetooth devices. If you are still having trouble connecting two speakers, hold down the pairing button for ten seconds to reset the Bluetooth pairing settings. You'll hear a "reset" sound. Then, turn off both speakers. Turn them back on and press the bluetooth button once on both speakers.

Shower Power Remote

The Shower Power remote works just like the button pad on Shower Power itself. If it's hard to reach, the remote allows you to control all the functionality from up to 10 meters away. The only difference is that the power button on the remote does not turn Shower Power on. Shower Power will turn on automatically when water starts to flow.

Cleaning and Care

Just like any showerhead, over time, the Shower Dock may become stained or dirty. This could be a buildup of limescale, or metals and minerals (like iron and manganese), or bacteria. It is fine to clean the Shower Dock with the same cleaners that you use for your showerhead. That could include vinegar, baking soda, or gentle bathroom cleaning spray.

Before you begin, remove the speaker (Droplet) from the speaker dock and set it aside. When cleaning the shower dock, pay close attention when cleaning the inside as not to damage the pogo pins. Be very careful with any cleaning agents around the pogo pins and try to keep them as dry as possible.

To clean the speaker component (Droplet), remove it from the speaker dock and clean with a damp cloth. Do not leave the pogo pin connection wet or submerged in water.

This device complies with part 15 of the FCC Rules. Operation is subject to the following two conditions: (1) This device may not cause harmful interference, and (2) this device must accept any interference received, including interference that may cause undesired operation.

Any Changes or modifications not expressly approved by the party responsible for compliance could void the user's authority to operate the equipment.

Note: This equipment has been tested and found to comply with the limits for a Class B digital device, pursuant to part 15 of the FCC Rules. These limits are designed to provide reasonable protection against harmful interference in a residential installation. This equipment generates uses and can radiate radio frequency energy and, if not installed and used in accordance with the instructions, may cause harmful interference to radio communications. However, there is no guarantee that interference will not occur in a particular installation. If this equipment does cause harmful interference to radio or television reception, which can be determined by turning the equipment off and on, the user is encouraged to try to correct the interference by one or more of the following measures:

- Reorient or relocate the receiving antenna.
- Increase the separation between the equipment and receiver.
- Connect the equipment into an outlet on a circuit different from that to which the receiver is connected.
- Consult the dealer or an experienced radio/TV technician for help.



AMPERE™