



LTE B2/B4/B5/B12/B17
WCDMA 850/1700/1900
GSM 850/900/1800/1900

MODEL: ***nitro5P***



IMEI1:35467710014000X



IMEI2:35467710027000X



SN: NTO5P2003000001

FCC ID: 2ASP8NITRO5P



Designed in USA | Made in China
Diseñado en EEUU | Hecho en China
Conçu aux Etats-Unis | Fabriqué en Chine

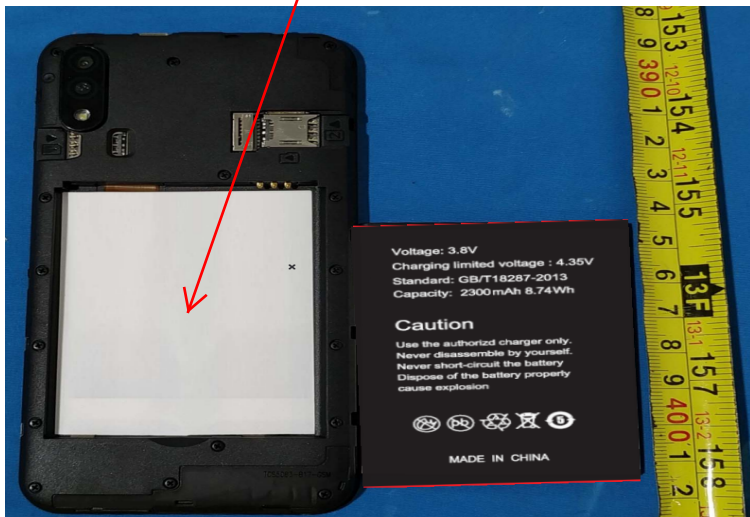

Voltage: 3.8V
Charging limited voltage : 4.35V
Standard: GB/T18287-2013
Capacity: 2300mAh 8.74Wh

Caution

Use the authorized charger only.
Never disassemble by yourself.
Never short-circuit the battery
Dispose of the battery properly
cause explosion



MADE IN CHINA