

FCC Statement

This equipment has been tested and found to comply with the limits for a Class B digital device, pursuant to Part 15 of the FCC Rules. These limits are designed to provide reasonable protection against harmful interference in a residential installation. This equipment generates uses and can radiate radio frequency energy and, if not installed and used in accordance with the instructions, may cause harmful interference to radio communications. However, there is no guarantee that interference will not occur in a particular installation. If this equipment does cause harmful interference to radio or television reception, which can be determined by turning the equipment off and on, the user is encouraged to try to correct the interference by one or more of the following measures:

- Reorient or relocate the receiving antenna.
- Increase the separation between the equipment and receiver.
- Connect the equipment into an outlet on a circuit different from that to which the receiver is connected.
- Consult the dealer or an experienced radio/TV technician for help.

This device complies with part 15 of the FCC Rules. Operation is subject to the following two conditions:

- (1) This device may not cause harmful interference, and (2) this device must accept any interference received, including interference that may cause undesired operation.

Changes or modifications not expressly approved by the party responsible for compliance could void the user's authority to operate the equipment.

The User Manual of Wireless Smart Plug

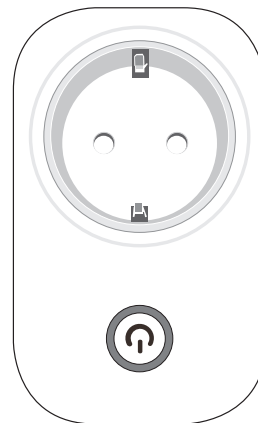

** We offer Smart Plug in global standards like CEE, GB, SAA, etc.
CEE standard is used for reference only in this document.*

Features

The smart plug is an accessory of smart alarm system. It is easy and reliable to use with elegant design. The smart plug could be controlled remotely by App. By the "Follow Me" feature of the system, the smart plug could also be automatically turned ON/OFF according to system or accessory events, or by preset time schedule.

Parameters

| | |
|--------------------------|-----------------------------|
| • Power Rating | MAX2400W |
| • Rated Input | AC 110V-240V/50-60Hz/MAX10A |
| • Rated Output | AC 110V-240V/50-60Hz/MAX10A |
| • Distance | 300 m |
| • Transmission Frequency | 433.92MHz |
| • Working Temperature | -10 C ~50 C |
| • Humidity | ≤90%rh (non-condensing) |
| • Weight | 88.7 g |
| • Dimension | 102*62.5*29.7 mm (L*W*H) |

Appearance

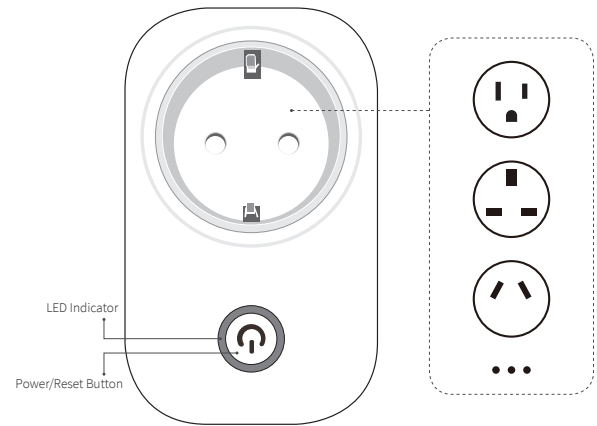

* We offer Smart Plug in global standards like CEE, GB, SAA, FC, etc.
CEE standard is used for reference only in this document.

Pairing With Main Panel by App

1. Make sure your Smart Plug is plugged into the outlet. Check the LED indicator if it is ON. If not, press the power button to ensure the smart plug has been turned ON.
2. Launch App. Scan the QR Code printed on the smart plug. Finish the rest parts like renaming, etc.
3. PRESS [SAVE] on App. The pairing would be finished when the LED indicator blinks several times. The system would inform you the pairing result by APP.

Hint: The main panel and the smart plug should be ON during the whole pairing process.

Use The Smart Plug

1. Turn ON/OFF.
In the App , you could easily turn ON/OFF by tapping buttons in the Smart Plug section or in the main control panel.
2. Setup Follow Me Strategy or Time Schedule
Smart plug could be automatically turned ON/OFF according to the system or accessory events, like ARM/DISARM/ALARM/TRIGGERED/TIME SCHEDULE etc. Users could easily setup these strategies in App, click the name in the Smart Plug List to modify settings.
3. Reset The Smart Switch
Keep holding the reset button in 10 seconds, the smart switch would be reset as the LED indicator keep flashing.