

## Owner's Manual

---

# INTEGRATED BIDET TOILET

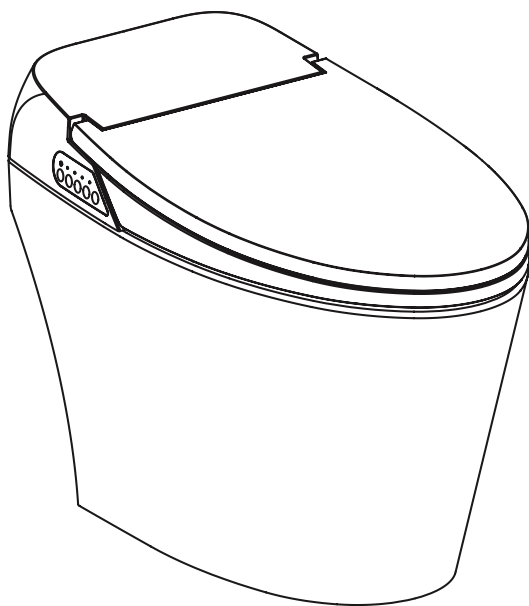

## Table of Contents

This manual contains important safety information. Before operating the bidet, please read this manual thoroughly, and retain it for future reference.

### GENERAL INFO

- 01 SAFETY INFORMATION
- 06 PRODUCT INFORMATION
- 06 Product Features
- 08 Product Dimensions
- 09 Product Parts

### PRODUCT INSTALLATION

- 10 PRODUCT INSTALLATION
- 10 Installation Parts
- 11 Before Installation
- 12 Preparing the Ceramic Bowl
- 14 Installing the Bidet Seat
- 15 Installing the Mesh Filter
- 16 Installing the Assembled Main Unit
- 17 Remote Installation

### PRODUCT OPERATION

- 18 PRODUCT OPERATION
- 18 Remote Control Functions
- 20 Auxiliary Control Functions
- 21 Using the Integrated Bidet Toilet
- 22 Auto Functions & Options
- 24 Special Mode Operations
- 25 Adjusting the Remote Control Frequency

### TECHNICAL INFO

- 26 PRODUCT SPECIFICATIONS
- 28 MAINTENANCE
- 28 Cleaning the Mesh Filter
- 28 Seat Cleaning
- 29 Nozzle Sterilization Mode
- 29 Nozzle Cleaning
- 30 Cleaning the Deodorizer Mesh Strainer
- 31 TROUBLESHOOTING
- 33 WARRANTY
- 34 CONTACT



### TRANSLATIONS

- 01 ENGLISH
- 35 SPANISH
- 70 FRENCH

## SAFETY INFORMATION (IMPORTANT SAFEGUARDS)

### READ ALL INSTRUCTIONS BEFORE USING

BE CAREFUL TO KEEP THIS SAFETY INFORMATION. PLEASE READ THIS INFORMATION TO PREVENT PROPERTY LOSS AND ENSURE SAFETY.

-  **DANGER:** If not observed, serious injury or even death may occur as a result.
-  **WARNING:** If not observed, serious physical injury or property damage may occur as a result.
-  **CAUTION:** If not observed, minor physical injury or property damage may occur as a result.

 **DANGER** Failure to observe the following warnings may result in electric shock, fire, personal injury, property damage or product damage.

- Do not use a damaged power plug or plug into a loose electric outlet.
- Do not move the product by pulling the power cord.
- Do not handle the product or power plug with wet hands.
- Do not forcefully bend the power cord or place heavy objects on it to prevent it from being damaged or deformed.
- Do not connect and pull out the power plug or cord repeatedly.
- Unplug the product before cleaning, repairing, inspecting, or replacing parts.
- Remove any dust or water from the power plug prior to plugging in.
- Do not plug the product into an electrical outlet or power strip that is being used by too many other products. Use an electrical outlet adequate for the wattage of the product rated for a minimum of 15 amps.
- If the power cord is damaged, do not attempt to repair, modify, or replace the cord yourself. Contact the Brondell Service Center toll free at 888-542-3355 or email us through our website.
- If the product produces a strange noise, a burning smell, or emits smoke, unplug it immediately from the electrical outlet and contact Brondell. Failure to do so may result in electric shock or fire.
- Do not insert any wires or sharp objects into any product gaps. This may result in electric shock, fire, or product damage.
- Do not place an electronic or gas heater near the product or dispose of any burning materials such as a lit cigarette in the toilet. This may result in fire or product deformation. Do not place any containers filled with water or other liquids, food, metallic objects, or any flammable material on top of the product. If foreign material enters the product, this may result in electric shock or fire.

**SAVE THESE INSTRUCTIONS**

# SAFETY INFORMATION (IMPORTANT SAFEGUARDS)

 **DANGER** Failure to observe the following warnings may result in electric shock, fire, personal injury, property damage or product damage.

- Do not use the product in locations exposed to excessive moisture and do not splash water onto the product.
- While cleaning the bathroom, pull the power plug out of the electrical outlet and exercise caution to ensure that water or cleaning supplies do not splash onto the bidet. Failure to do so may result in electric shock or fire.
- If foreign material enters the product, pull the power plug out of the electrical outlet, turn off the main water valve, and call the Brondell Service Center.
- Do not disassemble, repair, or modify the product yourself.
- Do not use the product while wet from bathing or showering.
- Do not place or store the product where it can fall or be pulled into a tub or sink.
- Do not place in or drop the product into water or any other liquid.
- Do not reach for the product if it has fallen into water. Unplug the product immediately and call the Brondell Service Center.
- Do not use the product if it is not working properly. Please unplug the product immediately, close the main water supply valve, and call the Brondell Service Center at 888-542-3355. Failure to do so may result in electric shock, fire, or flooding.

 **WARNING** Failure to observe the following warnings may result in electric shock, fire, personal injury, property damage or product damage.

- Do not plug in, operate, or store the unit in locations where flammable or combustible materials are used or kept.
- Do not use industrial water, or gray water for the supply, as this may cause skin damage or disease.
- Turn off the main water supply valve when cleaning.
- For children and seniors who may have difficulties with adjusting temperatures or those with sensitive skin or impaired heat sensitivity, set the temperature of the wash spray and seat to “low” or “off” to prevent burning.
- Close supervision is necessary when this product is used by children, seniors, or persons requiring general assistance.
- Do not press the buttons using excessive force.
- Do not stand on top of or place any heavy objects onto the seat cover.
- Use this product for its intended use only, as described in this manual. Do not use any attachments that are not recommended by Brondell.

# SAFETY INFORMATION (IMPORTANT SAFEGUARDS)

 **WARNING** Failure to observe the following warnings may result in electric shock, fire, personal injury, property damage or product damage.

- Never operate this product if it has a damaged cord or plug, if it is not working properly, if it has been dropped or damaged, or dropped into water. Contact the Brondell Service Center for examination and repair.
- Keep the cord away from heated surfaces and heating vents.
- Never block the air openings of the product or place it on a soft surface, such as a bed or couch, where the air openings may be blocked. Keep the air openings free of lint, hair, etc.
- Never drop or insert any object into any opening or hose.
- Do not use the product outdoors or operate where aerosol (spray) products are being used or a room where it could be exposed to oxygen.
- Connect this product to a properly grounded outlet only. Refer to the Grounding Instructions in the next pages of the manual.

 **CAUTION** Failure to observe the following warnings may result in electric shock, fire, personal injury, property damage or product damage.

- Do not connect the main water supply to the hot water pipe or supply (only connect to the cold water supply).
- After the installation, make sure to check all water supply connections for leaks. Rubber washers should be in place for the water connection hoses.
- Do not open/close the seat or seat cover with excessive force.
- Exercise caution that urine does not come into contact with the product failure to do so may result in bad odors or malfunction.
- If the product will not be used for a long period of time, unplug the power cord, close the main water supply valve.
- Do not pull out the bidet hose using excessive force.
- Do not use thinner, benzene, acidic chemicals, chloride, or hydrochloric acid detergent on or near the product. This may result in corrosion to the metal parts or discoloration or scratches to the bidet body.
- This appliance is not intended for use by persons (including children and seniors) with reduced physical, sensory, or mental capabilities, or lack of experience and knowledge, unless they have been given supervision or instruction concerning the use of the appliance by a person responsible for their safety.
- Children should be supervised to ensure that they do not play with the appliance.

# SAFETY INFORMATION (IMPORTANT SAFEGUARDS)

## GROUNDING AND GFCI OUTLET INSTRUCTIONS

This product should only be used with a grounded GFCI (Ground Fault Circuit Interrupter) outlet and a grounded three-prong electrical cord as shown to the right. In the event of an electrical short circuit, using a grounded GFCI outlet reduces the risk of electric shock.

This product is equipped with a grounded cord and is for use on a nominal 120V circuit only (minimum 15 amps) and must be plugged into an outlet that is properly grounded with a GFCI breaker as shown. Replace or repair a damaged cord immediately.

This product has a three-prong grounding plug, which must be plugged into an outlet that is properly installed and grounded. In the event of an electrical short circuit, grounding reduces the risk of electric shock by providing an escape wire for the electric current.

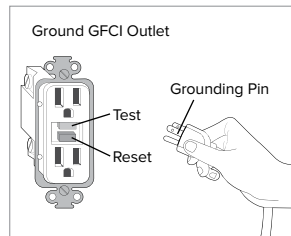

### IMPROPER USE OF THE GROUNDING PLUG CAN RESULT IN A RISK OF ELECTRIC SHOCK.

- If repair or replacement of the cord or plug is necessary do not connect the grounding wire to either flat blade terminal.
- The wire with insulation having an outer surface that is green with or without yellow stripes is the grounding wire. Check with a qualified electrician or service person if the grounding instructions are not completely understood, or if in doubt as to whether the product is properly grounded.

# SAFETY INFORMATION (IMPORTANT SAFEGUARDS)



**DANGER** Improper use of the grounding plug can result in a risk of electric shock.

## OPTIONAL GROUNDING INSTRUCTIONS

This product is for use on a nominal 120V circuit, and has a grounding plug that looks like the plug illustrated in sketch A in Figure 1.

A temporary adapter, which looks like the adapter illustrated in sketches B and C, may be used to connect this plug to a 2-pole receptacle as shown in sketch B if a properly grounded outlet is not available.

The temporary adapter should be used only until a properly grounded outlet (sketch A) can be installed by a qualified electrician.

The green colored rigid ear, lug, or the like extending from the adapter must be connected to a permanent ground such as a properly grounded outlet box cover. Whenever the adapter is used, it must be held in place by the screw.

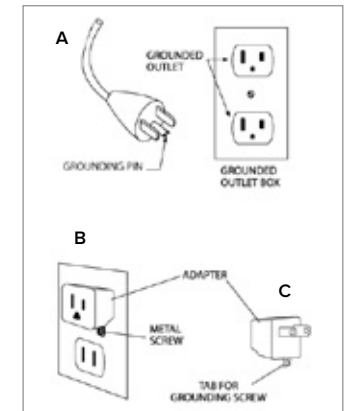

Figure 1

## PRODUCT INFORMATION

# Product Features

### Bidet Features

#### Stainless-Steel Nozzle System

Stainless steel resists soiling and bacterial contamination for enhanced hygiene.

#### Posterior and Feminine Warm Water Wash

Experience the ultimate in clean with adjustable temperature, position, pressure, massage, and oscillation settings

#### Positionable Nozzle

The nozzle has three different positions to ensure the most comfortable and complete wash.

#### Wireless Remote Control

The intuitive radio frequency remote control allows the user to easily select functions and settings.

#### Adjustable Water Temperature and Pressure

Front, and Rear wash modes have three available water temperature settings, and three water pressure settings.

#### Massage

When activated, the water pressure automatically increases and decreases to provide a pulsating, cleaning spray.

#### Warm Air Dryer

Includes adjustable temperature with three levels for a hands-free experience and toilet paper reduction – even elimination

#### Nozzle Oscillation

The Move function provides a massaging, oscillating cleanse during the wash cycle ensuring a thorough and comfortable wash.

#### Auto Function

Activates a preset for a rear wash cycle followed by a drying cycle.

#### Heated Seat with Smart Sensor

With four temperature settings (High/Medium/Low/Off).

#### Illuminating Night Light

The cool blue hue of the nightlight means no more blinding lights during midnight trips to the bathroom.

#### Gentle-Close Seat and Lid

“Slam free” gentle-closing seat and lid are user friendly.

#### Eco Mode

When activated, this function automatically lowers the water and seat temperature after the bidet was last used.

#### Deodorizer

The activated charcoal deodorizing filter eliminates odors at the source. It does not cover or mask odors, but eliminates them by removing air from the toilet bowl, passing it through the filter and expelling the clean air through the vent on the side of the bidet.

#### E-Water Nozzle Sterilization

E-Water or Electrolyzed Water Sterilization uses sodium hydroxide to transform your toilet's fresh water into a powerful disinfectant.

#### Tankless, Instant Water Heating System

With a ceramic-core heating system built in, you can experience warm water washes on demand without storing water in a tank or connecting to a hot water valve in your bathroom.

### Bowl Features

Vitreous China Bowl with ProTech Glaze

Chair height: 16-1/2 (420 mm)

Elongated Bowl Shape

12" (305mm) Rough-In Housing

#### DualJet+ Flushing System:

Auto and Manual Flush

Bowl-Cleaning Pre-Rinse

High-Performance Siphon and Double Jet

Rimless Flush for Optimal Bowl Cleaning

1.28 gallons (4.8 liters) per flush (gpf/lpf)

HET (high-efficiency toilet)

Fully glazed, 2-1/8" Internal Trapway

Large 9"x7" Water Surface Area

## PRODUCT INFORMATION

### Product Dimensions

Top View Lid Open

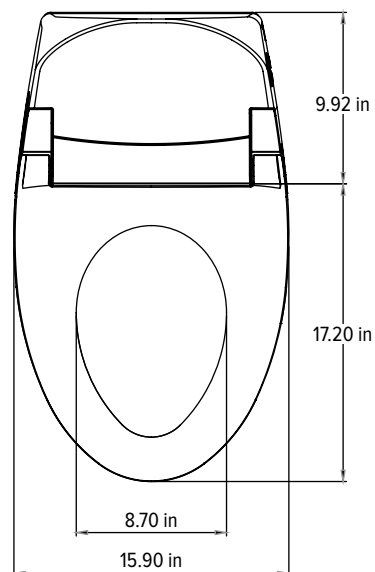

Top View Lid Closed

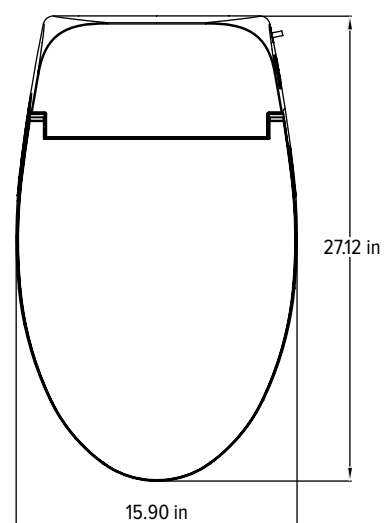

Front View

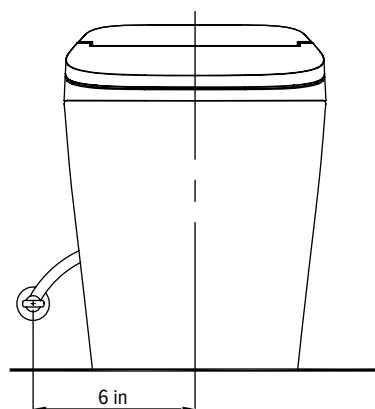

Profile View

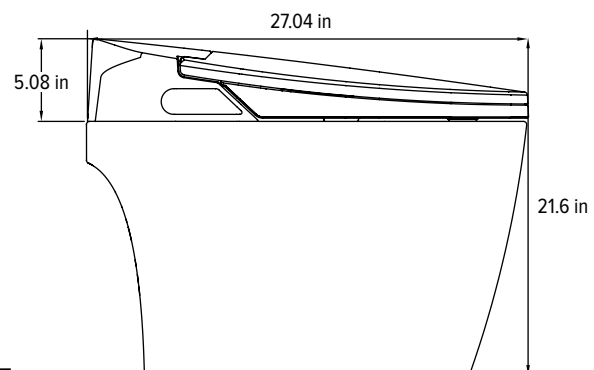

## PRODUCT INFORMATION

### Product Parts

Main unit – left side view

1. Seat Lid
2. Seat Control panel
3. Nozzle Cover
4. Heated Seat
5. LED Nightlight
6. Seat Sensor
7. Floor Bolt Cover (on ceramic bowl)

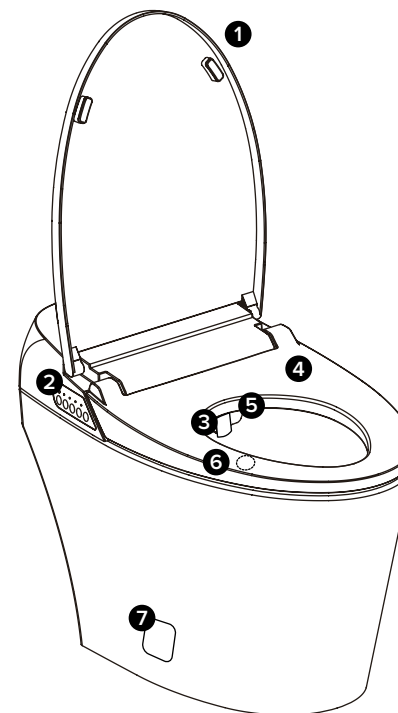

Main unit – right side view

8. Warm Air Dryer Outlet
9. Manual Flush Buttons
10. Deodorizer Vent
11. Nozzle

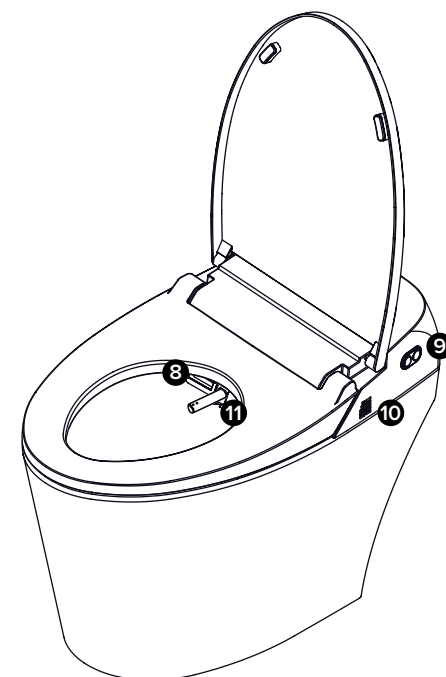

## PRODUCT INSTALLATION

### Installation Parts

#### Included Parts

- |  |                                    |
|--|------------------------------------|
| 1. Mesh Filter                             | 10. Washer                         |
| 2. Brass Adapter                           | 11. Nut                            |
| 3. 3/4" Water Supply Transfer Hose (Short) | 12. Remote Control with Wall Mount |
| 4. 1/2" Water Supply Line Hose (Long)      | 13. AAA batteries (3)              |
| 5. Seat Anchor (2)                         |                                    |
| 6. Seat Screw and Washer (2)               |                                    |
| 7. Rubber Anchor Cap (2)                   |                                    |
| 8. Plastic Anchor Bolt                     |                                    |
| 9. Rubber Cone Washer                      |                                    |

The following are pre-installed on the toilet bowl and are not shown:

14. Rim jet supply line  
15. Flush jet supply line

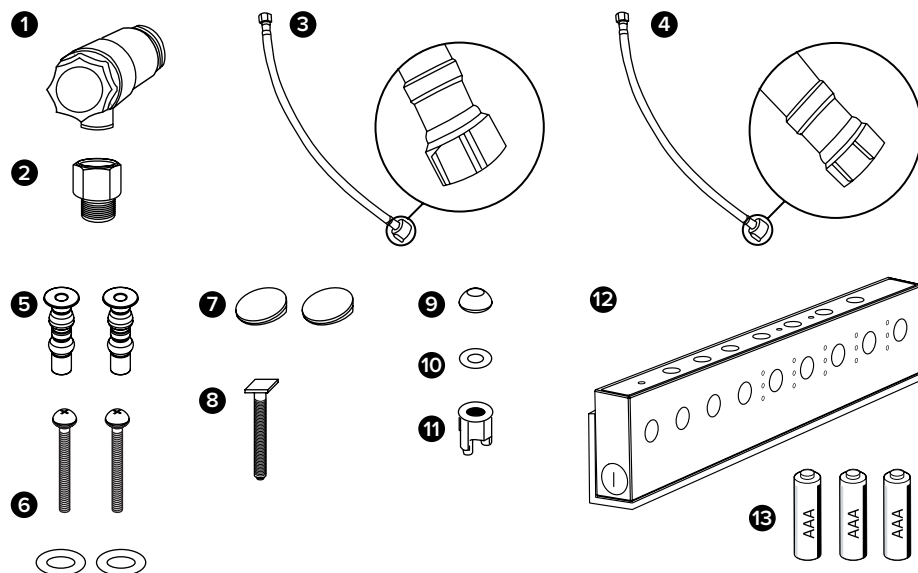

#### Required Installation Parts & Tools (Not Included)

- |   |  |
|---|--|
| 1. 7/16" slip joint angle stop (wall valve) with compression nut removed to expose 1/2" MIP threads   | 4. Open ended wrench that fits toilet bowl mounting nuts |
| 2. GFCI receptacle (wired in wall and tested)   | 5. Adjustable wrench                                     |
| 3. Toilet Installation Kit – with bowl to flange gasket (waxless ring is recommended although a ring may be used) and pair of 2 1/2" long toilet bowl mounting bolts/nuts | 6. #2 Phillips screwdriver                               |

## PRODUCT INSTALLATION

### Before Installation

**IMPORTANT NOTE:** Please read through this entire list of instructions and take inventory of included parts before beginning installation. If you have any questions at all, please call Customer Service at 1-888-542-3355 before you begin your installation.

Before unpacking this product, ensure rough-in dimensions are as follows:

- The centerline of the floor drain is to be 12" from the finished back wall. Do not include the thickness of any baseboard molding when taking this measurement.
- The centerline of the angle stop (wall valve) is to be 8" above the finished floor and 6" to the left of the centerline of the floor drain. The angle stop will need to have a 1/2" MIP thread to connect to the included supply line.

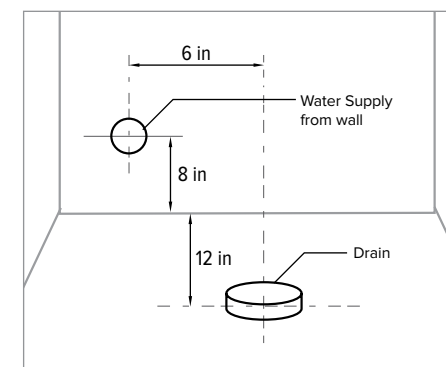

**VERY IMPORTANT:** Follow instructions in order! Connect hoses and attach seat top to bowl BEFORE putting down the bowl.

**NOTE:** An electrical outlet near the toilet is needed to provide power. Ensure that the skirt of the toilet does not interfere with the water supply point. Due to the complexity of the product, a plumber is recommended for installation.

## PRODUCT INSTALLATION

# Preparing the Ceramic Bowl

1. Separate the Brass Hose / Filter Adapter from the ½" Main Water Supply Line Hose and set aside to be used later in "Installing the Bidet Seat" section.
  - a. Screw and hand-tighten the water supply line hose to the water supply valve at the wall.
  - b. Open the angle stop and allow the water to flow into the floor drain for 60 seconds. **DO NOT SKIP THIS STEP!** Construction debris in the pipes will clog the unit's filter. This applies to new construction as well. Turn off valve and remove supply line when complete.

**HIGHLY RECOMMENDED:** You will likely need to buy a waxless gasket kit (recommended) or wax ring kit, complete with 2 ½" – 3 ½" bolts, to install with the best possible results. Your existing mounting hardware will likely be too old or damaged to properly and effectively accommodate the installation of your integrated bidet.

2. Insert toilet mounting bolts (not supplied) into the drain flange.
  - a. Position waxless gasket (recommended) on the floor flange. If a traditional wax ring is used, affix to the bottom of the toilet bowl.
3. Unbox the Bowl. Viewing from the back, there are two factory installed braided Stainless-Steel Water Line Hoses. One leads to the front of the bowl and operates the Bowl Flush Jet (left hose); the other leads to the rim and operates the Rim Jet (right hose).

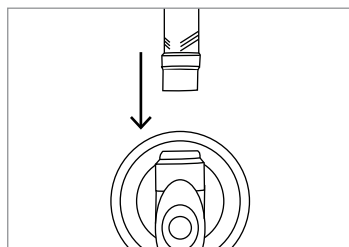

Step 1a

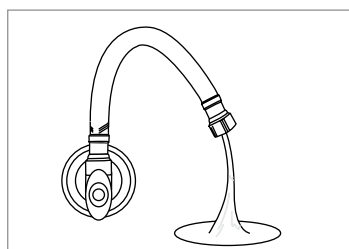

Step 1b

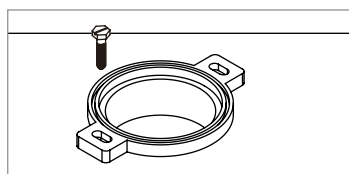

Step 2

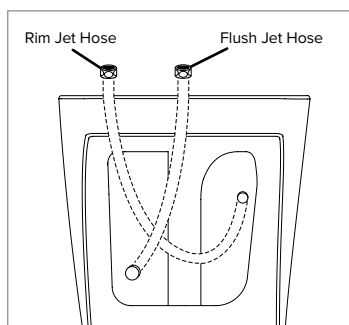

Step 3

4. Install Rubber Seat Anchors (included) in Bowl Deck Holes by inserting the narrow side and pushing down.
5. Unbox the Bidet Seat and the rest of the bowl. Prop the bidet seat onto of the bowl where the plastic hose connections on the bottom of the seat are visible and accessible.
  - a. Hand-tighten the ½" rim jet water supply line to the ½" plastic inlet on the left bottom side of the seat. Make sure the hoses are connected to the seat **WITHIN** the frame and cavity of the bowl.

**NOTE:** Supply line hoses will cross over each other.

- b. Hand-tighten the ½" bowl flush jet water supply line to the ½" plastic inlet on the right bottom side of the seat. Make sure the hoses are connected to the seat **WITHIN** the frame and cavity of the bowl.

**NOTE:** Supply line hoses will cross over each other.

- c. Hand-tighten the ¾" Water Supply Transfer Hose (included) to the center ¾" inlet, leaving the opposite hanging inside the rear cavity of the bowl.
- d. Using an adjustable wrench, **GENTLY** tighten each connection. **DO NOT OVERTIGHTEN AS THE PLASTIC THREADS OF THE INLET WILL BE DAMAGED AND LEAK.**

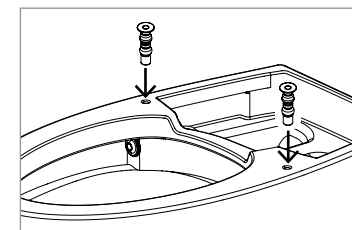

Step 4

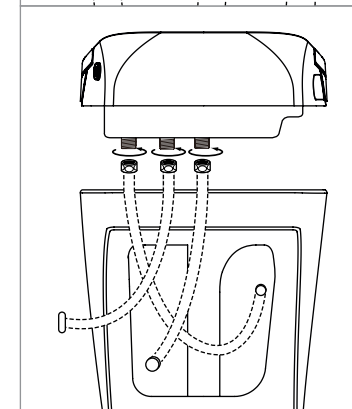
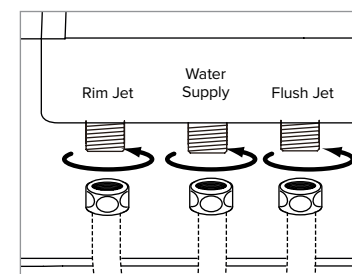

Step 5a – 5c



## PRODUCT INSTALLATION

### Installing the Bidet Seat

#### (Step 5 continued)

- e. Unscrew bolt assembly of Plastic Anchor Bolt (included) and insert the flat, square top of bolt into the open channel under the rear of the seat.
- f. Align seat with anchors and rear deck mounting hole. Affix the seat to the bowl by screwing the bolts and washers into the front anchors, then screw the plastic nut and washer into the plastic anchor bolt on the back end of the seat.
- g. Insert rubber caps to cover the screwheads in the front screw recesses.

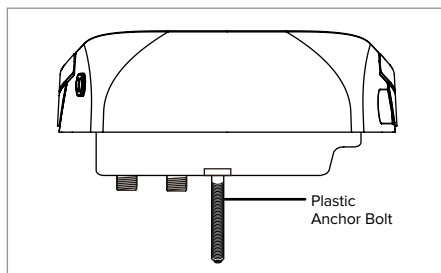

Step 5e

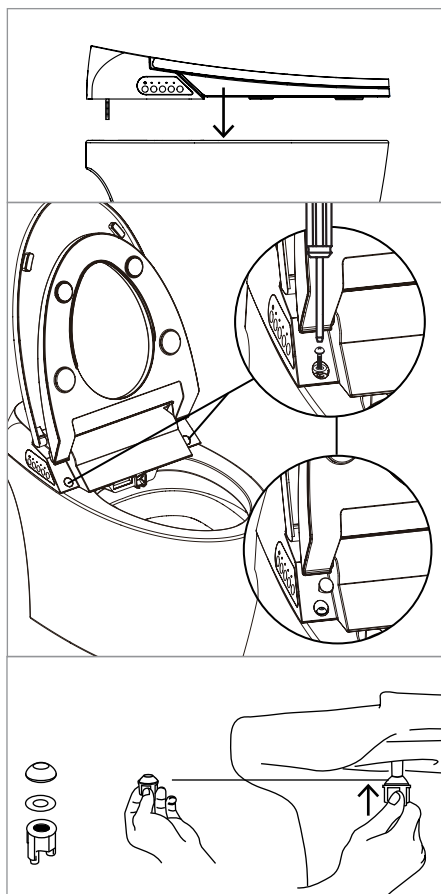

Step 5f - 5g

## PRODUCT INSTALLATION

### Installing the Mesh Filter

6. Hand-tighten  $\frac{1}{2}$ " brass adapter, that was originally set aside, to the Mesh Filter (both included).
  - a. Hand-tighten filter to  $\frac{3}{4}$ " water supply transfer hose. Using an adaptable wrench, GENTLY tighten each connection. DO NOT OVERTIGHTEN AS THE PLASTIC THREADS OF THE INLET WILL BE DAMAGED AND LEAK.
7. Hand-tighten  $\frac{1}{2}$ " main water supply line hose to the  $\frac{1}{2}$ " brass adapter.
  - a. Using a wrench (or channel locking pliers), secure the brass hose / filter adapter to prevent over-tightening the plastic filter threads. Tighten the  $\frac{1}{2}$ " main water supply line with a second wrench.

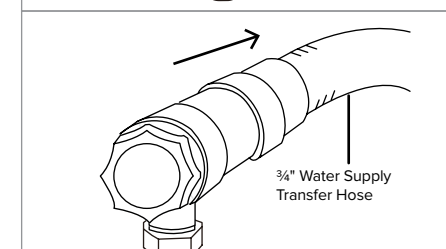
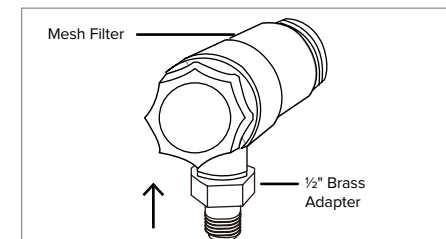

Step 6

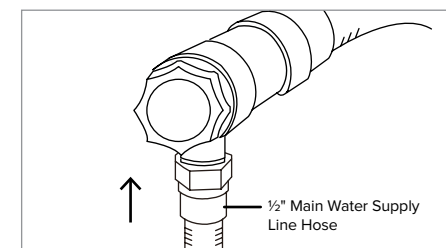

Step 7

## PRODUCT INSTALLATION

### Installing the Assembled Main Unit

**HIGHLY RECOMMENDED:** Use two or more people to complete step 8, as the bowl is very heavy and can be difficult to maneuver properly.

8. GENTLY align bowl over drain flange, guiding mounting bolts through the mounting holes in the base of the bowl.
9. Thread bolt nuts onto bolts through the circular openings on either end side of the bowl and hand-tighten.
  - a. Once hand-tightened, use a wrench to tighten further. **DO NOT OVER-TIGHTEN.** You will risk cracking the ceramic. Tighten alternately as follows: Left nut = ½ a turn; Right nut = ½ a turn; Left nut = ½ a turn, Right nut = ½ a turn; then STOP.
  - b. Snap in Cover Tiles over the circular openings on both sides of the bowl.
10. Hand-tighten the ½" main water supply line to the fresh water valve at the wall. Use a wrench to fully tighten. Ensure the line is not kinked or awkwardly bent.
11. Turn on water and check for leaks.
12. Plug unit into GFCI outlet.

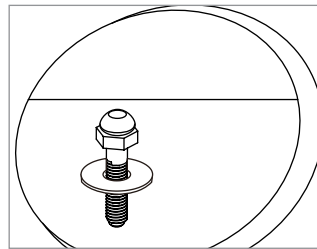

Step 9

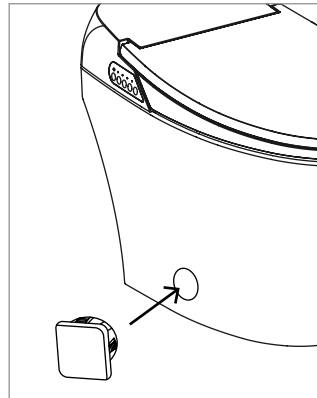

Step 10

## PRODUCT INSTALLATION

### Remote Installation

#### 1. Battery Installation

- a. Locate the circular battery compartment cover on the left side of the Remote.
- b. Using the edge of a small coin, insert into the groove and twist counterclockwise to open.
- c. Insert three AAA batteries (included) with the positive (+) position facing downwards.
- d. Replace battery compartment cover.
- e. Using the edge of the coin, apply pressure and twist clockwise to close securely.
- f. To confirm the batteries are installed correctly, press and release the DRY button. One of the vertical LED lights will illuminate.

#### IMPORTANT BATTERY INFORMATION

- Always purchase the correct size and grade of battery most suitable for the intended use.
- Clean the battery contacts and also those of the device prior to battery installation.
- Remove batteries from equipment which is not to be used for an extended period of time.
- Remove batteries if consumed or if product is to be left unused for a long time.

#### 2. Mount Remote (optional)

- a. Identify a location in the bathroom for the remote control that is visible and reachable from the toilet.
- b. Use the included mounting screws OR peel off the double-stick tape on the back of the wall mount and press firmly to the wall to ensure that it does not fall and damage the remote control.

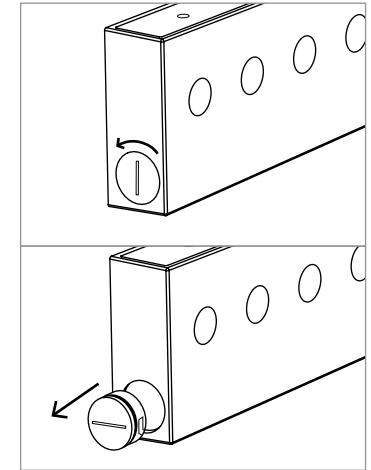

Step 1b

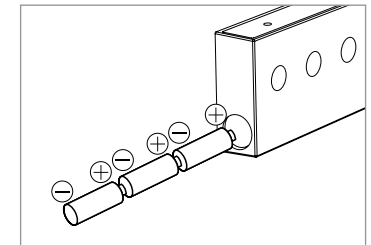

Step 1c

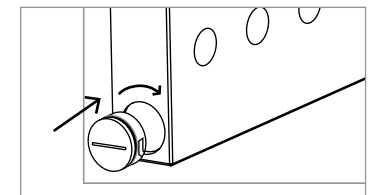

Step 1e

# Remote Control Functions

## Remote Control Front

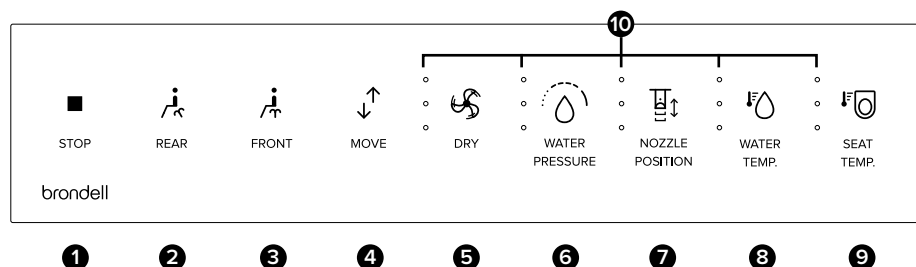

## Remote Control Top



### 1. Stop Button

Press to stop all operating functions, except "Sterilization".

### 2. Rear Wash Button

Press once to initiate a two-minute rear wash.

### 3. Front Wash Button

Press once to initiate a two-minute front wash.

### 4. Move Button

Press to initiate nozzle oscillation (repetitive forward and backward nozzle movement) during either the Front or Rear Wash. Press again to stop.

### 5. Warm Air Dry Button

Press once to initiate a two-minute warm air dry cycle. Press again to adjust three dryer settings (low, med, high).

### 6. Water Pressure Button

Press for three adjustable water pressures during wash. If you choose not to adjust, it will default to the last used setting.

### 7. Nozzle Position Button

Press to adjust the nozzle position forward and backward during a wash cycle.

### 8. Water Temperature Button

Press to adjust the outgoing water temperature to one of four settings (Low: 34 °C / 93.2 °F, Medium: 37 °C / 98.6 °F, High: 40 °C / 104 °F, and OFF). It will default to the last used setting.

### 9. Seat Temperature

Press to adjust the outgoing seat temperature to one of four settings (Low: 35 °C / 95 °F, Medium: 38 °C / 100.4 °F, High: 40 °C / 104 °F, and OFF). It will default to the last used setting.

### 10. LED Indicator Lights

These lights indicate the Dry Temperature, Water Pressure, Nozzle Position, Water Temperature, and Seat Temperature settings.

### 11. Battery Life Indicator

This indicator will light up when the batteries are low. See page 16 on how to install and replace the batteries.

### 12. User Preset Buttons

To save user presets, set water pressure, temperature, nozzle position, dryer temperature, and seat temperature to the desired settings, then hold the User 1 button for four seconds to save. A long beep will sound once settings are saved. Repeat for User 2.

To activate user presets, quickly press and release the desired user preset button. A short beep will sound when the user preset is activated. Then, select your wash.

### 13. Auto Mode Button

Press this button once to initiate a ninety-second rear wash cycle followed by a two-minute dry cycle. See page 22 for more information.

### 14. Massage Button

Pressing this button while a wash is running enables the water to repeatedly increase and decrease in pressure in a pulsating pattern. Press again to stop.

### 15. Deodorizer Button

Press this button to activate a one-minute Deodorizer cycle. See page 22 for optional Auto Deodorizer Mode activation.

### 16. Flush Button

Press this button at the top of the remote to activate the flush. See page 22 for optional Auto Flush activation.

### 17. Sterilization Button

Press this button to sterilize the water flow path from inside and the surface of the nozzle. To stop sterilization, press the Power and Stop buttons on the auxiliary control panel simultaneously for four seconds. See page 29 for maintenance information.

## Auxiliary Control Functions

### Auxiliary Control Panel Functions

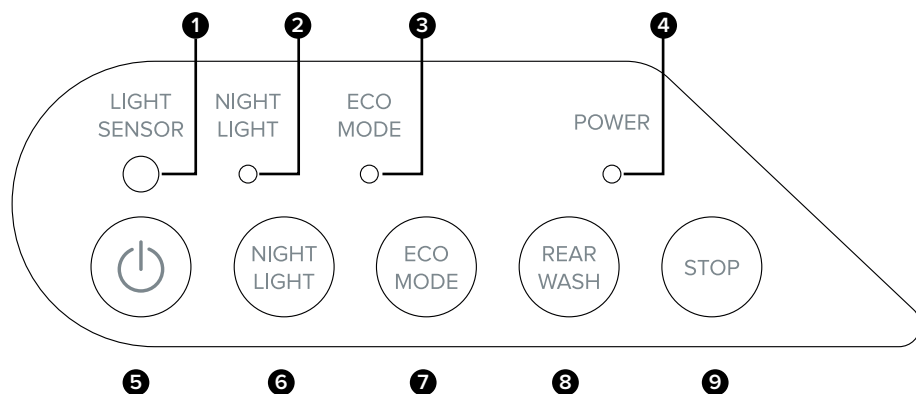

#### 1. Light Sensor

This sensor detects the amount of surrounding light and activates the Night Light. If the room is dark, the night light will automatically turn on. If the room is light, the night light will automatically turn off.

#### 2. Night Light Indicator

This indicator is illuminated when the Night Light is set.

#### 3. Eco Mode Indicator

This indicator is illuminated when the Eco Mode is set.

#### 4. Power On Indicator

This indicator is illuminated when the Power is turned on.

#### 5. Power ON/OFF Button

Press this button to turn the unit on and off.

#### 6. Night Light Button

Press this button to activate and de-activate the light sensor.

#### 7. Eco Mode Button

Press this button to turn Eco Mode on and off. See page 23 for more details.

#### 8. Rear Wash Button

Press this button to initiate the Rear Wash cycle. Press Stop button to stop wash.

#### 9. Stop Button

Press this button to stop functions currently operating.

## Using the Integrated Bidet

**NOTE:** The integrated bidet has a built in seat sensor. Wash functions will not work unless the sensor in the seat detects someone sitting down. To override the Seat Sensor, please see the instructions on Page 24.

### Prepare For Wash

Sit on the seat to ensure skin-to-seat contact on the Seat Sensor. Once contact is made, the seat will automatically:

1. Give an audible beep letting you know the Seat Sensor has been engaged.
2. Initiate a bowl-cleaning pre-rinse to prepare for use.
3. If the bidet was set to Eco Mode, the seat temperature will rise to the set temperature settings.

### Warm Water Wash

When ready to wash, press the Rear Wash or Front Wash button on the remote control one time to initiate a wash. The nozzle will self-clean, extend into the toilet bowl, spray for two minutes, turn off automatically, retract, and self-clean once again.

1. While washing, users can adjust the water temperature, pressure, and nozzle position settings, as well as initiate the Massage feature.
2. If you would like to stop the wash before the two-minute cycle ends, press the Stop button to discontinue water flow.

### Warm Air Dryer Function

Press the Dry button to activate the warm air dryer. The dryer will run for two minutes and turn off automatically.

1. While the air dryer is operating, users can adjust the dryer temperature to a comfortable level by pressing the Dry button repeatedly to select Low, Medium, or High temperature. The temperature will be illuminated on the three indicator LED lights of the remote.
2. To stop the dryer before the two minutes has elapsed, press the Stop button.

### Deodorizer

Press the Deodorizer button on the top of the remote to activate for a one-minute cycle. Press the Stop button to turn the deodorizer off. For optional Auto Deodorizer Mode function, see page 22.

**NOTE:** The deodorizer will not function during any wash or dry cycle.

## Auto, Eco Functions and Options

### Auto Mode

Press the Auto Mode button to initiate a ninety-second Rear Wash with the following preset parameters:

- Seat Temperature set to Medium
- Move (nozzle oscillation) turned on
- Water Pressure set to Level 2
- Water Temperature set to Medium

After the wash cycle is completed, Auto Mode will initiate a two-minute Warm Air Dry cycle on Level 2.

**NOTE:** All wash and dry settings are adjustable, while the Auto Mode wash cycle is running, to suit your preferences.

### Auto Deodorizer Mode

To turn on Auto Deodorizer Mode, press the Deodorizer button for two seconds. This activates continuous deodorization when the seat is occupied. When the seat becomes unoccupied, the deodorizing feature will continue to run for one minute before turning off. To turn off Auto Deodorizer Mode, press the Deodorizer button for two seconds. This will revert back to manual activation and you will need to press the Deodorizer button to activate the cycle.

### Auto Flush

The integrated bidet is factory defaulted with the Auto Flush feature. The toilet will flush automatically when it detects a user has vacated the seat after five seconds or more.

To turn off Auto Flush Mode, press and hold the Flush button on the remote for at least four seconds, then release. The unit should no longer flush automatically.

To turn on Auto Flush from manual flush, press and hold the Flush button for at least four seconds, then release.

In the event of a power outage, Auto Flush will not operate and you will need to flush manually. See below for instructions on how to flush manually.

## Auto, Eco Functions and Options

### Manual Flush Options

On the top of the remote, press the Flush button to activate the flush. This method is functional regardless of the Auto Flush settings.

**TIP:** You will need to firmly press the buttons to activate the flush and rim wash.

In the event of a power outage or remote malfunction, the flush control can be activated using the flush buttons located on the left side of the seat when seated on the toilet. Follow these steps to manually flush the toilet:

1. Hold Button 1 for four seconds to activate a rim wash.
2. Hold Button 2 for four seconds to activate siphon jet to clear waste.
3. Then, hold Button 1 for an additional four seconds to activate a second rim wash to refill the bowl.

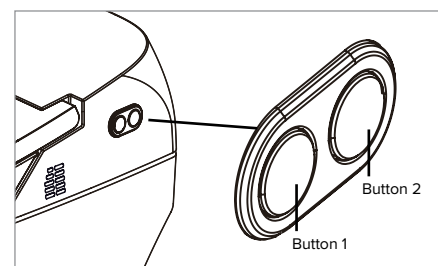

### Eco Mode

In Eco Mode, the seat temperature will be heated to 30 °C / 86 °F when the bidet is not in use. Once a person sits on the seat, it will revert to the last temperature setting used. To select this option, press and release the Eco Mode button located on the Auxiliary Control Panel on the right side of the seat.

## Special Mode Operations

### Seat Sensor

The Seat Sensor is activated at the factory by default. Completing the following steps will bypass the seat sensor located in the seat and allows the wash functions and dry functions to operate without the sensor being engaged. Use caution in this mode.

1. Unplug the integrated bidet from the outlet.
2. Press and hold the Eco Mode and Rear Wash buttons on the auxiliary control panel, and plug it back in while continuing to hold the two buttons down.
3. You'll hear one beep once it has been plugged back in. Keep holding the Eco Mode and Rear Wash buttons down until you hear a second beep (about five seconds later).
4. The second beep indicates that the Seat Sensor has been overridden.
5. To reactivate the Seat Sensor, repeat steps 1 – 3.

### Activating / Deactivating Silent Mode

By default, the integrated bidet will beep to confirm commands from the remote control and auxiliary control panel. Follow the steps below to silence the beeping sounds.

1. Press and hold the Night Light and Rear Wash buttons on the auxiliary control panel.
2. A beep will sound, indicating that Silent Mode has been activated.
3. To deactivate Silent Mode, repeat steps 1 and 2.

## Adjusting the Remote Control Frequency

It may be necessary to adjust the remote frequency channel in homes where two or more units are installed in close proximity. If two units are being activated by a single remote, follow the steps below to adjust the frequency on one remote.

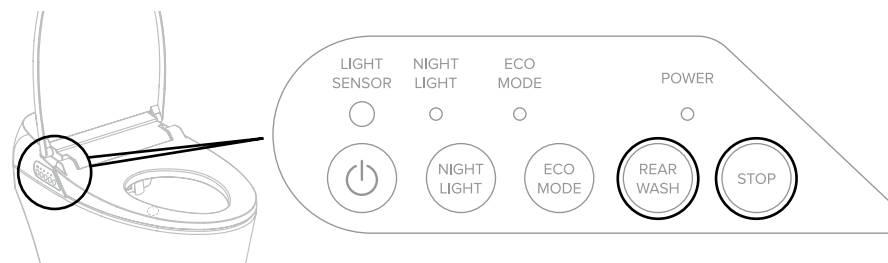

1. Turn the unit off and unplug the power cord.
2. Locate the control panel on the side of the seat.
3. Press and hold Rear Wash and Stop buttons simultaneously.
4. Continue to hold Rear Wash and Stop while plugging the power cord back in and hold
5. The Power On LED light should start flashing and you should hear a repeating beep sound, at which point you can release the Rear Wash and Stop buttons on the side panel.

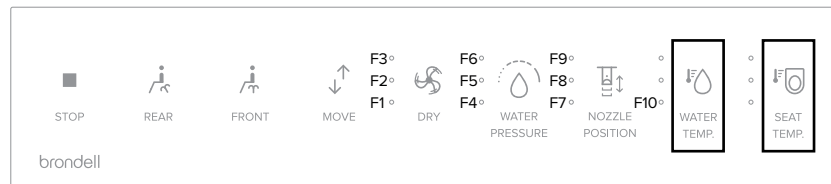

6. On the remote control, press and hold Water Temp and Seat Temp buttons simultaneously for four seconds. After four seconds, one of the LED lights from F1 to F10 will flash to indicate the current frequency channel (see picture above).
7. To change the frequency channel, press the Water Temp button to change between F1 to F10. The LED light should move on the remote which indicates the change to the next channel. You can select any of the frequency channels below except for channel F1, which is the default channel.
8. Press the Stop button on the remote control to set the channel choice.
9. Make sure each unit in your household is set to a different channel.

# TECHNICAL INFORMATION

## Product Specifications

BRONDELL INTEGRATED BIDET TOILET	
Power Voltage	120 V, 60 Hz
Power Consumption	1460W
Power Cord Length	47 in
Water Supply Connection	Direct connection to water supply
Water Supply Pressure	22 psi – 99 psi
Water Supply Temperature	37.4 °F – 93.2 °F
Ambient Water Temperature	37.4 °F – 104 °F
Seat Dimensions	16 in x 27 in x 5 in
Seat Weight	14 lbs
Seat / Lid Weight Limit	275 lbs / 178 lbs
Mesh Filter	0.57 in diameter
Deodorizer	Catalytic Deodorizer

WARM WATER WASHING	
Rear / Front Wash Flow Rate	17.17 gal/minute; automatic nozzle self-cleaning
Standard Time	Rear Wash: 2 minute / Front Wash: 2 minute
Water Pressure Control	3 levels
Water Temperature Control	4 levels: OFF – incoming water temperature; Low – 93.2 °F; Medium – 98.6 °F; High – 104 °F
Heat Power Consumption	1400W
Safety Devices	Thermal Fuse, Thermostat, Flow Sensor

DRYER	
Dryer Temperature Control	113 °F (default)
Heater Power Consumption	200W
Safety Devices	Thermal Fuse, Bi-Metal

# TECHNICAL INFORMATION

## Product Specifications (RWT-2001G)

REMOTE	
Type of Equipment	Remote Control
Rate Power Supply	DC 4.5 (3x 1.5V AAA battery)
Operating Frequency	<b>2419</b> MHz
Modulation Type	FSK

\*This device complies with Part 15 of the FCC Rules. Operation is subject to the following conditions:

- 1) This device may not cause harmful interference, and
- 2) this device must accept any interference received, including interference that may cause undesired operation.

Meets the Americans With Disabilities Act (ADA) guidelines and ANSI A117.1 requirements for accessible building facilities. Check local codes.

## Maintenance

### Cleaning the Mesh Filter

If your integrated bidet seems to be experiencing a loss of water pressure, your mesh filter may be dirty or clogged and should be cleaned. Follow the steps below to clean the filter. If the pressure issue is not resolved after cleaning, see the Troubleshooting section at the end of this manual for other possible solutions.

- Unplug the power cord from the wall outlet.
- Close the water supply by turning the valve clockwise.
- Turn the notched end of the filter counterclockwise to open the filter housing and pull out the inner barrel filter.
- Clean the barrel filter with water and soft brush, then push back into the filter housing and close.
- Turn on the water supply by turning the valve counterclockwise.

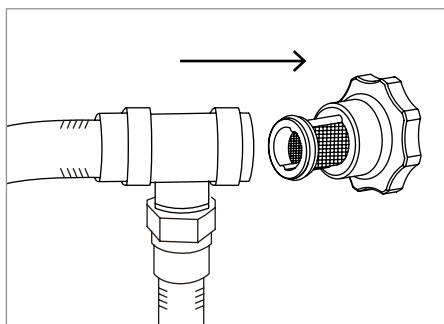

### Seat Cleaning

- ⚠ Unplug the integrated bidet from the power source before cleaning the seat.

Use a soft, damp cloth and mild cleanser (such as dish soap, Simple Green or Windex) to wipe down the seat. DO NOT scrub or use harsh, abrasive products to clean. DO NOT use thinner, benzene, acidic chemicals, chloride, or hydrochloric acid detergent. This may result in corrosion to the metal parts or discoloration or scratches to the bidet body.

**NOTE:** Be cautious of leaving home and beauty products in contact with the bidet seat, the result of which can be irreversible discoloration. Most stains can be removed using a 1:1 mix of rubbing alcohol and water and a soft cloth or towel. However, some permanent stains are the result of substances left on the seat while the seat heater was activated. Be cautious of home and beauty products (including but not limited to various hair and air freshener sprays, lotions, body wash, skin tanners, body butters, and oils) that come in contact with the seat as soon as possible. If necessary, replacement seat parts can be purchased through Brondell customer support.

### Nozzle Sterilization Mode

Press the Sterilization button on top of the remote to activate.

The blue LED light in the bowl will begin to pulsate and the auxiliary control panel lights will begin blinking, letting the user know that sterilization is in progress.

The sterilization cycle time will take three minutes to complete. During this time, there will be a water rinse and the nozzle will extend and retract. You will hear some “whirring” sounds which is normal.

Nozzle sterilization is complete when activity stops and lights turn off.

To stop the sterilization cycle while in progress, press the Power and Stop buttons on the auxiliary control panel simultaneously for four seconds.

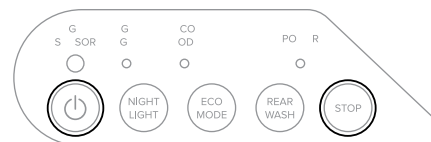

**NOTE:** The Nozzle Cleaning function will not work if the seat is occupied.

### Nozzle Cleaning (Manual)

1. Press and release the Eco Mode and Rear Wash buttons on the auxiliary control panel simultaneously. The nozzle will extend into the bowl.

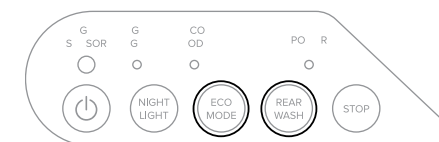

2. Gently clean the nozzle manually with a soft cloth or toothbrush.

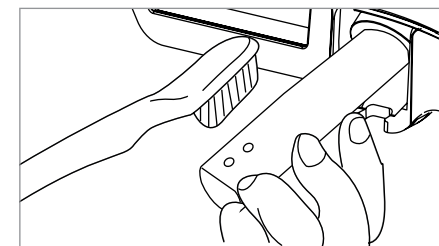

3. To retract the nozzle, press the “Stop” button on the remote control.



## Maintenance

### Cleaning the Deodorizer Mesh Strainer

The deodorizer has a mesh strainer cover that prevents dust and particles from flowing into the deodorizer filter. Over time, the strainer may get covered with dust which may affect the deodorizer's efficiency so this should be cleaned regularly.

1. Remove the strainer located under the body of the unit.
2. Using a toothbrush, gently brush or wash dust off the strainer. Be careful not to tear the mesh when brushing. If washing, dry completely before reinserting the strainer.
3. When reinserting the strainer, ensure the release tab faces the same direction as shown in the drawing.

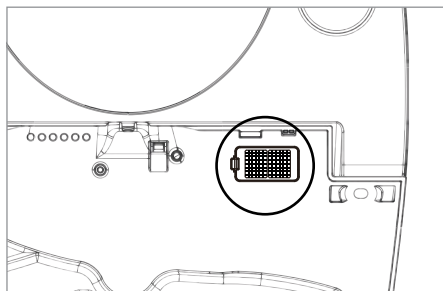

Step 1

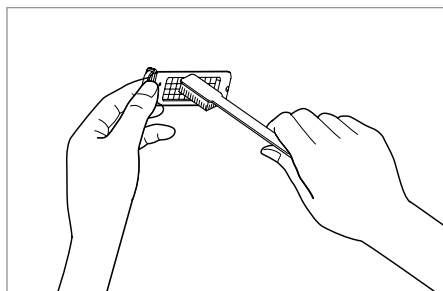

Step 2

## Troubleshooting

If the bidet appears to be operating abnormally, please review the troubleshooting tips before calling the Brondell Service Center as most issues are easily resolved with a few simple steps. If you are unable to resolve the issue after checking the following items, please call the Service Center at **888-542-3355**, Mon–Fri, 9am–5pm PST, or email us at [support@brondell.com](mailto:support@brondell.com).

### Check Before Continuing:

- Make sure the integrated bidet is connected to power and that the outlet is working properly.
  - Make sure you check & test the reset button on the GFCI outlet (Standard 120V GFCI outlet).
  - Make sure main water supply valve is open.
  - Make sure the bidet is not in Eco Mode.
  - Confirm there are no leaks from hoses or water supply.
  - Make sure mesh filter is clean and free of build up or debris (see maintenance section).
- After checking items above, refer to the following troubleshooting chart for additional solutions.

Problem	Possible Cause(s)	Solution(s)
The unit does not operate	1. Power is off	1. Press either, the Stop, Rear, Front, or Dry on / off buttons on the remote control to power the unit.
	2. Power plug is connected	2. Ensure the plug is securely connected. Check and reset GFCI outlet.
	3. There is no power to the outlet	3. Unplug the unit and plug another device into the outlet to make sure there is power.
Wash or Dry functions not working	Seat is not occupied	Most functions will not operate if the seat is not occupied. There is a sensor inside of the seat that recognizes touch. Please make sure there is nothing on the seat that could block the sensor (e.g., toilet seat cover, paper, etc.).
Remote control not working	Batteries are old or uncharged	Replace the batteries.
Water pressure is weak	1. Water pressure is set at the lowest level	1. Adjust the Water Pressure setting to a higher level.
	2. Mesh Filter is clogged	2. Clean the mesh filter (see Page 28).
	3. Tap water pressure used is under the minimum pressure suggested (1.0kgf/cm <sup>2</sup> )	3. The available water pressure is 1.5 – 7.0 kgf/cm <sup>2</sup> (22 - 99 psi).
	4. Wash cycle is being used while attempting to flush the toilet	4. Water pressure will fall while the unit is being flushed. Retry the wash cycle after the flush is complete.

## Troubleshooting

Problem	Possible Cause(s)	Solution(s)
Water is not warm	Water temperature is set to off or lowest level	Adjust the Water Temp setting to a higher level.
Seat is not warm	1. Seat temperature is set to off or lowest level	1. Adjust the Seat Temp setting to a higher level.
	2. Eco power-saving mode is activated	2. Deactivate any power-saving mode and try again after 5 minutes (see page 23).
Warm air dryer is not warm	Dry temperature is set at the lowest level	Adjust the Dry setting to a higher level.
Auto Flush does not operate	1. There is no power to the outlet.	1. Use Manual Flush in the event of a power outage. Auto Flush should function again once power is restored (see page 22 – 23).
	2. Auto Flush is deactivated.	2. Reactivate Auto Flush Mode (see page 22).
Flush does not fully flush	Water pressure is weak	Water pressure may drop when other household water supply is in use (Ex: another toilet flushing, shower, washer, etc). Wait and retry to flush.
Water flows into the bowl continuously	A power outage occurred during Auto Flush cycle	If a power outage occurs while the Auto Flush function is in use, the unit may continue to flush water. Close the water supply valve and stop use until electricity is recovered.
Water does not come out of nozzle	1. Water supply valve is closed	1. Open the water supply valve.
	2. Water supply is cut off	2. Wait until the water supply is turned on.
	3. Nozzle is dirty	3. Clean the nozzle (see page 29 – 30).
	4. Mesh filter is clogged	4. Clean the mesh filter (see page 28).
Shuts off during use	1. Power plug is disconnected	1. Ensure the plug is securely connected. Check and reset GFCI outlet.
	2. There is no power to the outlet.	2. Unplug the unit and plug another device into the outlet to make sure there is power.
Wash feature does not work or fails to spray	1. Seat sensor does not detect you are seated	1. Adjust sitting position to fully cover the Seat Sensor (see page 10).
	2. Seat sensor is deactivated	2. Refer to Special Mode Operation section to reactivate Seat Sensor (see page 24).

## Warranty



**CONTACT:**

Brondell, Inc.  
PO Box 470085  
San Francisco, CA 94147-0085

Email: [support@brondell.com](mailto:support@brondell.com)

Web: [www.brondell.com](http://www.brondell.com)

For questions, contact Brondell  
Customer Service:  
1-888-542-3355, Monday – Friday,  
9am – 5pm PST

**MANUFACTURED BY:**

Brondell, Inc.  
PO Box 470085  
San Francisco, CA 94147-0085

**Made in Korea**

**Please retain receipt records for any warranty  
claims.**

brondell®

a healthy home experience

[brondell.com](https://brondell.com)

#20SFC4150-0221

#### FCC Information to User

This equipment has been tested and found to comply with the limits for a Class B digital device, pursuant to Part 15 of the FCC Rules. These limits are designed to provide reasonable protection against harmful interference in a residential installation. This equipment generates, uses and can radiate radio frequency energy and, if not installed and used in accordance with the instructions, may cause harmful interference to radio communications. However, there is no guarantee that interference will not occur in a particular installation. If this equipment does cause harmful interference to radio or television reception, which can be determined by turning the equipment off and on, the user is encouraged to try to correct the interference by one of the following measures:

- Reorient or relocate the receiving antenna
- Increase the separation between the equipment and receiver
- Connect the equipment into an outlet on a circuit different from that to which the receiver is connected.
- Consult the dealer or an experienced radio/TV technician for help

#### Caution

Modifications not expressly approved by the party responsible for compliance could void the user's authority to operate the equipment.

FCC Compliance Information : This device complies with Part 15 of the FCC Rules. Operation is subject to the following two conditions: (1) This device may not cause harmful interference, and (2) this device must accept any interference received, including interference that may cause undesired operation.

#### RF Exposure Statement

This equipment complies with FCC radiation exposure limits set forth for an uncontrolled environment