

KULARK Voice Internet Earbuds

Thank you for choosing and using KULARK Voice Internet Earbuds.

We will teach you how to operate this Bluetooth earbuds. Before using the product, you need to know how to connect your cellphone with Bluetooth device.

The left and right earbuds of this product can be used independently (mono mode) or for pairing mode (stereo).

With stylish design, outstanding sound quality and our self-developed voice assistant, you can enjoy high-quality music anytime and anywhere.

Through voice interaction, you will have rich voice services.

User guide

1 Please follow the steps below to pair the earbuds to your cell phone.

1. Take the earbuds out from the charging box. The earbuds will automatically turn on.
2. Turn on the Bluetooth function of your cell phone to find the devices of KULARK GT101 and then click it to connect.
3. When hearing the prompt tone sounds of "dududu", it is considered the pairing mode has completed successfully.
4. After completely connected both the left and right earbuds can be used independently. The single and dual earbuds can be seamlessly switched.

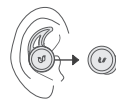
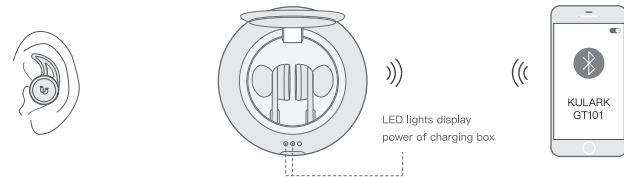

L or R

2 Remove/get in

The music will be paused when remove any left or right earbud and re-play again by putting it on.

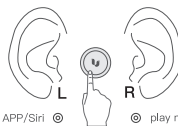

wake-up Kulark APP/Siri
answer call/hung up

L R

play next song
answer call/hung up

3 Double-click operation

Pairing Mode: Wake up voice assistant by double-click the earbud to wake up Kulark APP for android cell phone or siri for iphone.

Single earbud mode

In the Music:
Get the earbud in to play the music and remove to pause.
Double-click earbud for next song.

On the Call:
Double-click earbud to answer the call or hung-up.

Music Stopped:
Double-click earbud to wake-up the KULARK app or Siri.



L or R

4 Auto connect back and charging

Open the charging box and put the earbuds in then close the charging box, when the left and right orange light flashing at the same time, the earbuds will charge automatically. The charging is completed when the orange light on the both of left and right stopped flashing.

When using the earbuds in the next time, take it out and automatically connect back to the last connected cell phone.

When opening the charging box, white lights display power of charging box. The left orange light flashing means low power.

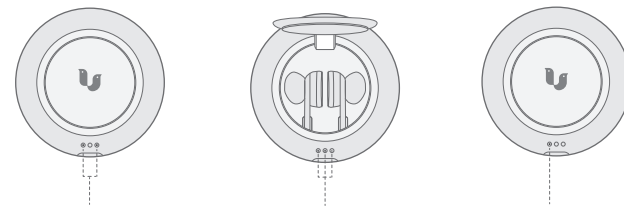

Both left and right orange lights flashing are in charging mode of earbuds.

Three white lights mean full power.

The left orange light flashing means low power of charging box

5 Other notice

1. Please ignore the current Bluetooth device stored on your cell phone, if you want to connect with a new Bluetooth device.
2. Put the earbuds into the box, re-open the box and take earbuds out of the box, the new cell phone can connect to KULARK GT101 device.

Attention notes

1. Do not put the earbuds in front of the airbag in the car which can cause serious damage when the airbag pops up.
2. Please avoid children play with the earbuds because the small parts can put the children at risk of suffocation.
3. Where the flammable and blasting or the potential explosive environments which may require users to turn off electronic equipment, please be aware of the instructions.
4. Please turn off the earbuds before boarding and do not use the earbuds in the aircraft.
4. Do not turn up the volume to protect your hearing.
5. Do not use this product for a long time in rain and wet environment.

Maintenance

1. Put the earbuds into the charging case before putting it in your pocket or handbag.
2. Do not use abrasive material to clean the earbuds.
3. Do not expose earbuds under the sunlight for a long time.
4. Do not put earbuds into the fire which can cause an explosion.
5. The earbuds should be not allowed to contact any sharp objects to avoid any scratches and abrasions.
6. Do not attempt to disassemble the earbuds, because it does not contain any repair components.
7. Keep the earbuds in a cool and dry place to avoid the extremely temperature and dust when your earbuds are not in use.
8. Charge the earbuds once a month at least for longer battery life.
9. Avoid charging your earbuds in extremely high or low temperatures.

Kulark App



Wechat Official Accounts



Guarantee

Dealer: _____

Telephone: _____

User name: _____

Telephone: _____

Address: _____

E-mail: _____

Information: _____



ShenZhen Lark Acoustics Co., Ltd.

Telephone: 4008387288

Web: www.kulark.com

San Hang Science and Technology Building, Northwestern Polytechnical University, Gaoxin South 9TH Road, Shenzhen, China.



GT101
Voice Internet
Earbuds

FCC Statement

This device complies with Part 15 of the FCC Rules. Operation is subject to the following two conditions: (1) this device may not cause harmful interference, and (2) this device must accept any interference received, including interference that may cause undesired operation.

Changes or modifications to this unit not expressly approved by the party responsible for compliance could void the user's authority to operate the equipment.

NOTE: This equipment has been tested and found to comply with the limits for a Class B digital device, pursuant to Part 15 of the FCC Rules. These limits are designed to provide reasonable protection against harmful interference in a residential installation. This equipment generates, uses and can radiate radio frequency energy and, if not installed and used in accordance with the instructions, may cause harmful interference to radio communications. However, there is no guarantee that interference will not occur in a particular installation. If this equipment does cause harmful interference to radio or television reception, which can be determined by turning the equipment off and on, the user is encouraged to try to correct the interference by one or more of the following measures:

-- Reorient or relocate the receiving antenna.

- Increase the separation between the equipment and receiver.
- Connect the equipment into an outlet on a circuit different from that to which the receiver is connected.
- Consult the dealer or an experienced radio/TV technician for help.

This device and its antenna(s) must not be co-located or operation in conjunction with any other antenna or transmitter.

The device has been evaluated to meet general RF exposure requirement. in portable exposure condition without restriction.