

**MAGNAVOX**

# **3-Piece CD Shelf System**

with Bluetooth® Wireless Technology

***OWNER'S MANUAL***

PLEASE READ BEFORE OPERATING THIS EQUIPMENT.

**MODEL:MM444BT**

# IMPORTANT SAFETY INSTRUCTIONS



**WARNING:**  
TO REDUCE THE RISK OF FIRE OR ELECTRIC SHOCK, DO NOT EXPOSE THIS PRODUCT TO RAIN OR MOISTURE.

**WARNING:**  
TO REDUCE THE RISK OF FIRE OR ELECTRIC SHOCK, AND ANNOYING INTERFERENCE, USE THE RECOMMENDED ACCESSORIES ONLY.



The lightning flash with arrowhead symbol within an equilateral triangle is intended to alert the user to the presence of uninsulated dangerous voltage within the product's enclosure that may be of sufficient magnitude to constitute a risk of electric shock to persons.



The exclamation point within an equilateral triangle is intended to alert the user to the presence of important operating and maintenance (servicing) instructions in the literature accompanying the appliance.

## FCC NOTICE:

This equipment has been tested and found to comply with the limits for a Class B digital device, pursuant to part 15 of the FCC Rules. These limits are designed to provide reasonable protection against harmful interference in a residential installation. This equipment generates, uses and can radiate radio frequency energy and, if not installed and used in accordance with the instructions, may cause harmful interference to radio communications.

However, there is no guarantee that interference will not occur in a particular installation. If this equipment does cause harmful interference to radio or television reception, which can be determined by turning the equipment off and on, the user is encouraged to try to correct the interference by one or more of the following measures:

- Reorient or relocate the receiving antenna.
- Increase the separation between the equipment and receiver.
- Connect the equipment into an outlet on a circuit different from that to which the receiver is connected.
- Consult the dealer or an experienced radio/TV technician for help.

## FCC WARNING:

To assure continued compliance, follow the attached installation instructions and use only shielded cables when connecting to other devices. Modifications not authorized by the manufacturer may void user's authority to operate this device.

**Warning:** Changes or modifications to this unit not expressly approved by the party responsible for compliance could void the user's authority to operate the equipment.

The product as required by IEC 60825-1 second edition 2007-03. Complies with 21 CFR 1040.10 and 1040.11 except for deviations pursuant to Laser Notice No .50, dated June 24, 2007

This equipment complies with FCC radiation exposure limits set forth for an uncontrolled environment. This equipment should be installed and operated with minimum distance 20cm between the radiator & your body.

# IMPORTANT SAFETY INSTRUCTIONS

Before using the unit, be sure to read all operating instructions carefully. Please note that these are general precautions and may not pertain to your unit. For example, this unit may not have the capability to be connected to an outdoor antenna.

- 1) **Read these instructions.**  
All the safety and operating instructions should be read before the product is operated.
- 2) **Keep these instructions.**  
The safety and operating instructions should be retained for future reference.
- 3) **Heed all warnings.**  
All warnings on the product and in the operating instructions should be adhered to.
- 4) **Follow all instructions.**  
All operating and use instructions should be followed.
- 5) **Do not use this apparatus near water.**  
Do not use this product near water and moisture, for example: near a bathtub, washbowl, kitchen sink or laundry tub; in a wet basement; or near a swimming pool.
- 6) **Clean only with dry cloth.**  
Unplug this product from the wall outlet before cleaning. Do not use liquid cleaners or aerosol cleaners. Use a dry cloth for cleaning.
- 7) **Do not block any ventilation openings. Install in accordance with the manufacturer's instructions.**  
Slots and openings in the cabinet and in the back or bottom are provided for ventilation, to ensure reliable operation of the product and to protect it from overheating. These openings must not be blocked or covered. The openings should never be blocked by placing the product on a bed, sofa, rug or other similar surface. This product should never be placed near or over a radiator or heat source. This product should not be placed in a built-in installation such as a bookcase or rack unless proper ventilation is provided or the manufacturer's instructions have been adhered to.
- 8) **Do not install near any heat sources such as radiators, heat registers, stoves, or other apparatus (including amplifiers) that produce heat.**
- 9) **Do not defeat the safety purpose of the polarized or grounding-type plug. A polarized plug has two blades with one wider than the other. A grounding type plug has two blades and a third grounding prong. The wide blade or the third prong are provided for your safety. If the provided plug does not fit into your outlet, consult an electrician for replacement of the obsolete outlet.**
- 10) **Protect the power cord from being walked on or pinched particularly at plugs, convenience receptacles, and the point where they exit from the apparatus.**
- 11) **Only use attachments/accessories specified by the manufacturer.**
- 12) **Use only with the cart, stand, tripod, bracket, or table specified by the manufacturer, or sold with the apparatus. When a cart is used, use caution when moving the cart/apparatus combination to avoid injury from tip-over.**

An appliance and cart combination should be moved with care. Quick stop, excessive force and uneven surfaces may cause the appliance and cart combination to overturn.



- 13) **Unplug this apparatus during lightning storms or when unused for long periods of time.**  
To protect your product from a lightning storm, or when it is left unattended and unused for long periods of time, unplug it from the wall outlet and disconnect the antenna or cable system. This will prevent damage to the product due to lightning and power-line surges.
- 14) **Refer all servicing to qualified service personnel. Servicing is required when the apparatus has been damaged in any way, such as power-supply cord or plug is damaged, liquid has been spilled or objects have fallen into the apparatus, the apparatus has been exposed to rain or moisture does not operate normally, or has been dropped.**
- 15) **Power source**  
This product should be operated only from the type of power source indicated on the marking label. If you are not sure of the type of power supply to your home, consult your appliance dealer or local power company. For products intended to operate from battery power, or other source, refer to the operation instructions.
- 16) **Power lines**  
An outside antenna system should not be located in the vicinity of overhead power lines or other electric light or power circuits, or where it can fall into such power lines or circuits. When installing an outside antenna system, extreme care should be taken to keep from touching such power lines or circuits as contact with them might be fatal.

# IMPORTANT SAFETY INSTRUCTIONS

**17) Overloading**

Do not overload wall outlets and extension cords as this can result in a risk of fire or electric shock.

**18) Object and liquid entry**

Never push objects of any kind into the product through openings as they may touch dangerous voltage points or short out parts that could result in fire or electric shock. Never spill or spray any type of liquid on the product.

**19) Outdoor antenna grounding**

If an outside antenna is connected to the product, be sure the antenna system is grounded so as to provide some protection against voltage surges and built up static charges. Section 810 of the National Electric Code ANSI/NFPA 70 provides information with respect to proper grounding of the mast and supporting structure, grounding of the lead-in wire to an antenna discharge product, size of grounding conductors, location of antenna-discharge product, connection to grounding electrodes and requirements for the grounding electrodes.

EXAMPLE OF ANTENNA GROUNDING AS PER NATIONAL ELECTRICAL CODE

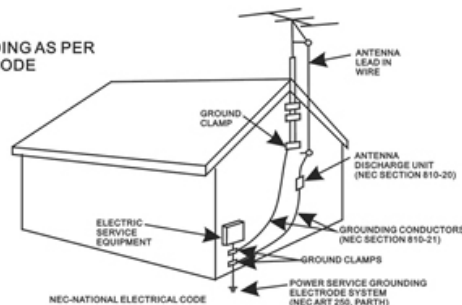

**20) Service**

Do not attempt to service this product yourself as opening or removing covers may expose you to dangerous voltage or other hazards. Refer all servicing to qualified service personnel.

**21) Replacement parts**

When replacement parts are required, be sure the service technician uses replacement parts specified by the manufacturer or those that have the same characteristics as the original parts.

Unauthorized substitutions may result in fire or electric shock or other hazards.

**22) Safety check**

Upon completion of any service or repairs to this product, ask the service technician to perform safety checks to determine that the product is in proper operation condition.

**23) Wall or ceiling mounting**

The product should be mounted to a wall or ceiling only as recommended by the manufacturer.

**24) Damage requiring service**

Unplug this product from the wall outlet and refer service to qualified service personnel under the following conditions.

- a) When the power-supply cord or plug is damaged.
- b) If liquid has been spilled or objects have fallen into the product.
- c) If the product has been exposed to rain or water.
- d) If the product does not operate normally by following the operating instructions. Adjust only those controls that are covered by the operating instructions, as an adjustment of other controls may result in damage and will require extensive work by a qualified technician to restore the product to its normal operation.
- e) If the product has been dropped or the cabinet has been damaged.
- f) When the product exhibits a distinct change in performance—this indicates a need for service.

**25) Note to CATV System Installer**

This reminder is provided to call the CATV system installer's attention to Article 820-40 of the NEC that provides guidelines for proper grounding and in particular, specifies that the grounding system of the building, as close to the point of cable entry as practical.

**Note:**

Refer all servicing to qualified service personnel. Servicing is required when the unit has been damaged in any way such as the following: the power-supply cord or plug has been damaged, liquid has been spilled into the unit, the unit has been exposed to rain or moisture, the unit has been dropped or the unit does not operate normally.

# CARE AND MAINTENANCE

## Caring for Compact Discs

- Treat the disc carefully. Handle the disc only by its edges. Never allow your fingers to come in contact with the shiny, unprinted side of the compact disc.
- Do not attach adhesive tape, stickers, etc. to the compact disc label.
- Clean the compact disc periodically with a soft, lint-free, dry cloth. Never use detergents or abrasive cleaners to clean the compact disc. If necessary, use a CD cleaning kit.
- If a compact disc skips or gets stuck on a section of the compact disc, it is probably dirty or damaged (scratched).
- When cleaning the compact disc, wipe in straight lines from the centre of the compact disc to the outer edge of the compact disc. Never wipe in circular motions.

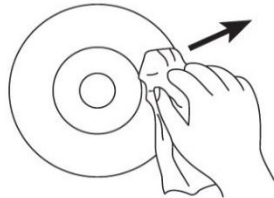
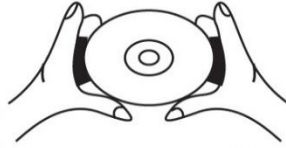

- This unit is designed to play only compact discs bearing the identification logo as shown here. Other discs may not conform to the CD standard and may not play properly.
- Compact Discs should be stored in their cases after each use to avoid damage.
- Do not expose compact discs to direct sunlight, high humidity, high temperatures or dust, etc. Prolonged exposure or extreme temperatures can warp the disc.
- Do not stick or write anything on either side of the disc. Sharp writing instruments, or the ink, may damage the surface.



## Cleaning the Unit

- To prevent fire or shock hazard, disconnect your unit from the AC power source when cleaning.
- The finish on your unit may be cleaned with a dust cloth and cared for as other furniture. Use caution when cleaning and wiping the plastic parts.
- Mild soap and a damp cloth may be used on the front panel.

# Welcome

Congratulations on purchasing this Flat CD Micro System. You can now listen to your CD's, Bluetooth and FM radio.

## You should have

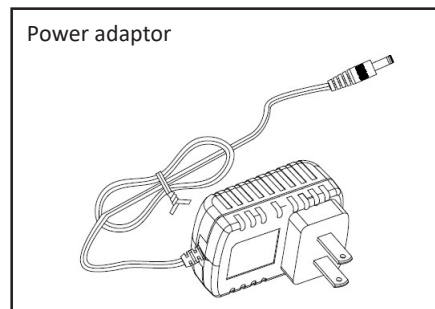
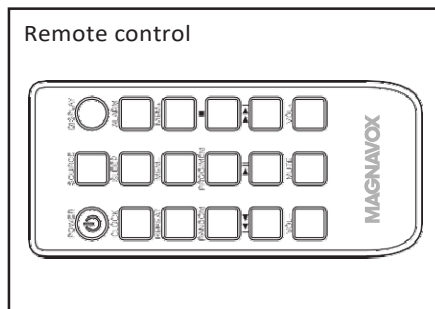
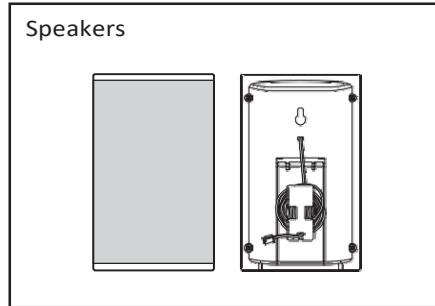
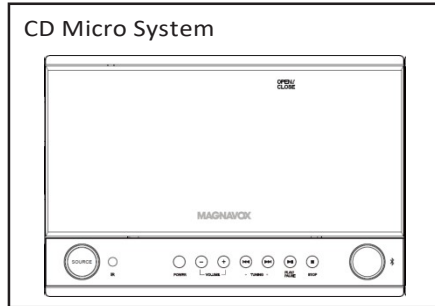

## Your Flat CD Micro System

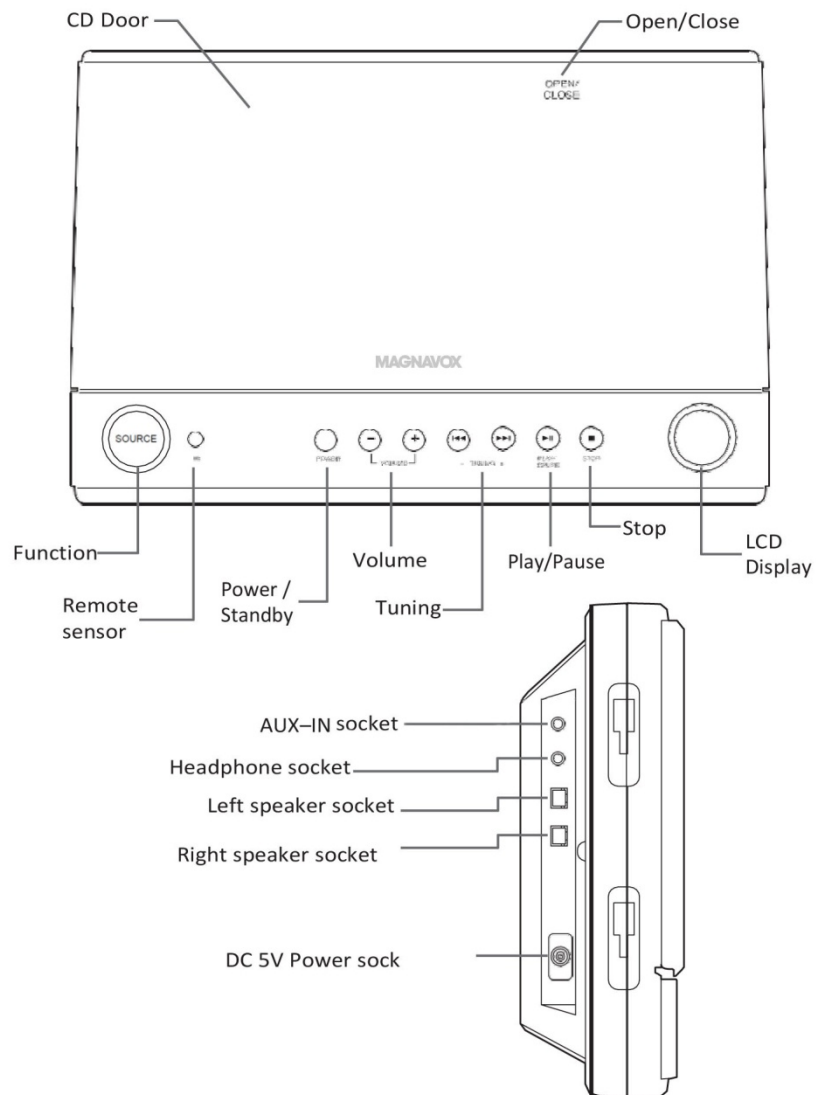



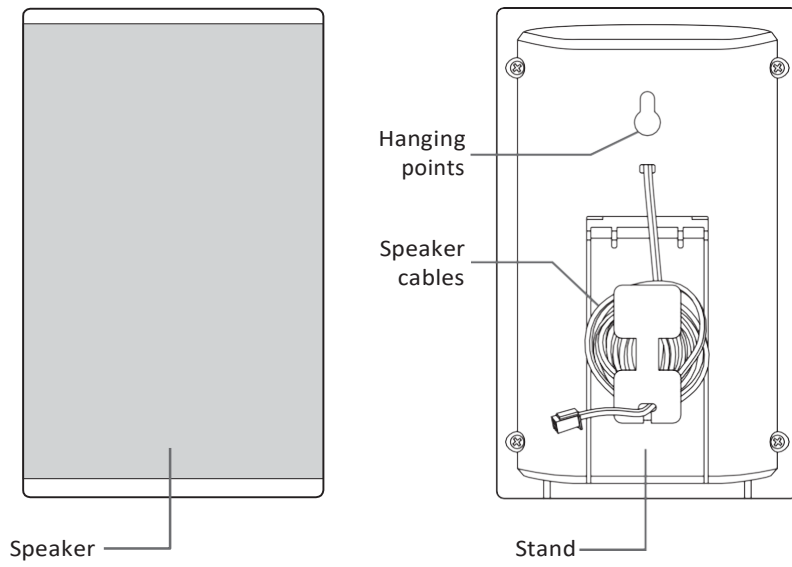
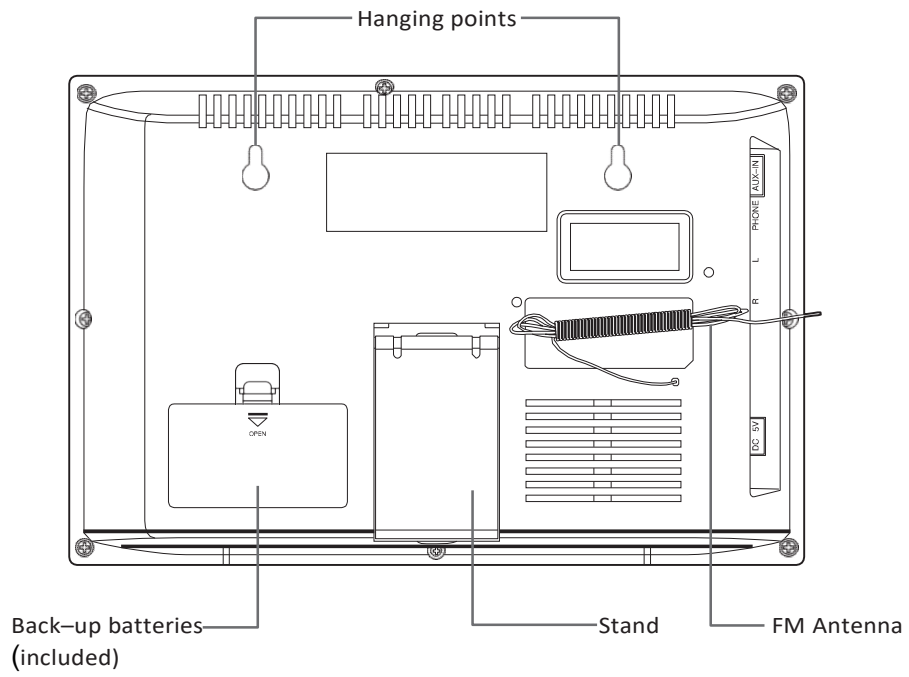

## Preparing the remote control

**IMPORTANT:** The remote control will work within a 6m range; however, this may be impossible if there are obstacles between the unit and the control. If the remote control is used near other devices which generate infrared rays then it may not operate properly and may interfere with other devices.

### For first time use:

The unit has a pre-installed lithium CR2025 battery (included). Remove the protective tab to activate the remote control battery.

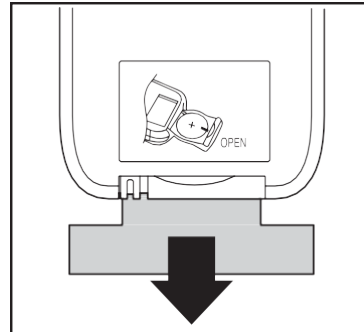

### To replace the remote control battery:

1. Push the switch at the side of the battery tray towards the tray **(A)**.
2. Now slide the battery tray out of the remote control **(B)**.
3. Remove the old battery.
4. Place a new CR2025 battery into the battery tray with the correct polarity (+/-) as indicated.
5. Slide the battery tray back into the slot in the remote control.

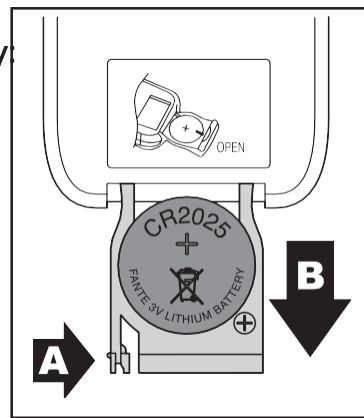

### Important battery information:

- When the remote control is not used for a long time (more than a month), remove the battery to prevent it from leaking.
- If the batteries do leak, wipe away the leakage inside the battery compartment and replace the batteries with new ones.
- Do not use any batteries other than those specified.
- Do not heat or disassemble batteries. Never throw them in fire or water.
- Do not carry or store batteries with other metallic objects. Doing so could cause batteries to short circuit, leak or explode.
- Never recharge a battery unless it is a rechargeable type.

## Recognising the remote control buttons

**POWER:** Switches the Flat CD Micro System ON or into the STANDBY mode.

**SOURCE:** Press to select between Radio, CD and AUX-IN.

**DISPLAY:** Press to view the time when your Flat CD Micro System is turned on.

**CLOCK:** Press to start setting the time on the LCD display clock.

**SLEEP:** Press to set the amount of time before your FLAT CD Micro System turns its self off.

**ALARM:** Press to start setting the alarm on your Flat CD Micro System.

**REPEAT:** Press to repeat songs when in CD mode.

**MEM-:** Press to scroll through saved tracks or radio stations in FM condition

**MEM+:** Press to scroll through saved tracks or radio stations in FM condition

**RANDOM:** Press to play random tracks in CD mode

**PROG/MEM:** Press to open the Program or Memory functions

**I◀◀:** Used to skip to previous audio track (*CD mode only*).

**▶II:** Used to start or pause audio tracks (*CD mode only*).

**▶▶I:** Used to skip to next audio track (*CD mode only*).

**VOL-:** Press to turn the volume down.

**MUTE:** Press to turn the volume off and on.

**VOL+:** Press to turn the volume up.

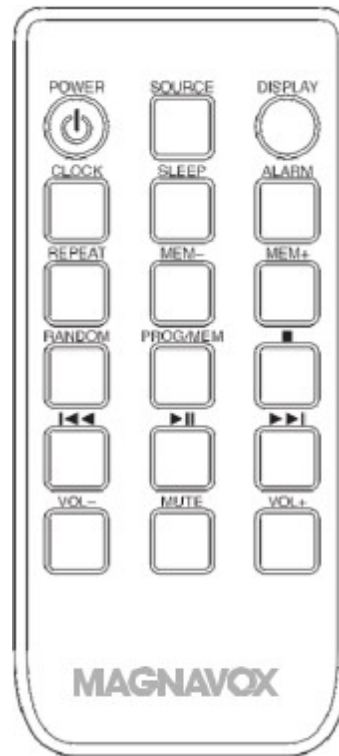

## Fitting the back-up batteries(included)

Backup batteries prevent your CD Micro System from losing all the saved information in the event of a power cut. It is recommended that you fit the batteries.

Push the catch on the battery compartment cover in the direction of the arrow shown.

You will now be able to lift the cover off.

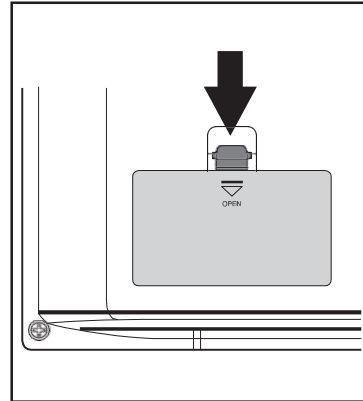

Slot the two AA type batteries into the battery compartment following the directions in the battery compartment.

Ensure the + & - on the batteries are correctly aligned with the marks in the battery compartment.

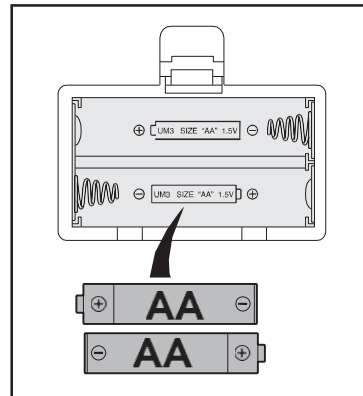

Slot the tabs on the top of the battery compartment cover into the slots in the top of the battery compartment.

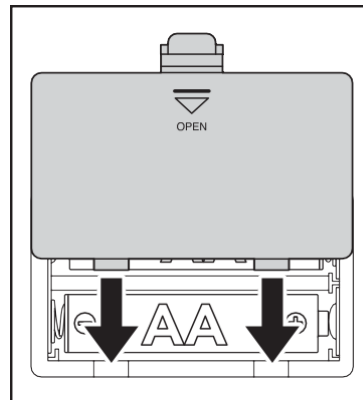

# Setting up your Flat CD Micro System

## Connecting the power

**Warning:** Ensure your power supply voltage corresponds to the voltage printed on the underside of the unit.

1. Slot the jack on the power adaptor into the power socket in the side of your Flat CD Micro System.
2. Slot the plug on the power adaptor into a wall socket.
3. Switch on at the plug, the unit is now in the standby mode.

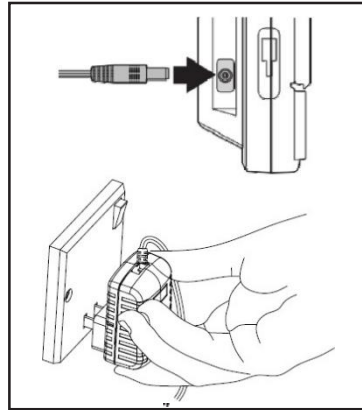

## Setting up the FM aerial

Unwind the coiled FM aerial at the back of your Flat CD Micro System.

**IMPORTANT:** You may need to adjust the position of the FM aerial when tuning the radio to receive the strongest signal.

**IMPORTANT:** Never leave the aerial where it can be pulled by young children.

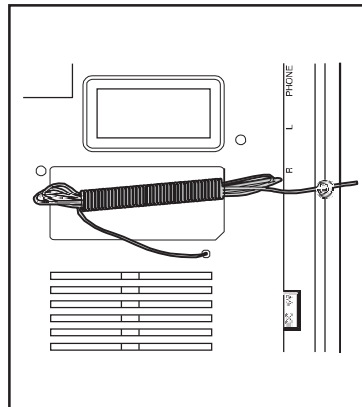

## Connecting the speakers

First check that the speakers are on the correct sides of the Flat CD Micro system.

The connection tabs on the sides of the speakers must align with the slots on the sides of the Flat CD Micro system

Unwind the cables on the backs of the speakers.

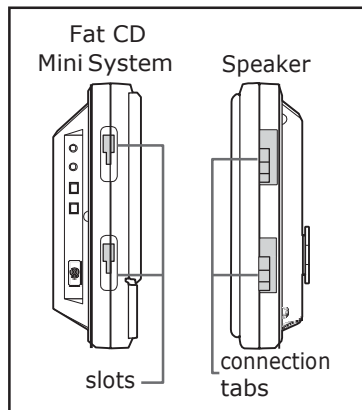

1. Slot the end of the cable on the left speaker into the left speaker socket on the side of the Flat CD Micro System.
2. Slot the end of the cable on the right speaker into the right speaker socket on the side of the Flat CD Micro System.

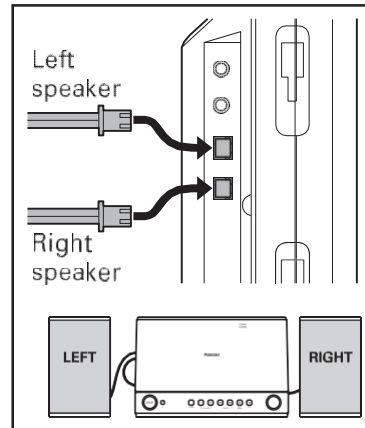

### Setting the clock

With the Flat CD Micro System in standby mode.

Press the **CLOCK** button on the remote control. The hour digits will now flash.

Press the **◀◀** or **▶▶** buttons to set the hour, press the **CLOCK** button again and the minutes will flash.

Press the **◀◀** or **▶▶** buttons to set the minutes. Press the **CLOCK** button to finish the clock setup.

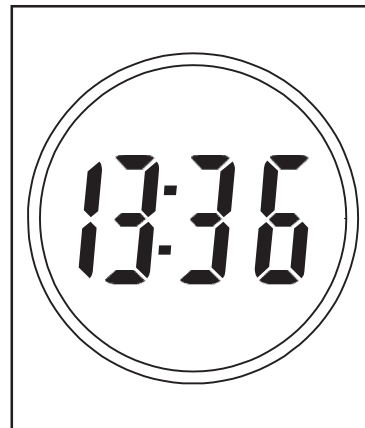

### Turning the CD Micro System ON or OFF

Press the **POWER** button on the Flat CD Micro System to turn the unit **ON** or **OFF** (*standby mode*). You can also press the **POWER** button on the remote control.

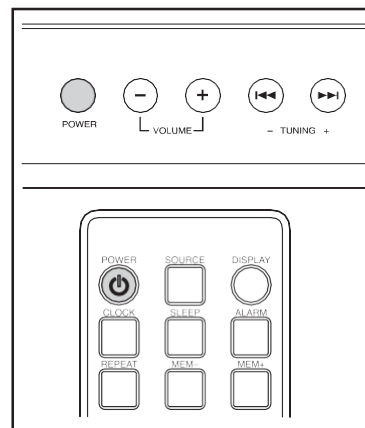

## Positioning your Flat CD Micro System

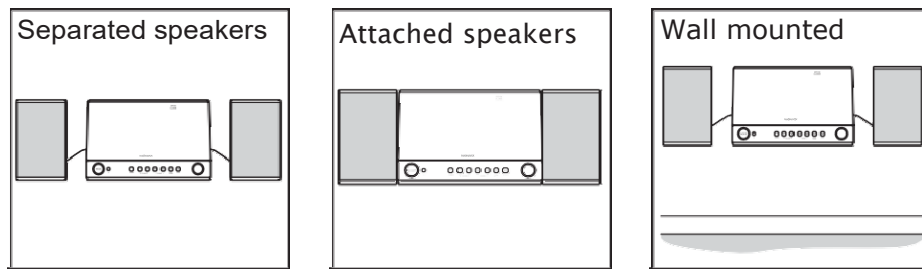

**Separated speakers:** Using this method the speakers can be separated and placed where you want them. You have already completed all assembly require see below to for how to use the stands.

**Attached speakers:** You can attached the speakers to the sides of the Flat CD Micro System, see page 12.

**Wall mounted:** You can wall mount your Flat CD Micro System with either the speakers attached or unattached. See page 13 on how to wall mount your Flat CD Micro System.

## Using the stands

There are stands on the backs of the two speakers and the Flat CD Micro System.

These are used when the Flat CD Micro System is placed on a flat surface.

To use the stands, simply pull the bottoms of the stands out of there housings and stand the speakers and Flat CD Micro System on a flat level surface.

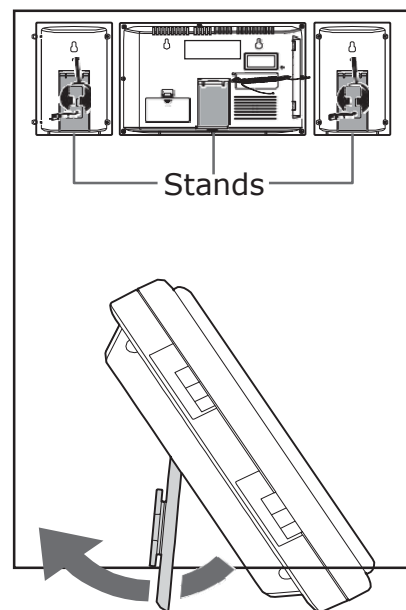

## Attaching the speakers

Place a small screwdriver against the bottom edge of the attachment tabs in the sides of the speakers, push them upwards and outwards until fully extended

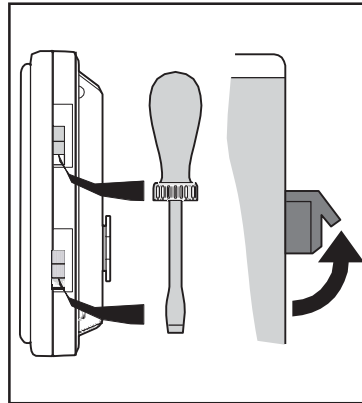

Slot the attachment tabs on the sides of the speakers into the slots in the sides of the Flat CD Micro System.

Push the speakers down until the speakers lock on to the sides of the Flat CD Micro System.

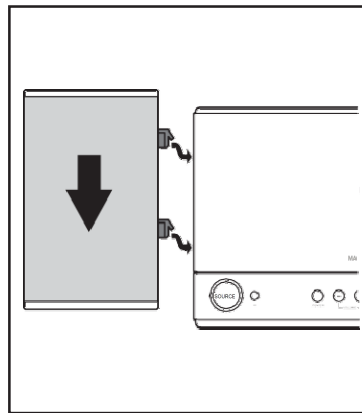

If you want to detach the speakers, simply push them upwards off the Flat CD Micro System.

The attachment tabs will automatically retract back into the sides of the speakers.

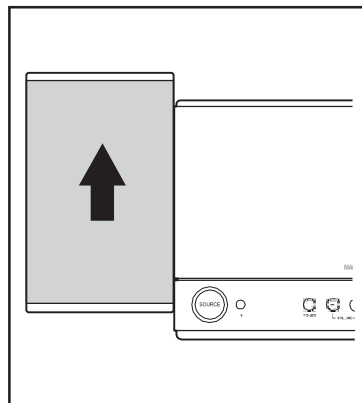



## Wall mounting

**WARNING:** Before attempting to fit the Flat CD Micro System to the wall, if you are in any way unsure about how or where to fit the Flat CD Micro System you should employ a qualified person to install the Flat CD Micro System.

**IMPORTANT:** There are no fittings supplied with your Flat CD Micro System. Please ensure that any fittings are correct for the wall you will be hanging your Flat CD Micro System on. Please consult a professional for advice before drilling any holes if you are in any doubt.

**Important:** These instructions show how to hang the Flat CD Micro System with the speakers attached. You can also hang the speakers impenitently from the Flat CD Micro System. You will need two extra fittings to do this and will have to drill two extra holes.

1. Mark the position on the wall that you want the Flat CD Micro System to be fitted to.
2. The distance between the two mounting points is 120 mm. Ensure the two points are level using a spirit level (**A**).
3. Drill 2 parallel holes (*the size of the drill will depend on the fittings you are using*) in the wall. The distance between the holes must be 120 mm (**B**).
4. Tighten the screws into the holes in the wall. The screw heads must be no larger than 8 mm and no smaller than 6 mm. Ensure that at least 3 mm of the screw is protruding from the wall so that it can be inserted into the hanging points in the back of your Flat CD Micro System (**C**).

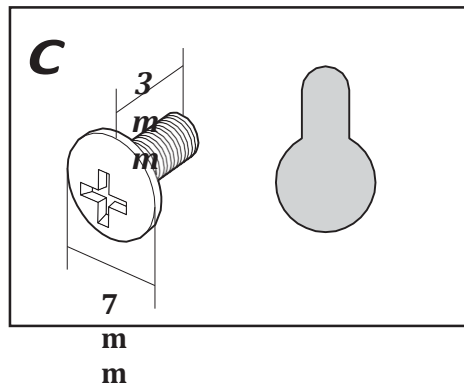
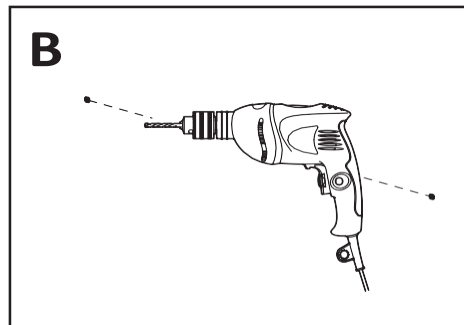
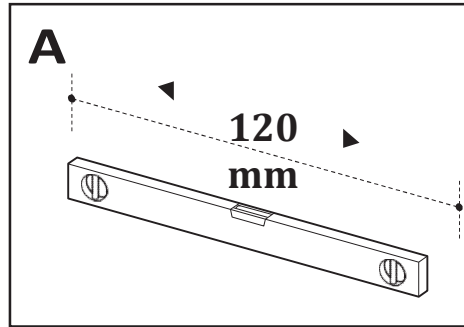

# Using your Flat CD Micro System

## Basic use

- 1. How to adjust the volume:** During use press the **VOL+** or **VOL-** buttons on the remote control or Flat CD Micro System to increase or decrease the volume.
- 2. How to mute the sound:** During play you can press the **MUTE** button on the remote control to turn off or restore the sound.
- 3. Setting the sleep timer:** Press the **SLEEP** button on the remote control repeatedly to select between 90 - 80 - 70 - 60 - 50 - 40 - 30 - 20 - 10 - off minutes before your Flat CD Micro System switches to standby mode. If off is selected the sleep timer is switched off.
- 2.** Press the **OPEN/CLOSE** section on the front of the Flat CD Micro System player to open the front.
- 3.** Place the CD onto the spindle with the printed side facing upwards. Close the disk drawer by pushing the disc door closed.
- 4.** The CD player will now read the disc, this will take a few seconds.  
**Once the disk has been read, press "play/pause" button and CD player will start play track one.**

## How to select input source

Press the **SOURCE** button on either the remote control or the **MODE** button on the Flat CD Micro System to select between CD, FM Radio or AUX-IN.

**CD:** Select for listening to CD's.

**FM:** Select to access the FM radio tuner so you can listen to the radio.

**AUX-IN:** Select if you have an external audio device attached to your Flat CD Micro System.

## Using the CD player

- 1.** Press the **SOURCE** button on either the remote control or the **MODE** button on the Flat CD Micro System to select CD.
- 2.** Press the **OPEN/CLOSE** section on the front of the Flat CD Micro System player to open the front.
- 3.** Place the CD onto the spindle with the printed side facing upwards. Close the disk drawer by pushing the disc door closed.
- 4.** The CD player will now read the disc, this will take a few seconds.  
**Once the disk has been read, press "play/pause" button and CD player will start play track one.**

## Play back features

**Selecting a track:** Press the **I◀◀ / ▶▶I** buttons on the remote control or Flat CD Micro System player to skip forwards or backwards through the tracks on the CD.

**Pausing/Playing:** Press the **▶II** on the remote control or Flat CD Micro System to pause play then press again to start play.

**Stopping playback:** Press the **■** on the remote control, or the **■ STOP** button on the Flat CD Micro System.

**Random playback:** Press the **RANDOM** button on the remote control to play the tracks in a random order.

**Repeat:** Press the **REPEAT** button on the remote control once to repeat the song playing, twice to repeat all tracks and again to switch the repeat off.

## Using the program feature

1. Once the CD has started to play, press the **■** button on the CD player.
1. Press the **PROG/MEM** button on the remote control.
2. Now select the track you want to play first using the **I◀◀ / ▶▶I** buttons.
3. Press the **PROG/MEM** button again to confirm selection
4. Repeat steps 1, 2 & 3 until you have all the tracks in the order you want to listen to them in.
5. Press the **▶II** to play the tracks in the order you have selected.

## Using the FM radio

1. Press the **SOURCE** button on either the remote control or the **MODE** button on the Flat CD Micro System to select FM radio mode.
2. Tune the radio automatically to the next strongest signal by pressing and holding the **I◀◀** or **▶▶I** buttons on the remote control or the **-TUNING +** buttons on the Flat CD Micro System for a few seconds.
3. You can fine tune the radio station by pressing and releasing the **I◀◀** or **▶▶I** buttons on the remote control or the **-TUNING +** buttons on the Flat CD Micro System.

## Using the program feature

You can save **2** FM radio stations to the internal memory of your Flat CD Micro System.

1. Press the **PROG/MEM** button on the remote control.
2. Now select the number you want to save the radio station to using the **MEM -** or **MEM +** buttons.
3. Press the **PROG/MEM** button again to confirm selection
4. Repeat steps 1, 2 & 3 until you have all the tracks in the order you want to listen to them in.

## Recalling a saved radio station

Use the **MEM -** or **MEM +** buttons to scroll through the saved stations. The radio will automatically retune to the station saved to the selected number.

## Using the AUX mode

You can connect an external audio device to your Flat CD Micro System using a 3.5mm audio cable.

1. Press the **SOURCE** button on either the remote control or the **MODE** button on the Flat CD Micro System to select AUX mode.
2. Connect one end of the audio cable to the AUX-OUT socket or headphone socket on the device.
3. Connect the other end of the audio cable to the AUX-IN socket on the side of the Flat CD Micro System.
4. You can now play audio from the attached device through the speakers of your Flat CD Micro System.

## Using the BT (Bluetooth):

The first time you use the unit or pair it to a new Bluetooth Device, pair it as follows:

1. Power on the unit from standby mode and enter to BT (Bluetooth) mode as previously instructed. "bt" will appear on the display and blink.
2. Power on the external BT Device and enter to BT searching mode. Start pairing following on screen instructions from the external BT Device. After pairing, the "bt" on the display will stop blinking.
3. Plays the music in the paired BT Device as usual.
4. During playback:
  - Press the Button on the unit or Remote Control to pause: press again to resume normal playback.
  - Press the TUNE +/- or TUNE -/ Buttons on the unit or the Buttons on the Remote Control to skip tracks.

### Notes:

- When the external Bluetooth Device searched the unit, our model number "CM444 BT" will appear on the display of external Bluetooth Device.
- Pairing code "0000" or "1234" may need to enter.

Normal operation after pairing:

1. Power on the external BT Device and enter to BT mode.
2. Power on the unit from standby mode and enter to BT (Bluetooth) mode as previously instructed. "bt" will appear on the display and blink.
3. Wait a few seconds until the unit is auto paired to the external BT Device, "bt" on display will stop blinking.
4. Plays the music in the paired BT Device as usual

# Troubleshooting

Problems	Cause(s)	Solution
<b>No power</b>	The appliance is not correctly plugged in or the power is not turned on at the socket. The fuse in the plug has blown.	Ensure the plug is correctly fitted and the power is turned on. Change the fuse in the plug.
<b>There is no sound or the sound is distorted.</b>	The audio cables are not correctly fitted. The volume is set to the minimal level.	Check the audio cables are correctly fitted in the back of the appliance. Turn the volume up.
<b>Unable to play a CD.</b>	The CD has been placed in the CD tray the wrong way up. The disk is not compatible with the appliance. The disc is dirty.	Turn the disc over and try again. You will not be able to play this CD on this appliance. Clean the disc.
<b>The buttons on the appliance do not work.</b>	Static electricity is interfering with the appliance.	Switch the unit off and remove the plug. Leave the appliance for a few minutes, then slot the plug into the power socket and turn the power back on.
<b>The remote control does not work</b>	The batteries in the remote control are flat. The remote control is not pointing at the sensor on the appliance. The remote control is out of the operational range of the appliance. The appliance is in Standby mode.	Install 2 new AA batteries. Ensure the remote control is pointing at the sensor on the appliance. Ensure the remote control is within range of the appliance. Press the power button on the appliance or remote control to turn it on.

## Technical Specification

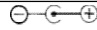
Power Source:	DC 5, 1A, Center positive 
Clock Back Up:	2 x 1.5 "AA" battery (included)
Power source of AC/DC Adaptor:	AC 100-240V~50/60Hz 0.4A
Output of the AC/DC Adaptor:	DC 5V, 1A, Center positive 
Radio Band Coverage:	FM 87.5 - 108 MHz
Audio Power:	1.8W per Channel
Impedence of Speakers:	8 Ohm; 3W x 2
BT version:	5.0
BT Operation Distance:	≥32 Feet in opera area

## Accessories:

- 1 x Instruction booklet
- 1 x AC/DC Adaptor
- 1x Remote Control (Uses 1 x CR2025 Button Cell, included)

SPECIFICATIONS AND ACCESSORIES ARE SUBJECT TO CHANGE  
WITHOUT NOTICE

