

STEERING WHEEL TRIM ADJUSTMENT

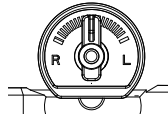

F

If the vehicle cannot go forward in a straight line you may need adjust the steering wheel trim. The steering wheel trim manual adjuster can be found on the bottom (underside) of the truck (SEE DIAGRAM F). From time to time you will need to adjust the steering trim.

WARNING

DO NOT USE CAR IN INCLIMATE WEATHER!



TROUBLESHOOTING

Before sending your car in for repair, please check for a solution below.

Problem	Possible Cause(s)	Solution
Car will not move.	Weak batteries; no batteries	Install new batteries in remote control and recharge the car battery.
Car does not respond properly to remote control.	Car and remote not synced properly Another RC car may be transmitting on the same radio frequency	Refer to sync section and re-sync your car and remote. Move to a new location where no other RC cars are present.
Car loses connection to remote control.	Using car in a small enclosed area Using car indoors Low batteries in transmitter or vehicle	Move outdoors to a large open area. Install new batteries in remote control or recharge your car.
Car battery has fully charged, but slower than normal.	Driving car for too long at high speeds, causing motor to overheat	Turn car off for 10-15 minutes.

SAFETY WARNINGS!

- Improper use of batteries may lead to overheating, breakage or leaking.
- Do not mix old and new batteries.
- Do not mix different battery brands.
- Install batteries with correct polarity. The flat side (negative terminal) of the battery should rest against the spring.
- Remove dead batteries immediately.
- Avoid liquids, which can short circuit the batteries.
- The truck or remote will become unresponsive when batteries are low, at which point you should replace all batteries with new ones.
- Remove the batteries if you will not use the truck for a long time.
- Avoid using near furniture or glass to prevent damage to these objects.
- Do not play on roads.
- Do not play in crowded areas to avoid injury or damage. Choose a safe location away from traffic.
- Do not use truck during a storm or when lightning or thunder are present.
- Do not use in a wet, sandy or muddy environment as truck may become damaged.
- Do not modify or attempt to replace the built-in original antenna on the remote or truck. Doing so will damage the set and affect operation.
- Do not pull on any wires that are part of the truck. Such action may cause the wires to break and the truck to malfunction.
- Keep fingers, hair and clothes away from the truck's spinning tires. Failure to do so may result in physical injury.
- Never aim the truck at other people.
- Do not throw the truck or purposely hit it with any object.
- Store truck in a cool environment, away from high-temperature sources such as fires, stoves, radiators, etc.
- This truck has no user-serviceable parts. Do not attempt to modify components or circuit board.

FCC Part 15 C Notice

CAUTION: Changes or modifications not expressly approved by the party responsible for compliance could void the user's authority to operate the equipment.

NOTE: This equipment has been tested and found to comply with the limits for a Class B digital device, pursuant to Part 15 of the FCC Rules. These limits are designed to provide reasonable protection against harmful interference in a residential installation. This equipment generates, uses and can radiate radio frequency energy and, if not installed and used in accordance with the instructions, may cause harmful interference to radio communications. However, there is no guarantee that interference will not occur in a particular installation. If this equipment does cause harmful interference to radio or television reception, which can be determined by turning the equipment off and on, the user is encouraged to try to correct the interference by one or more of the following measures:

- Reorient or relocate the receiving antenna.
- Increase the separation between the equipment and receiver.
- Connect the equipment into an outlet on a circuit different from that to which the receiver is connected.
- Consult the dealer or experienced radio/TV technician for help.

This device complies with Part 15 of the FCC Rules. Operation is subject to the following two conditions: (1) this device may not cause harmful interference, and (2) this device must accept any interference received, including interference that may cause undesired operation.



Conforms to safety requirements of FCC, ASTM and CPSIA.

SAVAGE™ II is the registered trademark of AMAX Group
AMAX Group USA Address: 12645 Memorial Dr Suite F1 #388 Houston, TX 77024
All Rights Reserved. visit us at www.amaxbrands.com

Made in China
C002S-USA-V1.0

SAVAGE II

ALL-TERRAIN RC RACER



INSTRUCTION MANUAL

Thank you for choosing SAVAGE™ II. With proper care your new vehicle will bring you many hours of enjoyment. Please read this instruction manual completely before using the product for the first time, and then keep this manual in a handy place for future reference.



Colors and styles may slightly vary.

PACKAGE CONTENTS

- SAVAGE™ II AWD Off-Road Racer
- Remote control
- USB charger
- 7.4V Li-poly battery pack
- Screwdriver

CHARGING THE BATTERY

1. Insert the white (3-wire) battery charging plug into the USB charger's socket. The charging plug and the USB charger's socket will properly fit in only one direction.
Note: never force a charging socket connection (SEE ILLUSTRATION A).
2. Connect the USB end of the charging cable to your computers USB port or a USB wall charger (SEE DIAGRAM B), The Red CHARGE indicator light will turn on and remain solid to indicate that charging is in progress.
3. Average approximate charging time is between 2-3 hours depending on the amount of residual charge that your Li-poly battery has before you begin charging. Note these charging times are based on 5.0V system with 2.0A or higher USB outlet.
4. The truck will run for approximately 30-40 minutes on a full charge.
5. The red led charging indicator light will turn off when the battery is fully charged.

Note: Periodically examine the charger should be for damage that may result in the risk of fire, electric shock, or injury to persons. Do not use a damaged adapter.

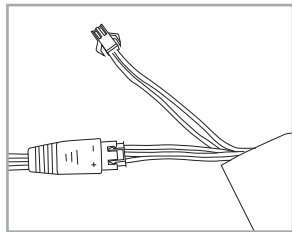

A

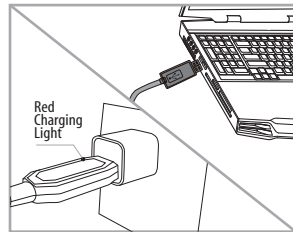

B

SET-UP

1. How to Install the battery into the truck:
Carefully pull off the battery cover lock on the bottom of the truck (SEE DIAGRAM C). Next connect the battery power plug into the truck socket power input socket (this is the black cable, 2 wire plug). Remember, the battery plug and the truck's power socket one properly fit in one direction, NEVER FORCE THE CONNECTION (SEE ILLUSTRATION D). After properly connecting the battery to the vehicle, replace the battery cover and lock it in securely.

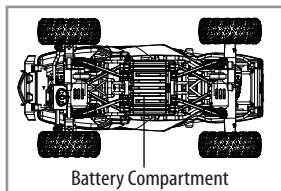

C

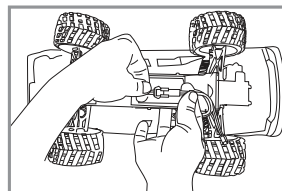

D

2. Installing the AA batteries into the remote control.
Open the controller battery cover which is located on the bottom of the remote control (SEE DIAGRAM E). Insert 4 AA batteries (not included) into the battery compartment. Make sure to carefully check that you have inserted the batteries in the correct direction by matching the polarity markers (+ and -) which are embedded in the plastic on the inside. When finished replace the battery cover and turn on your controller. If you have installed the AA batteries in the correct direction your controller indicator light will turn on (SEE REMOTE DIAGRAM). If the controller indicator light does not turn on you will need to re-check the installation direction of your batteries.

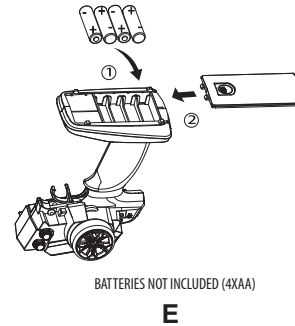

E

TRUCK DIAGRAM (BOTTOM VIEW)

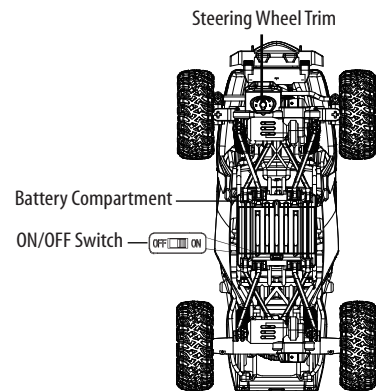

REMOTE DIAGRAM

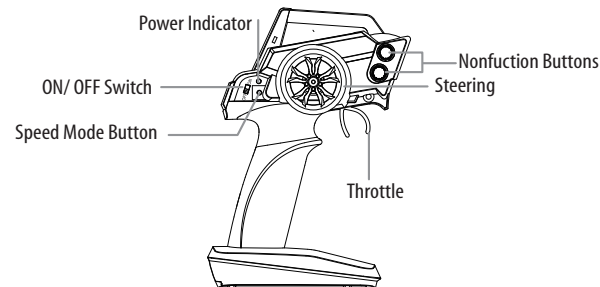

SYNCING YOUR SAVAGE™ II

Your SAVAGE™ II features an automatic 2.4G channel selection system that allows up to 8 people to race side by side in the same wireless range.

For One Player:

1. Before starting, make sure that the power on both your remote control and truck are in the OFF position. Make sure that there are also no other 2.4G devices in the immediate area that area that are powered on.
2. First, turn on the truck and set it down on a flat surface. The head lights and tail lights will be illuminated.
3. Second, turn on the remote control. When the remote control's power indicator should begin flashing. If the indicator light is flashing this means your ready to "pair". Simply pull the throttle lever all the way down. You will hear an engine start-up sound and the indicator light on the controller should now be solid. This means you have successfully paired your vehicle with the controller and you are ready to play! Note: If the light does not go solid, this means you were unable to sync your vehicle and you will have to start steps 1-3 ever again

How to Sync with multiple Players in the same vicinity:

1. Before starting, make sure that the power on all vehicles and controllers are in the OFF position. Also make sure that there are no other 2.4G wireless devices in the vicinity.
2. Each player will have to sync their vehicle one at a time to avoid cross interference, individually at a different time to avoid interference. (follow syncing steps 1-3 above) Important: after successfully syncing a vehicle you must leave it ON until all players have successfully completed syncing their vehicles.
3. If there is interference, all players must turn off their controllers and trucks and restart the syncing process.

OPERATION

THIS IS A HIGH-SPEED OUTDOOR RC TRUCK. DO NOT PLAY INSIDE YOUR HOME OR OTHER SMALL ENCLOSED AREAS.

Driving your truck:

- Pull the throttle halfway down to drive forward at low speed. Pull the throttle all the way down to drive at maximum speed.
- Push the throttle forward to make truck stop or move in reverse.
- To break or quickly stop simply pull or push the throttle in the opposite direction.

SPEED MODE

The SAVAGE™ II has two speed settings, simply press the Speed Mode Button to change the SAVAGE™ II speed from normal speed to high speed (SEE REMOTE DIAGRAM).