

**FLYKEYS**

Achieve Your Music Dream

FK130 DIGITAL PIANO  
**USER MANUAL**

# Safety Guideline

Before playing the digital piano, please read the following content.

\*Please put this instruction book in a safety place, in order to read it in the future.

## Warning

In case of getting seriously injured or killed because of electric shock, short circuit, damage, fire or other dangers, please obey the following warnings. These warnings include but not limited to the following situations:

### Power/Electric Cable

- \* The rated voltage of this device is fixed. The required voltage is printed on the nameplate of this device.
- \* Check the plug regularly, clean the dirt and ash piled up on the plug.
- \* This digital piano only matches with the provided power cable and plug.
- \* Please don't put electric cable beside heaters or radiators. Don't bend too much or cause damage to electric cable. Don't put any heavy stuff on the wire. Don't put it where it may be run over or trampled to make people stumble.

### Do Not Open

- \* Please do not open this device and try to dismantle inner components or transform it in any ways. This device does not include any components for users to fix. If you find any problems, please stop using and ask our qualified service staffs to examine and repair the device.

### Warning about humidity

- \* In case of any liquid splashing into the device, please do not get this device rained or use it nearby water, in a wet surrounding or put a container of liquid on it. If any liquid, like water, splashes into the instrument, please cut off power and pull out the electric cable from the AC socket immediately. Then ask our qualified service staffs to examine and repair the device.
- \* Do not plug with wet hands.

### Fire

- \* Do not place any burning stuff, like candle, on the instrument. It may cause fire.
- \* When sensing any unusual situations, such as worn away and damage of power cable, sound suddenly stops during playing and the smell and smoke it causes, please turn off the power immediately and pull out plug from the socket. Ask our qualified service staffs to examine and repair the device.

## **Attention**

In case that people around you and you get injured or get loss of device and property, please obey the following basic instructions. These instructions include but not limited to following situations.

### Power/Electric Cable

- \* When pulling out plug from socket, please grab the plug instead of power cable. Drawing directly will cause damage to the power cable.

- \* If not using the instruments for a long time or during a lighting storm, please  
pull out plug from the socket
- \* Do not connect the instrument to the socket by multiple connector, or it will  
lower the sound quality, or it will make socket overheat

### Assemble Use

- \* Please carefully read the attachment that explains the assemble process. If assembling the instrument in a wrong order, it will damage the instrument and hurt the user.
- \* Please connect the external equipment while the digital piano is off.
- \* Before using, please install the supporting screw and adjust it close to the ground, in case of trampling pedal.

### Installation place

- \* In case of deformation of control panel and damage to inner components, please do not place this device in an environment with a lot of dirt, vibration, extreme cold and hot (such as, direct sunshine, closing to heater and inside a car under the burning sun).
- \* Please do not use this device near the television, radio, stereo, cell phone or other electronic devices. This may make noise on the device itself and television or radio nearby.
- \* Please do not put this device on unstable place, or it may cause a sudden fall down.
- \* Before moving the device, please pull out all electric cables from the socket.
- \* When you set this device, please confirm the AC socket going to be used is reachable. The device should be connected to the socket with protecting grounding connection. If

you find any problems and questions, please immediately turn off the power and pull out the plug from the socket. Even though the power is turned off, there is still a small amount of electricity current flowing through it. If you decide not using this device for a long time, please pull out the plug from AC socket.

- \* This product uses all extreme power switch as a device to cut off from network power. The power switch button is on the right side of the keyboard.

The contents in this hand book is only for introduction purpose. It may be different from the instrument you buy.

# INDEX

Attention to installation .....	7
Control panel .....	8
Turn on the power\Adjust Volume\Connect the headphone .....	9
Demo playing\Voice .....	10
Teaching function\Function .....	11
1) Chord\2) Octave .....	12
3)Transpose\4)Soundboard resonance .....	13
5) Effect\6) Reverb .....	14
7)Chorus\8) Beat .....	15
9)Touch\10)Split .....	16
Touch switch\Voice choosing .....	18
Record and Play .....	20
Metronome\Using accompaniment .....	21
Dual Voices .....	24

Double keyboard .....	25
Rear panel function/USB MIDI function .....	26
Bluetooth MP3 function .....	27
Audio connecting .....	28
Voices list .....	29
Rhythm list .....	30
Demo list .....	31
Drum kit set list .....	32
Specification .....	36
Troubleshooting .....	38

Thank you for buying Our Digital Piano. No matter you are a student, piano hobbyist or the professional, this digital piano will impress you with its perfect sound and fashion design. It can be competent with piano studying, music listening, MIDI production, which satisfies your entertainment demand. It also has grand hammer dynamics keyboard, making you express yourself easily.

For further information about this new digital piano, we suggest you should read this hand book carefully in order to make full use of its advanced and convenient functions. Meanwhile, we also suggest you should keep this hand book well for reference in the future.

If you like Our digital piano, please recommend to your friends.

## Attention to installation

During the installation process, the screws under the pedal must be screwed close to the ground. Or it will be easily broken down.

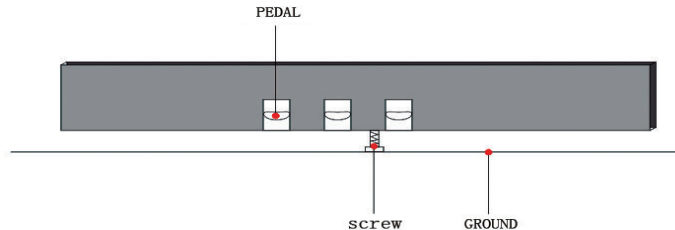



## Control Panel

All the function keys are on the left side control panel of the digital piano.

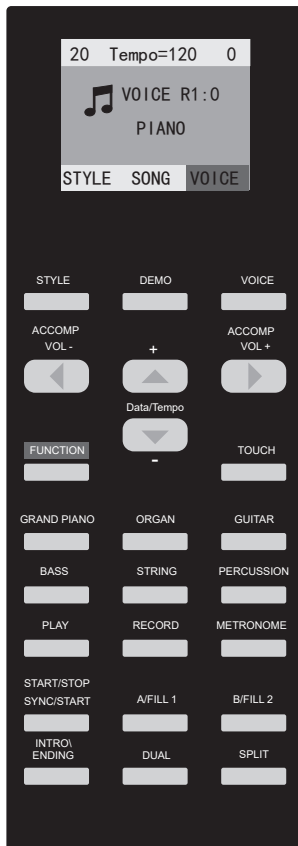

## Turn on the power

Connect the power with wall outlets and press the power button on the right side of the keyboard. The piano is on and the default voice is grand piano.



## Adjust volume

Adjust the [Volume]pushing button on the right side of the control panel to set the volume of the instrument. When you push up the volume will be increased, On the contrary the volume will be turned down.

**Warning:** Do not master excessive volume to avoid any harm to your hearing,(Especially when wearing headphone).



## Connect the headphone

Apart from the built-in speaker system, you can alsoconnect two standard stereo headphones.Headphone jack is on the left side under the keyboard.The built-in speaker system doesn't work after connecting the headphone.And just the headphone volume by switching master volume button.



## Demo playing

1. Press[Demo]button,the light is on and the screen shows the demo song and play it automatically. Press[Data/Tempo+/-] to choose the demo song you want.
2. Press[Demo]button again, the light is off and the demo playing function will be stop.

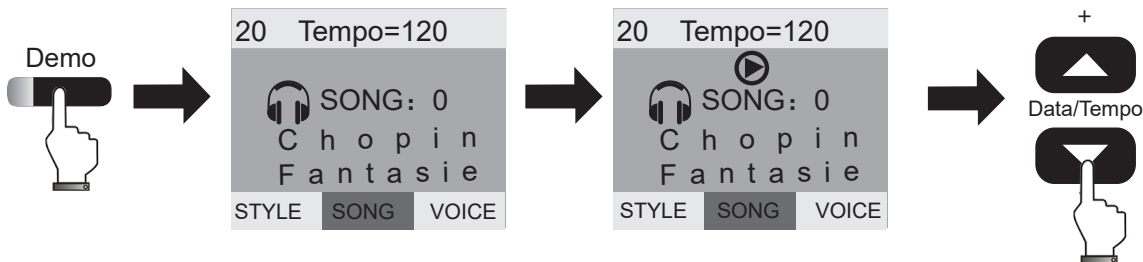

## Voice

1. Press[Voice]button,the light is on and the screen shows the sound. Press[Data/Tempo+/-] to choose the voice you want. (For the voices list, please see the Appendix.)
2. No operation within 5seconds,the voice light will be off and exit the voice function automatically.

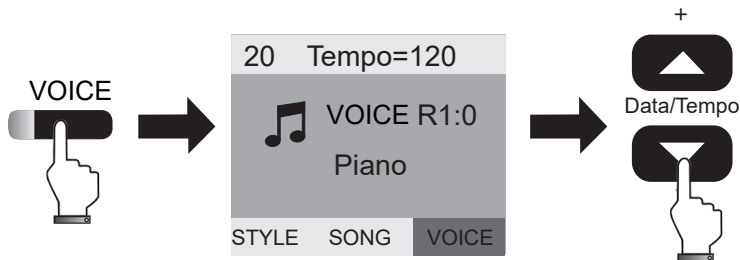

## Teaching function

1. Press [Demo] button, the light is on and the screen shows the demo song and play it automatically. Press [Data/Tempo+/-] to choose the demo song you want.
2. Press [Demo] button again, the light is off and the demo playing function will be stop.

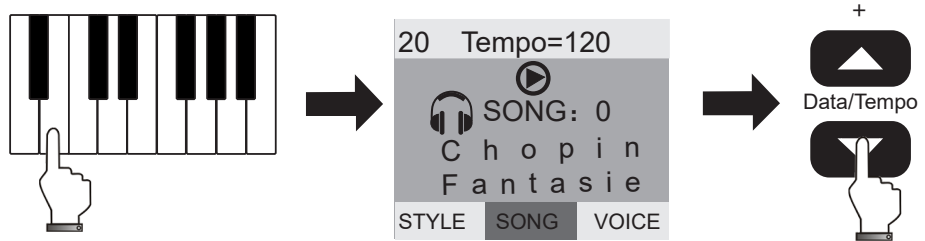

## Function

The instrument is easy to handle. All the function are easy to be activated and every key has a function for you to use. (The function is printed the front of the key) **Warning:** Do not master excessive volume to avoid any harm to your hearing, (Especially when wearing headphone).

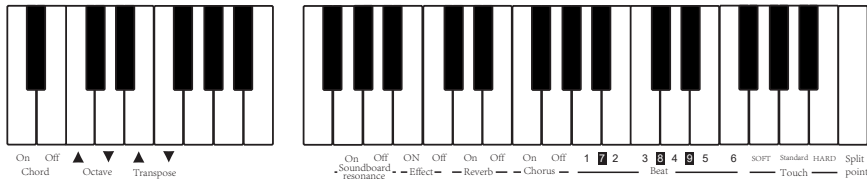

1. Press [Function] button, the function light will be on and activated, then press the corresponding key for the function you need.
2. Press the [Function] button again or no operation within 5 seconds. The function light will be off and exit the function setting. Here the keyboard have the corresponding function which you choose. (Note: when you are in the function setting status, the keyboard is silent.)

## 1) Chord

- 1.The piano has Chord function: Press[Function]button, the function light is on and screen shows"Function choosing"; Press the[Chord on] key within 5seconds. The screen show"Chord:On" mean that the chord function is on.
2. Press[Function]key, the function light is on,then press[Chord off]key,The screen show"Chord:Off" mean that the chord function is off.

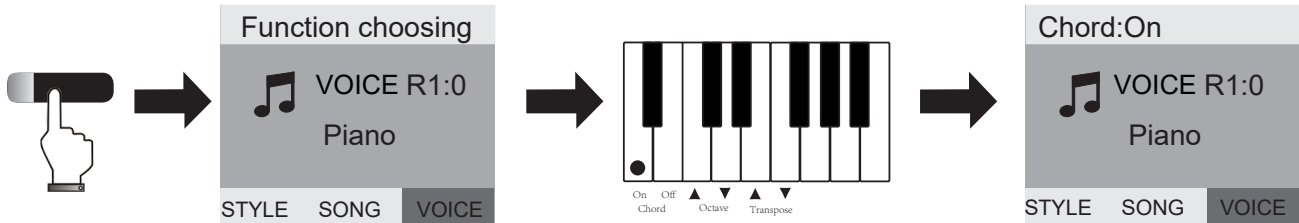

## 2) Octave

- 1.Press[Function]button, the function light is on, the screen shows"Function choosing"  
Press[Octave+/-]key, the screen shows"Octave:-1,0,+1"on the top then you can adjust the octave of the keyboard.
- 2.Press[Function]button again or no operation within 5 seconds, the light will be off and exit the keyboard pitch setting.

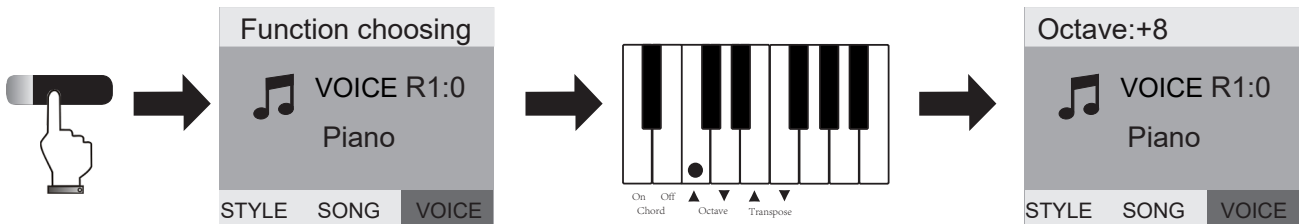

### 3) Transpose

With this function you can sharp or flat a semitone of twelve in the octave.

1. Press[Function]button, the light on, the screen show"Function choosing"

Press[Transpose+/-]key, the screen shows"Transpose+1/-1",then adjust the pitch between -12 and +12.

2. Press[Function]button or no operation within 5seconds, the light is off and shut off the Transpose function.

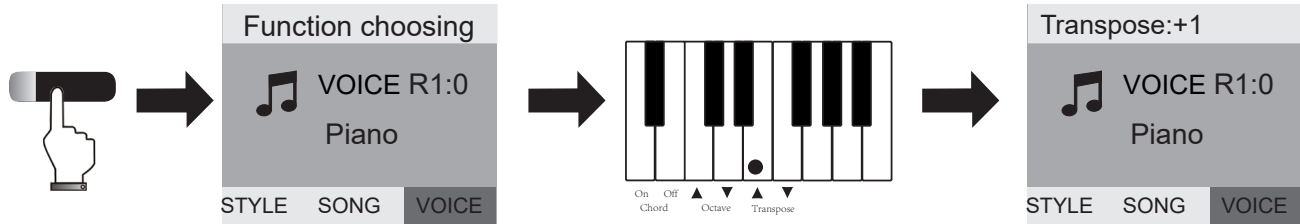

### 4) Soundboard resonance

1. Press[Function]button, the light is on, the screen show"Function choosing"

Press[Soundboard resonance On]key, the screen shows"Soundboard resonance:On",then the soundboard resonance function is activated and it will have the resonance effect when playing.

2.Press[Function]button,and the light is on,Press[Soundboard resonance Off]key within 5seconds, screen shows"Soundboard resonance:Off" and shut off the Soundboard resonance function.

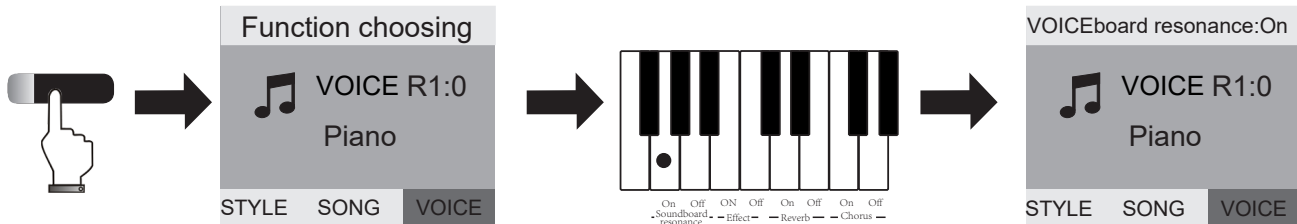

## 5) Effect

1. Press[Function]Button, the light is on and the screen shows"Function choosing"  
Press[Effect On]key within 5 seconds, and the screen shows"Effect:On" means the effect function is activated and it will have the special effect when playing.
2. Press[Function]button, the light is on, press the[Effect off]key within 5 seconds, The screen shows"Effect:Off" and shut off the effect function.

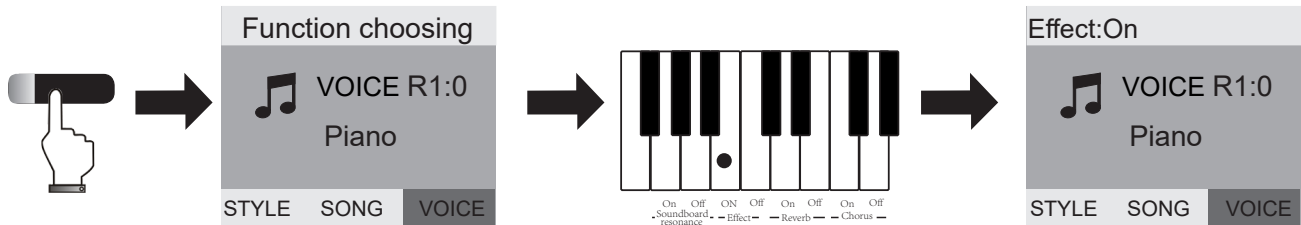

## 6) Reverb

1. Press[Function]Button, the light is on and the screen shows"Function choosing"  
Press[Reverb On]key within 5 seconds, and the screen shows"Reverb:On" means the Reverb function is activated and it will have the Reverb effect when playing.
2. Press[Function]button, the light is on, press the [Reverb off]key within 5 seconds, The screen shows"Reverb:Off" and shut off the reverb function.

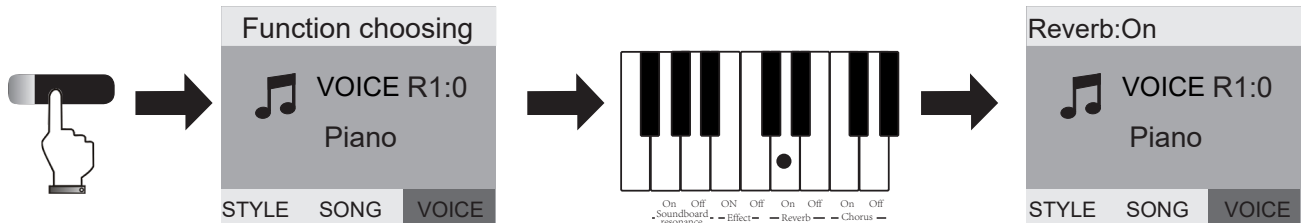

## 7) Chorus

1. Press[Function]Button, the light is on and the screen shows"Function choosing". Press[Chorus On]key within 5 seconds, and the screen shows"Chorus:On" means the Chorus function is activated and it will have the Chorus effect when playing.
2. Press[Function]button, the light is on, press the [Chorus off]key within 5 seconds, The screen shows"Chorus:Off" and shut off the Chorus function.

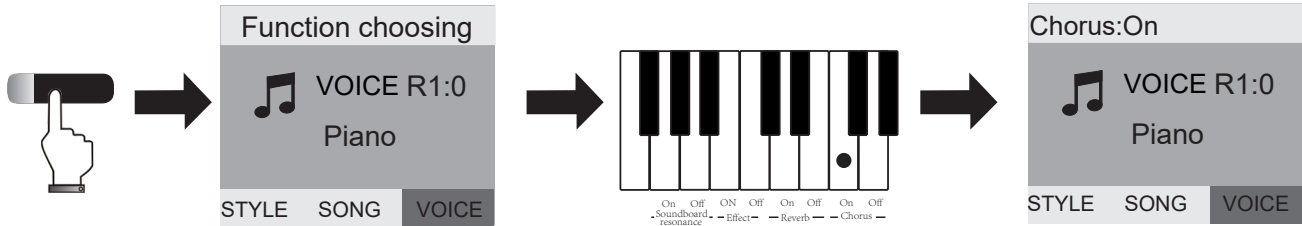

## 8) Beat

1. The instrument has 9 beats, 1,2,3,4,5,6,7,8,9 respectively. Press[Function]button, the light is on and screen shows"Function choosing". Press the corresponding beat key, the screen shows the corresponding beat, then choose the one you need.
2. Press[Function]button again or no operation within 5 seconds, The light is off and confirm the best setting (7,8,9 correspond to the black keys above).

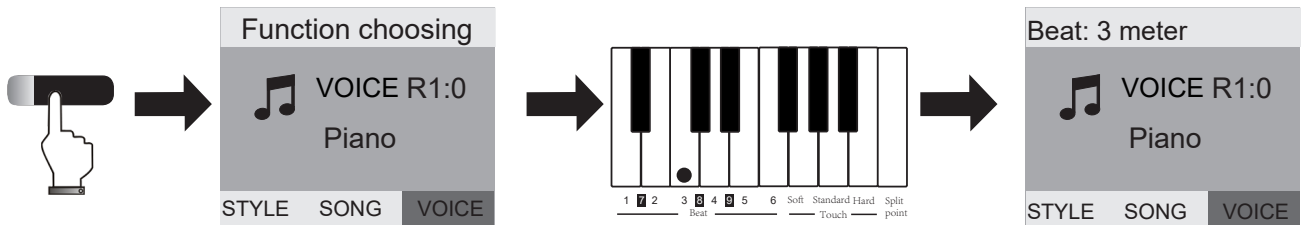



## 9) Touch

1. There are 5 touch curves, Default, Soft, Standard, Hard, Touch Off. Press[Function]button, the indicated light is on and screen shows"Function choosing"

Press the corresponding touch key within 5 seconds, the screen shows the corresponding touch means the keyboard touch function is activated.

2. Press[Function]button again or no operation within 5 seconds, The light is off and exit the touch setup function.

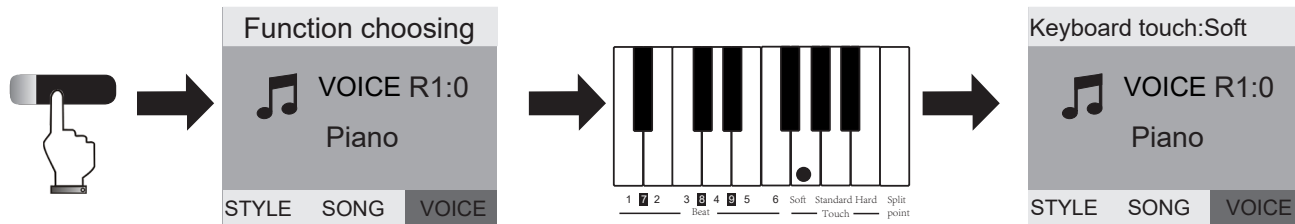

## 10) Split

1. Press[Function]button, the indicated light is on and screen shows"Function choosing"

Press the[Split]key within 5 seconds, the screen shows "keyboard split point=65" means the keyboard get in the Split setting status.

2. Press[Function]button again or no operation within 5 seconds, The light is off and confirm the Split point setting.

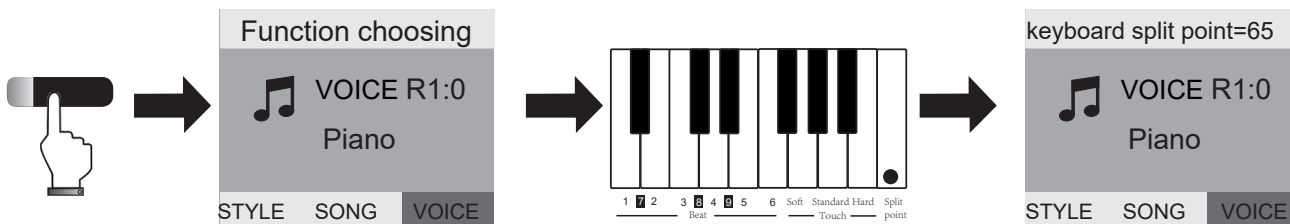

## Touch Switch

1. Touch On: The default touch is on when you turn on the instrument.
2. Touch Off: Press[Touch]button and the indicated light off, the Touch Function Off.



## Voice choosing

**Grand piano:** Grand piano voice is default voice,when you turn on the instrument, the Grand piano voice light will be on.

**Organ:** Press[Organ]Button, the indicated light [Organ]and[Voice] buttons will be on at the same time. The screen shows “Church Organ” and get in the Organ voice.

Press[Data/Tempo +/-] button to choose other voices. (The[Voice] indicated light will be off and exit the Organ voice setting function when there is no operation within 5 seconds.)

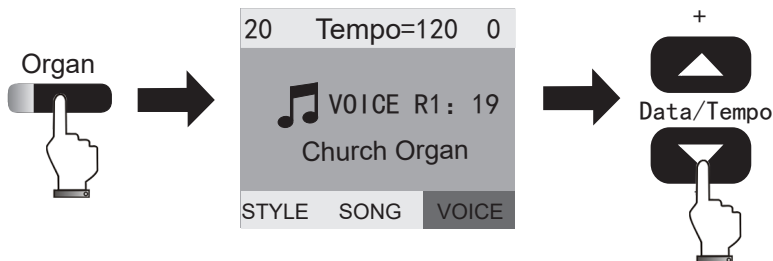

**Guitar:**Press[Guitar]Button, the indicated light [Guitar]and[Voice] buttons will be on at the same time. The screen shows “Classical Guitar” and get in the Guitar voice.

Press[Data/Tempo +/-] button to choose other voices. (The[Voice] indicated light will be off and exit the Guitar voice setting function when there is no operation within 5 seconds.)

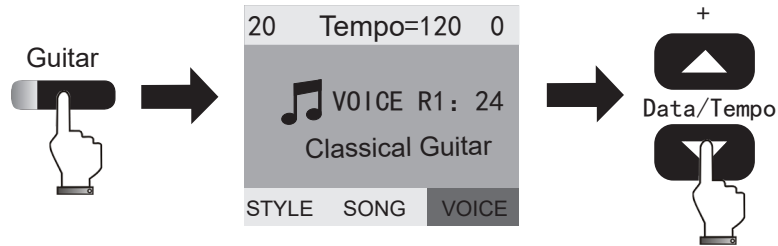

**Bass:** Press [Bass] Button, the indicated light [Bass] and [Voice] buttons will be on at the same time. The screen shows “Acoustic Bass” and get in the bass voice. Press [Data/Tempo +/-] button to choose other voices. (The [Voice] indicated light will be off and exit the Bass voice setting function when there is no operation within 5 seconds.)

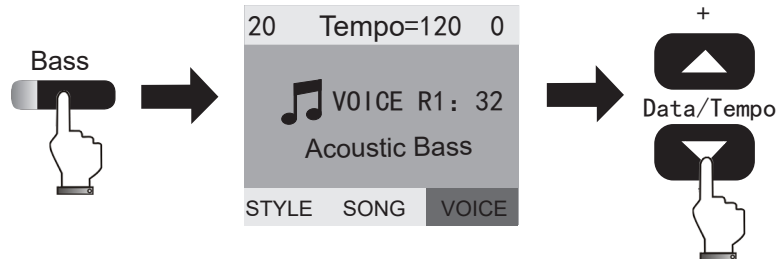

**Strings:** Press [Strings] Button, the indicated light [Strings] and [Voice] buttons will be on at the same time. The screen shows “String Ensemble1” and get in the string voice press [Data/Tempo +/-] button to choose other voices. (The [Voice] indicated light will be off and exit the string voice setting function when there is no operation within 5 seconds.)

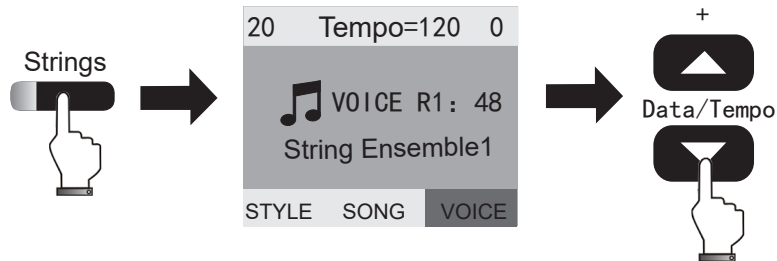

**Percussion:** Press [Percussion] button, the indicated light is on, the screen shows "GM standard kit". Then press [Voice] button again. The indicated light on and get in the percussion sound setting. Press [Data/Tempo +/-] button to choose other voices. (The [Voice] indicated light will be off and exit the Percussion sound setting function when there is no operation within 5 seconds.)

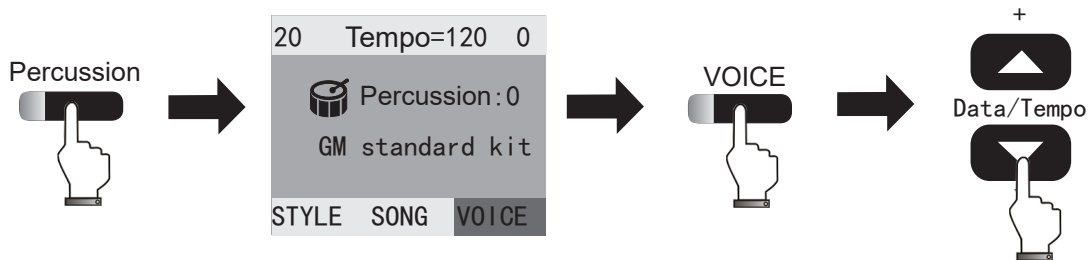

## Record and play

The digital piano can record the music your played, including the build-in accompaniment of the piano. Operation as follows:

### Record:

1. Press [Record] button and the indicated light on, the metronome function will be turned on and record. If you want to turn off the metronome voice, press [Metronome] to close it.
2. Press [Record] button ,the indicated light off and exit the record function.

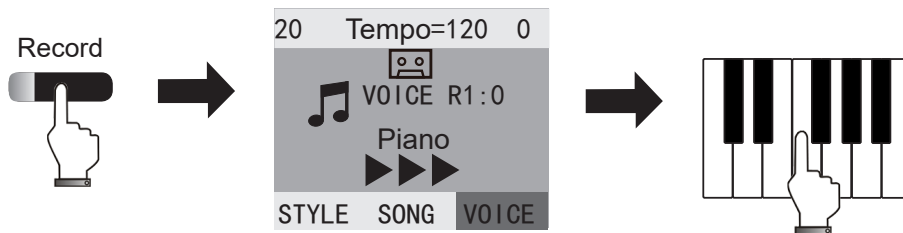

### Play:

1. Press [Play] button, the indicated light on, the screen shows you the music is playing as the icon below. (The music you recorded will be played.)
2. After playing, the indicated light off and the playing icon will be disappeared.

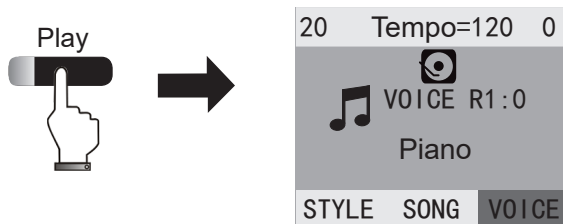

## Metronome

1. Press [Metronome] button, the indicated light on, the screen show the blink icon “▶▶▶” and the metronome voice sound.
2. Press [Data/Tempo +/-], the screen shows “Tempo=120” ( Default), In the moment, you can adjust the tempo by press the [Data/Tempo +/-] button.
3. Press [Metronome] button, the indicated light off and exit the metronome setting function.

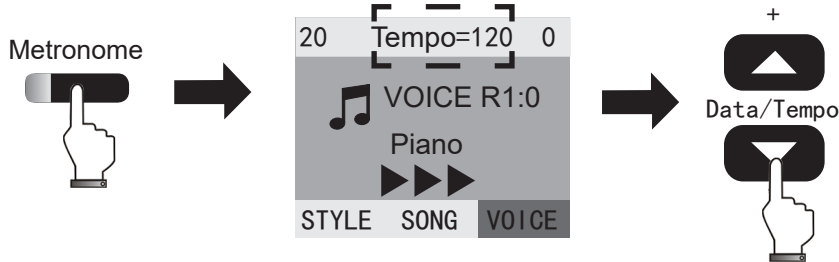

## Using accompaniment

Playing with the accompaniment makes your music more expressive and emits interest into your music:

### Style:

1. Press [Accomp] button, the indicated light on, the screen shows “STYLE”. Press [Data/Tempo +/-] button to choose the rhythm, the screen will show the corresponding name of the rhythm.
2. No operation within 5 seconds, the indicated light off and exit the rhythm function automatically.



### Accomp volume-/+:

1. Press [Accomp vol+/-] button, the screen show "20"(Default) on the top left. When you adjust the volume by pressing the [Accomp vol+/-], it will show corresponding figure.(Accomp volume:0-32)
2. After adjusting, the accomp volume function will be exited automatically.

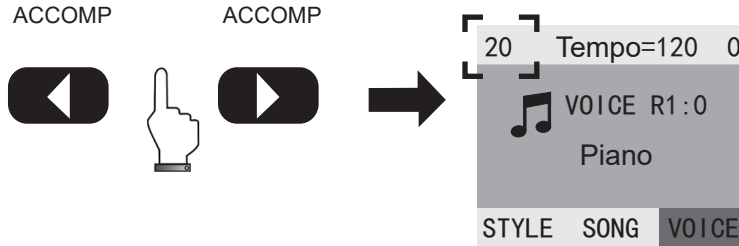

### Start/Stop:

Press the [Start/Stop] button, it will control the accompaniment.

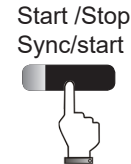

### Sync/Start:

1. Long press [Sync/Start] button, the screen show three blinking triangular symbols (When the chord function off, press any keys the automatic accompaniment will be activated. If the chord function is on, press the corresponding key of the Chord.)
2. Press [Sync/Start] button, the accompaniment will be stopped.

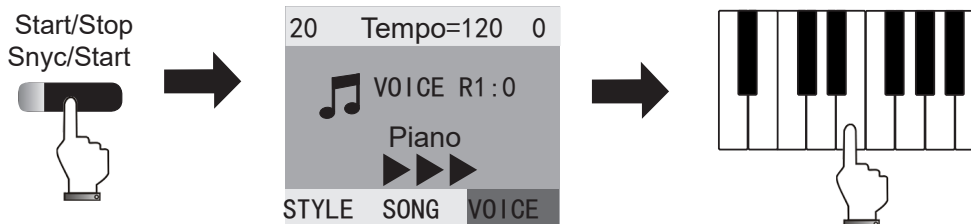

### A/fill 1:

1. When [A/fill 1] button is on(default status), Press[Start/Stop] button, the screen shows three blinking triangular symbols.
2. Press [A/fill 1] button, the indicated light is on. Accompaniment inserts A rhythm.



### B/fill 2:

1. Press [Start/Stop] button, the screen shows three blinking triangular symbols, Accompaniment voices.
2. Press [B fill 2] button, the indicated light is on. Accomp inserts B rhythm.



### INTRO\ENDING:

1. Press[INTRO\ENDING] button, the [Start/Stop] indicated light will be on simultaneously. The screen shows 3 blinking triangular symbols,the Prelude will be inserted into your music.
2. Press [INTRO\ENDING] button, the indicated light is on, the finale will be inserted into your music. Then the indicated light off and accomp stop.



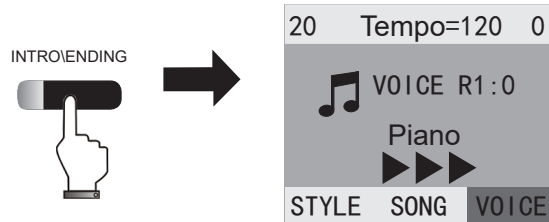

## Dual voice

1. Press [Dual] button to get in the dual voice status, the indicated light on.
2. Press [Data/Tempo +/-] button to select other second voice. The first voice setting needs to adjust before pressing [Dual ] button.
3. Press [Dual] button turn off the dual voice effect and back to the first voice.

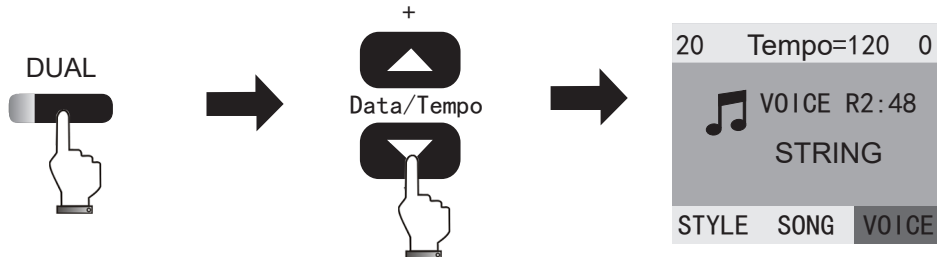

## Double keyboard

The function divides the keyboard into two separated operating areas.

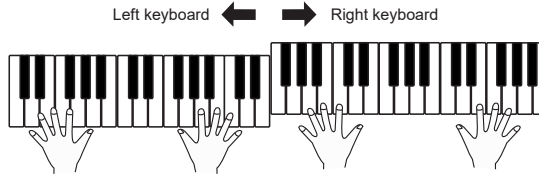

1. Select the voice of left side keyboard before pressing [Split] button. Press [Voice] button, the indicated light on, then press [Data/Tempo +/-] button to select the voice.
2. Press [Split] button to get into the double keyboard status, the keyboard will be divided into two separated operating area. The default split point is C. Press [Voice] button, select the voice of right side keyboard by pressing [Data/Tempo +/-] button.
3. Press [Split] button to exit the double keyboard status.

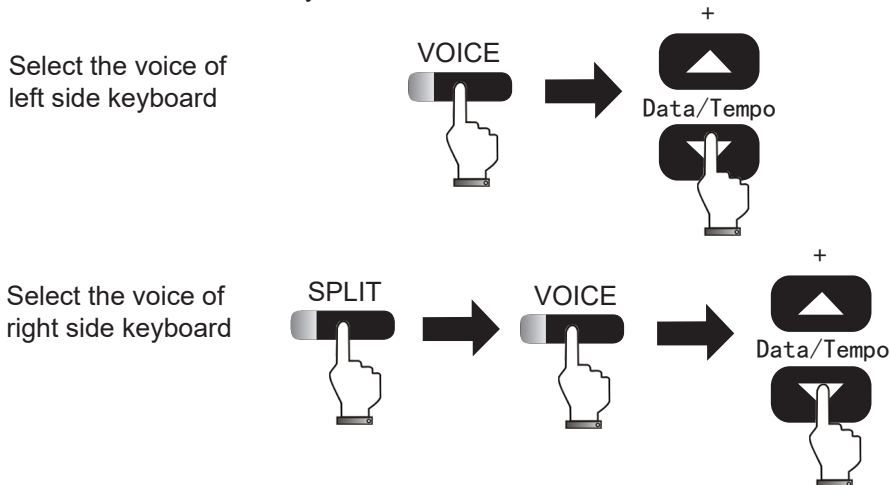

## Rear panel function

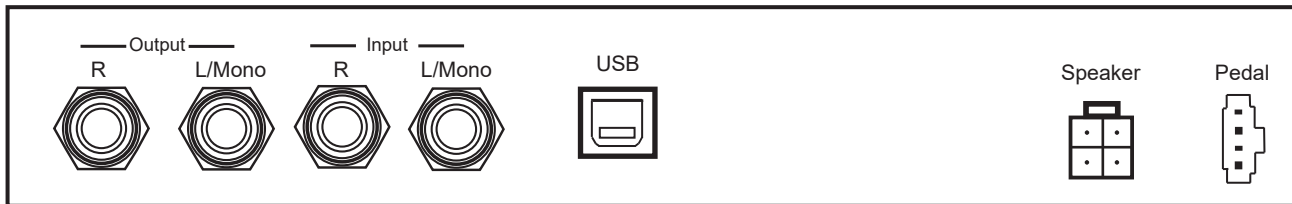

(1) LINE OUT L/R

(2) LINE IN L/R

(3) USB

(4) SPEAKER

(5) PEDAL

## USB MIDI function

Connecting the digital piano from the rear panel USB jack to the host of PC, to start MIDI music production.

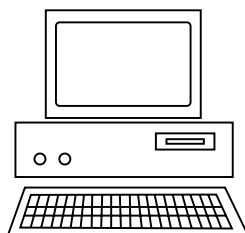

USB to host connecting

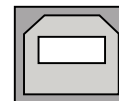

Digital piano rear board USB

## Bluetooth MP3 function

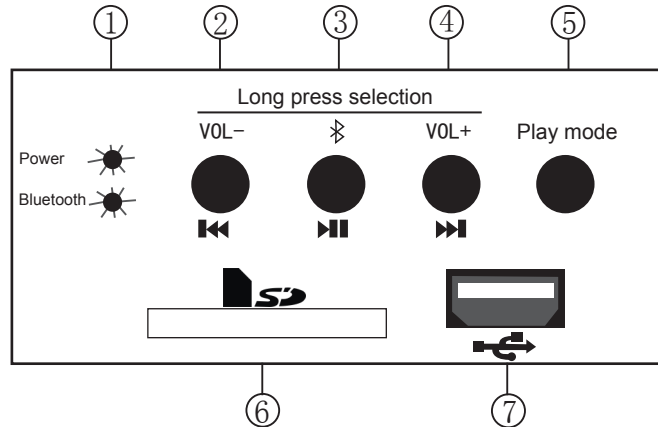

1. **Status indicated light:** the red light means in USB, SD status; the blue light means in Bluetooth status.
2. **Previous music/ Volume down:** short press the button will be turned to previous music. Long press the button will turned down the volume.
3. **Play-pause/Bluetooth:** short press the button will be switched play or pause mode. Long press the button will be Bluetooth pairing function.
4. **Next music/ Volume up:** short press the button will be turned to next music. Long press the button will turned up the volume.
5. **Play mode:** Switch between USB\SD and Bluetooth mode.
6. **SD card connector:** SD card input for playing MP3 files from the SD card.
7. **USB connector:** USB input for playing MP3 files from USB pen-driver.

### USB/SD card operating instructions:

When the instrument is on, the Bluetooth function standby. Insert the USB or SD card and the system get in the loading status with blinking LED red light. To select the music from your USD/SD card by pressing [ ◀◀ ] or [ ▶▶ ]. Perhaps the [ ▶▶ ] button to pause/play music. When in pause status,the red LED light will be on.

Bluetooth operating instructions:

Long press[ ⌘ ]to get in the Bluetooth pairing status, the blue LED light flashing slowly. At the moment, search the Bluetooth to pair with your cellphone. After pairing, it can play the music from your phone or other Bluetooth units. When playing, the blue LED light flash quickly, then you can select the music by pressing [ ◀◀ ] or [ ▶▶ ] or press the [ ▶▶ ] Pause/Play music button to set it. When in pause status,the blue LED flash slowly.

In USB,SD loading status,if you need to switch to Bluetooth play,you need to press [play mode]button to switch Bluetooth mode then do the Bluetooth pairing.

### Audio connecting

**Line In:** Connect the musical instrument to the built-in speaker system, regarding the digital piano as speaker.

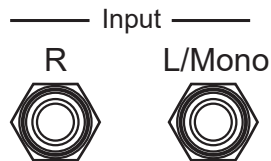

**Line Out:** Regarding this digital piano as sound source, connect it to the external speaker system.

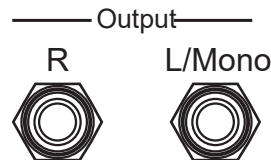

## Voice list

Number	Instrument
000	Grand Piano
001	Bright Piano
002	Honky-Tonk Piano
003	Electric Piano 1
004	Electric Piano 2
005	Harpsichord
006	Marimba
007	Hammond Organ
008	Church Organ
009	Guitar(nylon)
010	Acoustic Bass
011	Pizzicato Strings
012	Orchestral Harp
013	String 2

Number	Instrument
014	Synth Strings 1
015	Muted Trumpet
016	Alto sax
017	Clarinet
018	Pan FLute
019	Shakhachi
020	Pad 2(warm)
021	Pad 8(sweep)
022	FX3(crystal)
023	Sitar
024	Shamisen
<b>Drum</b>	
000	Standard Kit

## Rhythm list

Number	Name
000	8 Beat 1
001	8 Beat Pop 1
002	16 Beat 1
003	Guitar Ballad
004	Pop Ballad
005	Country Rock
006	Country Waltz
007	Salsa
008	Disco
009	Two Step
010	Polk Pop
011	80's Fusion
012	Swing 1
013	Jazz Samba
014	Jive

Number	Name
015	Bebop
016	Cha Cha
017	TEX TEX
018	Rap
019	Blues
020	Rock 1
021	Rock 2
022	Rock Shuffle
023	March
024	Samba
025	Polka Ober
026	Miami Pop
027	Piano Ballad
028	Bossa Nova 2
029	Guitar Waltz

## Demo list

Number	Demo Name
000	Chopin Fi
001	Bach Piano
002	Minuet Bach
003	Love Romance
004	Four Cygnets
005	Puppy Wlatz
006	CpnEtude
007	Turkey March
008	Chopin No.6
009	Menuett
010	MarciaAT
011	Chopin Night
012	Piano Ballad
013	Ragetime
014	Fn Rhythm
015	Dolly's Dream
016	4 Cygnets

Number	Demo Name
017	Old France
018	Minuet Bath
019	Song of Joy
020	Doves
021	Curvet Piano
022	Spring Waltz
023	Aledeman
024	Bach 2 Creative
025	Moonlight Debussy
026	Gavotte Dance
027	Canon Piano
028	Cowboy & Flute
029	Turkey March
030	Humoresque
031	England March
032	Little Boat
033	Minuet Piano

Number	Demo Name
034	Jingle Bells
035	Moscow Nights
036	Rainbow
037	Oh, Susanna
038	Lonely Goatherd
039	Missing In Moonlight
040	Old Black Joe
041	Santa Lucia
042	Good Scenery
043	Jambalaya
044	Little Cowboy
045	Fowing Stream
046	Little Swallow
047	Heart Love
048	Kaiser Waltz
049	Blue Danube Waltz



## Drum kit set list

MIDI note#		1-Standard	2-Room	3-Power	4-Electric	5-Synth
27	C1	Syn Sound	Syn Sound	Syn Sound	Syn Sound	Syn Sound
28	C#1	Slap	Slap	Slap	Slap	Slap
29	D1	Scratch1	Scratch1	Scratch1	Slap	Scratch1
30	D#1	Scratch2	Scratch2	Scratch2	Scratch2	Scratch2
31	E1	Sticks	Sticks	Sticks	Sticks	Sticks
32	F1	Click	Click	Click	Click	Click
33	F#1	Metronome Click	Metronome Click	Metronome Click	Metronome Click	Metronome Click
34	G1	Metronome Bell	Metronome Bell	Metronome Bell	Metronome Bell	Metronome Bell
35		Kick2	Kick2	Kick2	Eleotry Kick2	Kick2
36	A1	Kick1	Kick1	Power Kick1	Eleotry Kick1	Synth Kick
37	A#1	Side Stick	Side Stick	Side Stick	Side Stick	Synth Side Stick
38	B1	Snare Drum2	Snare Drum2	Power Snare	Eleotry Snare Drum2	Synth Snare
39	C2	Hand Clap	Hand Clap	Hand Clap	Hand Clap	Hand Clap
40	C#2	Snare Drum1	Room Snare1	Snare Drum1	Eleotry Room Snare 1	Snare Drum1
41	D2	Low Tom2	Power Low Tom2	Power Low Tom2	Eleotry Low Tom2	Synth Low Tom2
42	D#2	Closed Hi-Hat	Closed Hi-Hat	Closed Hi-Hat	Closed Hi-Hat	Synth Closed Hi-Hat

<b>MIDI note#</b>		<b>1-Standard</b>	<b>2-Room</b>	<b>3-Power</b>	<b>4-Electric</b>	<b>5-Synth</b>
43	E2	Low Tom1	Power Low Tom1	Power Low Tom1	Eleotry Low Tom1	Synth Low Tom1
44	F2	Pedal Hi-Hat	Low Tom1	Pedal Hi-Hat	Pedal Hi-Hat	Synth Pedal Hi-Hat
45	F#2	Mid Tom2	Power Mid Tom2	Power Mid Tom2	Eleotry Mid Tom2	Synth Mid Tom2
46	G2	Open Hi-Hat	Open Hi-Hat	Open Hi-Hat	Open Hi-Hat	Synth Open Hi-Hat
47	G#2	Mid Tom1	Power Mid Tom1	Power Mid Tom1	Eleotry Mid Tom1	Synth Mid Tom1
48	A2	High Tom2	Power High Tom2	Power High Tom2	Eleotry High Tom2	Synth Tom2
49	A#2	Crash Cymbal	Crash Cymbal	Crash Cymbal	Crash Cymbal	Synth Crash Cymbal
50	B2	High Tom1	Power High Tom1	Power High Tom1	Power High Tom1	Synth High Tom1
51	C3	Ride Cymbal	Ride Cymbal	Ride Cymbal	Ride Cymbal	Ride Cymbal
52	C#3	Chinese Cymbal 1	Chinese Cymba1	Chinese Cymbal 1	Chinese Cymbal 1	Chinese Cymbal 1
53	D3	Ride Bell	Ride Bell	Ride Bell	Ride Bell	Ride Bell
54	D#3	Tambourine	Tambourine	Tambourine	Tambourine	Tambourine
55	E3	Splash Cymbal	Splash Cymbal	Splash Cymbal	Splash Cymbal	Splash Cymbal
56	F3	Cowbell	Cowbell	Cowbell	Cowbell	Cowbell
57	F#3	Crash Cymbal	Crash Cymbal	Crash Cymbal	Crash Cymbal	Crash Cymbal

<b>MIDI note#</b>		<b>1-Standard</b>	<b>2-Room</b>	<b>3-Power</b>	<b>4-Electric</b>	<b>5-Synth</b>
58	G3	Vibra-Slap	Vibra-Slap	Vibra-Slap	Vibra-Slap	Vibra-Slap
59	G#3	Ride Cymbal1	Ride Cymbal1	Ride Cymbal1	Ride Cymbal1	Ride Cymbal1
60	A3	High bomgo	High bomgo	High bomgo	High bomgo	High bomgo
61	A#3	Low conga	Low conga	Low conga	Low conga	Low conga
62	B3	Mute conga	Mute conga	Mute conga	Mute conga	Mute conga
63	C4	High conga	High conga	High conga	High conga	High conga
64	C#4	Low conga	Low conga	Low conga	Low conga	Low conga
65	D4	High Timbale	High Timbale	High Timbale	High Timbale	High Timbale
66	D#4	Low Timbale	Low Timbale	Low Timbale	Low Timbale	Low Timbale
67	E4	High Agogo	High Agogo	High Agogo	High Agogo	High Agogo
68	F4	Low Agogo	Low Agogo	Low Agogo	Low Agogo	Low Agogo
69	F#4	Cabasa	Cabasa	Cabasa	Cabasa	Cabasa
70	G4	Msracas	Msracas	Msracas	Msracas	Msracas
71	G#4	Short Hi Whistle	Short Hi Whistle	Short Hi Whistle	Short Hi Whistle	Short Hi Whistle
72	A4	Long low whistle	Long low whistle	Long low whistle	Long low whistle	Long low whistle
73	A#4	ShortGuiro	ShortGuiro	ShortGuiro	ShortGuiro	ShortGuiro

<b>MIDI note#</b>		<b>1-Standard</b>	<b>2-Room</b>	<b>3-Power</b>	<b>4-Electric</b>	<b>5-Synth</b>
74	B4	logn Guiro	logn Guiro	logn Guiro	logn Guiro	logn Guiro
75	C5	Claves	Claves	Claves	Claves	Claves
76	C#5	Hi Wood Block	Hi Wood Block	Hi Wood Block	Hi Wood Block	Hi Wood Block
77	D5	Low Wood Block	Low Wood Block	Low Wood Block	Low Wood Block	Low Wood Block
78	D#5	Mute Cuica	Mute Cuica	Mute Cuica	Mute Cuica	Mute Cuica
79	E5	Open Cueca	Open Cueca	Open Cueca	Open Cueca	Open Cueca
80	F5	Mute Triangle	Mute Triangle	Mute Triangle	Mute Triangle	Mute Triangle
81	F#5	Open Triangle	Open Triangle	Open Triangle	Open Triangle	Open Triangle
82	G5	Shaker	Shaker	Shaker	Shaker	Shaker
83	G#5	Jingle Bell	Jingle Bell	Jingle Bell	Jingle Bell	Jingle Bell
84	A5	Bell Tree	Bell Tree	Bell Tree	Bell Tree	Bell Tree
85	#5	Castanets	Castanets	Castanets	Castanets	Castanets
86	B5	Mute Surdo	Mute Surdo	Mute Surdo	Mute Surdo	Mute Surdo
87	C6	Open Surdo	Open Surdo	Open Surdo	Open Surdo	Open Surdo

## Specifications

Technical Specifications	FK130
Keyboard :	Fashion small door, independent speaker structure, three rows of button side control panel, LCD color Chinese display screen, push-pull key cover, aluminum alloy handle, folding large spectrum frame
Sound Generation:	DSP sound source, Germany Famous grand piano sound sampling. 10 Layers dynamic, String overtone resonance analog audio technology
Maximum Polyphony:	512 Notes
Voice:	26
Demo:	50 Demos
Touch Sensitivity:	Default, Soft, Standard, Hard, Touch off
Keyboard Modes:	Whole, Split, Dual, Double (Grand Piano, Dual voice, Double keyboard, Split mode, Split point)
Soundboard Resonance :	Yes
Rhythms:	30 Styles
Rhythm Controls:	Auto Chord Switch, SYNC Start, SYNC Stop, A/fill 1, B/fill 2, Intro\Ending
Recorder:	2 Tracks, replay supported, Maximum 22.000 notes for one single song. MIDI, 64 tracks and 16 channels, Support MIDI 0&1 file
Teaching System functions:	Yes.
Metronome:	Yes (Selectable Beat, adjustable tempo)
Volume Controls:	Master volume, Accompaniment volume (0-32)
Connections:	Audio In L/R, Audio Out L/R, USB to Host (Type B), USB Host (Type A), SD Card, Power Supply

<b>Technical Specifications</b>	<b>FK130</b>
External Audio Sources:	Bluetooth, USB, SD Card
Transposer :	-12 / +12 Semitones
Octave:	Octave -1/ 0 / +1
Reverb Effects:	64 Types
Modulation Effects:	64 Types
Tempo:	20-280 Bpm
Controls:	Main Volume, Mic. Volume, Reverb
Functions Panel Menu:	Style, Demo, Voice, Accomp.Vol. -/+, Data/Tempo, Function, Touch, Sound Family, Play, Record, Metronome, Start/Stop, Sync.Start, A/Fill 1, B/Fill 2, Intro/Ending, Dual, Spilt
Display:	Yes, LCD Display
Pedals:	Soft, Sustain, Sostenuto
Power Amplifier:	60W (2 x 25W Low Section, 2 x 5W High Section)
Speakers:	2 woofer(5"), 2 tweeter(2")
Dimensions (D x W x H) :	1375 x 420 x 875mm - (54" x 13,38" x 29.53")
Weight:	50.4 Kg -(110.23 lbs)
Power Supply:	70W.
Included Accessoires:	Power cord, Guarantee card, Quality certificate, User manual

## Troubleshooting

Problem	Cause/Action
There is noise when turn on/off the power	This is normal , please don't worry.
After turning on, no sound is produced when press the keys	Please adjust the master volume or check if there is a headphone connected in the device.
The note and its timber are of a little differences under the same patch	This is normal.
When using the sustaining function, some patches are different long or short	This is normal.
The volume is too low	Please adjust the master volume knob.
MIDI transmission function fail when the MIDI Cord connecting well	This is normal.
Noise caused when near phone	This is normal, In order to avoid it please keep away when calling.
When playing piano, the pitch is not in accordance with the keyboard	Please check if you have activated the SPLIT mode function and turn it off.
Pitch can not be changed when playing piano, and the pitch is not in accordance with the keyboard	Please check if you have activated the SPLIT mode function and set the split point to the highest level, Turn off the split mode function and set the split point back to the original.
Distortion or intermittent when playing demo songs	The cause could be the overheating of the speakers,when you play for a long time with the maximum volume, at this point please lower the volume or turn the piano off for a while.
Two tones come out at the same time when playing	Dual sound function might by activated, please turn off it to avoid it.
Pitch wrong	Please confirm the pitch setting or set it to "Zero"

Problem	Cause/Action
No automatic Accompaniment and Chord	Please confirm the accompaniment volume or if the Chord function is turned on.
Dynamics is not same as before	There are 5 piano touch curve, Default、 Soft、 Standard、 Hard、 Touch off. You might choose the wrong dynamics. Please set the one you need.

FCC Caution.

(1)§ 15.19 Labelling requirements.

This device complies with part 15 of the FCC Rules. Operation is subject to the following two conditions: (1) This device may not cause harmful interference, and (2) this device must accept any interference received, including interference that may cause undesired operation.

§ 15.21 Changes or modification warning

Any Changes or modifications not expressly approved by the party responsible for compliance could void the user's authority to operate the equipment.

§ 15.105 Information to the user.

Note: This equipment has been tested and found to comply with the limits for a Class B digital device, pursuant to part 15 of the FCC Rules. These limits are designed to provide reasonable protection against harmful interference in a residential installation. This equipment generates uses and can radiate radio frequency energy and, if not installed and used in accordance with the instructions, may cause harmful interference to radio communications. However, there is no guarantee that interference will not occur in a particular installation. If this equipment does cause harmful interference to radio or television reception, which can be determined by turning the equipment off and on, the user is encouraged to try to correct the interference by one or more of the following measures:

- Reorient or relocate the receiving antenna.
- Increase the separation between the equipment and receiver.
- Connect the equipment into an outlet on a circuit different from that to which the receiver is connected.
- Consult the dealer or an experienced radio/TV technician for help.





Manufactured by  
Gangzhou Pearl River Amason Digital Musical  
Instrument Co.,Ltd

Add:No.38.Xiangshan Ave,Zengcheng  
Economic and Technological Development  
Zone,Guangzhou China  
Tel:+86-20-36574618 Fax:+86-20-81764948  
Email:wmk@pearlriverpiano.com

2B010604