

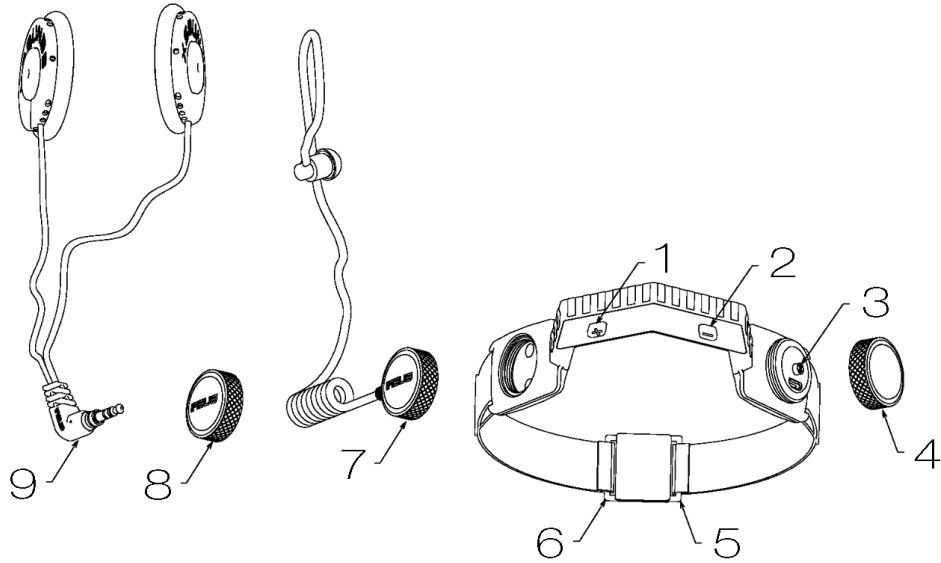

Stealth Rekon Hedaset (IA-NT4-BASIC-BT)

Operating Instructions v3.0



Stealth Parts Reference

1. Vol + / Next Track
2. Vol - / Previous Track
3. Primary Button: Power/Pairing/Pause/Play (w/ Micro-USB charging port underneath it)
4. Primary Button Cap
5. Magnetic clasp base
6. Magnetic clasp top
7. Acoustic coil module
8. 3.5mm (recessed/thin jack) module
9. Helmet speaker 3.5mm jack

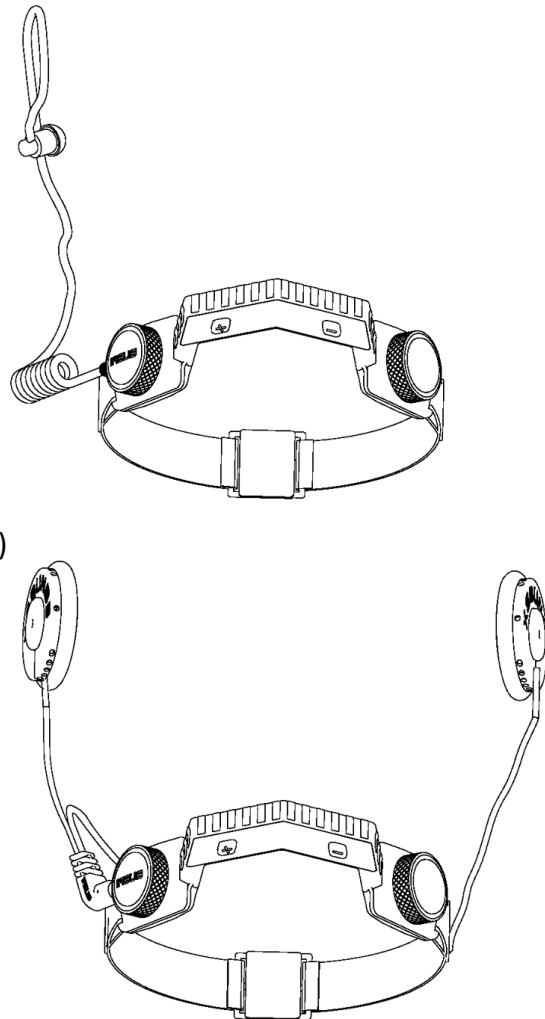



Stealth Rekon Hedaset (IA-NT4-BASIC-BT)
Operating Instructions v3.0

Thank you for purchasing the preproduction version of our Stealth Bluetooth Throat Mic.

In this document you will find instructions on operating the Stealth with Bluetooth enabled devices. Should there be any questions, feel free to contact us at info@iasus-concepts.com.

Orientation of the Stealth During Usage

When positioning the Stealth, the volume buttons on the wing blade should be facing downwards, while the primary button should be on the left side of the throat and the acoustic coil or 3.5mm module attachment should be on right side.

Charging

The Stealth comes shipped from our facilities with its battery already charged and ready for use.

When charging is needed, connect the included USB cable to the micro-USB port covered by the Primary Button Cap.**

To access the charging port, remove the Primary Button Cap by turning it counter-clockwise. A full charge takes about 90 minutes to complete and a red LED will remain lit until it is fully charged. Please note to charge with a computer USB port only.

Fast chargers (>500mA) will damage the Stealth's charging mechanism. To avoid damage to the battery, refrain from draining the battery completely and leaving it uncharged for an extended amount of time.

**With the ring and cap removed, the smoked silicone cap can be replaced with the included solid black silicone piece to mask the indicator LED for certain applications.

Controls

The Stealth was designed with 3 basic buttons for control. The **Primary Button** is located on the left side of the neck and the button cap is made of silicone with an indicator LED located behind it. A pair of buttons for volume up/down/skipping tracks are located on the wing blade, with beveled **+** and **-** on them. All control buttons are designed to be operated with ease even when gloves are worn.

Refer to the following table for functions of the buttons.

Function	Button Sequence*
Power On	Hold Primary Button for 2 seconds
Power Off	Hold + Button until Blue LED stops flashing
Pairing Mode	With Stealth on or off, hold Primary Button for more than 3 seconds until LED flashes Red and Blue with a pairing tone
Volume Up**	Press + Once / Twice Quickly
Volume Down**	Press - Once / Press Twice Quickly
Play/Pause Music in Music Profile Answer/End Call in Phone Profile	Press Primary Button
Next Track	Press + Twice Quickly
Previous Track	Press - Twice Quickly
Voice Command (iPhone Siri, Google Search)	Hold Primary Button for 2 seconds

* All functions sound a beep or tone confirmation when performed

** See Section "Volume During Music Playback and Calling"

Pairing

The IASUS Stealth uses standard Bluetooth 5.0 protocols. When paired with newer devices, there is no need to enter a passcode. For older Bluetooth equipped devices, the code is "0000". The device name is "Stealth Headset".

Pairing Second Device

The Stealth allows for pairing with two Bluetooth enabled devices at the same time, such as another smart phone, GPS, mp3 player, etc.

To pair a second device, after the Stealth is paired with the first device, hold the primary button for 3 seconds to get into pairing mode to pair with the second device. (Doing this will disconnect the Stealth from the first device) Go to your first device's Bluetooth settings and manually connect it back to the Stealth.

Phone Use

Once paired for standard communication with a mobile device, the primary button is used to answer/end a phone call. The two buttons underneath the "wing blade" are for volume + and -. Once pressed and released, a beep confirms the change in volume.

Volume During Music Playback and Calling

During music playback, the Stealth's volume level is independent of the phone's Bluetooth volume. During a phone call, they are linked. This is normal in both Acoustic Coil and Helmet Speaker/3.5mm configurations. If you experience low volume during music playback, be sure the volume is turned up on your phone as well as on the Stealth.

For example, when adjusting the Stealth's volume during music playback, the phone's Bluetooth volume is not affected. However, during a phone call, adjusting the Stealth's volume affects the phone's Bluetooth volume as well.

Interchangeable Audio Module

The Stealth can operate with our acoustic coil or helmet speakers which use the 3.5mm recess/thin audio connector. This is done by installing the appropriate audio module.

To properly attach these modules, they need to be turned clockwise and tightened very firmly until the IASUS logo is horizontal and right side up. This position ensures proper alignment with the contacts. Note: It should be tightened to the point where it will not turn anymore in order for the silicon ring to maintain a waterproof seal.

When connecting the helmet speaker's 3.5mm jack, be sure to insert the plug all the way into the jack until a click is felt to ensure the waterproof seal has been established.

Magnetic Breakaway Clasp

The Stealth neck strap is equipped with a magnetic breakaway clasp. It is designed for emergency situations where a rapid release of the headset is required by pulling on either strap away from the other to disengage.

Under normal usage, separate the top clasp from the base clasp with a light twisting motion – Only a very light force is required. Disengaging the clasps any other way during normal every day usage is unnecessary and not recommended.

Throat Mic Optimization

For users with no prior experience with throat mics, please keep in mind the sound quality will never be as clear as a standard phone. This is because the audio is created from vibrations of the larynx through the body of the throat. Since air is not the medium, nasal sounds will be absent. Basically, the audio quality is similar to a person with a cold, hence the “muffled” sound that is commonly associated with throat mics.

That being said, the Stealth benefits from a vast improvement of sound quality through our in-house advancement.

It is important to note to **NOT HAVE THE THROAT MIC AND STRAP TOO TIGHT AROUND THE NECK**. When worn properly, the neck strap should rest on the back of the neck and only very little pressure should be felt.

Indicator LED Definitions

LED State	Description
Blue LED on once every second	All profiles on standby; Stealth not paired with any Bluetooth device
Blue LED flashes once every 2 seconds	Paired; Phone or Music profile connected
Blue LED flashes twice every 2 seconds	On music streaming state
Blue LED on once every second (during call)	On active call state
Red LED and Blue LED flash alternately	Pairing mode
When Red LED replaces any Blue LED indicators above	Low battery
Red LED on solid	Battery Charging

Stealth Features

- IP68 Ingress Protection Rating against dust and water
- Silicone surrounding all essential ports restricts entry of dust and dirt
- 5 hours talk time
- Adjustable neck strap
- Magnetic breakaway clasp
- Flexible silicone wing blade mounts for a customized angle fit

Background Noise Through Multi-Mic Mobile Devices

It has been brought to our attention that many new mobile devices on the market today have multiple mics, which are used in conjunction with wired headset and Bluetooth headset modes. For traditional condenser mics, this allows the phone to help cancel out background noises. However, these mobile devices, by design, have the tendency to naturally pick up slight background voices and certain sounds when the user is not speaking into a throat mic. Once the throat mic is being used, the background noise is again suppressed by the mobile phone's internal system; therefore it should not affect any communication.

Adjusting the Length of the Acoustic Coil

For customizing the length of the acoustic coil, you will need the included Acoustic Coil Customization Adaptor (IA-ACADP) in order to shorten the coil. Follow the instructions below.

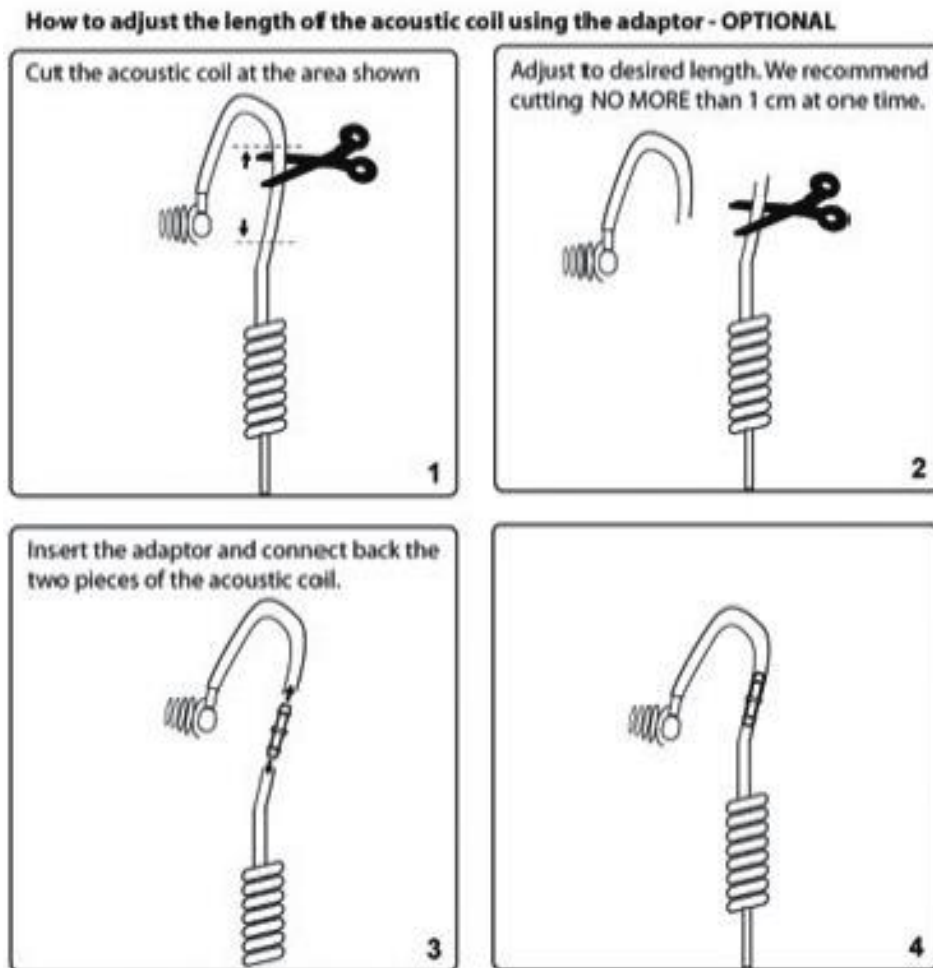

Step 1: Using a pair of scissors, cut the coil at the area shown in diagram 1.

Step 2: Cut the coil to your desired length. We recommend cutting no more than 1cm at a time.

Step 3: Insert the metal adaptor and connect the two piece of the coil.

Step 4: Put the acoustic coil back into the Acoustic Coil Attachment Module and test.

Note: Please double check the acoustic coil is to your desired length before cutting.

Frequently Asked Questions

Q: I paired the Stealth to my PC and when Windows tried to automatically install the drivers for the Stealth, it comes back with multiple “Bluetooth Peripheral Device – No Driver Found” errors. Where can I find the drivers?

A: This means Windows was not able to find any Bluetooth drivers for your PC hardware. Please ensure you have your computer manufacturer’s Bluetooth software suite installed and try to pair the Stealth again. It should automatically install all Bluetooth related functionalities of the Stealth upon pairing.

Q: I do not get any sound with my Acoustic Coil and the Helmet Speakers.

A: Please ensure the module attachment is screwed on tightly (not just finger tight) where the outer edge lines up with its base and the IASUS logo is perfectly horizontal. This confirms the module’s contacts are lined up and making a proper connection with the headset.

Warning: Any changes or modifications to this unit not expressly approved by the part responsible for compliance could void the user’s authority to operate the equipment.

This device complies with Part 15 of the FCC Rules. Operation is subject to the following two conditions:

- (1) this device may not cause harmful interference, and
- (2) this device must accept any interference received, including interference that may cause undesired operation.