

● Product Overview



Specification Remarks

- Not supported any use case of connecting with general smartphones.
- Pairing mode is locked when PDL is fully registered.

● Hardware Information

Topic	Value
Product type	Bluetooth® Headphone For dedicated RSI unit
Chipset	QCC3004
LED	RGB LED x1 (function) Red LED x1 (charging)
Button	4 buttons Power Volume Up/Down Channel Select (CS)
MIC	MEMS x1 *1
USB	USB type-C

*1. Always muted without factory test mode.

● Software Information

Topic	Value
ADK	ADK QCC300x 1.0.167
Bluetooth® version	Bluetooth® 5.0
Support profiles	A2DP v1.3.1 AVRCP v1.6 HFP v1.7
Support codecs	SBC
Multipoint	No
Pairing PIN	0000
PDL size	2 devices
BT Device Name	KT001 WH 01
BT VID source	USB Implementers Forum
BT Vendor ID	0x0230
BT Product ID	0x0012

● UI – Button operation

UI Event	User Action
Power on	Long press [PWR]
Power off	VLong press [PWR]
Enter pairing mode *1	Hold [PWR] after power on
Channel Switch	Short press [CS]
Volume up	Short press [Vol +] / Hold [Vol +]
Volume down	Short press [Vol -] / Hold [Vol -]
Factory Reset (Clear PDL)	VVLong press [PWR] & [CS] at power off
Enter Maintenance mode	VVLong press [PWR] & [Vol +] at power off
(Enter DUT mode)	VLong press [CS] & [Vol +] in maintenance mode
(Enter BCCMD mode)	VLong press [PWR] & [Vol -] in maintenance mode

***1. Pairing mode is locked when 2 devices are already paired.**

● Button Duration

UI Event	User Action
Short Press	Press and release within 800ms
Long Press	Press and hold for 1.0 sec long
Very Long Press	Press and hold for 2.0 sec long (In Factory Test Mode, 1.5 sec long)
Very Very Long Press	Press and hold for 3.5 sec long
Double Press	Press and release 2 times within 800ms
Triple Press	Press and release 3 times within 800ms

● UI – Function LED

LED Event	Image
Power On	
Power Off	
Connected	
Ch.1 selected	
Ch.2 selected	
Factory Reset	... flash 8 times

LED State	Image
Not Connected	
Pairing Mode	
Connected	
Maintenance mode	
DUT mode	
BCCMD Mode	No LED

● UI – Charging LED

LED State	Image
Charge in progress	
Charge completed	No LED
Charge Error	

How to pair 2 devices in Normal mode

1. System enters pairing mode automatically when PDL is empty.
2. In order to pair the 2nd device, press and hold the Power button for 2 seconds long in power off.

[Important]

In case that headset does not enter pairing mode, the key operation is locked.
It is necessary to clear PDL by executing factory reset.

Canada

This device contains licence-exempt transmitter(s)/receiver(s) that comply with Innovation, Science and Economic Development Canada's licence-exempt RSS(s). Operation is subject to the following two conditions:

1. This device may not cause interference.
2. This device must accept any interference, including interference that may cause an undesired operation of the device.

L'émetteur/récepteur exempt de licence contenu dans le présent appareil est conforme aux CNR d'Innovation, Sciences et Développement économique Canada applicables aux appareils radio exempts de licence. L'exploitation est autorisée aux deux conditions suivantes :

1. L'appareil ne doit pas produire de brouillage;
2. L'appareil doit accepter tout brouillage radioélectrique subi, même si le brouillage est susceptible d'en compromettre le fonctionnement.

This equipment complies with ISSED radiation exposure limits set forth for an uncontrolled environment and meets RSS-102 of the ISSED radio frequency (RF) Exposure rules as this equipment has very low levels of RF energy.

Cet équipement est conforme aux limites d'exposition aux rayonnements énoncées pour un environnement non contrôlé et respecte les règles d'exposition aux fréquences radioélectriques (RF) CNR-102 de l'ISDE puisque cet appareil a un niveau très bas d'énergie RF.

Mexico



La operación de este equipo está sujeta a las siguientes dos condiciones: (1) es posible que este equipo o dispositivo no cause interferencia perjudicial y (2) este equipo o dispositivo debe aceptar cualquier interferencia, incluyendo la que pueda causar su operación no deseada.

Korea

- Model name (KT001 WH 01)
- Manufacturer name (Foster Electric Co., Ltd.)
- Country of manufacture (China)

U.S.A

This device complies with part 15 of the FCC Rules. Operation is subject to the following two conditions:

- (1) This device may not cause harmful interference, and
- (2) this device must accept any interference received, including interference that may cause undesired operation

FCC CAUTION

Changes or modifications not expressly approved by the party responsible for compliance could void the user's authority to operate the equipment

- Properly shielded and grounded cables and connectors must be used for connection to host computers and / or peripherals in order to meet FCC emission limits.

Note: This equipment has been tested and found to comply with the limits for a Class B digital device, pursuant to part 15 of the FCC Rules. These limits are designed to provide reasonable protection against harmful interference in a residential installation. This equipment generates, uses and can radiate radio frequency energy and, if not installed and used in accordance with the instructions, may cause harmful interference to radio communications. However, there is no guarantee that interference will not occur in a particular installation. If this equipment does cause harmful interference to radio or television reception, which can be determined by turning the equipment off and on, the user is encouraged to try to correct the interference by one or more of the following measures: —Reorient or relocate the receiving antenna. —Increase the separation between the equipment and receiver. —Connect the equipment into an outlet on a circuit different from that to which the receiver is connected. —Consult the dealer or an experienced radio/TV technician for help.

This transmitter must not be co-located or operated in conjunction with any other antenna or transmitter.

This equipment complies with FCC radiation exposure limits set forth for an uncontrolled environment and meets the FCC radio frequency (RF) Exposure Guidelines as this equipment has very low levels of RF energy.

Nigeria

Connection and use of this communications equipment is permitted by the Nigerian Communications Commission

Oman

Oman-TRA
TRA/TA-R/XXXX/XX
Dealer No : D090024



EU



Information on Disposal of Old Batteries for Users in the European Union

This symbol on the product means that used batteries should not be mixed with general household waste. The correct disposal will help prevent potential negative effects on human health and the environment.

For proper treatment, recovery and recycling of old products, please take them to applicable collection points, in accordance with your national legislation.

For more information about collection and recycling of used products, please contact your local municipality, your waste disposal service or the point of sale where you purchased the items.

Information on Disposal in other Countries outside the European Union

This symbol is only valid in the European Union. If you wish to discard these items, please contact your local authorities or dealer and ask for the correct method of disposal.

Frequency Band: 2400-2483.5MHz
Frequency of Operation: 2402-2480MHz
Transmit Power: Typical: +0.5dBm, MAX: +3.5dBm

EU

Safety instructions for rechargeable Lithium-ion battery pack

This product has a built-in rechargeable lithium ion battery pack.

Danger

Do not use or handle the battery under the following conditions.

- use, storage or transportation of the battery in an excessively high or low temperature environment;
- disposal of a battery into fire or a hot oven, or mechanically crushing or cutting of a battery;
- leaving a battery in an extremely high temperature surrounding environment;
- leaving a battery in an extremely low air pressure surrounding environment;

Handling under the above conditions may cause battery leakage, and in extreme cases, explosion, heat generation, fire, smoke or gas generation.

Warning

- Do not charge a product with built-in rechargeable batteries if ambient temperatures above 0-45 °C.
- Product with built-in rechargeable batteries should not be heated to temperatures above 60 °C.
- Do not charge the product if there is a clear defect in the product that contains the rechargeable battery.

Disposal Method

- Dispose of product with built-in rechargeable batteries at special collection points or return them to your specialist dealer.



Information on Disposal for Users of Waste Electrical & Electronic Equipment

This symbol on the product means that used electrical and electronic equipment should not be mixed with general household waste.

The correct disposal will help prevent potential negative effects on human health and the environment.

For proper treatment, recovery and recycling of old products, please take them to applicable collection points, in accordance with your national legislation.

For more information about collection and recycling of used products, please contact your local municipality, your waste disposal service or the point of sale where you purchased the items.

For business users in the European Union

If you wish to discard electrical and electronic equipment, please contact your dealer or supplier for further information.

Information on Disposal in other Countries outside the European Union

This symbol is only valid in the European Union. If you wish to discard these items, please contact your local authorities or dealer and ask for the correct method of disposal.

CU declaration (Russia/Belarus/Kazachstan)

- Product name(Bluetooth® Headphone) and/or model name (KT001 WH 01)
- Manufacturer name and / or brand name (FOSTER ELECTRIC CO.,LTD.)
- Country of origin (China)
- The inquiry destination of the product
(Foster Electric Co., Ltd.
1-1-109, Tsutsujigaoka, Akishima City, Tokyo,
196-8550, Japan)



The Bluetooth® word mark and logos are registered trademarks owned by Bluetooth SIG, Inc. and any use of such marks by Foster Electric Company Limited is under license. Other trademarks and trade names are those of their respective owners.

Scope of Delivery

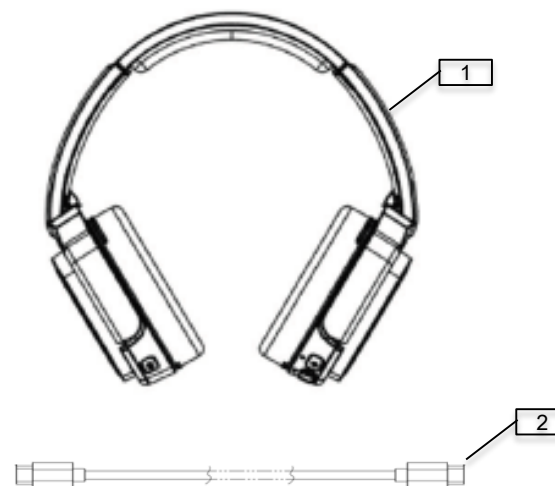

(1) Headphones

(2)¹ USB Cable

1 P/N:639725

Manufactured by

Name : Foster Electric Co., Ltd.
Address : 1-1-109, Tsutsujigaoka, Akishima City, Tokyo, Japan

Imported by

Name : Foster Electric (Europe) GMBH
Address : Gontenstrasse 21, 20097 Hamburg, Germany

Label Position (Behind Earpad)

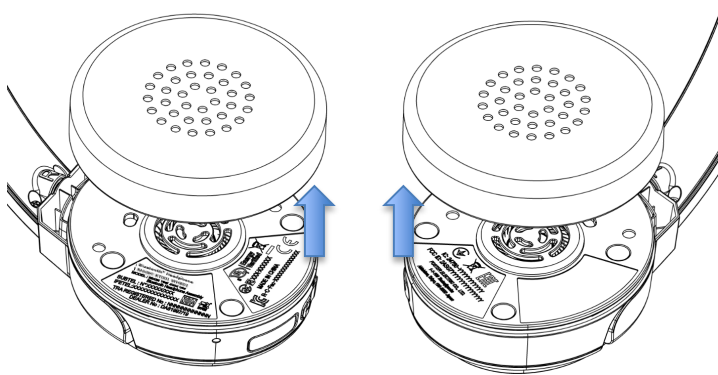

Detachable Earpad
Labels on headphone side.