

H19R Core

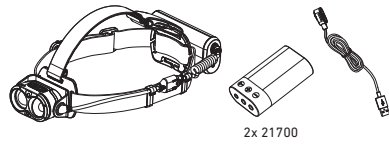

H19R Signature

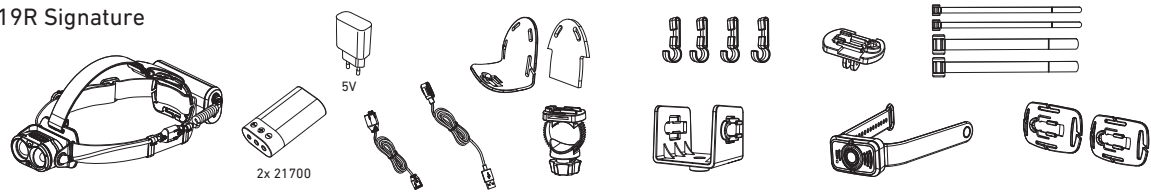

Operation

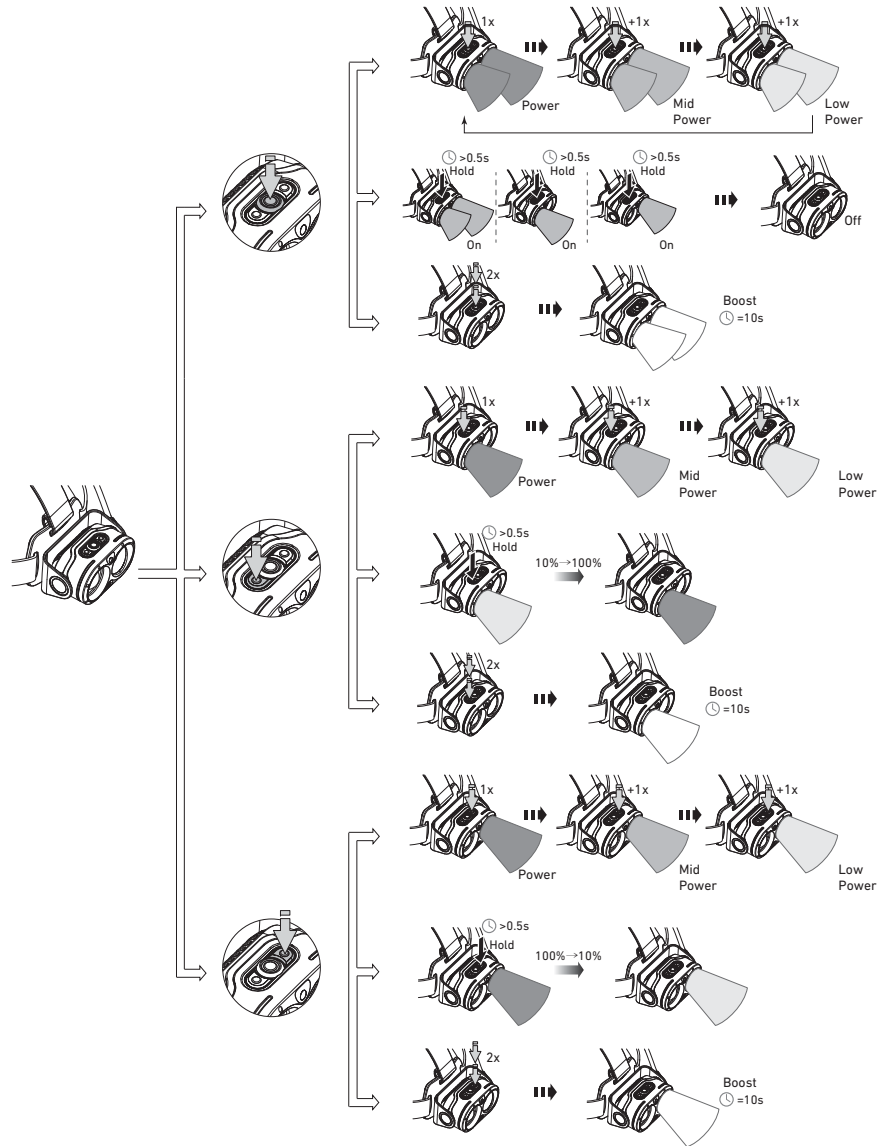

Battery Replacement

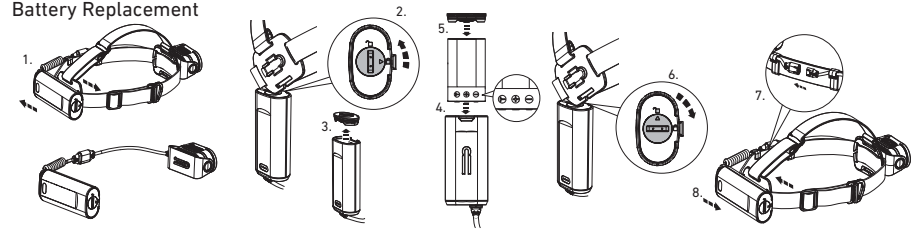

Transportation Lock

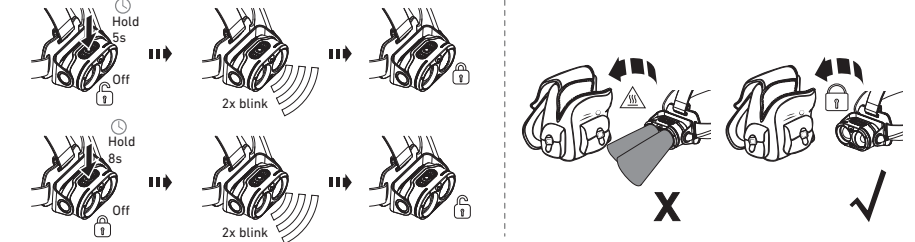

Red Mode

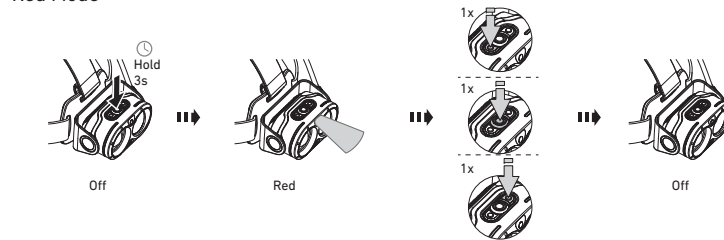

App Mode

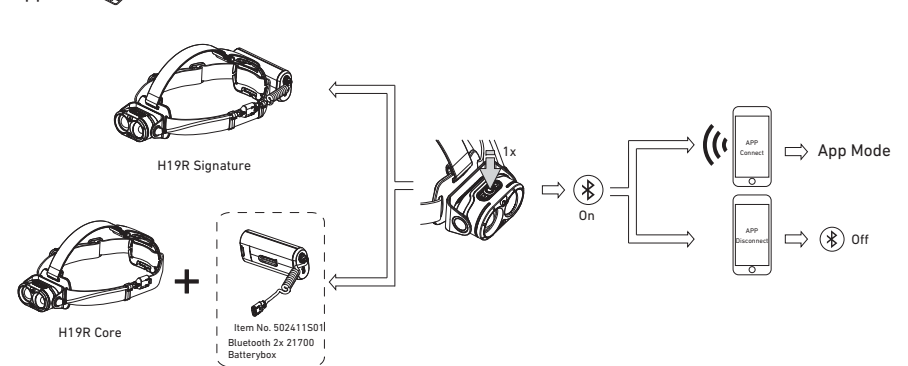

Battery Indicator

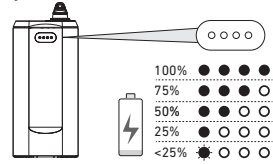

Backup Mode

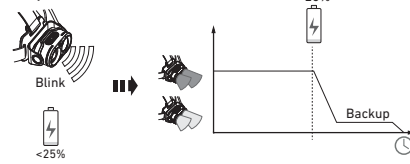

Lamp Head Rotation

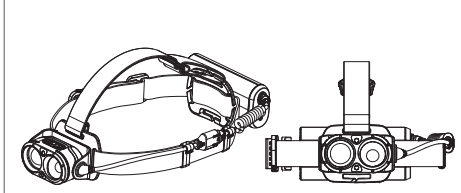
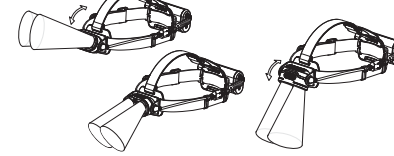

Magnetic Charging System

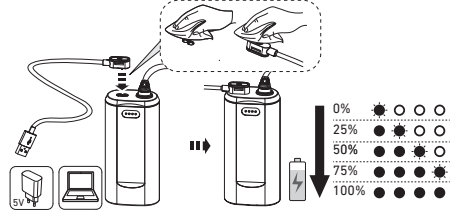

Extension Cable (H19R Signature)

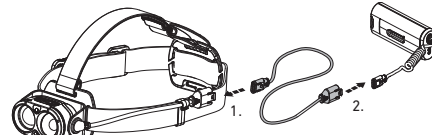

Helmet Fixing Clips (H19R Signature)

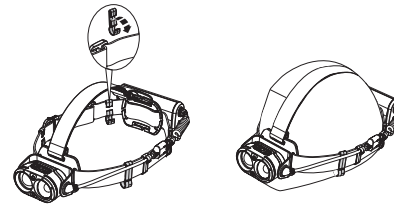

GoPro Mount (H19R Signature)

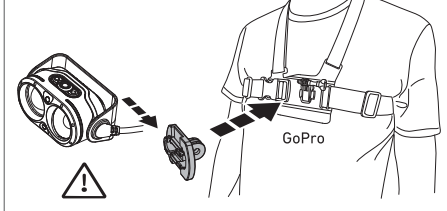

Tripod Mount (H19R Signature)

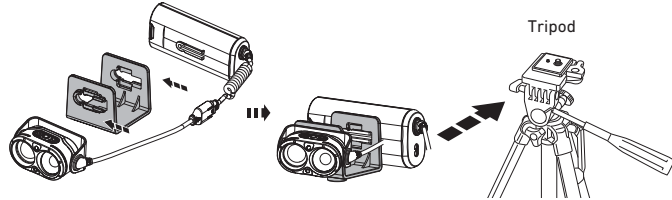

Helmet Connecting System (H19R Signature)

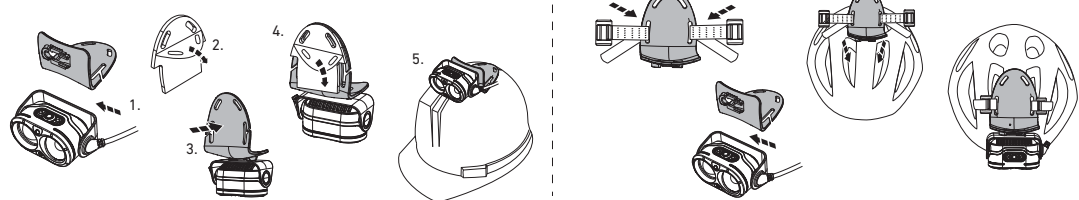

Universal Mounting Bracket (H19R Signature)

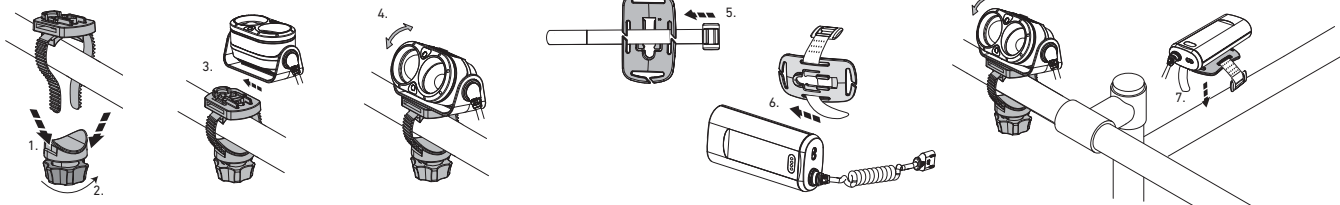

Recycling

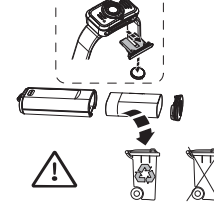

Remote Control (H19R Signature)

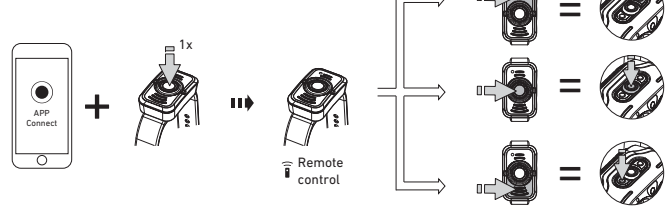

Further Information

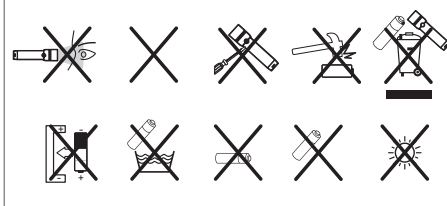
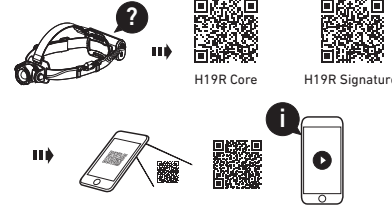

Battery Indicator (Remote Control)

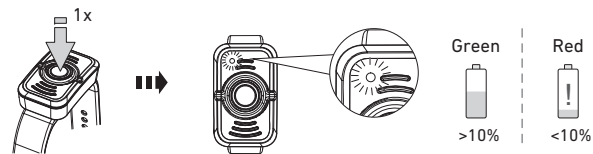

Battery Replacement (Remote Control)

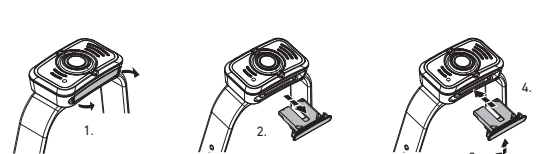

Ledlenser GmbH & Co. KG  
Kronenstr. 5-7 • 42699 Solingen • Germany  
Phone +49 212/5948-0 Fax +49 212/5948-200  
info@ledlenser.com



H19R\_V01  
19.06.2020  
1J12A0343

## **FCC Statement**

This device complies with Part 15 of the FCC Rules. Operation is subject to the following two conditions:

(1) This device may not cause harmful interference.

(2) This device must accept any interference received, including interference that may cause undesired operation.

2. Changes or modifications not expressly approved by the party responsible for compliance could void the user's authority to operate the equipment.

Note: This equipment has been tested and found to comply with the limits for a class B digital device, pursuant to Part 15 of the FCC Rules. These limits are designed to provide reasonable protection against harmful interference in a residential installation.

This equipment generates uses and can radiate radio frequency energy and, if not installed and used in accordance with the instructions, may cause harmful interference to radio communications. However, there is no guarantee that interference will not occur in a particular installation. If this equipment does cause harmful interference to radio or television reception, which can be determined by turning the equipment off and on, the user is encouraged to try to correct the interference by one or more of the following measures:

- Reorient or relocate the receiving antenna.
- Increase the separation between the equipment and receiver.
- Connect the equipment into an outlet on a circuit different from that to which the receiver is connected.
- Consult the dealer or an experienced radio/TV technician for help.

The device has been evaluated to meet general RF exposure requirements. The device can be used in portable exposure conditions without restriction.