



### In The Box

Headphones x 1 Pair  
Charging Case x 1

Type-C Charging Cable x 1

Silicone Ear Tip x 3 Pairs (XS/S/L)

User Guide x 1

Warranty Card x 1

1MORE Bear Sticker x 1

### Product Overview

Charging Contacts

Silicone Ear Tip

Infrared Sensor

Voice Mic / LED

Pairing Button

LED Indicator

Charging Case

### Placement

XS  
S  
M  
L

### Power

**Power On:** Open the charging case (with charge), the headphones will turn on automatically.

**Power Off:** Put the headphones back into the correct slot of the charging case and close the lid, they will automatically turn off and start charging.

\* Above functions are available for either earbud in individual or Stereo mode.

### Headphones Pairing

The Left and Right headphones will automatically pair to each other after the lid is open when they are in the case (with charge).

### Bluetooth Pairing To The Device

To connect to your device for the first time, turn the headphones on to enter the pairing mode, the Right headphone will flash in white alternatively. Headphones will enter a standby mode if not paired to a device within 3 minutes.

\* After the first successful pairing, headphones will automatically connect to your device.

\* Above functions are available for either earbud in individual or Stereo mode.

To pair the headphones to a new device, simply place them into the charging case and triple tap the pairing button. Then click "1MORE ComfoBuds Mini" in the new device pairing list to connect.

### Charging

① To charge the case with Type-C cable.

A full charge will take around 85 minutes.

The LED light of the charging case will indicate different battery statuses.

\* The headphones are certified by Qi wireless charging, please use a Qi certified charging pad to ensure charging safety and efficiency.

② To charge the headphones with the case.

Put headphones in correct slot until it locks in via the magnet. The white light of headphones will indicate headphones are charging.

A full charge will take around 70 minutes. The red light on the headphones turning off indicates the charging is complete.

### Battery Status Display in 1MORE MUSIC APP

Battery status of headphones and charging case will be displayed in 1MORE MUSIC APP.

### Battery Notification

LED indicator for low battery: when there is 25-30 minutes of use left, you will hear a voice prompt.

When the charge is too low on the case battery, the LED indicator will flash red.

### Touch Controls

Switch the Listening Modes

The default setting of the headphones is "ANC Off". touch and hold on the outside of the headphone to switch between "ANC Off", "ANC On" and "Pass-through". The brand new QuietMax Adaptive Noise Cancellation technology is included which dynamically detects the real-time noise levels outside and intelligently reduce the noise immediately. Phonecalls and music can be controlled by tapping the outside of the earbuds.

**Phone Call**

- Answer: Double tap
- End call: Double tap
- Voice control on cellphone: Triple tap (Bluetooth on and no phone calls)

**Playback**

- Play/Pause: Double-tap

\* Above functions are available for either earbud in individual or stereo mode.  
\* To decline a call, change a song or control volume, please operate on 1MORE MUSIC APP, paired mobile phone or device.  
\* Above functions may vary with different devices.

### Smart Playback

An IR Sensor automatically detects when you take out your headphones to stop playback intuitively and resumes playback when you put them back in.

To turn off Auto-Play, connect the headphones to the 1MORE MUSIC App and change in the settings.

### Personalized Sound Enabled by SoundID

1MORE MUSIC APP features personalized sound technology - SoundID from Sonarworks. Based on professional music-producing reference standard, SoundID serves simple A/B tests to deliver sound profile based on listener's individual preferences. Click "SoundID" in the App to maximize your listening experience on ComfoBuds Mini with a personalized sound profile.

### Switch Listening Modes via APP

Enter the 1MORE ComfoBuds Mini home page in 1MORE MUSIC APP after pairing to your cellphone, then you can switch listening modes between "Music" and "Soothing".

### Soothing Sounds

Click the "Soothing Sounds" to enter the playlist.

Click "+" to select the sound to be downloaded to your headphones for listening.

Click the timer icon in song page to set up the playtime.

\* Playback and volume adjustment for the soothing sounds can only be implemented via APP.

### Extra Functions

- If only 1 headphone can be paired to the device, Open the case, click the pairing button in the case 3 times quickly to initiate a Left & Right pairing, and then click "1MORE ComfoBuds Mini" in the device pairing list to connect to your device.
- Restore Factory Settings: Put both Left and Right earbuds into the case, triple tap the pairing button, the earbuds will initiate pairing to each other again.
- Clear The Pairing Records: Put both Left and Right earbuds into the case, press and hold the pairing button for 8 seconds, the pairing records will be cleared.
- OTA Firmware Update: can be done synchronously via the 1MORE MUSIC APP while the Left and Right earbuds are paired to each other with at least 50% battery.

\* Functions of 1MORE MUSIC APP may vary with different cellphones or operating systems. For more details, please contact our customer service.

### 1MORE (1) Year Limited Warranty

1MORE warrants to the original retail purchaser that this product is to be free from defective materials and workmanship for a period of one year from the date of purchase if it is properly used and maintained. If this product proves defective in either material or workmanship, 1MORE, at its option, will (a) repair the product with new or refurbished parts, or (b) replace the product with an equivalent new or refurbished product, at no charge for parts or labor. If the product model is no longer available and cannot be repaired effectively or replaced with an identical model, 1MORE at its sole option may replace the unit with a current model of equal or greater value. In some cases, modification to the mounting surface may be required where a new model is substituted. 1MORE assumes no responsibility or liability for such modification. TO OBTAIN A REPAIR OR REPLACEMENT UNDER THE TERMS OF THIS WARRANTY, PLEASE RETURN TO THE ORIGINAL DEALER FIRST AND THE ORIGINAL DEALER SHALL REPAIR THE PRODUCT WITH NEW OR REFINISHED PARTS OR REPLACE THE PRODUCT WITH AN EQUIVALENT NEW OR REFINISHED PRODUCT. You will be required to submit a proof of purchasing details, including but not limited to a receipt or sales invoice. Return shipping for exchanges/repairs is the sole responsibility of the original retail purchaser.

Limitations:

- This limited warranty does not cover the failure of the product resulting from improper installation, misuse, abuse, accident, neglect, mishandling, or wear from ordinary use or environmental deterioration.
- This limited warranty does not cover cosmetic damage, including paint damage, or consequential damage to other components or premises which may result for any reason from the failure of the product.
- This limited warranty is null and void for products not used in accordance with 1MORE's instructions.
- This limited warranty is null and void for products with altered or missing serial numbers and for products not purchased from an AUTHORIZED dealer.
- This limited warranty terminates if you sell or otherwise transfer this product to another party.

### We Appreciate Your Business

We know you will enjoy new 1MORE headphones as much as we do. At 1MORE, we value your satisfaction. If you would like more details on this product or any of our other products, please visit us online by scanning the QR code. Go to [www.1more.com](http://www.1more.com) and sign up for VIP; and 1MORE will treat you like one.

### Tips

- Please read this instruction manual carefully and retain for future reference.
- Please fully charge the battery before first use.
- If the headphones have been unused for more than 3 months, we recommend that you charge them. This will improve battery capacity.
- Only use charging cables and adapters that are FCC (Federal Communications Commission) approved.
- In dry environments, static electricity may numb your ear. This is not related to the quality of the product.

### Safety Information

- Never disassemble the headphones. There are no user-serviceable parts inside.
- Do not expose the headphones to temperatures below 32°F (0°C) or to temperatures above 113°F (45°C).
- Do not use the headphones in a thunderstorm storm. This could prevent the headphones from working properly, and also increase your chance of being electrically shocked.
- Do not use oil or any volatile liquid to clean this product.
- Do not listen at high volumes for extended periods of time.
- Do not use the headphones in traffic. Do not use the headphones any time it would be dangerous to be unaware of noises around you.
- Adult supervision is required for children of age 6 and under.
- If you don't feel comfortable after wearing the headphones, please refer to an ear-aur for advice on whether in-ear headphones are suitable for you.

### FAQ

- Why the headphones cannot be turned on?  
Check if your headphones have enough battery life. If not, please charge them for at least 30 minutes.
- Why the headphones cannot connect to my cellphone, or take a long time to connect?  
1) If headphones cannot pair normally when power on. Open the case, triple tap the pairing button to initiate searching for Left & Right pairing, and then click "1MORE ComfoBuds Mini" in the device pairing list.  
2) To pair the headphones to a new device, simply place them into the charging case and triple tap the pairing button. Then click "1MORE ComfoBuds Mini" in the new device pairing list to connect.
- Why the headphones cannot play music after successfully connecting to my Android device?  
After pairing successfully, on the Bluetooth menu of your device, tap the icon on the right of your device name and make sure the "Media Audio" option is on.
- Why there is no sound from the headphones while making phone calls after successfully connecting to my Android device?  
After pairing successfully, on the Bluetooth menu of your device, tap the icon on the right of your device name and make sure the "Phone Audio" option is on.
- Why the Bluetooth connection is not stable and causes some interruptions?  
1) Try shortening the distance between your headphones and device. Avoid solid barriers in between.  
2) Please keep away from strong interference sources, such as Wi-Fi and GPRS.  
3) Please make sure the Bluetooth antenna of your device is not blocked.
- Why some control functions do not match those in the manual while using third party music/video player Apps?  
Your operating system and the third party music/video player apps may have different settings for the in-line remote control functions. We recommend that you use the music/video player apps that your device has originally provided.

\* For more detailed product FAQs, please visit the product support section under [www.1more.com](http://www.1more.com)

### WEEE

Electrical and electronic equipment, parts and batteries marked with this symbol must not be disposed of with normal household waste, it must be collected and disposed of separately to protect the environment.

Your 1MORE retailer will advise you of the correct way of disposal in your country.

### Safety Caution

Do not expose batteries or battery packs to excessive heat such as sunshine, fire or the like.

### CE

Declaration of Conformity Hereby, Tinlab Corporation Limited declares that the radio equipment type 1MORE ComfoBuds Mini of ES603 is in compliance with Directive 2014/53/EU. The full text of the EU declaration of conformity is available at the following internet address: [www.1more.com](http://www.1more.com)

RF exposure information: The device has been evaluated to meet general RF exposure requirement. The device can be used in portable exposure condition without restriction. Radiation Exposure Statement Power is so low that no RF exposure calculation is needed.

Declaration for EU Compliance  
Operation Frequency/Max. EIRP:2402-2480MHz, Max. EIRP is 5dBm.

### Warning

Replacement of a battery with an incorrect type that can defeat a safeguard (such as catching fire, explosion, leakage of corrosive electrolyte etc);  
Disposal of a battery into fire or a hot oven, or mechanically crushing or cutting of a battery, that can result in an explosion;  
Leaving a battery in an extremely high temperature surrounding environment that can result in an explosion or the leakage of flammable liquid or gas; and A battery subjected to extremely low air pressure that may result in an explosion or the leakage of flammable liquid or gas.

⎓ The symbol indicates DC voltage.

♻️ RECYCLING

This product bears the selective sorting symbol for Waste electrical and electronic equipment (WEEE). This means that this product must be handled pursuant to European directive 2012/19/EU in order to be recycled or dismantled to minimize its impact on the environment.

User has the choice to give his product to a competent recycling organization or to the retailer when he buys a new electrical or electronic equipment.

⚠️ To prevent possible hearing damage, do not listen at high volume levels for long periods.

### FCC

The SAR limit of USA (FCC) is 1.6 W/kg for head averaged over one gram of tissue. Device types ES603 (FCC ID: 2ASDIES603R, FCC ID: 2ASDIES603L) has also been tested with 0mm against this SAR limit.

This device complies with part 15 of the FCC rules. Operation is subject to the following two conditions: (1) this device may not cause harmful interference, and (2) this device must accept any interference received, including interference that may cause undesired operation.

NOTE: The manufacturer is not responsible for any radio or TV interference caused by unauthorized modifications or changes to this equipment. Such modifications or changes could void the user's authority to operate the equipment.

NOTE: This equipment has been tested and found to comply with the limits for a Class B digital device, pursuant to part 15 of the FCC Rules. These limits are designed to provide reasonable protection against harmful interference in a residential installation. This equipment generates uses and can radiate radio frequency energy and, if not installed and used in accordance with the instructions, may cause harmful interference to radio communications. However, there is no guarantee that interference will not occur in a particular installation. If this equipment does cause harmful interference to radio or television reception, which can be determined by turning the equipment off and on, the user is encouraged to try to correct the interference by one or more of the following measures:

- Reorient or relocate the receiving antenna.
- Increase the separation between the equipment and receiver.
- Connect the equipment into an outlet on a circuit different from that to which the receiver is connected.
- Consult the dealer or an experienced radio/TV technician for help.

Supplier's Declaration of Conformity  
47 CFR § 2.1077 Compliance Information  
Trade Name: 1MORE  
Model No.: ES603  
Responsible Party - U.S. Contact Information  
1MORE USA, Inc.  
Address: 10225 Barnes Canyon Road, Suite A202, San Diego, California, 92121  
Tel: 1-855-551-6673  
E-Mail: [support@1moreusa.com](mailto:support@1moreusa.com)

### IC regulatory conformance

This device complies with CAN ICES-003 (B)/NMB-003(B) and CAN RSS-216 / CNR-216 . This device contains licence-exempt transmitter(s)/receiver(s) that comply with Innovation, Science and Economic Development Canada's licence-exempt RSS(s). Operation is subject to the following two conditions:  
(1) This device may not cause interference.  
(2) This device must accept any interference, including interference that may cause undesired operation of the device.  
Cet appareil est conforme à la norme CAN ICES-003 (B)/NMB-003 (B) et CAN RSS-216 / CNR-216 . Cet appareil contient des émetteurs / récepteurs exempt (s) de licence qui sont conformes aux RSS exemptes de licence d'Innovation, Sciences et Développement économique Canada. Son fonctionnement est soumis aux deux conditions suivantes:  
(1) Cet appareil ne doit pas provoquer d'interférences.  
(2) Cet appareil doit accepter toute interférence, y compris les interférences susceptibles de provoquer un fonctionnement indésirable de l'appareil.

The SAR limit of Canada (ICES) is 1.6 W/kg for head averaged over one gram of tissue. Device types ES603 (IC:24662-ES603R, IC:24662-ES603L) has also been tested with 0mm against this SAR limit.

Name: Wireless Earphones  
Model: ES603  
Headphone Weight: 3.7 g  
Case Weight: 34.9 g  
Product Weight: 42.3 g  
Headphone Size: 17 × 15 × 13 mm  
Case Size: 56.5 × 50 × 24.5 mm  
Headphone Battery Capacity: 34 mAh  
Case Battery Capacity: 440 mAh  
Headphone Charging Time: 70 mins  
Case Charging Time (with cable): 85 mins  
Fully Charged: 5 hours (ANC On)  
Headphone: 5 hours

Headphones + Case: 20 hours  
Fully Charged Playtime (ANC Off)  
Headphones: 6 hours  
Headphones + Case: 24 hours  
Headphone playtime (BLE): 8 hours  
Impedance: 32 Ω  
Wireless Range: 10 m  
Bluetooth: Bluetooth® 5.2  
Bluetooth Protocol: HFP / A2DP / AVRCP  
Input: 5V=1A  
Working Temperature: 0°C - 45°C  
Frequency Band: 2.400 GHz - 2.4835 GHz

\* The specifications are acquired from laboratory tested data.  
\* The playtime, tested under the laboratory condition of AAC format and 50% volume, may vary with different device setting, environments, usage and other factors.

Manufacturer: Tinlab Corporation  
Add: No. 8333, Lixuan Avenue, Tower A, 35th Floor, Tangliang City, Nanshan District, Shenzhen, China  
Product information can be found at [www.1more.com](http://www.1more.com)

### 包裝內容

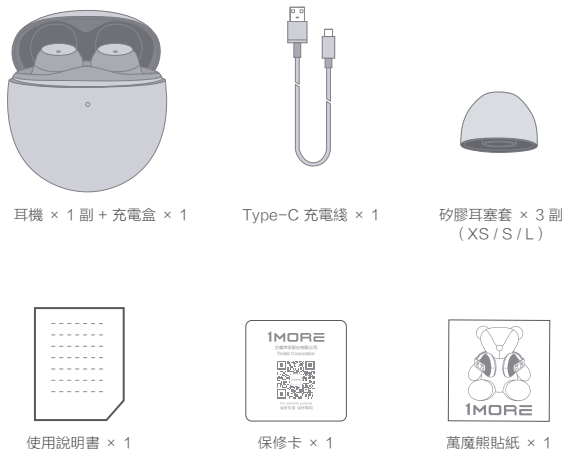

### 產品概覽

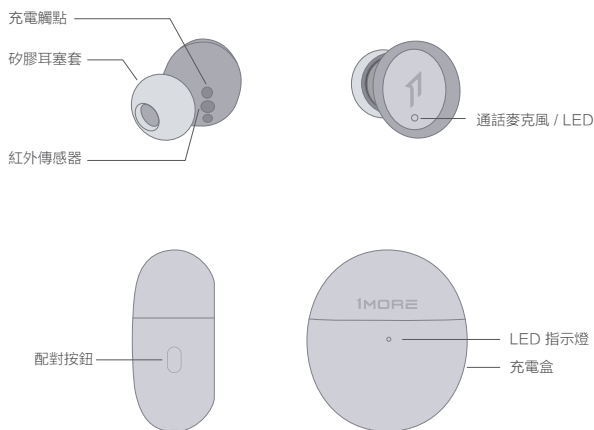

### 耳機佩戴

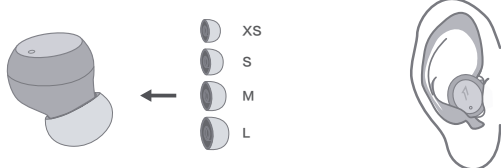

### 開 / 關機

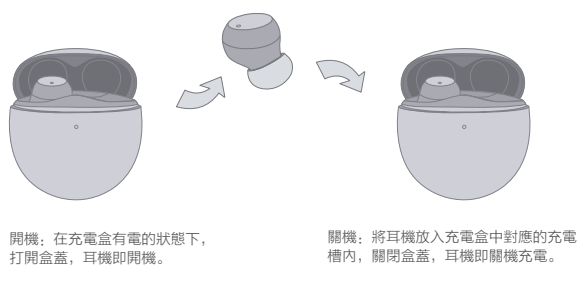

### 左、右耳機配對



### 耳機與藍牙設備配對

首次使用，開機後右耳機白燈快閃進入搜索模式。3 分鐘後未連接到設備，耳機進入待機狀態。

\* 已連接過設備的耳機，將自動與該設備進行藍牙配對。

\* 上述功能適用於單、雙模式使用時的任一耳機。

如需與新設備連接，將左、右耳機放回盒內，三擊配對按鈕，點擊新設備配對列表中的“1MORE ComfoBuds Mini”進行連接。

### 充電 ① 使用 Type-C 充電線給充電盒充電

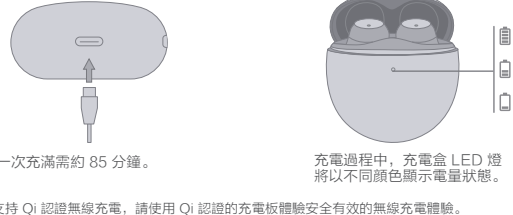

### ② 使用充電盒為耳機充電

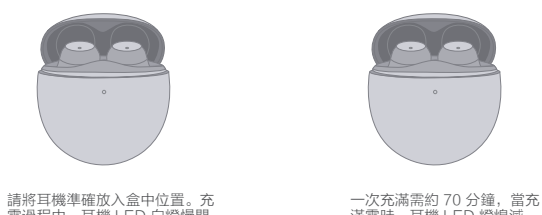

### 1MORE MUSIC APP 電量顯示

耳機與充電盒的電量狀態將在 1MORE MUSIC APP 中顯示。

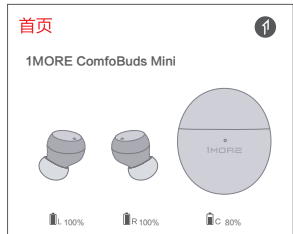

### 電量提示



### 觸控功能

切換聆聽模式切換  
耳機出廠設置為“降噪開”，長觸耳機表面（約 1.5 秒）可在“降噪開”、“降噪閉”與“通透模式”模式間切換。  
主動降噪加載全新 QuietMax 自適應降噪技術，實時判斷所在環境的噪聲強度，自動進行智能降噪。  
通話和播放功能可通過觸擊耳機表面來實現。



\* 上述功能適用於單、雙模式使用時的任一耳機。  
\* 拒接電話、選曲及音量調節，請在 1MORE MUSIC APP 及手機等設備端進行操作。  
\* 以上功能定義因設備不同可能略有差異。

### 自動暫停 / 播放功能

紅外傳感器將對耳機的使用狀態進行即時智慧偵測。當播放過程中取下耳機，播放內容將自動暫停；戴上後，繼續播放。

1MORE MUSIC APP 可關閉“自動播放”功能。



### SoundID 錄音室級個性化音效設定

1MORE MUSIC APP 採用 SoundID 個性化音效定制技術，基於專業音樂製作參考標準，可測算出更匹配雙耳的音效，並將其固化到耳機，隨時體驗個人專屬的聆聽風格。

APP 首頁，點擊“SoundID”可進行設置。



### APP 切換音質風格

耳機與 1MORE MUSIC APP 連接後，進入 1MORE ComfoBuds Mini 界面，可自選切換“音樂”和“舒眠”音質風格。



### 舒眠旋律

頁面中點擊“舒眠旋律”，可進入對應舒緩歌單界面。

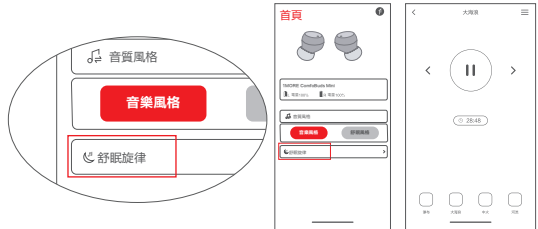

點擊“+”添加想要聆聽的旋律，即可同步下載至耳機中進行聆聽。



點擊曲目界面中的計時器圖標，可自行設定播放時長。

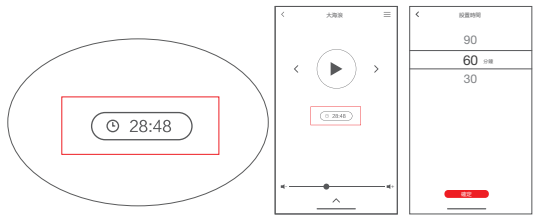

\* 舒眠旋律的播放控制盒音量調節，僅支持在 APP 中該曲目界面中進行操作。

### 其它功能

- 如左、右耳機無法配對，僅有單個耳機可與藍牙設備連接，可將左、右耳機放入盒中，三連擊配對按鈕，再點擊藍牙設備配對列表中的“1MORE ComfoBuds Mini”進行連接。
- 耳機恢復出廠設置：  
將左、右耳機放入充電盒中，三擊充電盒配對按鈕，左、右耳機重新自動配對。
- 清除配對記錄：  
將左、右耳機放入充電盒中，長按充電盒配對按鈕 8 秒，可強制清除耳機與藍牙設備的連接記錄。
- OTA 韌體升級：左、右耳機藍牙連接且電量不低於 50% 時，可直接在 1MORE MUSIC APP 上同步升級。

\* 1MORE MUSIC APP 的所有功能，在不同手機及操作系統上或有不同，請聯繫客服了解更多詳情。

### 保固範圍

1MORE 保證消費者自初次購買之日起一年內，對 1MORE 產品在正常使用中材料和工藝上的缺陷進行保修。在保固範圍內，1MORE 會直接受理您的申訴（包括從 1MORE 授權的經銷商處購買的 1MORE 產品）。在保固期內，1MORE 將自行決定修理或更換有缺陷產品或按照購買價格進行退款。本保固不適用於天災意外或使用、保養、維修不當，或是其他不是由材料，工藝上的缺陷引起的情況。完整的保固細節請登錄 [www.1more.com](http://www.1more.com) 查看。

### 感謝您的購買

我們知道您會享受並喜愛 1MORE 耳機。在 1MORE 我們格外重視您的滿意度，如果您想要了解更多產品的訊息請掃描背面的二維碼，進入 [www.1more.com](http://www.1more.com) 登錄成為 VIP，1MORE 將提供您專業的服務。

### NCC

取得審驗證明之低功率射頻器材，非經核准，公司、商號或使用者均不得擅自變更頻率、加大功率或變更原設計之特性及功能。  
低功率射頻器材之使用不得影響飛航安全及干擾合法通信；經發現有干擾現象時，應立即停用，並改善至無干擾時方得繼續使用。  
前述合法通信，指依電信管理法規作業之無線電通信。  
低功率射頻器材須忍受合法通信或工業、科學及醫療用電波輻射性電機設備之干擾。

型號：ES603	滿電播放時長（降噪開）
單耳機重量：3.7 g	單耳機：6 小時
充電盒重量：34.9 g	搭配充電盒：24 小時
整機重量：42.3 g	BLE 單耳播放時長：8 小時
耳機尺寸：17 × 15 × 13 mm	喇叭阻抗：32 Ω
充電盒尺寸：56.5 × 50 × 24.5 mm	通訊距離：10 米（在空曠環境下）
單耳機電池容量：34 mAh	藍牙規範：Bluetooth® 5.2
充電盒電池容量：440 mAh	藍牙協定：HFP / A2DP / AVRCP
耳機充電時間：70 分鐘	輸入：5V = 1A
充電盒充電時間（有線）：85 分鐘	工作溫度：0 °C ~ 45 °C
滿電播放時長（降噪閉）	頻率波段：2.400 GHz ~ 2.4835 GHz
單耳機：5 小時	
搭配充電盒：20 小時	

規格參數為實驗室測試數據。  
\* 播放時長為 AAC 格式、50% 音量條件下的實驗室測試數據，依設備設置、環境、使用情況及諸多其他因素可能有所差異。

製造商：萬魔聲學股份有限公司  
地址：深圳市南山區留仙大道 3333 號塘朗城 A 座 35 樓

