

材质: 80G书纸+胶装
尺寸: 86*98mm

封底

TINLAB



www.1more.com

制造商: 万魔声学股份有限公司
地址: 深圳市南山区留仙大道 3333 号塘朗城 A 座 35 楼
联系电话: 400-992-0909
Manufacturer: Tinlab Corporation
Add: No. 3333, Lixian Avenue, Tower A, 35th Floor,
Tanglang City, Nanshan District, Shenzhen, China

CCC: COCERUP140211
CCC: COCERUP140211
CCC: COCERUP140211

R-R-IC-ES602

210-160025

FCC ID: 2ASDIES602L
FCC ID: 2ASDIES602R

CMIT ID: 2021DP6872
HVIN: ES602L
HVIN: ES602R

IC: 24662-ES602L
IC: 24662-ES602R

CE, 10, Recycle, EAC, etc.

封面

ES602



1MORE ColorBuds 2 时尚豆 用户指南
1MORE ColorBuds 2 User Guide

1MORE MUSIC APP



中国内地用户可扫描二维码, 下载 1MORE MUSIC APP 进行产品升级, 体验更完整的功能。

1MORE MUSIC APP

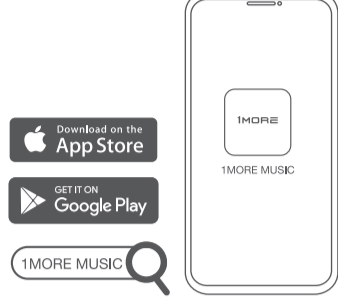

For users outside mainland China, please download the 1MORE MUSIC APP for product upgrades and additional features. 中国内地以外的用户可下载 1MORE MUSIC APP 进行产品升级, 体验更完整的功能。

筒中

包装内容

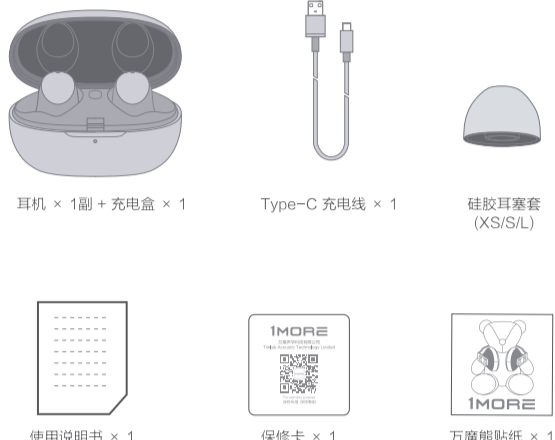

产品概览

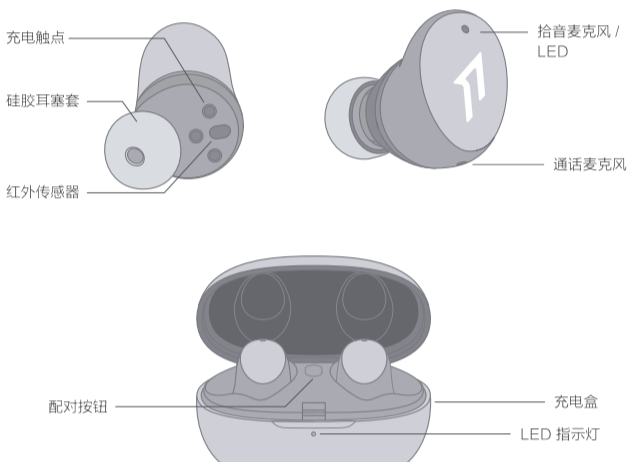

左、右耳机配对

在充电盒有电的状态下, 如左、右耳机置于盒内, 打开盒盖, 左、右耳机即自动配对。



耳机与蓝牙设备配对

首次使用, 开机后其中右耳机白灯闪烁进入搜索模式, 3 分钟后未连接到设备, 耳机进入待机状态。

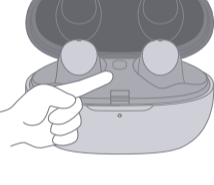

* 上述功能适用于单、双模式使用时的任一耳机。

耳机佩戴



开 / 关机

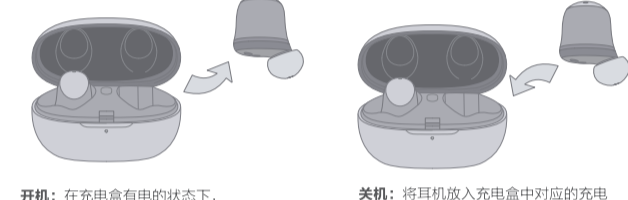

* 上述功能适用于单、双模式使用时的任一耳机。

充电 ① 使用 Type-C 充电线给充电盒充电

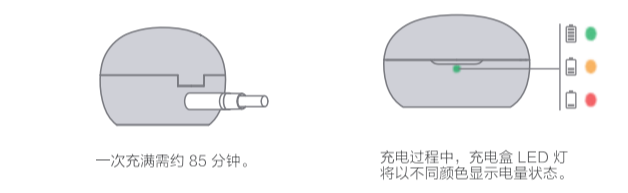

② 使用充电盒给耳机充电

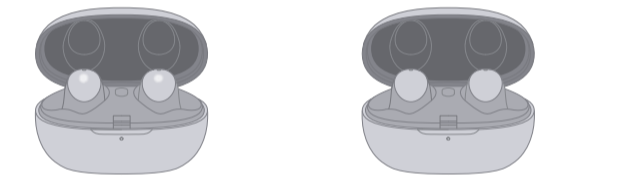

触控操作



* 上述功能适用于单、双模式使用时的任一耳机。
* 拒接电话、语音及音量调节, 请在 1MORE MUSIC APP 及手机等设备上进行操作。
* 以上功能定义因设备不同可能略有差异。

1MORE MUSIC APP 电量显示

耳机与充电盒电量状态将在 1MORE MUSIC APP 中显示。



电量显示



自动暂停 / 播放功能

红外传感器将对耳机的使用状态进行实时智能检测。当播放过程中取下耳机, 播放内容将自动暂停; 戴上后, 继续播放。

关闭“自动播放”功能, 可通过 1MORE MUSIC APP 进行设置。

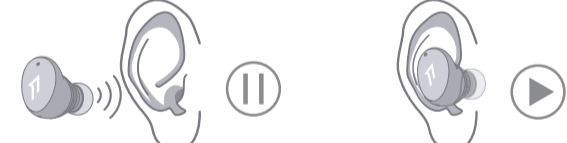

SoundID 录音室级个性化音效设定

1MORE MUSIC APP 采用 SoundID 个性化音效定制技术, 源自专业音乐制作参考标准, 可测算出更匹配双耳的音效, 并将其固化到耳机, 随时随个人专属的聆听风格。APP 首页, 点击“SoundID”可进行设置。

其它功能

- 如左、右耳机无法配对, 仅有单个耳机可与蓝牙设备连接, 可将左、右耳机放入盒中, 三点击配对按钮, 再点击蓝牙设备列表中的“1MORE ColorBuds 2”进行连接。
- 耳机恢复出厂设置: 将左、右耳机放入充电盒中, 长按充电盒配对按钮 8 秒, 左、右耳机重新自动配对, 且蓝牙设备的连接记录将被强制清除。
- OTA 固件升级: 左、右耳机蓝牙连接时, 可直接在 1MORE MUSIC APP 上同步升级。

* 1MORE MUSIC APP 的所有功能, 在不同手机及操作系统上使用或有不同, 请联系客服了解更多详情。

售后产品保修说明

1MORE ColorBuds 2 时尚豆产品售后服务依照《中华人民共和国消费者权益保护法》、《中华人民共和国产品质量法》实行产品售后服务, 服务内容如下: 在产品自购买之日起一年的免费保修期内, 您可依照本规定享受退货、换货、维修的权利, 修理、换货、退货应当凭相关订单号或发票办理。

- 7 日无理由的退货 (电商渠道), 由用户承担物流费用;
- 免费维修或以换代修的产品, 保修期仍然按原产品的购买日期计算一年免费保修期。
- 本产品出现《产品性能故障表》所列性能故障的情况, 经检测确认后, 可以享受如下服务:

| 服务类型 | 服务政策 |
|------|----------------------|
| 退货 | 自签收次日起 7 天内产品质量原因退货 |
| 换货 | 自签收次日起 15 天内产品质量原因换货 |
| 维修 | 自签收次日起 1 年内产品质量原因维修 |

产品性能故障表

| 名称 | 性能故障 |
|-----------------------|----------------|
| 1MORE ColorBuds 2 时尚豆 | 蓝牙耳机听不到声音 |
| | 通话过程中, 对方听不到声音 |
| | 无法为蓝牙耳机充电 |
| | 配对按钮功能失效 |

本表格依据 SJ/T 11364 的规定编制。
○: 表示该有害物质在该部件所有均质材料中的含量 GB/T 26572 规定的限量要求以下。
×: 表示该有害物质至少在该部件的某一均质材料中的含量超出 GB/T 26572 规定的限量要求。

提示

- 使用产品前请仔细阅读本使用说明书并妥善保管;
- 首次使用, 请先将本产品充满电;
- 如果产品长期 (超过 3 个月) 不使用, 请对其充电;
- 必须在干燥环境下使用, 避免在潮湿、多尘、多盐雾等环境下使用, 避免在强电磁干扰环境下使用;
- 在干燥环境佩戴, 静电可能会触到耳朵产生瞬间发麻的感觉, 这与产品质量无关。

警告

- 请勿以任何理由拆卸或修改耳机, 否则可能会导致火灾、电子击穿甚至彻底损坏本产品;
- 请勿将设备置于温度过低或过高 (0℃ 以下或 45℃ 以上) 的环境中;
- 请勿在雷暴天气下使用该设备, 雷暴可能导致设备工作不正常, 并增加触电的危险;
- 请勿用油及其它挥发性液体擦拭本产品;
- 请勿连续长时间佩戴耳机 (超过 6 小时), 尤其不要长时间开最大音量听耳机;
- 请勿在骑车或开车的状态下佩戴耳机, 因为这种行为在某些国家属于违法行为;
- 6 岁以下儿童请在成人监护下使用耳机;
- 如佩戴耳机后感到耳朵不适, 建议咨询耳科医生是否适合佩戴入耳式耳机;
- 本产品内含锂电池, 禁止拆解、撞击、挤压或投入火中, 若出现膨胀, 请勿使用。请勿置于高温环境中。

* 更多更详细的产品实际使用问题解析, 请登录 1MORE 官方网站“技术支持”项进行咨询。

扫描、关注 1MORE 官方微信公众账号

欢迎访问 1MORE 社区: bbs.1more.com
登录 www.1more.com, 注册成为 1MORE 会员, 更多精彩在等你。



| | |
|------------------------|------------------------------|
| 型号: ES602 | 满电播放时长 (降噪开)* |
| 耳机重量 (单个): 4.9 克 | 单耳满电, 6 小时 |
| 充电盒重量: 34.5 克 | 搭配充电盒满电, 18 小时 |
| 整机重量: 44.3 克 | 满电播放时长 (降噪关)* |
| 耳机尺寸: 27 × 21 × 20 mm | 单耳满电, 8 小时 |
| 充电盒尺寸: 60 × 30 × 38 mm | 搭配充电盒满电, 24 小时 |
| 喇叭阻抗: 32 Ω | 蓝牙规范: Bluetooth® 5.2 |
| 通讯距离: 10 米 (在空旷环境下) | 蓝牙协议: HFP / A2DP / AVRCP |
| 耳机电池容量 (单个): 55 mAh | 输入: 5V=1A |
| 充电盒电池容量: 410 mAh | 工作温度: 0℃ ~ 45℃ |
| 耳机充电时间: 70 分钟 | 频率波段: 2,400 GHz ~ 2,4835 GHz |
| 充电盒充电时间 (有电): 85 分钟 | |

规格参数为实验室测试数据。
*播放时长为 AAC 格式、50% 音量条件下的实验室测试数据, 依设备设置、环境、使用情况等诸多其他因素可能有所差异。
制造商: 万魔声学股份有限公司
地址: 深圳市南山区留仙大道 3333 号塘朗城 A 座 35 楼
执行标准: GB8898

FAQ

- 耳机无法开机, 该如何解决?
请确认耳机有电, 若耳机没有电, 请充电 30 分钟以上再开机。
- 耳机与手机蓝牙无法连接, 连接时间长, 该如何解决?
1) 如左、右耳机无法配对, 仅一个耳机可与手机连接时, 可将左、右耳机放入盒中, 快速 3 击配对按钮, 选择设备名, 耳机即可与手机连接。
2) 如需与新手机连接, 开机且非通话状态下, 将左、右耳机放回盒内, 长按配对按钮 2 秒, 在新手机蓝牙列表里面选择耳机蓝牙名, 耳机将与新手机进行蓝牙配对。
- 安卓系统手机连接耳机成功后, 无法听到音乐, 该如何解决?
在安卓系统手机连接成功后, 点击所连接设备名称右边的图标, 进入后确保“媒体音频”选项已被开启。
- 在安卓系统手机连接耳机成功后, 无法通话, 该如何解决?
在安卓系统手机连接成功后, 点击所连接设备名称右边的图标, 进入后确保“手机音频”选项已被开启。
- 蓝牙连接不稳定, 出现断续情况, 该如何解决?
1) 请尽量缩短设备与耳机之间的距离, 避开实体障碍物;
2) 请远离强干扰源环境 (Wi-Fi / GPRS 等);
3) 请确保手机天线不被遮挡。
- 使用第三方音乐播放软件时, 为什么部分按键功能与说明书定义不一致?
1) 手机软件与第三方软件定义不同而导致耳机按键功能有差异;
2) 建议使用品牌手机系统自带音乐播放器。

In The Box

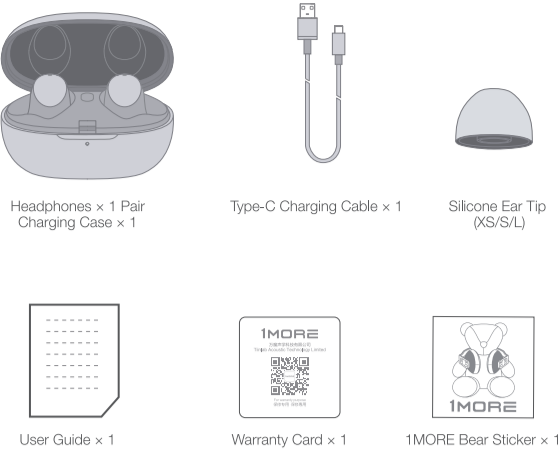

Product Overview

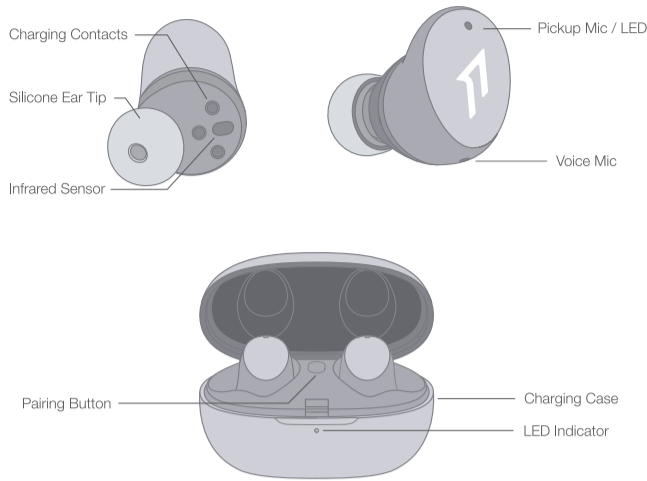

Placement



Power

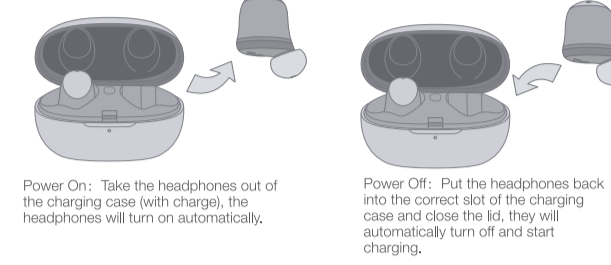

* Above functions are available for either earbud in individual or stereo mode.

Headphones Pairing

The Left and Right headphones will automatically pair to each other after the lid is open when they are in the case (with charge).

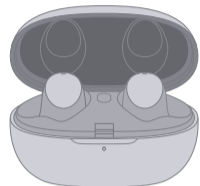

Bluetooth Pairing To The Device

To connect to your device for the first time, turn the headphones on to enter the pairing mode, the Right headphone will flash in white alternatively. Headphones will enter a standby mode if not paired to a device within 3 minutes.

* After the first successful pairing, headphones will automatically connect to your device.

To pair the headphones to a new device, simply place them into the charging case and press the pairing button for 2 seconds. Then click "1MORE ColorBuds 2" in the new device pairing list to connect.

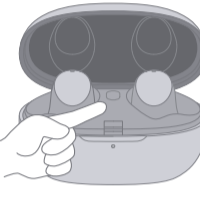

* After the first successful pairing, headphones will automatically connect to your device.

Charging ① To charge the case with Type-C cable.

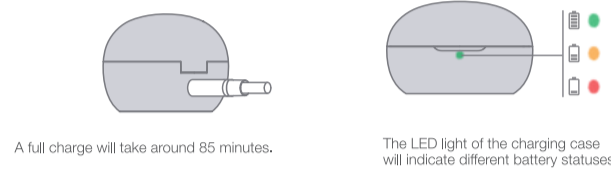

* The headphones are certified by Qi wireless charging, please use a Qi certified charging pad to ensure charging safety and efficiency.

② To charge the headphones with the case.

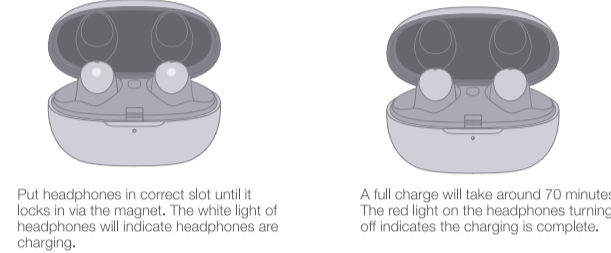

* Above functions are available for either earbud in individual or Stereo mode.

Battery Status Display in 1MORE MUSIC APP

Battery status of headphones and charging case will be displayed in 1MORE MUSIC APP.

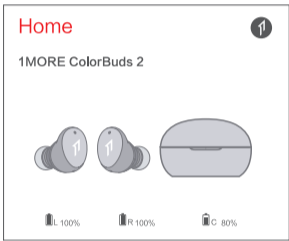

Battery Notification

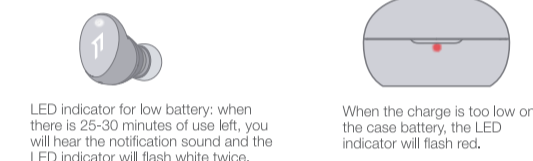

Touch Controls

Switch the Listening Modes
The default setting of the headphones is "ANC On", touch and hold on the outside of the headphone to switch "ANC On" to "Pass-through".
Phonecalls and music can be controlled by tapping the outside of the earbuds.

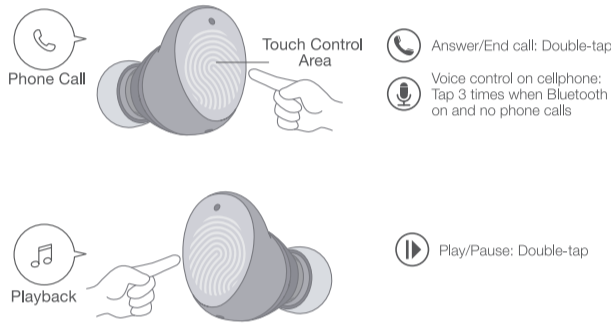

* Above functions are available for either earbud in individual or Stereo mode.
* To decline a call, change a song or control volume, please operate on 1MORE MUSIC APP, paired mobile phone or device.
* Above functions may vary with different devices.

Smart Playback

An IR Sensor automatically detects when you take out your headphones to stop playback intuitively and resumes playback when you put them back in.
To turn off Auto-Play, connect the headphones to the 1MORE MUSIC App and change in the settings.

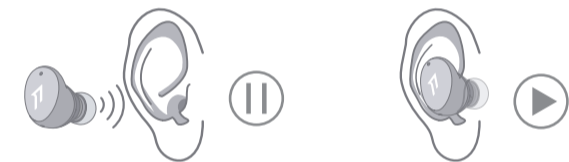

Extra Functions

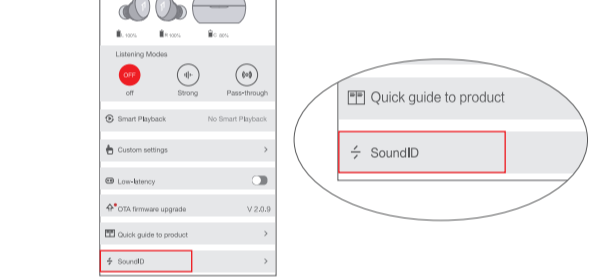

- If only 1 headphone can be paired to the device, Open the case, click the pairing button in the case 3 times quickly to initiate a Left & Right pairing, and then click "1MORE ColorBuds 2" in the device pairing list to connect to your device.
- Resetting the headphones:
Put both Left and Right headphones into the case, then press and hold the pairing button in the case for 8 seconds. The headphones will initiate pairing to each other again and the pairing records on the mobile phone/device will be cleared.
- OTA Firmware Update: can be done synchronously via the 1MORE MUSIC APP while the Left and Right earbuds are paired to each other.

* Functions of 1MORE MUSIC APP may vary with different cellphones or operating systems. For more details, please contact our customer service.

Personalized Sound Enabled by SoundID

1MORE MUSIC APP applies with the personalized sound technology – SoundID. Based on professional music-producing reference standard, SoundID can calculate out the best EQ for ears and solidify it to the headphones for any time use.

To pair the earbuds to a new cellphone, simply place them into the charging case and depress the pairing button for 2 seconds. Then click the new device name and pair with the new cellphone.

We Appreciate Your Business

We know you will enjoy new 1MORE headphones as much as we do. At 1MORE, we value your satisfaction, if you would like more details on this product or any of our other products, please visit us online by scanning the QR code. Go to www.1more.com and sign up for VIP, and 1MORE will treat you like one.

Tips

- Please read this instruction manual carefully and retain for future reference.
- Please fully charge the battery before first use.
- If the headphones have been unused for more than 3 months, we recommend that you charge them. This will improve battery capacity.
- Only use charging cables and adapters that are FCC (Federal Communications Commission) approved.
- In dry environments, static electricity may numb your ear. This is not related to the quality of the product.

Safety Information

- Never disassemble the headphones. There are no user-serviceable parts inside.
- Do not expose the headphones to temperatures below 32°F (0°C) or to temperatures above 113°F (45°C).
- Do not use the headphones in a thunderstorm storm. This could prevent the headphones from working properly and also increase your chance of being electrically shocked.
- Do not use oil or any volatile liquid to clean this product.
- Do not listen at high volumes for extended periods of time.
- Do not use the headphones in traffic. Do not use the headphones any time it would be dangerous to be unaware of noises around you.
- Adult supervision is required for children of age 6 and under.
- If you don't feel comfortable after wearing the headphones, please refer to an aurist for advice on whether in-ear headphones are suitable for you.

1MORE (1) Year Limited Warranty

1MORE warrants to the original retail purchaser that this product is to be free from defective materials and workmanship for a period of one year from the date of purchase if it is properly used and maintained. If this product proves defective in either material or workmanship, 1MORE, at its option, will (a) repair the product with new or refurbished parts, or (b) replace the product with an equivalent new or refurbished product, at no charge for parts or labor. If the product model is no longer available and cannot be repaired effectively or with an identical model, 1MORE at its sole option may replace the unit with a current model of equal or greater value. In some cases, modification to the mounting surface may be required where a new model is substituted. 1MORE assumes no responsibility or liability for such modification. TO OBTAIN A REPAIR OR REPLACEMENT UNDER THE TERMS OF THIS WARRANTY, PLEASE RETURN TO THE ORIGINAL DEALER FIRST AND THE ORIGINAL DEALER SHALL REPAIR THE PRODUCT WITH NEW OR REFURBISHED PARTS OR REPLACE THE PRODUCT WITH AN EQUIVALENT NEW OR REFURBISHED PRODUCT. You will be required to submit a proof of purchasing details, including but not limited to a receipt or sales invoice. Return shipping for exchanges/repairs is the sole responsibility of the original retail purchaser.

Limitations:

- This limited warranty does not cover the failure of the product resulting from improper installation, misuse, abuse, accident, neglect, mishandling, or wear from ordinary use or environmental deterioration.
- This limited warranty does not cover cosmetic damage, including paint damage, or consequential damage to other components or premises which may result for any reason from the failure of the product.
- This limited warranty is null and void for products not used in accordance with 1MORE's instructions.
- This limited warranty is null and void for products with altered or missing serial numbers and for products not purchased from an AUTHORIZED dealer.
- This limited warranty terminates if you sell or otherwise transfer this product to another party.

FAQ

- Why the headphones cannot be turned on?
Check if your headphones have enough battery life. If not, please charge them for at least 30 minutes.
- Why the headphones cannot connect to my cellphone, or take a long time to connect?
1) If the earbuds cannot pair to one another, and only one earbud will pair with your cellphone, then put both buds back into the charging case and quickly press the pairing button 3 times, click the device name, they should now pair correctly to the phone.
2) To pair the earbuds to a new cellphone, simply place them into the charging case and depress the pairing button for 2 seconds. Then click the new device name and pair with the new cellphone.
- Why the headphones cannot play music after successfully connecting to my Android device?
After pairing successfully, on the Bluetooth menu of your device, tap the icon on the right of your device name and make sure the "Media Audio" option is on.
- Why there is no sound from the headphones while making phone calls after successfully connecting to my Android device?
After pairing successfully, on the Bluetooth menu of your device, tap the icon on the right of your device name and make sure the "Phone Audio" option is on.
- Why the Bluetooth connection is not stable and causes some interruptions?
1) Try shortening the distance between your headphones and device. Avoid solid barriers in between.
2) Please keep away from strong interference sources, such as Wi-Fi and GPS.
3) Please make sure the Bluetooth antenna of your device is not blocked.
- Why some control functions do not match those in the third party music/video player Apps?
Your operating system and the third party music/video player apps may have different settings for the in-line remote control functions. We recommend that you use the music/video player apps that your device has originally provided.

* For more detailed product FAQs, please visit the product support section under www.1more.com

Warning

Replacement of a battery with an incorrect type that can defeat a safeguard (such as catching fire, explosion, leakage of corrosive electrolyte etc);
Disposal of a battery into fire or a hot oven, or mechanically crushing or cutting of a battery, that can result in an explosion;
Leaving a battery in an extremely high temperature surrounding environment that can result in an explosion or the leakage of flammable liquid or gas; and A battery subjected to extremely low air pressure that may result in an explosion or the leakage of flammable liquid or gas.



This product bears the selective sorting symbol for Waste electrical and electronic equipment (WEEE). This means that this product must be handled pursuant to European directive 2014/53/EU in order to be recycled or dismantled to minimize its impact on the environment.

User has the choice to give his product to a competent recycling organization or to the retailer when he buys a new electrical or electronic equipment.

To prevent possible hearing damage, do not listen at high volume levels for long periods.

WEEE

Electrical and electronic equipment, parts and batteries marked with this symbol must not be disposed of with normal household waste; it must be collected and disposed of separately to protect the environment.

Your 1MORE retailer will advise you of the correct way of disposal in your country.

Safety Caution

Do not expose batteries or battery packs to excessive heat such as sunshine, fire or the like.

CE

Declaration of Conformity Hereby, Tiinlab Corporation declares that the radio equipment type 1MORE ColorBuds 2 (ES602) is in compliance with Directive 2014/53/EU. The full text of the EU declaration of conformity is available at the following internet address: www.1more.com

RF exposure information: The device has been evaluated to meet general RF exposure requirement. The device can be used in portable exposure condition without restriction. Radiation Exposure Statement Power is so low that no RF exposure calculation is needed.

Declaration for EU Compliance
Operation Frequency/Max. EIRP: 2400-2483.5MHz, Left ear Max. EIRP is 12dBm, Right ear Max. EIRP is 12dBm.

FCC

The SAR limit of USA (FCC) is 1.6 W/kg for head averaged over one gram of tissue.
Device types ES602
(FCC ID: 2ASDIES602L (Left ear) , 2ASDIES602R (Right ear)) has also been tested with 0mm against this SAR limit.

NOTE: The manufacturer is not responsible for any radio or TV interference caused by unauthorized modifications or changes to this equipment. Such modifications or changes could void the user's authority to operate the equipment.

NOTE: This equipment has been tested and found to comply with the limits for a Class B digital device, pursuant to part 15 of the FCC Rules. These limits are designed to provide reasonable protection against harmful interference in a residential installation. This equipment generates uses and can radiate radio frequency energy and, if not installed and used in accordance with the instructions, may cause harmful interference to radio communications. However, there is no guarantee that interference will not occur in a particular installation. If this equipment does cause harmful interference to radio or television reception, which can be determined by turning the equipment off and on, the user is encouraged to try to correct the interference by one or more of the following measures:

- Reorient or relocate the receiving antenna.
- Increase the separation between the equipment and receiver.
- Connect the equipment into an outlet on a circuit different from that to which the receiver is connected.
- Consult the dealer or an experienced radio/TV technician for help.

This device complies with Part 15 of the FCC Rules. Operation is subject to the following two conditions:
(1) This device may not cause harmful interference.
(2) This device must accept any interference received, including interference that may cause undesired operation.

Supplier's Declaration of Conformity
47 CFR § 2.1077 Compliance Information
Unique Identifier:
Trade Name: 1MORE
Model No.: ES602
Responsible Party – U.S. Contact Information
1MORE USA, Inc
Address: 10225 Barnes Canyon Road, Suite A202, San Diego, California, 92121
Tel: 1-855-551-6673
E-Mail: support@1moreusa.com
IC regulatory conformance
This device complies with CAN ICES-003 (B)/NMB-003(B) and CAN RSS-216 / CNR-216.
This device contains licence-exempt transmitter(s)/receiver(s) that comply with Innovation, Science and Economic Development Canada's licence-exempt RSS(s). Operation is subject to the following two conditions:
(1) This device may not cause interference.
(2) This device must accept any interference, including interference that may cause undesired operation of the device.
Cet appareil est conforme à la norme CAN ICES-003 (B)/NMB-003 (B) et CAN RSS-216 / CNR-216.
Cet appareil contient des émetteurs / récepteurs exempt (s) de licence qui sont conformes aux RSS exemptes de l'Innovation, Sciences et Développement économique Canada. Son fonctionnement est soumis aux deux conditions suivantes:
(1) Cet appareil ne doit pas provoquer d'interférences.
(2) Cet appareil doit accepter toute interférence, y compris les interférences susceptibles de provoquer un fonctionnement indésirable de l'appareil.

The SAR limit of Canada (ICES) is 1.6 W/kg for head averaged over one gram of tissue.
Device types ES602
(IC: 24662-ES602L (Left ear) , 24662-ES602R (Right ear)) has also been tested with 0mm against this SAR limit.

* Do not put the battery in trash that is disposed of in landfills. When disposing of the battery, comply with local laws or regulations.

| | |
|---|--|
| Model: ES602 | Headphones + Case: 18 hours |
| Case Weight: 34.5 g | Fully Charged Playtime (ANC Off) |
| Product Weight: 44.3 g | Headphones: 8 hours |
| Headphone Size: 27 × 21 × 20 mm | Headphones + Case: 24 hours |
| Case Size: 60 × 30 × 38 mm | Impedance: 32 Ω |
| Headphone Battery Capacity (single): 55 mAh | Wireless Range: 10 m |
| Case Battery Capacity: 410 mAh | Bluetooth: Bluetooth® 5.2 |
| Headphone Charging Time: 70 mins | Bluetooth Protocol: HFP / A2DP / AVRCP |
| Case Charging Time (with cable): 85 mins | Input: 5V=1A |
| Fully Charged Playtime (ANC On) | Working Temperature: 0°C ~ 45°C |
| Headphone: 6 hours | Frequency Band: 2.400 GHz ~ 2.4835 GHz |

The specifications are acquired from laboratory tested data.
* The playback time, tested under the laboratory condition of AAC format and 50% volume, may vary with different device setting, environments, usage and other factors.

Manufacturer: Tiinlab Corporation
Add: No. 3333, Luxian Avenue, Tower A, 35th Floor, Tanglang City, Nanshan District, Shenzhen, China
Product information can be found at www.1more.com

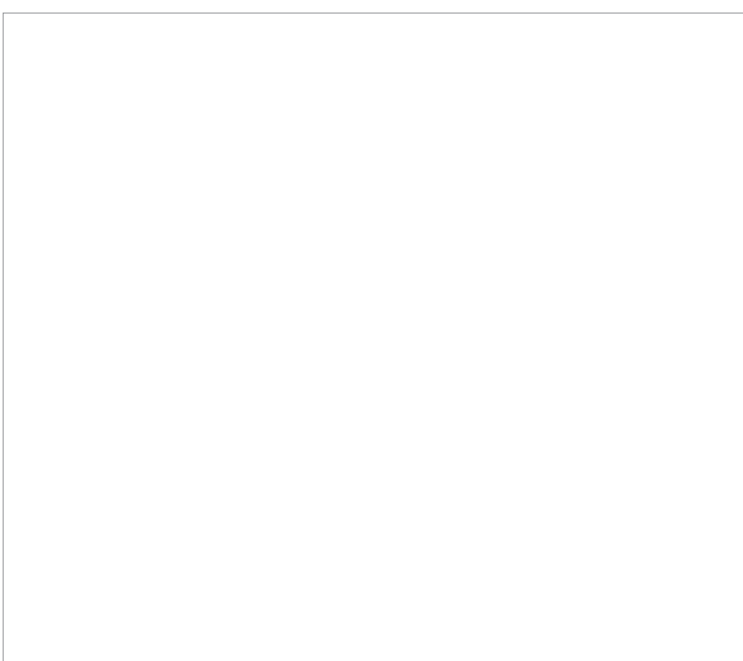

包裝內容

- 耳機 × 1 副 + 充電盒 × 1
- Type-C 充電線 × 1
- 矽膠耳塞套 (XS/S/L)
- 使用說明書 × 1
- 保修卡 × 1
- 萬魔熊貼紙 × 1

產品概覽

充電觸點
矽膠耳塞套
紅外傳感器

拾音麥克風 / LED
通話麥克風

配對按鈕
充電盒
LED 指示燈

耳機佩戴

XS
S
M
L

開 / 關機

開機：在充電盒有電的狀態下，從盒中取出耳機，耳機即開機。

關機：將耳機放入充電盒中對應的充電槽內，關閉盒蓋，耳機即關機充電。

* 上述功能適用於單、雙模式使用時的任一耳機。

左、右耳機配對

在充電盒有電狀態下，如左、右耳機置於盒內，打開盒蓋，左、右耳機即自動配對。

耳機與藍牙設備配對

首次使用，開機後右耳機白燈快閃進入搜索模式。3 分鐘後未連接到設備，耳機進入待機狀態。

* 已連接到設備的耳機，將自動與該設備進行藍牙配對。

如需與新設備連接，將左、右耳機放回盒內，長按配對按鈕 2 秒，點擊新設備配對列表中的 "1MORE ColorBuds 2" 進行連接。

* 上述功能適用於單、雙模式使用時的任一耳機。

充電

① 使用 Type-C 充電線給充電盒充電

一次充滿需約 85 分鐘。

充電過程中，充電盒 LED 燈將以不同顏色顯示電量狀態。

* 本耳機支持 Qi 認證無線充電，請使用 Qi 認證的充電板體驗安全有效的無線充電體驗。

② 使用充電盒為耳機充電

請將耳機準確放入盒中位置。充電過程中，耳機 LED 白燈慢閃。

一次充滿需約 70 分鐘，當充滿電時，耳機 LED 燈熄滅。

1MORE MUSIC APP 電量顯示

耳機與充電盒的電量狀態將在 1MORE MUSIC APP 中顯示。

電量提示

低電量提示：當耳機還能使用的約 25 ~ 30 分鐘時，耳機提示音將進行提醒，LED 白燈快閃 2 次。

當充電盒的電量不足以給耳機供電時，充電盒的 LED 將閃紅燈。

觸控功能

聆聽模式切換
耳機出廠設置為“主動降噪”，長觸耳機表面（約 1.5 秒）可在“主動降噪”與“通透模式”模式間切換。

通話和播放功能可通過觸擊耳機表面來實現。

- 通話**：接聽 / 掛斷：雙擊；手機語音助手：藍牙連接，非通話時三連擊。
- 播放**：播放 / 暫停：雙擊。

* 上述功能適用於單、雙模式使用時的任一耳機。
* 拒接電話、選曲及音量調節，請在 1MORE MUSIC APP 及手機等設備端進行操作。
* 以上功能定義因設備不同可能略有差異。

自動暫停 / 播放功能

紅外傳感器將對耳機的使用狀態進行即時智慧偵測。當播放過程中取下耳機，播放內容將自動暫停；戴上後，繼續播放。

關閉“自動播放”功能，可通過 1MORE MUSIC APP 進行設置。

SoundID 錄音室級個性化音效設定

1MORE MUSIC APP 採用 SoundID 個性化音效定制技術，源自專業音樂製作參考標準，可測算出更匹配雙耳的音效，並將其固化到耳機，隨時體驗個人專屬的聆聽風格。

APP 首頁，點擊“SoundID”可進行設置。

其它功能

- 如左、右耳機無法配對，僅有單個耳機可與藍牙設備連接，可將左、右耳機放入盒中，三連擊配對按鈕，再點擊藍牙設備配對列表中的 "1MORE ColorBuds 2" 進行連接。
- 耳機恢復出廠設置：
將左、右耳機放入充電盒中，長按充電盒配對按鈕 8 秒，左、右耳機重新自動配對，且藍牙設備的連接記錄被強制清除。
- OTA 軟體升級：左、右耳機藍牙連接時，可直接在 1MORE MUSIC APP 上同步升級。

* 1MORE MUSIC APP 的所有功能，在不同手機及操作系統上或有不同，請聯繫客服了解更多詳情。

保固範圍

1MORE 保證消費者自初次購買之日起一年內，對 1MORE 產品在正常使用途中材料和工藝上的缺陷進行保修。在保固範圍內，1MORE 會直接受理您的申訴（包括從 1MORE 授權的經銷商處購買的 1MORE 產品）。在保固期內，1MORE 將自行決定修理或更換有缺陷產品或按照購買價格進行退款。本保固不適用於天災意外或使用、保養、維修不當，或是其他不是由材料、工藝上的缺陷引起的情況。完整的保固細節請登錄 www.1more.com 查看。

感謝您的購買

我們知道您會享受並喜愛 1MORE 耳機。在 1 MORE 我們格外重視您的滿意度，如果您想要了解更多產品的訊息請掃描背面的二維條碼，進入 www.1more.com 登錄成為 VIP，1MORE 將提供您專榮的服務。

NCC

取得審驗證明之低功率射頻器材，非經核准，公司、商號或使用者均不得擅自變更頻率、加大功率或變更原設計之特性及功能。

低功率射頻器材之使用不得影響飛航安全及干擾合法通信；經發現有干擾現象時，應立即停用，並改善至無干擾時方得繼續使用。

前述合法通信，指依電信管理法規定作業之無線電通信。

低功率射頻器材須忍受合法通信或工業、科學及醫療用電波輻射性電機設備之干擾。

名稱：1MORE ColorBuds 2 時尚豆

型號：ES602

耳機重量（單個）：4.9 克

充電盒重量：34.5 克

整機重量：44.3 克

耳機尺寸：27 × 21 × 20 mm

充電盒尺寸：60 × 30 × 38 mm

喇叭阻抗：32 Ω

通訊距離：10 米（在空曠環境下）

耳機電池容量（單個）：55 mAh

充電盒電池容量：410 mAh

耳機充電時間：70 分鐘

充電盒充電時間（有線）：85 分鐘

滿電播放時長（降噪開）*
單耳滿電：6 小時
搭配充電盒滿電：18 小時

滿電播放時長（降噪關）*
單耳滿電：8 小時
搭配充電盒滿電：24 小時

藍牙規範：Bluetooth® 5.2

藍牙協議：HFP / A2DP / AVRCP

輸入：5V=1A

工作溫度：0 °C ~ 45 °C

頻率波段：2.400 GHz ~ 2.4835 GHz

規格參數為實驗室測試數據。
* 播放時長為 AAC 格式、50% 音量條件下的實驗室測算數據，依設備設置、環境、用情況及諸多其他因素可能有所差異。

製造商：萬魔聲學股份有限公司
地址：深圳市南山區留仙大道 3333 號塘朗城 A 座 35 樓

제품개요

충전 핀, 실리콘 이어팁, 적외선 센서, 외부 소음 수집 마이크 / LED 표시등, 통화 마이크, 페어링 버튼, 충전케이스, LED 표시등

이어폰 페어링

왼쪽 이어폰과 오른쪽 이어폰이 케이스에 충전중인 상태일 때 덮개를 열면 자동으로 서로 페어링 됩니다.

블루투스 장치 연결

장치에 처음으로 연결하기 위해 이어폰을 켜서 페어링모드에 진입하면 오른쪽 이어폰의 LED가 흰색으로 깜빡입니다. 3분 이내 장치와 연결되지 않으면 이어폰은 대기모드로 전환됩니다.

*사용하는 장치와 연결이 성공하면, 다음 사용시 이어폰이 자동으로 장치에 연결됩니다.

이어폰을 새 장치에 연결하려면 충전 케이스에 넣고 페어링 버튼을 2초간 누르십시오. 그런 다음 새 장치 목록에서 "1MORE ColorBuds 2"를 클릭하여 연결합니다.

* 위 기능은 두개의 이어폰이 개별 사용 또는 스테레오 모드 사용중일 때 모두 작동됩니다.

1MORE MUSIC APP 배터리 상태 표시

이어폰과 충전 케이스의 배터리 상태는 1MORE MUSIC APP에 표시됩니다.

전기량 제시

배터리 부족 LED 표시등 : 사용 가능 시간이 25-30분 정도 남으면 알림음으로 알려주고, 빨간색 LED 표시등이 초당 2회 깜빡입니다.

충전 케이스의 배터리 충전량이 너무 낮을 경우, 빨간색 LED 표시등이 깜빡입니다.

스마트 재생

귀에서 이어폰을 빼면 IR 센서가 자동으로 감지하여 재생을 멈추고, 다시 착용하면 재생합니다.

자동 실행을 끄려면 이어폰을 1MORE 음악 앱에 연결합니다.

SoundID를 통한 EQ 개인설정 활성화

1MORE MUSIC APP은 맞춤형 사운드 기술인 SoundID가 적용됩니다. 전문적인 음악 제작 기준 표준을 기반으로, SoundID는 최적의 EQ를 계산하여 언제 사용하더라도 최적화된 사운드를 들려줍니다.

앱 홈페이지에서 "SoundID"를 클릭하여 나만의 사운드를 설정하세요.

품질 보증

1MORE 제품들은 설명서에 따라 사용되었을 경우, 구입하신 날짜로부터 1년간 고장과 부품 결함으로부터 품질을 보장합니다. 이 품질 보증서에 따라, 공인된 총판으로부터 제품을 구입하셨어도 1MORE에 직접 청구하실 수 있습니다. 보증기간 동안 1MORE에서는 고장난 부분 혹은 결함이 있는 부분을 수리하거나 교체해 드립니다. 이 품질 보증서는 제품의 재료 또는 생산과정에서 생긴 문제가 아닌 사고, 잘못된 사용, 관리 또는 수리로 인한 손상이나 다른 문제로 생긴 고장에 대해서는 보장하지 않습니다. 품질 보증에 대한 더 자세한 내용은 www.1more.com을 방문해 주십시오.

구입해 주셔서 감사합니다

우리는 당신이 우리의 새로운 1MORE 피스톤 이어폰을 만족하길 바랍니다. 1MORE에서는 당신의 의견에 귀를 기울이고 있습니다. 저희 제품에 대해 궁금한 점이 있으시면 설명서 뒷면의 QR코드를 스캔하여 저희 공식웹사이트를 방문해 주십시오. www.1more.com을 방문하여 회원등록을 해주십시오. 1MORE에서는 소중한 당신을 위해 귀를 기울이겠습니다.

KCC

1. 이 기기는 가정용으로 전자파적합등록을 한 기기로서 주거지역에서는 물론 모든 지역에서 사용할 수 있습니다.

2. 당해 무선설비는 전자파선 가능성이 있으므로 인명안전과 관련된 서비스는 할 수 없음. 특정소출력 무선기기(무선데이터통신시스템용 무선기기)

박스 내용물을 확인하십시오

- 이어폰 x 1세트, 충전 케이스 x 1
- Type-C 충전 케이블 x 1
- 실리콘 이어팁 (XS/S/L)
- 사용자 설명서 x 1
- 보증 카드
- 1MORE 배어 스티커

이어폰 착용

전원

전원 켜기 : 충전 케이스에서 이어폰을 꺼내면 이어폰의 전원이 자동으로 켜집니다.

전원 끄기 : 이어폰을 충전 케이스에 거치한 후 덮개를 닫으면 이어폰의 전원이 자동으로 꺼지고 충전이 시작됩니다.

* 위 기능은 두개의 이어폰이 개별 사용 또는 스테레오 모드 사용중일 때 모두 작동됩니다.

충전

① Type-C 케이블 이용 충전케이스를 충전합니다.

완전 충전까지 약 85 분 소요됩니다.

충전 케이스에 표시된 LED 표시등은 각각 배터리 상태를 나타냅니다.

* 이어폰은 Qi규격 무선충전 인증을 받았으며, 안전과 효율을 위하여 Qi규격 인증된 충전 패드를 사용하십시오.

② 충전케이스를 이용하여 이어폰에 충전한다.

이어폰을 충전 케이스에 정확히 넣어 주십시오. 충전 시 흰색 LED 표시등이 표시됩니다.

70 분 풀 충전은 약 1시간이 필요되며, 충전완료시, 충전케이스 LED지시등이 꺼집니다.

탭 컨트롤

청취 모드 전환 : 이어폰의 기본 설정은 "ANC ON" 입니다. 이어폰 외부 길게 누르면 "ANC ON"을 "패스투(주변음 허용)모드"으로 전환합니다.

전화통화 및 음악 재생은 이어폰의 바깥면을 탭하여 조절할 수 있습니다.

- 전화수신 / 전화끊기 : 버튼 두 번 클릭
- 스마트폰 음성 제어 : 블루투스가 연결되어 있고 통화 중이 아닐 때 버튼을 3회 탭 합니다.
- 재생 / 일시 정지 : 버튼 두 번 클릭

* 위 기능은 두개의 이어폰이 개별 사용 또는 스테레오 모드 사용중일 때 모두 작동됩니다.

* 통화 수신 거부, 곡을 변경하거나 볼륨을 조절하려면, 1MORE MUSIC APP 또는 연결된 스마트폰 장치에서 조작하세요.

* 위 기능은 핸드폰마다 다를 수 있습니다.

기타기능

- 전원을 켤 때 이어폰이 정상적으로 페어링되지 않는 경우, 왼쪽 및 오른쪽 이어폰의 올바른 연결(페어링)을 위해 충전케이스를 열고 케이스에 장착된 상태에서 페어링 버튼을 3번 빠르게 클릭하십시오.
- 이어폰 재설정 : 충전 케이스에 양쪽 이어폰을 모두 넣은 다음, 케이스의 페어링 버튼을 8초간 길게 누릅니다. 양쪽 이어폰은 서로 연결되며, 스마트폰 및 연결장치 등의 연결 기록은 삭제됩니다.
- OTA 펌웨어 업데이트 : 왼쪽, 오른쪽 이어폰을 각각 연결(페어링)한 후 1MORE MUSIC APP을 통해 업데이트를 진행할 수 있습니다.

* 1MORE MUSIC APP 기능은 사용하는 스마트폰이나 운영체제에 따라 다를 수 있습니다. 자세한 내용은 고객센터에 문의하시기 바랍니다.