

材质：80G书纸
尺寸：98*86mm

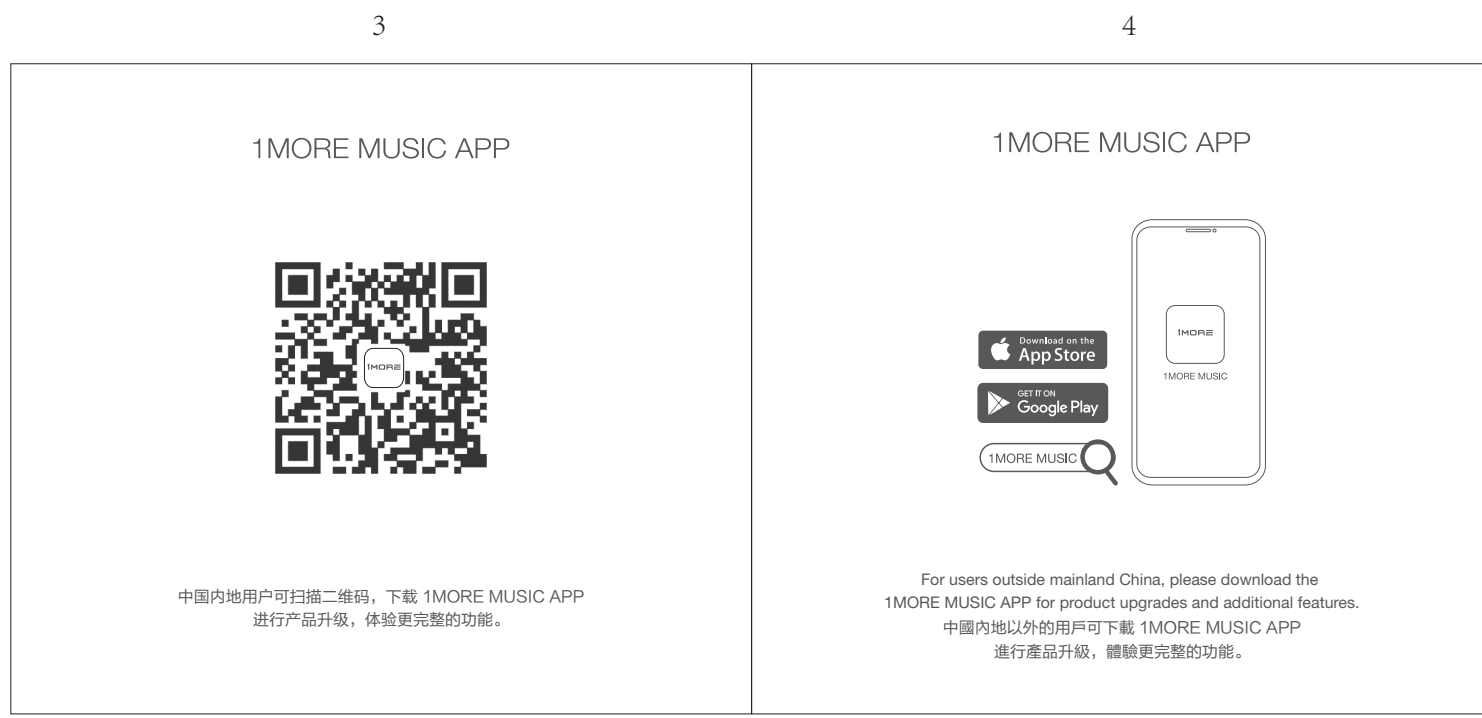

红色：熔岩红
PANTONE
Bright Red C
RGB 255,40,25
黑色：钛黑
PANTONE
My Soul Black 6C
RGB 255,40,25

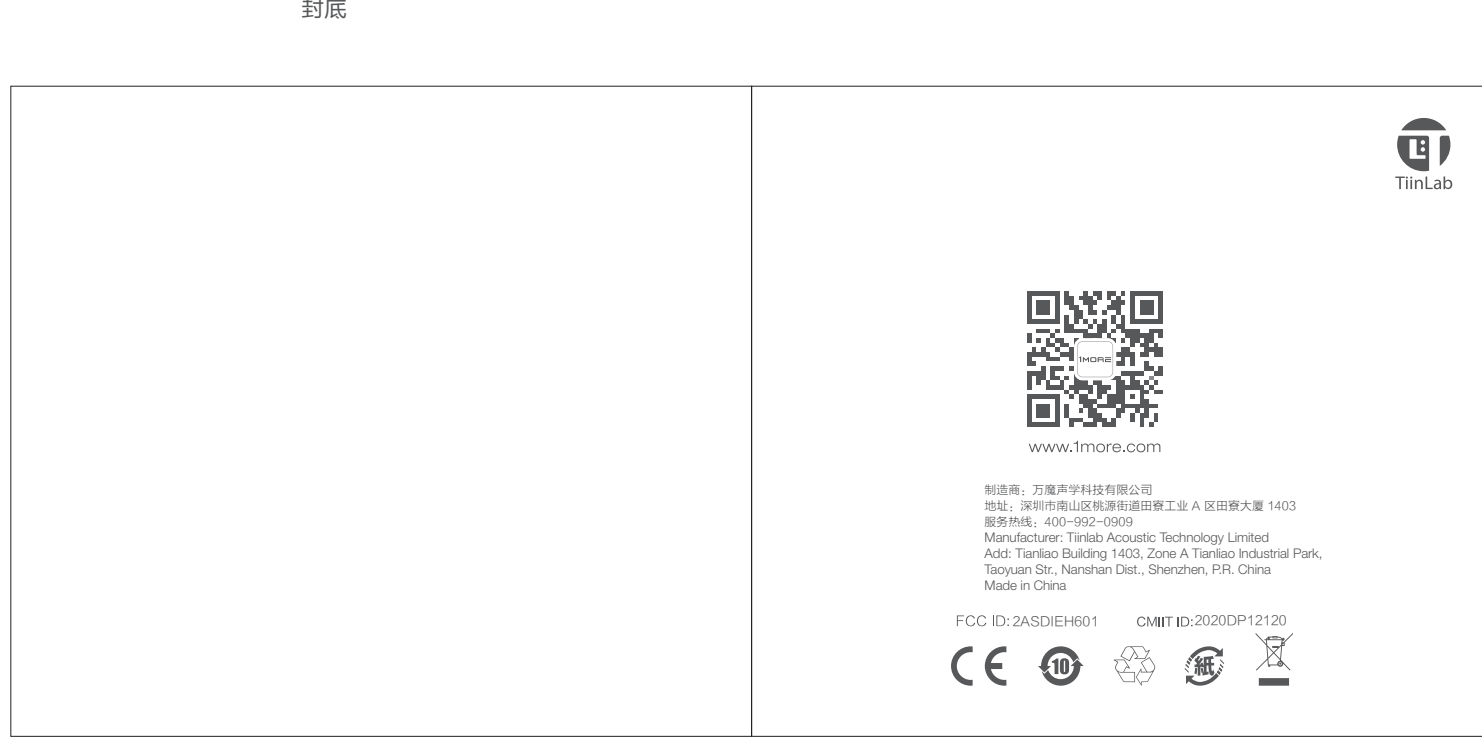
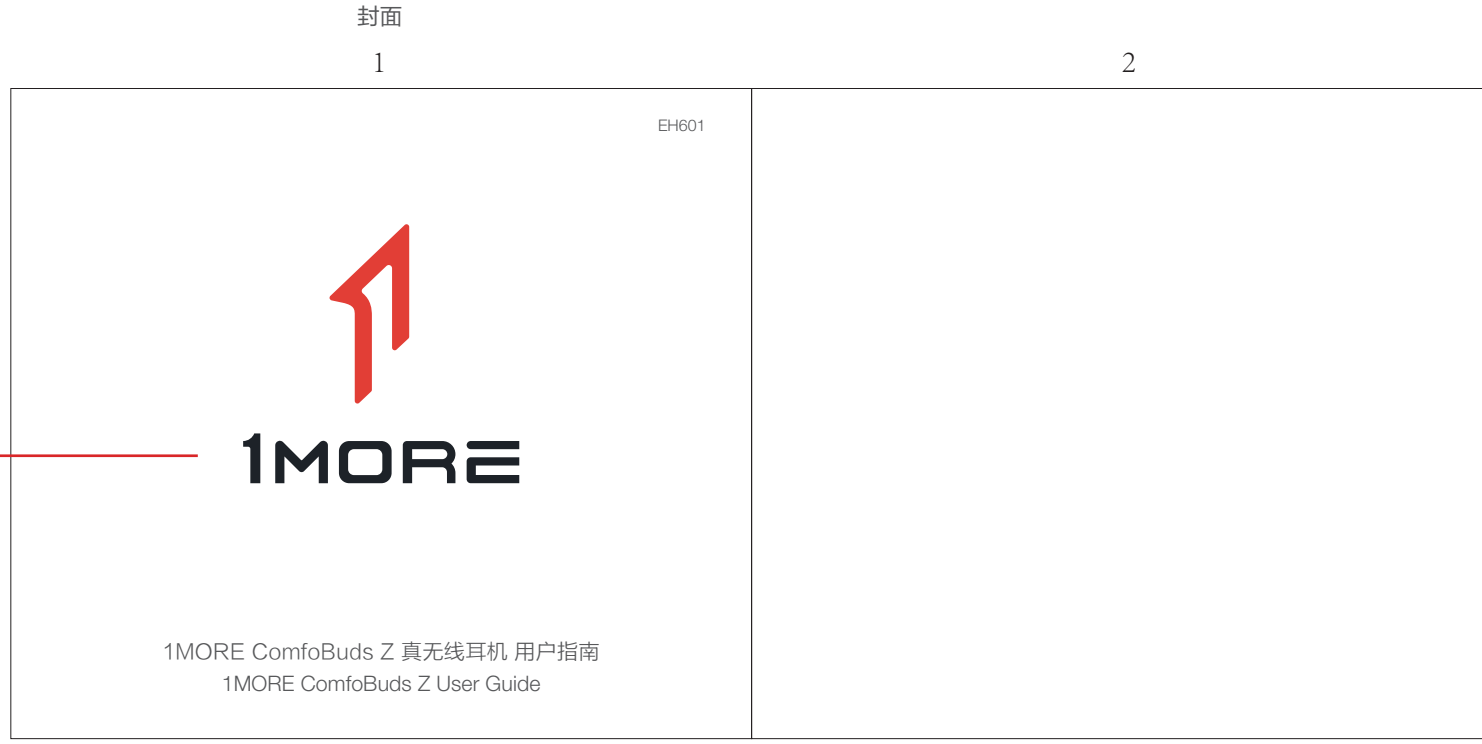

筒中

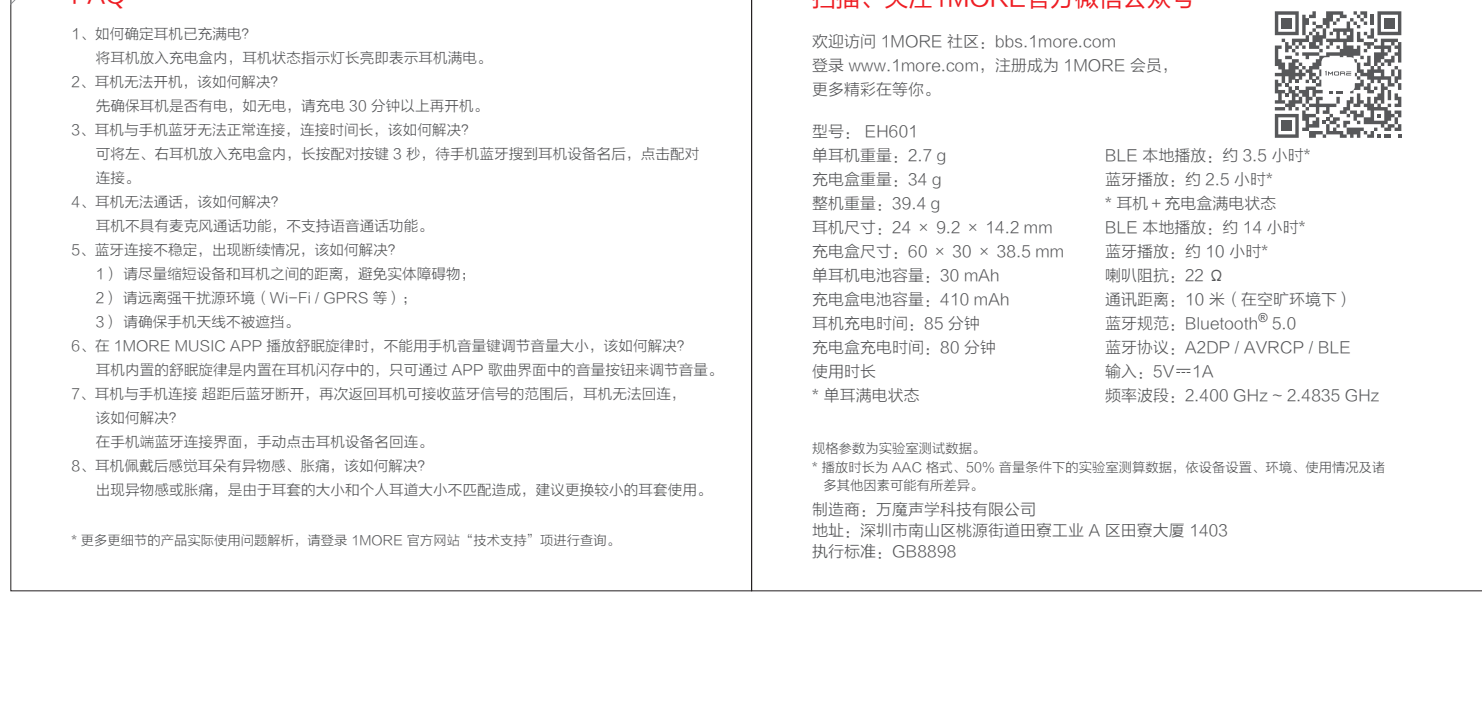
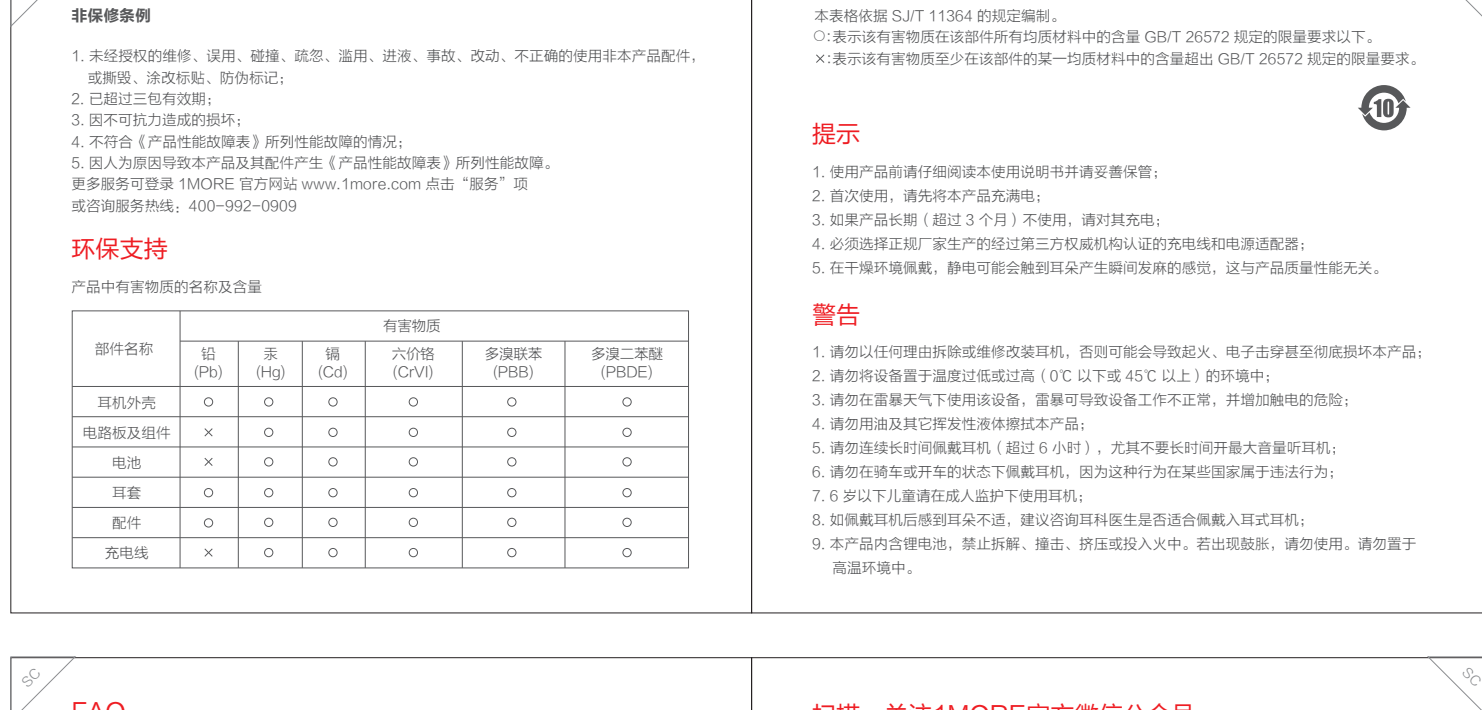
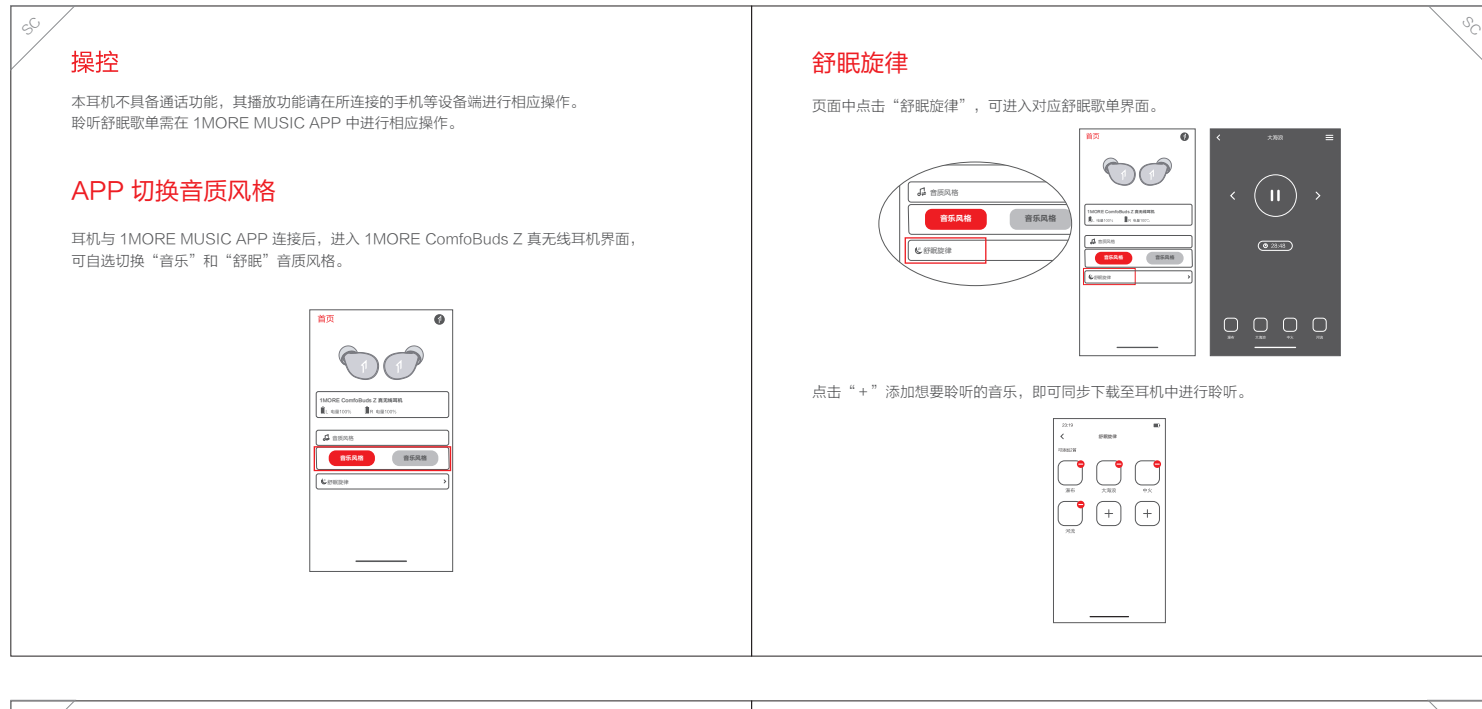
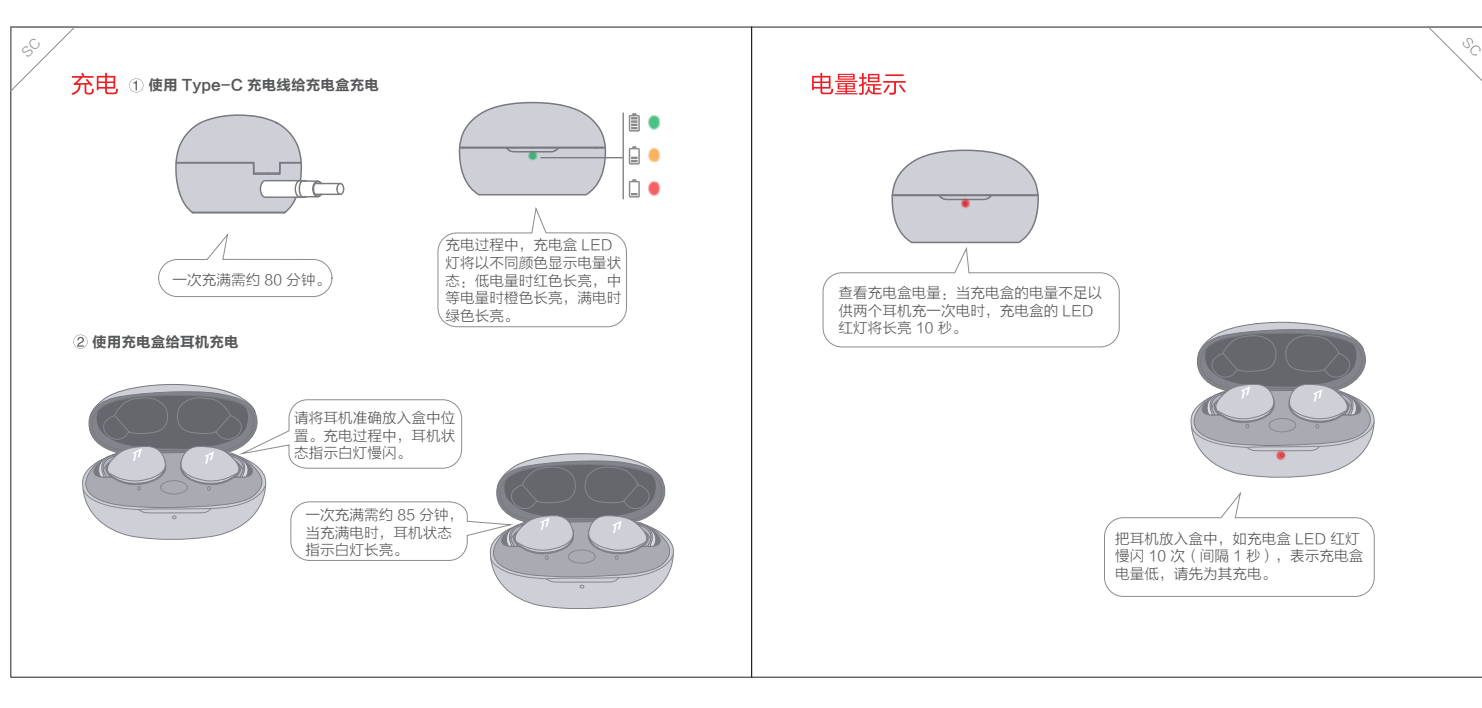
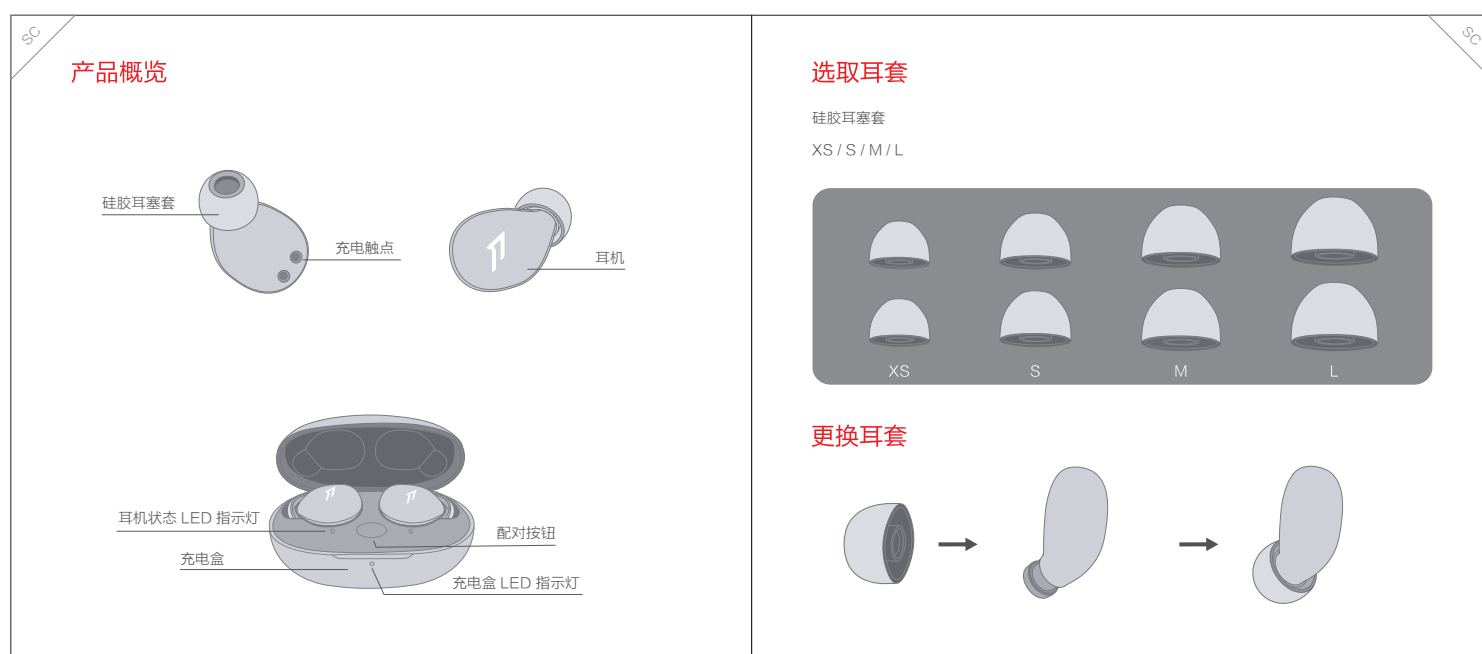
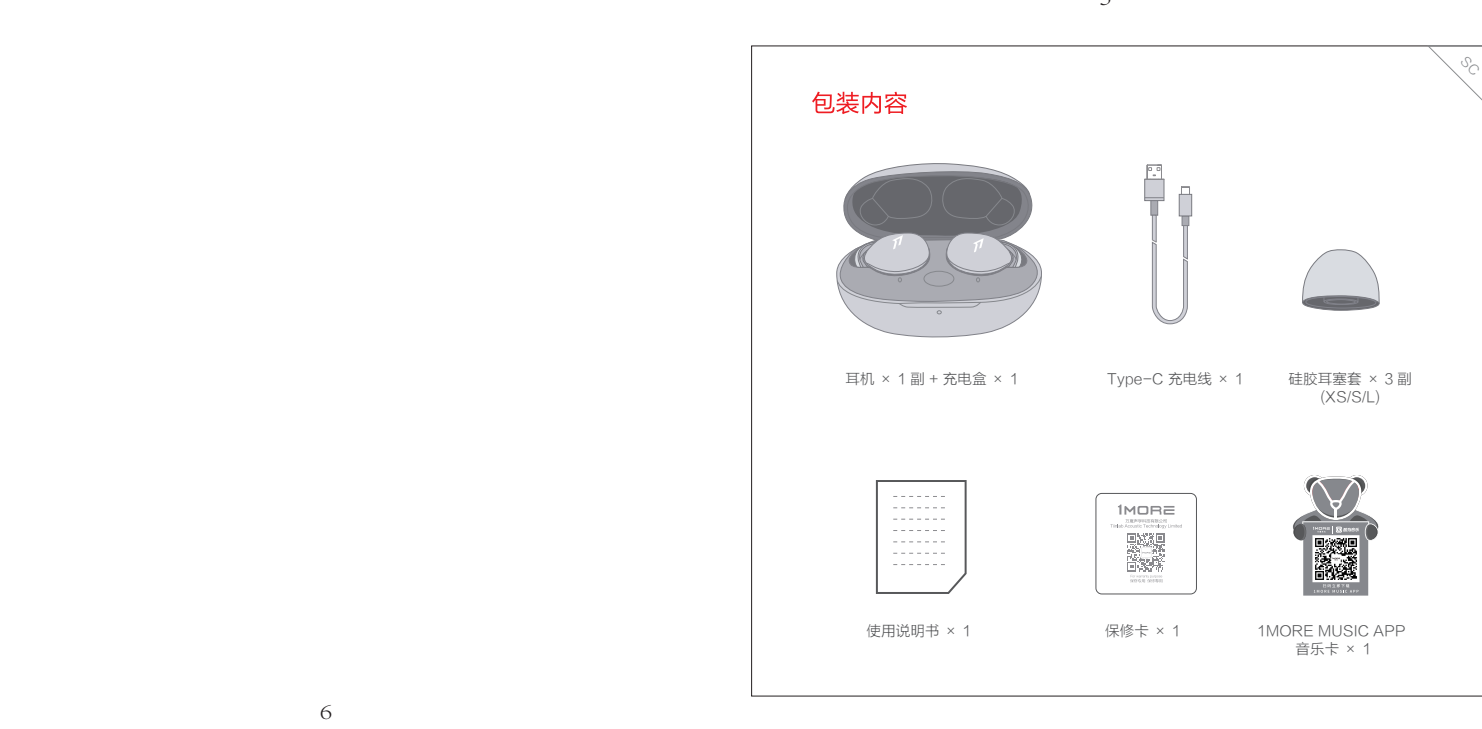

In The Box

Headphones x 1 set
Charging Case
Type-C Charging Cable x 1
Silicone Ear Tip x 3 sets (XS/S/M/L)

User Guide x 1
Warranty Card x 1

Product Overview

Fit

Silicone Ear Tip
XS / S / M / L

Replace

Placement

Power On: Take the headphones out of the charging case (with charge), the headphones will turn on automatically.

Power Off: Put the headphones back into the correct slot and close the lid, they will automatically turn off and start charging.

* Above functions are available for either headphone in individual or Stereo mode.

Headphones Pairing

- The Left and Right headphones will automatically pair to each other after the lid is open when they are in the case (with charge).
- Headphones taken out of the case that fail to pair to each other will enter sleep mode. Put the headphones back into the charging case (with charge), and they will pair to each other automatically.

Bluetooth Pairing To The Device

To connect to your device during first use, turn the headphones on to enter pairing mode, the LEDs for headphone status will flash in white. Headphones will enter sleep mode if not paired to a device within 2 minutes.

* After first successful pairing, headphones will automatically connect to your device.

To skip previously paired device and pair with a new one, put headphones back into the case, press and hold the pairing button for 3 seconds when powered on (no playback) to re-enter pairing mode.

* Above functions are available for either headphone in individual or Stereo mode.

Charging

1) To charge the case with Type-C cable.

Full charge will take around 80 minutes.

The LED light of the charging case will indicate different battery status: red light indicates low battery, orange light indicates medium battery and green light indicates full battery.

2) To charge the headphones with the case.

Put the headphones into the correct slot until it locks in via magnetic click. LEDs will indicate headphone status. LEDs breathing in white indicate headphones are charging.

Full charge will take around 85 minutes. Headphone status LEDs glow in white indicating charging is complete.

Battery Notification

LED indicator for case battery status: when case battery is too low on charge, LED indicator will glow solid red for 10 seconds.

When headphones are placed in charging case and the LED on charging case flashes 10 times, the case has low battery, please charge the case first.

Controls

Phone call function is not available on these headphones, and the playback controls must be implemented on the connected device.

Please download 1MORE MUSIC APP for the sleep playlist.

Switch Listening Modes via APP

Enter the 1MORE ComfoBuds Z home page in 1MORE MUSIC APP after pairing to your cellphone, then you can switch listening modes between "Music" and "Soothing".

Soothing Sounds

Click the "Soothing Sounds" to enter the playlist.

Click "*" to select the sound to be downloaded to your headphones for listening.

Click the timer icon in the song page to set up the playtime.

* Volume adjustment for the soothing sounds can only be implemented via APP.

Extra Functions

- If headphones cannot pair normally when they power on, Put both headphones into the case, press and hold the pairing button in the case for 3 seconds and the headphone status LEDs flash in white, and then headphones will start searching for Left & Right pairing.
- For single mode: put Left and Right earbuds in the case, double-click the pairing button and enter the separate pairing for single earbud. Then the Left and Right earbuds can be connected to different cellphones.
- To unpair the device: Press and hold the pairing button in the case for 3 seconds to disconnect the earbuds and the device.

* Functions of 1MORE MUSIC APP may vary with different cellphones or operating systems. For more details, please contact our customer service.

1MORE (1) Year Limited Warranty

1MORE Inc., ("1MORE") warrants to the original retail purchaser that this product is to be free from defective materials and workmanship for a period of one year from the date of purchase if it is properly used and maintained. If this product proves defective in either material or workmanship, 1MORE, at its option, will (a) repair the product with new or refurbished parts, or (b) replace the product with an equivalent new or refurbished product, at no charge for parts or labor. If the product model is no longer available and cannot be repaired effectively or replaced with an identical model, 1MORE at its sole option may replace the unit with a current model of equal or greater value. In some cases, modification to the mounting surface may be required where a new model is substituted. 1MORE assumes no responsibility or liability for such modification. TO OBTAIN A REPAIR OR REPLACEMENT UNDER THE TERMS OF THIS WARRANTY, PLEASE RETURN TO THE ORIGINAL DEALER FIRST AND THE ORIGINAL DEALER SHALL REPAIR THE PRODUCT WITH NEW OR REFURBISHED PARTS OR REPLACE THE PRODUCT WITH AN EQUIVALENT NEW OR REFURBISHED PRODUCT.

You will be required to submit a proof of purchasing details, including but not limited to a receipt or sales invoice.

Return shipping for exchanges/repairs is the sole responsibility of the original retail purchaser.

Limitations:

- This limited warranty does not cover the failure of the product resulting from improper installation, misuse, abuse, accident, neglect, mishandling, or wear from ordinary use or environmental deterioration.
- This limited warranty does not cover cosmetic damage, including paint damage, or consequential damage to other components or premises which may result for any reason from the failure of the product.
- This limited warranty is null and void for products not used in accordance with 1MORE's instructions.
- This limited warranty is null and void for products with altered or missing serial numbers and for products not purchased from an AUTHORIZED dealer.
- This limited warranty terminates if you sell or otherwise transfer this product to another party.

We Appreciate Your Business

We know you will enjoy new 1MORE headphones as much as we do. At 1MORE, we value your satisfaction. If you would like more details on this product or any of our other products, please visit us online by scanning the QR code. Go to www.1more.com and sign up for VIP, and 1MORE will treat you like one.

Tips

- Please read this instruction manual carefully and retain for future reference.
- Please fully charge the battery before first use.
- If the headphones have been unused for more than 3 months, we recommend that you charge them. This will improve battery capacity.
- Only use charging cables and adapters that are FCC (Federal Communications Commission) approved.
- In dry environments, static electricity may numb your ear. This is not related to the quality of the product.

Safety Information

- Never disassemble the headphones. There are no user-serviceable parts inside.
- Do not expose the headphones to temperatures below 32 °F (0 °C) or to temperatures above 113 °F (45 °C).
- Do not use the headphones in a thunderstorm storm. This could prevent the headphones from working properly, and also increase your chance of being electrically shocked.
- Do not use oil or any volatile liquid to clean this product.
- Do not listen at high volumes for extended periods of time.
- Do not use the headphones in traffic. Do not use the headphones any time it would be dangerous to be unaware of noises around you.
- Adult supervision is required for children of age 6 and under.
- If you don't feel comfortable after wearing the headphones, please refer to an aurist for advice on whether in-ear headphones are suitable for you.

FAQ

- How to make sure the headphones have been fully charged?
Put the headphones into the charging case, if the headphone status LEDs are glowing this means they have been fully charged.
- Why won't headphones turn on?
Check if your headphones have enough battery life. If not, please charge them for at least 30 minutes.
- Why won't the headphones connect to my cellphone, or take a long time to connect?
Put both buds back into the charging case, then press and hold the pairing button for 3 seconds, click the device name in your settings, they should now pair correctly to the phone.
- Why won't the headphones make phone calls?
The headphones are without microphones or phone call functions.
- Why is the Bluetooth connection not stable and/or experiences some interruptions?
1) Try shortening the distance between your headphones and the device. Avoid solid barriers between you and the device.
2) Please keep away from strong interference sources, such as Wi-Fi and GPRS.
3) Please make sure the Bluetooth antenna of your device is not blocked.
- Why can't the volume be adjusted by the cellphone buttons when playing soothing sounds in 1MORE MUSIC APP?
The soothing sounds are stored in the flash of the headphone which can be adjusted only via the APP.
- The headphones will be disconnected from the cellphone when out of wireless range. They cannot restore the connection after returning back into the wireless range, how to solve it?
Click the device name in the cellphone pairing list to connect again.
- I feel uncomfortable when wearing the headphones, how to solve it?
This is mainly because the sizes of ear tips and your canals are not snug, we suggest trying smaller ear tips.

* For more detailed product FAQs, please visit the product support section under: www.1more.com

WEEE

Electrical and electronic equipment, parts and batteries marked with this symbol must not be disposed of with normal household waste, it must be collected and disposed of separately to protect the environment.

Your 1MORE retailer will advise you of the correct way of disposal in your country.

Safety Caution

Do not expose batteries or battery packs to excessive heat such as sunshine, fire or the like.

CE

Declaration of Conformity Hereby, Tianlab Acoustic Technology Limited declares that the radio equipment type 1MORE ComfoBuds Z of EH601 is in compliance with Directive 2014/53/EU. The full text of the EU declaration of conformity is available at the following internet address: www.1more.com

RF exposure information: The device has been evaluated to meet general RF exposure requirement. -Connect the equipment into an outlet on a circuit different from that to which the receiver is connected. -Consult the dealer or an experienced radio/TV technician for help.

Supplier's Declaration of Conformity
47 CFR § 2.1077 Compliance Information
Unique Identifier:
Trade Name: 1MORE
Model No.: EH601
Responsible Party - U.S. Contact Information
1MORE USA, Inc.
Address: 10225 Barnes Canyon Road, Suite A202, San Diego, California, 92121
Tel: 1-855-551-6673
E-Mail: support@1moreusa.com

Warning

Replacement of a battery with an incorrect type that can defeat a safeguard (such as catching fire, explosion, leakage of corrosive electrolyte etc);
Disposal of a battery into fire or a hot oven, or mechanically crushing or cutting of a battery, that can result in an explosion;
Leaving a battery in an extremely high temperature surrounding environment that can result in an explosion or the leakage of flammable liquid or gas; and A battery subjected to extremely low air pressure that may result in an explosion or the leakage of flammable liquid or gas.

⚡ The symbol indicates DC voltage.

♻️ RECYCLING

This product bears the selective sorting symbol for Waste electrical and electronic equipment (WEEE). This means that this product must be handled pursuant to European directive 2012/19/EU in order to be recycled or dismantled to minimize its impact on the environment. User has the choice to give his product to a competent recycling organization or to the retailer when he buys a new electrical or electronic equipment.

⚠️ To prevent possible hearing damage, do not listen at high volume levels for long periods.

FCC

The SAR limit of USA (FCC) is 1.6 W/kg averaged over one gram of tissue. Device types EH601 (FCC ID: 2ASDIEH601) has also been tested against this SAR limit. This device complies with part 15 of the FCC rules. Operation is subject to the following two conditions: (1) this device may not cause harmful interference, and (2) this device must accept any interference received, including interference that may cause undesired operation.

NOTE: The manufacturer is not responsible for any radio or TV interference caused by unauthorized modifications or changes to this equipment. Such modifications or changes could void the user's authority to operate the equipment.

NOTE: This equipment has been tested and found to comply with the limits for a Class B digital device, pursuant to part 15 of the FCC Rules. These limits are designed to provide reasonable protection against harmful interference in a residential installation. This equipment generates uses and can radiate radio frequency energy and, if not installed and used in accordance with the instructions, may cause harmful interference to radio communications. However, there is no guarantee that interference will not occur in a particular installation. If this equipment does cause harmful interference to radio or television reception, which can be determined by turning the equipment off and on, the user is encouraged to try to correct the interference by one or more of the following measures:

- Reorient or relocate the receiving antenna.
- Increase the separation between the equipment and receiver.
- Connect the equipment into an outlet on a circuit different from that to which the receiver is connected.
- Consult the dealer or an experienced radio/TV technician for help.

Supplier's Declaration of Conformity
47 CFR § 2.1077 Compliance Information
Unique Identifier:
Trade Name: 1MORE
Model No.: EH601
Responsible Party - U.S. Contact Information
1MORE USA, Inc.
Address: 10225 Barnes Canyon Road, Suite A202, San Diego, California, 92121
Tel: 1-855-551-6673
E-Mail: support@1moreusa.com

Model: EH601
Headphone Weight: 2.7 g
Case Weight: 34 g
Product Weight: 39.4 g
Headphone Size: 24 × 9.2 × 14.2 mm
Case Size: 60 × 30 × 38.5 mm
Headphone Battery Capacity: 30 mAh
Case Battery Capacity: 410 mAh
Headphone Charging Time: 85 mins
Case Charging Time: 80 mins
Battery Life
* Headphone Fully Charged
BLE Local Playtime: approx. 3.5 h

Bluetooth Playtime: approx. 2.5 h*
* Headphones + Case Fully Charged
BLE Local Playtime: approx. 14 h*
Bluetooth Playtime: approx. 10 h*
Impedance: 22 Ω
Wireless Range: 10 m
Bluetooth: Bluetooth® 5.0
Bluetooth Protocol: A2DP / AVRCP / BLE
Input: 5V-1A
Frequency Band: 2.400 GHz ~ 2.4835 GHz

The specifications are acquired from laboratory tested data.
* The playtime, tested under the laboratory condition of AAC format and 50% volume, may vary with different device setting, environments, usage and other factors.

Manufacturer: Tianlab Acoustic Technology Limited
Address: Tianlab Building 1403, Zone A Tianliao Industrial Park, Taoyuan Str., Nanshan Dist., Shenzhen, P.R. China
Product information can be found at www.1more.com