

**aidios *M1***

USER MANUAL



1.	Safety instructions and warnings .....	1
2.	Overview	
2.1.	Inside the box .....	2
2.2.	Specification .....	2-3
2.3.	Product overview .....	4
3.	Getting started	
3.1.	Charging and powering monitor unit .....	5
3.2.	Powering camera unit .....	6
4.	Operation – General mode	
4.1.	OSD icons .....	7
4.2.	Control keys .....	8
5.	Operation – Menu mode	
5.1.	Video category .....	9
5.2.	Audio category .....	10
5.2.1.	Auto mute .....	10
5.2.2.	VOX .....	11
5.3.	Camera category .....	11
5.3.1.	Add a camera unit .....	12
5.3.2.	Auto scan .....	12
5.3.3.	Picture in picture (PiP) .....	13
6.	Troubleshooting and tips .....	14-16
7.	Warranty information .....	17
8.	FCC statement .....	18
9.	Declaration of conformity / Others .....	19

## 1. Safety instructions and warnings



Please read and follow all instructions and warnings in this user manual before using the product.

- **Strangulation Hazard** - Keep the adapter cord out of the reach of children. Never place the camera or cord within 3 feet of a crib or playpen.
- **Choking Hazard** - This product contains small parts which may cause choking. Not for children under 3 years.
- Risk of explosion if battery is replaced by an incorrect type. Dispose of used battery according to the instructions.
- Use ONLY the power adapters and battery supplied with this product. Using other 3rd parties power adapter or battery may cause fatal damage to the product.
- Protect the adapter cord. Route cord so that they are not walked on or pinched by items or against them.
- Keep all components away from water or heat source such as a sink, bath tub, laundry tub, fire place or stove.
- Provide proper ventilation for both monitor and camera unit. Do NOT cover them with any material, such as a blanket or cloth.
- Disconnect all A/C adapters before cleaning. Do NOT immerse in water. Clean it only with a dry cloth.
- Do NOT attempt to open the devices or accessories. No user serviceable part inside. Risk of electrical shock, fire or death.
- This product is NOT a substitute for direct supervision of your baby. Check your baby's activities at regular intervals.
- This product is not a toy. Do NOT allow children to play with it.

## 2. Overview



### 2.1. Inside the box

Thanks for purchasing aidios M1 wireless monitoring system. It contains below components :

Monitor unit x 1

Camera unit x 1

Rechargeable Lithium battery x 1

A/C adapters x 2

Wall mounting screw x 1

Adhesive rubber foot (for camera stand) x 4

User manual x 1

### 2.2. Specification

RF frequency	2400 – 2483.5 MHz
Type of modulation	GFSK
Type of spread spectrum	FHSS
Data rate	4 Mbps
Channel width	4 MHz
Transmission range	>1000 feet (LOS)

## 2. Overview



### Monitor unit

Display	4.3" color TFT LCD, 480x272
Audio	Built-in speaker and microphone
Battery	1800mAh rechargeable Lithium-ion polymer
Duration (Normal)	~9 hours
Duration (VOX on)	~15 hours
Operating voltage	5V

### Camera unit

Picture sensor	1/5" Color CMOS, 640x480
Optical lens	F2.4, EFL 3.7mm, FOV 70°
Night vision	8 x 940nm IR LEDs
Light sensor	Built-in
Audio	Built-in speaker and microphone
Operating voltage	5V

	A/C adapter	Battery
Mfg.	Dongguan Guanjin Electronics Technology Co., Ltd.	True Power Technology Co., Limited.
Model #	K05B050100 series	505068 (1ICP5/51/68)
Spec.	Input 100-240V AC 50/60 Hz Output 5.0V DC 1.0A	3.7V 1800mAh 6.66Wh



### 2.3. Product Overview

#### Monitor Unit

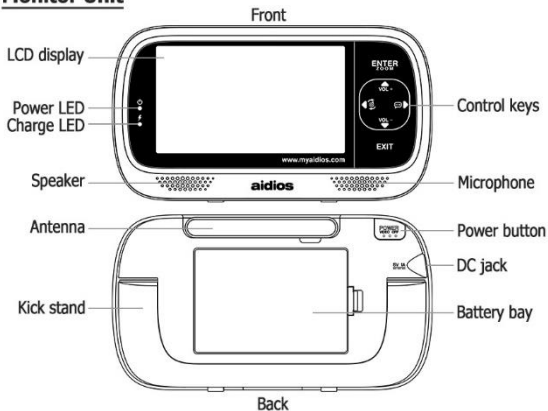

#### Camera Unit

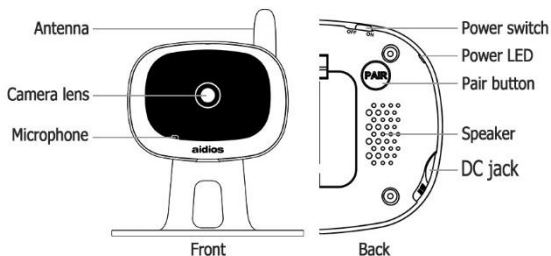

## 3. Getting started



### 3.1. Charging and powering monitor unit

Loosen the screw and open battery door. Plug in the battery to the battery socket as shown in *pic. 1*. Close the battery door and tighten the screw.

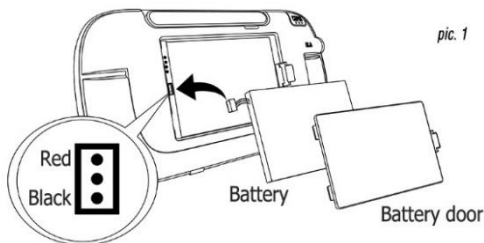

Plug the power adapter into an electrical outlet. Insert the 3.5mm plug to the power jack as shown in *pic. 2*. The charging process starts and charge LED indicator emits red light.

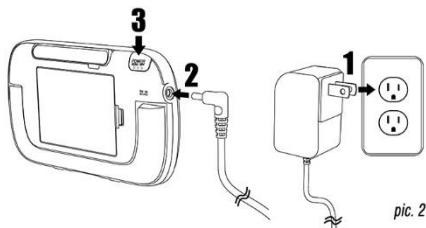

Press and hold the power button for 1 second to turn on the monitor unit. Power LED indicator emits blue light when monitor unit is turned on.



### 3.2. Powering camera unit

Plug the power adapter into an electrical outlet. Insert the 3.5mm plug to the power jack as shown in *pic. 3*. Slide the power switch to 'ON' position to turn on the camera unit. Power LED indicator emits blue light when camera unit is turned on.

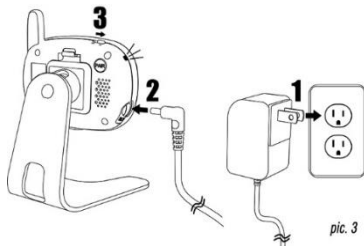

#### NOTE :

- Do not ingest battery, Chemical Burn Hazard.
- This product contains a Lithium cell battery. If the battery is swallowed, it can cause severe internal burns in short period and can lead to death.
- Keep new and used batteries away from children.
- If the battery compartment does not close securely, stop using the product and keep away from children.
- If you think battery might have been swallowed and placed inside any part of body, seek immediate medical attention.





### 4.1. OSD icons

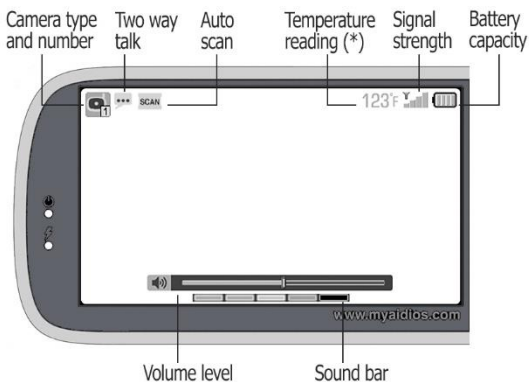

Camera icons :



Standard camera unit



Camera unit at zoom mode



Camera unit with pan tilt docking installed

(\*) Temperature reading icon will be displayed only when pan tilt docking is installed.



### 4.2. Control keys

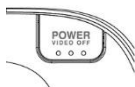

#### Power button

Press and hold : Power on/off

Short press : Video off mode (audio only)

#### Up arrow key

Short press :  
Increase volume

#### Left arrow key

Short press :  
Switch camera number

#### Exit key

Short press :  
Exit modes  
Press and hold :  
Pan-tilt mode (\*)

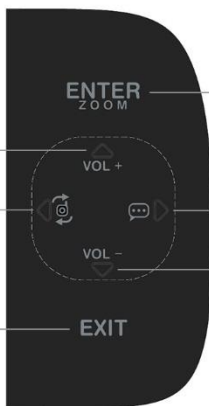

#### Enter key

Short press :  
Enter menu mode  
Press and hold :  
Enter zoom mode

#### Right arrow key

Press and hold :  
Two way talk

#### Down arrow key

Short press :  
Decrease volume

(\*) Pan-tilt mode is only available when pan-tilt docking is installed.

## 5. Operation - Menu mode



To enter menu mode, press 'Enter' key once. To leave menu mode, press 'Exit' key once. In menu mode, press arrow keys to navigate and select different options.

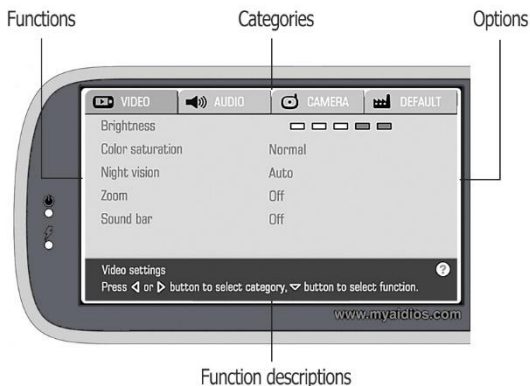

### 5.1. Video category

Brightness	Adjust brightness of LCD screen
Color Saturation	Adjust saturation level of video image
Night vision	Select different night vision modes
Zoom	Display enhanced zoom image
Sound bar	Display sound bar on screen
Temperature scale	Select Celsius/Fahrenheit for temperature display (Available only with pan-tilt docking)
Pan tilt mode	Toggle pan-tilt mode on/off (Available only with pan-tilt docking)



### 5.2. Audio category

Camera# volume	Adjust sound output of registered camera (2 way talk, lullaby and nature sound)
Low battery alert	Toggle low battery alert on/off (2 beeps)
Out of range alert	Toggle out of range alert on/off (1 beep)
Auto mute	Toggle auto mute on/off (3 sensitivity levels)
VOX	Toggle VOX on/off (3 sensitivity levels)
Camera # lullaby	Toggle lullaby on/off for registered camera
Camera # nature sound	Toggle nature sound on/off for registered camera

Note : After selected the option of lullaby and nature sound, press 'Enter' key to perform the action.

#### 5.2.1. Auto mute

When auto mute is enabled, the camera unit starts to detect noise level. It turns off audio completely after a 10 seconds of continuous silence. Any noise detected afterwards will trigger the audio system back on, and repeat the noise detection.

The pre-determined level of silence can be adjusted over sensitivity setting. High sensitivity setting works better at silent condition. Low sensitivity setting works better at noisy condition.

Note : When auto mute is enabled, VOX function will be disabled automatically.



### 5.2.2. VOX

Alike auto mute function, the camera unit starts to detect noise level when VOX is enabled. It turns off both video and audio completely after a 10 seconds of continuous silence. Any noise detected afterwards will trigger both systems back on, and repeat the noise detection.

Sensitivity setting is the same as auto mute function mentioned in 5.2.1.

Note : When VOX is enabled, auto mute function will be disabled automatically.

### 5.3. Camera category

Camera#	View, pair and or delete camera pairing for each camera
Auto scan	Cycle all registered cameras at an interval of 10 seconds.
Picture in picture	Display video from two camera units simultaneously. Video from secondary camera unit will be displayed at bottom right corner of screen.
Camera# night light	Toggle night light on/off at different camera units. (Available only with pan-tilt docking)

Note : After selected the option of camera#, press 'Enter' key to perform the action.



### 5.3.1 Add a camera

1. Select an ID number for your new camera and move the cursor to this camera ID number by pressing up/down arrow key.
2. Press left/right arrow key and select 'Pair' option.
3. Press 'Enter' key to perform pairing process.
4. Press and hold the 'Pair' button at the back of camera unit for 1 second. The power LED of camera unit will blink to indicate pairing mode.
5. Pairing process will be started automatically. Upon pairing success, the screen will display a message to indicate if the pairing process is completed.
6. If unsuccessful, delete the pairing and retry above process.

### 5.3.2 Auto scan

Auto scan function automatically cycles through all registered cameras and display each camera for 10 seconds. If only one camera is registered, the screen will only display video from the registered camera.

Note : When auto scan is enabled, VOX and auto mute functions will be disabled temporarily until auto scan is disabled.



### 5.3.3 Picture in picture (PiP)

Picture in picture function allows viewing 2 camera units simultaneously. The video image of primary screen will be displayed at normal size. The video image of secondary screen will be reduced to 1/3 of its original size and displayed at lower right corner of screen. No audio will be transmitted from the camera at secondary screen.

Camera number of secondary screen can be changed by pressing 'Left' arrow key at general mode

To swap between primary and secondary screen, press and hold 'Left' arrow key for 1 second at general mode.

Note : When picture in picture is enabled, activation of VOX and auto mute function will depend on the sound level of camera at primary screen.

Note : When both auto scan and picture in picture are enabled, the camera at secondary screen will be cycled at every 10 seconds

## 6. Troubleshooting and tips



Problem	Solution
Product does not switch on	<ol style="list-style-type: none"><li>1. Check the power adapter is properly connected to the device and wall outlets.</li><li>2. Swap the power adapter to check if the problem is caused by a defected adapter.</li><li>3. Double check if the monitor unit and camera unit is powered on. (Refer to section 3 of this user manual)</li></ol>
Screen shows 'Signal lost ! Establishing connection'	<p>It indicates that the monitor unit cannot communicate with the camera unit.</p> <ol style="list-style-type: none"><li>'1. Check the current camera number if it is correct. The camera number is displayed at the camera icon located at top left corner of screen.</li><li>2. If you are not sure about the camera number, press left arrow key to cycle through each camera from number 1 to 4.</li><li>3. Make sure the camera is powered on. The blue power LED should be lighted up.</li><li>4. If all fail, it may due to connection issue. Please check below column for the tips.</li></ol>
Connection issues	<p>Below are the tips to improve the connectivity between monitor and camera unit</p> <ol style="list-style-type: none"><li>1. Place both monitor and camera unit 3 feet above ground.</li><li>2. Flip the antenna out of the monitor unit.</li></ol>



## 6. Troubleshooting and tips



Connection issues (continued)	<ol style="list-style-type: none"><li>3. Place the monitor and camera units closer, if possible.</li><li>4. Avoid large metallic objects in close proximity to the monitor or camera unit.</li><li>5. Place the monitor or camera unit at least 3 feet from any 2.4GHz device, such as WiFi router, smartphone or microwave oven.</li><li>6. Try to delete the pairing at the monitor unit, and re-pair to the camera unit.</li><li>7. Try to enable smart channeling and use different band to test connectivity.</li></ol>
Screen shows black and white image, not color image	<p>It is normal that the system delivers black and white image at night vision mode.</p> <ol style="list-style-type: none"><li>1. Relocate the camera unit, so to capture correct ambient light level.</li><li>2. Select a low sensitivity night vision setting.</li><li>3. Night vision can be enabled or disabled manually in menu mode.</li></ol>
Feedback noise (shrill sound)	<ol style="list-style-type: none"><li>1. Avoid to put monitor and camera unit too close together.</li><li>2. Decrease volume level of monitor unit.</li></ol>
Sound cut in and out	<ol style="list-style-type: none"><li>1. Possibly due to auto mute function. Turn off auto mute function and test.</li><li>2. Unit at marginal reception condition. Try solutions in connection issues column.</li></ol>

## 6. Troubleshooting and tips



<p>Annoying beep alerts</p>	<p>There are 2 types of beep alerts, low battery and out of range.</p> <p>System delivers one beep every 10 seconds if the monitor cannot communicate with camera unit.</p> <p>System delivers two beeps every 10 seconds if the battery capacity is low.</p> <p>Both alerts can be enabled or disabled in user menu.</p>
<p>Battery and charging issue</p>	<p>For first time usage, it is always recommended to charge the battery for at least 8 hours before power on. Avoid to dry up the capacity before recharging, as it degrades the battery and shorten its life cycle.</p> <ol style="list-style-type: none"><li>1. During battery charging, the red charge LED should be lighted up. Check the power adapter and make sure it is properly connected to monitor unit and wall outlet.</li><li>2. Swap the power adapter to check if the problem is caused by a defected adapter.</li><li>3. Plug the power adapter to other wall outlet/power source.</li><li>4. Remove the battery from monitor unit, and re-insert it. Check the connection pins if they are in good condition.</li></ol>

## 7. Warranty information



We warrant to the original user that the product is free from material and workmanship defects for a period of one (1) year from the date of original purchase. If this monitoring system fails to function properly when used as directed under normal condition within the one year period, we will either repair or replace the product, at our discretion, free of charge.

This warranty does not apply to a product which has been damaged as a result of improper maintenance, accidents, improper voltage supply, or other misuses. The warranty is also void if the owner repairs or modifies the product in any way. We are not liable for any incidental or consequential damages with regard to this product. The warranty also excludes any liability other than what is stated above. No other warranties are given.

Legal rights vary from country to country. Some countries do not allow the exclusion or limitation of incidental or consequential damages, so the above limitation may not apply to you.

If you experienced any problem and the troubleshooting can not help you to solve the problem, please visit our website for an updated FAQ or contact us directly. We are always pleased to serve you at the best we can.

## 8. FCC statement



**WARNING** : Modifications not authorized by the manufacturer may void users authority to operate this device.

This device complies with part 15 of the FCC Rules. Operation is subject to the following two conditions: (1) This device may not cause harmful interference, and (2) this device must accept any interference received, including interference that may cause undesired operation.

Changes or modifications not expressly approved by the party responsible for compliance could void the user's authority to operate the equipment.

This equipment has been tested and found to comply with the limits for a Class B digital device, pursuant to Part 15 of FCC Rules. These limits are designed to provide reasonable protection against harmful interference in a residential installation. This equipment generates, uses, and can radiate radio frequency energy and, if not installed and used in accordance with the instructions, may cause harmful interference to radio communications.

However, there is no guarantee that interference will not occur in a particular installation. If this equipment does cause harmful interference to radio or television reception, which can be determined by turning the equipment off and on, the user is encouraged to try to correct the interference by one or more of following measures:

- Reorient or relocate the receiving antenna.
- Increase the separation between the equipment and receiver.
- Connect the equipment into an outlet on a circuit different from that to which the receiver is connected.
- Consult the dealer or an experienced radio/TV technician for help.

The camera unit shall be installed and operated with a minimum distance of 20cm between the radiator and your body.

Please refer to the appendix for the SAR statement.

## 9. Declaration of conformity / Others



### Declaration of Conformity :

Hereby aidios Ltd., declares that the aidios M1 and the series is in compliance with essential requirements and other relevant provision of Red Directive 2014/53/EU. The product had designed, tested and manufactured according the European Red Directive 2014/53/EU.



### Information on waste disposal for Consumers of Electrical & Electronic Equipment.

This mark on a product and/or accompanying documents indicates that when it is to be disposed of, it must be treated as Waste Electrical & Electronic Equipment, (WEEE). Any WEEE marked products must not be mixed with general household waste, but kept separate for the treatment, recovery and recycling of the materials used. For proper treatment, recovery and recycling; please take all WEEE marked waste to your Local Authority Civic waste site, where it will be accepted free of charge. If customers dispose of Waste Electrical & Electronic Equipment correctly, they will be helping to save valuable resources and preventing any potential negative effects upon human health and the environment, of any hazardous materials that the waste may contain.



FCC ID : 2AS8PAIDIOSM1M  
FCC ID : 2AS8PAIDIOSM1C

### Agent :

aidios LLC  
4400 SW 53 Terrace, Ocala, FL., 34474  
[info@myaidios.com](mailto:info@myaidios.com)  
<http://www.myaidios.com/>

Copyright® 2020

## **Appendix :**

For Monitor:

This equipment complies with FCC radiation exposure limits set forth for an uncontrolled environment. End user must follow the specific operating instructions for satisfying RF exposure compliance. This transmitter must not be co-located or operating in conjunction with any other antenna or transmitter. The portable device is designed to meet the requirements for exposure to radio waves established by the Federal Communications Commission (USA). These requirements set a SAR limit of 1.6 W/kg averaged over one gram of tissue. The highest SAR value reported under this standard during product certification for use when properly worn on the body is 0.256 W/kg. For body operation, this device has been tested and meets FCC RF exposure guidelines when used with any accessory that contains no metal and that positions a minimum of 15mm from the body. Use of other accessories may not ensure compliance with FCC RF exposure guidelines.