

Wireless Charger for Motorcycle

User's manual

R1/R2

Arzin Intelligent Co., Ltd

www.motocam.net

Please read this manual carefully before using the product

Product description

The Wireless Charger is a wireless charging product designed specifically for motorcycle brackets. Surface non-slip silicone material, 3M adhesive tape on the back, used with QC3.0 intelligent step-down cable, put the phone on the surface, can achieve 10W wireless fast charge. Waterproof rating IP67 also can be used normally even in the rain.

USB port



Charging Indicator

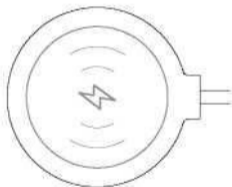

Power Indicator

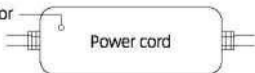

Power cord

Installation instructions

1. Connect the red and black wires of the main Line of the charging cable to the positive and negative terminals of the ignition switch of the

motorcycle.

2. After the main line is connected to the ignition switch, operate the wiring in sequence to the handle bar and then fix it with cable ties.

Reasonable wiring is required according to the actual situation of the vehicle because different types of vehicles differ in Line design.

3. Connect the USB receptacle Line with the waterproof connector of the main Une.

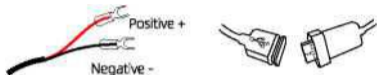

The main line is connected to Waterproof connectors
the ignition switch of the motorcycle

4. Remove the 3M adhesive tape on the back of the wireless chargee adjust the position according to different mobile phone holder and attach it to the surface of the mobile phone holder

if it is a RAM holder please remove the RAM adhesive tape first

5. When the device with wireless charging function conforms to the Qi standard is placed at the center of the wireless chargee; charging will start automatical When the wireless charger is in normal working state, the LED white light is always on.



Note: Keep the center position of the mobile phone at the center of the the wireless charger when wirelessly charge. If it is networking properly please adjust the position of the phone until the phone shows normal power charging or the LED white light is always on. (please Referto the figure below to place the position).

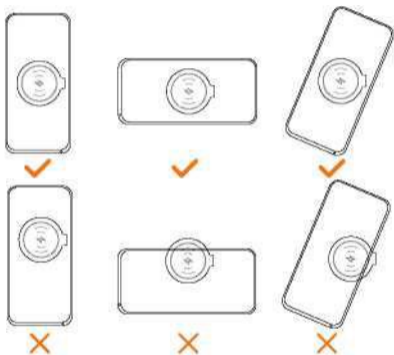

6. When the status of the LED light is blinking white, The wireless charger is in the wrong and protection phase. At this point, you should pay attention to whether there is a metal object placed on the wireless charger. Remove it and observe if it can be used normally. If you still can't solve it, please contact the sales staff.

QC3.0 Smart Power Cord

Item	Parameters
Input	12-24V
Output	5V3A
Cable Length	2.5m

How to charge the phone quickly?

1. First of all ensure that the mobile phone supports the fast charging function, the device will adaptively output the corresponding charging power according to the mobile phone; if the mobile phone does not have a fast charging function, it can be charged normally.
2. When charging, make sure that the phone is in closely bonded to the round part of the bracket with the mark.
3. Please ensure that the thickness of the phone case is within 4mm, so that the wireless charging function can be used normally.
4. If the indicator Light flashes rapidly or goes out during charging, please check if the charging part of the bracket is aligned with the wireless charging part of the mobile phone, or if there is metal object between the wireless charging and the mobile phone holder.

LED status description

White LED	Status
Always on for 4s	Self-testing
Always on	The device is charging the phone
Flashes per 3s	The device is in the stand by state
Flashes per 1s	The power output is low, please adjust the position of the mobile phone in time

Attention

* Do not disassemble or modify it by yourself.

- * Do not bring the product close to the fire or into the fire.
- * Do not use the wireless charger under severe heat or corrosive conditions to avoid damage to the circuit.
- * Do not place the magnetic card (ID card, bank card, etc.) with a magnetic strip or chip too close to avoid the magnetic card failure.

FCC WARNING STATEMENT

Changes or modifications not expressly approved by the party responsible for compliance could void the user's authority to operate the equipment. This equipment has been tested and found to comply with the limits for a Class B digital device, pursuant to Part 15 of the FCC Rules. These limits are designed to provide reasonable protection against harmful interference in a residential installation. This equipment generates uses and can radiate radio frequency energy and, if not installed and used in accordance with the instructions, may cause harmful interference to radio communications. However, there is no guarantee that interference will not occur in a particular installation. If this equipment does cause harmful interference to radio or television reception, which can be determined by turning the equipment off and on, the user is encouraged to try to correct the interference by one or more of the following measures: -- Reorient or relocate the receiving antenna. -- Increase the separation between the equipment and receiver. -- Connect the equipment into an outlet on a circuit different from that to which the receiver is connected. -- Consult the dealer or an experienced radio/TV technician for help. -- The distance between user and products should be no less than 20cm