

Installation Guide

WMZ10 Sensor

Wireless People Counting Sensor



BEFORE YOU BEGIN

Read these instructions completely and carefully.
Save these instructions for future use.

⚠ WARNING

Risk of electrical shock. Disconnect power before service installation, or maintenance of the product.

⚠ WARNING

Risk of fire. Follow all relevant IEC or UL instructions and local building codes.

⚠ WARNING

Risk of injury. Wear safety glasses and gloves during installation and servicing.

Prepare Electrical Wiring



Electrical Requirements

In case of power supply miswiring, mains can be present on the device. Make sure all electricity is switch off before inspection.



Grounding Instructions

The grounding and bonding of the overall system shall be done in accordance with National Electric Code (NEC) Article 600 and local codes.

ESD

Avoidance of Electrostatic Discharge

While the sensor is designed to withstand Electrostatic Discharge (ESD), it is always advisable to touch a grounded metal object before handling the sensor, particularly in an operating fixture.

IMPORTANT

To ensure the product warranty is valid, please ensure all installation instructions and environmental conditions for storage and operation are complied with. Only GE trained contractors can install the product.

FCC / IC COMPLIANCE STATEMENTS

This device complies with part 15 of the FCC Rules. Operation is subject to the following two conditions: (1) This device may not cause harmful interference, and (2) this device must accept any interference received, including interference that may cause undesired operation.

This device contains license-exempt transmitter(s)/receiver(s) that comply with Innovation, Science and Economic Development Canada's license-exempt RSS(s). Operation is subject to the following two conditions:

1. This device may not cause interference.
2. This device must accept any interference, including interference that may cause undesired operation of the device.

L'émetteur/récepteur exempt de licence contenu dans le présent appareil est conforme aux CNR d'Innovation, Sciences et Développement économique Canada applicables aux appareils radio exempts de licence. L'exploitation est autorisée aux deux conditions suivantes :

1. L'appareil ne doit pas produire de brouillage;
2. L'appareil doit accepter tout brouillage radioélectrique subi, même si le brouillage est susceptible d'en compromettre le fonctionnement.

To satisfy FCC/ISED RF exposure requirements a separation distance of 20 cm or more must be maintained between the antenna of this device and persons during operation. Operation at closer than 20cm is not permitted.

Pour être conforme aux limites d'exposition aux ondes RF des normes FCC/ISED, une distance de séparation d'au moins 20 cm doit être maintenue entre l'antenne de cet appareil et toute personne pendant son opération. Mettre en opération cet appareil à une distance plus rapprochée que 20 cm n'est pas permis.

Product Overview

The **WMZ10** is part of the Daintree Enterprise product portfolio, an open networked wireless controls solution to address evolving environmental regulations and transform spaces into intelligent environments for buildings of all sizes. The WMZ10 utilizes the Daintree Enterprise wireless network for dimmable light luminaire control, daylight harvesting, occupancy detection and non-camera based people counting. The WMZ10 is capable of advertising BLE beacons in the iBeacon format for enabling Indoor Positioning Solutions.

Technical Data

Product Specifications

Sensor Type	People counting, occupancy, light
Dimensions	See dimensioned diagram on the next page
Weight	0.016 kg
Voltage Rating	9.5 – 24 VDC, Class 2 (see note below)
Current Consumption	50 mA
Operating Ambient Temperature Range	0 - 50°C (Indoor)
Status Indicator	LED pattern indicates network join status
Connections	See connection diagram on the next page
Mounting Hole	Installs within a 22mm (0.87") hole
Recommended Mounting Height	9 – 11 ft; Recommended to be spaced 8ft apart on the x,y grid
Warranty	5 years

Note: Connect WMZ10 to GE Lighting Solutions LLC LED drivers or control modules not capable of providing greater than 15VA power, including but not limited to models listed in the Power Supply Compatibility List (see page 3).

Product Availability

SKU	DESCRIPTION	MODEL NUMBER
93106832	Wireless People Counting Sensor	WMZ10

Product Certifications



FCC ID: 2AS3F-WMZ10
IC: 25008-WMZ10

Additional Information

Purpose of the Control	Operating Control
Method of Mounting Control	Independently Mounted Control. Model WMZ10 intended for flush mounting into a recessed cavity
Type of Action and Additional Features	Type 1
Control Pollution Degree	2
Function / Software Class and Structure	Class A
Rated Impulse Voltage	330V

Note: Any external cables connected to devices not to exceed 30 meters length.

Product Dimensions

Note: Dimensions shown in mm.

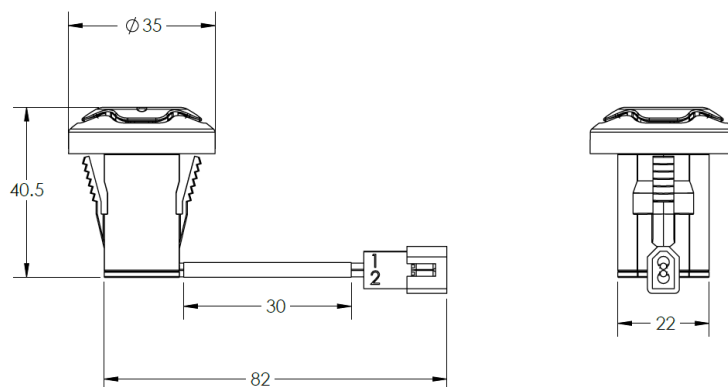

Wiring Diagram

Connect the WMZ10 Sensor to a compatible power supply using the provided connector.

While the sensor is designed to withstand Electrostatic Discharge (ESD), it is always advisable to touch a grounded metal object before handling the sensor, particularly in an operating fixture.

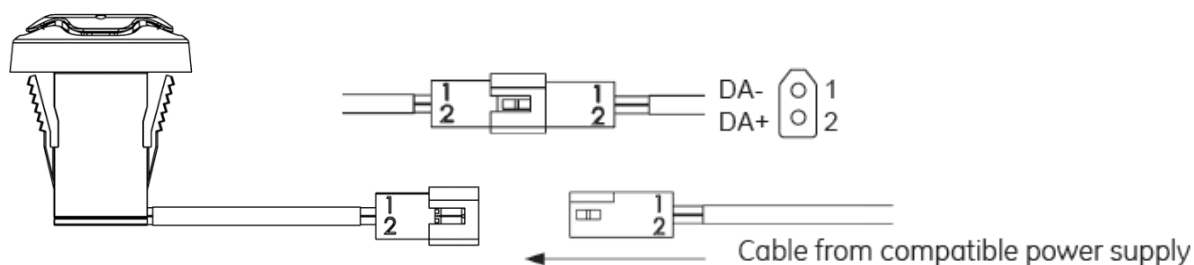

Power Supply Compatibility List

Manufacturer	Manufacturer P/N	Input Voltage (VAC)	Output Voltage (VDC)	DALI (Y/N)	WMZ10
Daintree	WA100	120 – 277 VAC	24 VDC	N	Compatible
Daintree	WGA100	120 – 277 VAC	24 VDC	N	Compatible
Wattstopper	BZ-50	120 – 277 VAC	24 VDC	N	Compatible
GE	LCACBA0TWUNGALV	120 – 277 VAC	12 – 20 VDC	Y	Compatible
GE	GED50MCC2P1000	120 – 277 VAC	DA OUTPUT 22.5 VDC	Y	Compatible
GE	GED36MCC2P700	120 – 277 VAC	DA OUTPUT 22.5 VDC	Y	Compatible
GE	GEMOD/DB010	120 – 277 VAC	DA OUTPUT 16 VDC	Y	Compatible

Caution: The user is cautioned that changes or modifications not expressly approved by the party responsible for compliance could void the user's authority to operate the equipment.

Note: This equipment has been tested and found to comply with the limits for a Class B digital device, pursuant to part 15 of the FCC Rules. These limits are designed to provide reasonable protection against harmful interference in a residential installation. This equipment generates, uses, and can radiate radio frequency energy and, if not installed and used in accordance with the instructions, may cause harmful interference to radio communications. However, there is no guarantee that interference will not occur in a particular installation. If this equipment does cause harmful interference to radio or television reception, which can be determined by turning the equipment off and on, the user is encouraged to try to correct the interference by one or more of the following measures:

- Reorient or relocate the receiving antenna.
- Increase the separation between the equipment and receiver.
- Connect the equipment into an outlet on a circuit different from that to which the receiver is connected.
- Consult the dealer or an experienced radio/TV technician for help.