

Solar Hybrid Module - B

Instructions Manual

Module solaire
Manuel d'instructions



DESCRIPTION

Components In The Box

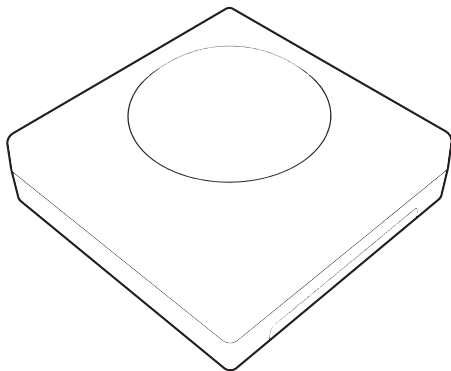

Module

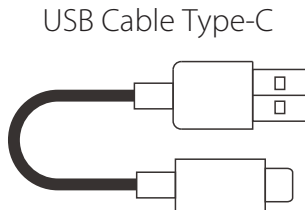

USB Cable Type-C

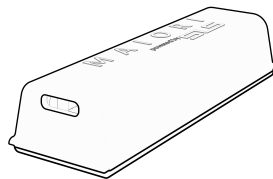

USB Dock

PRODUCT DESCRIPTION

- Built-in lithium battery, Bluetooth APP operation.
- Configure external charging type-c, solar power supply system.
- Dual button mode, auto/manual mode switching, brightness.
- Adjustment mode OFF - 25% - 50% - 100%.

FUNCTIONAL DIAGRAM

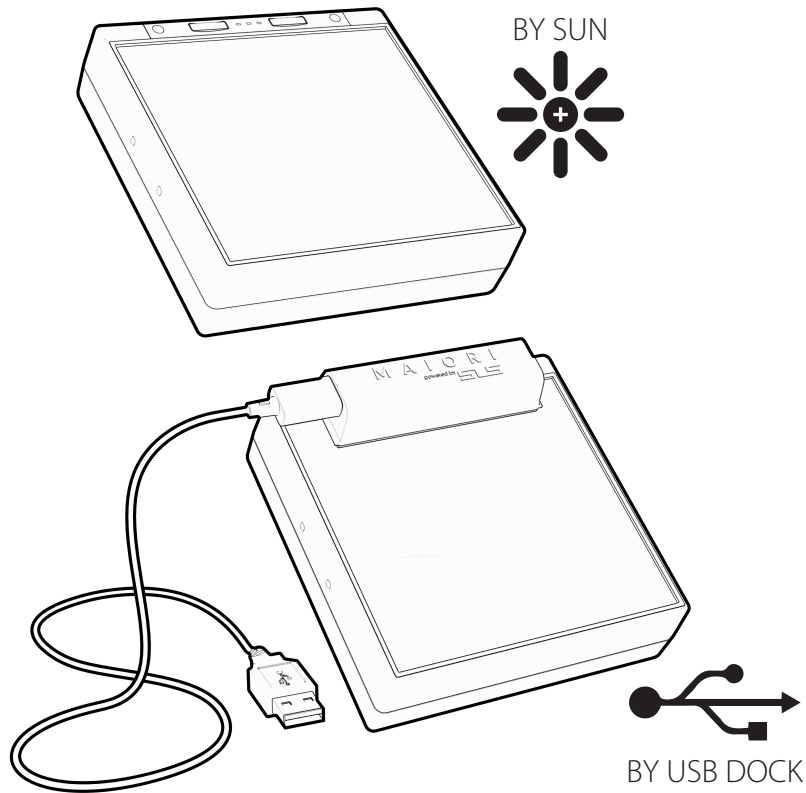

E INSTRUCTIONS

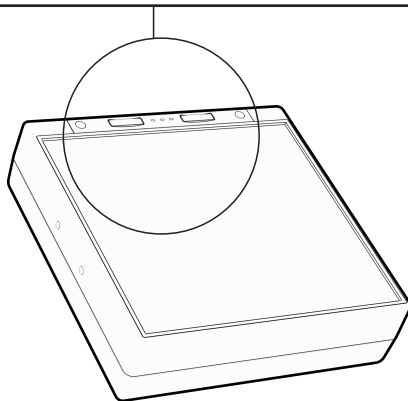
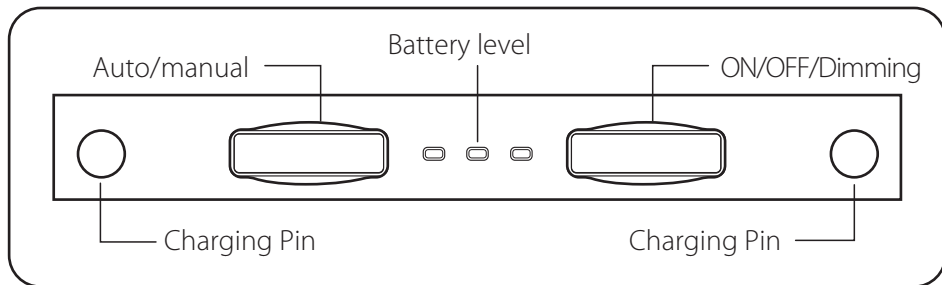

ON/OFF:

The ON OFF button allows to go through the main light functions : OFF > 75 lumens > 150 lumens > 300 lumens

E BASIC FUNCTIONS

Auto/Manual

If the user doesn't want to use the automatic sunlight detection mode, please press one time the left button to disable it. The ON/OFF button is on the right. On Auto mode, the module will be working only when the ambient light received by the solar panel is sufficiently low.

Battery level

The 3 leds battery indicator gives the information related to the current battery status. Each time when the user is pressing a button, the 3 leds indicator will be displaying the battery level for 3 seconds – 3 led lights means fully charged battery level, 2 led lights means an average battery level, 1 led light means a low but still usable battery level and 1 blinking led light means a critical low battery level indicating the user to charge the module.

Charging indicator

When the module is charging, a blue light located in the bulb will be glowing slowly and as soon as the battery is fully charged, it will stop. When not in use for a long time, the module can be put into deep sleep mode to save energy by pressing both buttons for 5 seconds until the 3 leds indicator blinks. A short press on the Auto/Manual button allows the module to wake up.



INSTRUCTIONS

Please check our website to have more information about how to use our smartphone APP

1. Download the MAIORI application onto your Smartphone.
2. The module must be charged before its first use, and regularly afterwards (otherwise the battery may deteriorate). It will glow blue when charging.
3. Set up your module using the MAIORI application. Refer to the user guide for further instructions: **<https://maiori.com/en/>**
4. In the event of a connection problem, press on the « ON/OFF » button for 10 seconds to reset it.

E MAIORI APP BASIC FUNCTIONS

ON / OFF + DIMMER

GROUPS LAMPS

PREFERRED LAMPS

SCHEDULING

SUN SET/RISE MODE

DEACTIVATE BUTTONS ON THE SOLAR HYBRID MODULE

DEEP SLEEP (BLUETOOTH OFF)



E INSTRUCTIONS

UP TO
300
LUMENS

RECHARGE OF THE BATTERY

under the sun

100%
Solar Powered

OUTDOOR & INDOOR USE

Remains lit for
10hours
Depending on settings

LED

LED Lighting



Solar Powered



Lithium Battery



Sustainable



Weatherproof



Recyclable
Product



100% Recyclable
Packaging and
Shock Proof

IP65

OUTDOOR LIGHTING

Tested waterproof
for outdoor use



E FCC WARNING STATEMENT

Changes or modifications not expressly approved by the party responsible for compliance could void the user's authority to operate the equipment. This equipment has been tested and found to comply with the limits for a Class B digital device, pursuant to Part 15 of the FCC Rules. These limits are designed to provide reasonable protection against harmful interference in a residential installation. This equipment generates uses and can radiate radio frequency energy and, if not installed and used in accordance with the instructions, may cause harmful interference to radio communications. However, there is no guarantee that interference will not occur in a particular installation. If this equipment does cause harmful interference to radio or television reception, which can be determined by turning the equipment off and on, the user is encouraged to try to correct the interference by one or more of the following measures:

- - Reorient or relocate the receiving antenna.
- - Increase the separation between the equipment and receiver.
- - Connect the equipment into an outlet on a circuit different from that to which the receiver is connected.
- - Consult the dealer or an experienced radio/TV technician for help.

E WARRANTY

Maiori Products are guaranteed for 2 years from the date of the purchase against defects in material and workmanship. The warranty does not cover normal wear and tear, scratches, deliberate damage or misuse, and / or damage caused by failure to observe operating instructions. The warranty will be void if the solar module unit has been opened.

For More Information

www.maiori.com

La Lampe^{by} Maiori Design