

# PIUM

## User's Guide

www.pium.co

### What's inside



Pium device

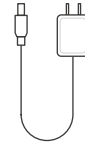

Power Adapter

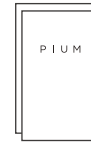

User's guide & Quick start guide

### Read me

- Requires fragrance capsules(not included)
- 2.4GHz Wi-Fi network is only supported.
- For more information, please visit [www.pium.co/support](http://www.pium.co/support)

### How to set up

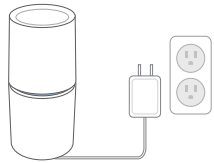

1

Plug the power adapter into the outlet on the wall.

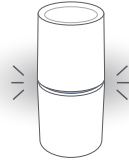

2

Make sure the white LED is blinking.



3

Download the Pium app and create own account.

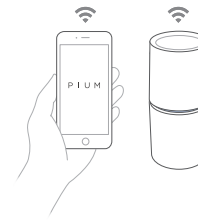

4

Follow the step-by-step guide from the Pium app to setup your device.

### Parts

[ Top ]

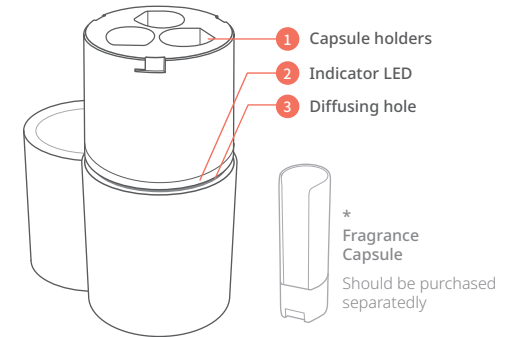

### How to use capsule

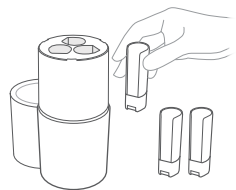

1

Open the top cover, and place capsules into your device.

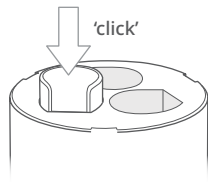

2

Make sure capsules are located properly.

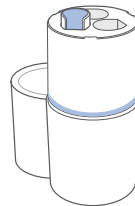

3

Blink the fragrance color when the RFID tag of the capsule is detected.

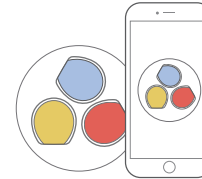

4

Use the Pium app to control scents and set up schedules.

[ Bottom ]

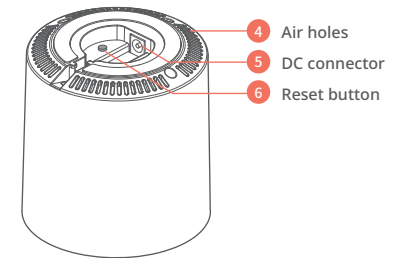

## Control

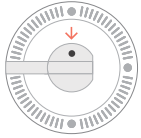

Bottom

### Reset

To reset your device by holding the reset button 5 seconds.



LED On



LED Off

### LED Control

1. Open the Pium app, and go to 'Device' tab
2. Tab the 'lightbulb' icon next to the device name.

## What LED color means

White blink	Wi-Fi is disconnected
White	Device is ready
Color blink	New scent capsule is recognized
Color	Scent capsule is on

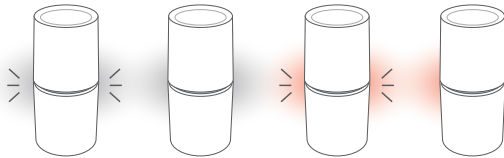

**White blink**  
Wi-Fi disconnected

**White**  
Ready

**Color blink**  
New scent capsule

**Color**  
Scenting

## FCC Statement

### FCC Certification Requirements

This device complies with Part 15 of the FCC Rules. Operation is subject to the following two conditions: (1) this device may not cause harmful interference, and (2) this device must accept any interference received, including interference that may cause undesired operation.

### Note:

This equipment has been tested and found to comply with the limits for a class B digital device, pursuant to Part 15 of the FCC Rules. These limits are designed to provide reasonable protection against harmful interference in a residential installation. This equipment generates, uses and can radiate radio frequency energy and if not installed and used in accordance with the instructions, may cause harmful interference to radio communications. However, there is no guarantee that interference will not occur in a particular installation. If this equipment does cause harmful interference to radio or television reception, which can be determined by turning the equipment off and on, the user is encouraged to try to correct the interference by one or more of the following measures:

- Reorient or relocate the receiving antenna
- Increase the separation between the equipment and receiver
- Connect the equipment into an outlet on a circuit different from that to which the receiver is connected
- Consult the dealer or an experienced radio/TV technician for help.

### CAUTION:

Changes or modifications not expressly approved by the party responsible for compliance could void the user's authority to operate the equipment.

## Warranty

Duration and Coverage. One (1) year Limited Hardware Warranty. Subject to the additional terms and conditions set forth below, Pium provides the following Limited Warranty only to the person or entity that originally purchased the Device from Pium or from one of its authorized resellers or distributors (must register via the Pium app);

Pium warrants the Device against defects in materials and workmanship under normal use for a period of one (1) year from the date of original purchase and with respect to pre-orders from the date the pre-orders are shipped ("Warranty Period"). If a Device is returned to Pium during the Warranty Period as provided below, and Pium determines that the Device is defective, Pium will either repair or replace the unit with either a new or a refurbished Pium device, or refund the original purchase price (less any discounts or promotional codes) in return for the Device, at its option. If the Warranty Period has expired or is otherwise not applicable as per the Scope and Limitation on Warranty, we will return the Device to you. More information about this warranty can be found at <http://www.pium.co/support>.

## Safety

1. Pium device is designed to be used indoors in a dry condition. Avoid liquid contact with the device. Do not submerge the devices in liquid or attempt to clean them with unauthorized liquids or solvents. To clean the device, disconnect from the power outlet and use a damp towel or authorized tools.
2. Pium device is designed for residential applications.
3. Do not apply directly to the body or in proximity to the face.
4. Do not disassemble or open Pium smart diffuser. Disassembling and opening device is very dangerous when it is connected to any power outlet. Disassembly of the device will void your warranty.
5. There should be at least 1-2 feet clearance for the best performance.
6. No modification of the equipment is allowed.
7. Do not use the power adapter if the cord is damaged.
8. Do not use a different power adapter than the one provided. with the device.
9. Confirm that your Pium is properly plugged in fully into your power outlet.
10. Do not use the scent capsule from non-authorized distributors or 3rd party manufacturers. Warranty will be void when unauthorized capsules are used.

## Specification

Dimension	Φ3.5in x 7.6in
Weight	0.7 lbs
Power	Input : AC 100-240V, 50-60Hz, 1A Output : DC 12V, 2A

Bluetooth	Bluetooth 4.2
Wi-Fi	802.11b/g/n/e/i (2.4GHz)
RFID	13.56 MHz / 47.544 mV/m @ less than 10m

Product	Pium Diffuser
Model No	P3001
FCC ID	<a href="#">MSIP-CRI-AAAA-FDDDD-FFFF</a>