

Operation manual

Gravity Touch

WGC

The diagram of installation

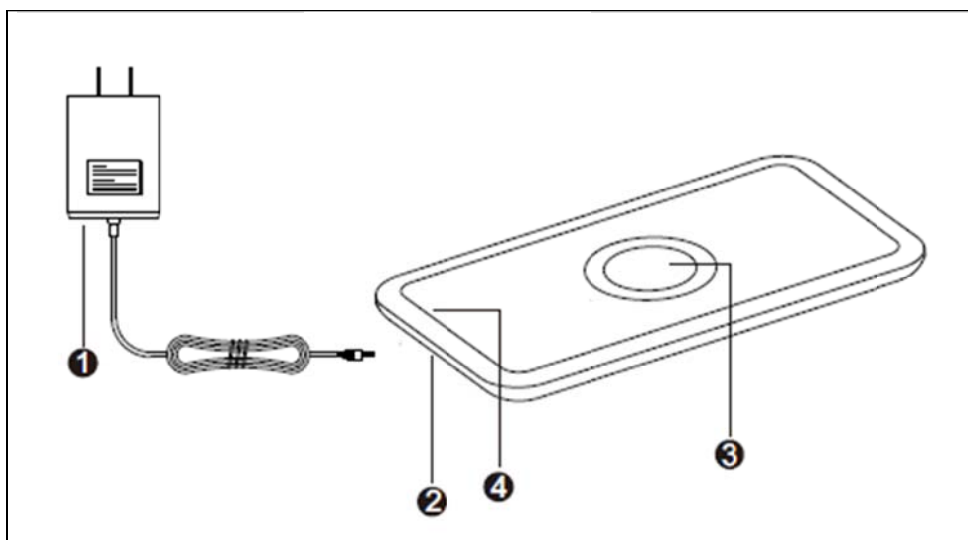

1. Power supply
2. Connector for power supply
3. Charging area
4. Product description

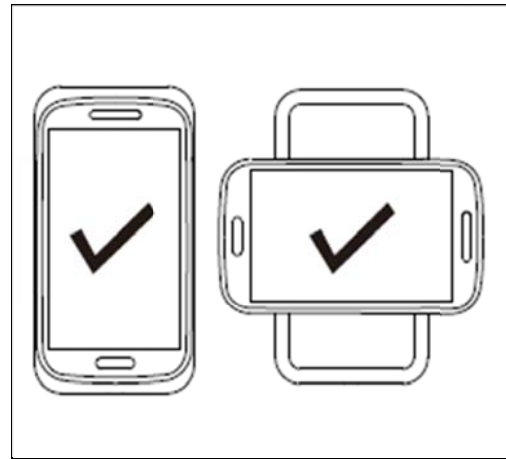
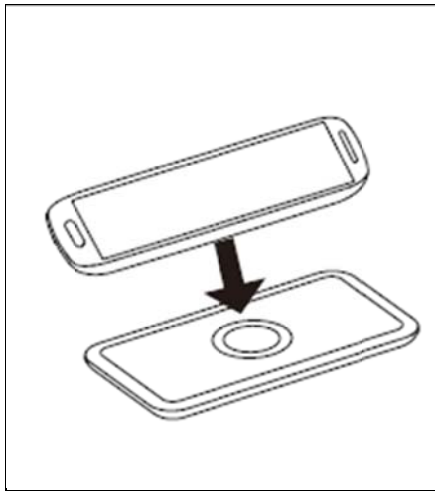

First of all, thanks sincerely for buying this product

1) For your safety, please read this manual carefully before using this product .

2) Please make sure that write down the selling date and sales shop's name on the warranty, and put it away with operation manual, keep them properly.

The first: To protect people from harm and property loss, we make a clear explanation on what you do should obey:

A. Warning! There are concerning the possibilities of death and severe wound : People who use heart-birth-maker should consult your doctor before you use this product ; And please leave it at a distance of 50cm from the place where you install your heart-birth-maker, the electromagnetic wave have influence on heart- birth-maker's work.

B. Attention! It may led to heat, fire and electric shock:

- 1) Do not put it into water or any other liquid , Do not make it wet;
- 2) Do not pull the AC adapter out with wet hands, ensure the safety and integrity of the adapter;
- 3) Do not let the dust or other things accumulate on the product and the AC adapter;
- 4) Do not use the product outside the temperature-20 °C to 40 °C;
- 5) Do not charge in places where the sun shine directly or with high temperature;
- 6) Do not use this product in places that are easy to fall , so as not to break;
- 7) Do not lay the magnetic card , magnetic record media and precise machine too close to the protect ;
- 8) Do not decompose and remold ;
- 9) Do not lay anything between the non-connection charging pad and the charging machine ;
- 10) Do not surpass the rated value when using the plug and other wiring layout;
- 11) Do not make any breakage on the AC adapter , please make sure you connect the AC adapter fully and take the AC adapter off the plug when it's not used .

12) Do not use travel converter .

13) Please teach your children , the let them use

The second :Product advantages

1) the product is of high sensitivity , intelligent recognition,

put a charge; After charging, automatically enter standby

mode of the product;

2) charge for all QI compliant product .

3) efficiency can reach more than 70% ,less heat;

4) in the process of charging can be free to pick up, answer the

phone , freeing discharge or charge;

The third wireless charger's charging method

1) Please connect the product to the AC adapter or

insert the USB to the computer socket ,red light is

on, enters the standby status;

2) Please lay the charge device directly on this product label

indicating area (without direction),green light is on, enters

the charging status;

3) When the charging equipment complete, can be taken away;

red light is on again, enters the standby status.

Main functions: wireless charging transmitter;

Products applicable: all qi wireless charging equipment

accorded with QI standard;

Charging type: one-on-one charge corresponding area;

The input voltage:DC:5V-2A;9V-1.67A

Launch distance:4 to 6 mm;

Conversion efficiency: $\geq 70\%$;

Charging methods: induction model;

Working frequency:110-205 KHz;

Accessories/components name: USB cable, Wireless charging pad ,Packing box, AC adapter(Selective).

FCC Warning

This device complies with part 18 of the FCC Rules. Operation is subject to the following two conditions:

(1) This device may not cause harmful interference, and (2) this device must accept any interference received, including interference that may cause undesired operation.

NOTE: Any changes or modifications to this unit not expressly approved by the party responsible for compliance could void the user's authority to operate the equipment.