

The label uses a double adhesives tape to with plastic for protection to ensure it cannot be removed.

Version history		PROJECT GRAPHIC DRAWINGS		Scale:100% Unit: mm	
Project: TCL SOCL200BTOR		Design Lead: Bazil Tung			
Version	Summary of updates	Approved for use by	Date	Version	Summary of updates
1.0	Issue for production	Bazil Tung	07.11.2018		
2.0	Approbations label update	Bazil Tung	28.01.2019		
3.0	Update FCC ID/IC shared with MTRO100BT	Bazil Tung	25.02.2019		

Appendix: ISO - A series paper (mm)	
A4 - 210 x 297	A1 - 594 x 841
A3 - 297 x 420	A0 - 841 x 1189
A2 - 420 x 594	2A0 - 1189 x 1682

Appendix: Types of drawing lines

Center line (center of an area)	-----
Thick line (boundary of product)	—————
Thin line (inner size & descriptive detail)	—————

Break line (break large parts)	⚡
Dashed line (indicates special requirement)	- - - - -
Dimension line (indicates size/ distance)	↔

Appendix: Tolerance (mm)

Small parts, delta +/-0,15
Medium parts, delta +/-0,25
Large parts, delta variant

PART	COLOUR	TECHNIQUE	CHANGES / REMARKS	VER	
A	TCL logo on earpiece	PMS Warm Red C	Pad printing	--	3.0
B	"L" and "R" graphic on earpiece	As per material	Recess engraving, 0.2, high gloss	--	3.0
C	TCL wordmark on neckband	As per material	Recess engraving, 0.2, high gloss	--	3.0
D	Model number on neckband	PMS Warm Red C	Pad printing	--	3.0
E	Approbations label	White colour graphics on black background	Single color print on black label, matte finish	--	3.0

100% Graphics art

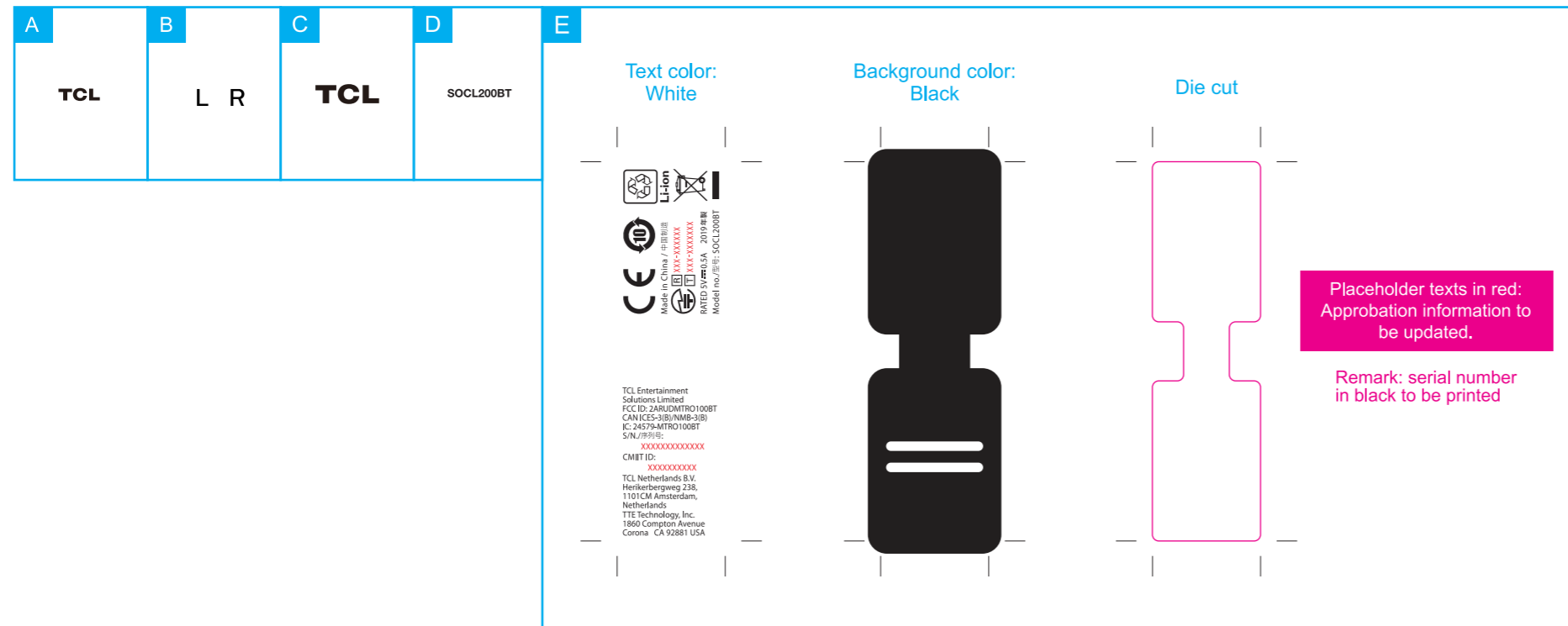



Label location