



ESCAPE
AUDIO

ESCAPE PODS
Amplify Your Workout



ESCAPE PODS
Amplify Your Workout

ESCAPE PODS
Amplify Your Workout

ESCAPE
AUDIO



Please read the enclosed instructions carefully before use.



MADE IN CHINA

ESCAPE PODS

User Manual

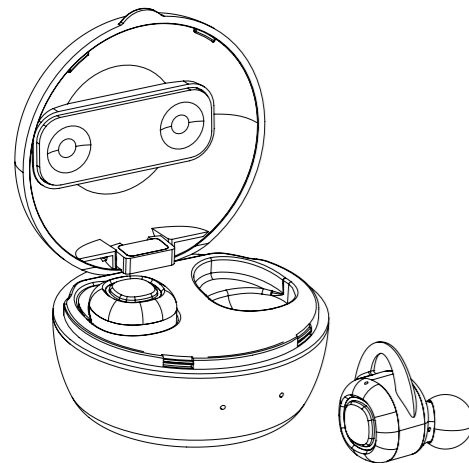

READ THIS MANUAL BEFORE USING THIS PRODUCT. FAILURE TO FOLLOW THE INSTRUCTIONS AND SAFETY PRECAUTIONS IN THIS MANUAL CAN RESULT IN SERIOUS INJURY OR DEATH.

INTRODUCTION

Thank you for choosing the Escape Pods, we really appreciate all your support.

This manual should provide you all the information that you need to operate your Escape Pods, but if you experience any issues at all then please don't hesitate to contact us on enquiries@escapeaudio.co.uk.

PRODUCT DESCRIPTION

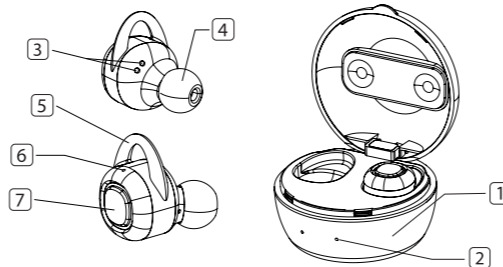

1. Charging Case
2. Charging Indicator
3. Charge Contact Point
4. Ear Tip
5. Ear Brace
6. Microphone
7. Multi-Function Key (Pair, Pause/Play, Answer Call/ Dial, Play Next Song/Previous Song)

PRODUCT FUNCTION PARAMETERS

1. Right and left earbuds can be used individually (mono) or simultaneously (stereo)
2. Diameter: 17mm
3. Bluetooth Chip: BES2000
4. Bluetooth Version: V4.2
5. Bluetooth Frequency: 2.4 GHz
6. Sensitivity: -38db MIC
7. Earbud Battery: 50 Mah with rechargeable customised Li-ion batteries
8. Distance: At least 10 meters (without obstacles)
9. Playing Time: Up to 3 hours
10. Standby Time: 100 hours (mono), 50 hours (binaural)
11. Built-in CVC 6.0 noise cancellation technology
12. 6mm high fidelity speakers
13. Charging Case: 500 MAH
14. Support: Android and IOS system

HOW TO USE

SWITCHING ON AND PAIRING THE ESCAPE PODS (STEREO USE)

1. Remove both Escape Pods from the charging case
2. Both Escape Pods will now switch on and connect automatically with each other
3. After a short 'beep' the Escape Pods will now search for a Bluetooth device
4. Turn on the Bluetooth on your device

CONNECTING THE ESCAPE PODS TO YOUR DEVICE

1. Once the Escape Pods are paired this will be indicated by flashing red and blue lights in the left (master) Escape Pod and a flashing blue light in the right (secondary) Escape Pod
2. Open the Bluetooth option on your mobile device
3. Select the option 'Escape Pods'
4. Once the connection has been achieved your Bluetooth status will display as 'Connected' and an audio message of 'Connected' will be transmitted by the Escape Pods

SWITCHING ON AND CONNECTING THE ESCAPE PODS (SINGLE USE)

1. Remove the left Escape Pod from the charging case
2. Hold down the multi-function button for 6 seconds
3. After a short 'beep' the switched on Escape Pod will now search for a Bluetooth device
4. Turn on the Bluetooth on your device
5. Select the option 'Escape Pods'
6. Once the connection has been achieved your Bluetooth status will display as 'Connected' and an audio message of 'Connected' will be transmitted by the Escape Pods

AUTOMATICALLY RECONNECT THE ESCAPE PODS

1. Ensure that the Bluetooth is activated on the device that you have previously connected the Escape Pods to
2. The device must be within 10 meters of the Escape Pods
3. Press and hold the multi-function button on both Escape Pods for 6 seconds
4. Both earbuds will automatically connect with each other (you'll hear a 'beep')
5. The Escape Pods will now search for a Bluetooth device which they have previously been connected to
6. The Escape Pods will now automatically connect to your Bluetooth device



ANSWER CALL

1. The phone call function is a mono function and therefore when making a phone call in stereo mode the left (master) Escape Pod is the only activated Escape Pod
2. When a call is incoming, please press the multi-function key to answer the call
3. Press the multi-function key to end the call

Please note – if you experience a slight echo at a high volume then you may have to turn the volume down slightly.

REJECT A CALL

1. When a call is incoming, please press and hold the multi-function key to reject the call
2. Once the call is rejected, press the multi-function key to return to music listening mode

LISTENING TO MUSIC

1. Press the multi-function key to play/pause your music
2. Press and hold the multi-function key to return to the previous song
3. Double click the multi-function key to listen to the next song

RESETTING THE ESCAPE PODS TO RECONNECT BOTH EARBUDS

1. Make sure that both Escape Pods are turned off by pressing and holding both earbuds for 3 seconds
2. Go to 'Settings' > 'Bluetooth' and press next to the name Escape Pods and tap on 'Forget this device'
3. Press and hold the multi-function button on both earbuds for 5 seconds
4. You will hear a rising tone, followed by a searching tone in both earbuds
5. The earbuds are now searching for each other
6. Press the multi-function button on both earbuds twice to reconnect them
7. After a couple of seconds the earbuds will connect with each other (you'll hear a 'Beep')
8. The Escape Pods will now search for a Bluetooth device
9. Go to 'Settings' > 'Bluetooth' and press 'Escape Pods' to connect them to your device

TURNING OFF THE ESCAPE PODS

1. Place both Escape Pods in the charging case

Or...
2. Press and hold the multi-function button for 3 seconds.

HOW TO CHARGE THE ESCAPE PODS

1. Put the Escape Pods in the charging case
2. The activation of a red light on the front of the charging case indicates that each Escape Pod is being charged
3. Sometimes one of the Escape Pods will take slightly longer to charge than the other
4. When the right lights turn off it means that charging has completed
5. When you place the Escape Pods in the charging case and the lights on the front don't turn on, it means that the charging case battery is empty
6. It takes approximately 50 minutes to fully charge the charging case

HOW TO CHARGE THE CHARGING CASE

1. Charge the charging case by connecting the USB cable provided into the slot on the rear of the case
2. When the red light on the back of the case stops flashing it means that the charging case is fully charged

GENERAL INFORMATION

GUARANTEE

Your Escape Pods are guaranteed for a period of 12 months from date of purchase.

Subject to the terms below, the guarantee will provide for the repair or replacement of the Escape Pods or any components thereof, which is identified as faulty or below standard, or as a result of inferior workmanship or materials.

The conditions of this guarantee are:

- The guarantee shall only apply to defects that occur within the 12 month guarantee period
- Proof of purchase is required
- The Escape Pods are returned to Escape Audio as instructed

This guarantee does not cover any faults or defects caused by accidents, misuse, fair wear and tear, neglect, tampering with the equipment, or any attempt at adjustment or repair other than through approved agents.

This product has an IPX4 waterproof rating, which is covered under the manufacturer's warranty.

This guarantee does not affect your statutory rights.

Please retain this document as it acts as a guarantee certificate.

PRODUCT DISPOSAL INSTRUCTIONS

The symbol shown here and on the product packaging means that the product is classed as Electrical or Electronic Equipment and should not be disposed with other household or commercial waste at the end of its working life.

The waste of Electrical or Electronic Equipment (WEEE) Directive (2002/96/EC) has been put in place to recycle products using best available recovery and recycling techniques to minimise the impact on the environment, treat any hazardous substances and avoid the increasing landfill.



PRODUCT DISPOSAL INSTRUCTIONS FOR RESIDENTIAL USERS

When you have no further use for it, please remove any batteries and dispose of them and the product as per your local authority's recycling processes. For more information please contact your local authority.

PRODUCT DISPOSAL INSTRUCTIONS FOR BUSINESS USERS

Business users should contact their suppliers and check the terms and conditions of the purchase contract and ensure that this product is not mixed with other commercial waste for disposal.

WARNING

Listening to earphones with the volume too high can harm your hearing

Keep this product away from children

Please do not attempt to make any modifications to or attempt to disassemble this product

Do not expose to extreme temperatures

Never attempt to use the Escape Pods while in charging mode

Never attempt to clean this product when in charging mode

Always ensure you are aware of your surrounding when using this product

We cannot guarantee that this product will always remain securely in your ears

Great care should be taken if ever handling any heavy objects while using/wearing this product and this is done entirely at the users own risk

This device complies with part 15 of the FCC Rules. Operation is subject to the following two conditions: (1) this device may not cause harmful interference, and (2) this device must accept any interference received, including interference that may cause undesired operation.

Any changes or modifications not expressly approved by the party responsible for compliance could void the user's authority to operate the equipment.

NOTE: This equipment has been tested and found to comply with the limits for a Class B digital device, pursuant to Part 15 of the FCC Rules. These limits are designed to provide reasonable protection against harmful interference in a residential installation. This equipment generates, uses and can radiate radio frequency energy and, if not installed and used in accordance with the instructions, may cause harmful interference to radio communications.

However, there is no guarantee that interference will not occur in a particular installation.

If this equipment does cause harmful interference to radio or television reception, which can be determined by turning the equipment off and on, the user is encouraged to try to correct the interference by one or more of the following measures:

- Reorient or relocate the receiving antenna.
- Increase the separation between the equipment and receiver.
- Connect the equipment into an outlet on a circuit different from that to which the receiver is connected.
- Consult the dealer or an experienced radio/TV technician for help.

The device has been evaluated to meet general RF exposure requirement. The device can be used in portable exposure condition without restriction